

ANOKA COUNTY
COUNTY DITCH INSPECTION REPORT

DITCH #13

DATE: 7/12/94

BY: P K Ruud

COMMUNITIES: East Bethel

REMARKS:

CSAH #22	From the north side of #22, west of Jackson St., CD # 13 coincides with CD #67. The ditch from Jackson St to TH #65 was cleaned by Hoffman Bros in 1994 under a Corps permit and with County Board approval.
CSAH #22	At this crossing, east of TH #65, the ditch is clear and flowing.
Klondike Rd	At this crossing, 3/8 mile east of TH 65, the ditch is in good repair and flowing.
Klondike Rd	At this crossing, 1 1/8 mile east of TH 65, the ditch is well maintained and flowing.
CR # 74	Ditch is defined, little water, no apparent flow.

ACTIVITIES:

The area east of TH 65, north of CSAH 22 to Klondike Rd is an area of active peatland farming.

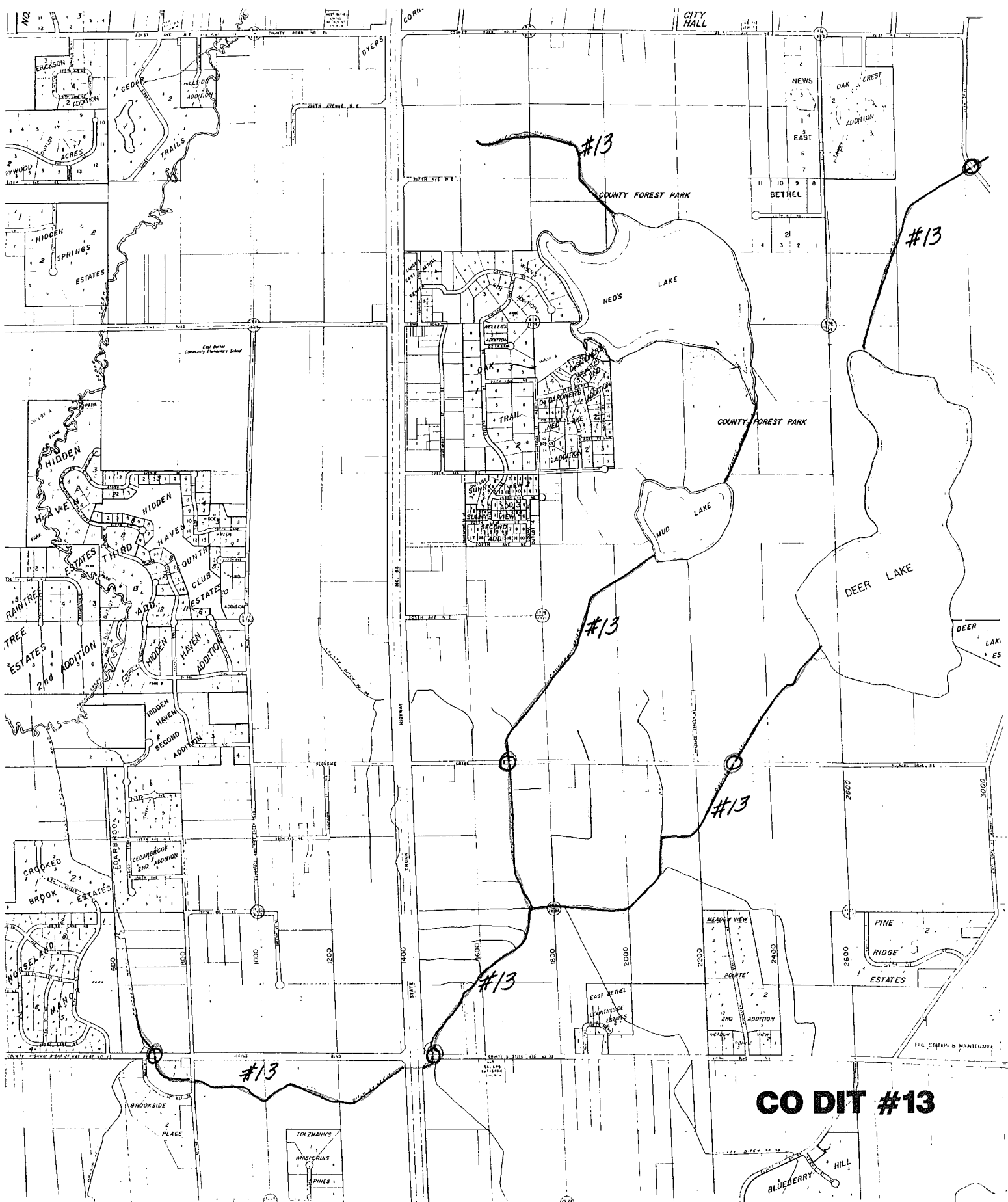

CO DIT #13