

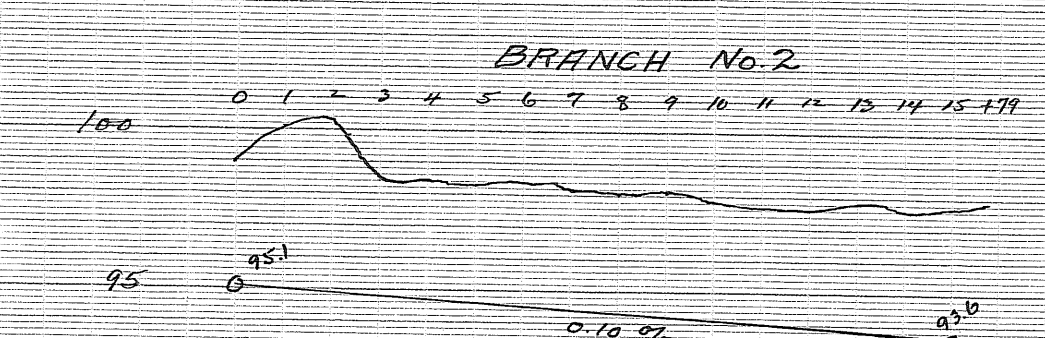

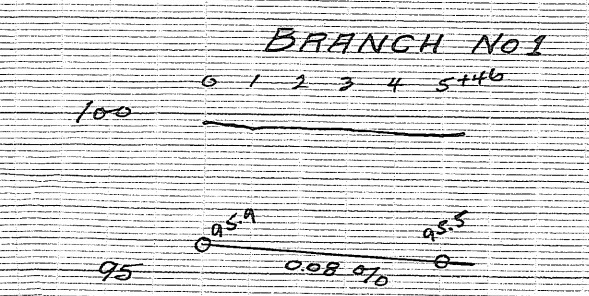

PROFILE OF REPAIRS DITCH NO. 14  
ANOKA COUNTY, MINN.

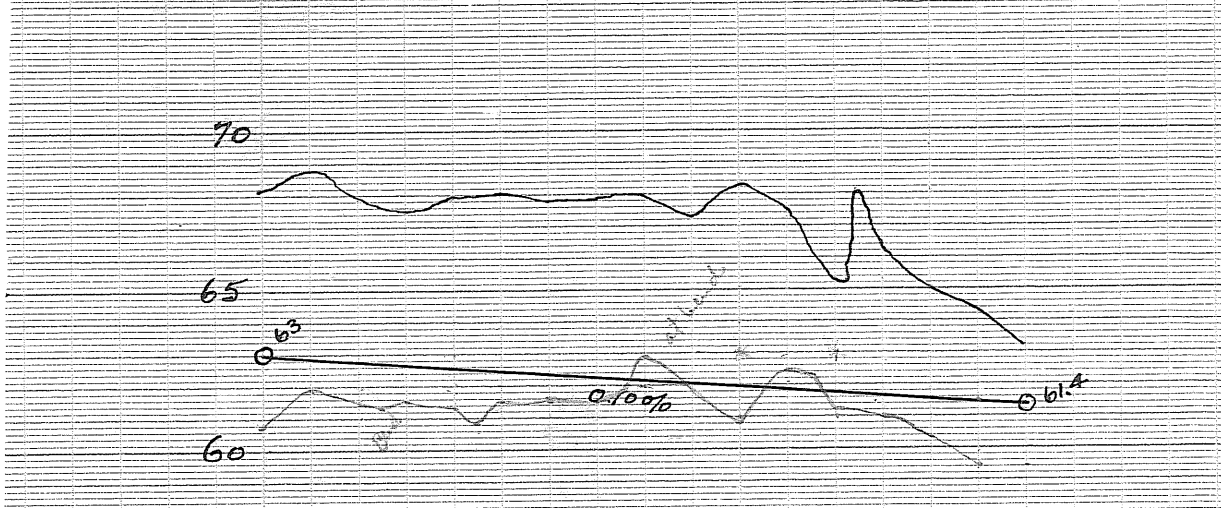
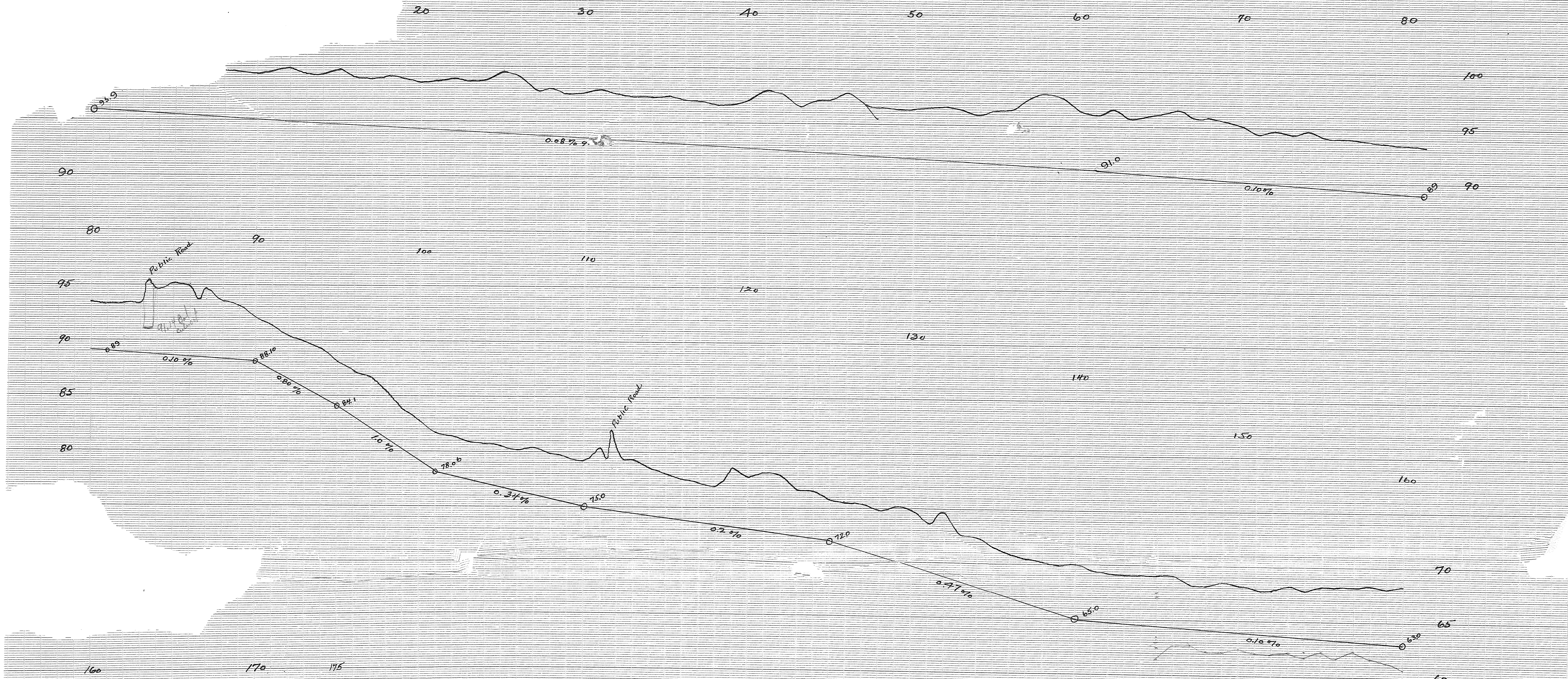

B.M. Twin Elm 200ft SW. of Sta 24+50 Elev 100.55  
 B.M. Top S. end stone culvert Sta 111+60 Elev 80.27  
 B.M. Barr Oak Near Sta 175+90 Elev 65.85



REPAIRS COUNTY DITCH No 14

Exhibit No. 2

MAIN DITCH

Station	Cut	Bl	Top	Cubic Yards	Yards to Excavate	Yds. to Pipe	Cost per Station
0	41	2	61	60	10	50	12.50
1	40	2	60	60	10	50	12.75
2	42	62	61	61	10	51	14.25
3	43	65	67	71	10	57	17.75
4	45	65	71	71	10	57	17.00
5	43	63	68	68	10	58	16.25
6	42	62	65	65	10	55	16.00
7	42	62	64	64	10	54	16.00
8	42	62	64	64	10	54	16.25
9	43	63	65	65	10	55	16.25
10	42	62	65	65	10	55	17.25
11	46	66	69	69	10	59	11.00
+50	57	77	44	44	10	44	11.50
12	49	69	46	46	10	46	18.50
13	44	64	74	74	10	74	17.50
14	45	65	70	70	10	70	19.25
15	50	70	77	77	10	77	18.50
16	43	63	74	74	10	74	16.50
17	43	63	66	66	10	66	17.50
18	46	66	70	70	10	70	16.50
19	44	64	71	71	10	71	17.75
20	42	62	66	66	10	66	16.75
21	45	65	67	67	10	67	16.50
22	48	68	74	74	10	74	18.00
23	46	66	76	76	10	76	19.00
24	48	68	76	76	10	76	18.00
25	57	77	90	90	10	90	22.50
26	52	72	95	95	10	95	23.75
27	41	61	75	75	10	75	18.75
28	43	63	64	64	10	64	16.00
29	39	59	61	61	10	61	15.25
30	42	62	60	60	10	60	15.00
31	45	65	67	67	10	67	16.75
32	43	63	68	68	10	68	17.00
33	40	60	63	63	10	63	15.75
34	41	61	60	20	40	40	10.00
35	43	63	64	20	44	44	11.00
36	40	60	63	20	43	43	10.75
37	40	60	59	20	39	39	9.75
38	37	57	56	20	36	36	9.00
39	39	59	55	20	35	35	9.75
40	45	65	64	20	44	44	11.00
41	54	74	82	20	62	62	15.50
42	51	71	90	20	70	70	17.50
43	40	60	73	20	53	53	13.25
44	40	60	66	20	46	46	11.50
45	49	69	77	20	57	57	14.25
46	56	76	90	20	70	70	17.50
47	46	66	86	20	66	66	16.50
48	44	64	71	20	51	51	12.75
49	43	63	67	20	47	47	11.75
50	45	65	69	20	49	49	12.25
51	47	67	73	20	53	53	13.25
52	49	69	78	20	58	58	14.50
53	46	66	77	20	57	57	14.25
54	43	63	70	20	50	50	12.50
55	48	68	72	20	52	52	13.00
56	50	70	81	20	61	61	15.25
57	62	82	100	30	70	70	17.50
58	65	85	121	30	91	91	22.75
59	63	83	123	20	103	103	25.75
60	62	82	104	20	84	84	21.00
61	50	70	86	20	66	66	16.50
62	56	76	91	20	71	71	17.75
63	58	78	96	20	76	76	17.50
64	52	72	84	20	64	64	16.00
65	55	75	93	20	73	73	18.25
66	61	81	106	15	81	81	20.25
67	54	74	104	15	79	79	19.75
68	55	75	95	15	70	70	17.50
69	53	73	94	20	74	74	18.50
70	50	70	87	20	67	67	16.75
71	44	64	76	20	56	56	14.00
72	48	68	78	20	58	58	15.25
73	45	65	74	20	54	54	13.50
74	50	70	77	20	57	57	14.25
75	45	65	77	20	57	57	14.25
76	45	65	71	20	51	51	12.75
77	45	65	71	20	51	51	12.75
78	44	64	70	20	50	50	12.50
79	44	64	69	20	49	49	12.25
80	44	64	69	20	49	49	12.25
81	43	63	69	20	49	49	11.75
82	45	65	69	20	49	49	12.25
83	46	66	72	20	52	52	13.00
+100	52	72	32	10	22	22	5.50
146	52	72	5	5	5	5	1.25
153	67	87	8	8	8	8	2.00
161	68	88	11	11	11	11	2.75
171	68	88	14	14	14	14	3.50
84	59	79	35	10	25	25	6.25
85	66	86	119	40	79	79	19.75
86	60	80	130	40	90	90	22.50
+60	53	73	66	30	36	36	9.00
87	63	83	52	30	22	22	5.50
88	52	72	104	20	84	84	21.00
89	49	69	84	20	64	64	16.00
90	40	60	70	20	50	50	12.50
91	41	61	60	20	40	40	10.00
92	37	57	59	20	39	39	9.75

BRANCH No. 1

Station	Cut	Bl	Top	Cubic Yards	Yards to Excavate	Yds. to Pipe	Cost per Station	
0	38	2	58	60	10	50	15.00	
1	38	58	55	55	10	45	13.75	
2	39	59	56	56	10	46	14.00	
3	39	59	57	57	10	47	14.25	
4	39	59	57	57	10	47	14.25	
5	39	59	57	57	10	47	14.25	
+46.5	41	61	27	27	10	17	4.25	
							309	\$77.25

BRANCH No. 2

Station	Cut	Bl	Top	Cubic Yards	Yards to Excavate	Yds. to Pipe	Cost per Station			
0	39	2	59	60	10	50	12.75			
1	51	71	71	20	51	51	17.50			
2	54	74	90	20	70	70	17.50			
3	36	56	72	20	52	52	13.00			
4	37	57	52	15	37	37	9.25			
5	37	57	53	15	38	38	9.50			
6	39	59	55	15	40	40	10.00			
7	38	58	56	15	41	41	10.25			
8	37	57	54	15	39	39	9.75			
9	39	59	55	15	40	40	10.00			
10	37	57	55	15	40	40	10.00			
11	37	57	53	15	38	38	9.50			
12	37	57	53	15	38	38	9.50			
13	40	60	56	15	41	41	10.25			
14	39	59	58	15	43	43	10.75			
15	41	61	59	15	44	44	11.00			
+79	43	63	51	9	42	42	10.50			
							743	249	644	173.50

SUMMARY							
Main Ditch	Cu. Yds. in Ditch	Yds. to Excavate	Yds. to Pipe	Cost	Culverts	Man. Cost	Total Cost
Branch No. 1	309	1910	309	77.25	1	88.50	165.75
Branch No. 2	943	249	644	173.50	1	88.50	262.00
Totals	16,476	2,159	14,317	350.75	2	177.00	\$527.75

Hubert Ave 6/19/20  
 Andrew J. [Signature]  
 [Signature]