

STATE OF MINNESOTA
DEPARTMENT OF HIGHWAYS
CONSTRUCTION PLAN FOR GRADING, SURFACING, CURB AND GUTTER
TRUNK HIGHWAY NO. 10 = 62

BETWEEN 1/4 MI. WEST OF T.H. 65 AND 1/4 MI. WEST OF PROPOSED T.H. 47
 A PT. 820.74' SO. AND 1021.71' E. OF A PT. 2476.39' NO. AND 1800.52' W. OF
 From N.W. COR. SEC. 1 T. 30 N. R. 24 W. To P. 1/4 COR. OF SEC. 36 T. 31 N. R. 24 W.

MINNESOTA PROJECT F058-1		STATE PROJECT NO. 0203-48	
GROSS LENGTH	9675.33 FEET	1.832 MILES	
BRIDGES-LENGTH	0.00 FEET	0.000 MILES	
EXCEPTIONS-LENGTH	0.00 FEET	0.000 MILES	
NET LENGTH	9675.33 FEET	1.832 MILES	



SPECIFICATIONS
 THE 'SPECIFICATIONS FOR HIGHWAY CONSTRUCTION'
 DATED MAY 1, 1959 AND SUBMITTED FOR APPROVAL BY
 THE DIVISION ENGINEER OF THE BUREAU OF PUBLIC
 ROADS ON MARCH 26, 1959 SHALL GOVERN.

EQUATIONS
 [Orwb P.T. 684+39.38= [Orwb P.T. 682+61.51=
 [Orwb P.O.T. 711+49.48 [Orwb P.O.T. 709+56.54
 [Orwb P.T. 738+61.62=
 [Orwb P.O.T. 738+60.12
 GROSS LENGTH BASED ON W.B. STATIONING

INDEX

SHEET NO.	DESCRIPTION
1	TITLE SHEET
2	ESTIMATE SHEET
3-4	TYPICAL SECTIONS
5-6	CROSS-OVER LAYOUTS
7	DRAINAGE
8	ITEM TABULATIONS
9-13	GRAVEL PITS
14-17	PLAN AND PROFILE
18-19	PROFILES
20-41	CROSS-SECTIONS

CONVENTIONAL SIGNS

PIT DATA

PIT NO. 2395	Located in S.E. 1/4 N.W. 1/4 & N.E. 1/4 S.W. 1/4 SEC. 10 T. 30 N. R. 23 W.
PIT NO. 3125	Located in S.W. 1/4 S.E. 1/4 SEC. 14 T. 119 N. R. 22 W.
PIT NO.	Located in Dead Man
PIT NO.	Located in Dead Man

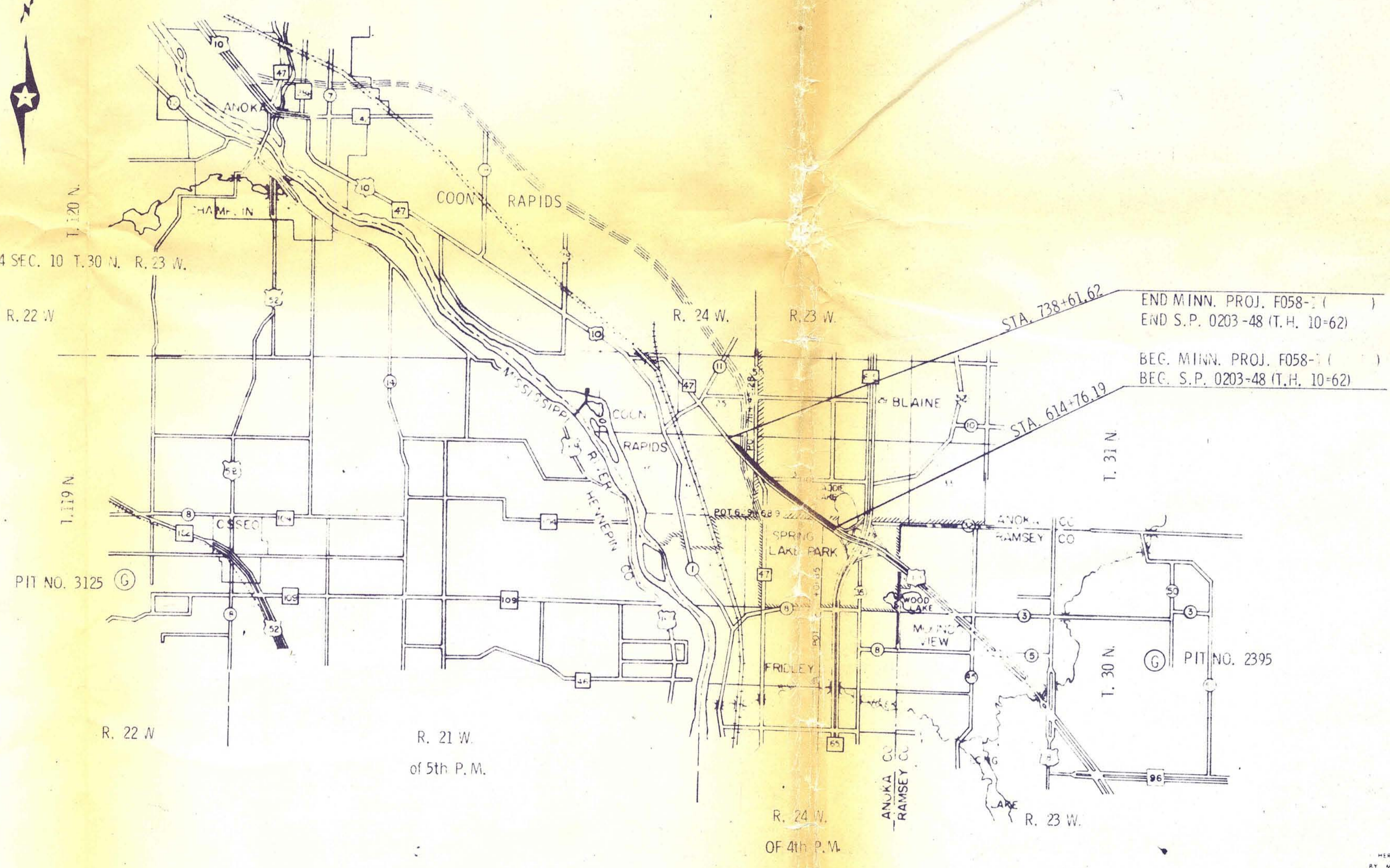

NOTE: PIT NO. 2395 IS A POSSIBLE SOURCE OF AGGREGATE FOR BITUMINOUS STABILIZED BASE. PIT NO. 3125 IS A POSSIBLE SOURCE OF AGGREGATE FOR BITUMINOUS MATERIALS.

DESIGN SPEED 70 MPH
 EXCEPT AS LOCALLY RESTRICTED
 BASED ON STOPPING SIGHT
 DIST. HEIGHT OF EYE 3.75' HEIGHT
 OF OBJECT 0.50' CLEAR VISION 600'

HEREBY CERTIFY THAT THIS PLAN WAS PREPARED
 BY ME OR UNDER MY DIRECT SUPERVISION AND
 THAT I AM A DULY REGISTERED PROFESSIONAL
 ENGINEER UNDER THE LAWS OF THE STATE OF
 MINNESOTA.

Right of Way Approval	ENGINEER OF LANDS AND RIGHT OF WAY	19
Recommended for Approval	ROAD PLANS ENGINEER	19
Recommended for Approval	DISTRICT ENGINEER	19
Recommended for Approval	ASSISTANT ROAD DESIGN ENGINEER	19
Recommended for Approval	ROAD DESIGN ENGINEER	19
Approved	DEPUTY CHIEF ENGINEER	19

S.P. 0203-48 (10=62) * 50-263

DEPARTMENT OF COMMERCE
 BUREAU OF PUBLIC ROADS

APPROVED

DATE