

Anoka County Ditch 22:

Report Dated 6-21-65

Begin in Sec. 32 Columbus,

Sec. 32 T32N R22W

5 T31N R22W

6 " "

7 " "

Feeds into County Ditch 10

Sec 7 T31 N R22 W

18 " "

19 " "

Into Marsham Lake

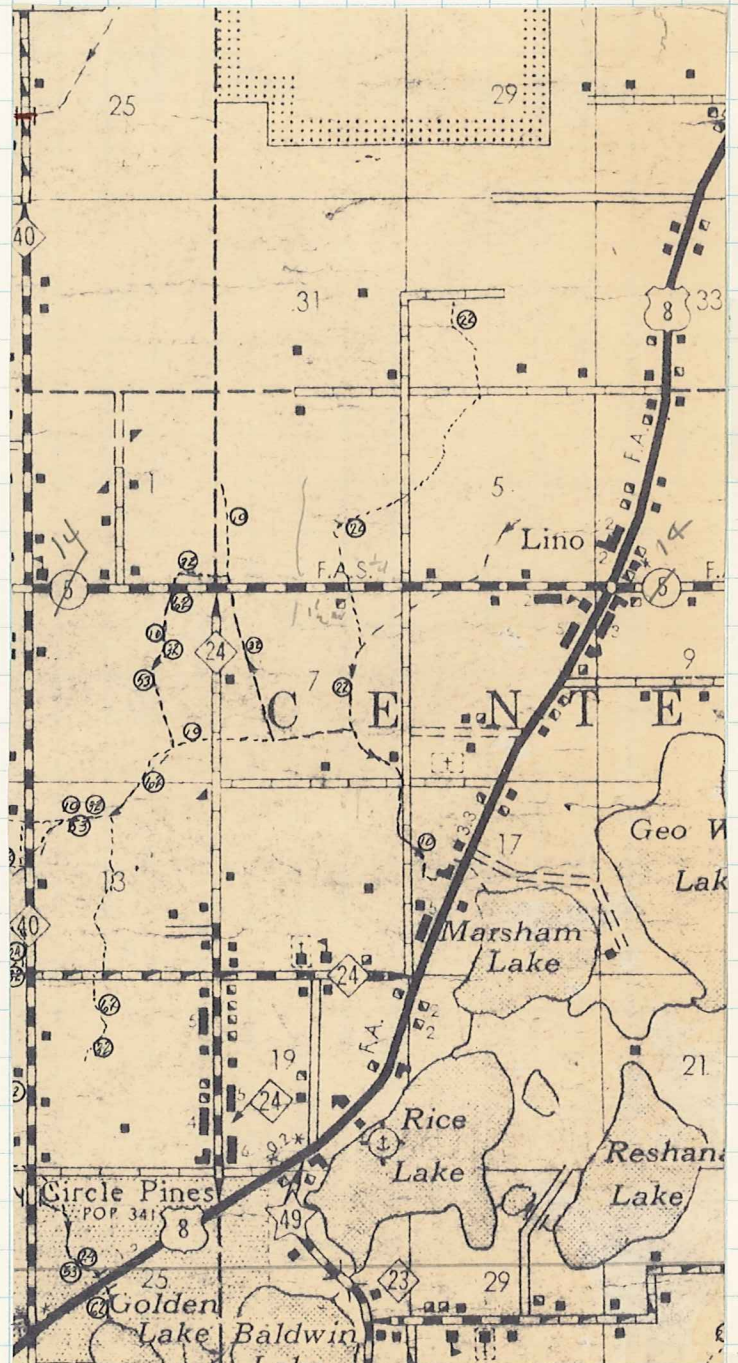
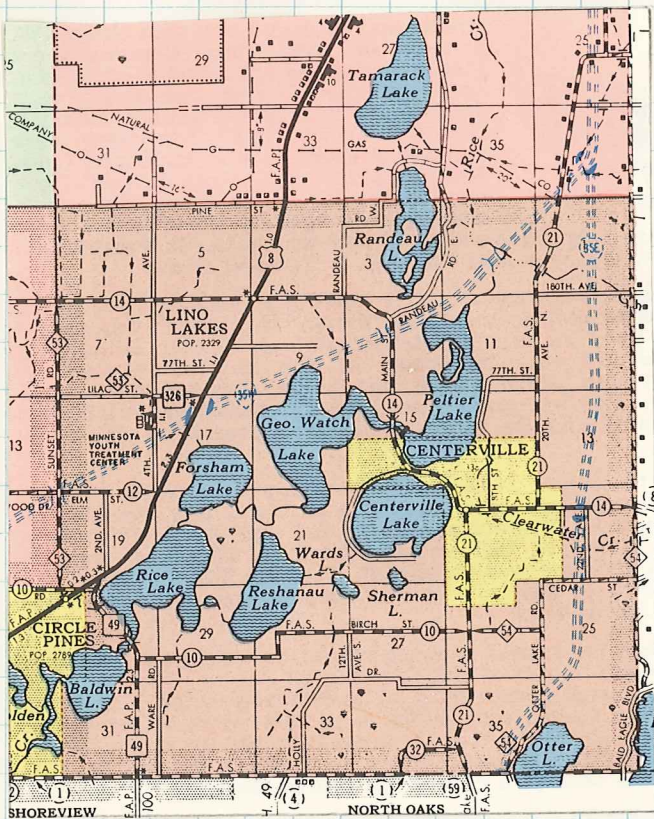

Photo Notes

65-Ditch-22

- ① At Town Line Road Looking North
- ② At Town Line Road Looking South
- ③ At Unused Half Section Road Looking North 12" pipe dry
- ④ At Town Road Between Secs. 5 & 6 Looking East
- ⑤ ditto Looking West
- ⑥ Existing Ditch East Edge Sod Field Looking North
- ⑦ ditto ditto
- ⑧ ditto ditto
- ⑨ Looking South
- ⑩ C.S.A.H. 14 Ditch Looking West
- ⑪ ditto ditto
- ⑫ ditto Looking East
- ⑬ From Single Box under T.H. 8 towards Marsden Lake
- ⑭ ditto upstream
- ⑮ At intersection C.R. 53 & T.H. 326 Looking South
- ⑯ ditto Looking North west
- ⑰ In S.E. 1/4 Sec. 7 looking North
- ⑱ C.S.A.H. 14 at quarter corner Secs. 6 & 7 Looking North
- ⑲ ditto South
- ⑳ ditto East
- ㉑ ditto West
- ㉒ C.S.A.H. 14 north side ditch 1/4 mile east of Sunset water running
- ㉓ Field Ditch running north ditto
- ㉔ Field Ditch North of intersection of C.S.A.H. 14 and Sunset (C.R. 53)

} 18" R.C.P. full & running  
Cover 1.7'

} Cover 1.2'  
24" C.M.P. clear & run

} 12" C.M.P. Clear  
Flowing

} Water  
Flowing  
South



JUNE 1965

1



JUNE 1965

4



JUNE 1965

2



JUNE 1965

5



JUNE 1965

3



JUNE 1965

6



JUNE 1965

7



JUNE 1965

10



JUNE 1965

8



JUNE 1965

11



JUNE 1965

9



JUNE 1965

12



JUNE 1965

13



JUNE 1965

16



JUNE 1965

14



JUNE 1965

17



JUNE 1965

15



JUNE 1965

18



JUNE 1965

19



JUNE 1965

22



JUNE 1965

20



JUNE 1965

23



JUNE 1965

21



JUNE 1965

24