

PUBLIC DRAINAGE DITCH INVENTORY FORM
(Laws of 1990, Chapter 601, Section 27)

*Porter
McClair
Member / H. B. B.*

1. Drainage authority name: Anoka County (Ramsey)
2. Drainage ditch name and number: #3
3. Ditch location and drainage area boundary: (shown on attached quadrangle map)
4. Drainage area in acres: 2106 ; Benefitted area in acres: 720
5. Approximate length in miles: Open Ditch 4.55 Buried Tile 0
6. Year constructed: 1889 ; Original cost: \$ 546.85
7. Are original plans on file? Yes No ; Location: Anoka County Courthouse
8. Date of original plans: 1889
9. Are "as built" plans on file? Yes No ; Location: _____
10. Year(s) improved: None
11. Are improvement plans on file? Yes No N/A ; Location: _____
12. Year(s) repaired: None
13. Are repair plans on file? Yes No N/A ; Location: _____
14. If the ditch was transferred from a county or joint county ditch authority to a watershed district or WMO, is the transfer order on file? Yes No NA
15. Is the list of lands benefitted and damaged on file? Yes No
16. Have the benefits and damages been redetermined? Yes No ; If yes, year(s) of redetermination: _____
17. Has right-of-way been acquired for a 1-rod permanent grassed strip? Yes No ; If yes, has it been maintained? Yes No N/A
18. Is there a maintenance fund for the ditch? Yes No ; If yes, current balance in maintenance fund: \$ _____
19. What was the last year maintenance work was performed by drainage authority:
1977-78

CETA

20. Have other local units or private parties performed maintenance work on the ditch?
Yes _____ No x ; List parties: _____

21. Have the alignment, grade, bottom width, or bridge or culvert crossings been materially changed from the original or improved construction, without going through formal ditch proceedings? Yes _____ No x

22. Is the ditch inspected annually _____; every 2-5 years _____; every 5-10 years; only when a problem arises x ; or never _____? Year of last inspection: 1989

23. Approximate percentage of the ditch's contributing drainage area that is currently urbanized: 50 % ; rural: 50 %

24. Have any substantial areas of wetlands originally totally drained by the ditch reestablished themselves due to lack of ditch maintenance? Yes _____ No x

25. What is the general condition of the ditch?
- a. well-maintained _____
 - b. fairly well-maintained _____
 - c. poorly maintained _____
 - d. very poorly maintained x
 - e. functionally abandoned _____

26. Describe the existing condition of the ditch, including erosion/sedimentation problems:
Pourly maintained water not flowing when viewed.

27. Does the ditch continue to serve a useful purpose to one or more properties? Yes x
No _____; Estimated acres of agricultural land currently benefitting: 0
Does provide for highwater outlet for residential properties.

28. What plans are there for future management of the ditch?
- A. Monitor the ditch for problems that occur, such as deadfalls, unapprove culverts/crossings, or filling, that block or impede the normal flow.
 - B. Review, with municipalities & the WMO's, the impact of new development on the drainage system. C. Monitor & repair/replace drainage structures at county highways crossed by the ditch.

29. Additional comments or recommendations for statutory changes: _____
- A. Need legislation that allows for maintenance of the county ditch system
 - B. Need changes in county ditch legislation that provides for a method (s) of assessing area to pay for approved repairs or improvements.
- _____

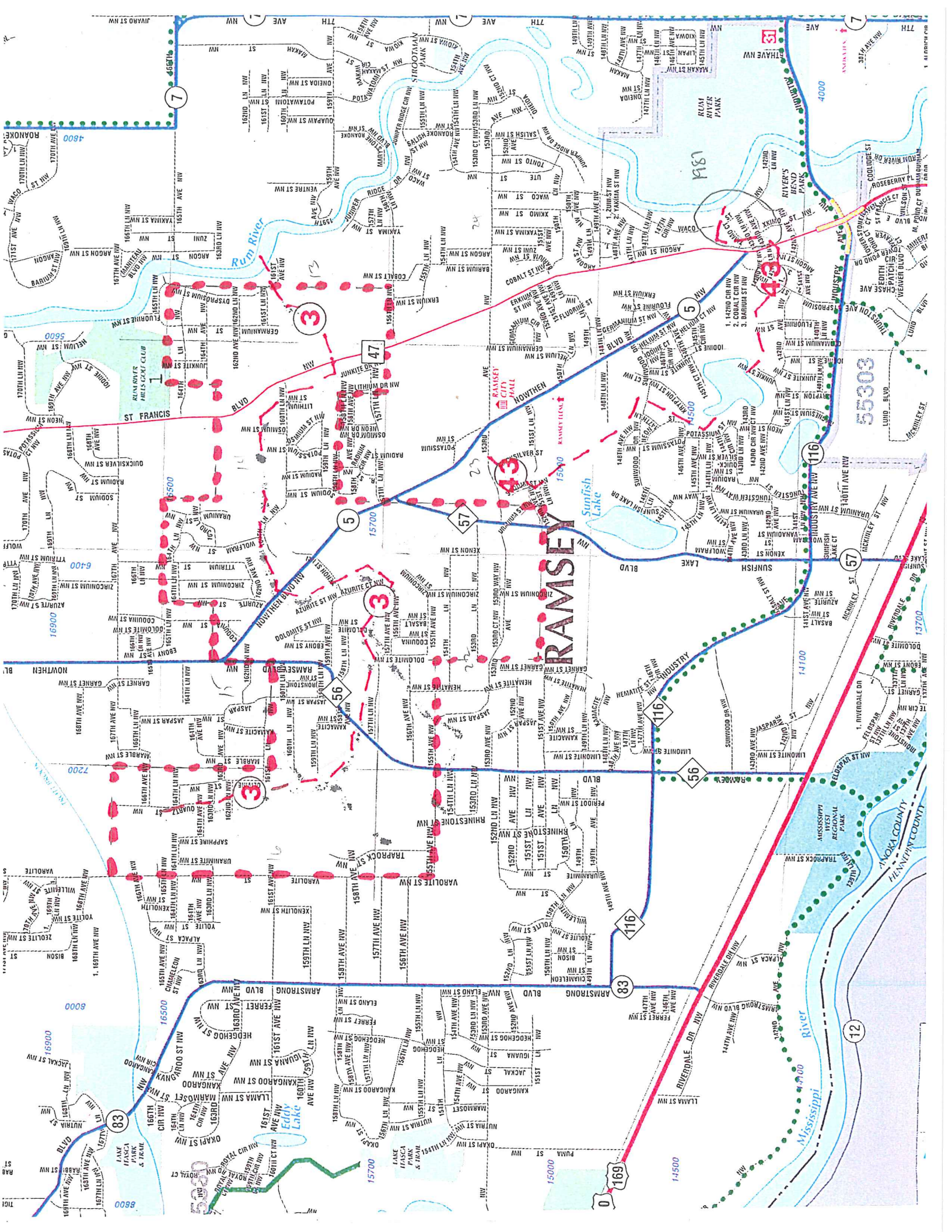

**ABANDONED
EAST OF TH 47
IN 1987**

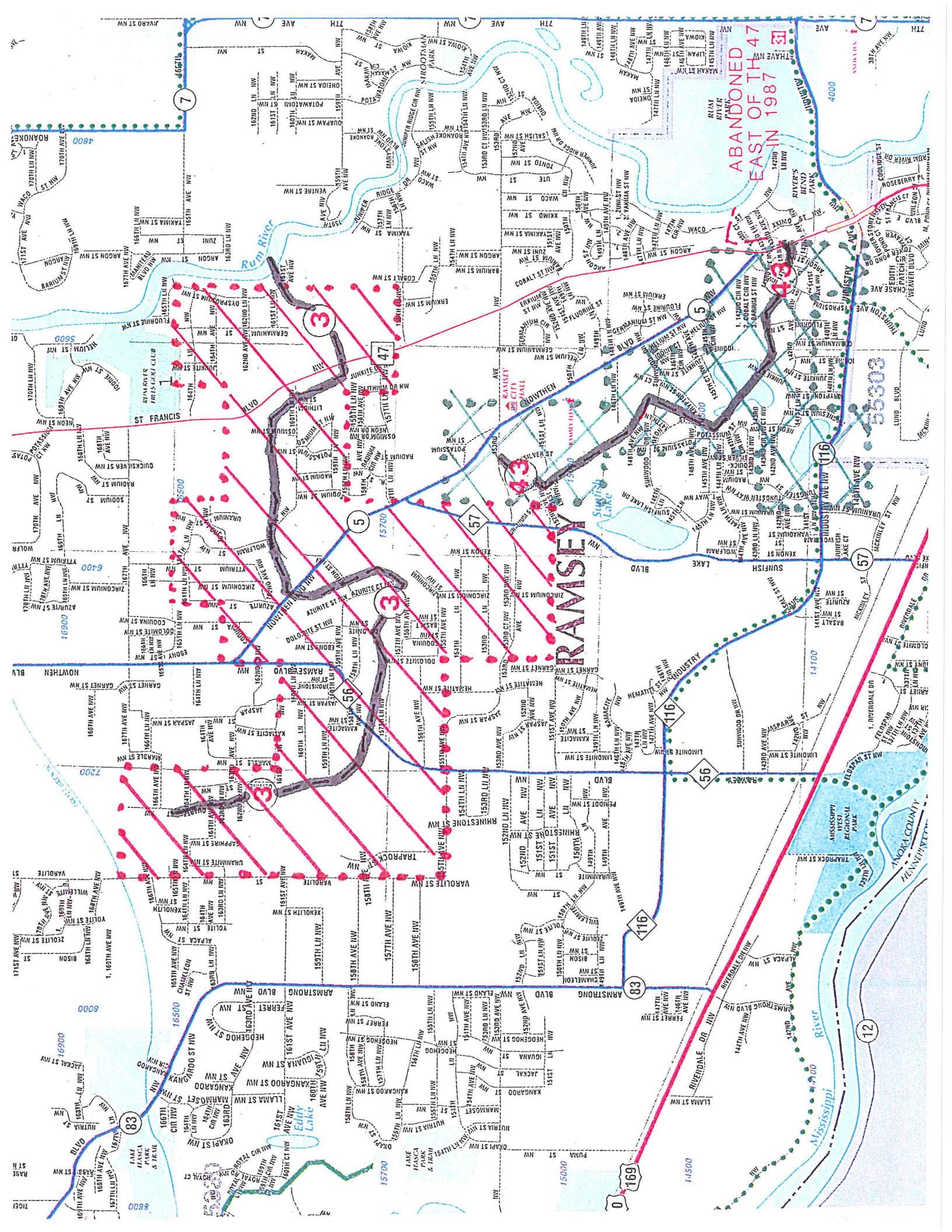

RAMSEY

Map showing street names and road numbers. Major roads include Highway 169, Highway 83, Highway 116, and Highway 47. Local streets include Armstrong Blvd, Sunfish Blvd, and various residential streets. The Rum River and Mississippi River are also shown.