

FED. ROAD DIST. NO.	STATE	FEDERAL PROJ. NO.	FISCAL YEAR	SHEET NO.	TOTAL SHEETS
58	MINN.			3	85

N.B. STA. 492+00
TO
N.B. STA. 529+00

CLASS A EXC. 69,361 C.Y.

5829 C.Y. TOPSOIL
30,104 C.Y. GRANULAR FOR 12" SELECTED GRANULAR MATERIAL AND REPLACE UNSTABLE MATERIAL
33,428 C.Y. REGULAR

EMBANKMENT 51,378 C.Y.

N.B. STA. 529+00
TO
N.B. STA. 536+00

CLASS A EXC. 161,376 C.Y.

6126 C.Y. TOPSOIL
11,138 C.Y. GRANULAR FOR 12" SELECTED GRANULAR MATERIAL
144,112 C.Y. REGULAR

(ADDITIONAL MAT'L. OBTAINED FROM STA. 786+00 = 152,746 C.Y.)

EMBANKMENT 128,589 C.Y.

N.B. STA. 629+00
TO
N.B. STA. 643+63.50

CLASS A EXC. 15,359 C.Y.

1737 C.Y. TOPSOIL
8578 C.Y. GRANULAR FOR 12" SELECTED GRANULAR MATERIAL AND REPLACE UNSTABLE MATERIAL
5044 C.Y. REGULAR

EMBANKMENT 11,378 C.Y.

N.B. STA. 536+00
TO
N.B. STA. 577+57

CLASS A EXC. 84,833 C.Y.

9072 C.Y. TOPSOIL
31,817 C.Y. GRANULAR FOR 12" SELECTED GRANULAR MATERIAL AND REPLACE UNSTABLE MATERIAL
43,944 C.Y. REGULAR

EMBANKMENT 62,843 C.Y.

N.B. STA. 577+57
TO
N.B. STA. 629+00

CLASS A EXC. 255,186 C.Y.

11,390 C.Y. TOPSOIL
76,733 C.Y. GRANULAR FOR SUBGRADE TREATMENT, SWAMP BACKFILL, 12" SELECTED GRANULAR MATERIAL AND REPLACE UNSTABLE MATERIAL
167,063 C.Y. REGULAR

(ADDITIONAL MAT'L. OBTAINED FROM STA. 750+00 TO STA. 786+00 = 191,646 C.Y.)

SWAMP EXCAVATION 26,530 C.Y.
EMBANKMENT 172,870 C.Y.

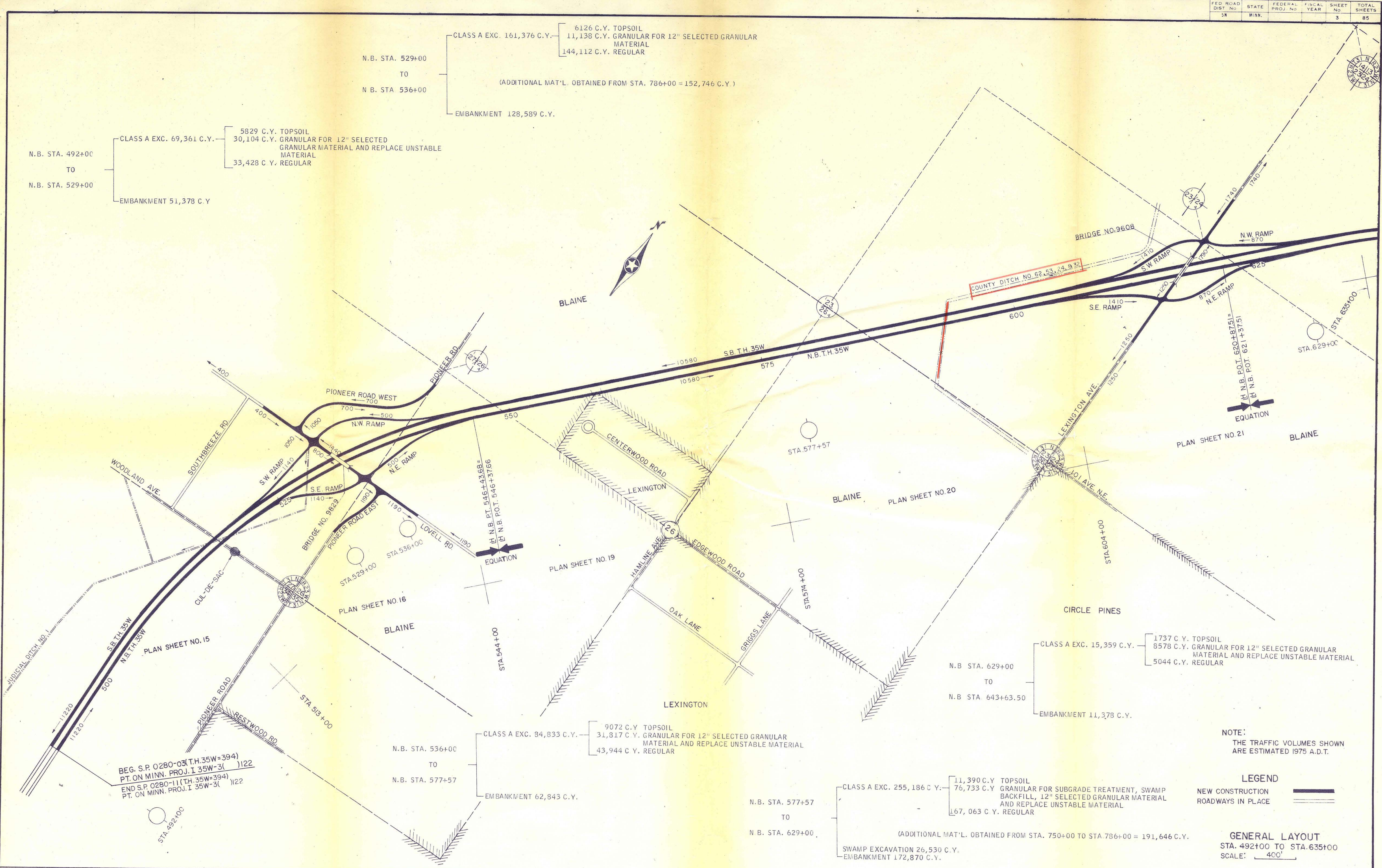

NOTE:
THE TRAFFIC VOLUMES SHOWN
ARE ESTIMATED 1975 A.D.T.

LEGEND
NEW CONSTRUCTION
ROADWAYS IN PLACE

GENERAL LAYOUT
STA. 492+00 TO STA. 635+00
SCALE: 1" = 400'