

# ANOKA COUNTY DEPARTMENT OF HIGHWAYS

## CONSTRUCTION PLANS FOR COON RAPIDS BLVD. BITUMINOUS WIDENING & OVERLAY

PROJECT NO. C.P. 73-39-01  
CITY OF COON RAPIDS  
ANOKA COUNTY, MINNESOTA  
AUGUST, 1973

### SPECIFICATIONS

STATE OF MINNESOTA, DEPARTMENT OF HIGHWAYS "STANDARD SPECIFICATIONS FOR HIGHWAY CONSTRUCTION" DATED JANUARY 1, 1972 SHALL GOVERN.

#### CONVENTIONAL SIGNS

STATE LINE	SPRINGS
COUNTY LINE	MARSH
TOWNSHIP OR RANGE LINE	TIMBER
SECTION LINE	ORCHARD
QUARTER LINE	BRUSH
SIXTEENTH LINE	NURSERY
RIGHT-OF-WAY LINE	CATCH BASIN
PRESENT RIGHT-OF-WAY LINE	MANHOLE
CONTROL OF ACCESS LINE	FIRE HYDRANT
PROPERTY LINE (Except Land Lines)	STREET LIGHT
VACATED PLATTED PROPERTY	RAILROAD CROSSING SIGN
CORPORATE OR CITY LIMITS	RAILROAD CROSSING BELL
TRUNK HIGHWAY CENTER LINE	ELECTRIC WARNING SIGN
RETAINING WALL	CROSSING GATE
RAILROAD	CATTLE GUARD
RAILROAD RIGHT-OF-WAY LINE	OVERPASS (Highway Over)
RIVER OR CREEK	UNDERPASS (Highway Under)
DRY RUN	BRIDGE
DRAINAGE DITCH	BUILDING (One Story Frame)
ELECTRIC POWER LINE	F-FRAME C-CONCRETE
TELEPHONE OR TELEGRAPH LINE	S-STONE T-TILE
JOINT TELEPHONE AND POWER	B-BRICK ST-STUCCO
CONDUIT	IRON PIPE OR ROD
TELEPHONE CABLE-AERIAL	MONUMENT (STONE, CONCRETE, OR METAL)
TELEPHONE CABLE-UNDERGROUND	WOODEN HUB
POWER CABLE-UNDERGROUND	GRAVEL PIT
GAS MAIN	SAND PIT
CULVERT	BORROW PIT
DROP INLET	ROCK QUARRY
GUARD RAIL	MEANDER CORNER
BARBED WIRE FENCE	
WOVEN WIRE FENCE	
CHAIN LINK FENCE	
RAILROAD SNOW FENCE	
STONE WALL OR FENCE	
HEDGE	
WATER PIPE	
SEWER PIPE	
DRAIN TILE	

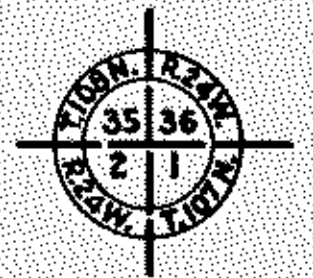
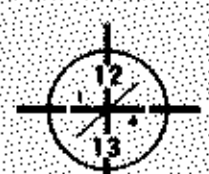

NOTE: SECTION NUMBERS READ FROM THE SOUTH

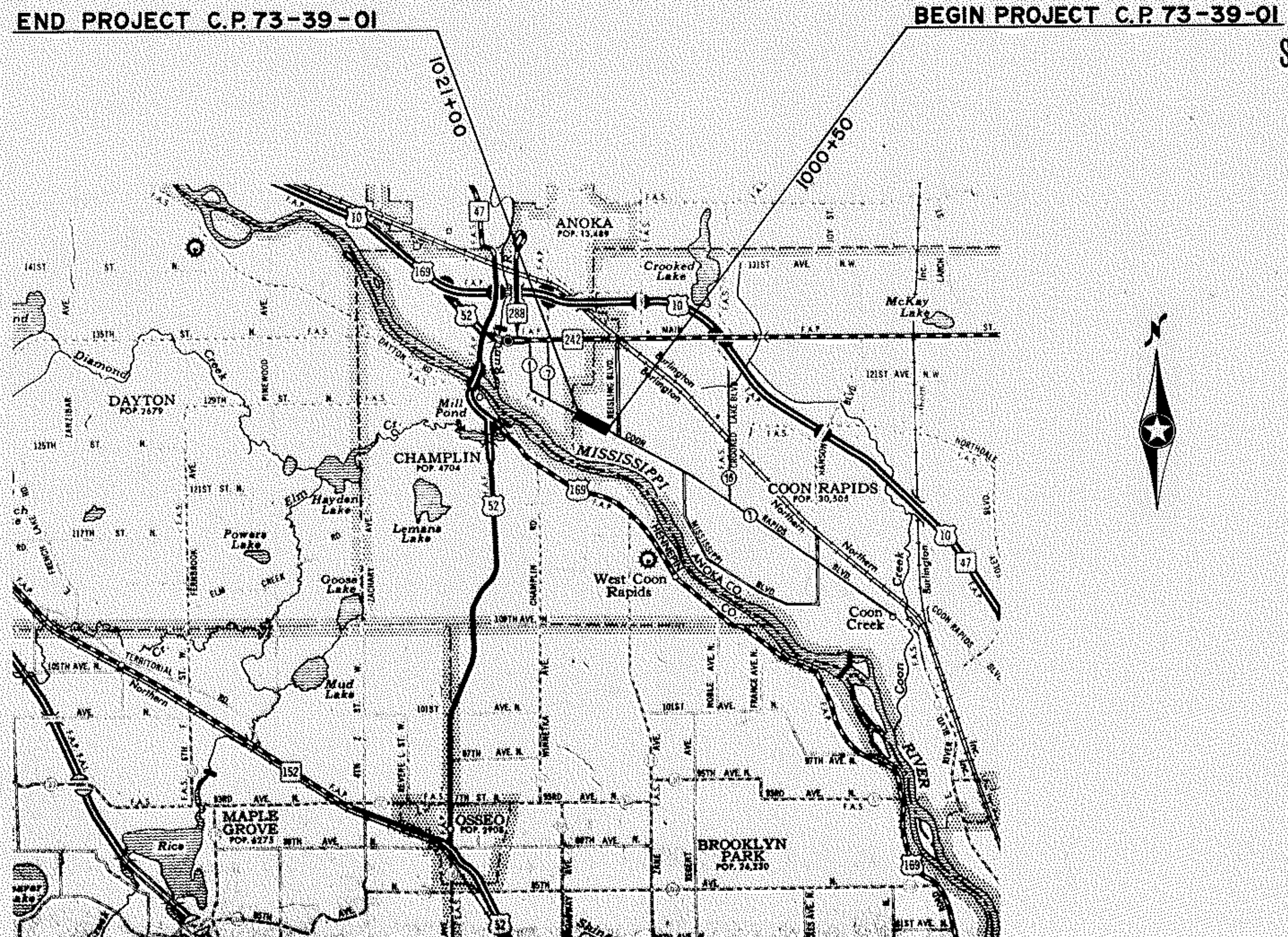

Sheet No.	Description
1	TITLE SHEET
2	EST. QUANTITIES & TABULATIONS
3	TYPICAL SECTIONS
4-5	PLAN & PROFILE
6-12	CROSS-SECTIONS

REVISIONS		
SHEET NO.	REVISED BY	DATE

FROM YUCCA STREET			
TO ANOKA CORP. LIMITS			
GROSS LENGTH	2050.0	FEET	0.39 MILES
BRIDGES LENGTH	0	FEET	MILES
EXCEPTIONS LENGTH	0	FEET	MILES
NET LENGTH	2050.0	FEET	0.39 MILES

DESIGN: 9 TON, A-3 SOIL  
ANTICIPATED A.D.T. 20,000  
H.C.A.D.T. 300-600  
DESIGN SPEED 45 MPH.

I HEREBY CERTIFY THAT THIS PLAN WAS PREPARED BY ME OR UNDER MY DIRECT SUPERVISION AND THAT I AM A DULY REGISTERED PROFESSIONAL ENGINEER UNDER THE LAWS OF THE STATE OF MINNESOTA.  
*E. J. Lundheim*  
DATE: 8/29/73 REG. NO. 9075

Approval: *E. J. Lundheim* COUNTY ENGINEER Date: 8-29-73

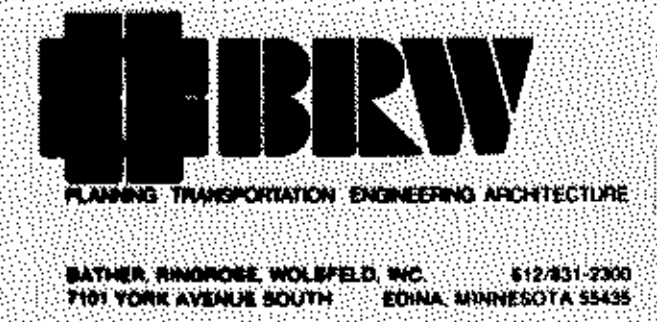







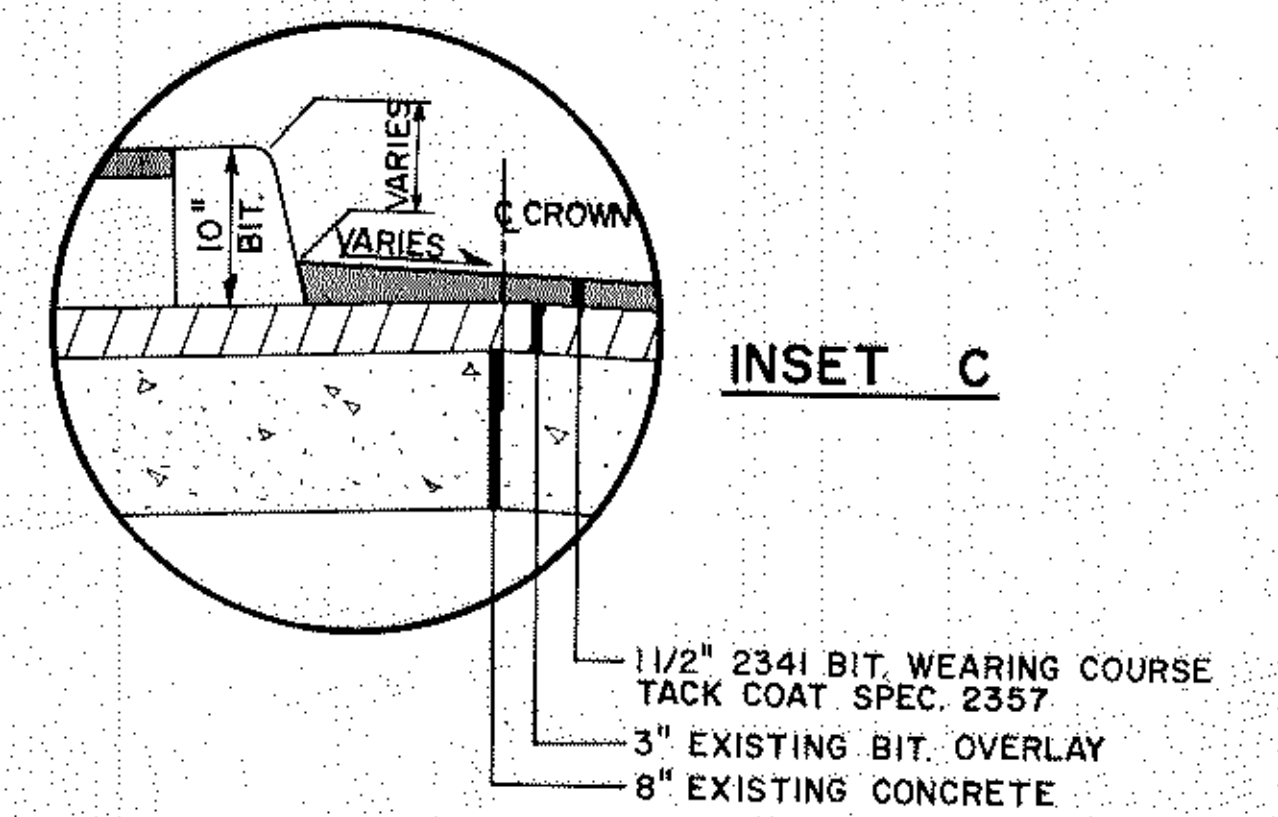
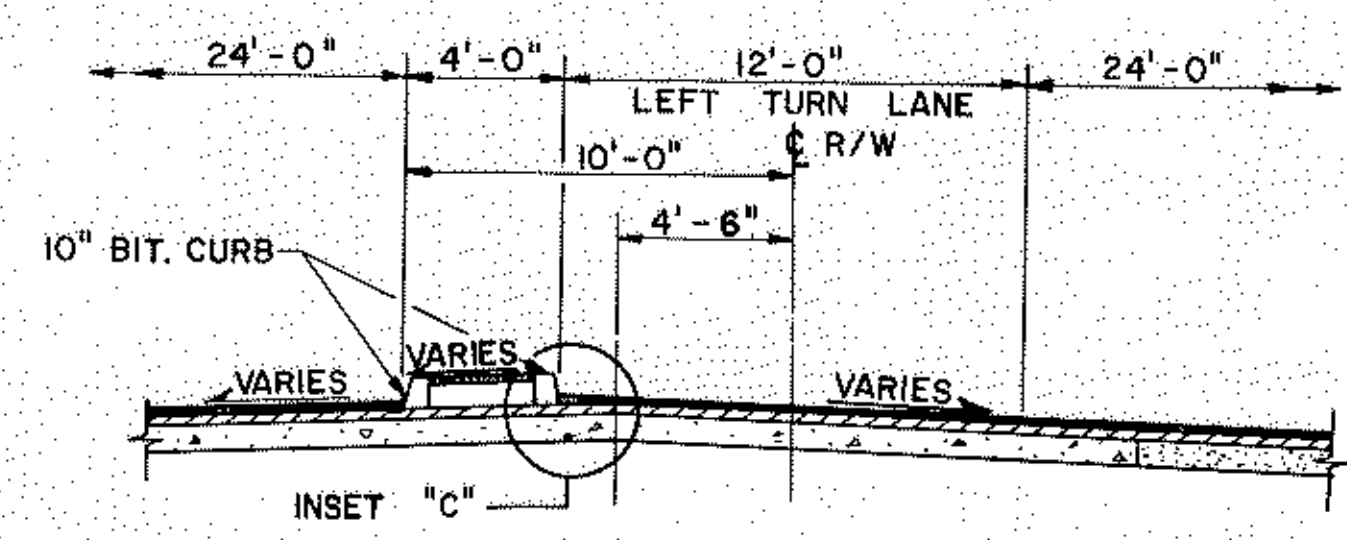
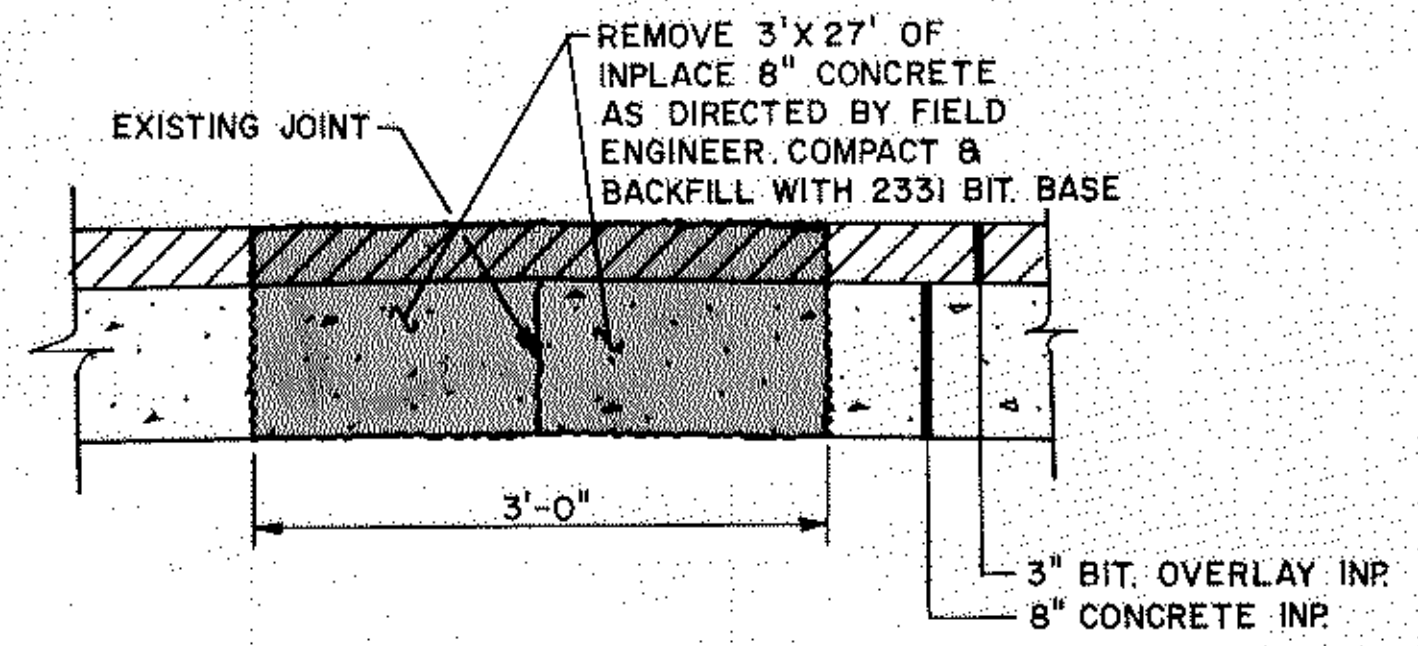
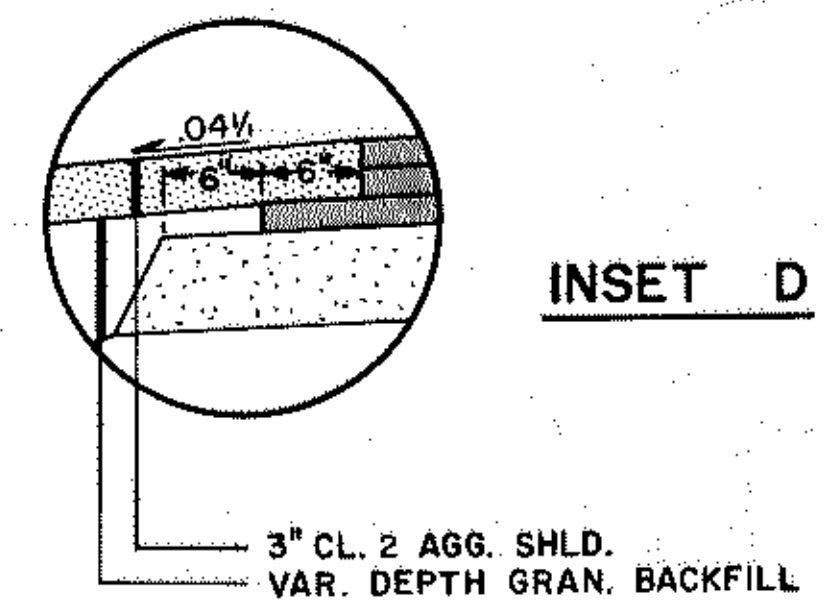
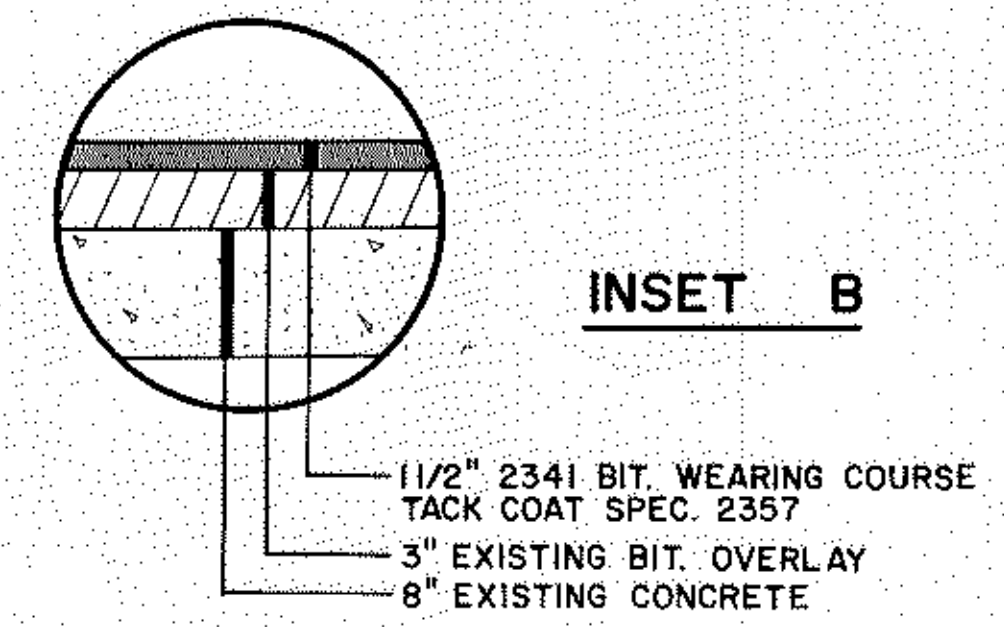
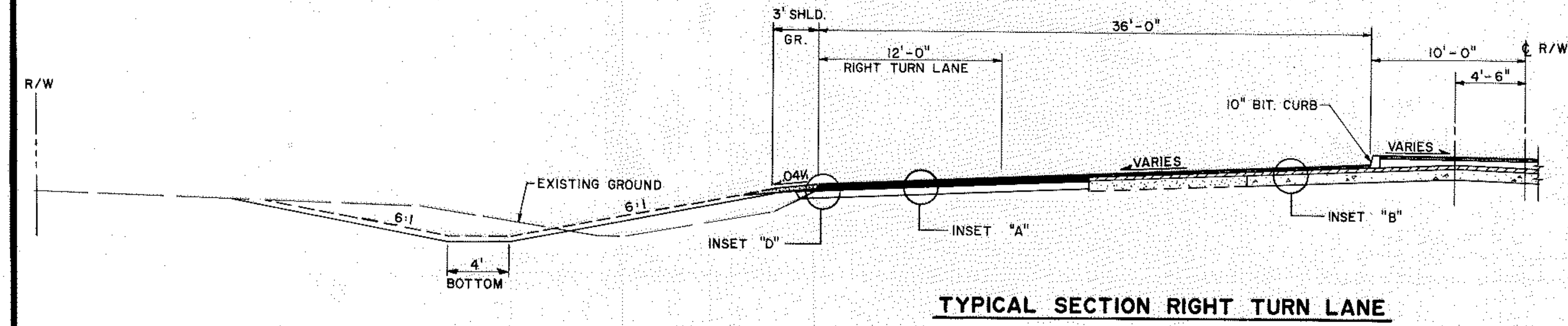
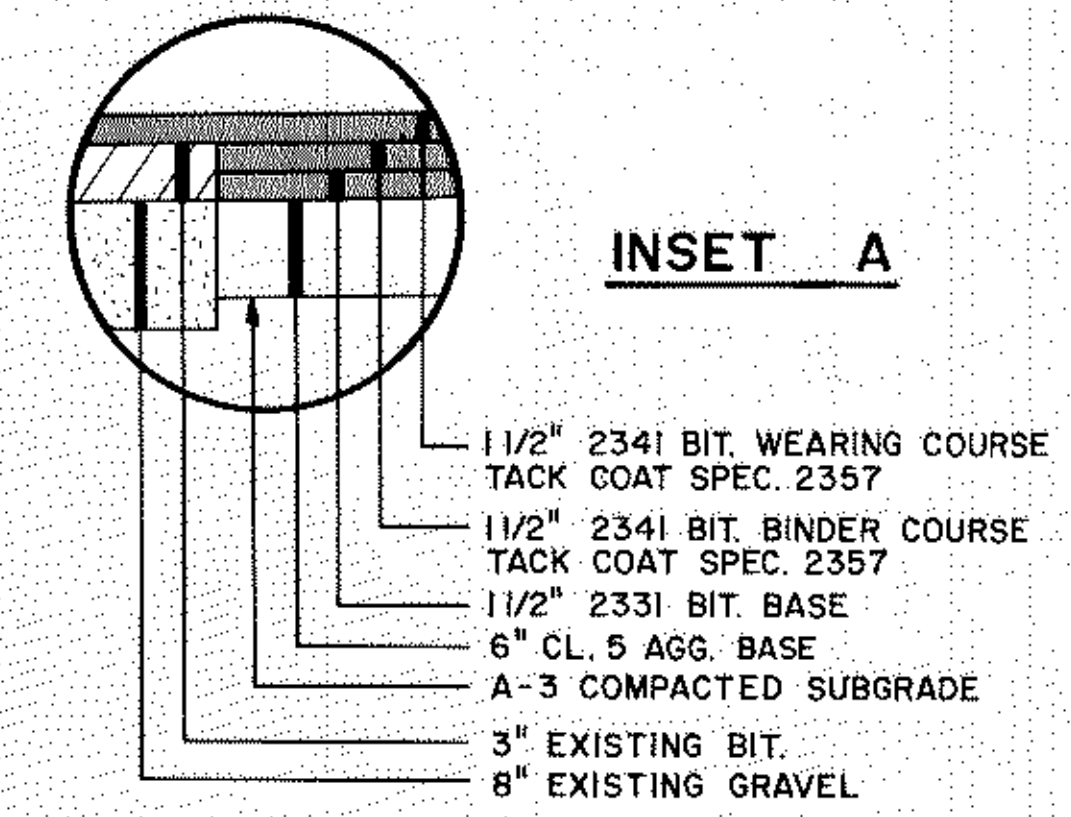
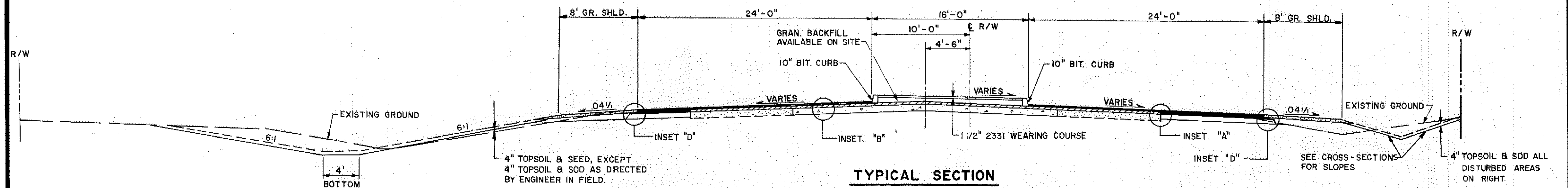

**CONCRETE JOINT REMOVAL DETAIL**

**TYPICAL SECTION LEFT TURN LANE**







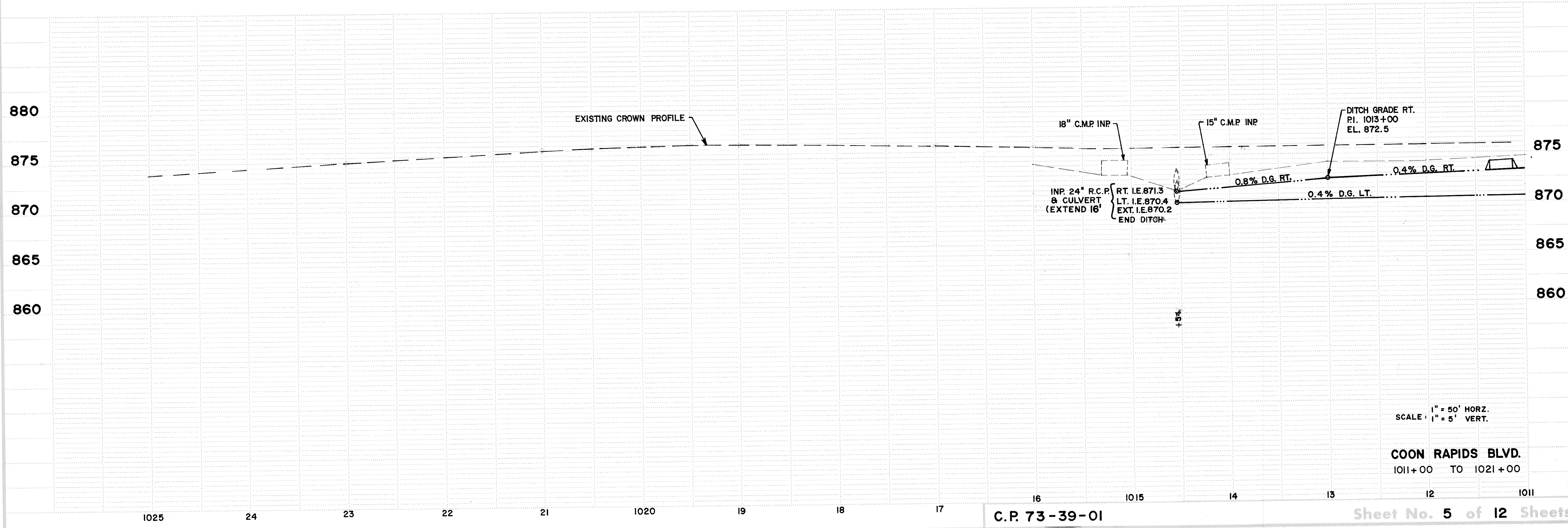
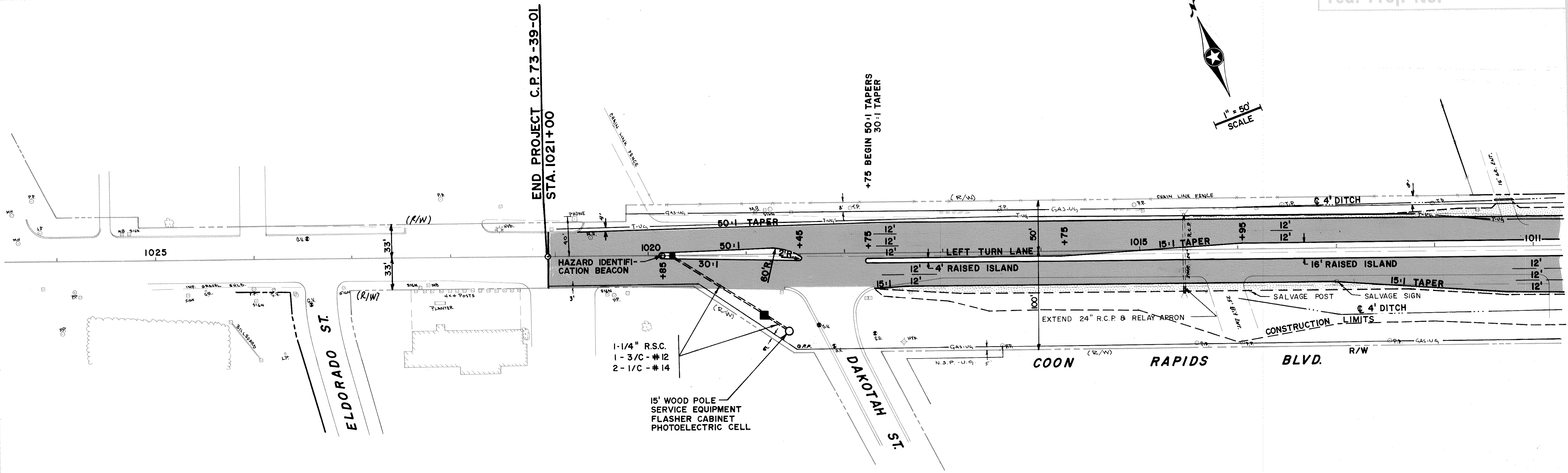
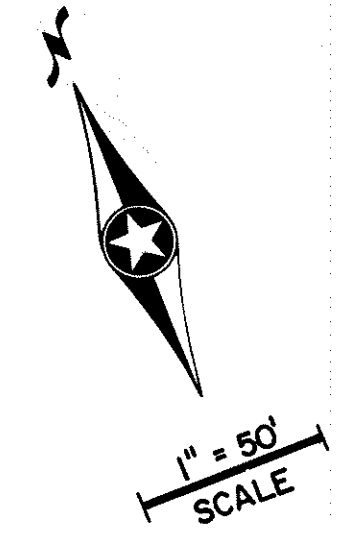

SINGLE PLAN, COTTED  
BY: C. WOODRUFF  
DATE: 10/15/65