

STATE OF MINNESOTA
DEPARTMENT OF HIGHWAYS
Plan and Profile of State Road No. 6
ANOKA COUNTY

From pt. 1320 No. of S. 1/4 Cor. Sec. 6 T. 32 N. R. 23 W. To Jct. T.H. #65-1320 N. S. 1/4 Cor. Sec. 5 T. 32 N. R. 23 W.
(Give proper reference to Section, Township and Range)

GROSS LENGTH- 6300 FEET 1.19 MILES
 LENGTH OF EXCEPTIONS- 0 FEET 0 MILES
 NET LENGTH 6300 FEET 1.19 MILES

PLAN, 1 Inch = 200 Feet
 PROFILE, Horiz. 1 Inch = 200 Feet Vert. 1 Inch = 20 Feet
 WORKING PLANS { Horiz. 1 Inch = 100 Feet
 Vert. 1 Inch = 10 Feet
 Cross-Section, 1 Inch = Feet

LAYOUT
 Scale, 1 Inch = 10560 Feet

CONVENTIONAL SIGNS

STATE LINE	-----
COUNTY LINE	-----
TWP OR RANGE LINE	-----
SECTION LINE	-----
RIGHT OF WAY LINE	-----
CORPORATE OR CITY LIMITS	-----
ROAD CENTER LINE	-----
RETAINING WALL	-----
RAILROADS	-----
CREEK	-----
DRY RUN	-----
DRAINAGE DITCH	-----
POWER POLE LINE	-----
TELEPHONE OR TELEGRAPH LINE	-----
CULVERTS - PLAIN	-----
WITH ENDWALLS	-----
WITH WINGWALLS	-----
DROP INLET	-----
FENCE LINE	-----
GRAVEL PIT	-----
SAND PIT	-----
CLAY PIT	-----
ROCK QUARRY	-----
SPRINGS	-----
MARSH	-----
BRUSH OR TIMBER	-----
HEDGE	-----
ROCK LEDGE	-----
SAND	-----
EDGE OF CUT	-----
TOE OF EMBANKMENT	-----
RAILROAD R/W LINE	-----
BUILDING (One Story Frame)	-----

ABBREVIATIONS

EXCAVATION	EXC.
EARTH	E
LOOSE ROCK	L.R.
SOLID ROCK	S.R.
EMBANKMENT	F
OVERHAUL	H
SURFACING	S
HAND DITCHING	H.D.
SPECIAL EXCAVATION	S.E.
SPECIAL PLOWING	S.P.
GUARD RAIL	G.R.
CORRUGATED METAL CULVERT	C.M. CULV.
SECTIONAL CONCRETE CULVERT	R. CULV.
SECTIONAL CONCRETE CULVERT (heavy type)	R. CULV.
TON MILES	T.M.
TELEPHONE POLE	TEL. P.
POWER POLE	P.P.
PLACE	P.
IN PLACE	INP.
REPLACE	REP.
RIGHT	RT.
LEFT	LT.
INTERSECTION ANGLE	I.A.
RADIUS	R.
TANGENT	T.
LENGTH OF CURVE	L.C.
POINT OF CURVE	P.C.
POINT OF TANGENT	P.T.
POINT OF INTERSECTION	P.I.
VERTICAL CURVE	V.C.
BENCH MARK	B.M.
ELEVATION	EL.
ACRES	A.

NOTE: SECTION NUMBERS READ FROM THE SOUTH

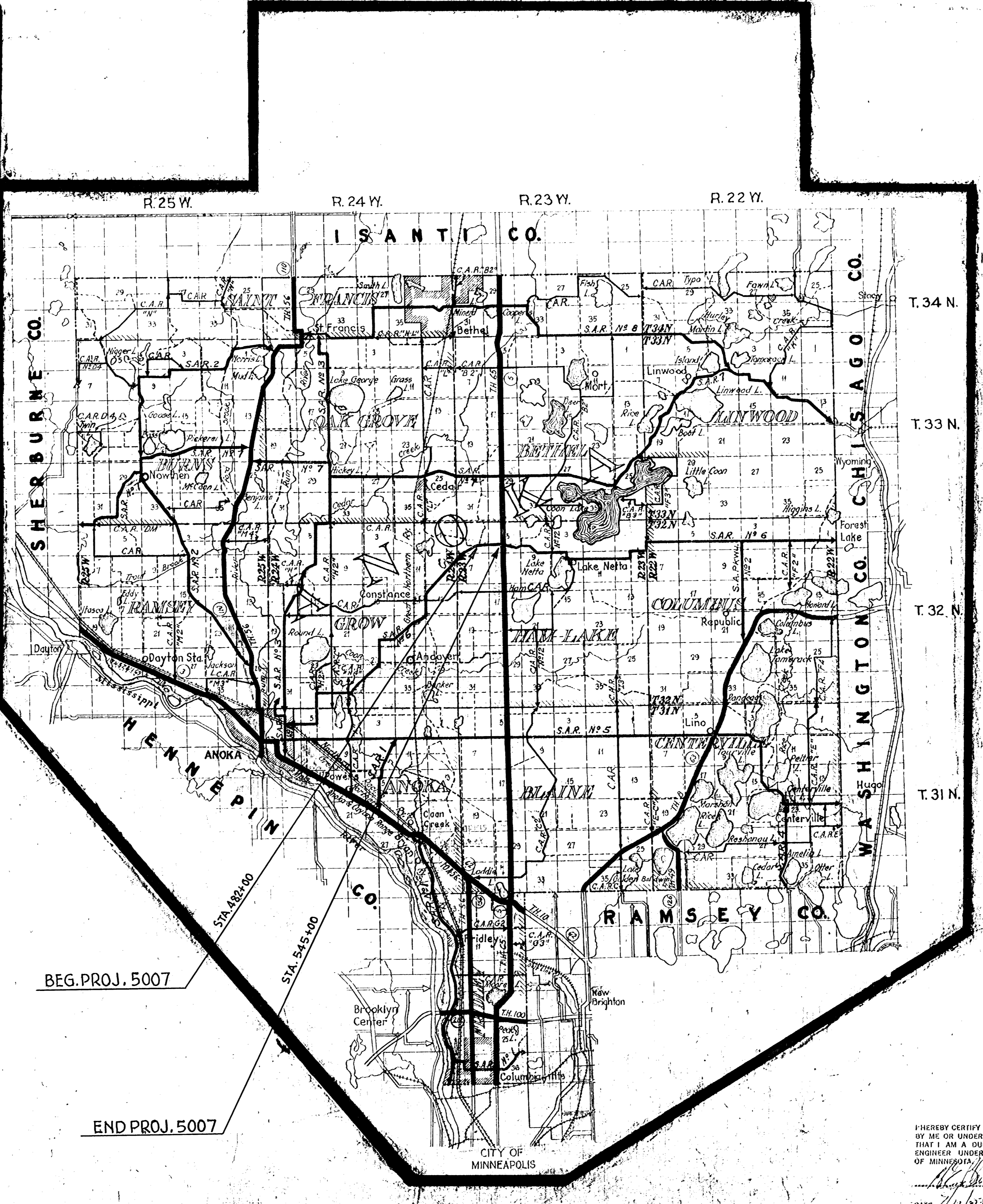

INDEX OF SHEETS

Sheet No. 1. Title Sheet and Layout Map
 " No. 2. Typical Cross-Sections and Statement
 " No. 3. Plan and Profile Sta. to Sta.
 " No. 4.

NOTE: THE SPECIFICATIONS FOR HIGHWAY CONSTRUCTION DATED JULY 1, 1947 AND SUBMITTED FOR APPROVAL BY THE DIVISION ENGINEER OF THE PUBLIC ROADS ADMINISTRATION OCT. 15, 1947 SHALL GOVERN.

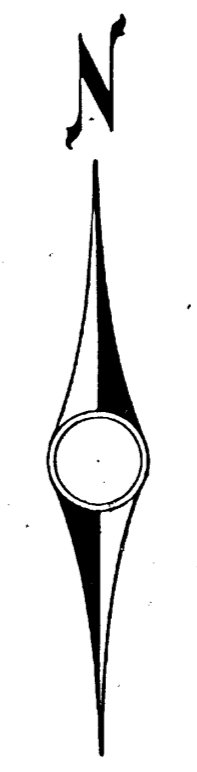

Planned By *H. E. Blund*
 HIGHWAY ENGINEER FOR ANOKA COUNTY.
 Recommended for Approval *H. E. Blund*
 DISTRICT ENGINEER
 Recommended for Approval *J. M. Brown* 7/1/50
 ENGINEER OF SURVEYS AND DESIGN
 County Division
 Approved 7/1/50 *W. J. Peterson*
 ENGINEER OF PLANS AND SURVEYS

I HEREBY CERTIFY THAT THIS PLAN WAS PREPARED BY ME OR UNDER MY DIRECT SUPERVISION AND THAT I AM A DULY REGISTERED PROFESSIONAL ENGINEER UNDER THE LAWS OF THE STATE OF MINNESOTA.
W. J. Peterson
 DATE 7/1/50 REG. NO. 593

S.A.P. 02-507-01

STATEMENT OF ESTIMATED QUANTITIES

SPECIFICATION REFERENCE NUMBER	ITEM	UNIT	TOTAL ESTIMATED QUANTITIES
2321.501	BITUMINOUS MATERIAL FOR PRIME COAT	GAL.	14612
2321.503	BITUMINOUS MATERIAL FOR MIXTURE	GAL.	317294
2321.506	AGGREGATE	TON	31183
2321.512	BITUMINOUS SURFACE	SQ.YD	15372
2123.503	MOTOR GRADER	HR	11
2123.504	PNEUMATIC-TIRED ROLLER	HR	16

**TYPICAL SECTION
BITUMINOUS SURFACING**

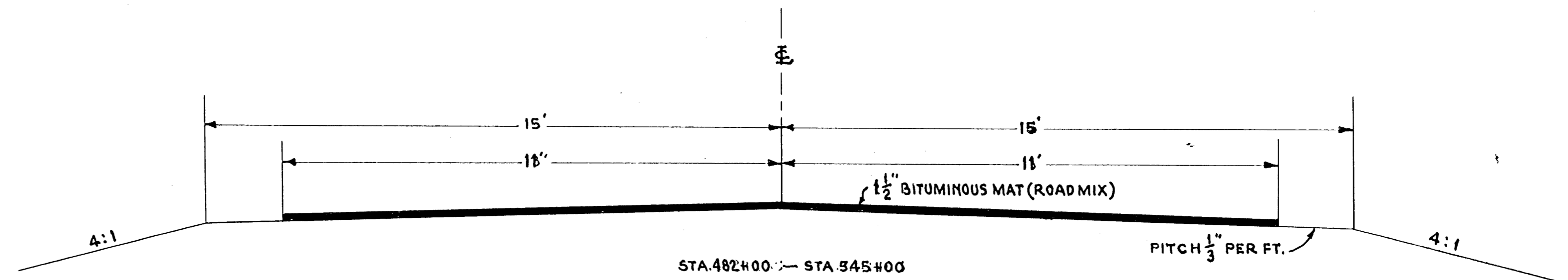

BASIS FOR COMPUTATION OF QUANTITIES

- BITUMINOUS MATERIAL FOR PRIME COAT 0.3 GAL. PER SQ. YD
- BITUMINOUS MATERIAL FOR MIXTURE 1.125 GAL. PER SQ. YD
- AGGREGATE 150 L.B. PER SQ. YD
- MOTOR GRADER 10 HOUR PER MILE
- PNEUMATIC-TIRED ROLLER 5 HOUR PER MILE
- BITUMINOUS MATERIAL FOR MIXTURE - MC 2 OR 3
- BITUMINOUS MATERIAL FOR PRIME COAT - MC 0 OR 1