

CONVENTIONAL SIGNS

STATE LINE	----
COUNTY LINE	----
TOWNSHIP OR RANGE LINE	----
SECTION LINE	----
QUARTER LINE	----
SIXTEENTH LINE	----
RIGHT OF WAY LINE	----
PRESENT RIGHT OF WAY LINE	----
CONTROL OF ACCESS LINE	----
PROPERTY LINE (Except Land Lines)	----
VACATED PLATTED PROPERTY	----
CORPORATE OR CITY LIMITS	----
TRUNK HIGHWAY CENTER LINE	----
RETAINING WALL	----
RAILROAD	----
RAILROAD RIGHT OF WAY LINE	----
RIVER OR CREEK	----
DRY RUN	----
DRAINAGE DITCH	----
ELECTRIC POWER LINE	----
TELEPHONE OR TELEGRAPH LINE	----
JOINT TELEPHONE AND POWER	----
CONDUIT	----
TELEPHONE CABLE - AERIAL	----
TELEPHONE CABLE - UNDERGROUND	----
POWER CABLE - UNDERGROUND	----
GAS MAIN	----
SEWER	----
DROP-INLET	----
RAILROAD CROSSING SIGN	----
RAILROAD CROSSING BELL	----
ELECTRIC WARNING SIGN	----
CROSSING GATE	----
CATTLE GUARD	----
OVERPASS (Highway Over)	----
UNDERPASS (Highway Under)	----
BRIDGE	----
BUILDING (One Story Frame)	----
F FRAME C-CONCRETE	----
S STONE T-TILE	----
B BRICK ST-STUCCO	----
IRON PIPE OR ROD	----
MONUMENT (STONE, CONCRETE, OR METAL)	----
WOODEN HUB	----
GRAVEL PIT	----
SAND PIT	----
BORROW PIT	----
ROCK QUARRY	----
MEANDER CORNER	----

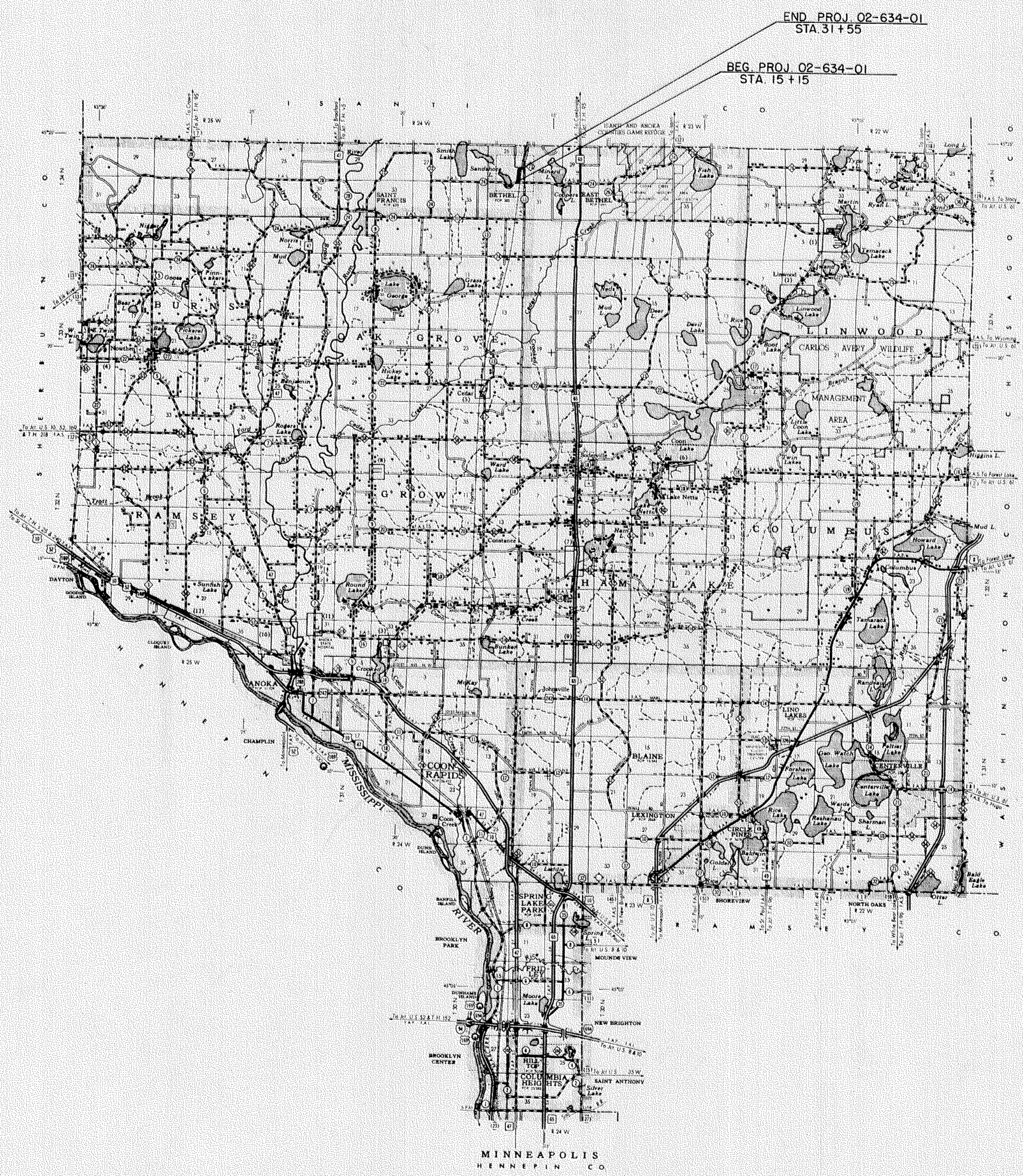
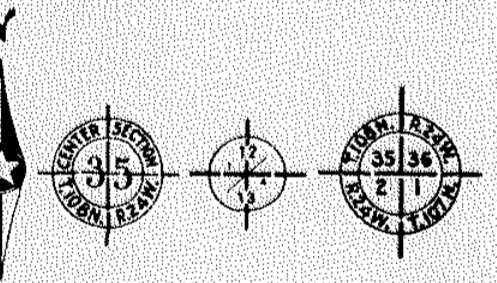

Fed. Proj. No. _____

STATE OF MINNESOTA
DEPARTMENT OF HIGHWAYS

CONSTRUCTION PLAN FOR STORM SEWER, GRADING, BASE & BIT SURFACING

County State Aid Highway No. 34

Between CS.A.H. 24 And MAIN ST.

From 1000' W OF SE. COR. SEC. 25-T 34-R 24 IN THE VILLAGE OF BETHEL To A PT. 1660 N. AND 735 W. OF S.E. COR. SEC. 25-T34-R24 IN THE VILLAGE OF BETHEL

GROSS LENGTH 1,640 FEET .31 MILES
 BRIDGES LENGTH _____ FEET _____ MILES
 EXCEPTIONS LENGTH _____ FEET _____ MILES
 NET LENGTH 1,640 FEET .31 MILES

INDEX OF SHEETS

Sheet No. 1 Title Sheet & Layout Map
 No. 2 Est. Quantities & Typical Sec.
 No. 3 To 4 Plan & Profile & Storm Sewer
 No. 5 To 6 Cross Sections

SCALE: PLAN 1"=50'
 PROFILE HORIZ. 1"=50'
 VERT. 1"=5'
 CROSS-SECTION 1"=10'

DESIGN DESIGNATION

ADT (CURRENT YEAR) 317
 ADT (FUTURE YEAR) 729
 T (HEAVY COMMERCIAL) HCADT LESS THAN 150
9 Ton Design SOIL FACTOR = 50 %
 Design Speed LOCALLY RESTRICTED
 Design Speed not achieved at:
 STA _____ TO STA _____ MPH
 STA _____ TO STA _____ MPH

SPECIFICATIONS

THE "STANDARD SPECIFICATIONS FOR HIGHWAY CONSTRUCTION", DATED JAN. 1, 1972, SHALL GOVERN.

ALL APPLICABLE FEDERAL, STATE AND LOCAL LAWS AND ORDINANCES WILL BE COMPLIED WITH, IN THE CONSTRUCTION OF THIS PROJECT.

I HEREBY CERTIFY THAT THIS PLAN WAS PREPARED BY ME OR UNDER MY DIRECT SUPERVISION AND THAT I AM A DULY REGISTERED PROFESSIONAL ENGINEER UNDER THE LAWS OF THE STATE OF MINNESOTA.

E. J. Lundheim COUNTY ENGINEER DATE 1-19-72

ANOKA COUNTY REG. NO. 2551

RECOMMENDED FOR APPROVAL C. E. Weichel DISTRICT ENGINEER 1-22, 1972

RECOMMENDED FOR APPROVAL D. J. Brandy 2-7, 1972

APPROVED 2/9 19 72 Michael M. Sog STATE AID ENGINEER

Minn. Proj. No. _____ County Proj. No. _____
 State Proj. No. _____ S. A. P. 02-634-01

Anoka County, Minnesota. Plan No. _____ Sheet 1 of 6 Sheets

STATEMENT OF ESTIMATED QUANTITIES			
ITEM NO.	ITEM	UNIT	TOTAL ESTIMATED QUANTITIES
2104.501	REMOVE CULVERT PIPE	LIN. FT.	64
2104.503	REMOVE SIDEWALK	SQ. FT.	560
2104.509	REMOVE CATCH BASIN (DRY WELL)	EACH	2
2105.501	COMMON EXCAVATION EV.	CU. YD.	1245
2105.525	TOPSOIL BORROW LV	CU. YD.	307
2105.531	SALVAGED BITUMINOUS MIXTURE	CU. YD.	313
2130.501	WATER	M-GAL.	100
2207.503	BITUMINOUS MATERIAL FOR MIXTURE	GAL.	25612
2207.512	BIT. STABL. SUBGRADE (6" THICK)	SQ. YD.	8262
2211.501	AGGREGATE BAS CLASS-5	TON	57
2341.504	BITUMINOUS MATERIAL FOR MIXTURE	TON	68.10
2341.508	WEARING COURSE MIXTURE	TON	794
2341.510	BINDER COURSE MIXTURE	TON	444
2357.502	BIT. MATERIAL FOR TACK COAT	GAL.	817
2451.507	GRANULAR BEDDING CV	CU. YD.	49.30
2501.501	CULVERT EXCAVATION CLASS U	CU. YD.	40
2501.511	36" RC PIPE CULVERT CLASS 2	LIN. FT.	48
2501.515	12" RC PIPE APRONS	EACH	2
2501.515	24" RC PIPE APRONS	EACH	2
2501.515	36" RC PIPE APRONS	EACH	2
2503.511	12" RC PIPE SEWER CLASS 2	LIN. FT.	142
2503.511	18" RC PIPE SEWER CLASS 2	LIN. FT.	950
2503.511	24" RC PIPE SEWER CLASS 2	LIN. FT.	76
2506.507	CONSTR. CATCH BASINS (DESIGN A OR F)	LIN. FT.	9.30
2506.507	CONSTR. CATCH BASINS (DESIGN C OR G)	LIN. FT.	23.80
2506.516	CASTING ASSEMBLIES	EACH	9
2521.501	4" CONCRETE WALK	SQ. FT.	60
2575.505	SODDING	SQ. YD.	2791

TYPICAL GRADING, BASE & SURFACING SECTIONS

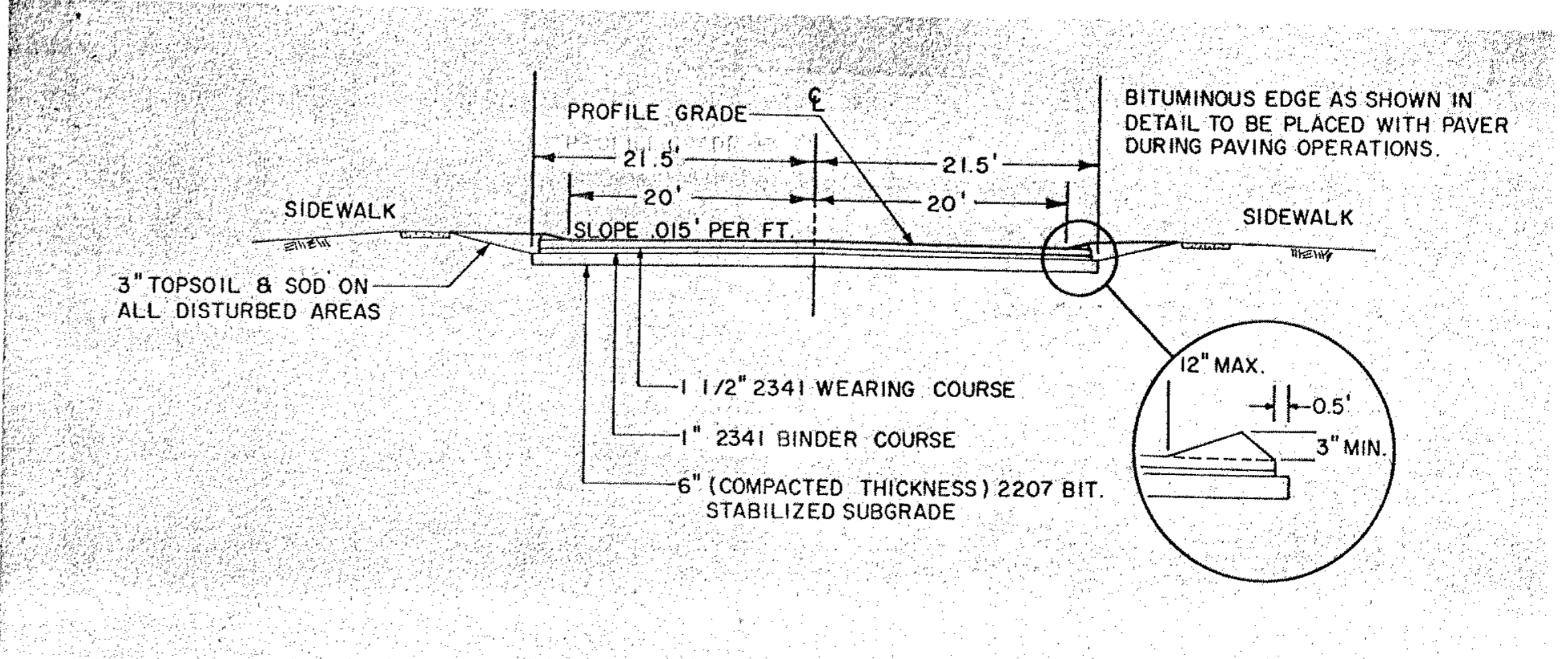
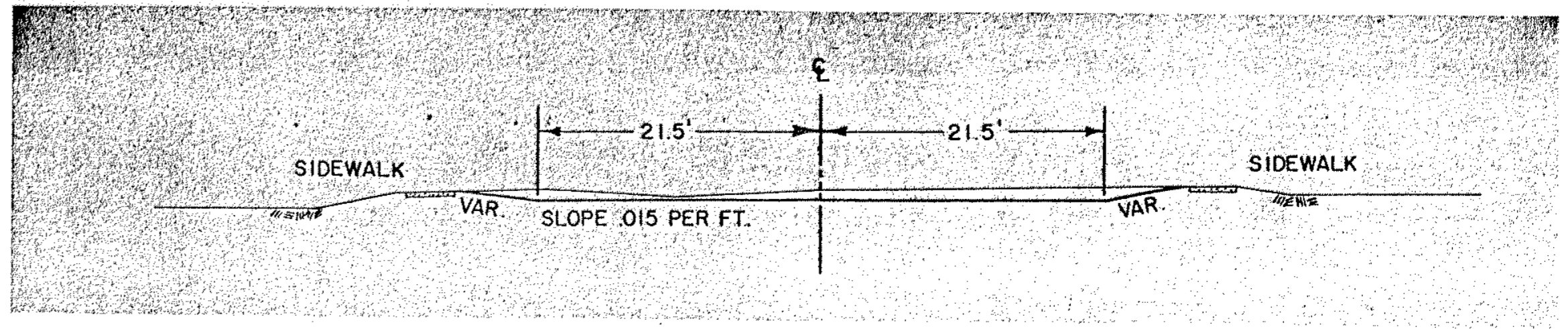

FORM 21166-10-58

The following Standard Detail plates, approved by the Bureau of Public Roads, shall apply on this project.

STANDARD DETAIL PLATES	
PLATE NO.	DESCRIPTION
3000F	REINFORCED CONCRETE PIPE
3006A	GASKET JOINT FOR R. C. PIPE
3100F	CONC. APRON FOR REINFORCED CONCRETE PIPE
4000G-4005H	MANHOLE OR CATCH BASIN
4002D-4006H	MANHOLE OR CATCH BASIN
4126D	CATCH BASIN FRAME CASTING
4149C	GRATE CASTING FOR CATCH BASIN
4161E	CURB BOX CASTING FOR CATCH BASIN
8000C	STANDARD BARRICADES
8008D	CONTRACTORS SIGN
0001A	SPECIFICATION REFERENCE TO STANDARD PLATES

BASIS OF PLANNED QUANTITIES

2207	BITUMINOUS STABILIZED SUBGRADE BITUMINOUS MATERIAL FOR MIX. 0.5 GAL. PER SQ. YD. PER INCH THICKNESS BITUMINOUS MATERIAL FOR FOG 0.10 GAL. PER SQ. YD.
2341	PLANT MIXED BITUMINOUS WEARING COURSE BITUMINOUS MIXTURE 165 LBS. PER SQ. YD. BITUMINOUS MATERIAL 6.5% OF MIXTURE BY WT.
2341	PLANT MIXED BITUMINOUS BINDER COURSE BITUMINOUS MIXTURE 110 LBS. PER SQ. YD. BITUMINOUS MATERIAL 5.0% OF MIXTURE BY WT.
2357	BITUMINOUS MATERIAL FOR TACK COAT 0.05 GAL. PER SQ. YD.

NOTE: BITUMINOUS ITEMS INCLUDE QUANTITIES FOR ALL STREET APPROACHES, DRIVEWAYS AND BITUMINOUS EDGE



BM # 6 ELEV. 927.02
SPIKE IN PP LT. 35
STA. 15+45

SCHOOL

BEGIN PROJECT 02-634-01
STA. 15+15

BIT LOT

SNOW FENCE

CONSTRUCT BIT LIP
SEE DETAIL ON SHEET 2

POT
23+00

WYATT ST.

CSA# #24 ϕ PIPE
INP. 24" x 64' RC PIPE
REMOVE
F&I 36" x 48' RC PIPE CL. 2
F&I 2-36" RC APRONS

STA. 18+46 SIDEWALK RT.
REMOVE 60 SQ. FT.

STA. 24+57 SIDEWALK RT.
REMOVE 108 SQ. FT.

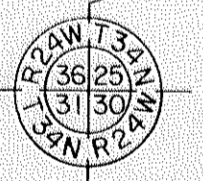

BM # 5 ELEV. 930.64
SPIKE IN PP RT. 27
STA. 22+70

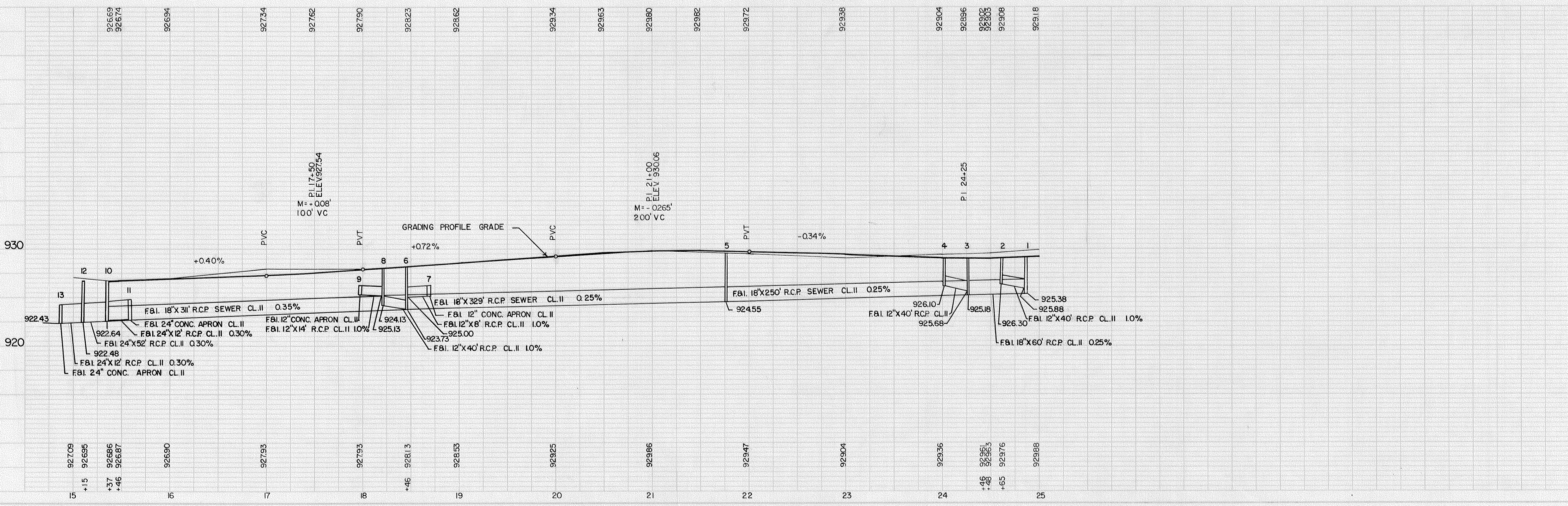

PLAN
CHECKED: []
DATE: []
NO. []

PROFILE
CHECKED: []
DATE: []
NO. []

PLAN
 SUPERVISOR
 CHECKED
 DATE
 NOTE BOOK
 P. OF NO. SHEETS

PROFILE
 SUPERVISOR
 CHECKED
 DATE
 NOTE BOOK
 P. OF NO. SHEETS

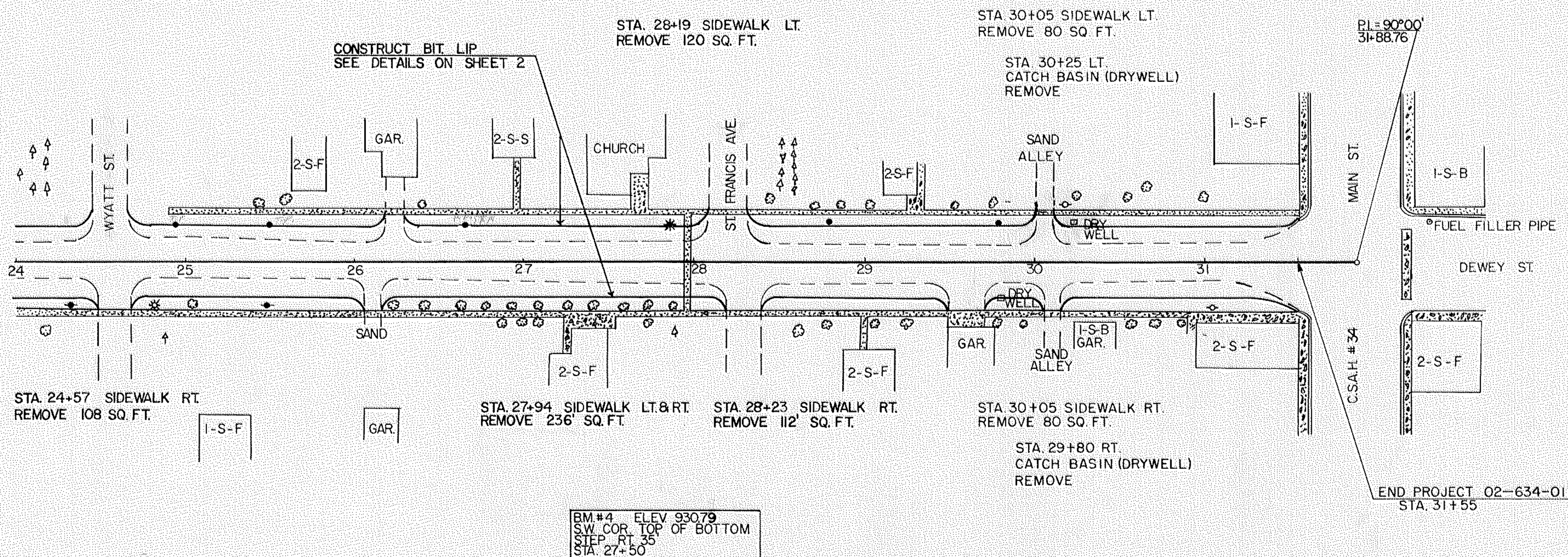
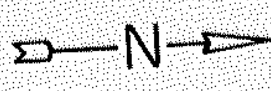

COMMON EXCAVATION 1245 CU. YDS.
 SALVAGE BITUMINOUS MATERIAL 313 CU. YDS.
 EMBANKMENT 793 CU. YDS.

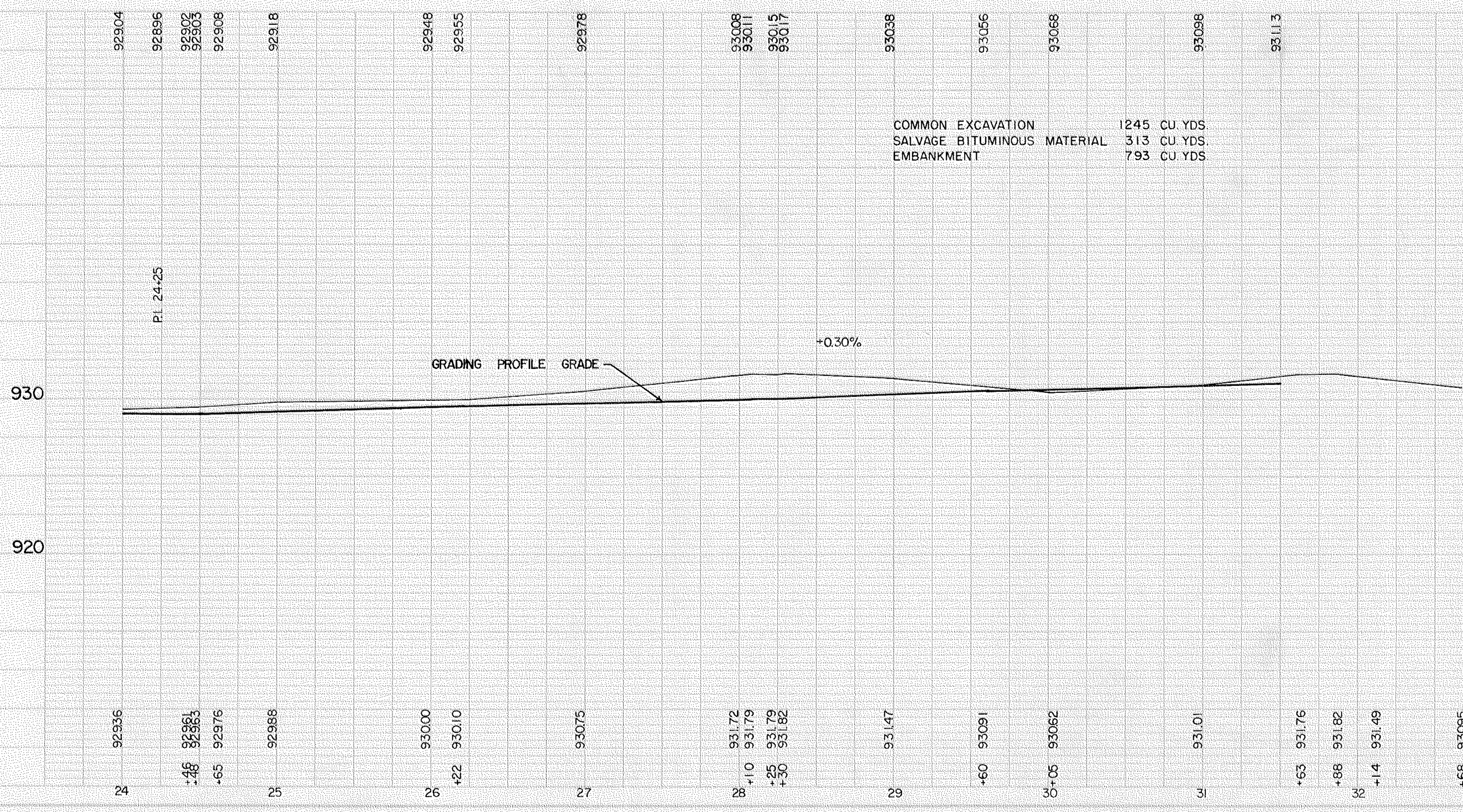

NO	STATION	LOCATION	TYPE	DESIGN	LIN. FT.	TOP CASTING	OUTLET	CAST ASSEMBLY	DRAIN TO	12"	18"	24"
1	24+85	18.9' LT	C.B.	C.O.R.G.	36	928.94	925.38	A	C.B. 3			
2	24+85	18.9' RT	C.B.	C.O.R.G.	26	928.94	926.30	A	C.B. 1	40'		
3	24+25	18.9' LT	C.B.	C.O.R.G.	35	928.72	925.18	A	C.B. 5		250'	
4	24+25	18.9' RT	C.B.	C.O.R.G.	26	928.72	926.10	A	C.B. 3	40'		
5	21+25	18.9' LT	C.B.	A.O.R.F.	50	929.59	924.55	A	C.B. 6		329'	
6	18+46	18.9' LT	C.B.	A.O.R.F.	43	928.03	923.73	A	C.B. 10		311'	
7	18+46	34.0' LT		12" R.C.P. APRON			925.14		C.B. 6			
8	18+46	18.9' RT	C.B.	C.O.R.G.	39	928.03	924.13	A	C.B. 6	8'		
9	18+46	40.0' RT		12" R.C.P. APRON			925.13		C.B. 8	14'		
10	15+35	25.9' LT	C.B.	C.O.R.G.	37	926.38	922.64	A	C.B. 12			52'
11	15+35	45.0' LT		24" R.C.P. APRON			922.69		C.B. 10			
12	15+35	25.9' RT	C.B.	C.O.R.G.	39	926.38	922.48	A	OUTLET 13			12'
13	15+35	45.0' RT		24" R.C.P. APRON			922.43					

KEY	GRATE	FRAME	CURB BOX
A	810	801	821 B.