

105TH AVE.

8

9

M.H.

C.R. 51

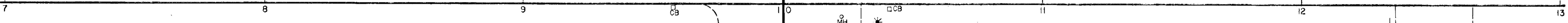

SERVICE ROAD

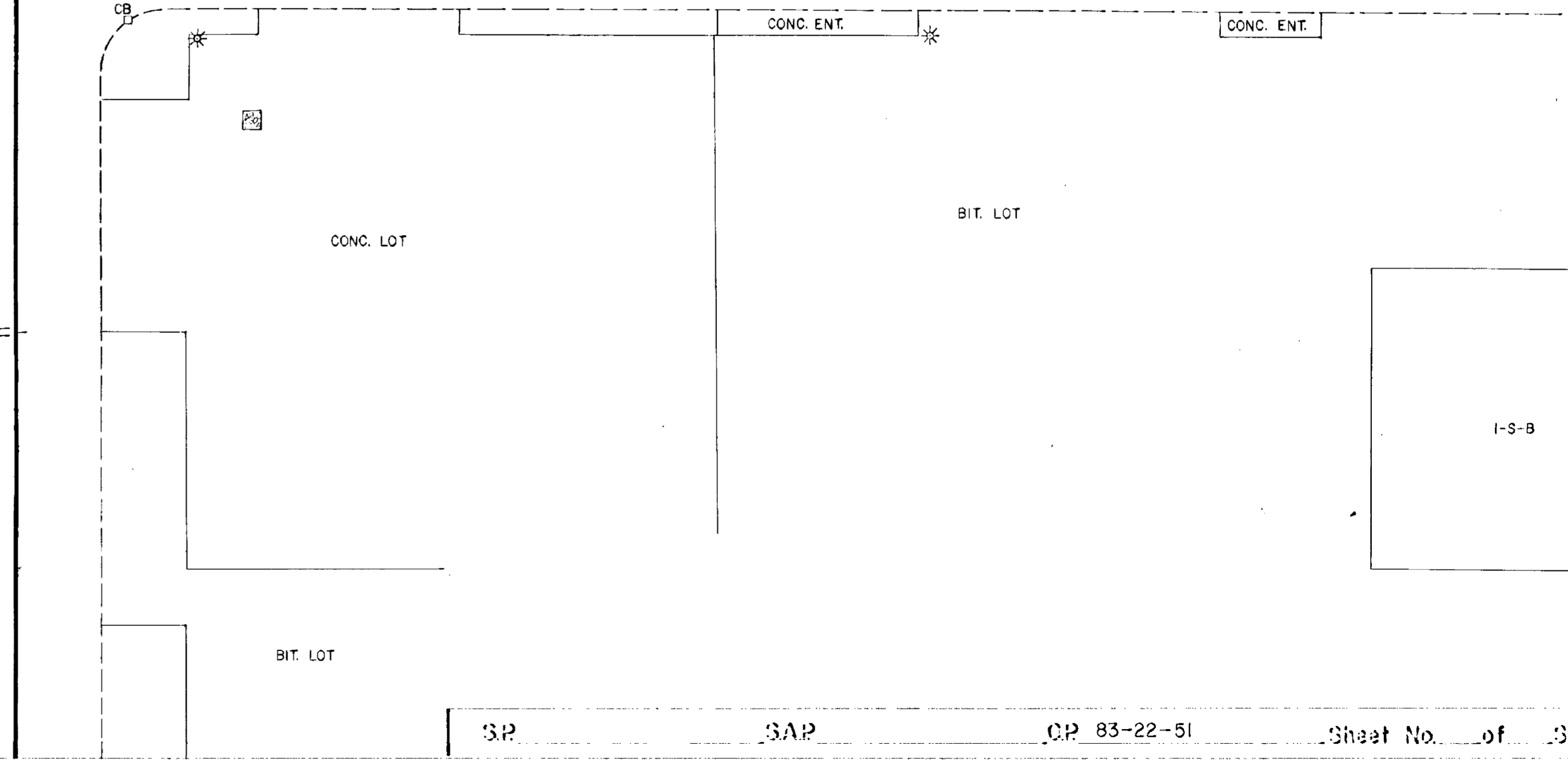
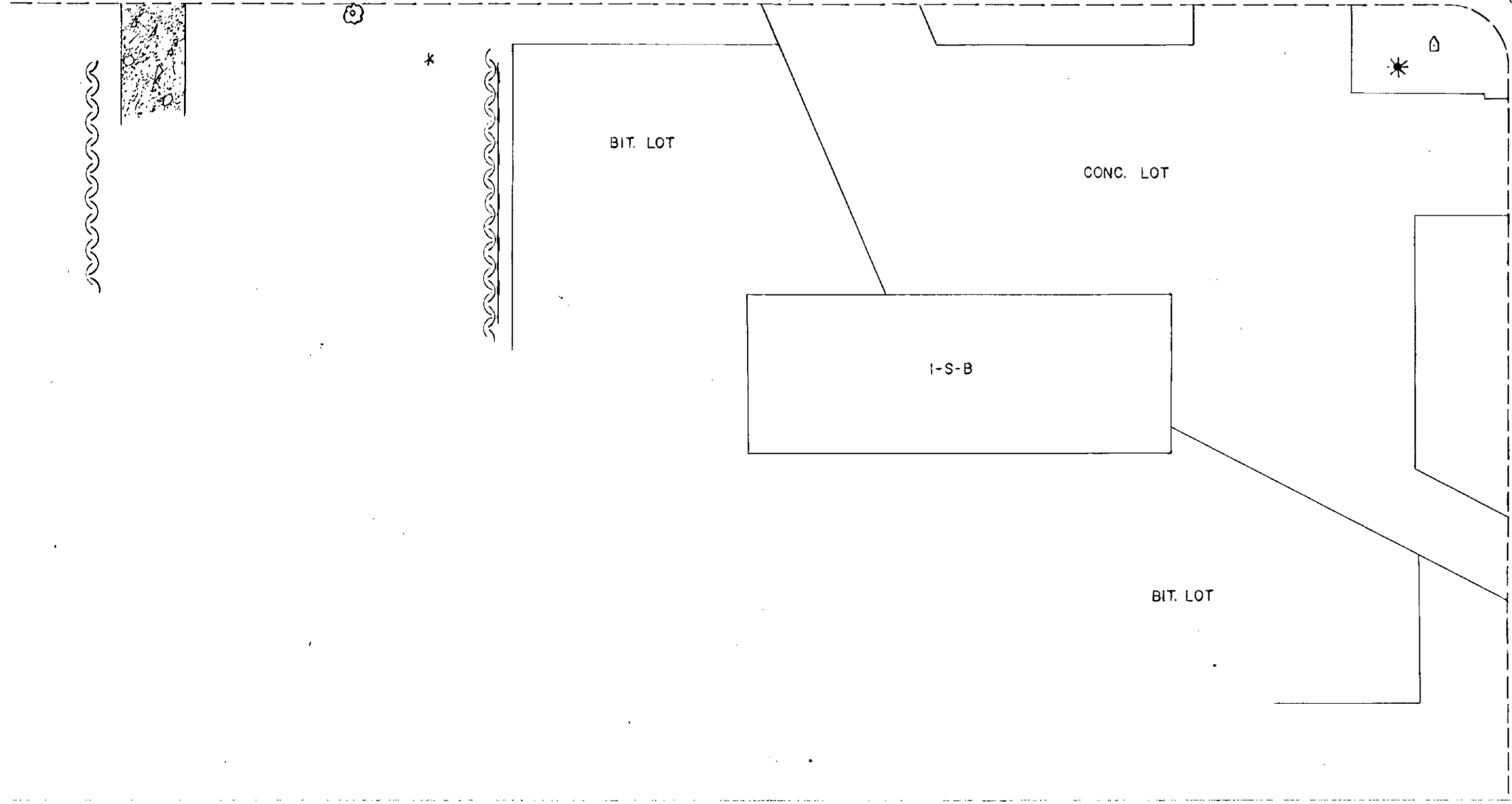

FIELD WIRING TABLE

12e/#12	FUNCTION	CABLE-1	CABLE-2	CABLE-3					
COLOR CODE	RED	VEH. IND.	1-5, 1-1	1-2					
R	RED	1-4, 1-6							
BL	AMBER								
WH	GREEN								
R/BL	NEU.	2-4, 2-6	2-1	2-3					
O/BL	AMBER								
BL/BLK	GREEN								
WH/BLK	NEU.	2-5	2-2	1-3					
BLK	RED								
BLK/WH	AMBER	SIGNAL HOUS.	SIGNAL HOUS.	SIGNAL HOUS.					
G/BLK	GREEN								
GREEN	GROUND								
3e/#12	FUNCTION	CABLE-4	CABLE-5						
COLOR CODE	BLK	PED. IND'S.	PED. IND'S.						
BLK	WK	P2-5, P2-6	P2-2, P2-3						
WH	NEU.	"	"						
RED	D/WK	"	"						
3e/#12	FUNCTION	CABLE-6	CABLE-7						
COLOR CODE	BLK	PPB 2-5	PPB 2-2						
WH	PPB -	2-5, 2-6	2-2, 2-3						
RED	PPB +	PPB 2-6	PPB 2-3						
2es/#14	FUNCTION	CABLE-8	CABLE-9	CABLE-10	CABLE-11	CABLE-12	CABLE-13	CABLE-14	
COLOR CODE	BLK	D2-1	D2-2	D2-4	D2-5	D2-6	D1-1	D1-2	
WH	LOOP +								
SHIELD	EQ. GND								

LOOP DETECTOR SCHEDULE

DETECTOR AMP NO.	NUMBER	SIZE	LOCATION	NO. OF TURNS	SPECIAL NOTE'S	TYPE OF OPERATION
1	D1-1	2-6'X6'	378'	3	1,2	CALL & EXTEND
1	D1-2	2-6'X6'	378'	3	1,2	CALL & EXTEND
2	D2-1	6'X10'	155'	3	1	EXTEND ONLY (STRETCH)
3	D2-2	2-6'X8'	33'	3	1,2	EXTEND (DELAYED CALL)
4	D2-3	6'X6'	28'	3	1	EXTEND (DELAYED CALL)
3	D2-4	6'X10'	73'	3	1	EXTEND (DELAYED CALL)
2	D2-5	6'X8'	185'	3	1	EXTEND ONLY (STRETCH)
4	D2-6	6'X8'	36'	3	1	EXTEND (DELAYED CALL)

SPECIAL NOTES

1. LOCATION IS MEASURED FROM CENTER OF INTERSECTION TO NEAR SIDE OF LOOP
2. CONNECT LOOPS IN SERIES AT HANDHOLE.

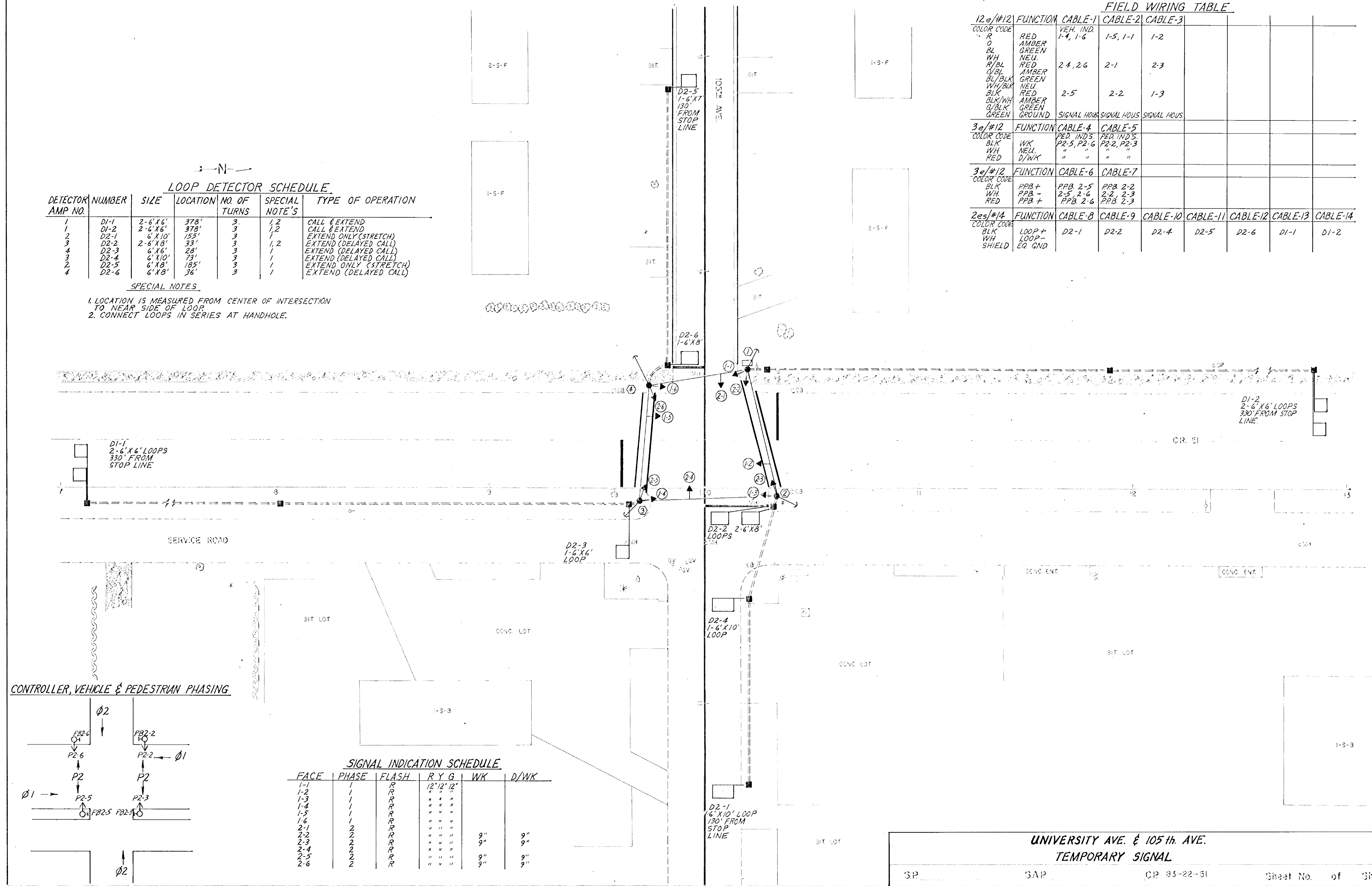

CONTROLLER, VEHICLE & PEDESTRIAN PHASING

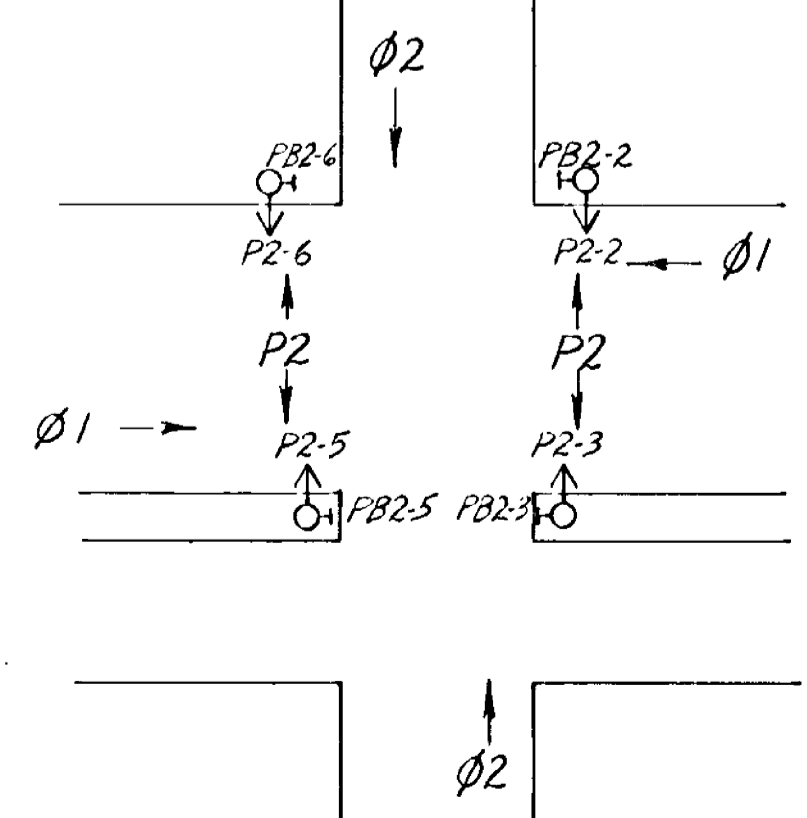

SIGNAL INDICATION SCHEDULE

FACE	PHASE	FLASH	R Y G	WK	D/WK
1-1	1	R	12' 12' 12'		
1-2	1	R	" " "		
1-3	1	R	" " "		
1-4	1	R	" " "		
1-5	1	R	" " "		
1-6	1	R	" " "		
2-1	2	R	" " "	9"	9"
2-2	2	R	" " "	9"	9"
2-3	2	R	" " "	9"	9"
2-4	2	R	" " "	9"	9"
2-5	2	R	" " "	9"	9"
2-6	2	R	" " "	9"	9"

**UNIVERSITY AVE. & 105th AVE.
TEMPORARY SIGNAL**

LOOP DETECTOR SCHEDULE

DETECTOR AMP NO.	NUMBER	SIZE	LOCATION	NO. OF TURNS	SPECIAL NOTE'S	TYPE OF OPERATION
1 E	D1-1	2-6x6	378'	3	1, 2	Call and EXTEND
2 E	D1-2	2-6x6	378'	3	1, 2	Call and EXTEND
3 E STR	D2-1	6x10	155'	1	1, 2	EXTEND ONLY [STRETCH]
4 E DC	D2-2	2-6x8	33'	1	1, 2	EXTEND [DELAYED CALL]
5 E DC	D2-3	6x6	28'	1	1, 2	EXTEND [DELAYED CALL]
6 E DC	D2-4	6x10	28'	1	1, 2	EXTEND [DELAYED CALL]
7 E STR	D2-5	6x8	183'	1	1, 2	EXTEND ONLY [STRETCH]
8 E DC	D2-6	6x8	30'	1	1, 2	EXTEND [DELAYED CALL]

- SPECIAL NOTE'S
1. LOCATION IS MEASURED FROM CENTER OF INTERSECTION TO NEAR SIDE OF LOOP.
 2. Connect LOOPS IN SERIES AT HAND HOPE.

12c/#12	FUNCTION	CABLE 1	CABLE 2	CABLE 3				
Color Code		VEH IND						
R	RED	1-4, 1-6	1-5, 1-1	1-2				
O	AMBER							
BL	GREEN							
WH.	NEU.							
R/BLK	RED	2-4, 2-6	2-1	2-3				
O/BLK	AMBER							
BL/BLK	GREEN							
WH/BLK	NEU.							
BLK	RED	2-5	2-2	1-3				
BLK/WH	AMBER							
G/BLK	GREEN							
Green	Ground	SIGNAL HOUSING	SIGNAL HOUSING	SIGNAL HOUSING				
3c/#12	FUNCTION	CABLE 4	CABLE 5					
Color Code		PED IND'S	PED IND'S					
BLK	WK	P2-5, P2-6	P2-2, P2-3					
WH.	NEU	" "	" "					
RED	D/WK	" "	" "					
3c/#12	FUNCTION	CABLE 6	CABLE 7					
Color Code								
BLK.	PPB +	PPB 2-5	PPB 2-2					
WH.	PPB -	2-5, 2-6	2-2, 2-3					
RED	PPB +	PPB 2-6	PPB 2-3					
2c/#14	FUNCTION	CABLE 8	CABLE 9	CABLE 10	CABLE 11	CABLE 12	CABLE 13	CABLE 14
Color Code								
BLK	LOOP +	D2-1	D2-2	D2-4	D2-5	D2-6	D1-1	D1-2
WH	LOOP -							
SHIELD	EQ. GND							

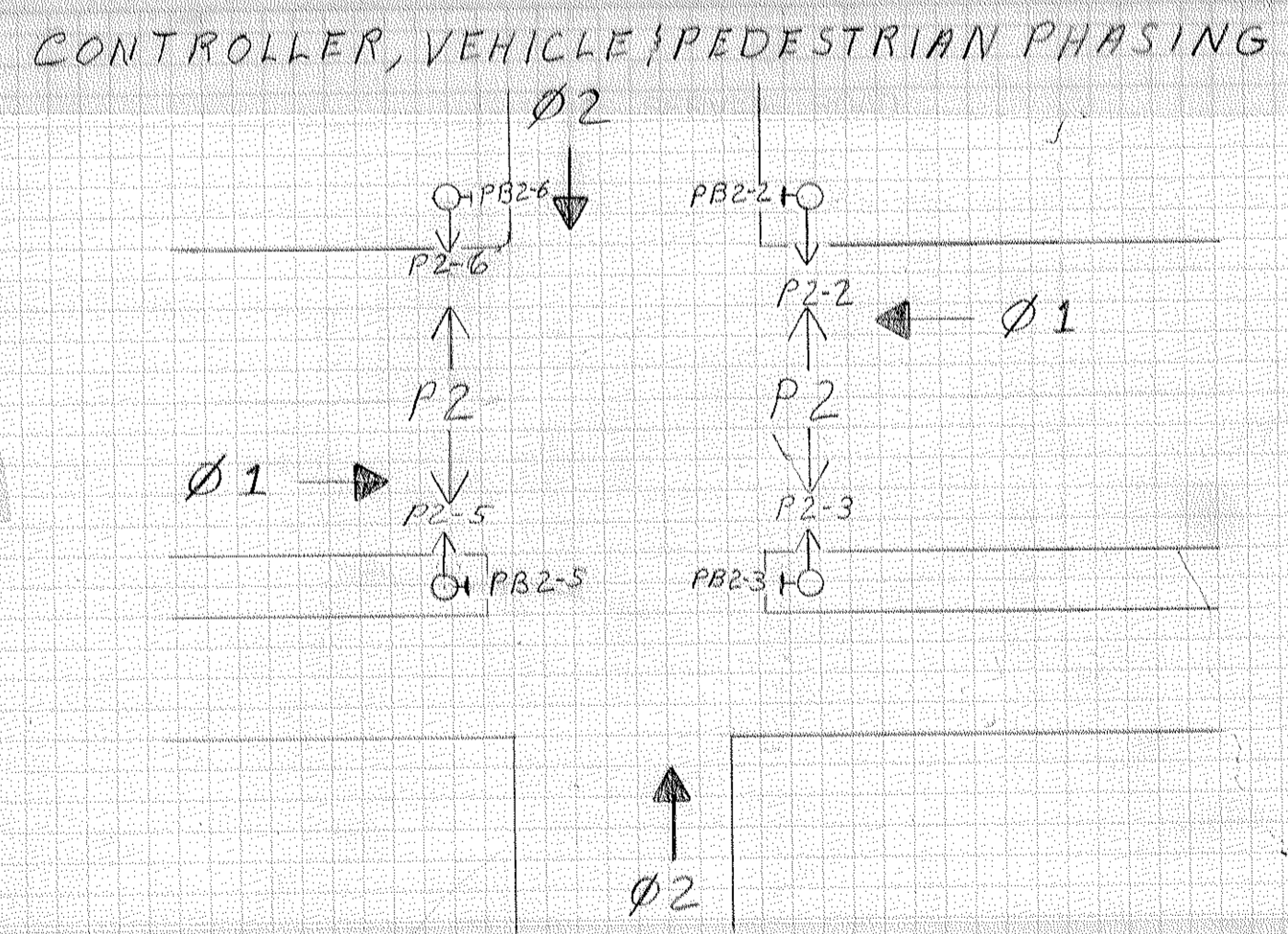
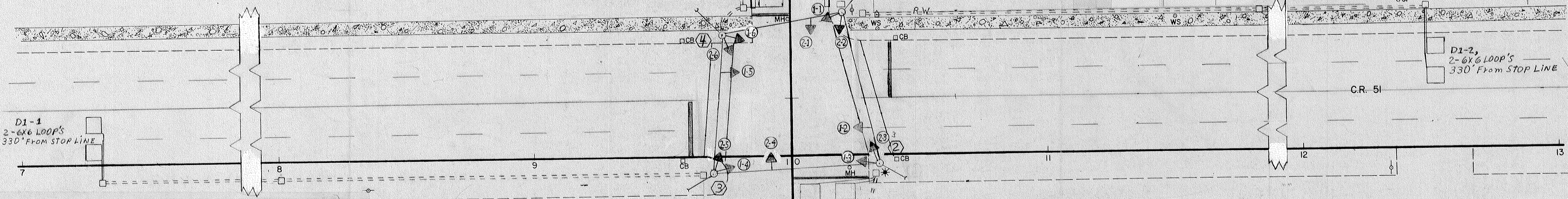

SIGNAL INDICATION SCHEDULE

FACE	PHASE	FLASH	R	Y	G	WK	D/WK
1-1	1		R	12"	12"	12"	-
1-2	1		R	"	"	"	-
1-3	1		R	"	"	"	-
1-4	1		R	"	"	"	-
1-5	1		R	"	"	"	-
1-6	1		R	"	"	"	-
2-1	1		R	"	"	"	9"
2-2	1		R	"	"	"	9"
2-3	1		R	"	"	"	9"
2-4	1		R	"	"	"	9"
2-5	1		R	"	"	"	9"
2-6	1		R	"	"	"	9"

175TH
83-22-51
99TH
83-21-51

UNIVERSITY
TEMPORARY SIGNAL
CP-83-22-51