

STATE OF MINNESOTA
DEPARTMENT OF HIGHWAYS

CONSTRUCTION PLAN FOR GRADING, BIT BASE, BIT SURFACING, CONCRETE CURB & GUTTER

County State Aid Highway No. 8

Between CS.A.H. NO. 35 And STINSON BLVD.

From A POINT 5' SOUTH AND 22' EAST OF CENTER SEC. 12 T. 30N. R. 24 W. To A POINT 5' SOUTH OF THE EAST 1/4 COR. SEC. 12 T. 30N. R. 24 W.

GROSS LENGTH - 2.631 FEET - 0.498 MILES
BRIDGES LENGTH - 0.0 FEET - 0.0 MILES
EXCEPTIONS LENGTH - 0.0 FEET - 0.0 MILES
NET LENGTH - 2.631 FEET - 0.498 MILES

INDEX OF SHEETS
Sheet No. 1 The Sheet & Layout Map
No. 2 Est. Quantities & Typical Sec.
No. 3 Plan & Profile
No. 4 Cross Sections

CONVENTIONAL SIGNS

- STATE LINE
- COUNTY LINE
- TOWNSHIP OR RANGE LINE
- SECTION LINE
- QUARTER SECTION LINE
- PROPERTY LINE
- RIGHT OF WAY LINE
- PRESENT TYPED AND PAVED
- CONV. OF ACCESS LINE
- PROPERTY LINE (ELECTRIC AND OTHER)
- INDICATED BY OTHER PROPERTY
- CORPORATE OR CITY LIMITS
- RAILROAD CENTER LINE
- RAILROAD
- RAILROAD RIGHT OF WAY LINE
- RIVER OR CREEK
- DRY RUN
- SPRINKLER DITCH
- ELECTRIC POWER LINE
- TELEPHONE OR TELEGRAPH LINE
- JOINT TELEPHONE AND POWER
- JOINT
- TELEPHONE CABLE UNDERGROUND
- POWER CABLE UNDERGROUND
- S&W DITCH
- GRAVEL
- GRASS
- RAISED RAIL FENCE
- WOODEN WIRE FENCE
- CHAIN LINK FENCE
- GALVANIZED SNOW FENCE
- STONE WALL OR FENCE
- WEDGE
- WATER PIPE
- SEWER PIPE
- DRAIN TILE
- SPRINGER
- HARBOR
- TRAIL
- ROAD
- BRIDGE
- WATER
- CATCH BASIN
- MANHOLE
- FREE ENTRANCE
- STREET LIGHT
- RAILROAD CROSSING SIGN
- RAILROAD CROSSING SIGN
- ELECTRIC WARNING SIGN
- CROSSING GATE
- GATE
- UNDERPASS (Highway Over)
- UNDERPASS (Highway Under)
- BRIDGE
- BUILDING (One Story Frame)
- FRAME CONCRETE
- BRICK
- IRON & PL. OR RUB.
- MONUMENT (STONE, CONCRETE, OR METAL)
- WOODEN PILE
- GRAVEL PIT
- SAND PIT
- EROSION PIT
- ROCK QUARRY
- MEASURED CORNER



END PROJECT STA. 26+53
BEGIN PROJECT STA. 0+22

DESIGN DESIGNATION
ADT (CURRENT YEAR) 1296
ADT (FUTURE YEAR) 3000
T (HEAVY COMMERCIAL) 300-600
9 Ton Design, Soil Factor 50
Design Speed 30 MPH
Design Speed not achieved at:
STA _____ TO STA _____ MPH
STA _____ TO STA _____ MPH

SPECIFICATIONS
THE STANDARD SPECIFICATIONS FOR HIGHWAY CONSTRUCTION, DATED JAN. 1, 1968, SHALL GOVERN

ALL APPLICABLE FEDERAL STATE AND LOCAL LAWS AND ORDINANCES WILL BE COMPLIED WITH IN THE CONSTRUCTION OF THIS PROJECT
I HEREBY CERTIFY THAT THIS PLAN WAS PREPARED BY ME OR UNDER MY DIRECT SUPERVISION AND THAT I AM A DULY REGISTERED PROFESSIONAL ENGINEER UNDER THE LAWS OF THE STATE OF MINNESOTA

Carl J. Lundholm COUNTY ENGINEER DATE 1-24-68
ANOKA COUNTY REG. NO. 2561
RECOMMENDED FOR APPROVAL 37 Wells DISTRICT ENGINEER 10-68
RECOMMENDED FOR APPROVAL C.C. Weichselbaum 3-29-68
APPROVED 4/1/68 Lundholm STATE ENGINEER

Minn. Proj. No. _____ County Proj. No. _____
State Proj. No. _____ S.A.P. 02-608-03

SECTIONAL DETAILS

EXCEPT COMMON EXCAVATION APPROXIMATELY 18" TO 24" DEEP SHALL BE HAUL TO OTHER ROAD PROJECT (BEHIND THE CURB & GUTTER) FOR REMOVAL. WATER SHALL BE REMOVED BY SPECIAL PROVISIONS.

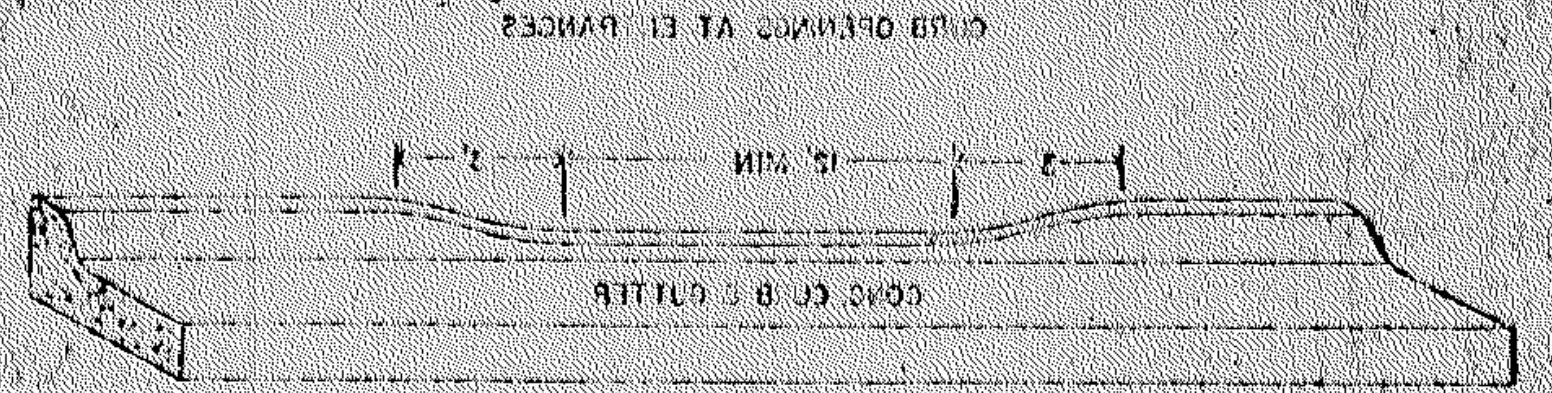

NO.	STATION	LOCATION	TYPE	DESIGN	IN. FT.	TO	OFFSET	CAST	TO	IN. FT.	TO	IN. FT.
1	0+50	C.B.	COR.	A	18	0+50	0	A	18	0+50	0	18
2	0+55	C.B.	COR.	A	18	0+55	0	A	18	0+55	0	18

CASTING ASSEMBLY
NEARLY RESIDE OR TRAIL

ITEM	STATION	LOCATION	TYPE	DESIGN	IN. FT.	TO	OFFSET	CAST	TO	IN. FT.	TO	IN. FT.
1	0+50	C.B.	COR.	A	18	0+50	0	A	18	0+50	0	18

ITEM	STATION	LOCATION	TYPE	DESIGN	IN. FT.	TO	OFFSET	CAST	TO	IN. FT.	TO	IN. FT.
1	0+50	C.B.	COR.	A	18	0+50	0	A	18	0+50	0	18

ITEM	STATION	LOCATION	TYPE	DESIGN	IN. FT.	TO	OFFSET	CAST	TO	IN. FT.	TO	IN. FT.
1	0+50	C.B.	COR.	A	18	0+50	0	A	18	0+50	0	18

ITEM	STATION	LOCATION	TYPE	DESIGN	IN. FT.	TO	OFFSET	CAST	TO	IN. FT.	TO	IN. FT.
1	0+50	C.B.	COR.	A	18	0+50	0	A	18	0+50	0	18

BASIS OF PLANNED UTILITIES

1. BITUMINOUS MIXTURE FOR TACK COAT 0.0 GALL. PER SQ. YD.
2. BITUMINOUS MIXTURE FOR SURFACE COURSE 2.5 GALL. PER SQ. YD.
3. BITUMINOUS MIXTURE FOR WEARING COURSE 3.5 GALL. PER SQ. YD.
4. BITUMINOUS MIXTURE FOR FINISH COURSE 4.5 GALL. PER SQ. YD.
5. BITUMINOUS MIXTURE FOR CURB & GUTTER 5.5 GALL. PER SQ. YD.
6. BITUMINOUS MIXTURE FOR SIDEWALK 6.5 GALL. PER SQ. YD.
7. BITUMINOUS MIXTURE FOR DRIVEWAY 7.5 GALL. PER SQ. YD.
8. BITUMINOUS MIXTURE FOR PARKING 8.5 GALL. PER SQ. YD.
9. BITUMINOUS MIXTURE FOR ROAD 9.5 GALL. PER SQ. YD.
10. BITUMINOUS MIXTURE FOR SHOULDER 10.5 GALL. PER SQ. YD.

TYPICAL GRADING SECTIONS

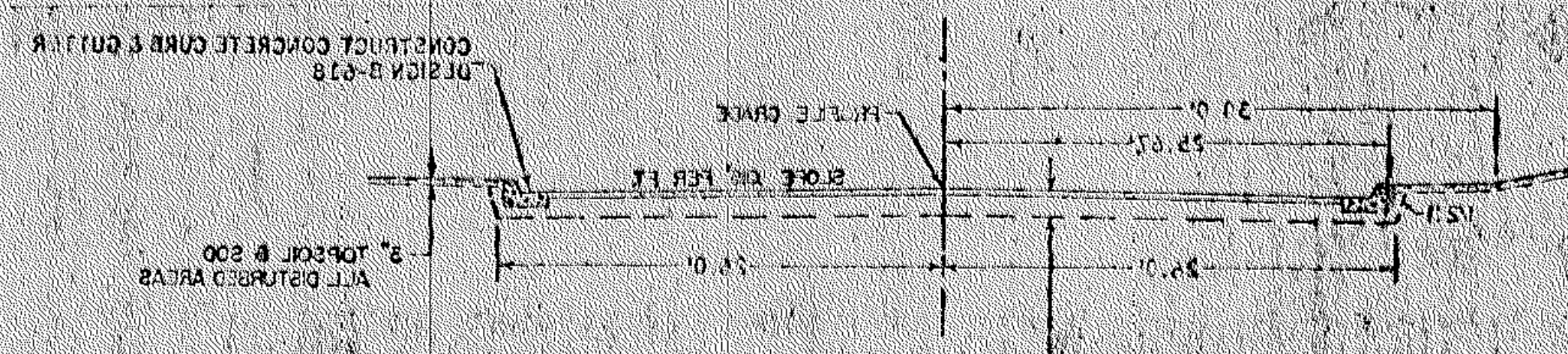

TO SUPPORT FOR CONTACT WITH COMMON EXCAVATION
QUANTITIES INCLUDED WITH COMMON EXCAVATION

TYPICAL BASE & SURFACE SECTIONS

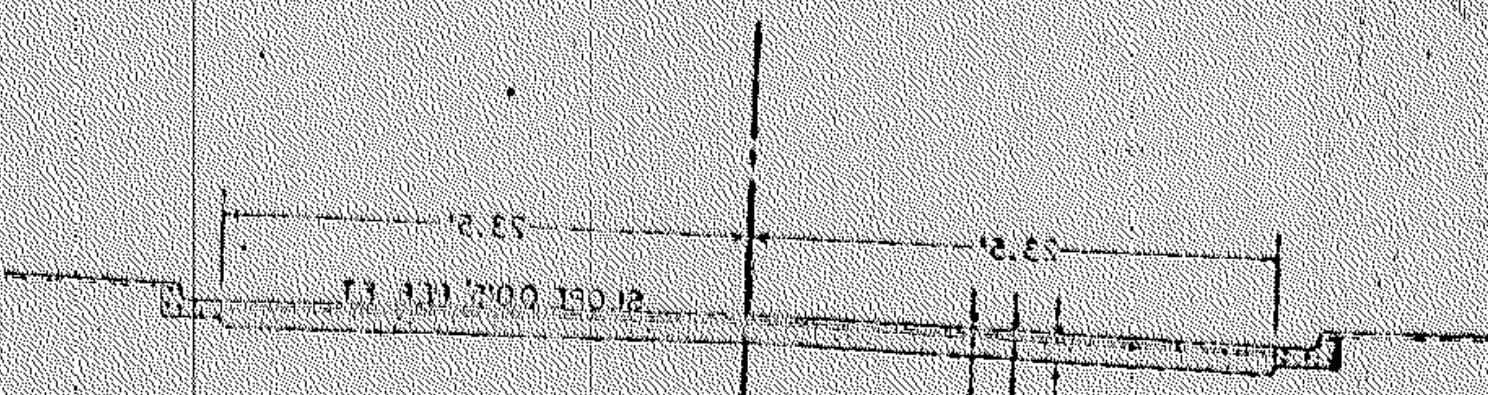

1. BITUMINOUS MIXTURE FOR TACK COAT 0.0 GALL. PER SQ. YD.
2. BITUMINOUS MIXTURE FOR SURFACE COURSE 2.5 GALL. PER SQ. YD.
3. BITUMINOUS MIXTURE FOR WEARING COURSE 3.5 GALL. PER SQ. YD.
4. BITUMINOUS MIXTURE FOR FINISH COURSE 4.5 GALL. PER SQ. YD.
5. BITUMINOUS MIXTURE FOR CURB & GUTTER 5.5 GALL. PER SQ. YD.
6. BITUMINOUS MIXTURE FOR SIDEWALK 6.5 GALL. PER SQ. YD.
7. BITUMINOUS MIXTURE FOR DRIVEWAY 7.5 GALL. PER SQ. YD.
8. BITUMINOUS MIXTURE FOR PARKING 8.5 GALL. PER SQ. YD.
9. BITUMINOUS MIXTURE FOR ROAD 9.5 GALL. PER SQ. YD.
10. BITUMINOUS MIXTURE FOR SHOULDER 10.5 GALL. PER SQ. YD.

ITEM NO.	ITEM	UNIT	ESTIMATE	TOTAL
1	CONCRETE CURB & GUTTER DESIGN B-618	LINEAL FEET	100	100
2	CONCRETE CURB & GUTTER DESIGN B-618	LINEAL FEET	100	100
3	CONCRETE CURB & GUTTER DESIGN B-618	LINEAL FEET	100	100
4	CONCRETE CURB & GUTTER DESIGN B-618	LINEAL FEET	100	100
5	CONCRETE CURB & GUTTER DESIGN B-618	LINEAL FEET	100	100
6	CONCRETE CURB & GUTTER DESIGN B-618	LINEAL FEET	100	100
7	CONCRETE CURB & GUTTER DESIGN B-618	LINEAL FEET	100	100
8	CONCRETE CURB & GUTTER DESIGN B-618	LINEAL FEET	100	100
9	CONCRETE CURB & GUTTER DESIGN B-618	LINEAL FEET	100	100
10	CONCRETE CURB & GUTTER DESIGN B-618	LINEAL FEET	100	100

- 1. FOR CURB DETAIL
- 2. FOR DRIVEWAY
- 3. FOR REPAIR OF DRIVEWAY

ROADS SHALL APPLY TO THIS PROJECT
THE FOLLOWING STANDARD DETAIL PLATES, APPROVED BY THE BUREAU OF PUBLIC WORKS

PLATE NO.	DESCRIPTION
1000	CONCRETE CURB & GUTTER DESIGN B-618
1100	CONCRETE CURB & GUTTER DESIGN B-618
1200	CONCRETE CURB & GUTTER DESIGN B-618
1300	CONCRETE CURB & GUTTER DESIGN B-618
1400	CONCRETE CURB & GUTTER DESIGN B-618
1500	CONCRETE CURB & GUTTER DESIGN B-618
1600	CONCRETE CURB & GUTTER DESIGN B-618
1700	CONCRETE CURB & GUTTER DESIGN B-618
1800	CONCRETE CURB & GUTTER DESIGN B-618
1900	CONCRETE CURB & GUTTER DESIGN B-618
2000	CONCRETE CURB & GUTTER DESIGN B-618

S.A.P. 02-608-03
STA. 0+22

B.M. #1 ELEV. 100.00
TOP HYD. LT. STA. +94

B.M. #2 ELEV. 105.10
TOP HYD. LT. STA. 6+90

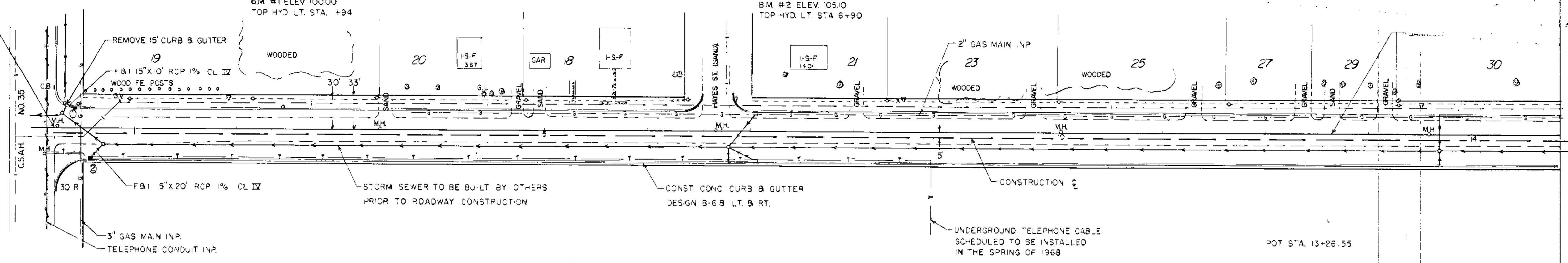
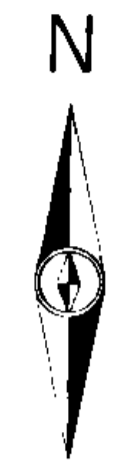

SCALE VERT. 1"=5'
HORIZ. 1"=50'

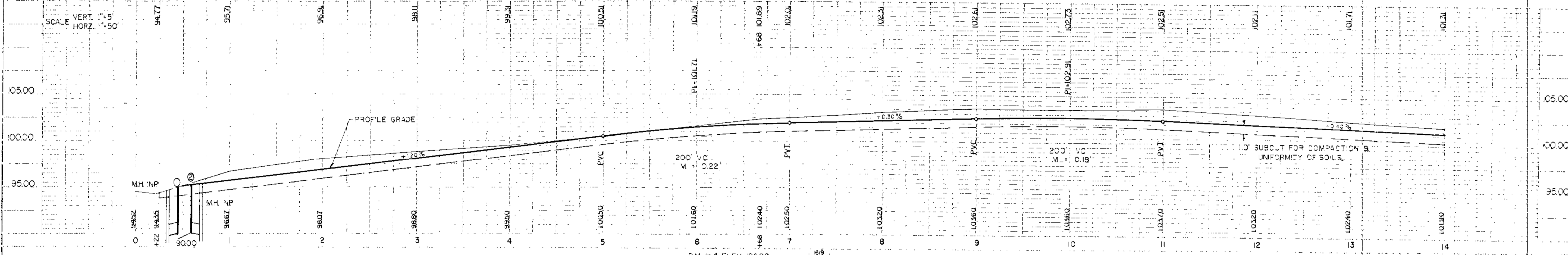

B.M. #4 ELEV. 106.02
TOP HYD. LT. STA. 20+1

B.M. #5 ELEV. 105.97 LT
TOP HYD. STA. 26+2.5

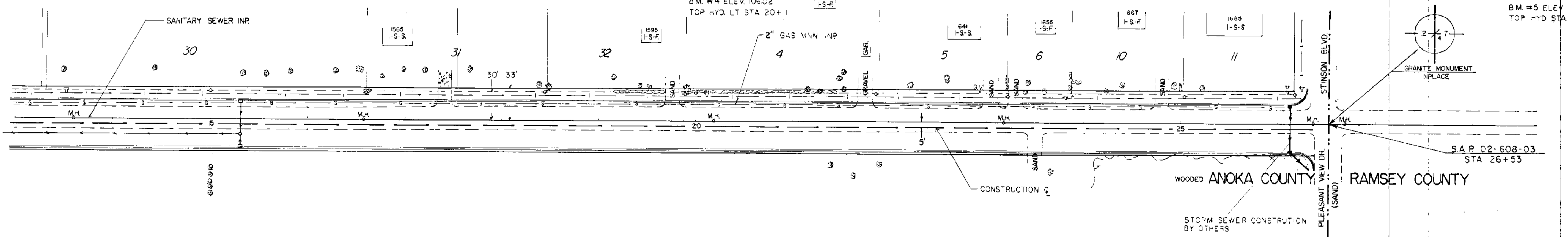

WOODED ANOKA COUNTY
RAMSEY COUNTY

