

CURVE #4
 $\Delta = 19^{\circ}29'50''$
 $R = 1145.92'$
 $T = 530.87'$
 $L = 391.48'$
 $PC STA 42+55.73$
 $PT STA 50+65.93$

CURVE #5
 $\Delta = 19^{\circ}29'50''$
 $R = 1145.92'$
 $T = 530.87'$
 $L = 391.48'$
 $PC STA 57+43.77$
 $PT STA 64+74.86$
 $PT STA 67+43.27$

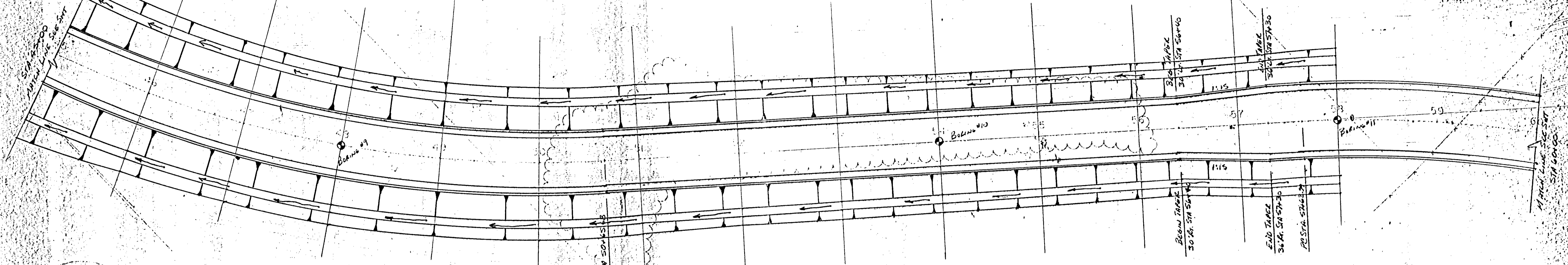

NOTE: ANG -48

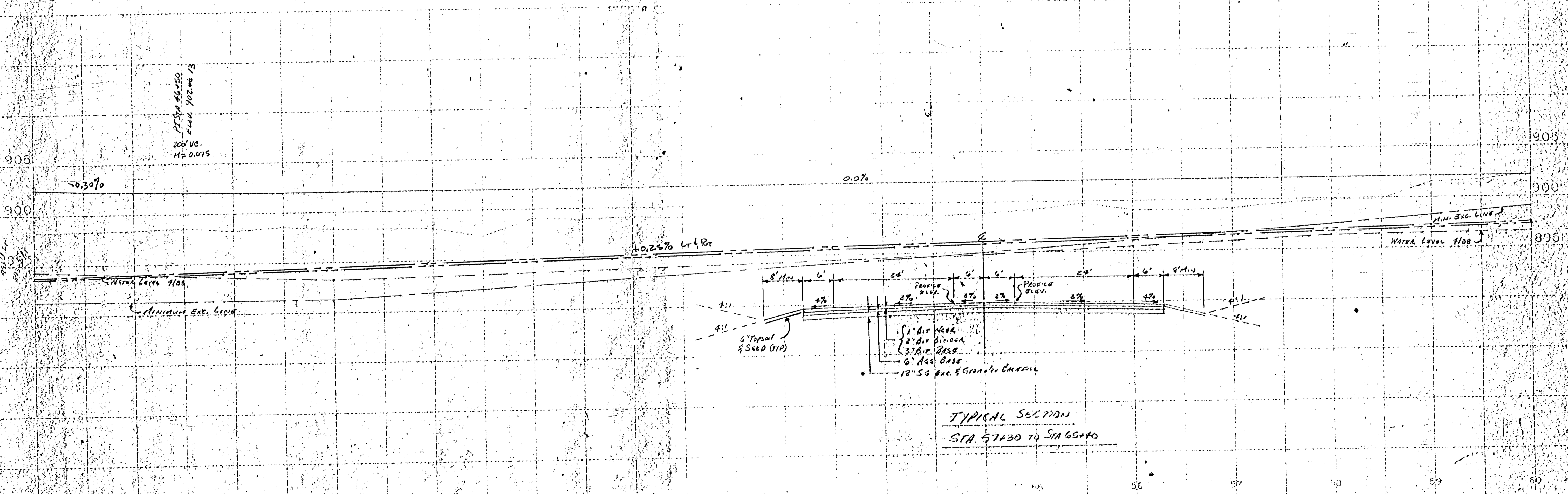

TYPICAL SECTION
 STA 57+30 TO STA 65+10