

TOURNAMENT PLAYERS CLUB NINTH ADDITION - PHASE 2

SANITARY SEWER, WATERMAIN, STORM SEWER AND STREET CONSTRUCTION PLANS BLAINE, MINNESOTA

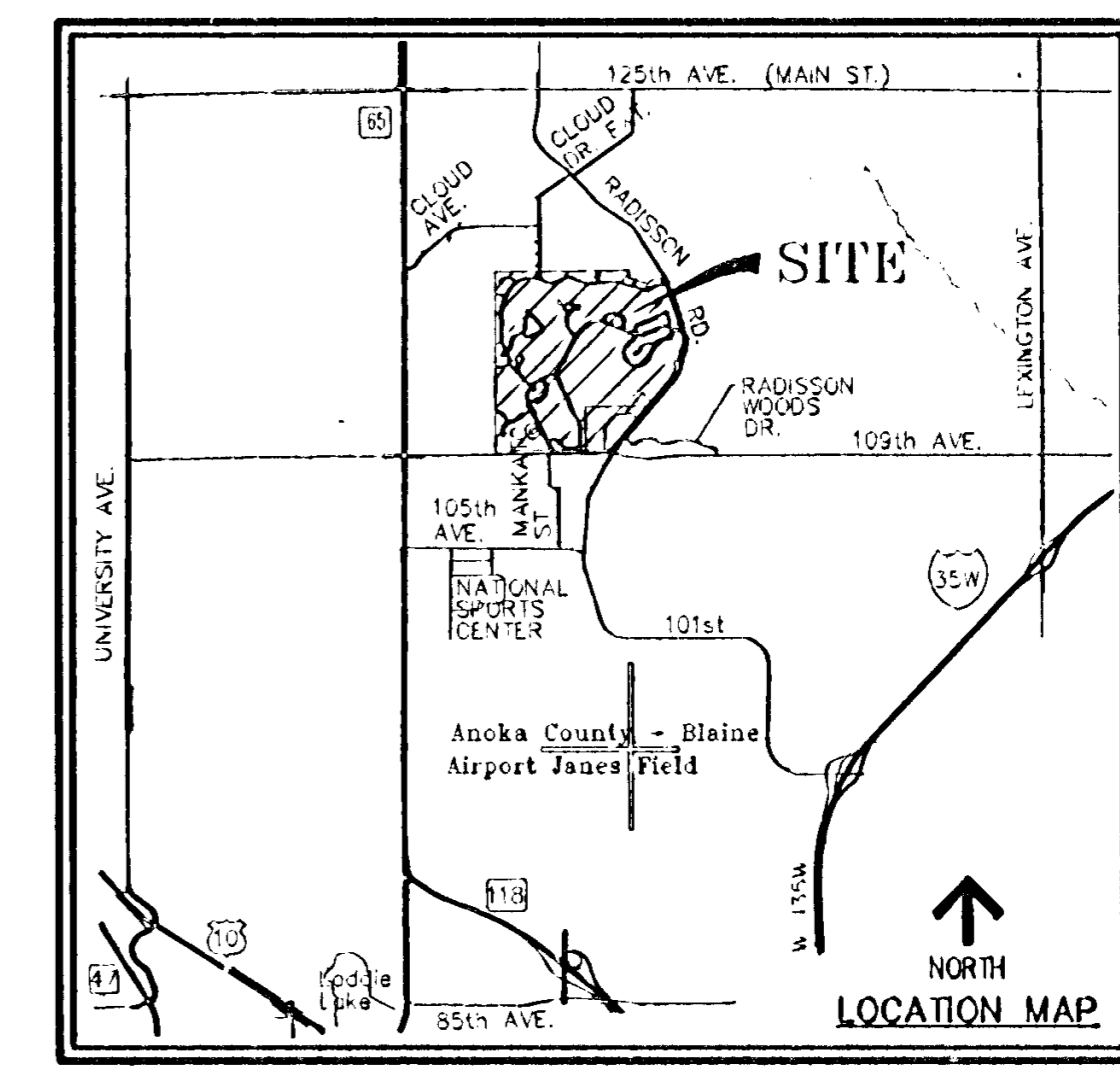
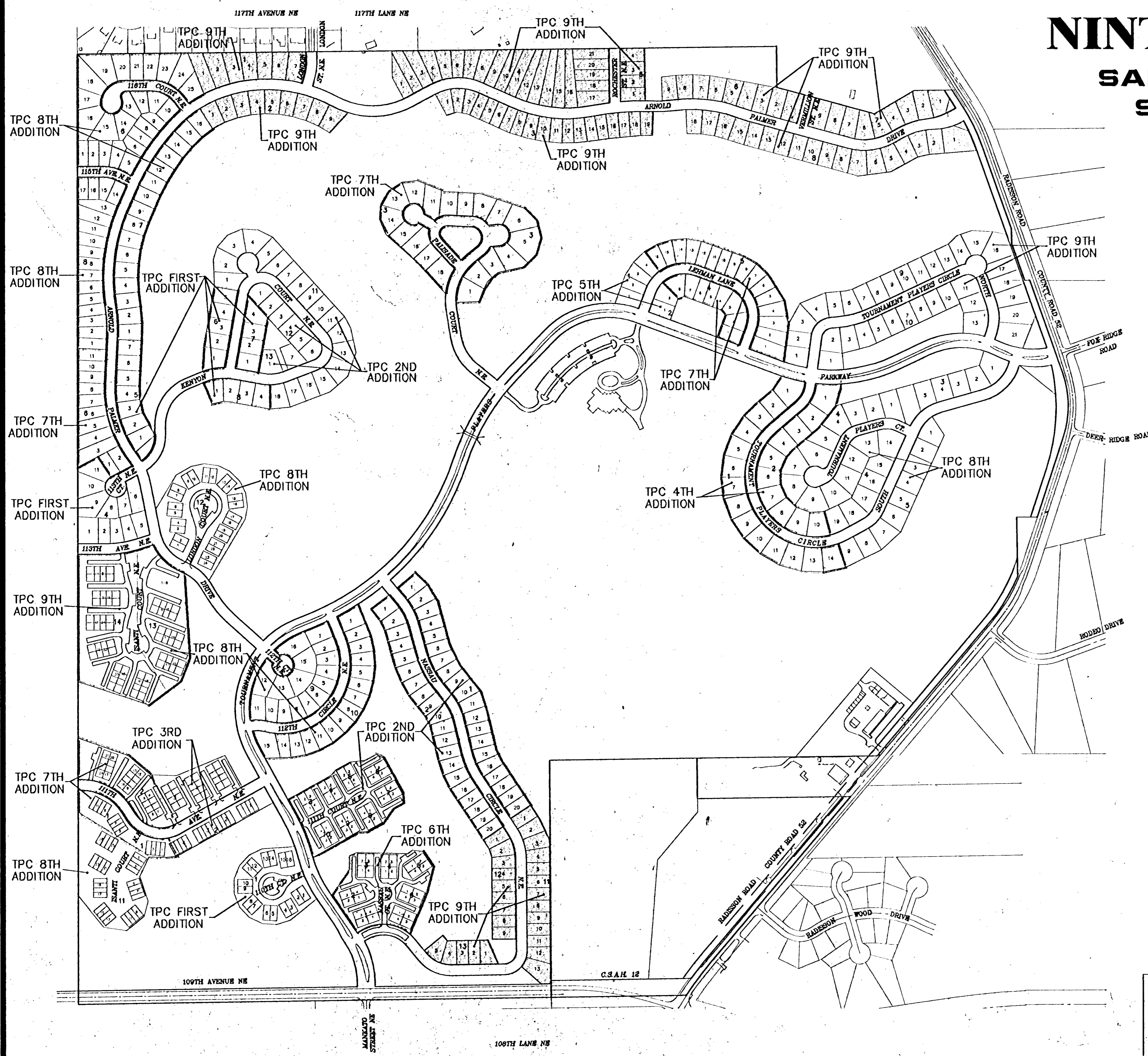

SHEET INDEX

1. COVER SHEET
2. SANITARY SEWER AND WATERMAIN
ARNOLD PALMER DRIVE
3. SANITARY SEWER AND WATERMAIN
ARNOLD PALMER DRIVE
4. SANITARY SEWER AND WATERMAIN
ARNOLD PALMER DRIVE
5. SANITARY SEWER AND WATERMAIN
ARNOLD PALMER DRIVE
6. SANITARY SEWER AND WATERMAIN
RADISSON ROAD
7. SANITARY SEWER AND WATERMAIN
LONDON STREET NE,
ROCHESTER STREET NE,
& VERMILLION STREET NE
8. SANITARY SEWER AND WATERMAIN
NASSAU CIRCLE N.E.
9. SANITARY SEWER AND WATERMAIN
NASSAU CIRCLE N.E.
10. STORM SEWER CONSTRUCTION
11. STORM SEWER CONSTRUCTION
12. STORM SEWER CONSTRUCTION
13. STORM SEWER CONSTRUCTION
14. STREET CONSTRUCTION
ARNOLD PALMER DRIVE
15. STREET CONSTRUCTION
ARNOLD PALMER DRIVE
16. STREET CONSTRUCTION
ARNOLD PALMER DRIVE
17. STREET CONSTRUCTION
ARNOLD PALMER DRIVE
18. STREET CONSTRUCTION
LONDON STREET NE,
ROCHESTER STREET NE,
& VERMILLION STREET NE
19. STREET CONSTRUCTION
NASSAU CIRCLE N.E.
20. STREET CONSTRUCTION
NASSAU CIRCLE N.E.
21. TURN LANE
ARNOLD PALMER DR. & RADISSON RD.
22. DETAILS
23. DETAILS

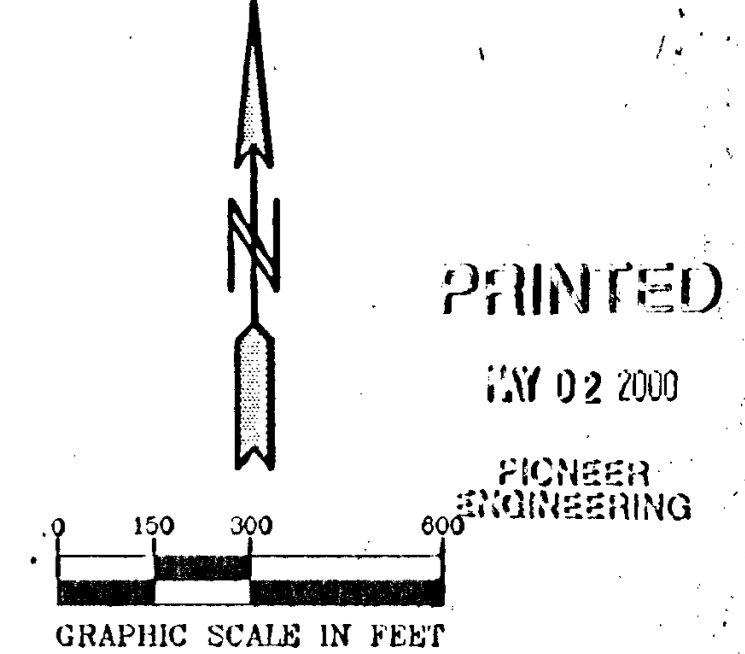

Prior to any excavation the contractor shall verify the location of all underground utilities.
Call 48 Hours before digging:
GOPHER STATE ONE CALL
Twin City Area 454-0002
Mn. Toll Free 1-800-252-1166

BENCH MARKS

T.N.H. 100' (FT.) WEST OF LONDON ST. NE.
ON NORTH SIDE OF 117TH AVE. NE.
ELEVATION = 902.60

T.N.H. SW. QUAD. OF 109TH AVE. NE.
AND MANKATO ST. NE
ELEVATION = 900.55

J:\Draw\117420 - TPC of Blaine\Tpc-9th-Phase2\117420-9.dwg 03/16/00 11:49:33 AM CST

PIONEER engineering
2429 Exchange Blvd
Minneapolis, MN 55425
(612) 831-1111 FAX 612-831-1188
www.pioneer-engineering.com
P.L.L.C.
Blaine, MN 55425
(612) 753-1000 FAX 612-753-1003

I hereby certify that this plan was prepared by me or under my direct supervision and that I am a duly registered Professional Engineer under the laws of the State of Minnesota.

Name: *BA [Signature]*
Reg. No. 25083 Date 2/10/00

Checked by: *S.S. [Signature]*
1. 3/15/00
2. 3/24/00
3. 4/13/00

Date 2/10/00
Designed BJK
Drawn LOC

SHEET TITLE
COVER SHEET

OWNER SIENNA CORPORATION
4940 VIKING DRIVE, SUITE 608
MINNEAPOLIS, MINNESOTA 55435

PROJECT TPC 9TH ADDITION - PHASE 2

SHEET 1 OF 23 SHEETS