

TYPICAL STREET SECTION
(PUBLIC STREETS)

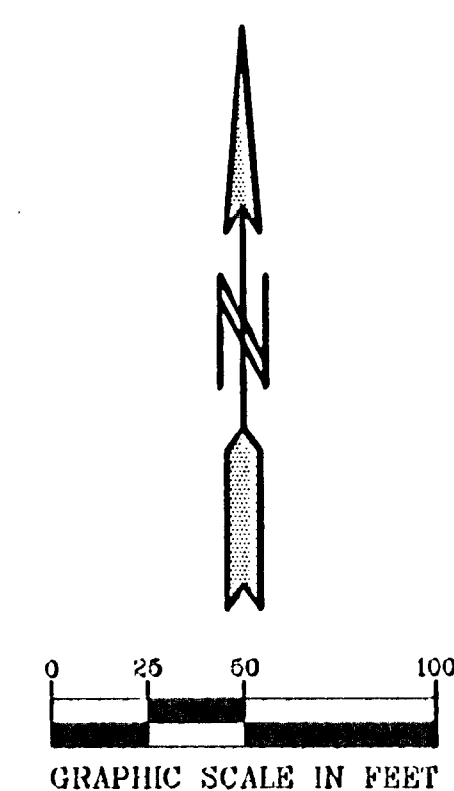
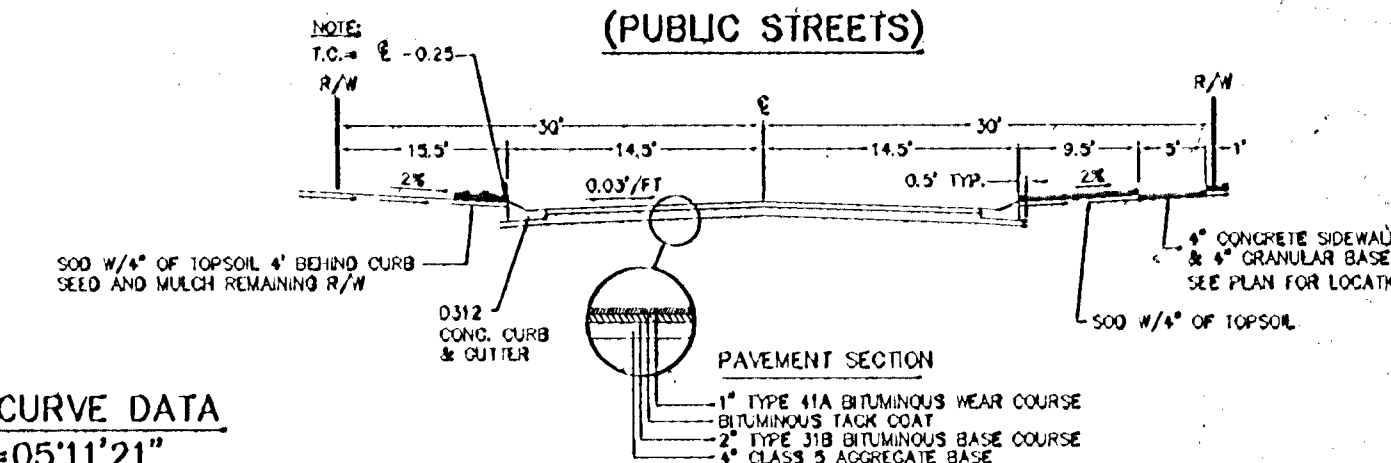

BENCH MARKS
 T.N.H. 100' (FT.) WEST OF LONDON ST. NE. ON NORTH SIDE OF 117TH AVE. NE. ELEVATION = 902.60
 T.N.H. SW. QUAD. OF 109TH AVE. NE. AND MANKATO ST. NE. ELEVATION = 900.55

SEE SHEET 18

☉ CURVE DATA
 $\Delta=34^{\circ}37'31''$
 $R=750.00'$
 $L=453.24'$
 $T=233.78'$

☉ CURVE DATA
 $\Delta=09^{\circ}13'18''$
 $R=750.00'$
 $L=120.70'$
 $T=60.48'$

☉ CURVE DATA
 $\Delta=05^{\circ}11'21''$
 $R=750.00'$
 $L=67.93'$
 $T=33.99'$

☉ CURVE DATA
 $\Delta=12^{\circ}40'56''$
 $R=1600.00'$
 $L=354.16'$
 $T=177.80'$

☉ CURVE DATA
 $\Delta=27^{\circ}35'50''$
 $R=750.00'$
 $L=361.25'$
 $T=184.20'$

☉ STA. 20+64.58 ARNOLD PALMER DRIVE = STA. 0+00 ROCHESTER STREET NE.

CURB TYPES

- ==== DENOTES D312 CONCRETE CURB & GUTTER
- ==== DENOTES B618 CONCRETE CURB & GUTTER
- ==== DENOTES B612 CONCRETE CURB & GUTTER

NOTE: TOP OF CURB ELEV. ARE THE ACTUAL ELEV'S FOR THE TYPE OF CURB SHOWN.

ARNOLD PALMER DRIVE

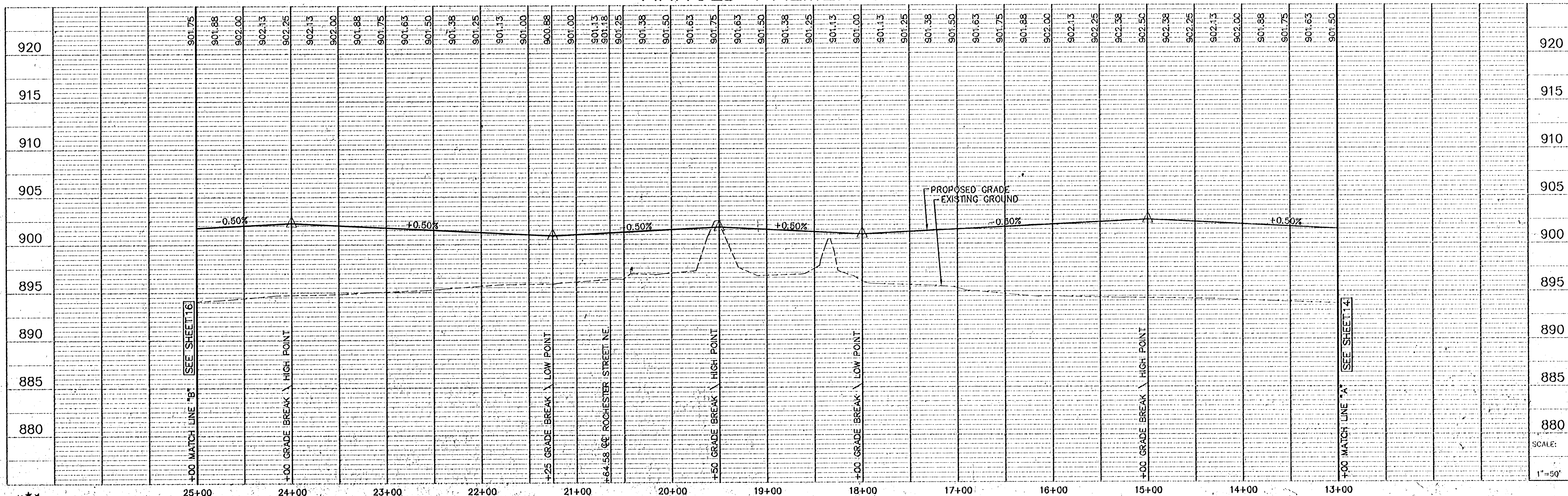

PIONEER engineering
 PA
 2225 Glenview St. Suite 200
 (612) 831-1914 FAX 831-2408
 13333 - 13334
 13335 - 13336
 (612) 831-2883 FAX 831-1053

I hereby certify that this plan was prepared by me or under my direct supervision and that I am a duly registered Professional Engineer under the laws of the State of Minnesota.

Name: *Brian J. Krastoriar*
 Reg. No. 25063 Date 2/10/00

Revisions
 1. Rev. sheet numbers
 Date 2/10/00
 Designed BJK
 Drawn LOC

SHEET TITLE
STREET CONSTRUCTION

OWNER **SIENNA CORPORATION**
 4940 VIKING DRIVE, SUITE 608
 MINNEAPOLIS, MINNESOTA 55435

PROJECT
TPC 9TH ADDITION - PHASE 2

SHEET 15 OF 23 SHEETS

SCALE:
 1"=50'