

STATE OF MINNESOTA  
DEPARTMENT OF TRANSPORTATION  
CONSTRUCTION PLAN FOR BITUMINOUS OVERLAY

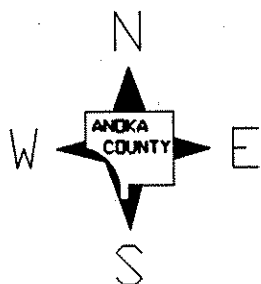

COUNTY STATE AID HIGHWAY NO. \_\_\_\_\_  
COUNTY ROAD NO. 158

From C.S.A.H. 7

To C.R. 58

From \_\_\_\_\_

To \_\_\_\_\_

COUNTY PROJECT NO. 92-22-158

GROSS LENGTH 3461 FEET 0.655 MILES

BRIDGES LENGTH 0 FEET 0 MILES

EXCEPTIONS LENGTH 0 FEET 0 MILES

NET LENGTH 3461 FEET 0.655 MILES

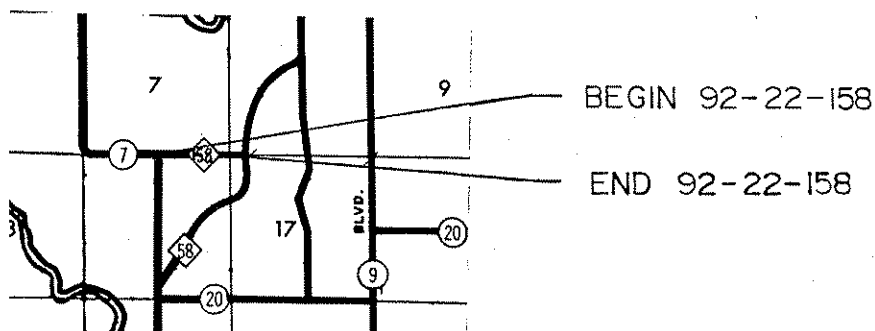

**DESIGN SPEED**

50 MPH.

**GOVERNING SPECIFICATIONS**

THE 1988 EDITION OF THE MINNESOTA DEPARTMENT OF TRANSPORTATION "STANDARD SPECIFICATIONS FOR CONSTRUCTION" AND "SUPPLEMENTAL SPECIFICATIONS TO THE 1988 STANDARD SPECIFICATIONS FOR CONSTRUCTION" DATED 1/2/1991 SHALL GOVERN.

ALL APPLICABLE FEDERAL, STATE AND LOCAL LAWS AND ORDINANCES WILL BE COMPLIED WITH IN THE CONSTRUCTION OF THIS PROJECT.

I HEREBY CERTIFY THAT THIS PLAN WAS PREPARED BY ME OR UNDER MY DIRECT SUPERVISION AND THAT I AM A DULY REGISTERED PROFESSIONAL ENGINEER UNDER THE LAWS OF THE STATE OF MINN.

*Paul K. Rued*  
\_\_\_\_\_  
COUNTY ENGINEER

DATE 5-22-92

**ANOKA**

COUNTY REG. NO. 6549

RECOMMENDED FOR APPROVAL \_\_\_\_\_, 19\_\_\_\_  
DISTRICT ENGINEER

RECOMMENDED FOR APPROVAL \_\_\_\_\_

APPROVED \_\_\_\_\_, 19\_\_\_\_  
STATE AID ENGINEER

COUNTY PROJECT 92-22-158

STATE AID PROJECT \_\_\_\_\_

	ITEM NO	ITEM	UNIT	TOTAL EST. QUANT
①	2123.503	MOTOR GRADER	HOUR	2
	2232.501	MILL BITUMINOUS SURFACE	SQ. YD.	345
②	2331.508	TYPE 41 WEAR COURSE MIXTURE	TON	902
	2357.502	BITUMINOUS MATERIAL FOR TACK COAT	GAL.	547
③	2535.501	BITUMINOUS CURB	LIN. FT.	1400
③	2573.508	BITUMINOUS LINED FLUME	SQ. YD.	28
	2580.501	TEMPORARY LANE MARKING	RD. STA.	35

- ① SHOULDER PREPARATION PRIOR TO PAVING
- ② INCLUDES 42 TONS FOR STREET APPROACHES AND ENTRANCES
- ③ BITUMINOUS CURB & BITUMINOUS LINED FLUME TO BE PLACED AT LOCATIONS DESIGNATED BY THE ENGINEER.

BASIS OF PLANNED QUANTITIES

2331 TYPE 41 WEARING COURSE MIXTURE: 110 LBS/SQ.YD. PER 1"

2357 BITUMINOUS MATERIAL FOR TACK COAT: 0.05 GAL/SQ.YD.

STANDARD DETAIL PLATES	
PLATE NO.	DESCRIPTION
0004 A	SPECIFICATION REFERENCE TO STANDARD PLATES
8000 I	STANDARD BARRICADES
7065 C	BITUMINOUS CURB

# TYPICAL SECTIONS

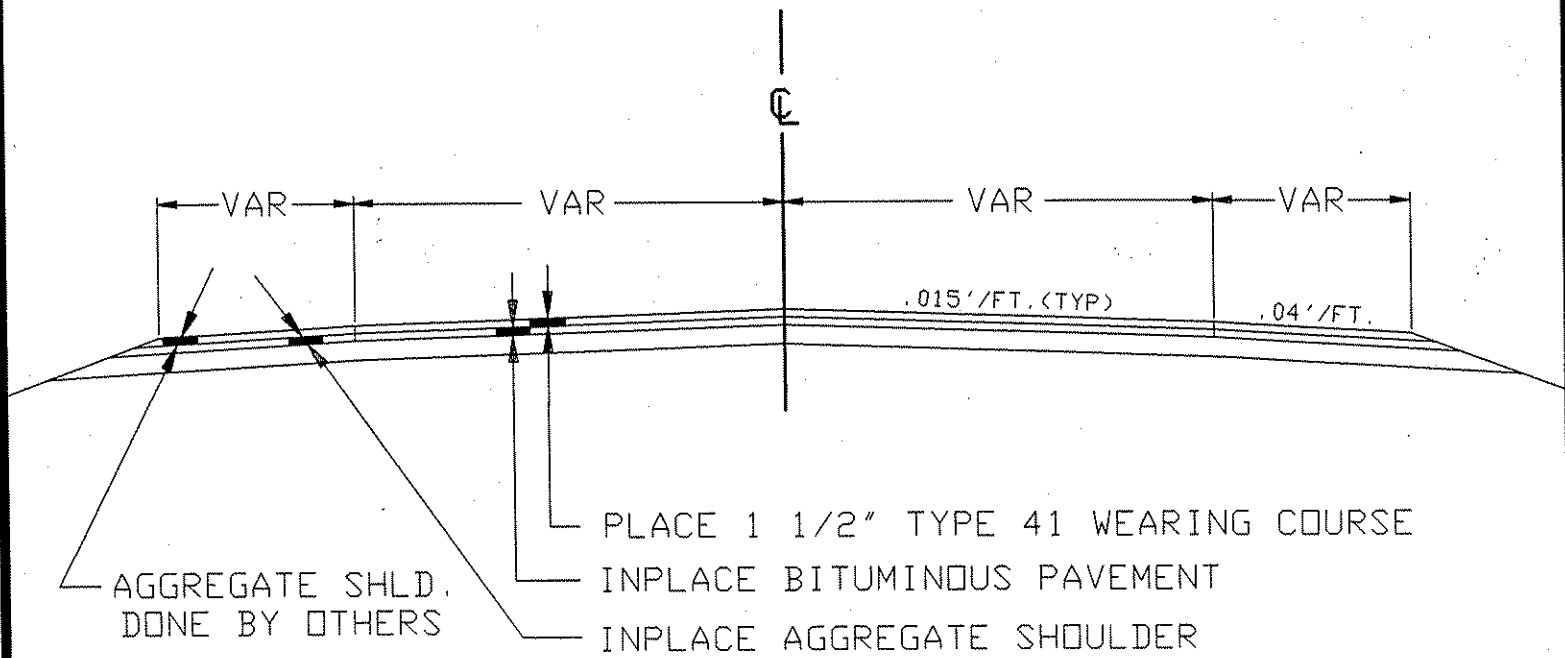

NOTE:  
NOT TO SCALE

# TYPICAL ENTRANCES

