

STATE OF MINNESOTA
 DEPARTMENT OF TRANSPORTATION
 CONSTRUCTION PLAN FOR BIT. MILLING AND OVERLAY,
RECONST. C.B.'S, REPL. CONC. CURB

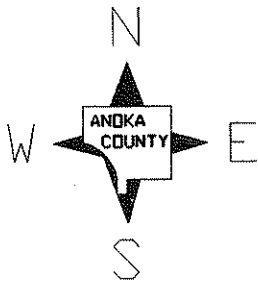

COUNTY STATE AID HIGHWAY NO. 1 (SB ONLY)

From DAKOTAH STREET
 To C.S.A.H. 18
 From _____
 To _____

COUNTY PROJECT NO. 95-34-01

GROSS LENGTH 9458.00 FEET 1.791 MILES
 BRIDGES LENGTH 0.00 FEET 0.000 MILES
 EXCEPTIONS LENGTH 0.00 FEET 0.000 MILES
 NET LENGTH 9458.00 FEET 1.791 MILES

BEGIN C.P. 95-34-01

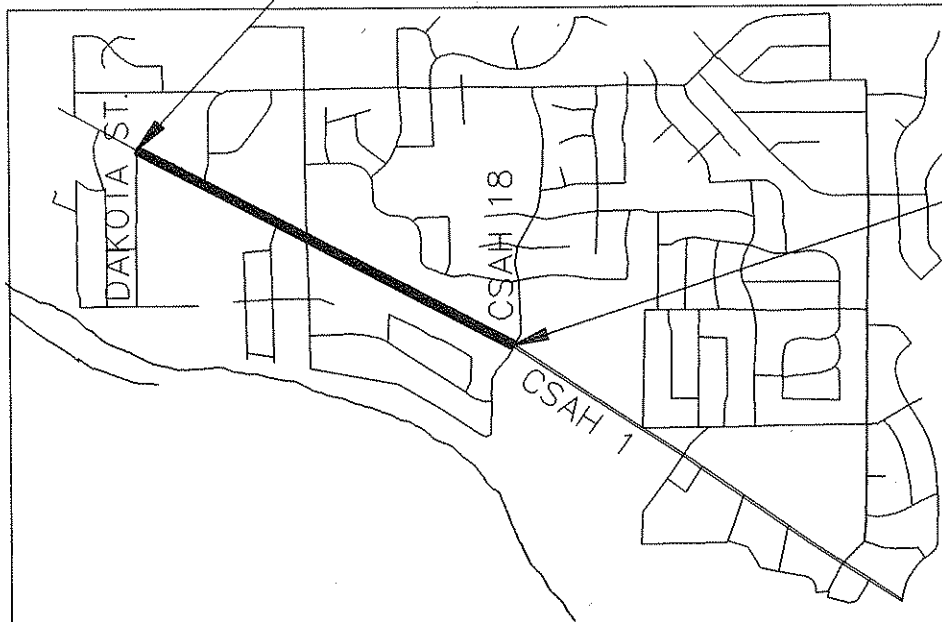

END C.P. 95-34-01

DESIGN SPEED

GOVERNING SPECIFICATIONS

THE 1988 EDITION OF THE MINNESOTA DEPARTMENT OF TRANSPORTATION "STANDARD SPECIFICATIONS FOR CONSTRUCTION", AS AMENDED BY THE MAY 2, 1994 SUPPLEMENTAL SPECIFICATIONS, SHALL GOVERN.

ALL APPLICABLE FEDERAL, STATE AND LOCAL LAWS AND ORDINANCES WILL BE COMPLIED WITH IN THE CONSTRUCTION OF THIS PROJECT.

I HEREBY CERTIFY THAT THIS PLAN WAS PREPARED BY ME OR UNDER MY DIRECT SUPERVISION AND THAT I AM A DULY REGISTERED PROFESSIONAL ENGINEER UNDER THE LAWS OF THE STATE OF MINN.

[Signature]
 DESIGN ENGINEER

REG. NO. 20235

DATE 5/18/95

APPROVED 5/18/95

[Signature]
 ANOKA COUNTY ENGINEER

ITEM NO	ITEM	UNIT	TOTAL EST. QUANT
2104.501	REMOVE CURB & GUTTER	LIN FT	1120
2104.523	SALVAGE CASTING	EACH	11
2232.501	MILL BITUMINOUS SURFACE	SQ YD	26,273
2340.508	TYPE 41 WEARING COURSE MIXTURE	TON	2,365
2357.502	BITUMINOUS MATERIAL FOR TACK COAT	GALLON	1,314
2506.521	INSTALL CASTING	EACH	11
0506.602	REPAIR DRAINAGE STRUCTURE	EACH	11
0506.602	GROUT DRAINAGE STRUCTURE	EACH	12
2531.501	CONCRETE CURB & GUTTER DESIGN B618	LIN FT	450
2531.501	CONCRETE CURB & GUTTER DESIGN B612	LIN FT	670
0565.602	LOOP DETECTORS 6'x 6'	EACH	6
0565.602	LOOP DETECTORS 6'x 20'	EACH	3
2580.501	TEMPORARY LANE MARKING	RD STA	95

DESIGN DESIGNATION

TYPE 41 WEAR: 41WEA50055Y

BASIS OF PLANNED QUANTITIES

2340 WEARING COURSE MIXTURE: 120 LBS./SQ.YD. PER 1" THICKNESS
2357 BITUMINOUS MATERIAL FOR TACK COAT: 0.05 GAL./SQ.YD.

STANDARD DETAIL PLATES	
PLATE NO.	DESCRIPTION
0004 A	SPECIFICATION REFERENCE TO STANDARD PLATES
8000 I	STANDARD BARRICADES

MILLING & RESURFACING TYPICAL

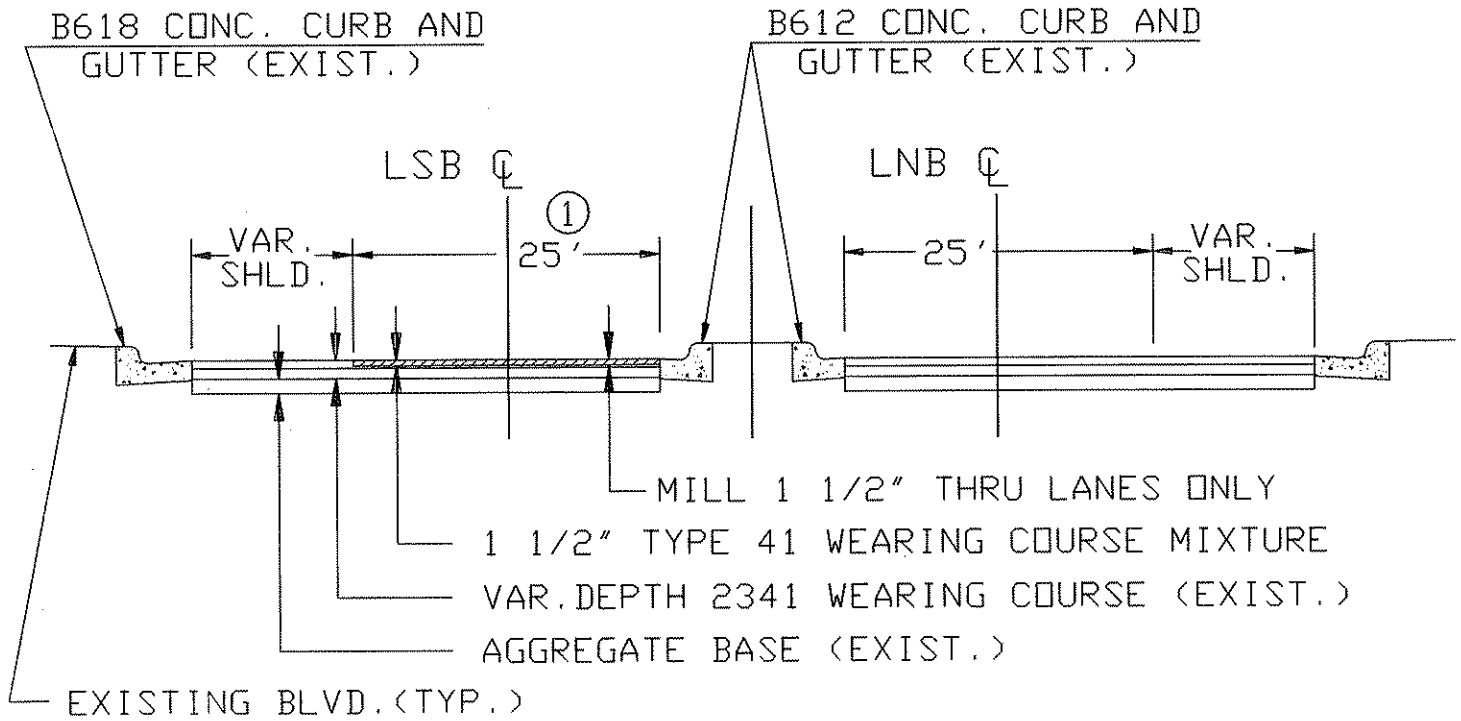

- ① WIDTH MAY VARY IN AREAS OF TURN OR ACCELERATION LANES, ONLY THE TWO THROUGH LSB DRIVING LANES WILL BE MILLED AND RESURFACED. TURN AND ACCELERATION LANES WILL REMAIN AS IS.

NOTE:

NOT TO SCALE

DRAINAGE TABULATION

STATION	LOCATION	SALV. CAST. (EACH)	RECONST. STRUCT. (EACH)	INSTALL CAST. (EACH)	GRDUT STRUCT. (EACH)
20+20	RT.	1	1	1	
22+66	RT.	1	1	1	
26+42	RT.				1
28+43	RT.	1	1	1	
30+05	RT.				1
32+68	RT.	1	1	1	
35+89	RT.				1
39+01	RT.				1
42+02	RT.				1
49+56	RT.	1	1	1	
52+62	RT.				1
54+62	RT.				1
56+62	RT.	1	1	1	
58+62	RT.	1	1	1	
60+61	RT.				1
68+56	RT.				
71+41	RT.	1	1	1	
73+42	RT.	1	1	1	
75+76	RT.				1
80+73	RT.				1
82+79	RT.	1	1	1	
84+27	RT.				
86+81	RT.				
89+30	RT.	1	1	1	
91+32	RT.				1
93+95	RT.				1
TOTALS =		11	11	11	12