

STA. 942 + 00 LT  
 (F) F & I 15" x 36" C.M.P.  
 F & I 2 METAL APRONS

STA. 944 + 09 LT.  
 (F) F & I 15" x 36" C.M.P.  
 F & I 2 METAL APRONS

STA. 955 + 40 RT.  
 (F) INP 18" x 30 C.M.P.  
 REMOVE 30' LIN. FT.

STA. 951 + 45 LT.  
 (F) F & I 15" x 50" C.M.P.  
 F & I 2 METAL APRONS

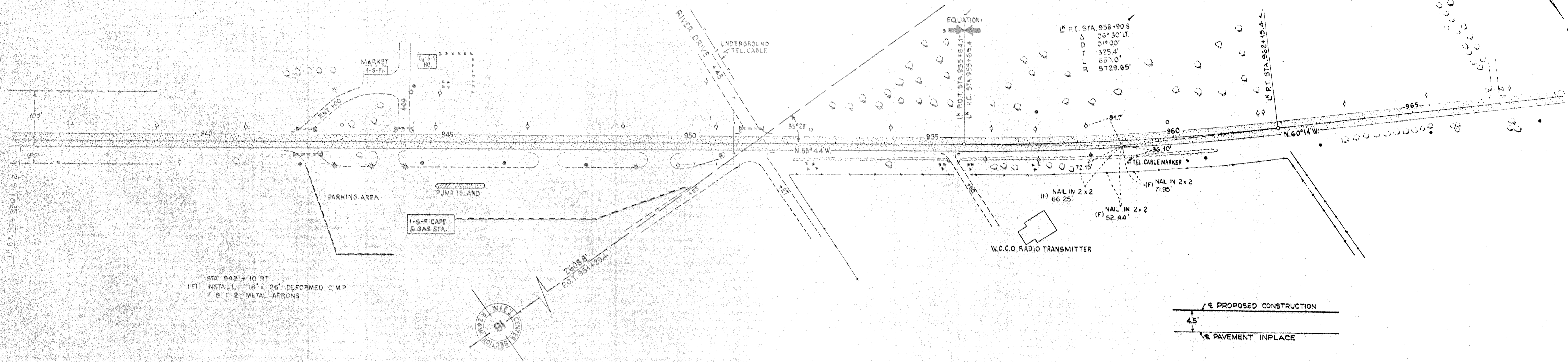

STA. 942 + 10 RT.  
 (F) INSTAL. L 18" x 26" DEFORMED C.M.P.  
 F & I 2 METAL APRONS

