

REMOVE TYPE "D" SIGN	
LOCATION	SIGN
590+50± SB., LT.	JCT. CO. 3, CO. 132
590+50± SB., RT.	JCT. CO. 3, CO. 132
594+00± SB., RT.	UNIVERSITY AVE. NORTH, SOUTH
602+50± SB., RT.	85TH AVENUE
609+00± SB., RT.	JCT. CO. 3, CO. 132
610+50± NB., RT.	JCT. CO. 3, CO. 132
612+00± NB., LT.	85TH AVENUE
620+00± NB., RT.	CO. 3, - RIGHT LANE

SALVAGE TYPE "D" SIGN	
LOCATION	SIGN
602+50± SB., RT.	SPRING BROOK NATURE CENTER
612+00± NB., LT.	SPRING BROOK NATURE CENTER
615+00± NB., RT.	UNIVERSITY AVENUE
	RIGHT TURN ARROW

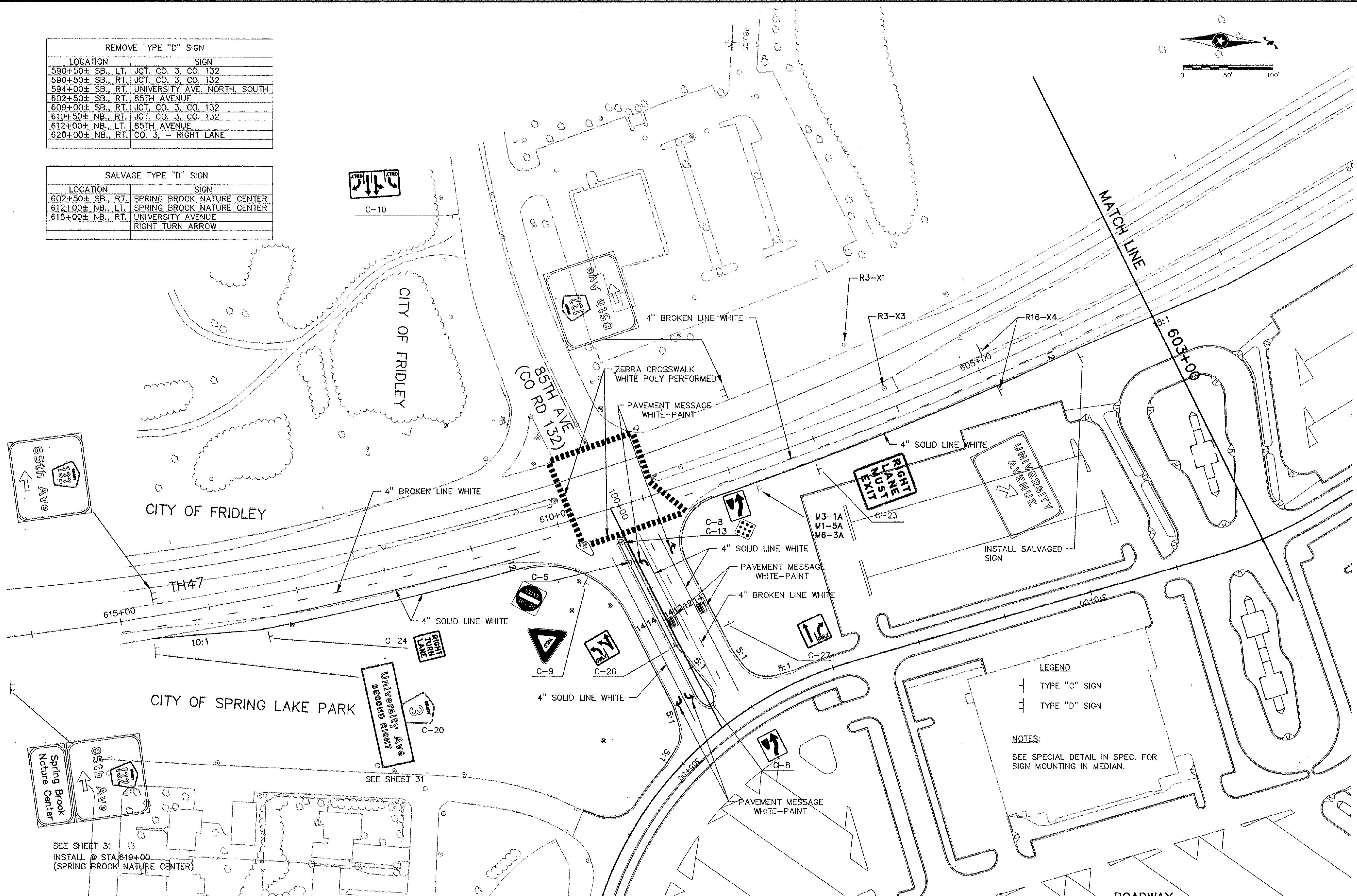
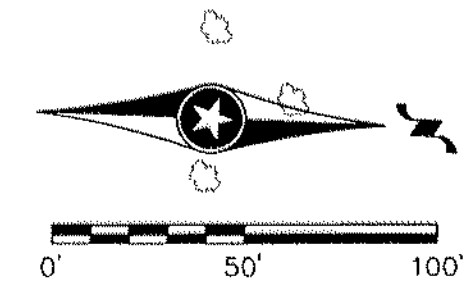

LEGEND
 + TYPE "C" SIGN
 - TYPE "D" SIGN

NOTES:
 SEE SPECIAL DETAIL IN SPEC. FOR SIGN MOUNTING IN MEDIAN.

DRAWING NAME: SIGN1.DWG PLOT DATE: 1-20-97 (AS BUILT)

SEE SHEET 31
 INSTALL @ STA. 619+00.
 (SPRING BROOK NATURE CENTER)

REVISION NO.	EXPLANATION
01-13-97	AS BUILT
SCALE: AS NOTED	DESIGN BY: TJC
PLAN BY: JMB	CHECKED BY: JMB
DATE: 10-14-94	RECORD COPY BY: JMB

I HEREBY CERTIFY THAT THIS PLAN, SPECIFICATION OR REPORT WAS MADE BY ME OR UNDER MY DIRECT SUPERVISION AND THAT I AM A DULY REGISTERED PROFESSIONAL ENGINEER UNDER THE LAWS OF THE STATE OF MINNESOTA.

Ray P. Orndel
 DATE: Feb 9, 1997 REG. NO. 10453

BRW
 PLANNING • TRANSPORTATION • ENGINEERING • URBAN DESIGN
 Thresher Square, 700 Third Street South, Mpls, MN 55415