

PLAN SYMBOLS

- COUNTY LINE
- TOWNSHIP OR RANGE LINE
- SECTION LINE
- QUARTER LINE
- SIXTEENTH LINE
- RIGHT OF WAY LINE
- SLOPE EASEMENT
- PRESENT RIGHT OF WAY
- PROPERTY LINE
- CORPORATE OR CITY LIMITS
- RETAINING WALL
- RAILROAD
- RAILROAD RIGHT OF WAY
- RIVER OR CREEK
- DRAINAGE DITCH
- CULVERT
- DROP INLET
- CAURD RAIL
- BARBED WIRE FENCE
- WOVEN WIRE FENCE
- CHAIN LINK FENCE
- WOOD FENCE
- STONE WALL OR FENCE
- HEDGE
- LOWLAND
- TIMBER
- ORCHARD
- BRUSH
- NURSERY
- CATTLE GAURD
- OVERPASS (Highway Over)
- UNDERPASS (Highway Under)
- BRIDGE
- BUILDING (One Story Frame)
- F-FRAME C-CONCRETE
- S-STONE T-TILE
- B-BRICK ST-STUCCO
- RAILROAD CROSSING BELL
- RAILROAD CROSSING GATE
- MANHOLE
- CATCH BASIN
- FIRE HYDRANT
- CAST IRON MONUMENT
- IRON P.N.
- GRAVEL PIT
- SAND PIT
- BORROW PIT
- ROCK QUARRY

UTILITY SYMBOLS

- POWER POLE LINE
- TELEPHONE OR TELEGRAPH POLE LINE
- JOINT TELEPHONE & POWER ON POWER POLES
- ON TELEPHONE POLES
- ANCHOR
- STEEL TOWER
- STREET LIGHT
- PEDESTAL (Cable Terminal)
- GAS MAIN
- WATERMAIN
- TELEPHONE CABLE IN CONDUIT
- ELECTRIC CABLE IN CONDUIT
- TELEPHONE MANHOLE
- ELECTRIC MANHOLE
- BURIED TELEPHONE CABLE
- BURIED ELECTRIC CABLE
- AERIAL TELEPHONE CABLE
- SEWER (Sanitary or Storm)
- SEWER MANHOLE

SCALES

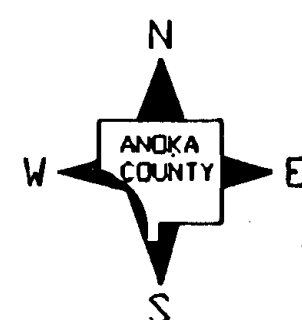
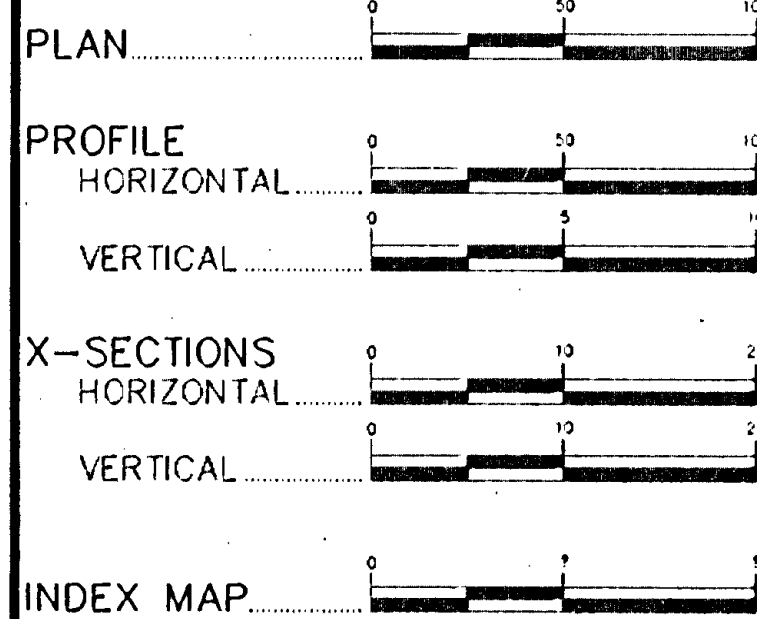

MINNESOTA DEPARTMENT OF TRANSPORTATION

ANOKA COUNTY

CONSTRUCTION PLAN FOR BITUMINOUS OVERLAY

LOCATED ON CSAH 14 IN THE CITY OF CENTERVILLE BETWEEN C.S.A.H. 21 AND LINO LAKES CITY LIMITS, AND
 LOCATED ON CSAH 14 IN THE CITY OF LINO LAKES BETWEEN CENTERVILLE CITY LIMITS AND 24TH AVE.-COUNTY LINE

STATE PROJ. NO. 02-614-20 COUNTY PROJ. NO.

MN PROJ. NO.	COUNTY PROJ. NO.
GROSS LENGTH 9393.00 FEET 1.779 MILES BRIDGES-LENGTH FEET MILES EXCEPTIONS-LENGTH 272.00 FEET 0.052 MILES NET LENGTH 9121.00 FEET 1.727 MILES	GROSS LENGTH FEET MILES BRIDGES-LENGTH FEET MILES EXCEPTIONS-LENGTH FEET MILES NET LENGTH FEET MILES

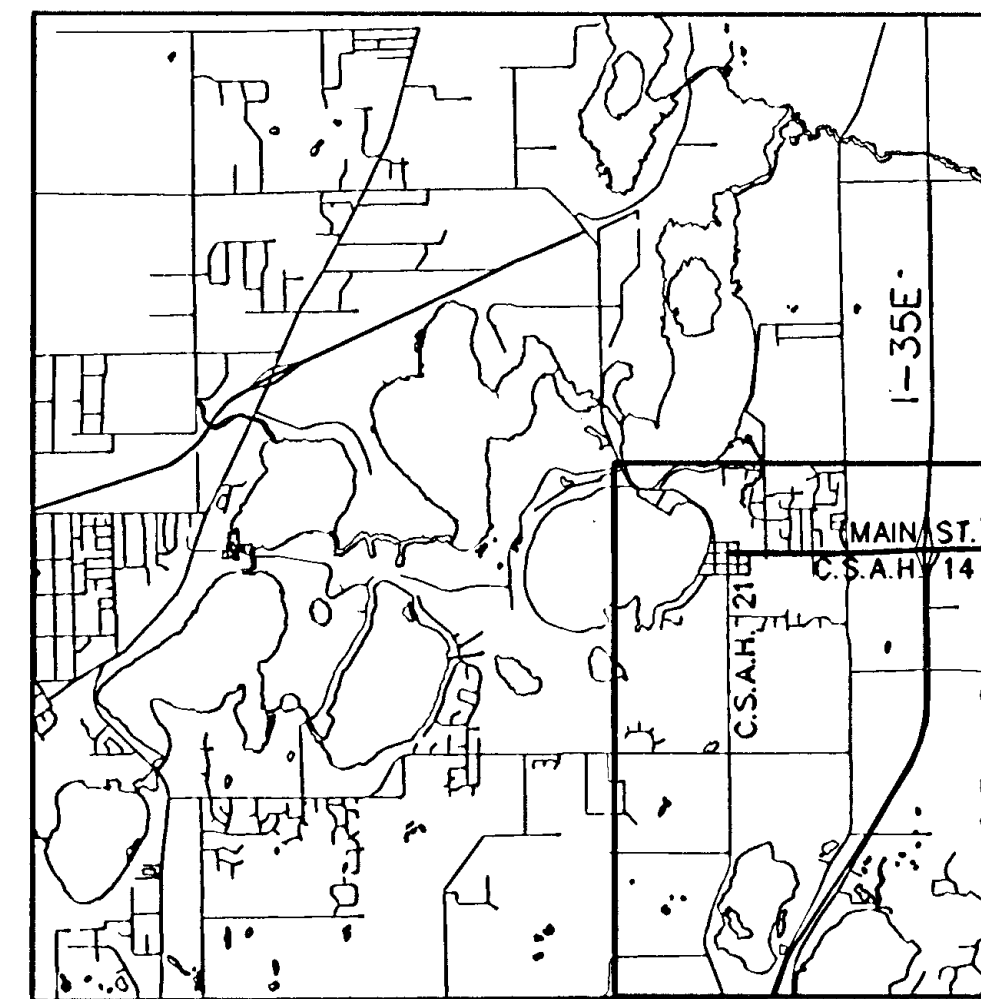
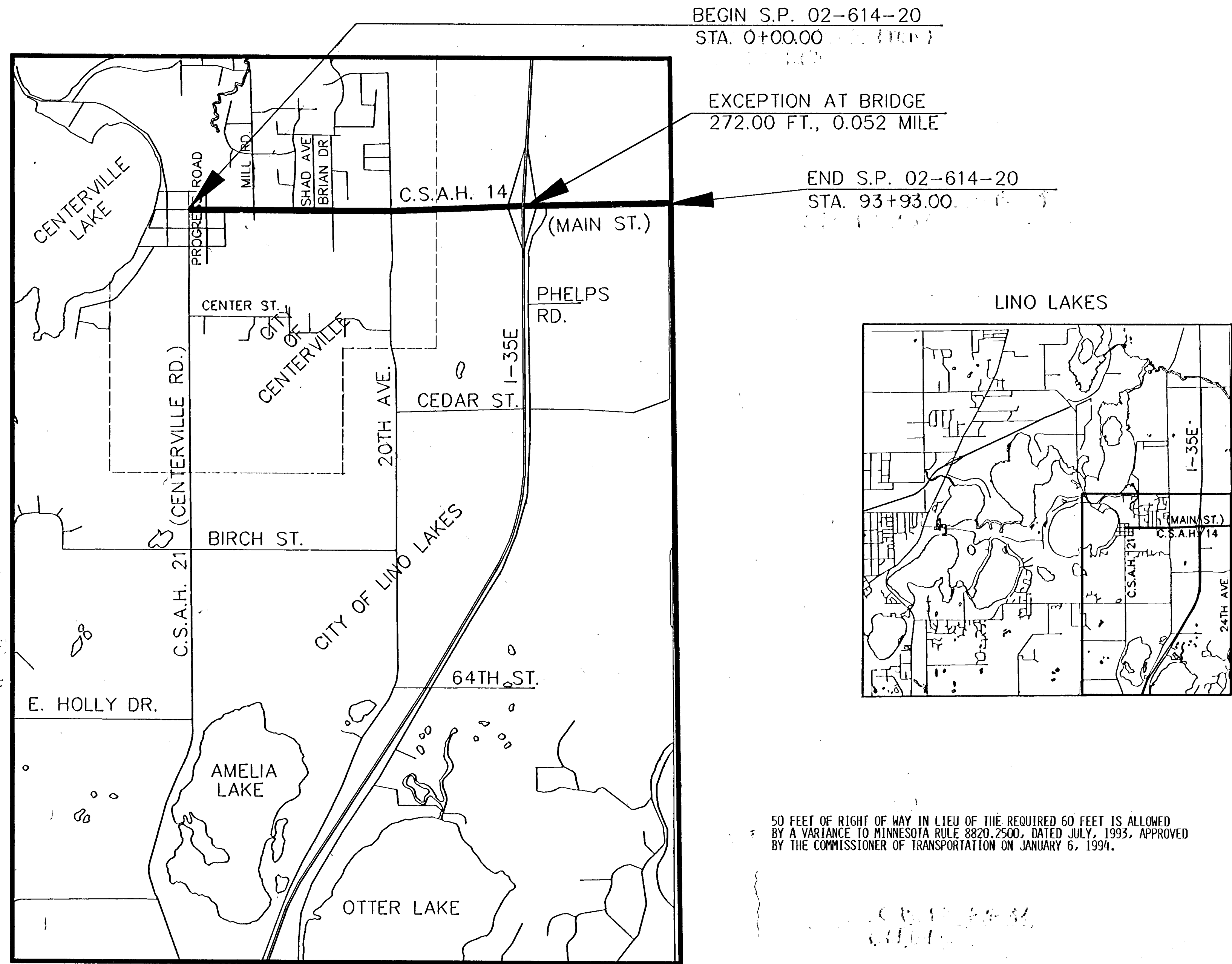

50 FEET OF RIGHT OF WAY IN LIEU OF THE REQUIRED 60 FEET IS ALLOWED BY A VARIANCE TO MINNESOTA RULE 8820.2500, DATED JULY, 1993, APPROVED BY THE COMMISSIONER OF TRANSPORTATION ON JANUARY 6, 1994.

MINN. PROJ. NO. _____
 MINN. PROJ. NO. STP PAVE (010)

GOVERNING SPECIFICATIONS

THE 1988 EDITION OF THE MINNESOTA DEPARTMENT OF TRANSPORTATION "STANDARD SPECIFICATIONS FOR CONSTRUCTION" AS AMENDED BY THE JANUARY 2, 1991 SUPPLEMENTAL SPECIFICATIONS SHALL GOVERN.

INDEX

SHEET NO.	DESCRIPTION
1	TITLE SHEET
2	ESTIMATED QUANTITIES
3	TABULATED QUANTITIES
4	TYPICAL SECTIONS
5	STANDARD DETAILS
6	TRAFFIC CONTROL

THIS PLAN CONTAINS 6 SHEETS

DESIGN DESIGNATION

§1820 NA
 R VALUE NA
 ADT (1993)= 6009
 Proj. ADT (2013)= 10,216
 Proj. HCADT (2013)= 766
 Soil Factor 100%
 9 TON DESIGN
 Shoulder Width 8'-10'

Functional Classification HIGH DENSITY COLLECTOR
 No. of Traffic Lanes 2 No. of Parking Lanes 2
 Design Speed 55+ MPH
 Based on Stopping Sight Distance
 Height of eye 3.5 Height of object 0.5
 Design Speed not achieved at:
 STA. 69+84 TO STA. 81+24 MPH 50
 STA. 24+82 TO STA. 26+82 MPH 35*
 STA. 28+30 TO STA. 31+30 MPH 45**
 * POSTED SPEED IS 30 MPH
 ** POSTED SPEED IS 45 MPH

I HEREBY CERTIFY THAT THIS PLAN WAS PREPARED BY ME OR UNDER MY DIRECT SUPERVISION AND THAT I AM A DULY REGISTERED PROFESSIONAL ENGINEER UNDER THE LAWS OF THE STATE OF MINNESOTA.
 DATE 8/21/93 REG. NO. 20235 ENGR. Douglas M. Kirschner, DESIGN ENGINEER
 DESIGN SQUAD J. TRICK

- Recommended for Approval *Michael R. Kelly* 3/27, 1993
- Recommended for Approval *John Pennington* 8/21, 1993
- Recommended for Approval *Don Kelly* 8/21, 1993
- Approved 3/30, 1993 *Robert K. Kirschner* ANOKA COUNTY ENGINEER
- Approved 9/9, 1993 *David J. Kirschner* ANOKA COUNTY ENGINEER
- Approved 9/25, 1993 *David J. Kirschner* ANOKA COUNTY ENGINEER
- Recommended for Approval *Mark G. Grogan* 11/10, 1993
- Recommended for Approval *Mark G. Grogan* 4-5, 1994
- Approved 4/5, 1994 *Judith Skellman* STATE AID ENGINEER

DEPARTMENT OF TRANSPORTATION
 FEDERAL HIGHWAY ADMINISTRATION

APPROVED _____
 DIVISION ADMINISTRATOR DATE