

PLAN SYMBOLS

- COUNTY LINE
- TOWNSHIP OR RANGE LINE
- SECTION LINE
- QUARTER LINE
- SIXTEENTH LINE
- RIGHT OF WAY LINE
- SLOPE EASEMENT
- PRESENT RIGHT OF WAY
- PROPERTY LINE
- CORPORATE OR CITY LIMITS
- RETAINING WALL
- RAILROAD
- RAILROAD RIGHT OF WAY
- RIVER OR CREEK
- DRAINAGE DITCH
- CULVERT
- DROP INLET
- GAUZO RAIL
- BARBED WIRE FENCE
- WOVEN WIRE FENCE
- CHAIN LINK FENCE
- WOOD FENCE
- STONE WALL OR FENCE
- HEDGE

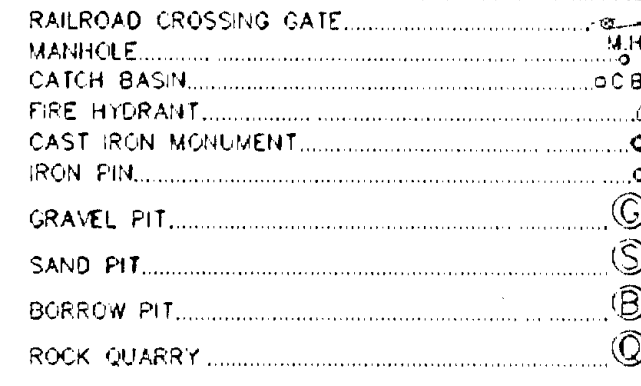
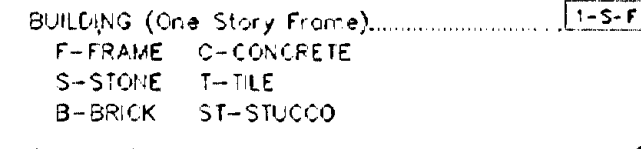
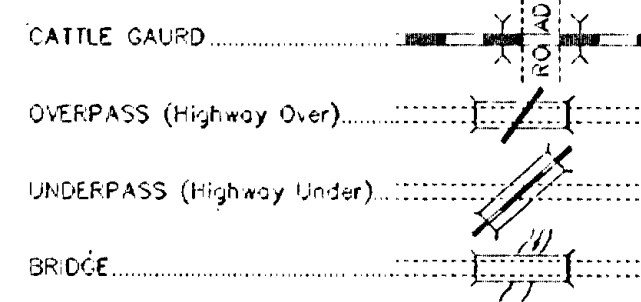
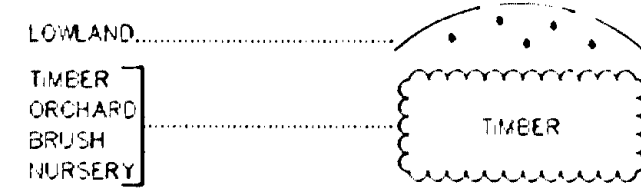

UTILITY SYMBOLS

- POWER POLE LINE
- TELEPHONE OR TELEGRAPH POLE LINE
- JOINT TELEPHONE & POWER ON POWER POLES
- ON TELEPHONE POLES
- ANCHOR
- STEEL TOWER
- STREET LIGHT
- PEDESTAL (Cable Terminal)
- GAS MAIN
- WATERMAIN
- TELEPHONE CABLE IN CONDUIT
- ELECTRIC CABLE IN CONDUIT
- TELEPHONE MANHOLE
- ELECTRIC MANHOLE
- BURIED TELEPHONE CABLE
- BURIED ELECTRIC CABLE
- AERIAL TELEPHONE CABLE
- SEWER (Sanitary or Storm)
- SEWER MANHOLE

SCALES

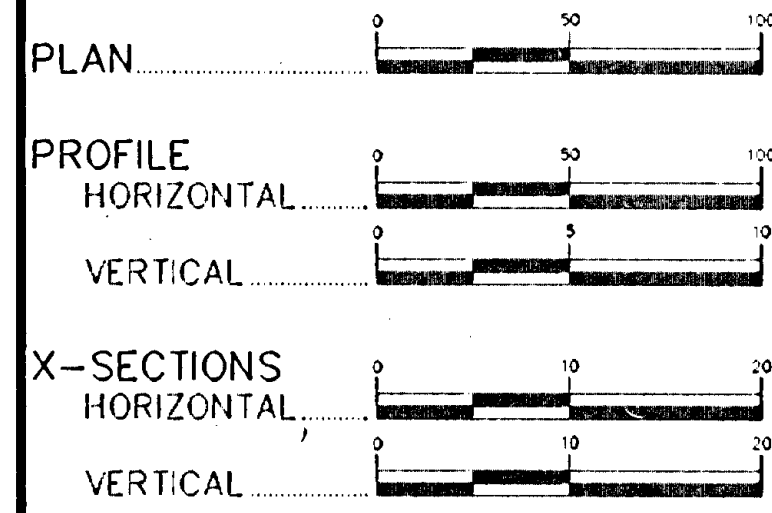

INDEX MAP NOT TO SCALE

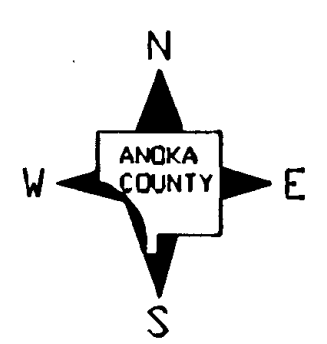

MINNESOTA DEPARTMENT OF TRANSPORTATION

ANOKA COUNTY

CONSTRUCTION PLAN FOR BITUMINOUS OVERLAY

LOCATED ON C.S.A.H. 22 BETWEEN LIMITS OF EAST BETHEL AND EAST COUNTY LINE (Geographic Description)

STATE PROJ. NO. 02-622-25

COUNTY PROJ. NO.

MN PROJ. NO.

GROSS LENGTH 41,793.00 FEET 7.915 MILES
 BRIDGES-LENGTH FEET MILES
 EXCEPTIONS-LENGTH FEET MILES
 NET LENGTH 41,793.00 FEET 7.915 MILES

GROSS LENGTH FEET MILES
 BRIDGES-LENGTH FEET MILES
 EXCEPTIONS-LENGTH FEET MILES
 NET LENGTH FEET MILES

LINWOOD TOWNSHIP

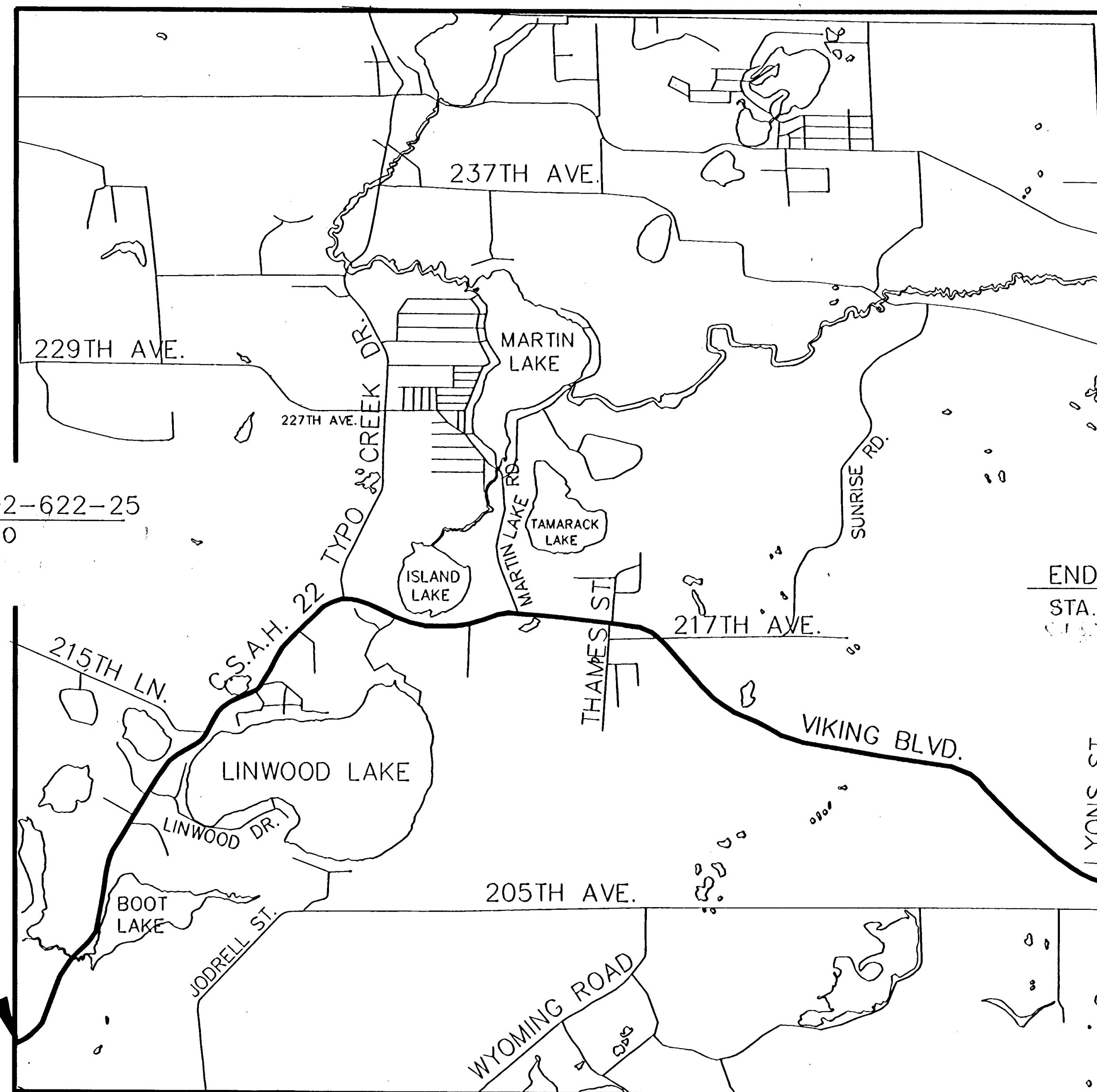

BEGIN S.P. 02-622-25
 STA. 184+04.00

END S.P. 02-622-25
 STA. 1601+97.00

MINN. PROJ. NO.
 MINN. PROJ. NO. STP PAVE (010)

GOVERNING SPECIFICATIONS

THE 1988 EDITION OF THE MINNESOTA DEPARTMENT OF TRANSPORTATION "STANDARD SPECIFICATIONS FOR CONSTRUCTION" AS AMENDED BY THE JANUARY 2, 1991 SUPPLEMENTAL SPECIFICATIONS SHALL GOVERN.

INDEX

SHEET NO.	DESCRIPTION
1	TITLE SHEET
2	ESTIMATED QUANTITIES
3-5	TABULATED QUANTITIES
6	TYPICAL QUANTITIES
7	STANDARD DETAILS
8	TRAFFIC CONTROL

THIS PLAN CONTAINS 8 SHEETS

DESIGN DESIGNATION

≤18₂₀ NA
 R VALUE NA
 ADT (1993)= 4556
 Proj. ADT (2013)= 7745
 Proj. HCADT (2013)= 581
 Soil Factor 50%
 9 TON DESIGN
 Shoulder Width 8'-10'
 Functional Classification
 No. of Traffic Lanes 2 No. of Parking Lanes 0
 Design Speed MPH 55
 Based on Stopping Sight Distance
 Height of eye 3.5 Height of object 0.5
 Design Speed not achieved at:
 STA. 297+84 TO STA. 303+84 MPH 45
 STA. 342+24 TO STA. 346+24 MPH 40
 STA. 360+24 TO STA. 366+24 MPH 45
 STA. 371+24 TO STA. 381+74 MPH 45
 STA. 386+69 TO STA. 390+69 MPH 45

I HEREBY CERTIFY THAT THIS PLAN WAS PREPARED BY ME OR UNDER MY DIRECT SUPERVISION AND THAT I AM A DULY REGISTERED PROFESSIONAL ENGINEER UNDER THE LAWS OF THE STATE OF MINNESOTA.

DATE 8/27/93 REG. NO. 20235 ENGR. *[Signature]* ANOKA COUNTY DESIGN ENGINEER
 DESIGN SQUAD J. TRICK

Recommended for Approval *[Signature]* 8/27, 1993
 Recommended for Approval *[Signature]* 8/27, 1993
 Recommended for Approval *[Signature]* 8/27, 1993
 Approved 8/30, 1993
 Approved 9-2, 1993
 Recommended for Approval *[Signature]* 11/2, 1993
 Recommended for Approval *[Signature]* 1993
 Approved 4/5, 1994

DEPARTMENT OF TRANSPORTATION
 FEDERAL HIGHWAY ADMINISTRATION
 APPROVED _____
 DIVISION ADMINISTRATOR DATE