

- All signs High Intensity sheeting
- Location of signs is approximate. Exact locations to be determined in the field by the engineer.
- All signs and barricades will be properly weighted with sandbags.
- All barricades will have reflective material on both sides.
- All barricade markings will be slanted in accordance with the "Minnesota Manual on Uniform Traffic Control Devices".
- All traffic control devices shall conform to the "Minnesota Manual on Uniform Traffic Control Devices", including Appendix B, dated March 1990.
- Additions or changes to this plan may be made at any time as determined by the engineer.

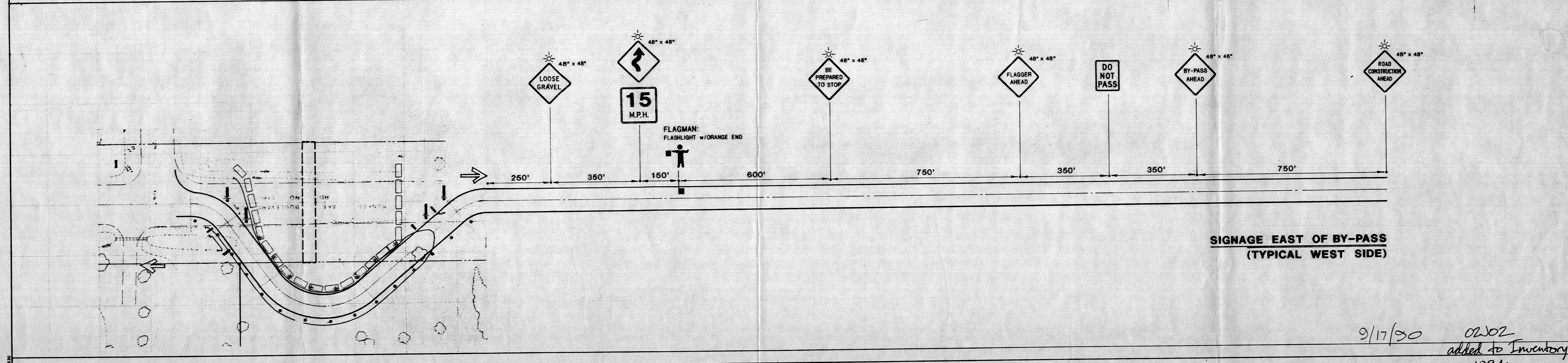

9/17/90 02/02  
added to Inventory  
1994

**MERILA & ASSOCIATES**  
 ENGINEERING SURVEYING & CONSULTING  
 4407 7th Avenue North, Suite 601  
 Brooklyn Park, Minnesota 55428  
 Telephone (612) 533-7500  
 Fax (612) 533-9437

I hereby certify that this plan, specification or report was prepared by me or under my direct supervision and that I am a duly Licensed Professional Engineer under the laws of the State of Minnesota.

Date: \_\_\_\_\_  
 Title: \_\_\_\_\_  
 No. \_\_\_\_\_

**Majestic Oaks**  
**BUNKER LAKE BOULEVARD**  
**DETOUR PLAN**

90-009  
 1 of 2

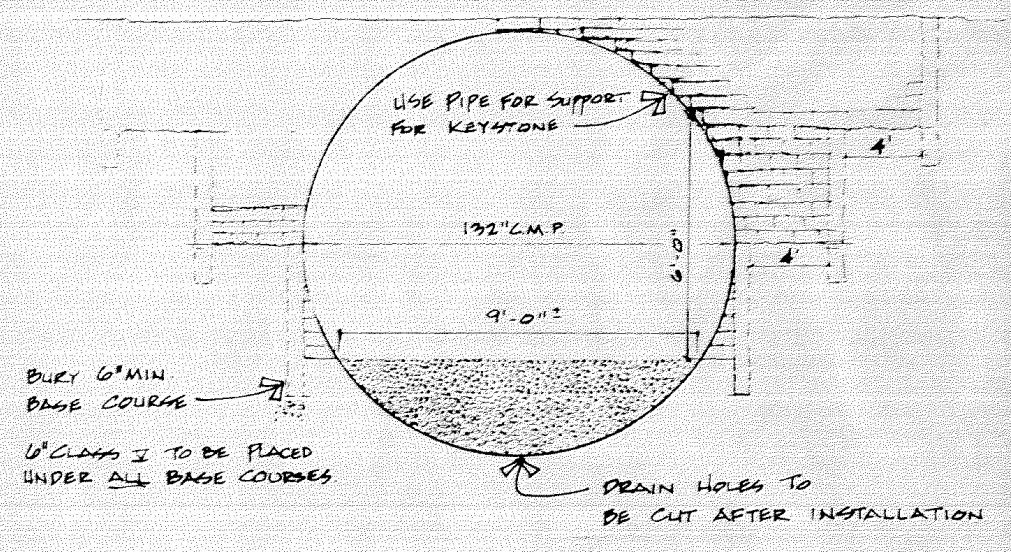
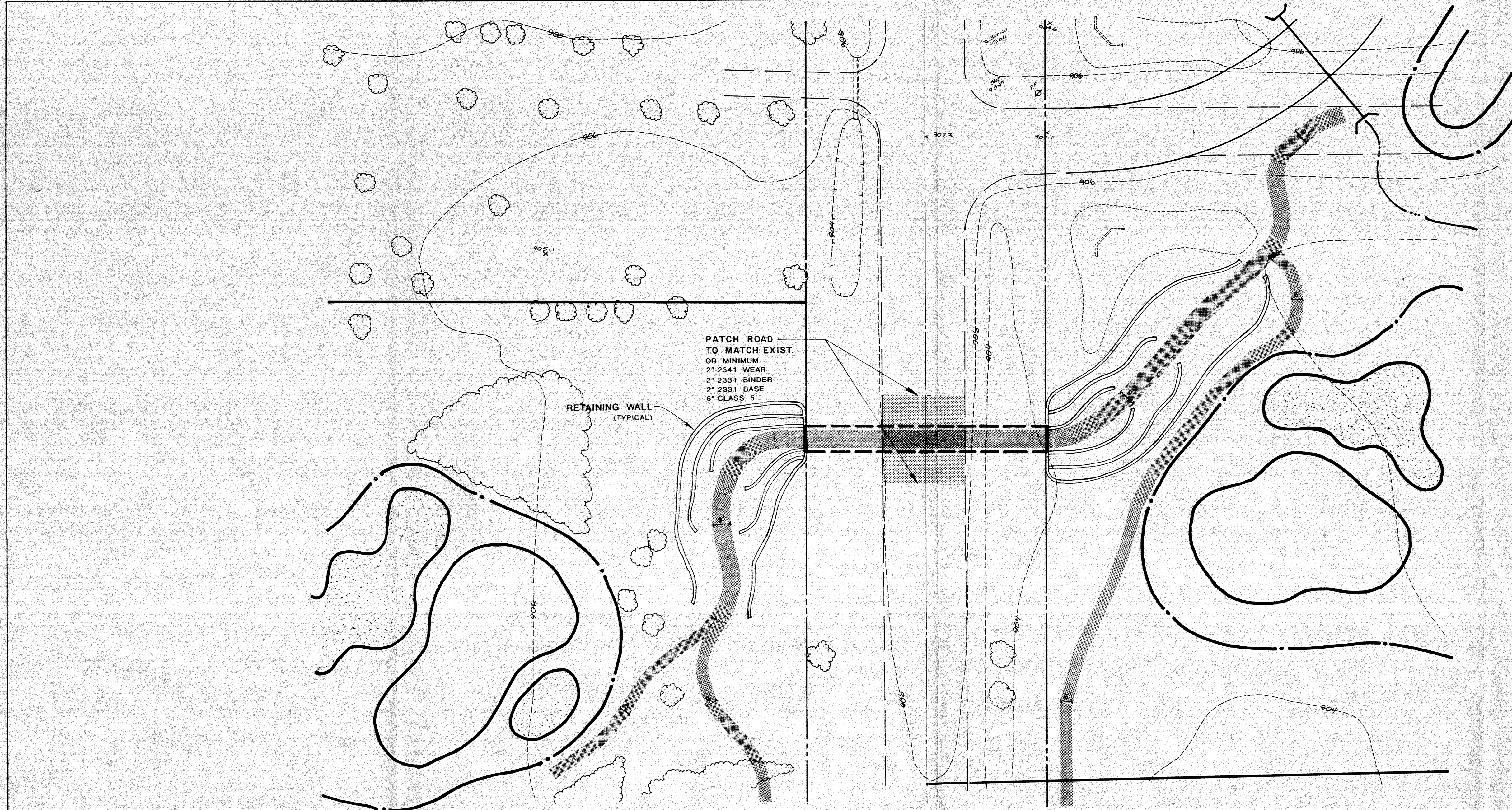

**RETAINING WALL END SECTION**

**NOTES:**

**COMPACTION REQUIREMENTS:**  
 BACKFILL SHALL BE COMPACTED TO A MINIMUM OF 97% OF STANDARD PROCTOR DENSITY TO 3 FEET BELOW THE FINAL GRADE. THE TOP 3 FEET SHALL BE COMPACTED TO 100% OF STANDARD PROCTOR DENSITY.

**RESTORATION:**  
 DITCH AREAS SHALL BE RESTORED WITH 4" TOPSOIL AND A MNDOT TYPE 500 SEED MIXTURE.

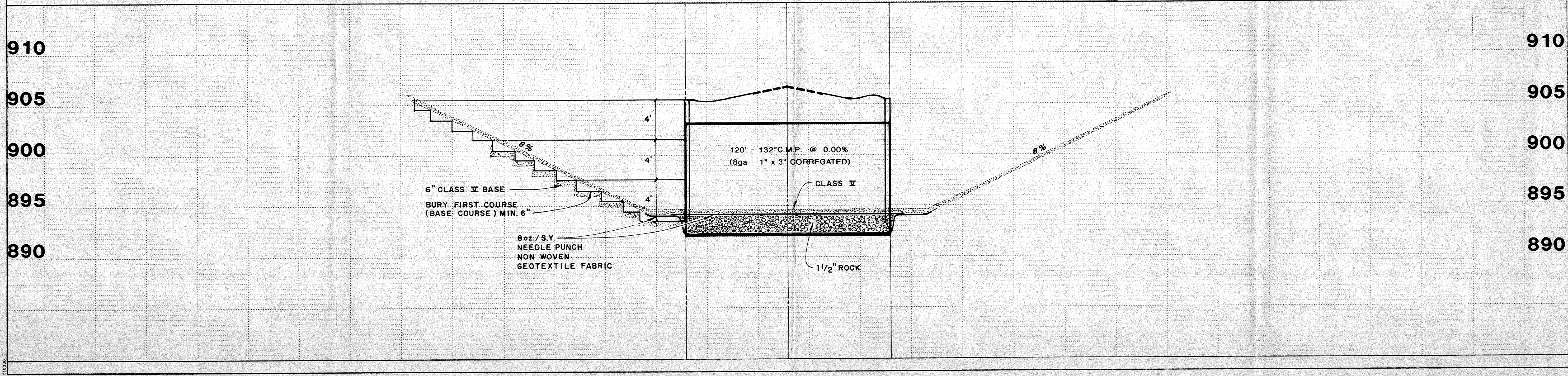

8401 73rd Avenue North, Suite 63  
 Brooklyn Park, Minnesota 55428  
 Phone: (763) 759-7590  
 Fax: (763) 583-1837

**MERILA & ASSOCIATES**  
 ENGINEERING SURVEYING PLANNING

Copyright © 1990 by MERILA & ASSOCIATES

---

DATE: \_\_\_\_\_ REVISION DESCRIPTION: \_\_\_\_\_ BY: \_\_\_\_\_

**Majestic Oaks**  
 BUNKER LAKE BOULEVARD  
**RETAINING WALL & GOLF CART UNDER PASS**

DESIGNED: \_\_\_\_\_  
 DRAWN: \_\_\_\_\_  
 CHECKED: \_\_\_\_\_  
 FILE NO: 90-009

SHEET **2** of **2**