

PLANS SYMBOLS

STATE LINE	----
COUNTY LINE	----
TOWNSHIP OR RANGE LINE	----
SECTION LINE	----
QUARTER LINE	----
SIXTEENTH LINE	----
RIGHT-OF-WAY LINE	----
SLOPE EASEMENT	----
PRESENT RIGHT-OF-WAY LINE	----
CONTROL OF ACCESS LINE	----
PROPERTY LINE (EXCEPT LAND LINES)	----
VACATED PLATTED PROPERTY	----
CORPORATE OR CITY LIMITS	----
TRUNK HIGHWAY CENTER LINE	----
RETAINING WALL	----
RAILROAD	----
RAILROAD RIGHT-OF-WAY LINE	----
RIVER OR CREEK	----
DRY RUN	----
DRAINAGE DITCH	----
DRAIN TILE	----
CULVERT	----
DROP PALET	----
GUARD RAIL	----
BANDED WIRE FENCE	----
WOOLEN WIRE FENCE	----
CHAIN LINK FENCE	----
RAILROAD SHOW FENCE	----
STONE WALL OR FENCE	----
HEDGE	----
RAILROAD CROSSING SIGN	----
RAILROAD CROSSING BELL	----
ELECTRIC WARNING SIGN	----
CROSSING GATE	----
NEARBY CORNER	----
SPRINGS	----
MARSH	----
TIMBER	----
ORCHARD	----
BRUSH	----
MURSERY	----
CATCH BASIN	----
FIRE HYDRANT	----
CATTLE GUARD	----
OVERPASS (Highway Over)	----
UNDERPASS (Highway Under)	----
BRIDGE	----
BUILDING (One Story Frame)	----
F - FRAME	C - CONCRETE
S - STONE	T - TILE
B - BRICK	ST - STUCCO
SIGN (PIE OR ROD)	----
MONUMENT (STONE, CONCRETE, OR METAL)	----
WOODEN HUB	----
GRAVEL PIT	----
SAND PIT	----
DRAINAGE PIT	----
ROCK QUARRY	----

UTILITIES SYMBOLS

POWER POLE LINE	----
TELEPHONE OR TELEGRAPH POLE LINE	----
JOINT TELEPHONE AND POWER ON POWER POLES	----
ON TELEPHONE POLES	----
ANCHOR	----
STEEL TOWER	----
STREET LIGHT	----
FEDESTAL (TELEPHONE CABLE TERMINAL)	----
GAS MAIN	----
WATER MAIN	----
CONDUIT	----
TELEPHONE CABLE IN CONDUIT	----
ELECTRIC CABLE IN CONDUIT	----
TELEPHONE MANHOLE	----
ELECTRIC MANHOLE	----
BURIED TELEPHONE CABLE	----
BURIED ELECTRIC CABLE	----
AERIAL TELEPHONE CABLE	----
SEWER (SANITARY OR STORM)	----
SEWER MANHOLE	----

SCALES

PLAN
PROFILE
INDEX MAP
GENERAL LAYOUT

MINNESOTA DEPARTMENT OF TRANSPORTATION

ANOKA COUNTY

CONSTRUCTION PLAN FOR C.S.A.H. 11 (NORTHDAL BLVD.)

LOCATED ON **C.S.A.H. 11** BETWEEN **EAGLE STREET** AND **XEON STREET** (Geographic Description)

FROM **342.35' EAST OF S.W. CORNER OF SEC. 11** TO **642.35' EAST OF S.W. CORNER OF SEC. 11** (Legal Description)

COUNTY PROJ. NO. **02-611-24**

STATE AID PROJ. NO. **02-611-24**

GROSS LENGTH **300.00** FEET **0.057** MILES
 BRIDGES-LENGTH **44.08** FEET **0.009** MILES
 EXCEPTIONS-LENGTH FEET MILES
 NET LENGTH **255.58'** FEET **0.048** MILES

GROSS LENGTH FEET MILES
 BRIDGES-LENGTH FEET MILES
 EXCEPTIONS-LENGTH FEET MILES
 NET LENGTH FEET MILES

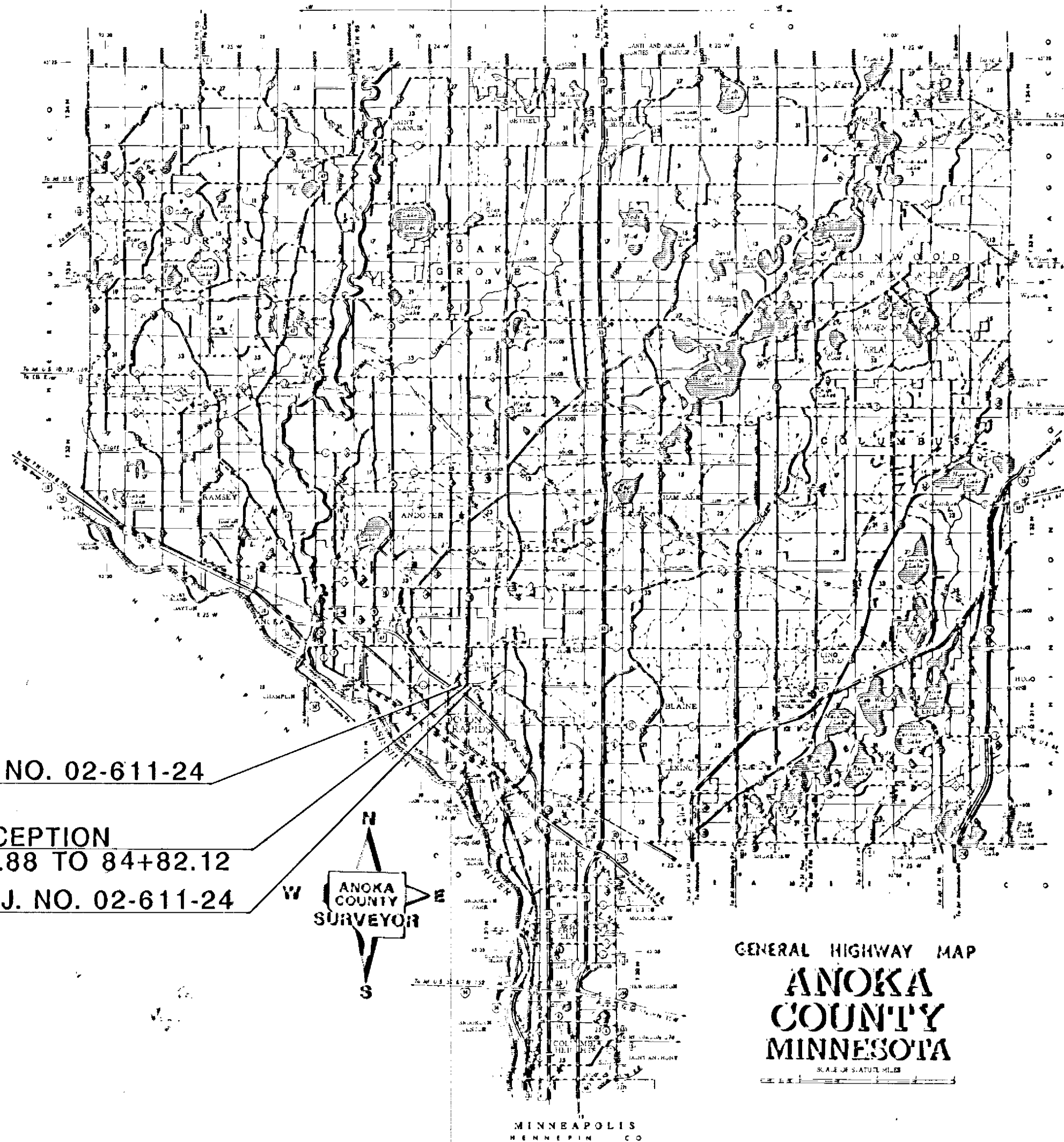

BEGIN ANOKA CO. PROJ. NO. 02-611-24
 STA. 83+00

BRIDGE EXCEPTION
 STA. 83+97.88 TO 84+82.12

END ANOKA CO. PROJ. NO. 02-611-24
 STA. 86+00

GENERAL HIGHWAY MAP
ANOKA COUNTY
MINNESOTA

MINN. PROJ. NO.
 MINN. PROJ. NO.

GOVERNING SPECIFICATIONS

THE 1988 EDITION OF THE MINNESOTA DEPARTMENT OF TRANSPORTATION "STANDARD SPECIFICATIONS FOR CONSTRUCTION" SHALL GOVERN.

INDEX

SHEET NO. 1	TITLE SHEET
2	ESTIMATED QUANTITIES, TYPICAL SECTIONS,
3	DETAILS
4	PLAN & PROFILE
5	EROSION CONTROL
6-7	CROSS SECTION
7a-7b	TRAFFIC CONTROL

THIS PLAN CONTAINS 7 SHEETS

DESIGN DESIGNATION

ΣN18₂₀ **1,334,000**
 R Value **70**
 ADT (1989) = **13,804**
 Proj. ADT (2010) = **19265**
 Proj. HCADT (2010) = **1600**
 Soil Factor **A-3**
 **9** Ton Design
 Shoulder Width

Design Speed **50** MPH
 Based on Stopping Sight Distance
 Height of eye **3.5'** Height of object **0.5'**
 Design Speed not achieved at:
 STA. TO STA. MPH
 STA. TO STA. MPH
 STA. TO STA. MPH

I HEREBY CERTIFY THAT THIS PLAN WAS PREPARED BY ME OR UNDER MY DIRECT SUPERVISION AND THAT I AM A DULY REGISTERED PROFESSIONAL ENGINEER UNDER THE LAWS OF THE STATE OF MINNESOTA.

DATE 12/22/89 REG. NO. 18612 ENGR. Gordon Owen Moore

COUNTY

Recommended for Approval 19
 DISTRICT STATE AID ENGINEER

Recommended for Approval 19
 STATE AID PLANS AND SPECS ENGINEER

Approved 19
 STATE AID ENGINEER

DEPARTMENT OF TRANSPORTATION
 FEDERAL HIGHWAY ADMINISTRATION
 APPROVED

COUNTY PROJ. NO. **02-611-24**
 STATE PROJ. NO. **02-611-24** SHEET NO. **1** OF **7** SHEETS

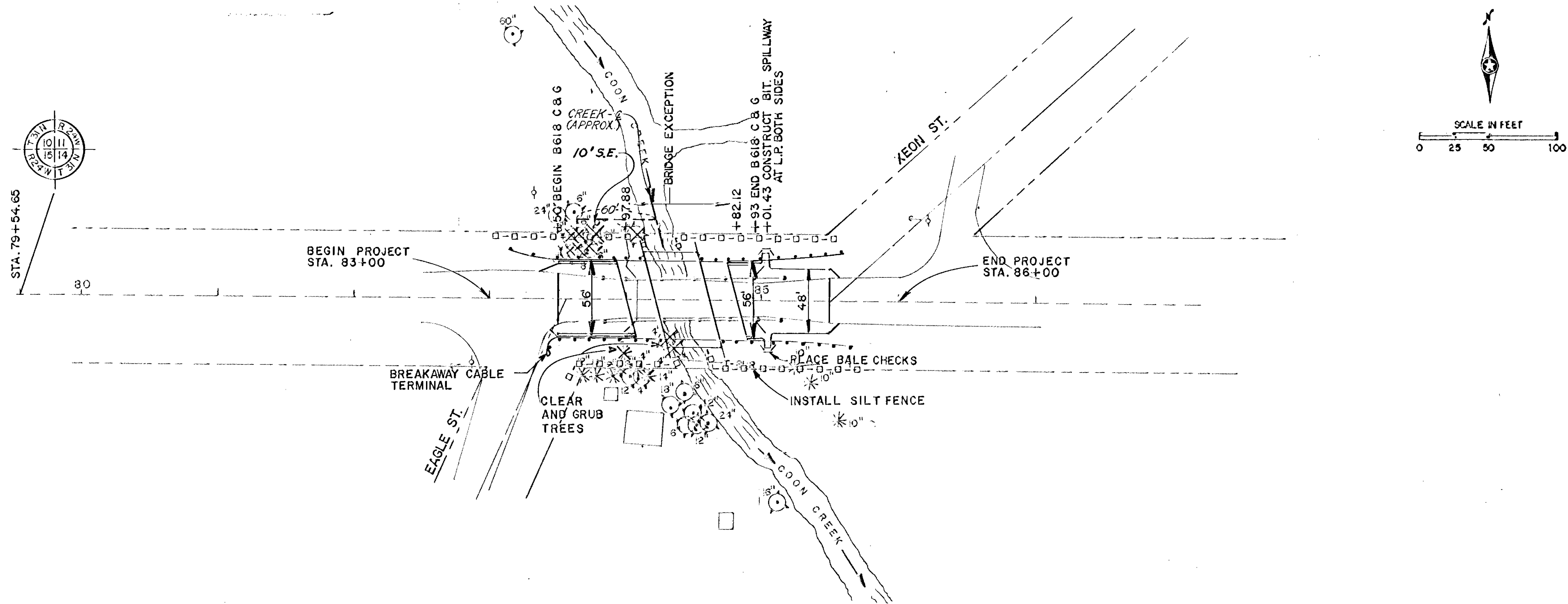

C.S.A.H. NO. 11 (NORTHDALE BLVD.)

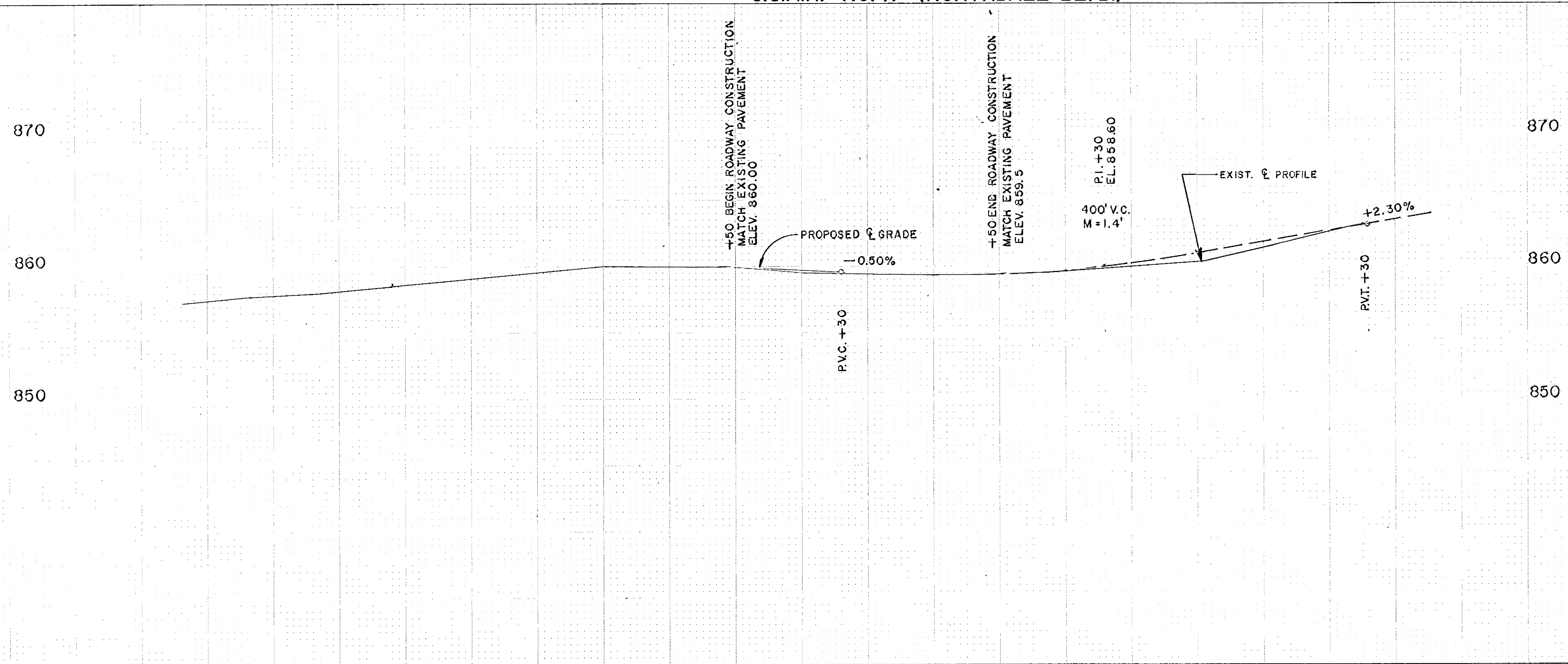

		80+00	81+00	82+00	83+00	84+00	85+00	86+00	87+00	88+00	89+00	90+00	FILE NO. 89129	4	
													DATE 10/23/89	7	
NO.	BY	DATE	REVISIONS	ITEM	DESIGN	CHECKED	I hereby certify that this plan was prepared by me or under my direct supervision and that I am a duly Registered Professional Engineer under the laws of the state of Minnesota. <i>Jason Green Mason</i> Date 10/27/89 Reg. No. 18612					ANOKA CO., MINNESOTA		PLAN & PROFILE	

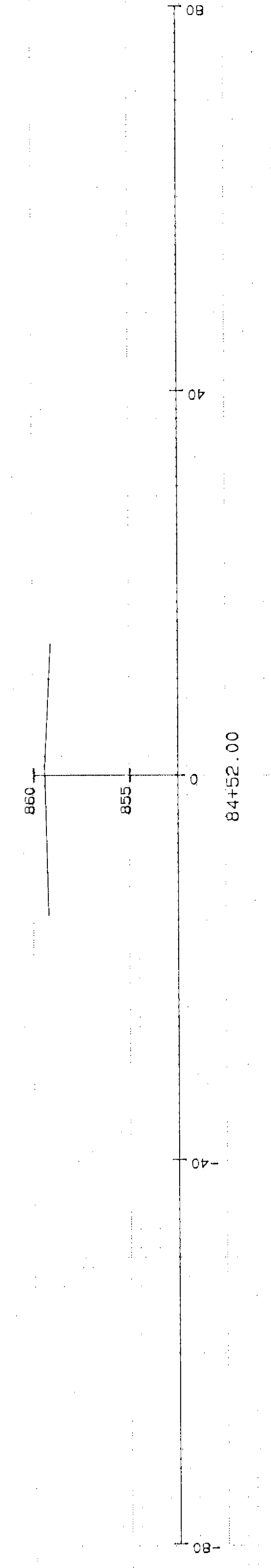
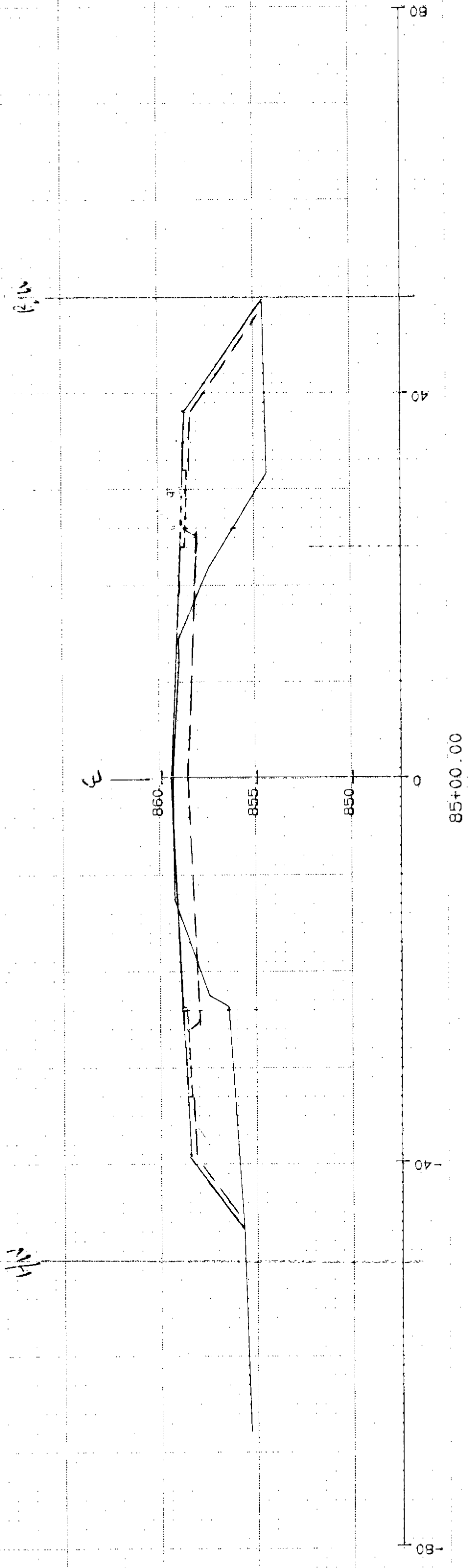
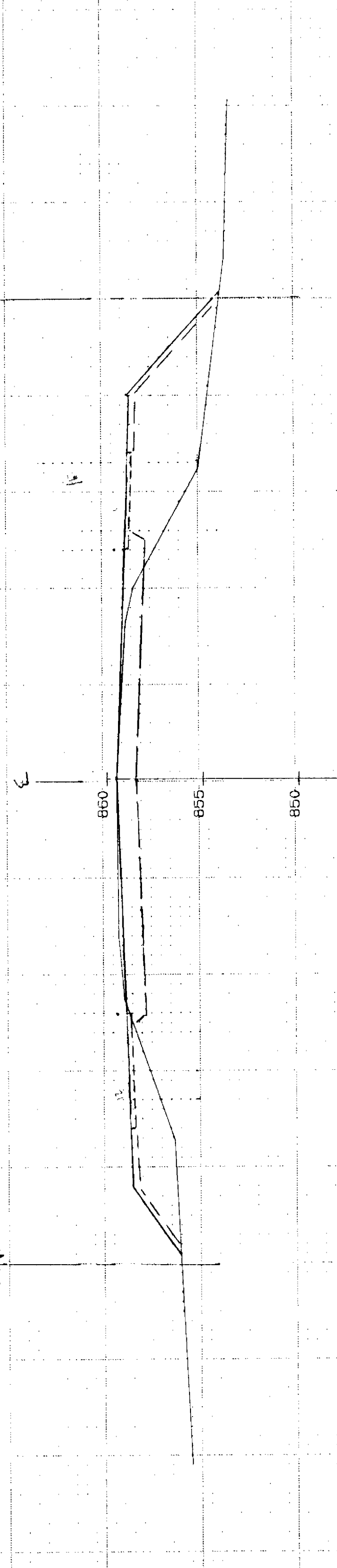
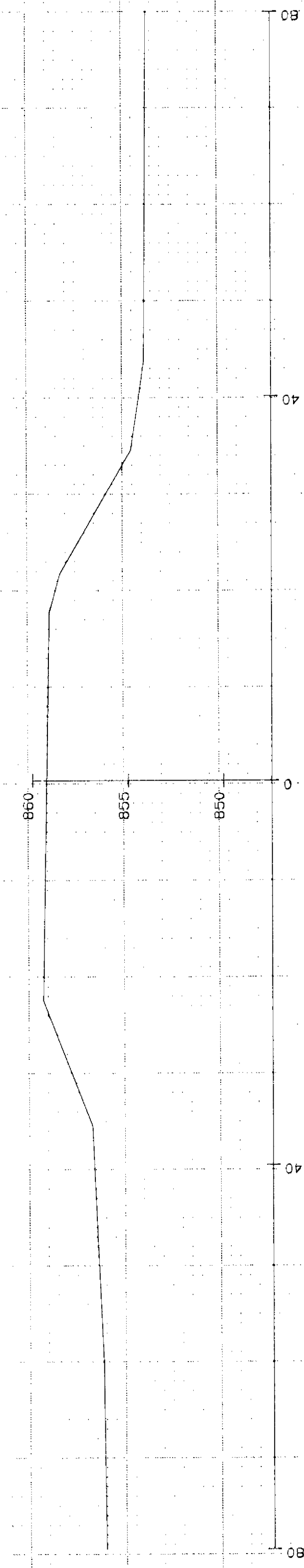
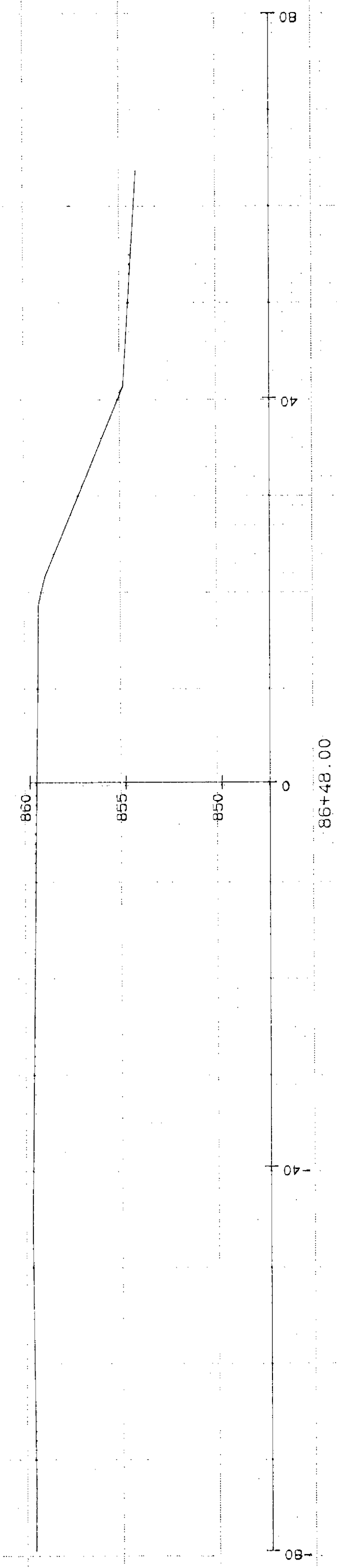
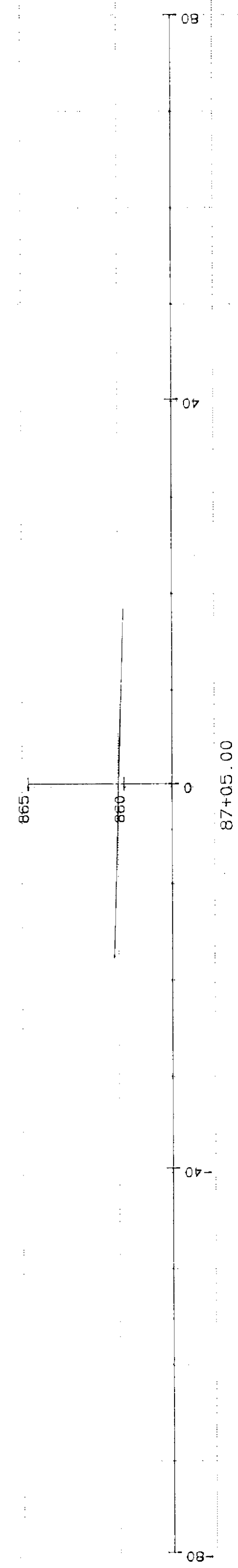

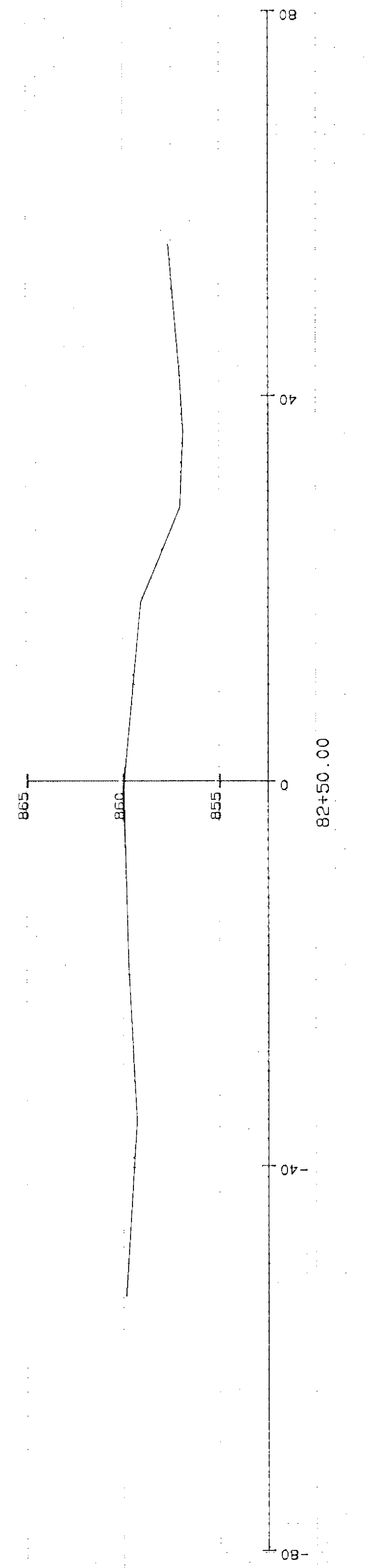
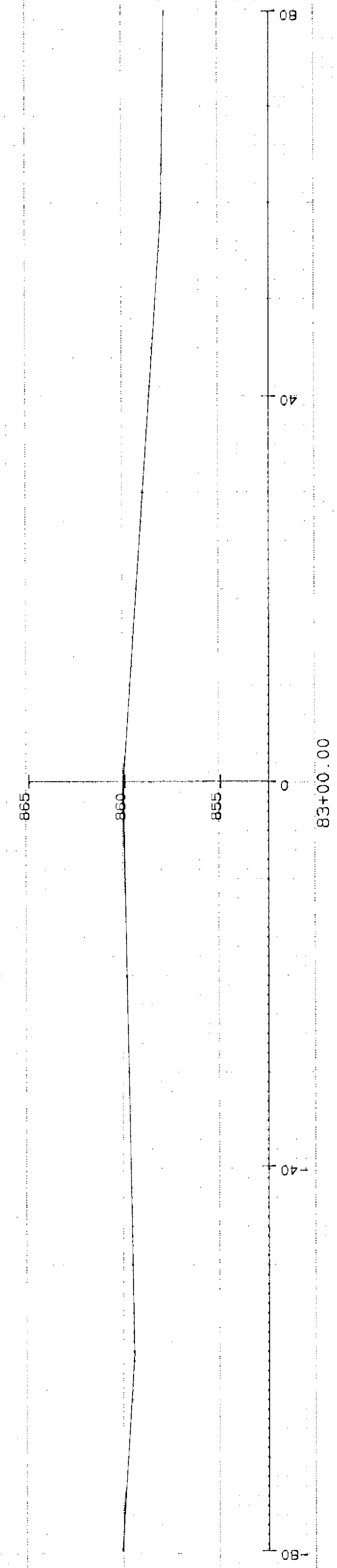
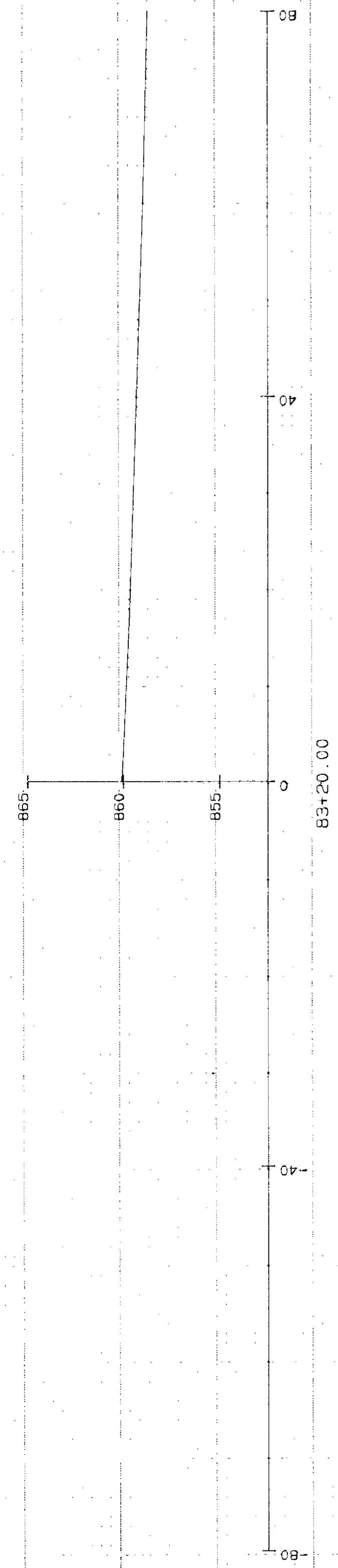
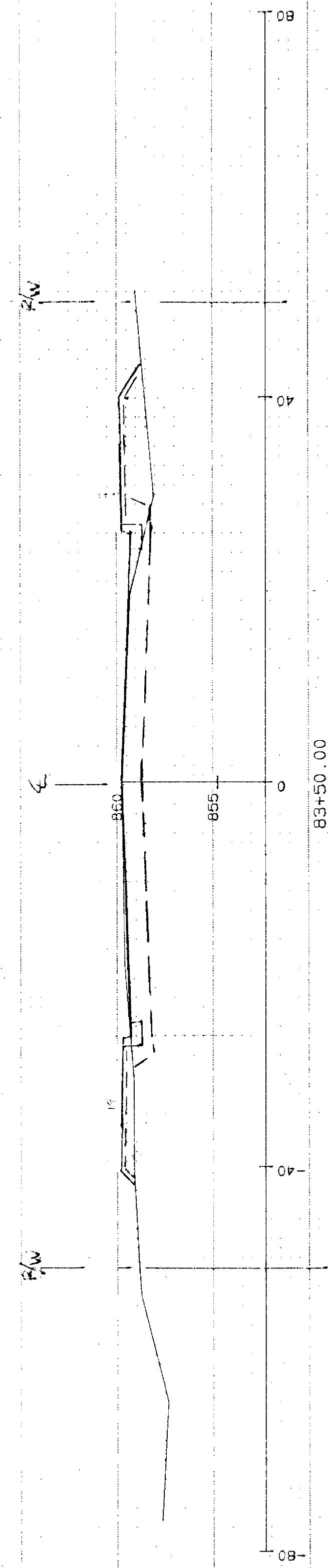
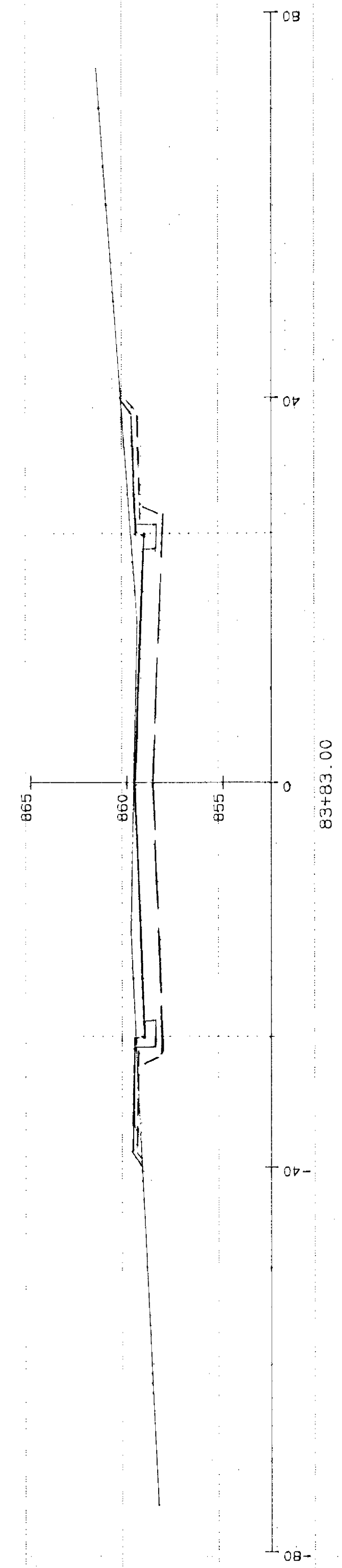
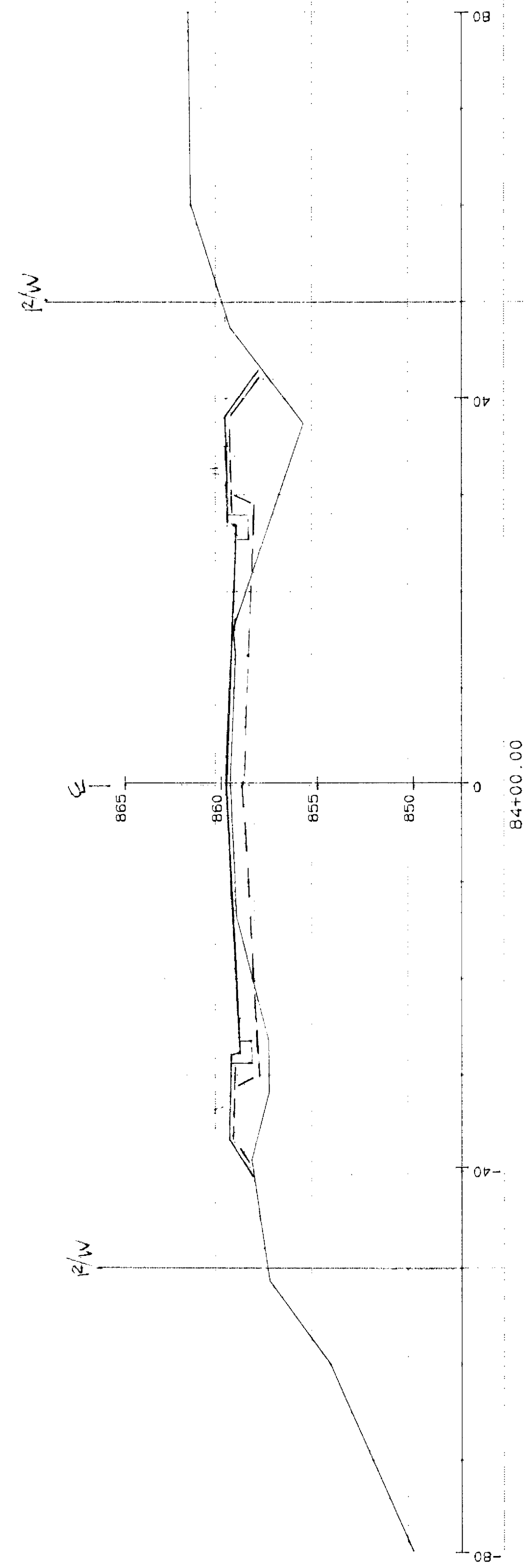

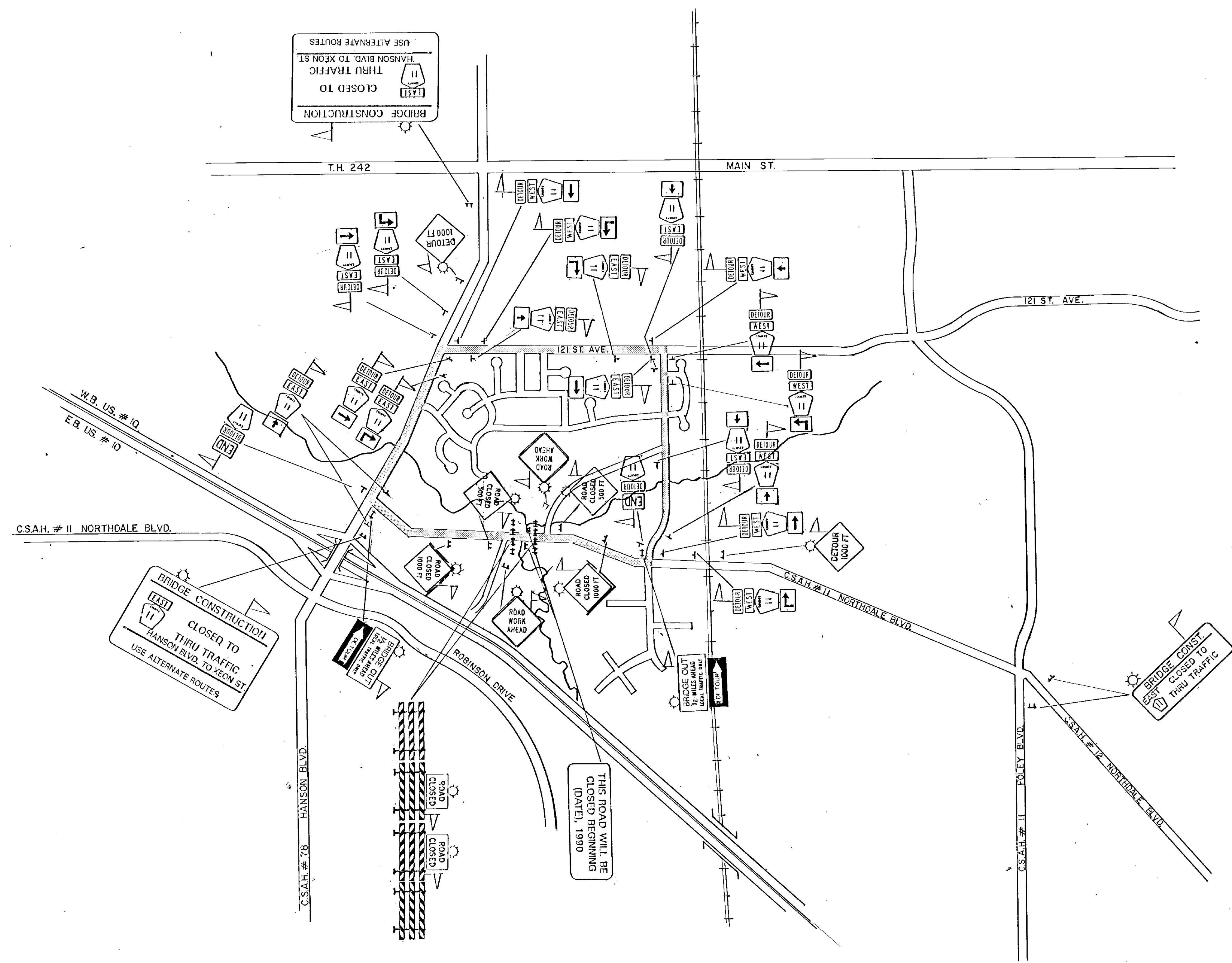

REVISIONS			
DATE	BY	DATE	BY

S.A.P. S.P. C.P. 02-611-24

