

STATE OF MINNESOTA
 DEPARTMENT OF HIGHWAYS
 Plan and Profile of State Road No. 5
 ANOKA COUNTY

From Jct. T.H.#8-NW, Cor. Sec. 9 T.31N., R.22W. To Jct. S.A.R.#4 in Centerville

GROSS LENGTH- 19000 FEET 3.6 MILES
 LENGTH OF EXCEPTIONS- 0 FEET 0 MILES
 NET LENGTH- 19000 FEET 3.6 MILES

PLAN, 1 Inch=200 Feet
 PROFILE, Horz. 1 Inch=200 Feet Vert. 1 Inch=20 Feet
 WORKING PLANS { Horz. 1 Inch=100 Feet
 Vert. 1 Inch=10 Feet
 Cross-Section, 1 Inch= Feet

LAYOUT
 Scale, 1 Inch=10560 Feet

CONVENTIONAL SIGNS	ABBREVIATIONS
STATE LINE	EXCAVATION EXC
COUNTY LINE	EARTH E
TWP OR RANGE LINE	LOOSE ROCK LR
SECTION LINE	SOLID ROCK SR
RIGHT OF WAY LINE	EMBANKMENT EMB
CORPORATE OR CITY LIMITS	OVERHAUL O
ROAD CENTER LINE	SURFACING S
RETAINING WALL	HAND DITCHING HD
RAILROADS	SPECIAL EXCAVATION SE
CREEK	SPECIAL PLOWING SP
DRY RUN	GUARD RAIL GR
DRAINAGE DITCH	CORRUGATED METAL CULVERT CM.CULV
POWER POLE LINE	SECTIONAL CONCRETE CULVERT R.CULV
TELEPHONE OR TELEGRAPH LINE	TON MILES T.M.
CULVERTS - PLAIN	TELEPHONE POLE TEL.P.
WITH ENDWALLS	POWER POLE P.P.
WITH WINGWALLS	PLACE PL
DROP INLET	IN PLACE INP
FENCE LINE	REPLACE REP
GRAVEL PIT	RIGHT RT
SAND PIT	LEFT LT
ROCK QUARRY	INTERSECTION ANGLE IA
SPRINGS	TANGENT T
MARSH	LENGTH OF CURVE L.C.
BRUSH OR TIMBER	POINT OF CURVE P.C.
HEDGE	POINT OF TANGENT P.T.
ROCK LEDGE	POINT OF INTERSECTION P.I.
SAND	VERTICAL CURVE V.C.
EDGE OF CUT	BENCH MARK B.M.
TOE OF EMBANKMENT	ELEVATION EL
RAILROAD R/W LINE	ACRES A
BUILDING (One Story Frame)	

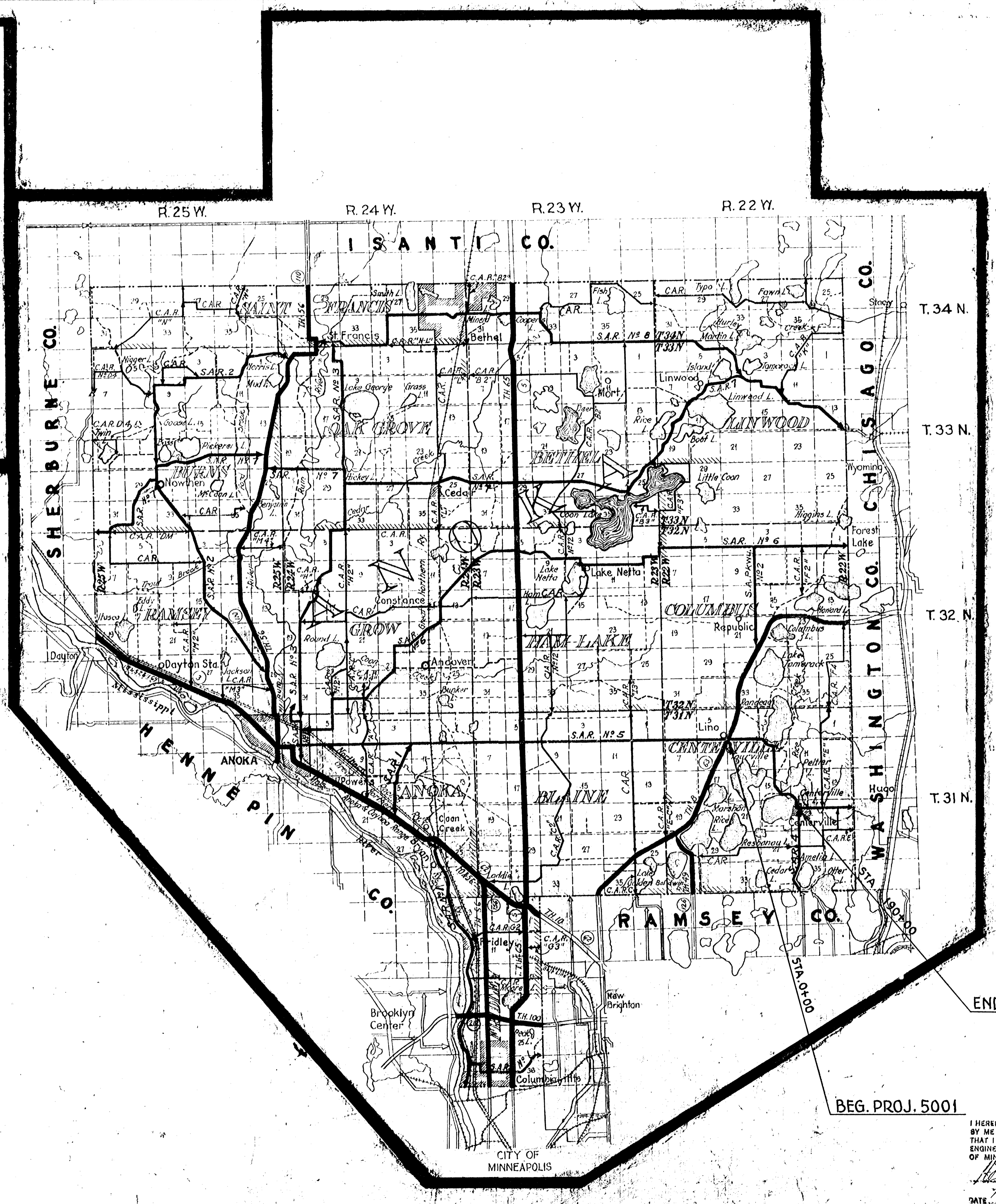
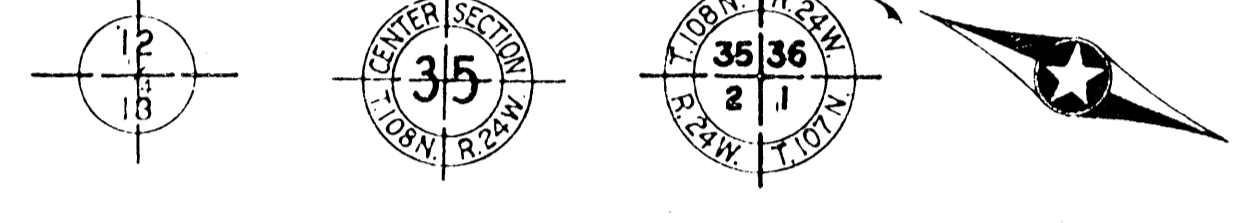

INDEX OF SHEETS

Sheet No. 1.	Title Sheet and Layout Map
" No. 2.	Typical Cross-Sections and Statement
" No. 3.	Plan and Profile Sta. to Sta.
" No. 4.	

NOTE: THE SPECIFICATIONS FOR HIGHWAY CONSTRUCTION DATED JULY 1, 1947 AND SUBMITTED FOR APPROVAL BY THE DIVISION ENGINEER OF THE PUBLIC ROADS ADMINISTRATION OCT. 15, 1947 SHALL GOVERN.



BEG. PROJ. 5001

END PROJ. 5001

I HEREBY CERTIFY THAT THIS PLAN WAS PREPARED BY ME OR UNDER MY DIRECT SUPERVISION AND THAT I AM A DULY REGISTERED PROFESSIONAL ENGINEER UNDER THE LAWS OF THE STATE OF MINNESOTA.
 DATE: 10/15/50
 593

Planned By: *H. G. Beal*
 HIGHWAY ENGINEER FOR ANOKA COUNTY.
 Recommended for Approval: *H. G. Beal* DISTRICT ENGINEER
 Recommended for Approval: *J. M. Egan* ENGINEER OF SURVEYS AND DESIGN
 Approved: *H. G. Beal* COUNTY DIVISION ENGINEER OF PLANS AND SURVEYS

S.A.R. 02-509-01

STATEMENT OF ESTIMATED QUANTITIES

SPECIFICATION REFERENCE NUMBER	ITEM	UNIT	TOTAL ESTIMATED QUANTITIES
2321.501	BITUMINOUS MATERIAL FOR PRIME COAT	GAL.	13908
2321.503	BITUMINOUS MATERIAL FOR MIXTURE	GAL.	52155
2321.506	AGGREGATE	TON	3477
2321.512	BITUMINOUS SURFACE	SQ. YD	46360
2123.503	MOTOR GRADER	HOUR	36
2123.504	PNEUMATIC-TIRED ROLLER	HOUR	18

TYPICAL SECTION BITUMINOUS SURFACING

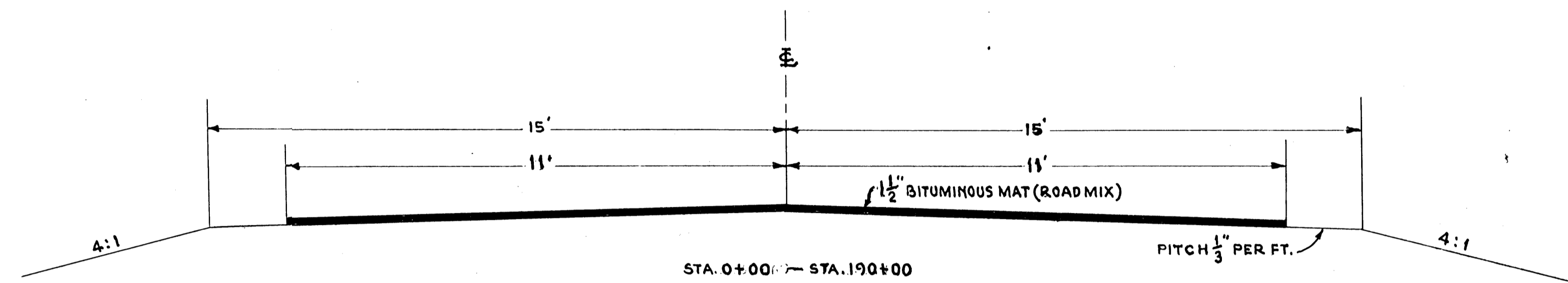

BASIS FOR COMPUTATION OF QUANTITIES

BITUMINOUS MATERIAL FOR PRIME COAT 0.3 GAL. PER SQ. YD
 BITUMINOUS MATERIAL FOR MIXTURE 1.125 GAL. PER SQ. YD
 AGGREGATE 150 LB. PER SQ. YD
 MOTOR GRADER 10 HOUR PER MILE
 PNEUMATIC-TIRED ROLLER 5 HOUR PER MILE
 BITUMINOUS MATERIAL FOR MIXTURE - MC 2 OR 3
 BITUMINOUS MATERIAL FOR PRIME COAT - MC 0 OR 1

S.A.R 02-509-01