

**STATEMENT OF ESTIMATED QUANTITIES**

ITEM NO.	ITEM	UNIT	TOTAL ESTIMATED QUANTITIES
2031.503	FIELD LABORATORY TYPE B	EACH	1
2101.502	CLEARING	TREE	121
2101.507	GRUBBING	TREE	112
2104.501	REMOVE INTEGRANT CURB	LIN. FT.	2,060
2104.505	REMOVE CONCRETE PAVEMENT	SQ. YD.	18
2104.521	SALVAGE CULVERT PIPE	LIN. FT.	687
2104.521	SALVAGE FENCE	LIN. FT.	1,165
2104.523	SALVAGE APRONS	EACH	8
① 2105.501	COMMON EXCAVATION	CU. YD.	47,605
2105.525	TOPSOIL BORROW (L.V.)	CU. YD.	10,771
0557.604	INSTALL FENCE	LIN. FT.	1,125
② 2123.503	MOTOR GRADER	HOUR	8
② 2123.509	DOZER	HOUR	8
③ 2130.501	WATER	M - GALLON	300
2207.503	BITUMINOUS MATERIAL FOR MIXTURE	GALLON	167,657
④ 2207.512	BITUMINOUS STABILIZED SUBGRADE 6" THICK	SQ. YD.	54,083
2221.501	AGGREGATE SHOULDERING CL. 1	TON	642
2331.504	BITUMINOUS MATERIAL FOR MIXTURE	TON	340
⑤ 2331.514	BASE COURSE MIXTURE	TON	7,561
2341.504	BITUMINOUS MATERIAL FOR MIXTURE	TON	521.39
⑥ 2341.508	WEARING COURSE MIXTURE	TON	8,021
2357.502	BITUMINOUS MATERIAL FOR TACK COAT	GALLON	2,343
2411.501	CONCRETE MIX NO. 3Y43	CU. YD.	124.45
2411.541	REINFORCEMENT BARS	POUND	12,021.70
2501.511	15" C.M. PIPE CULVERT	LIN. FT.	500
2501.511	18" C.M. PIPE CULVERT	LIN. FT.	648
2501.511	24" R.C. PIPE CULVERT CL. 2	LIN. FT.	30
2501.511	24" R.C. PIPE CULVERT CL. 3	LIN. FT.	70
2501.515	15" C.M. PIPE APRONS	EACH	34
2501.515	18" C.M. PIPE APRONS	EACH	20
2501.515	24" R.C. PIPE APRONS	EACH	5
2501.571	INSTALL 15" C.M. PIPE CULVERT	LIN. FT.	238
2501.571	INSTALL 22" SPAN R.C. PIPE ARCH CULVERT	LIN. FT.	27
2501.571	INSTALL 24" R.C. PIPE CULVERT	LIN. FT.	144
2501.571	INSTALL 30" R.C. PIPE CULVERT	LIN. FT.	60
2501.573	INSTALL 22" SPAN R.C. PIPE ARCH APRON	EACH	1
2501.573	INSTALL 24" R.C. PIPE APRONS	EACH	5
2501.573	INSTALL 30" R.C. PIPE APRON	EACH	1
2506.511	RECONSTRUCT MANHOLES	LIN. FT.	6
2506.522	ADJUST FRAME & RING CASTINGS	EACH	20
2531.501	CONCRETE CURB & GUTTER DESIGN B - 618	LIN. FT.	320
2545.509	CONDUIT SYSTEM	LUMP SUM	1
2575.501	ROADSIDE SEEDING	ACRE	26.70
2575.502	SEED MIXTURE NO. 5	POUND	1,335
2575.505	SODDING	SQ. YD.	5,256
2575.511	MULCH MATERIAL TYPE 1	TON	53.4
2575.519	DISC ANCHORING	ACRE	26.70
2575.531	COMMERCIAL FERTILIZER, ANALYSIS 10 - 10 - 10	TON	6.7

- ① 3,079 CU. YD. WILL BE EXCESS MATERIAL.
- ② FOR OBLITERATION OF STREET APPROACHES OUTSIDE OF GRADING AREA.
- ③ DUST CONTROL.
- ④ INCLUDES 8,709 SQ. YD. FOR STREET APPROACHES.
- ⑤ INCLUDES 1,253 TON FOR STREET APPROACHES.
- ⑥ INCLUDES 770 TON FOR STREET APPROACHES & DRIVEWAYS.

**BASIS OF PLANNED QUANTITIES**

2207	BITUMINOUS STABILIZED SUBGRADE. BITUMINOUS MATERIAL FOR MIXTURE 0.5 GAL. PER S.Y./ INCH THICKNESS. BITUMINOUS MATERIAL FOR FOG 0.10 GAL./ S.Y.
2221	AGGREGATE SHOULDERING CL. 1, 140 LBS./ CU. FT. COMPACTED.
2331	PLANT MIXED BITUMINOUS BASE. BITUMINOUS MIXTURE 100 LBS. PER S.Y./ INCH THICKNESS. BITUMINOUS MATERIAL FOR MIXTURE, 4.5% BY WT.
2341	PLANT MIXED BITUMINOUS WEARING COURSE. WEARING COURSE MIXTURE, 165 LBS./ S.Y. PER 1 1/2" THICKNESS. BITUMINOUS MATERIAL FOR MIXTURE, 6.5% BY WT.
2357	BITUMINOUS MATERIAL FOR TACK COAT 0.05 GAL./ S.Y.

**TYPICAL GRADING SECTION**

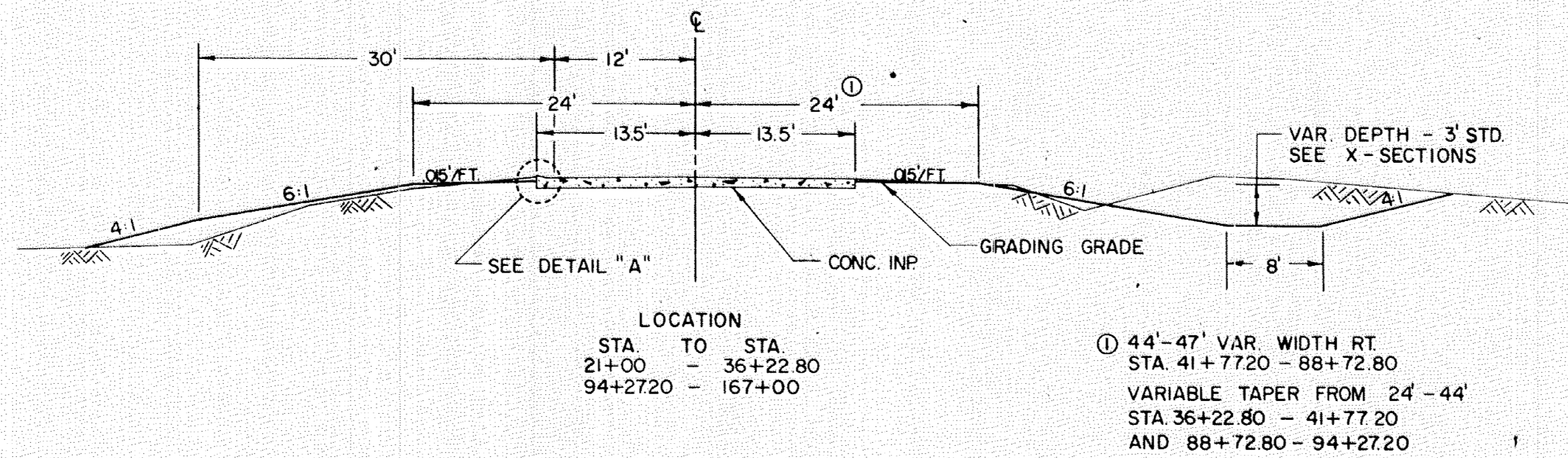

**TYPICAL BITUMINOUS SECTION**

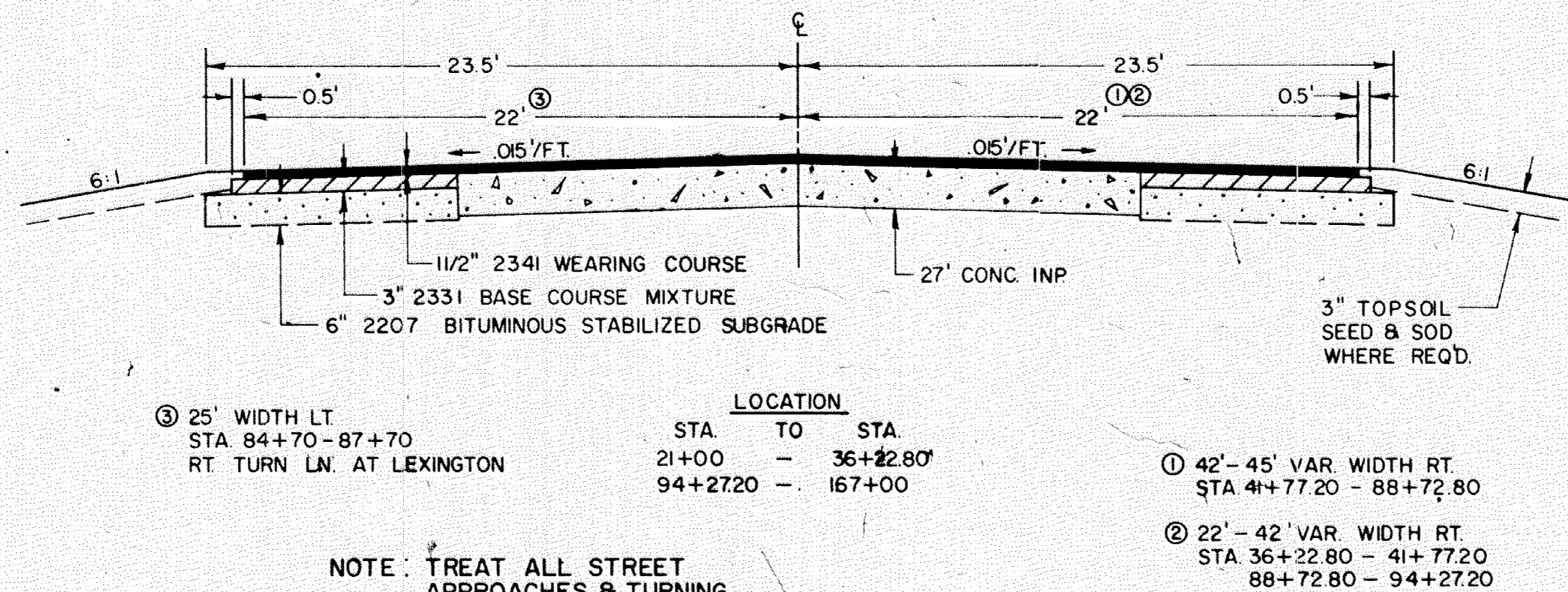

NOTE: TREAT ALL STREET APPROACHES & TURNING LANES THE SAME AS TYPICAL BITUMINOUS SECTION.

**SPECIAL BITUMINOUS SECTION**

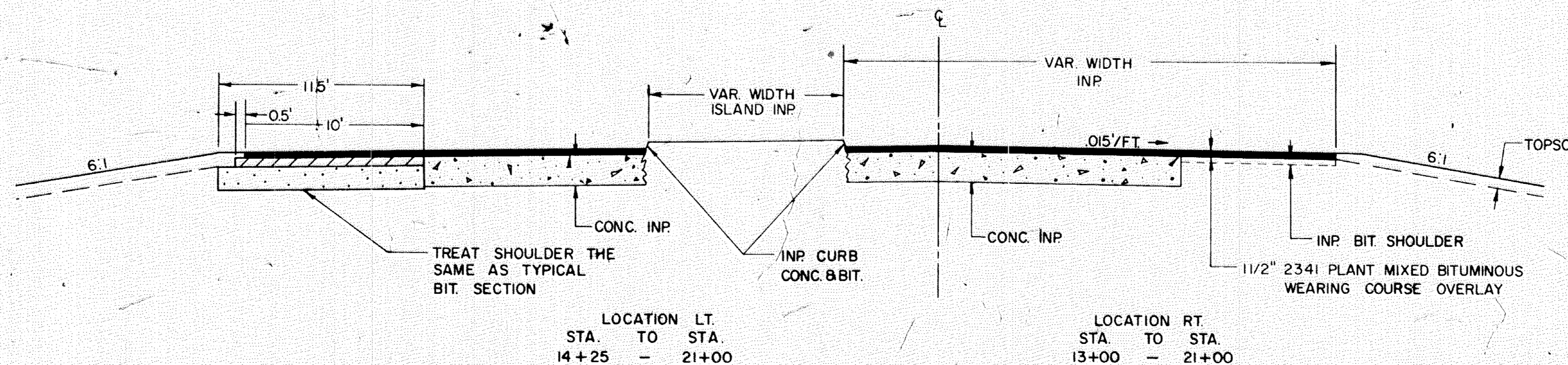

**CONCRETE REMOVAL**

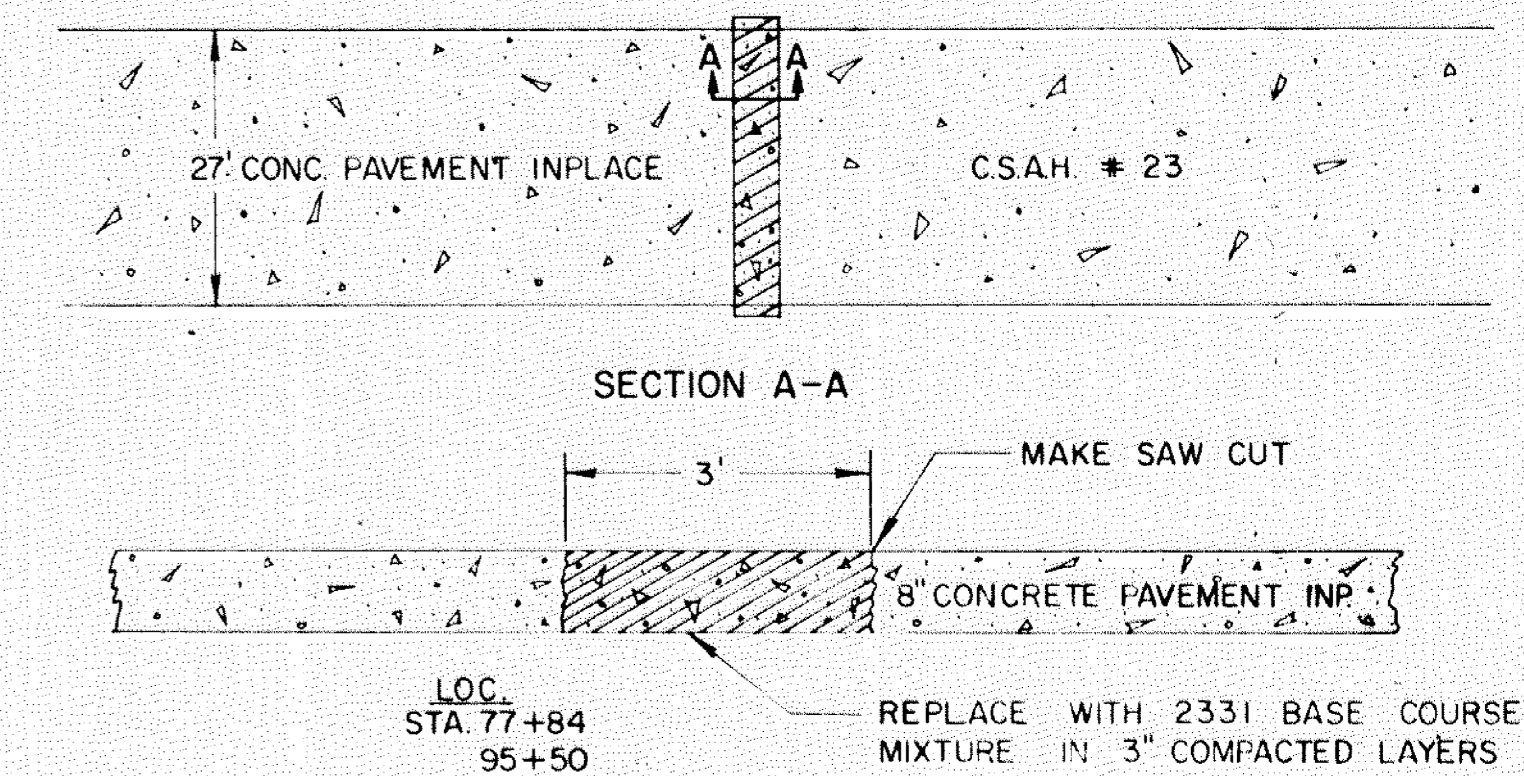

**RIGHT TURN LANES**

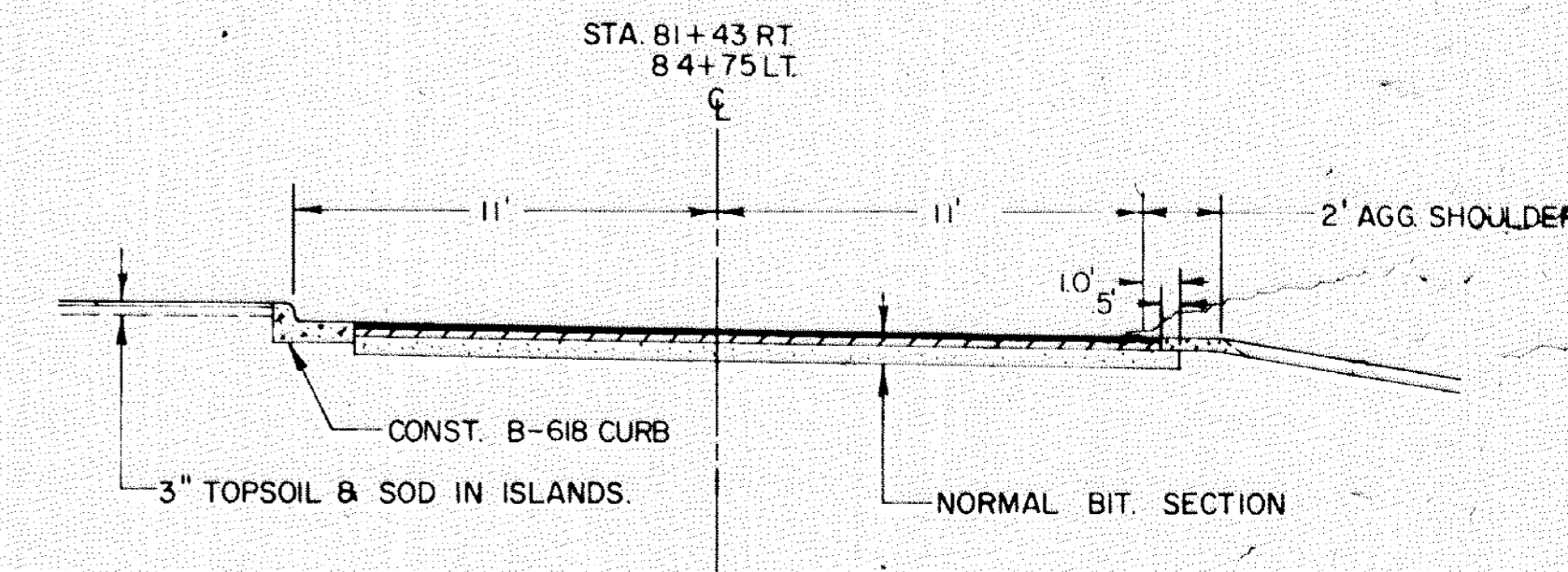

**DETAIL "A"**

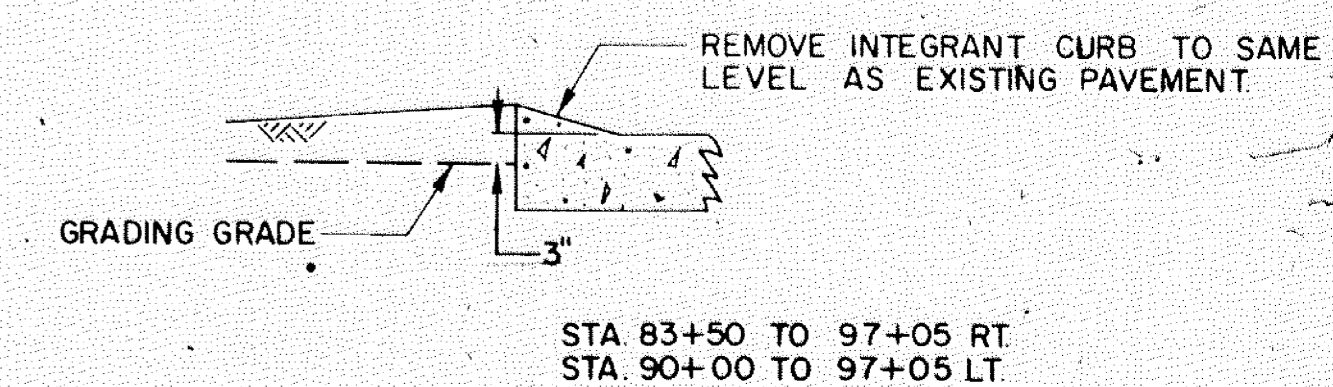



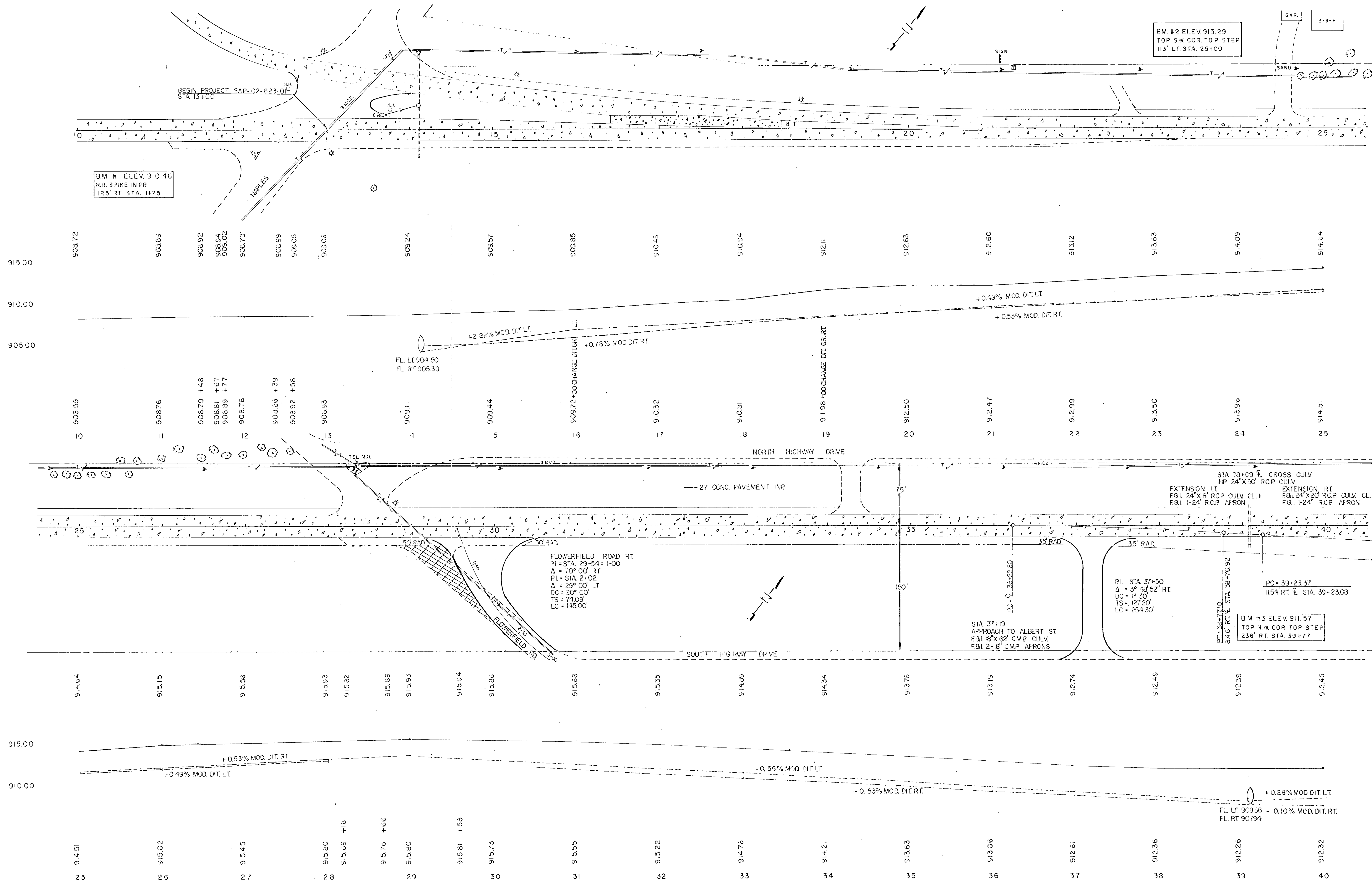

B.M. #1 ELEV. 910.46  
R.R. SPIKE IN RR  
125' RT. STA. 11+25

B.M. #2 ELEV. 915.29  
TOP S.W. COR. TOP STEP  
113' LT. STA. 25+00

B.M. #3 ELEV. 911.57  
TOP N.W. COR. TOP STEP  
236' RT. STA. 39+77

RESTWOOD ROAD LT.  
 PI = C STA. 47+89 = STA. 1+00  
 $\Delta = 110^{\circ}-00'$  LT.  
 PL = STA. 2+03  
 $\Delta = 29^{\circ}-00'$  LT.  
 DC = 20^{\circ}-00' LT.  
 TS = 74.09'  
 LC = 145.00'

PI = STA. 40+50.57  
 20' RT. C STA. 40+50  
 $\Delta = 3^{\circ}-48'-50''$  LT.  
 DC = 19'-30"  
 TS = 127.20'  
 LC = 254.25'

PI = STA. 41+77.67  
 20' RT. C STA. 41+77.20

RADIUS POINTS  
 A - A PT. 237' RT. OF  
 C STA. 45+37  
 B - A PT. 214' RT. OF  
 C STA. 45+65

\*ADDED VAR. WIDTH BETWEEN STA. 36+22.80 TO  
 STA. 94+27.20 FOR FUTURE CHANNELIZATION.

STA. 49+56 RESTWOOD ROAD RT.  
 F&I 18'X114' C.M.P. CULV.  
 F&I 2-18" APRONS

RESTWOOD ROAD RT.  
 PI = C STA. 49+56 = STA. 1+00  
 $\Delta = 70^{\circ}-00'$  RT.  
 PL = STA. 2+24  
 $\Delta = 23^{\circ}-00'$   
 DC = 20^{\circ}-00'  
 TS = 74.09'  
 DC = 145.00'

912.45      912.48      912.56      912.65      912.78      912.96      913.06      913.16      913.20      913.26      913.29      913.27      913.18      913.02      912.89      912.31      911.96      911.59      911.20

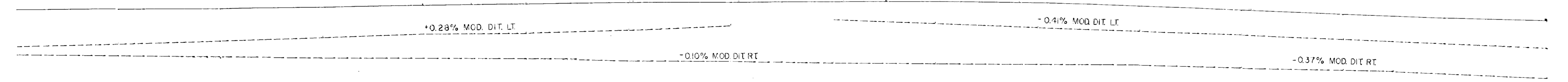

10      11      12      13      14      15      16      17      18      19      20      21      22      23      24      25

912.32      912.35      912.43      912.52      912.65      912.83      912.93      913.03      913.07 + 50      913.13      913.16 + 50      913.14      913.05 + 50      912.89      912.56      912.18 +00 CHANGE DIT. GR.      911.83      911.46      911.13

STA 64+10  $\frac{1}{2}$  CROSS CULVERT  
 INP 24" X 62' R.C.P. (INC. APRONS)  
 LT. EXTENSION REMOVE 24" X 6' R.C.P. & APRON  
 F&I 24" X 12' R.C.P. CULV. CL. III  
 F&I 1-24" R.C.P. APRON

WOODLAND ROAD LT.  
 INP 24" X 76' R.C.P. (INC. APRONS)  
 REMOVE  
 INSTALL 84' R.C.P. (INC. APRONS)  
 USING 8' FROM DUNLAP AVE.

WOODLAND ROAD LT.  
 PI STA 68+27=1+00  
 $\Delta = 110^{\circ}00'$  LT.  
 PI = STA 1+75  
 $\Delta = 29^{\circ}00'$  LT.  
 DC = 24' 00"  
 TS = 61.74'  
 LC = 120.83'

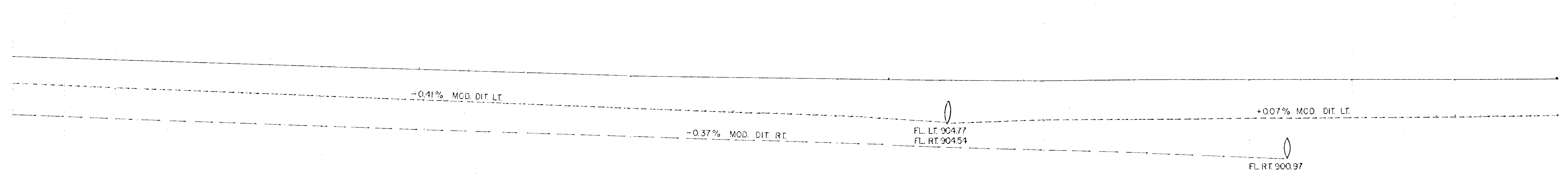
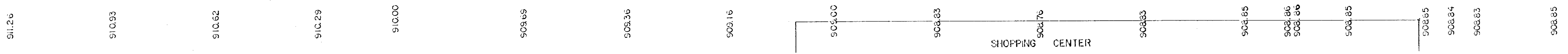
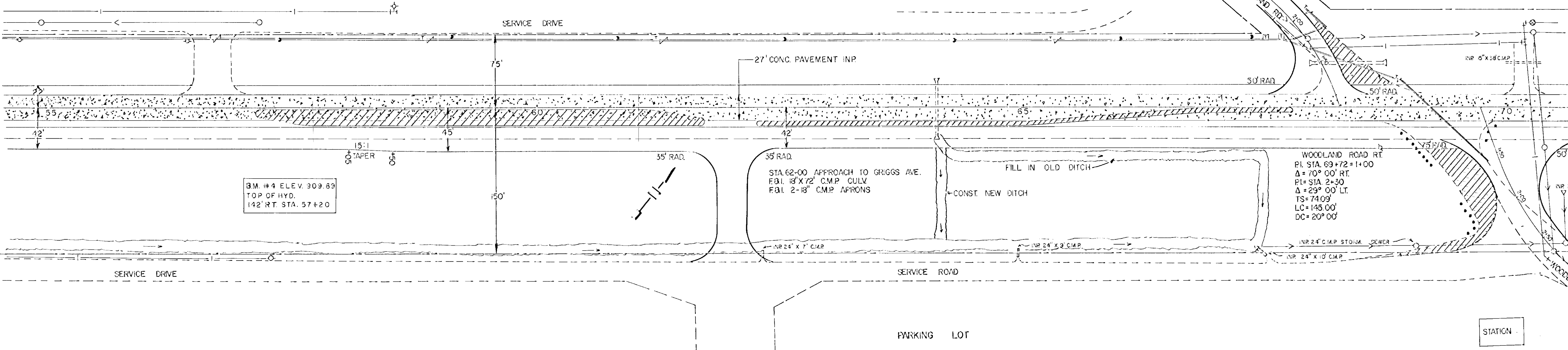

STA. 75+00 DUNLAP AVE. L.T.  
 INR 24" X 32" R.C.P. (INC. APRONS)  
 REMOVE  
 INSTALLED 24" X 72" R.C.P. CULV.  
 INSTALL 2-24" R.C.P. APRONS

DUNLAP AVE. L.T.  
 PI = STA. 74+70+1+00  
 $\Delta = 70^{\circ}00' L.T.$   
 RI = STA. 1+82  
 $\Delta = 21^{\circ}00' R.T.$   
 DC = 242'-00"  
 TS = 53.05'  
 LC = 195.00'

RADIUS POINT  
 A POINT 74' LT. OF  
 STA. 84+75

RADIUS POINT  
 A POINT 94' RT. OF  
 STA. 81+43

B.M. #6 ELEV. 910.18  
 TOP SE. BOLT ON LITE BASE  
 STA. 73+64 102' L.T.

B.M. #7 ELEV. 910.57  
 U.S.G.S. BENCHMARK  
 INTERSECT. ON 10317

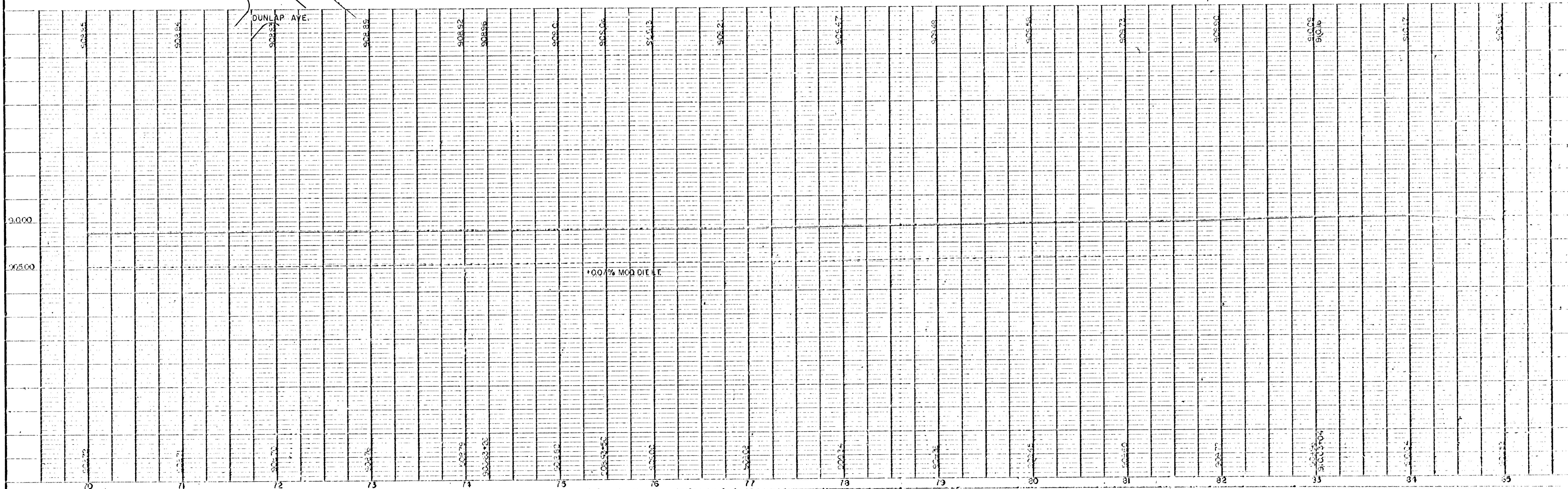
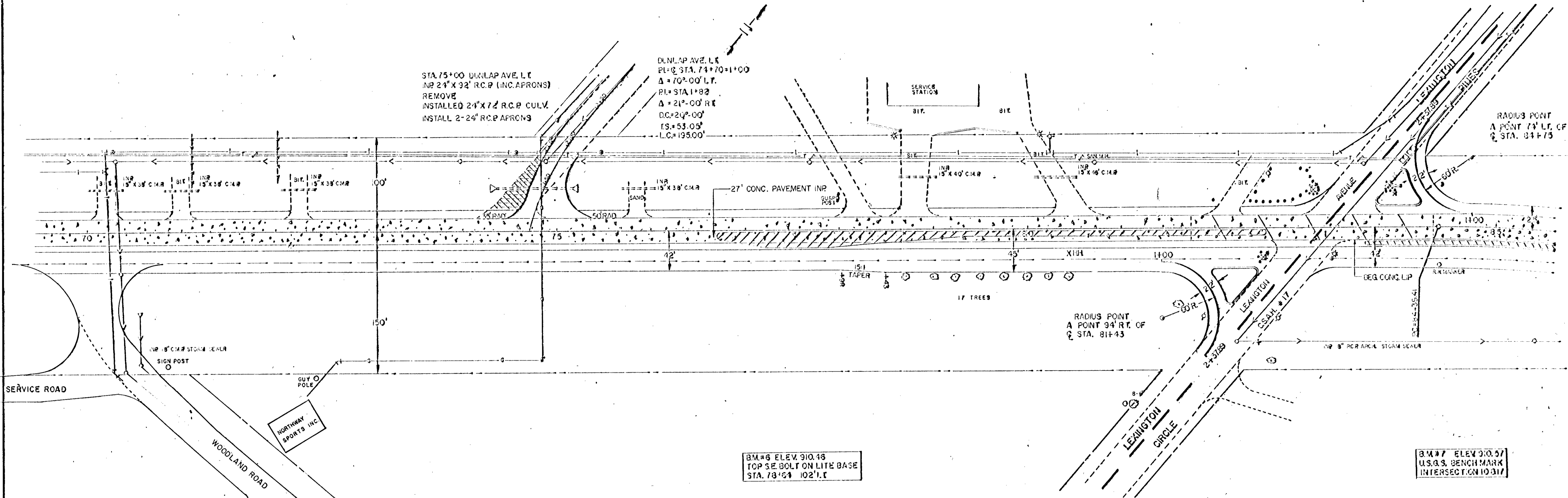
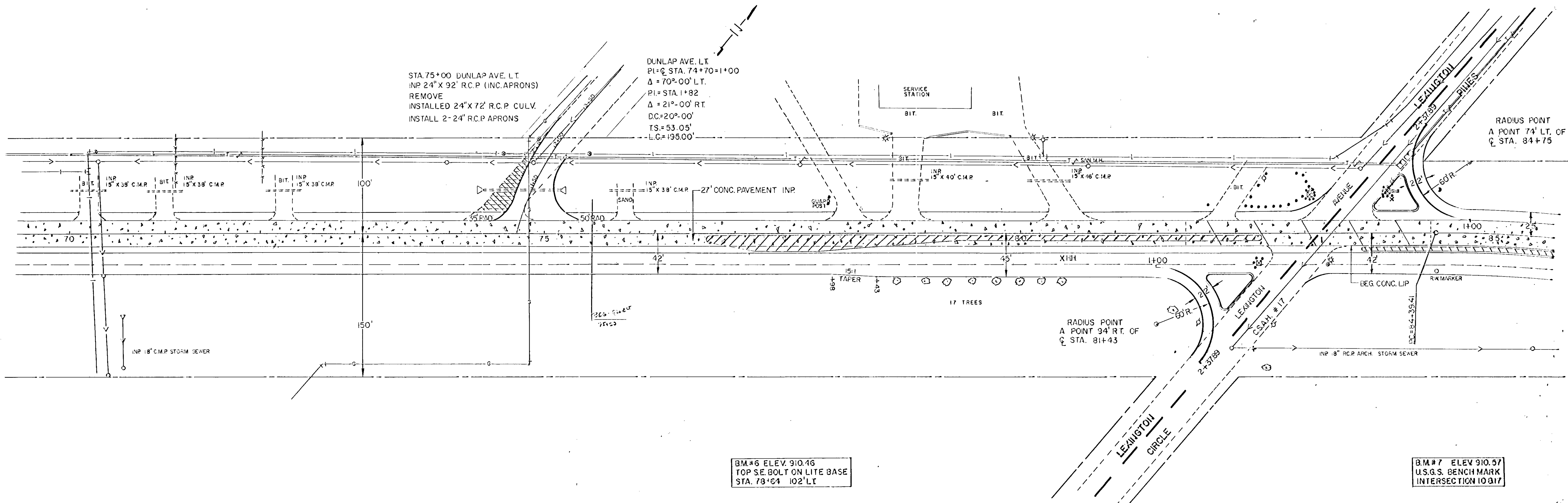
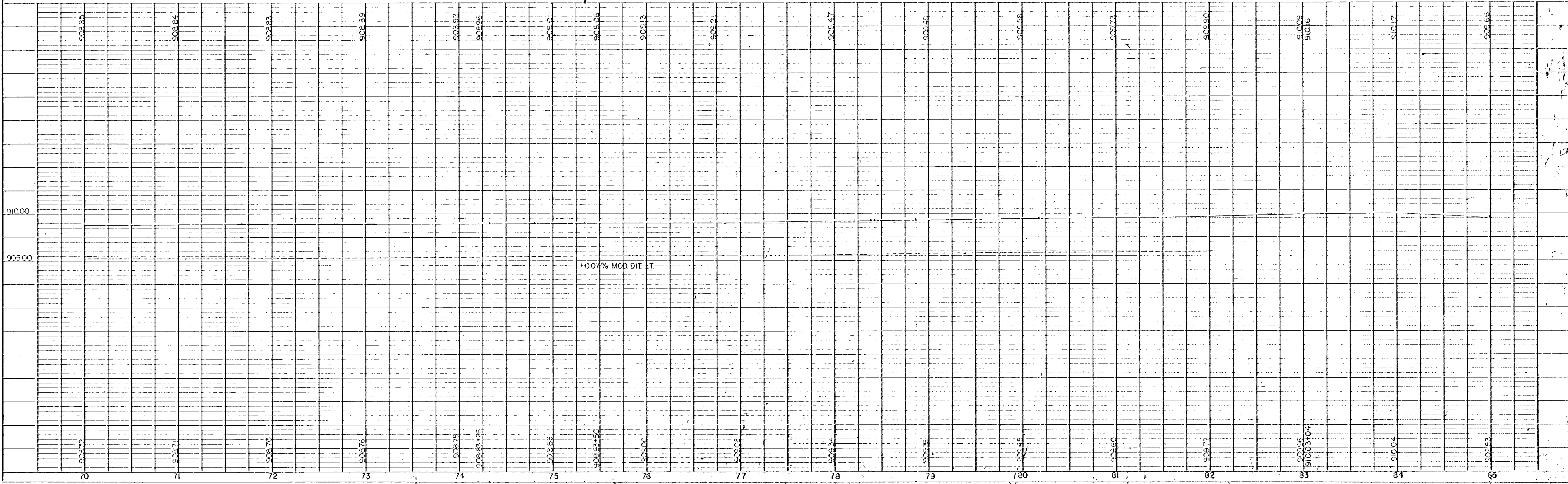

PLATE 1, PLAN & PROFILE  
 DUNLAP AVE. L.T.



B.M.#6 ELEV. 910.16  
 TOP SE. BOLT ON LITE BASE  
 STA. 78+64 102' LT

B.M.#7 ELEV. 910.57  
 U.S.G.S. BENCH MARK  
 INTERSECTION 10317





BM #8 ELEV 902.94  
SPIKE IN ROOT 6" ELM  
STA. 89+98 116' LT.

PI = STA. 89+97.04  
20' RT. @ STA. 90+00  
 $\Delta = 3^\circ 48' 52''$   
DC = 1' 30"  
TS = 127.20'  
LC = 254.30'

STA. 93+00 @ CROSS CULV.  
INP 24" X 60" R.C.P. CULV.  
EXTENSION LT. FBI 24" X 14" R.C.P. CULV. CL. II  
EXTENSION RT. FBI 24" X 16" R.C.P. CULV. CL. II  
F&I 1-24" R.C.P. APRON F&I 1-24" R.C.P. APRON

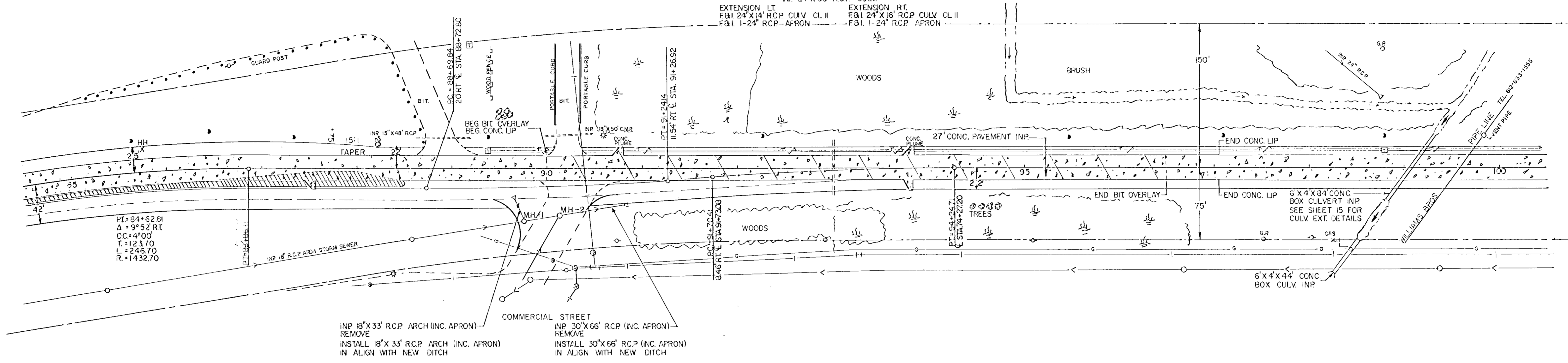

INP 18" X 33" R.C.P. ARCH (INC. APRON) REMOVE  
INSTALL 18" X 33" R.C.P. ARCH (INC. APRON) IN ALIGN WITH NEW DITCH

COMMERCIAL STREET  
INP 30" X 66" R.C.P. (INC. APRON) REMOVE  
INSTALL 30" X 66" R.C.P. (INC. APRON) IN ALIGN WITH NEW DITCH

PI = STA. 92+97.60  
@ STA. 93+00  
 $\Delta = 3^\circ 48' 52''$   
DC = 1' 30"  
TS = 127.20'  
LC = 254.30'

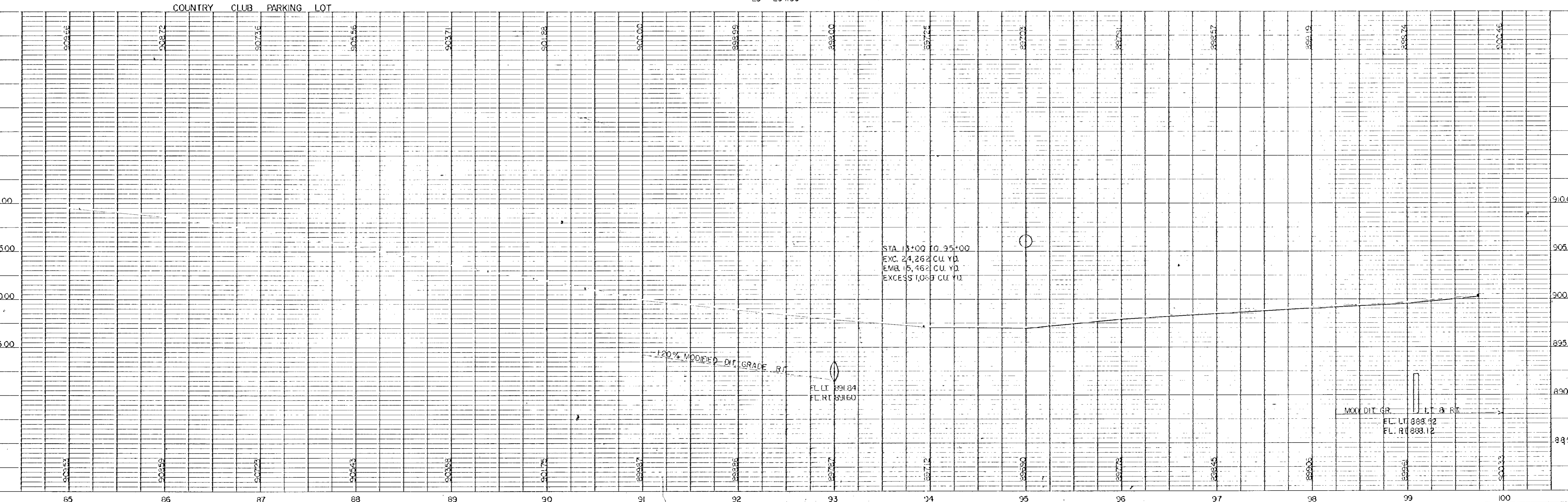
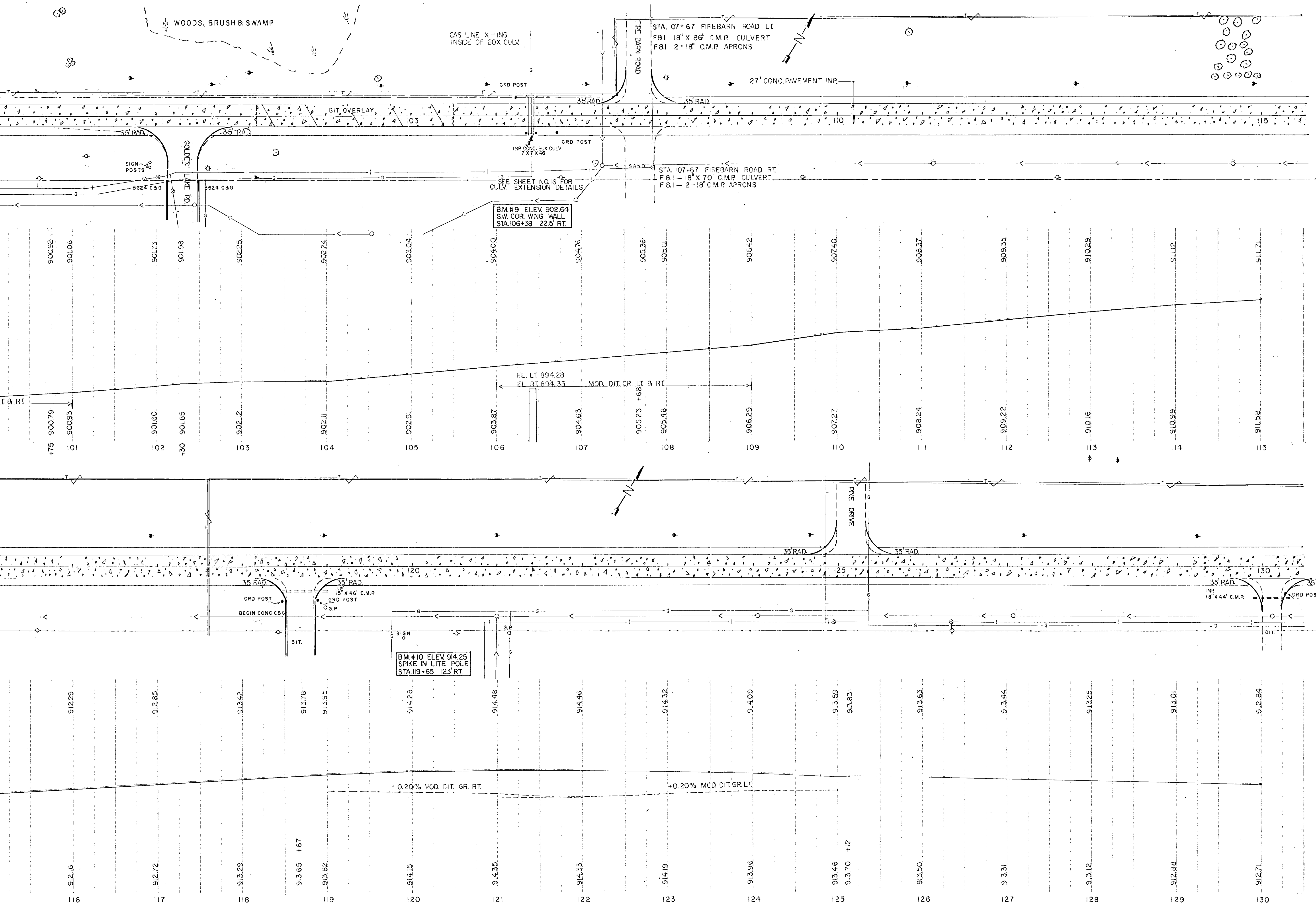
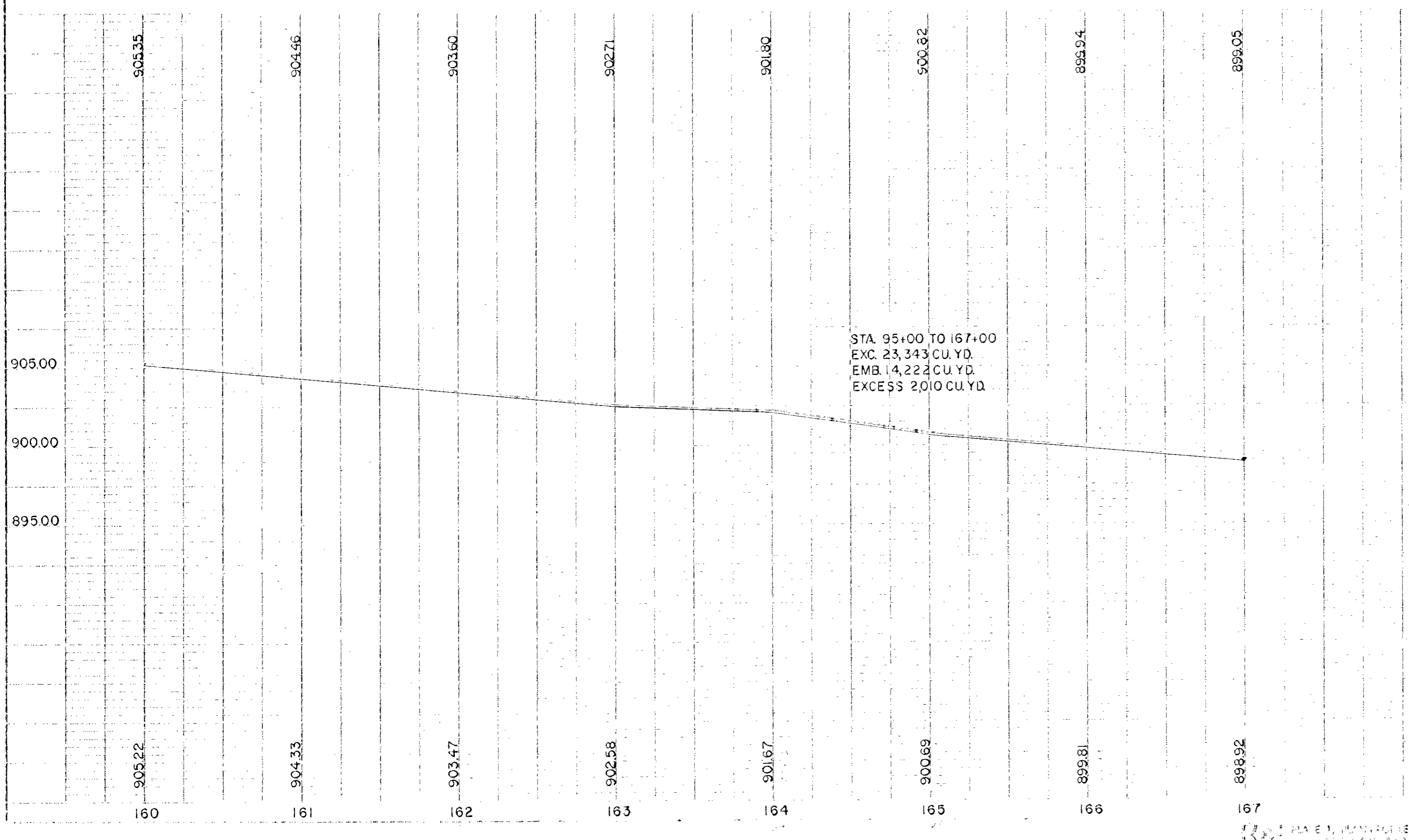
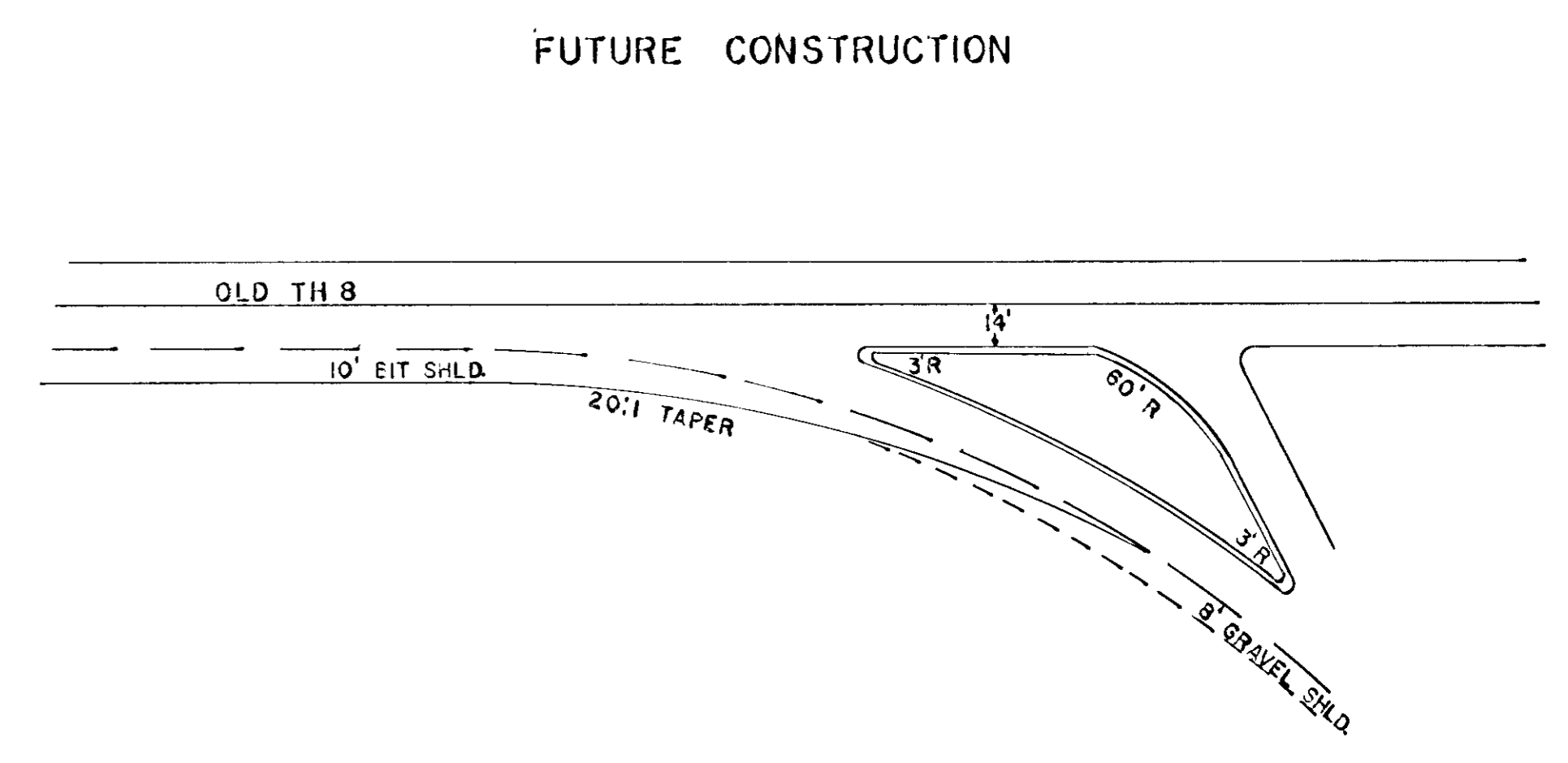
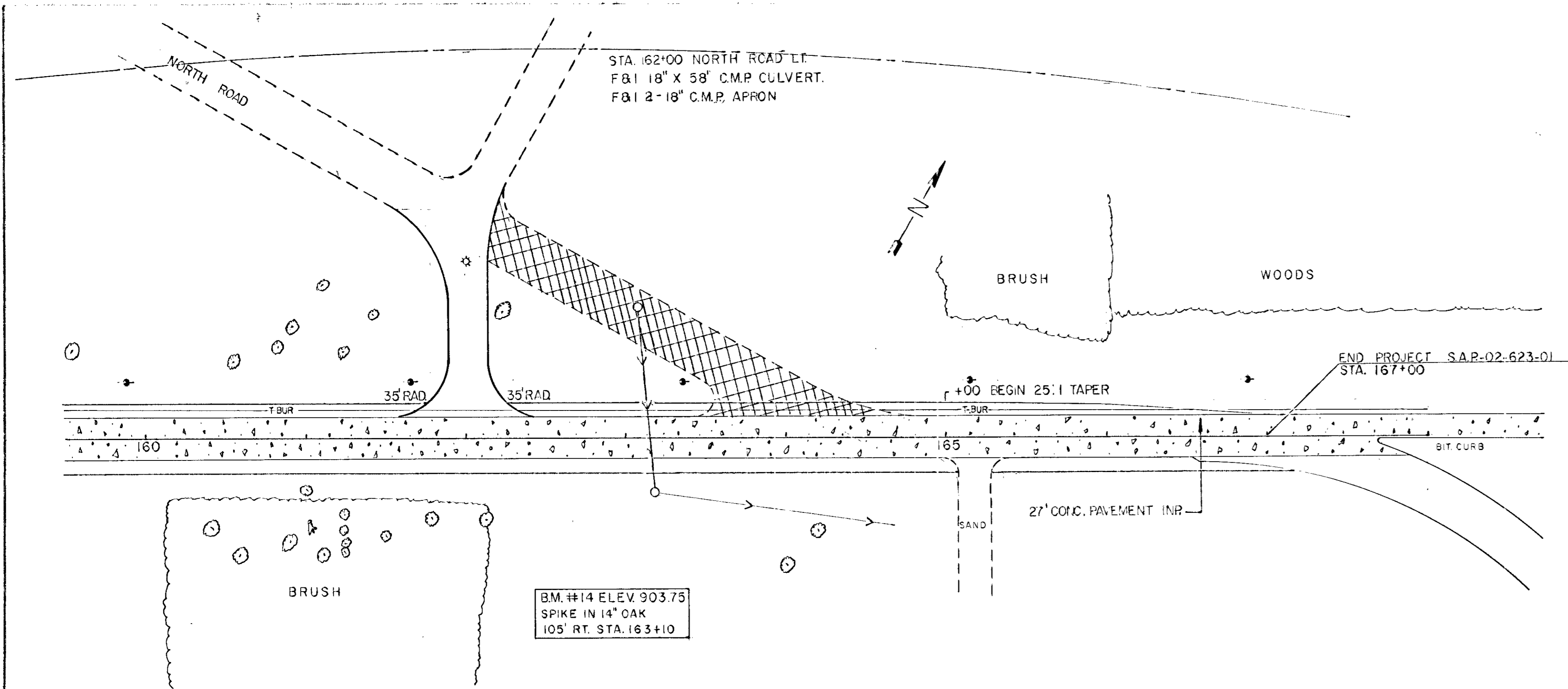
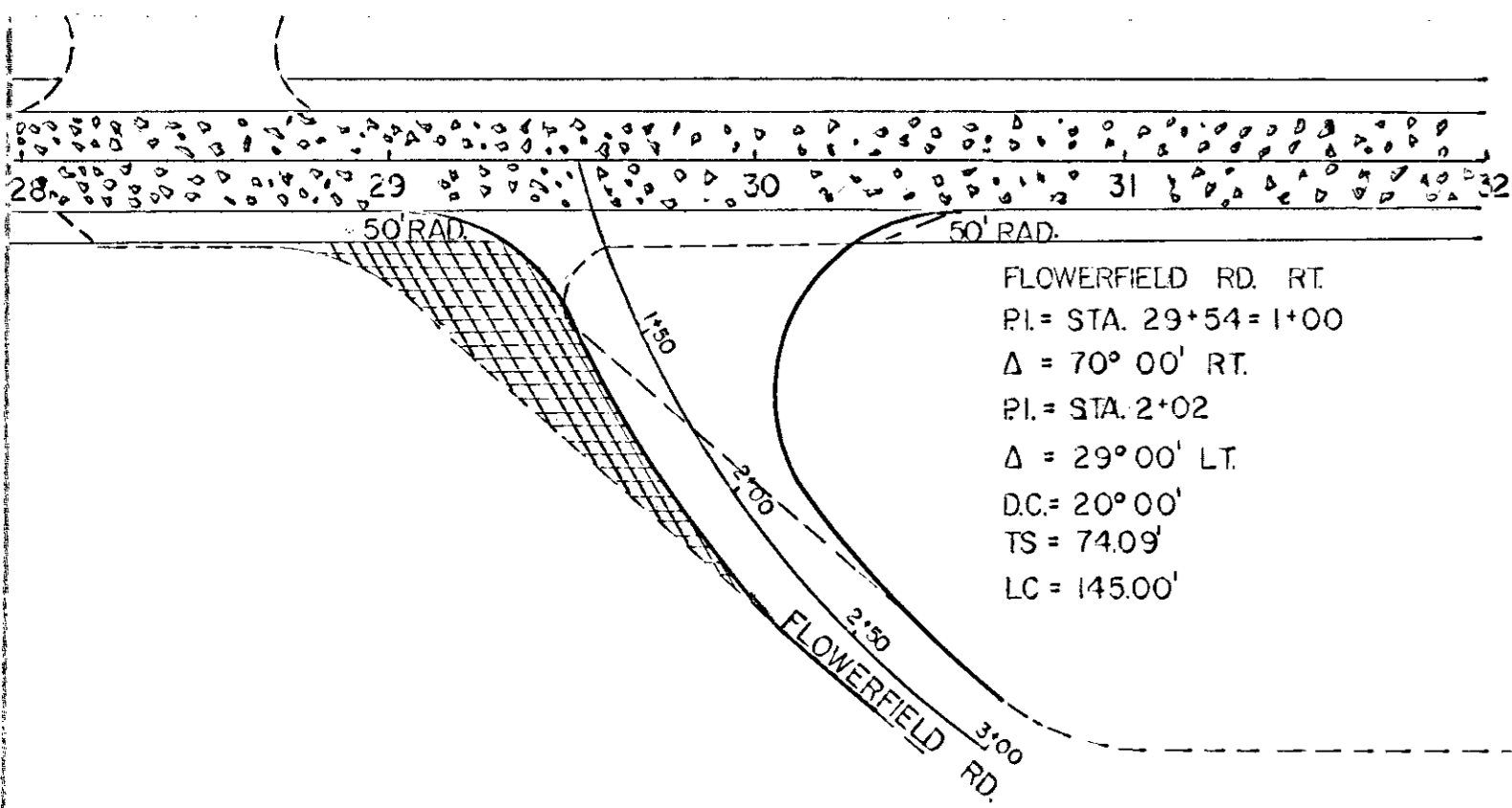

PLATE 1, PLAN PROFILE  
K&S ENGINEERS & ARCHITECTS









FLOWERFIELD ROAD

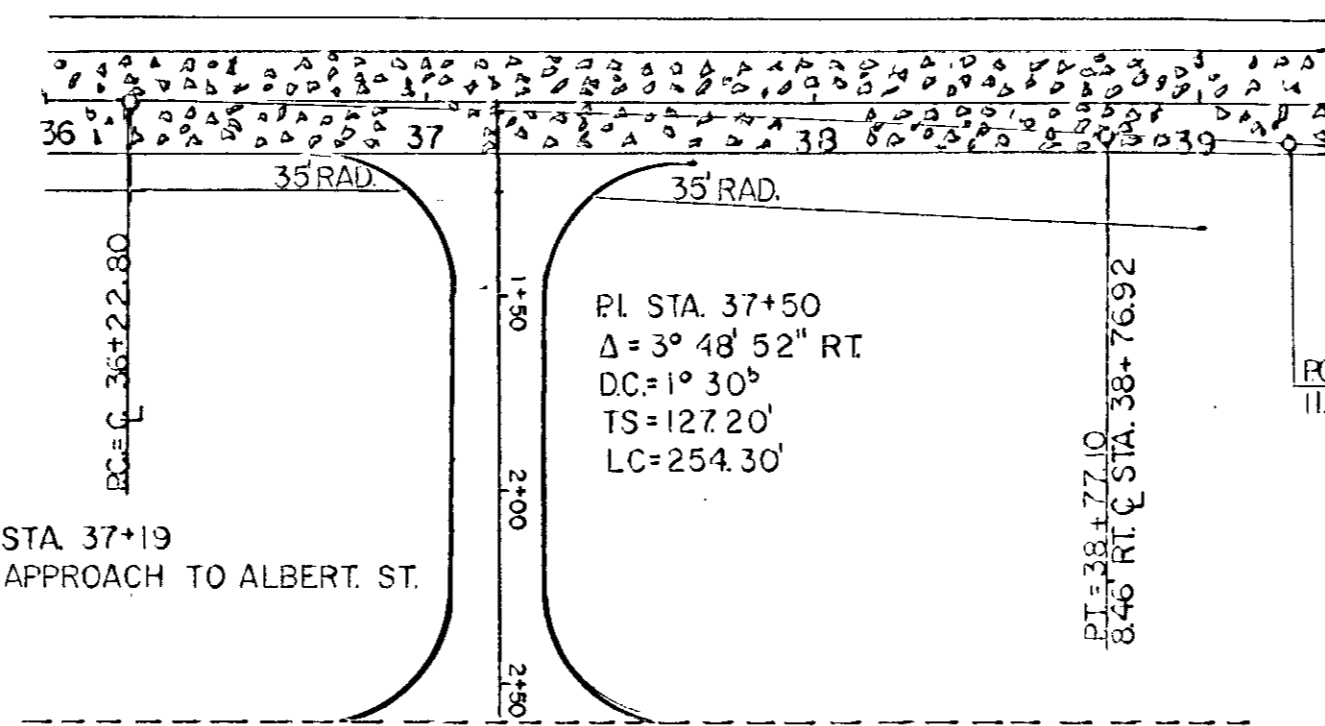
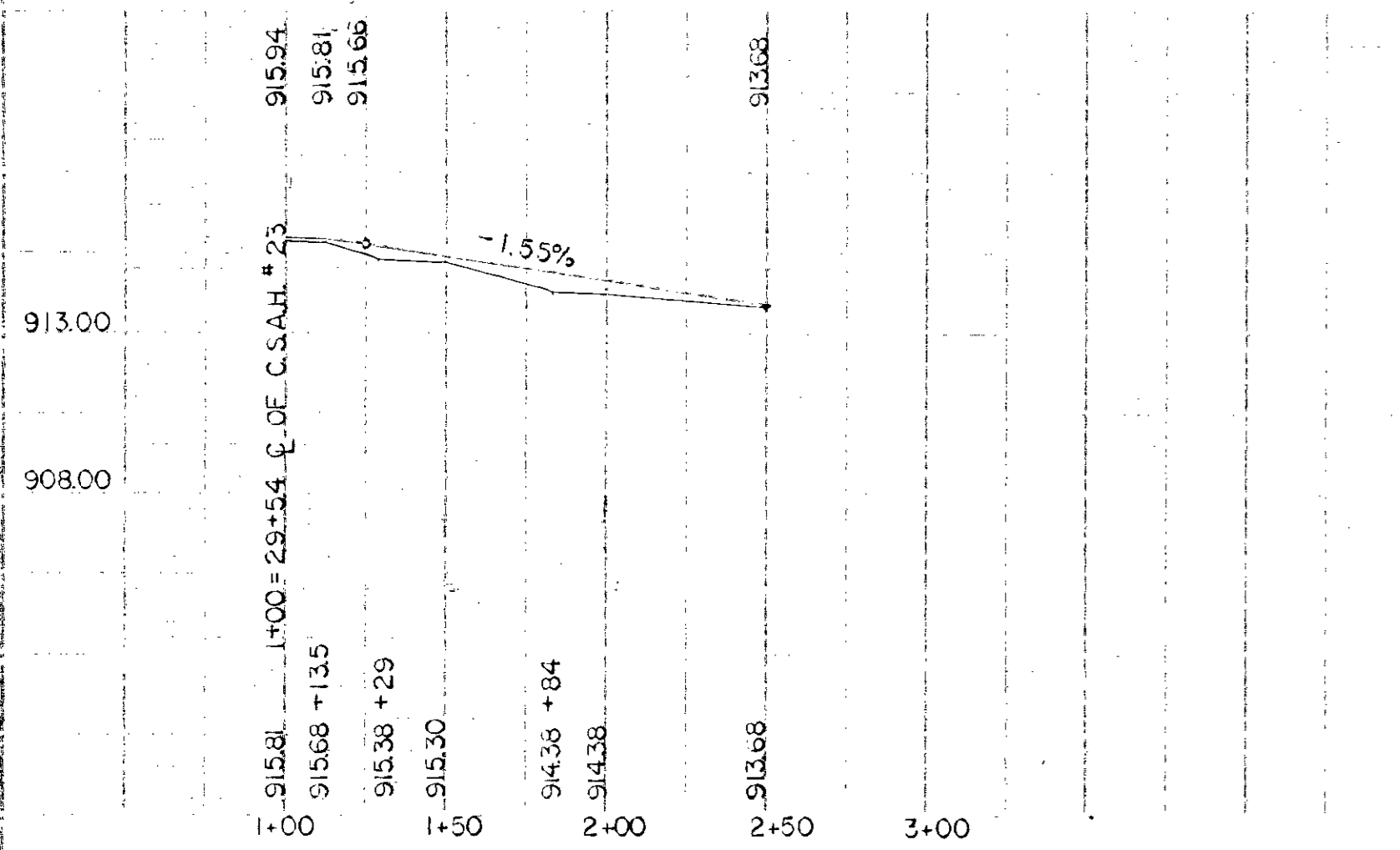

ALBERT STREET

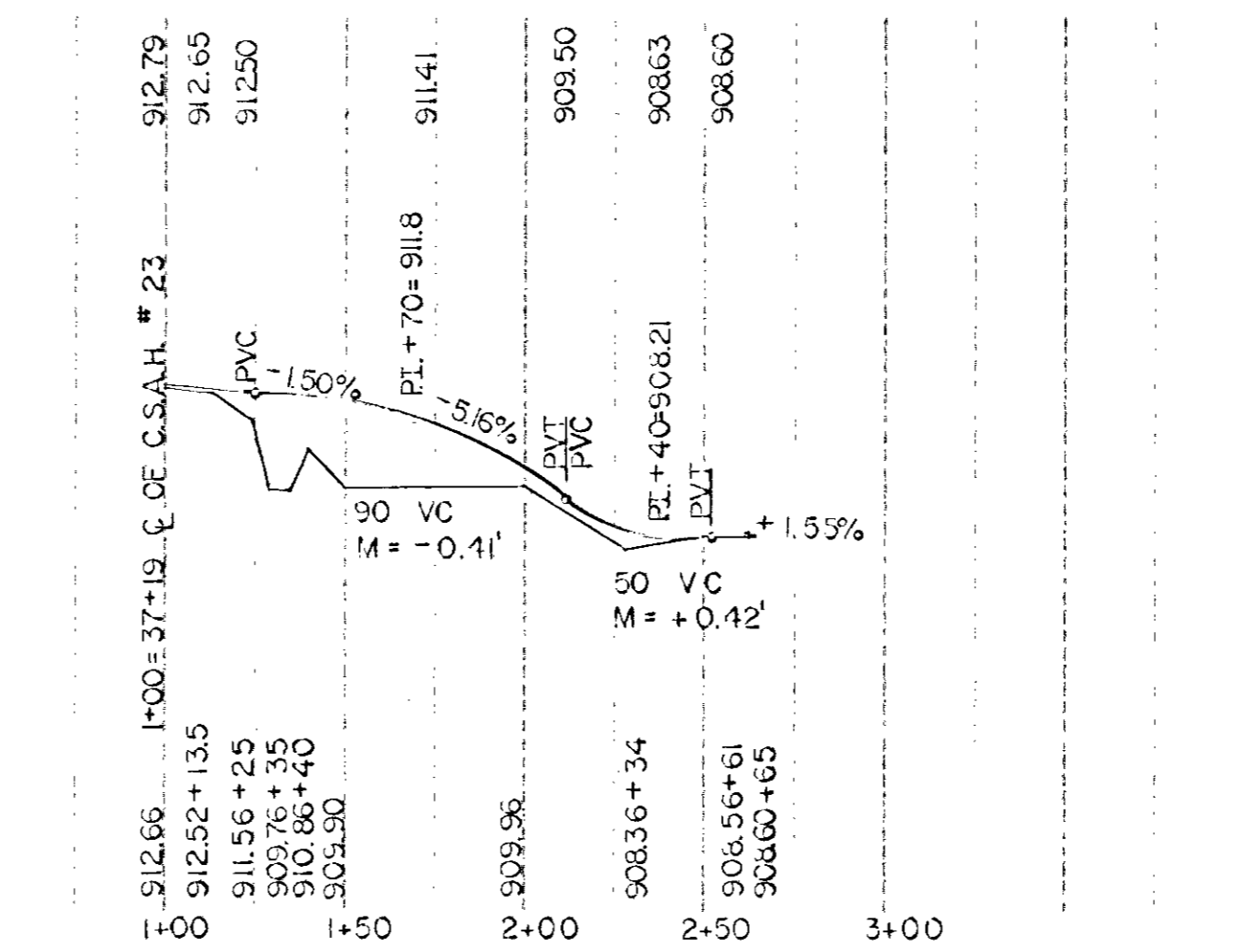

RESTWOOD RD. LT.  
 PI = STA. 47+89 = STA. 1+00  
 $\Delta = 110^\circ 00' \text{ LT}$   
 PI = STA. 2+03  
 $\Delta = 29^\circ 00' \text{ LT}$   
 DC = 20' 00'  
 TS = 74.09'  
 LC = 145.00'

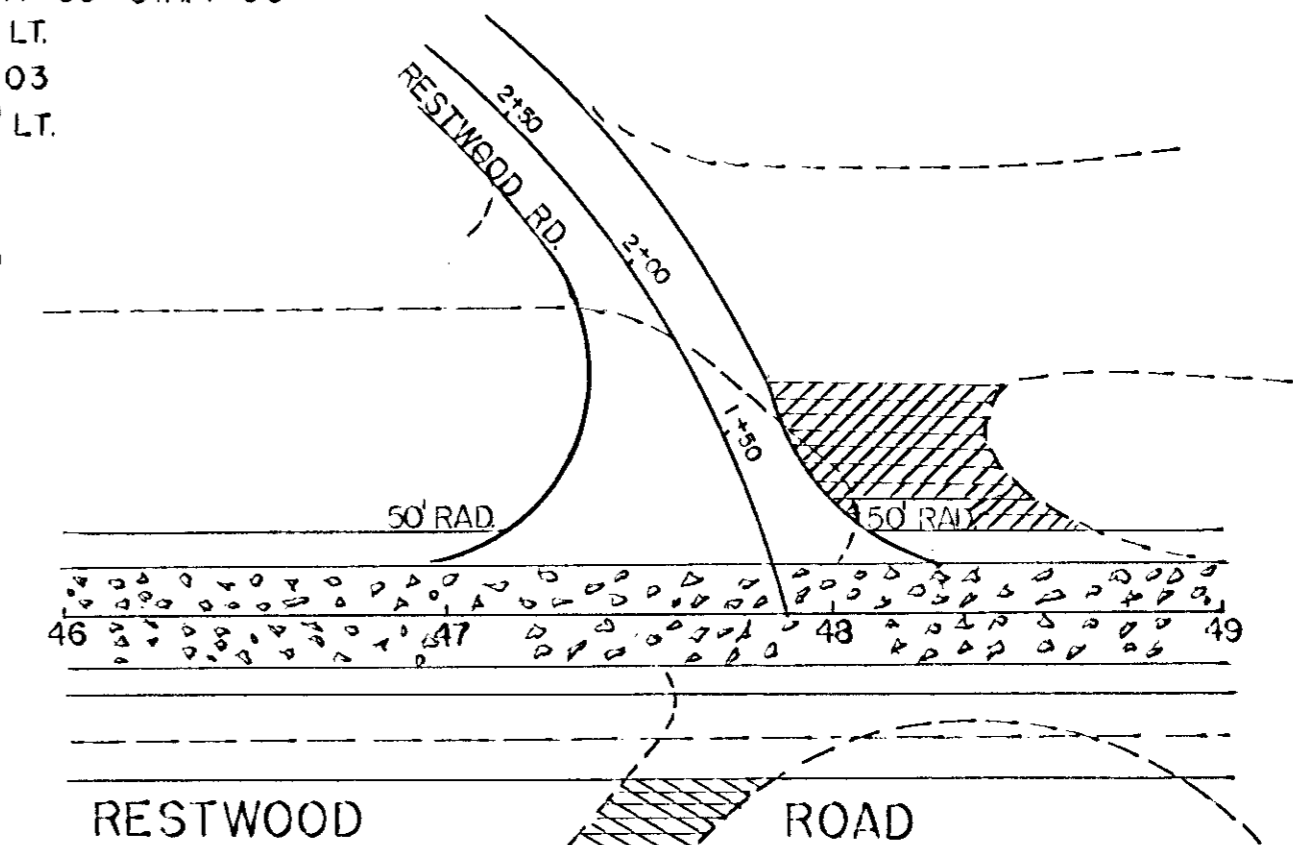

RESTWOOD ROAD

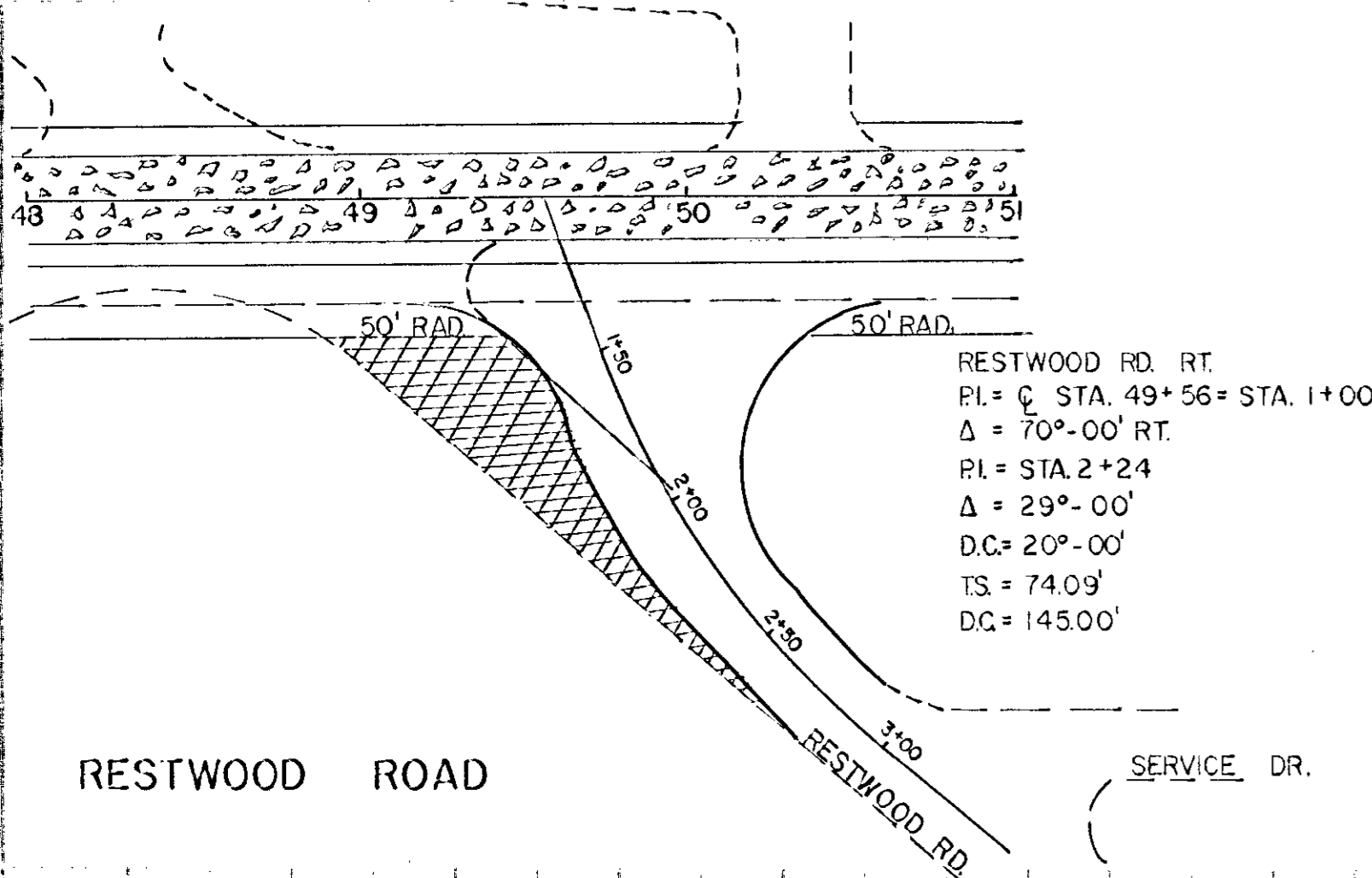
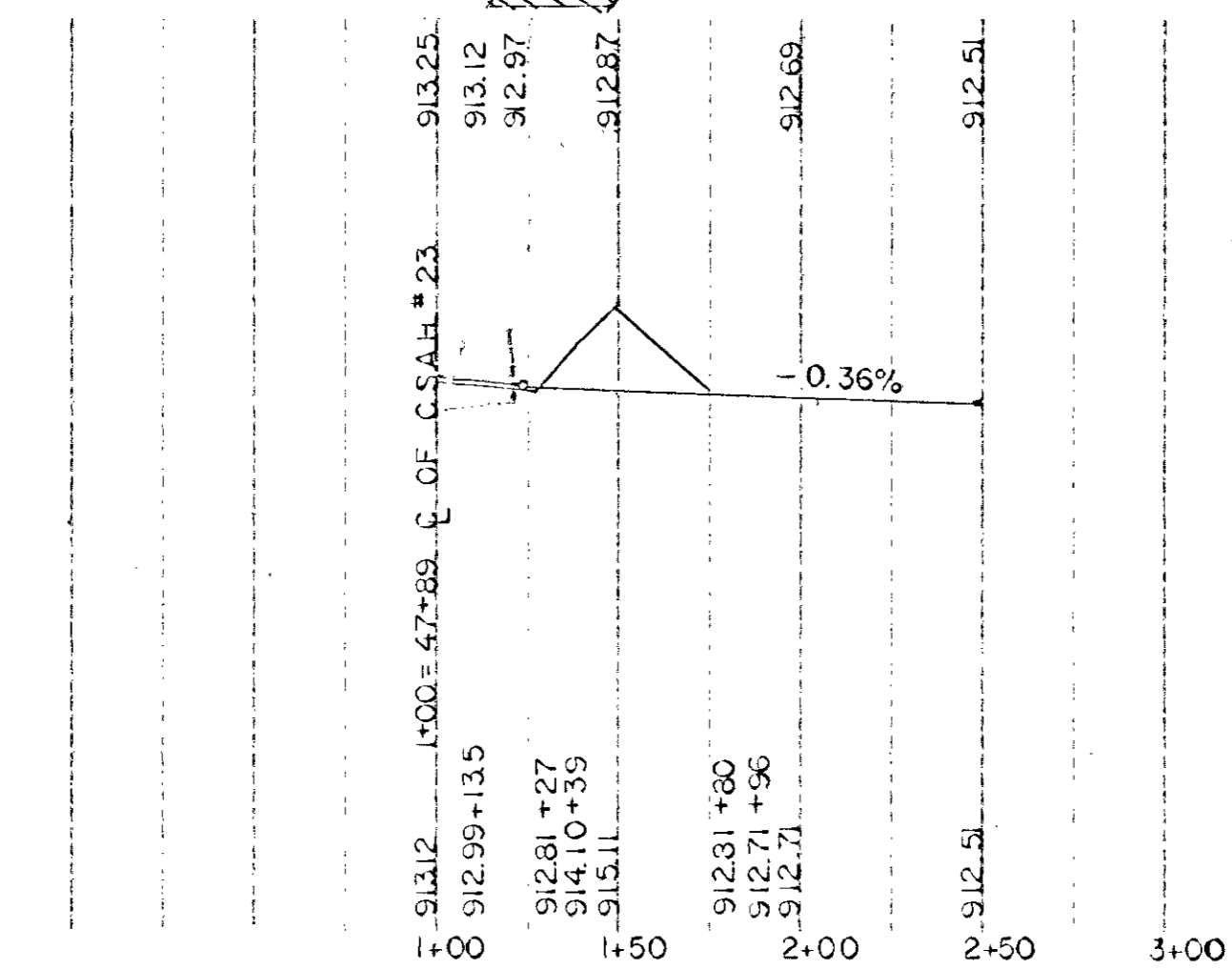

RESTWOOD ROAD

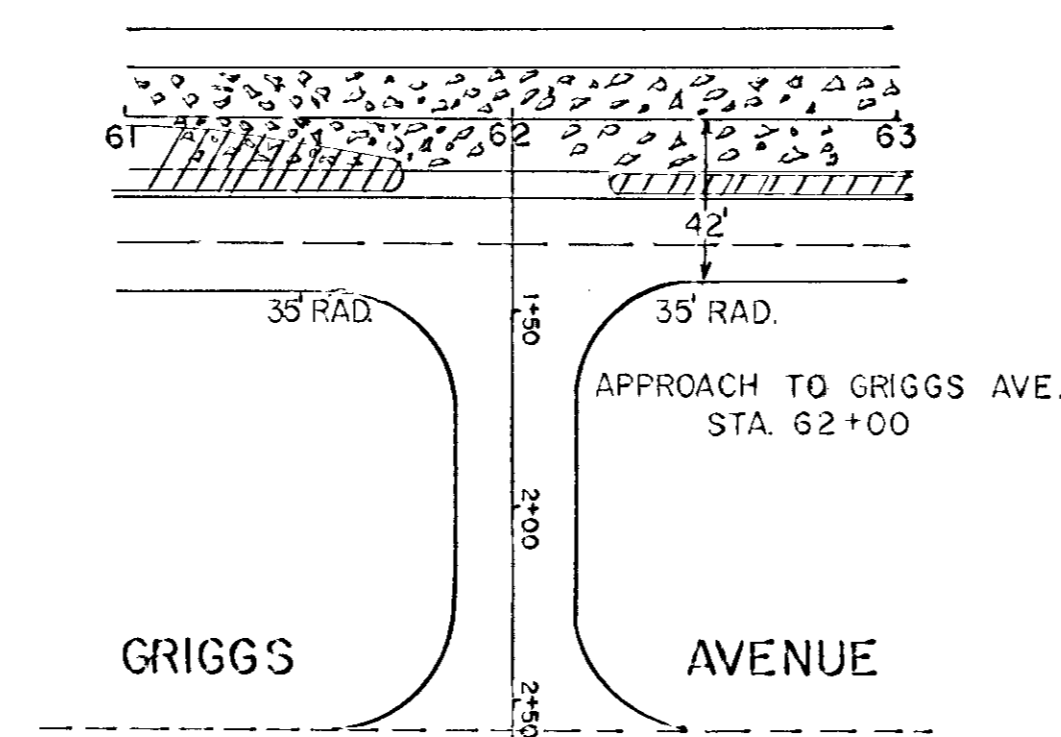
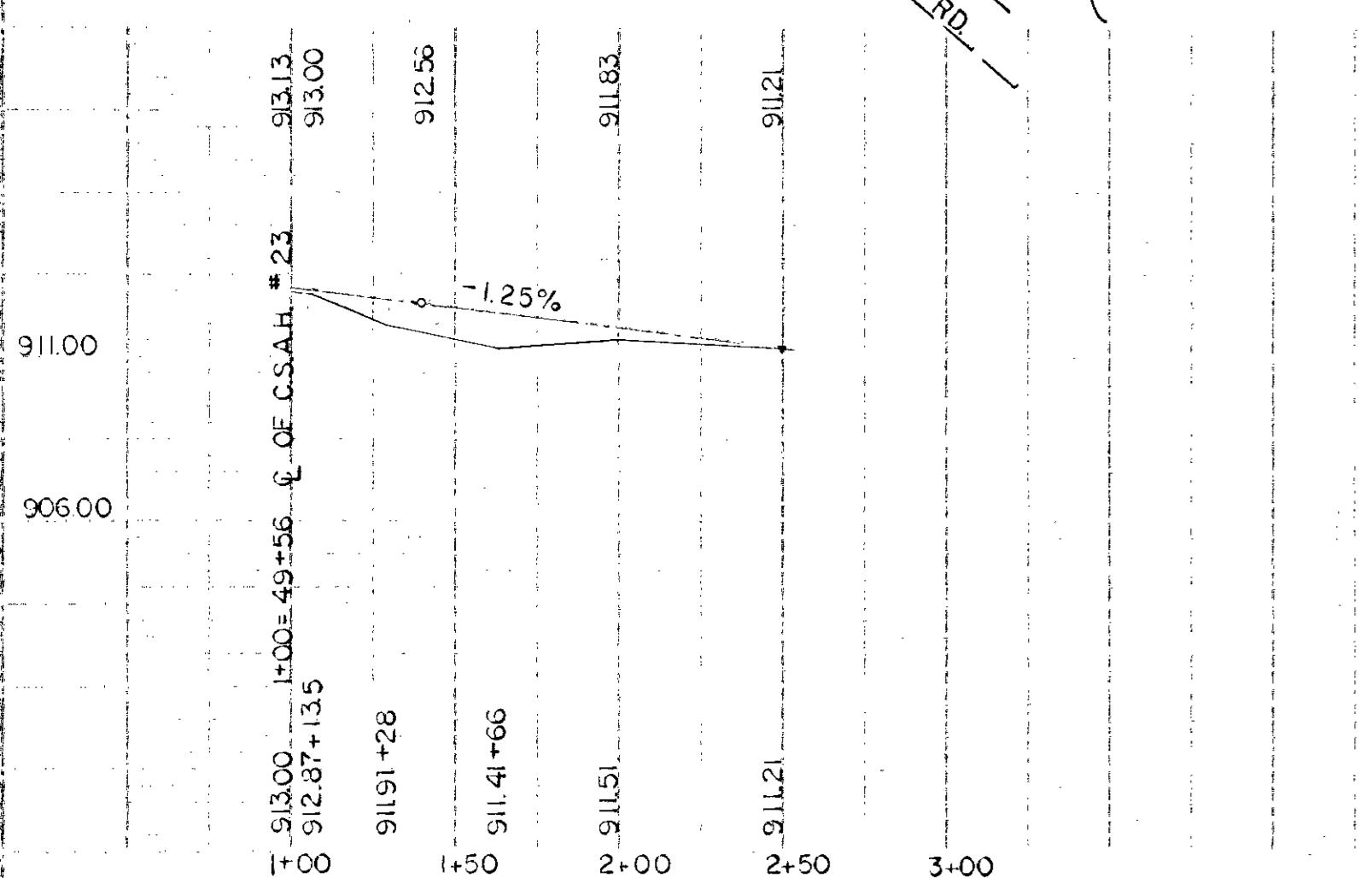

GRIGGS AVENUE

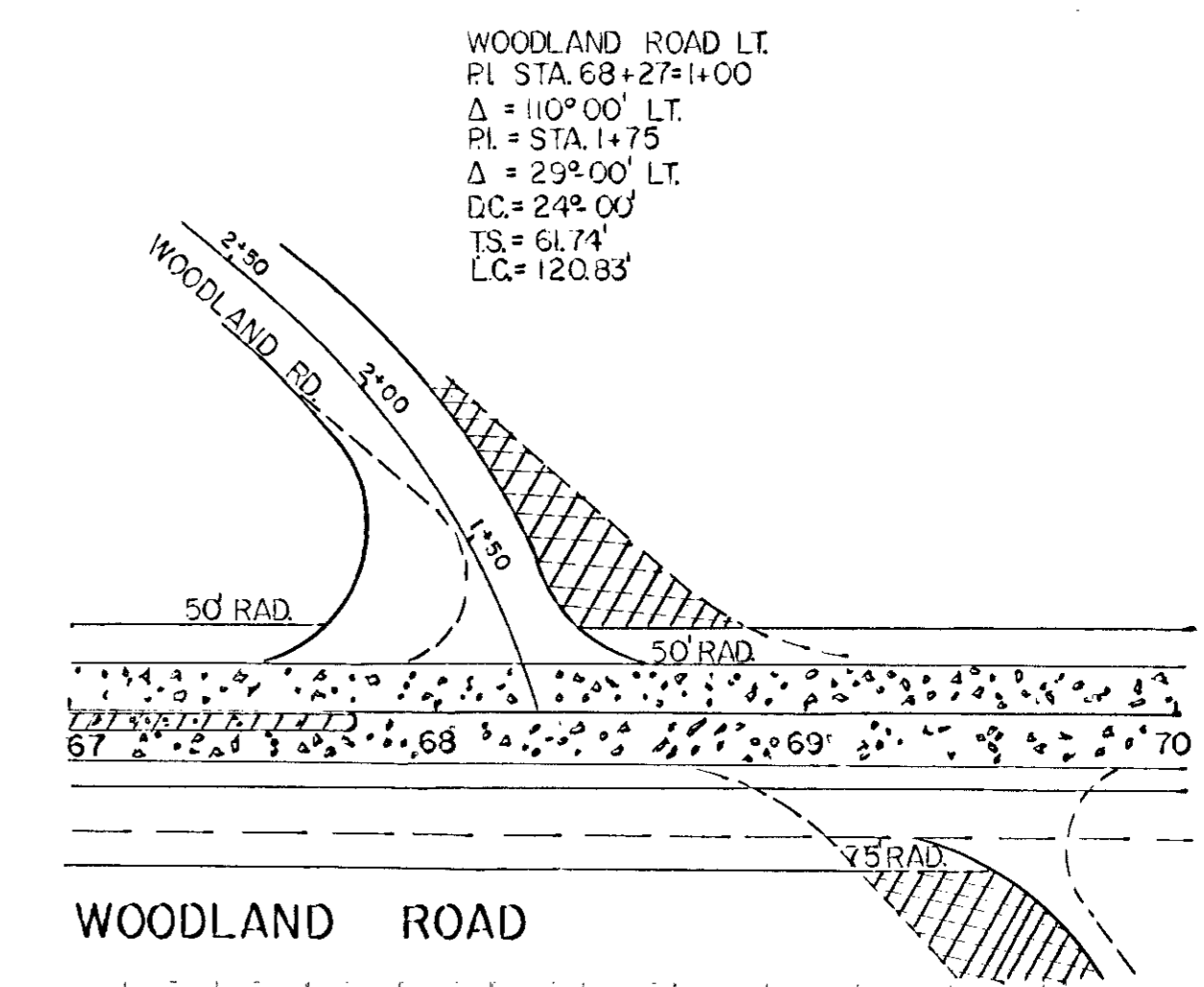
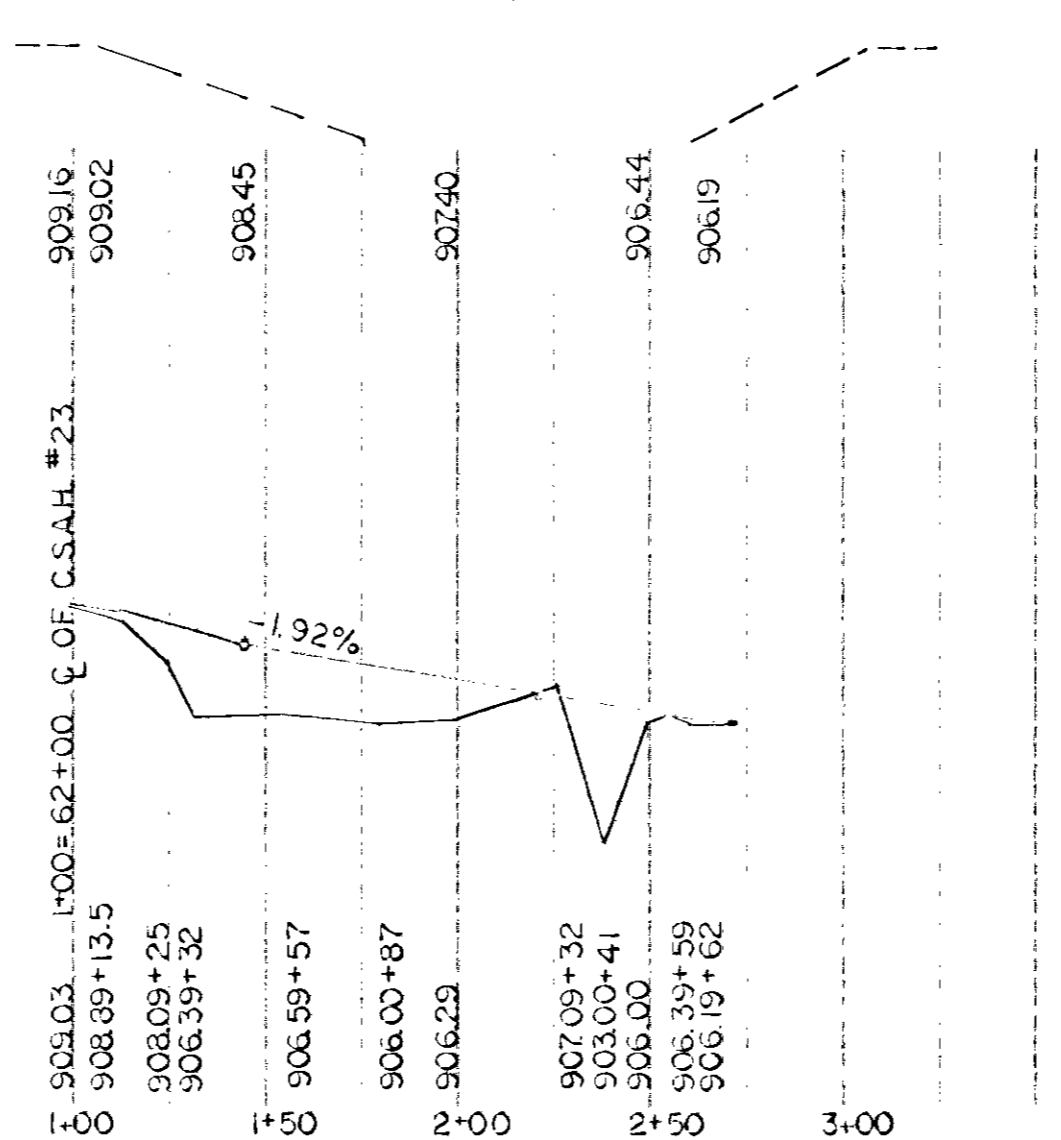

WOODLAND ROAD

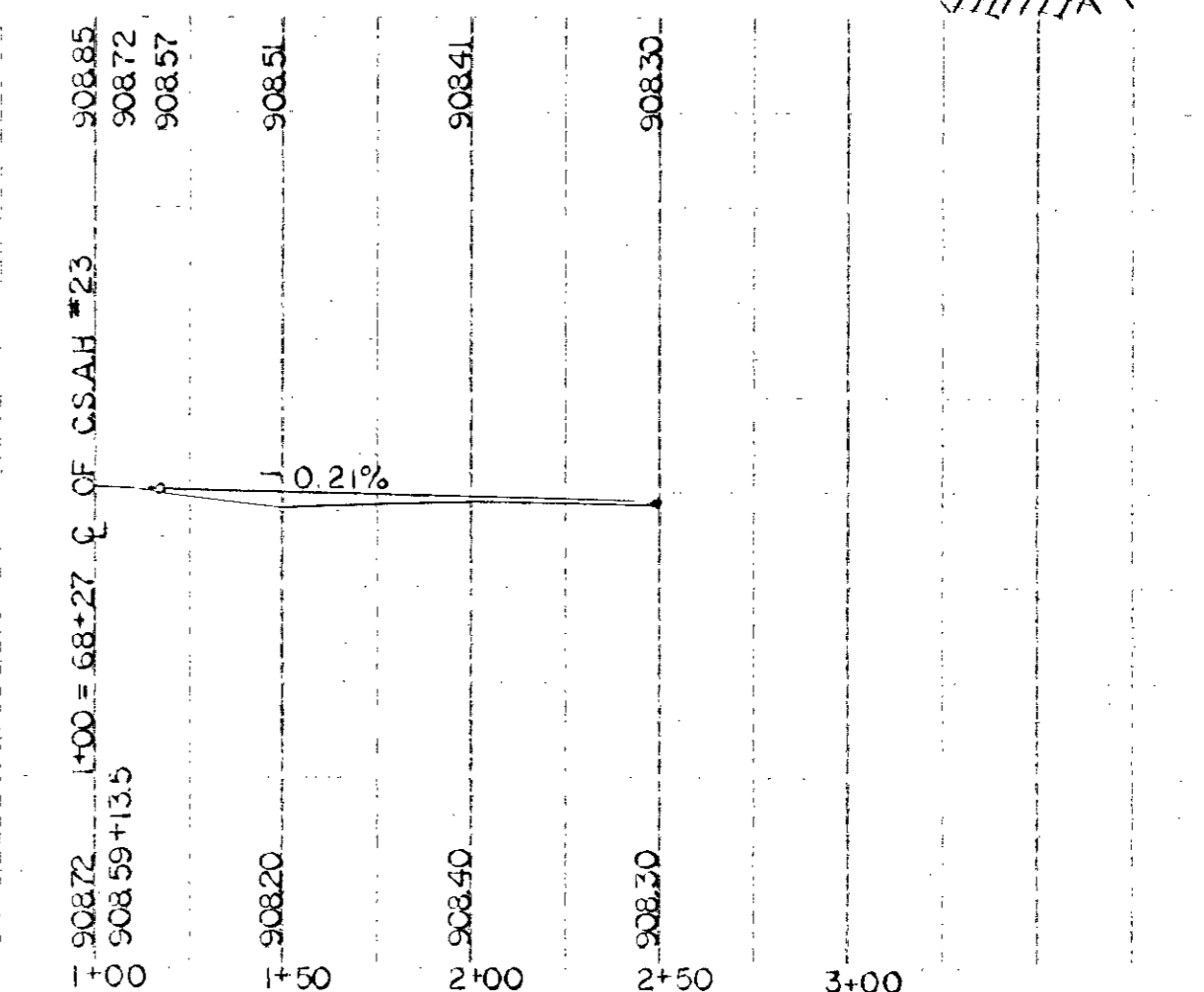

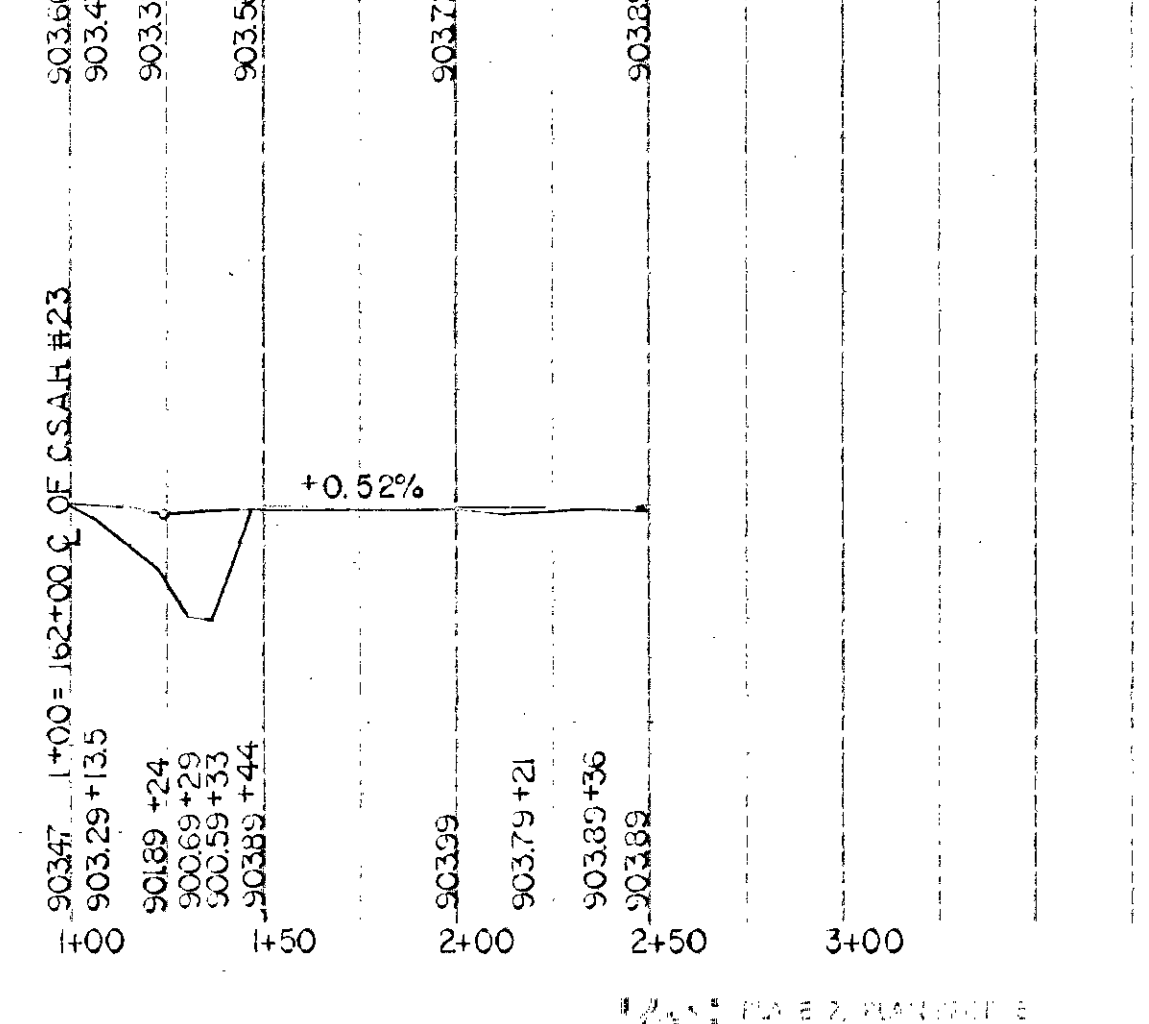
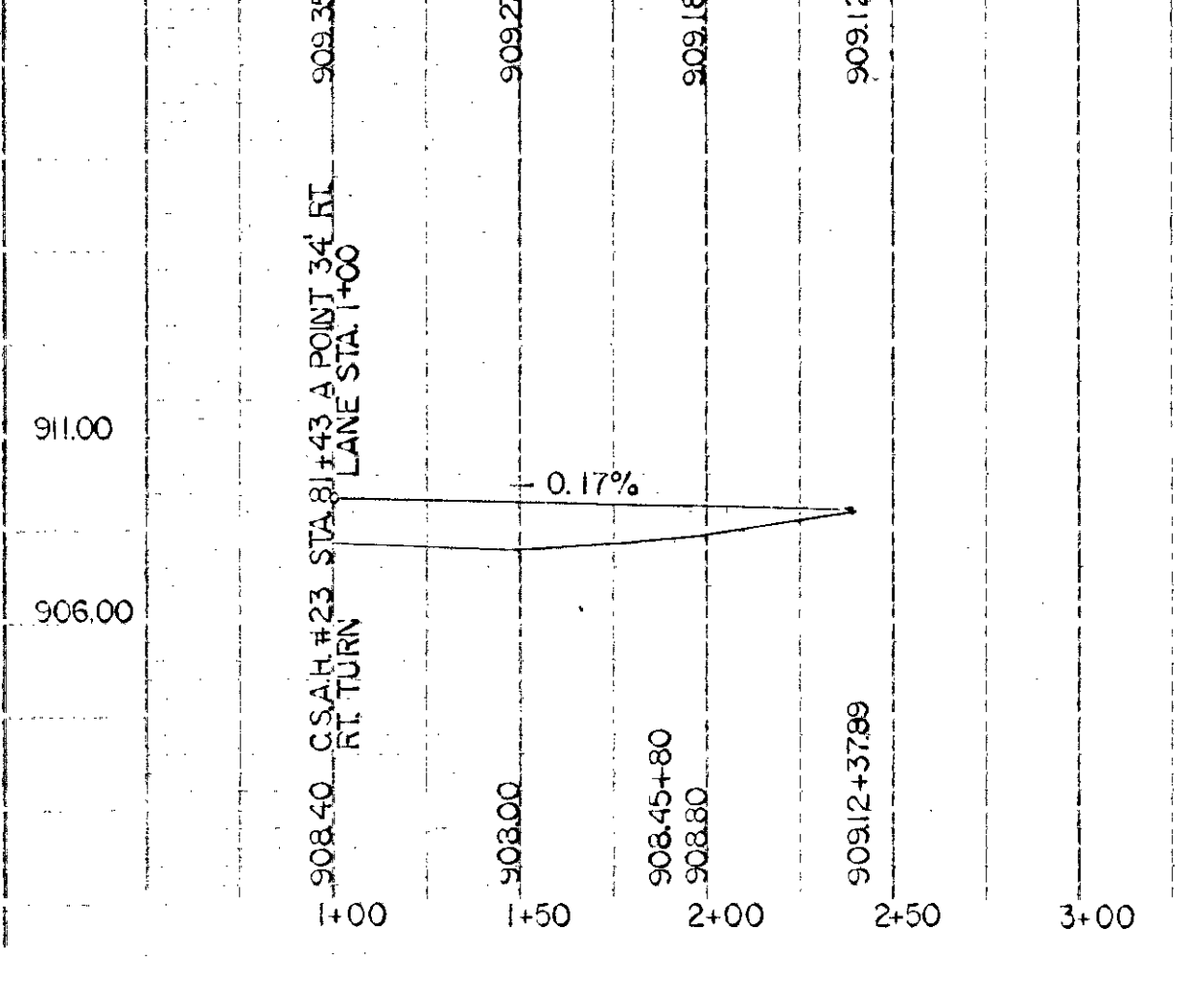
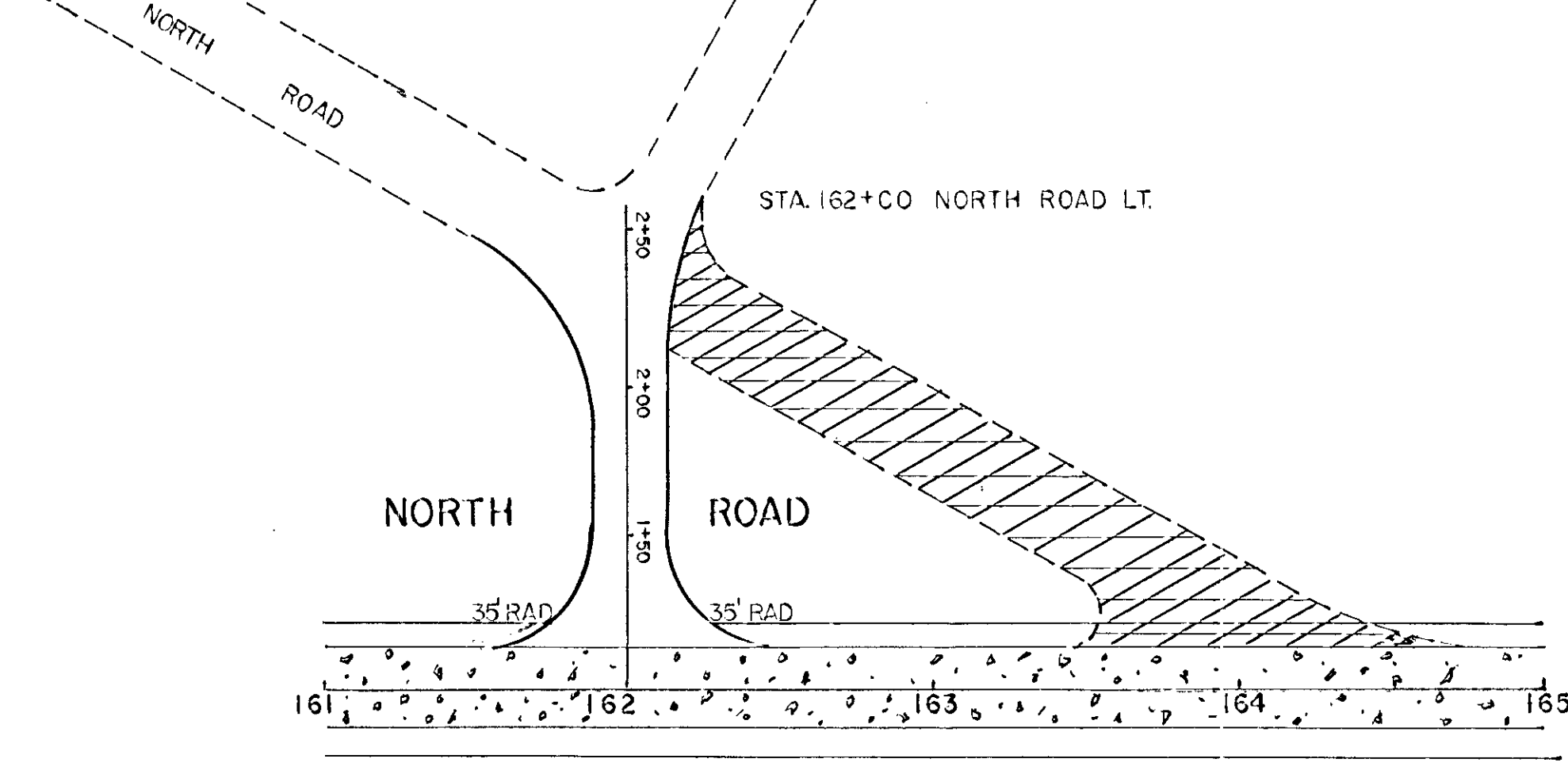
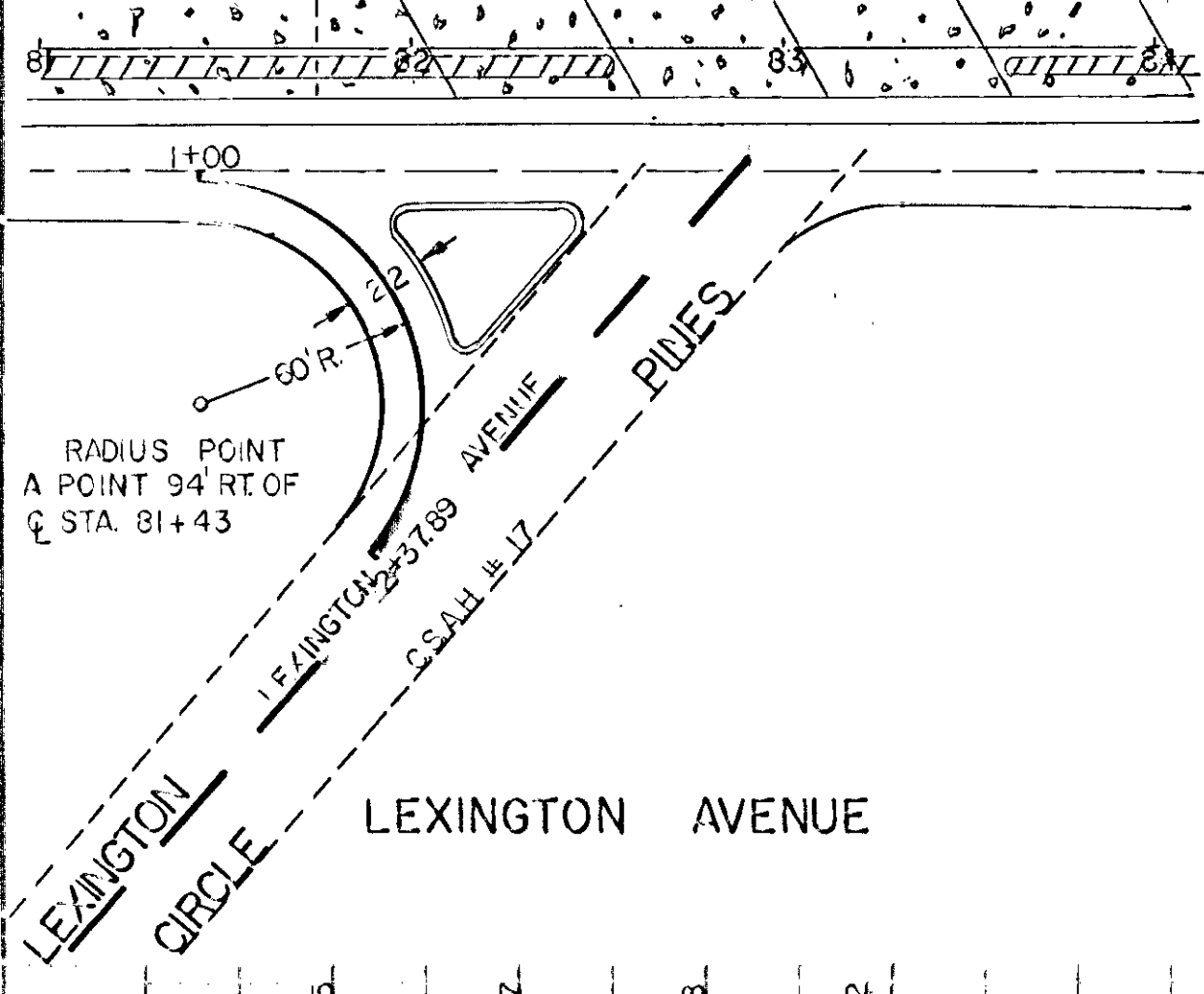
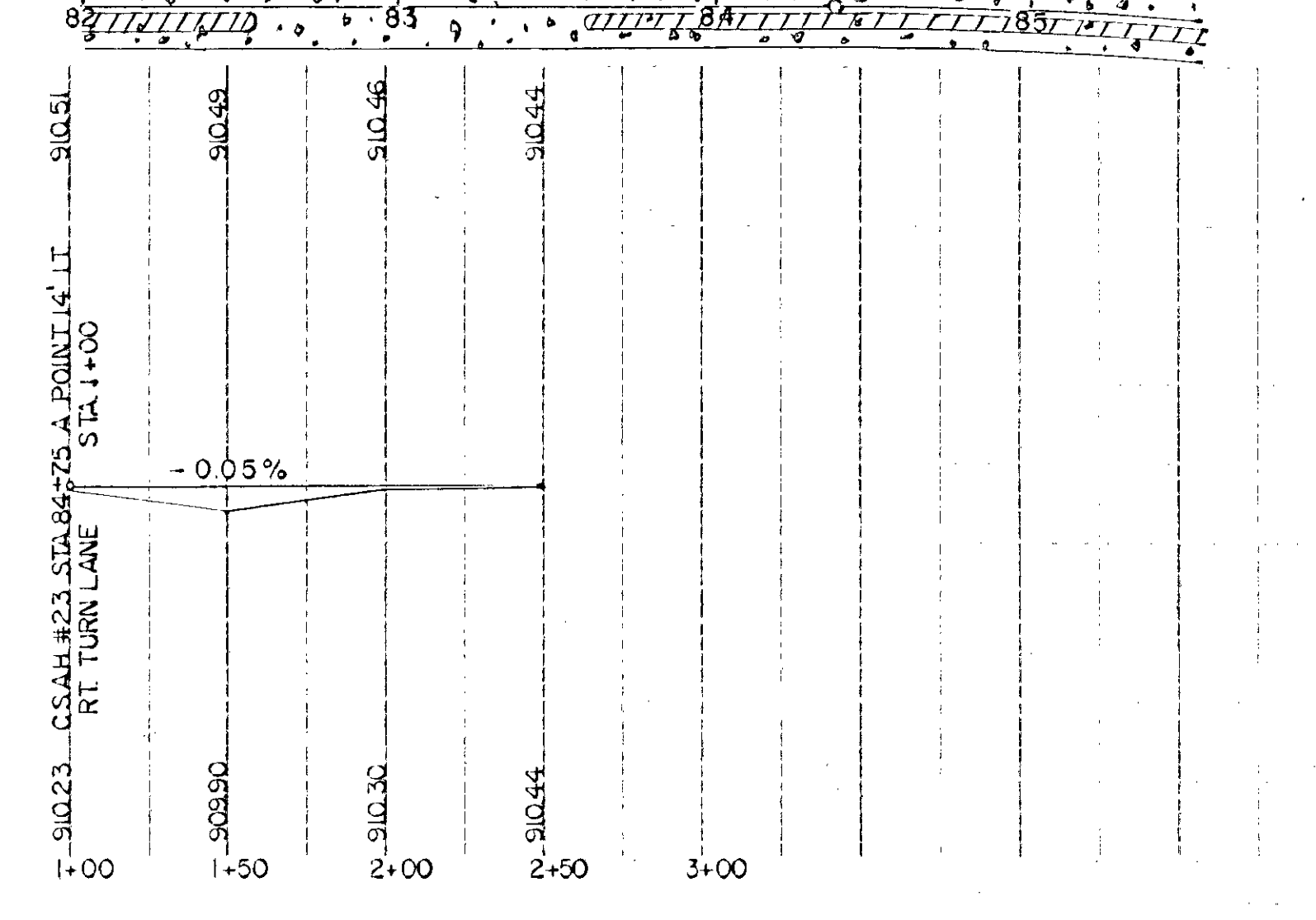
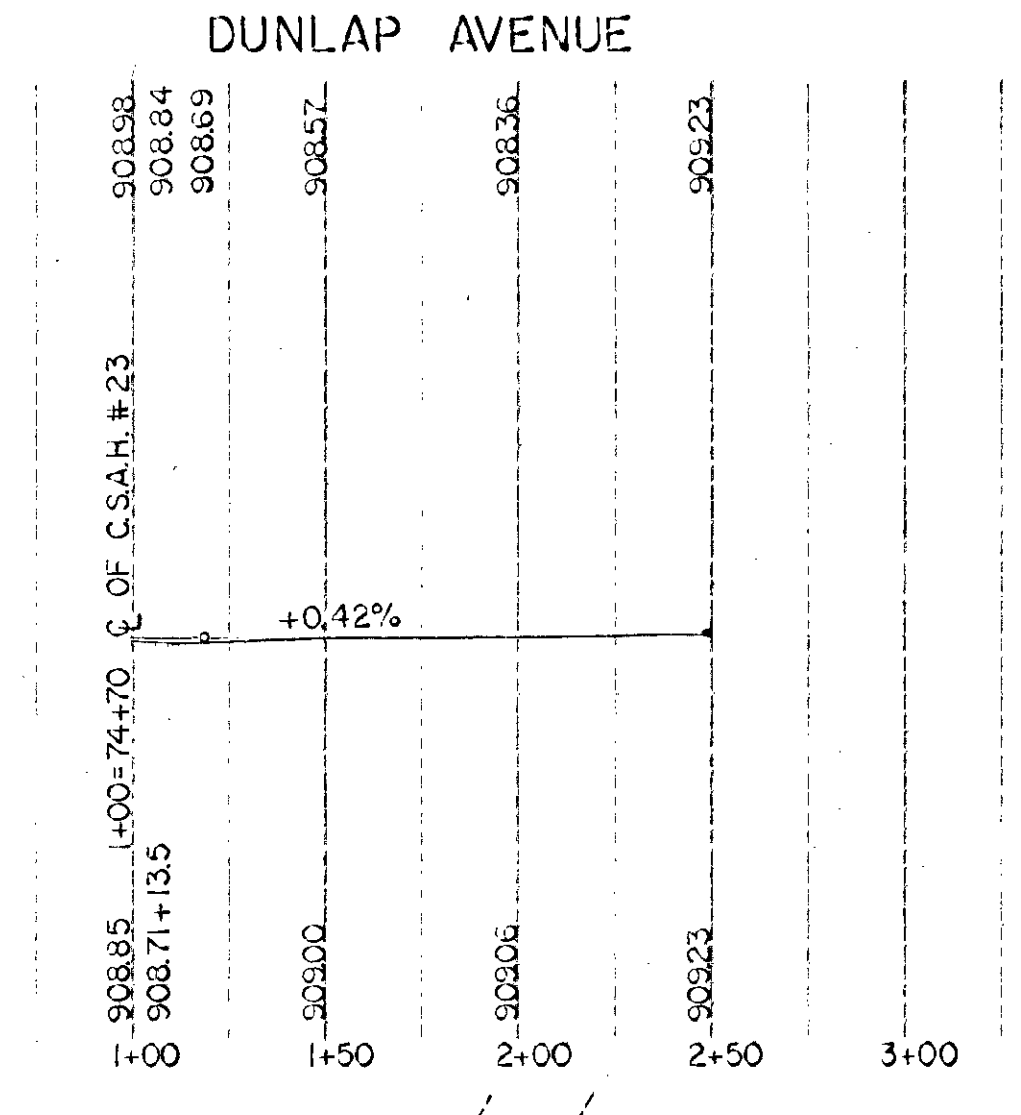
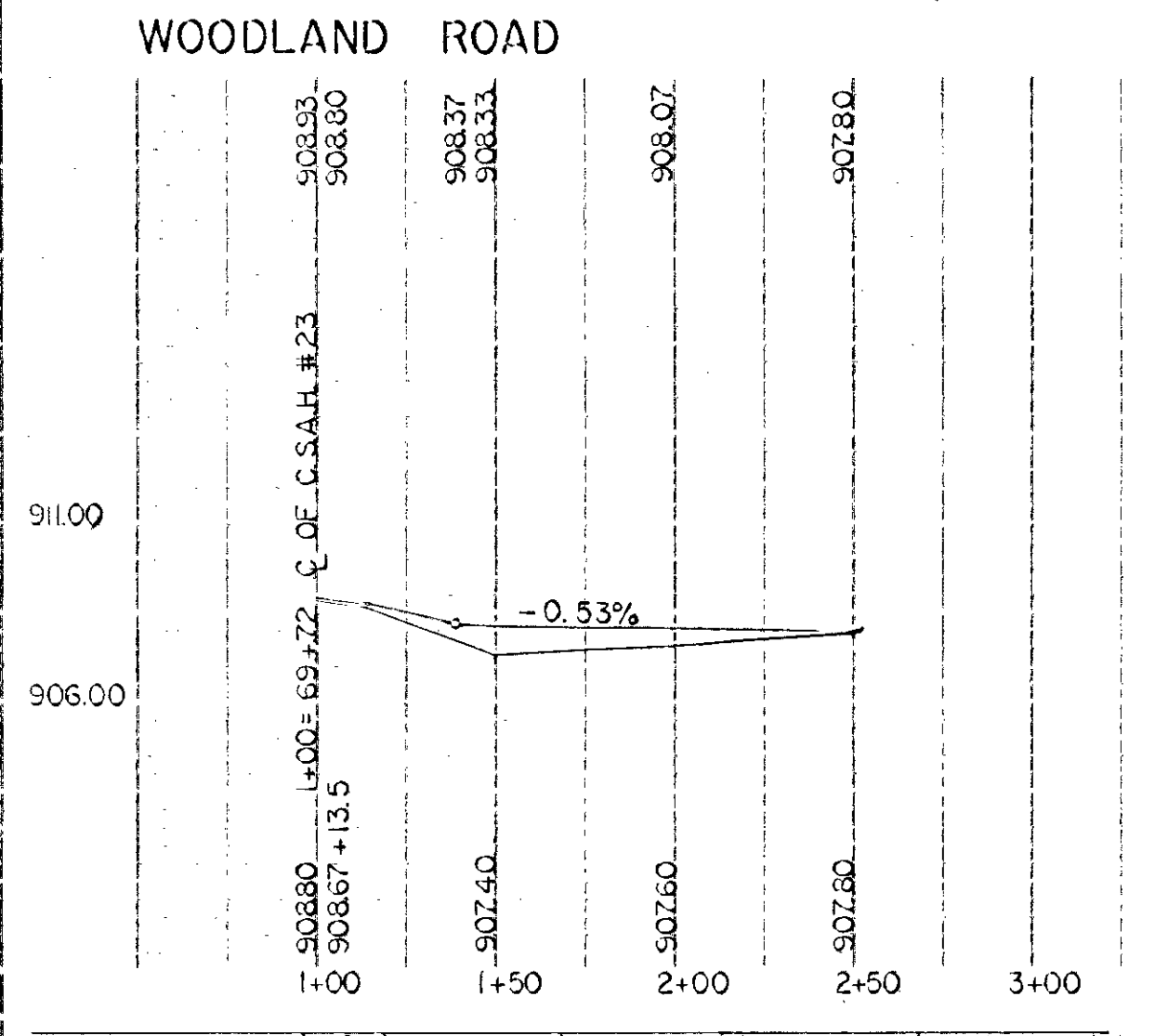
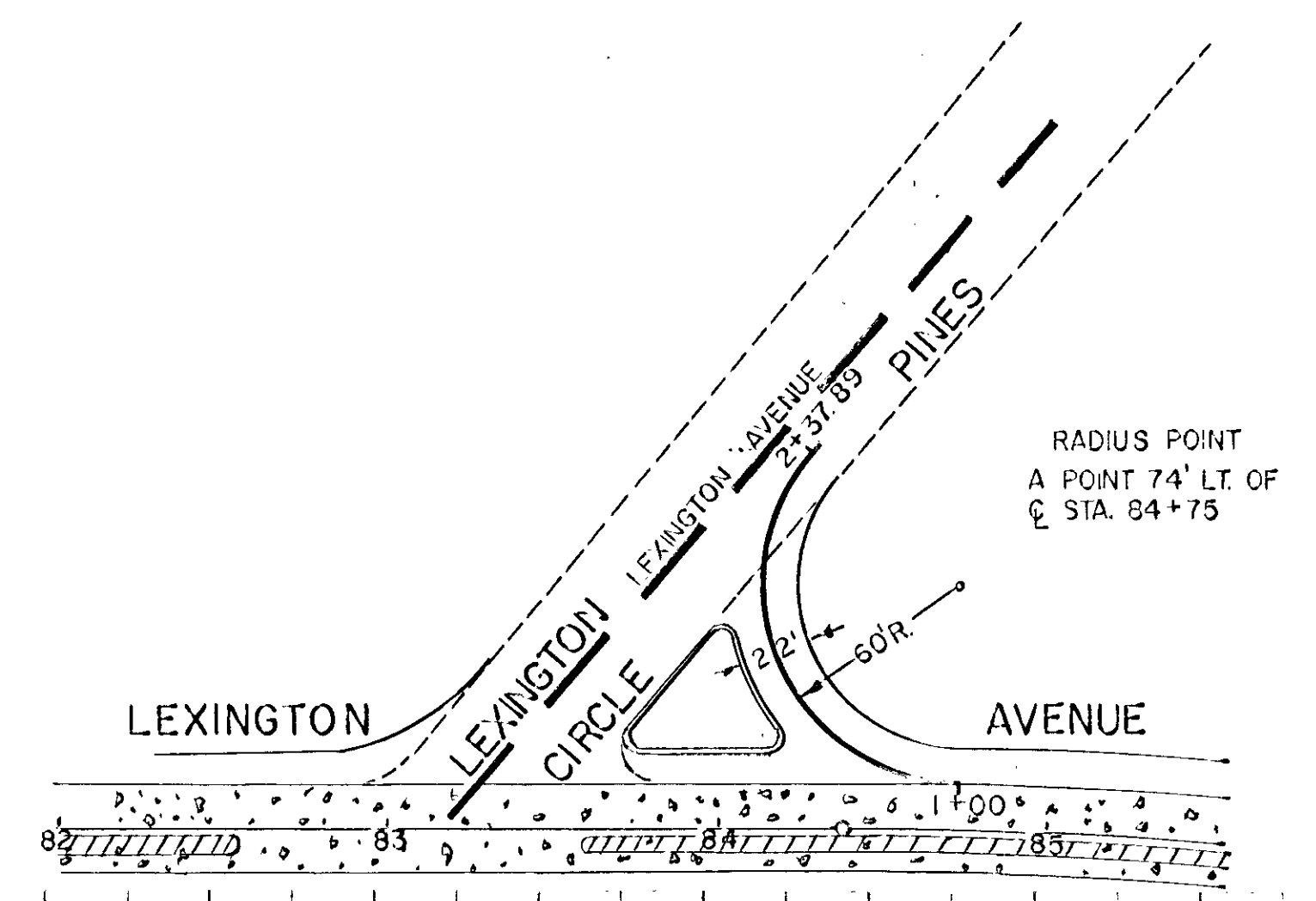
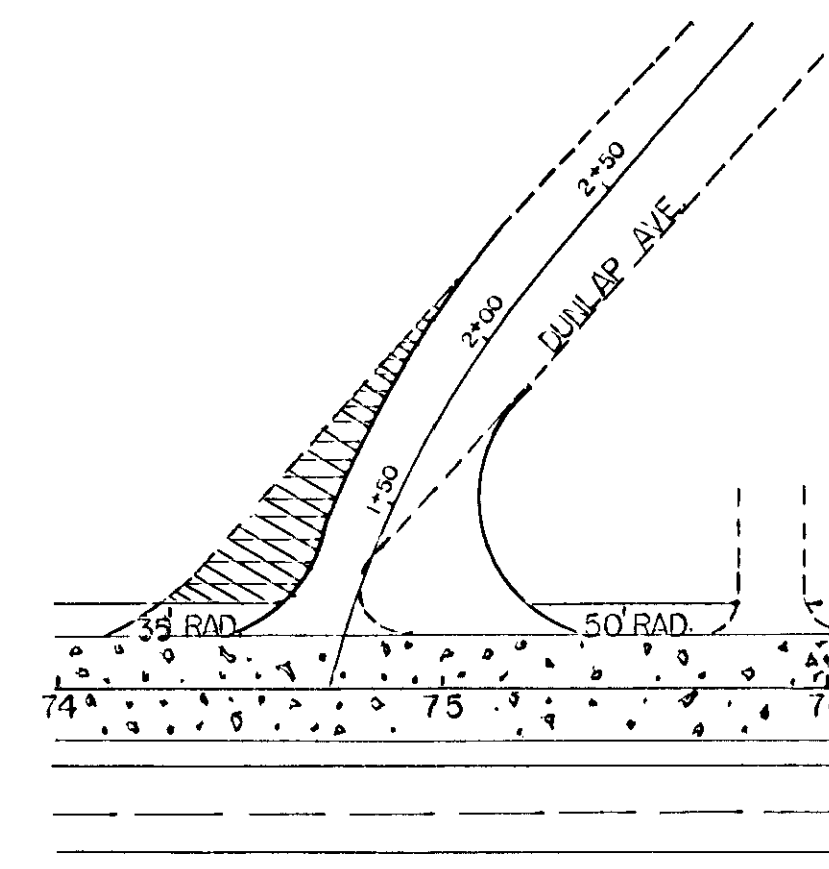
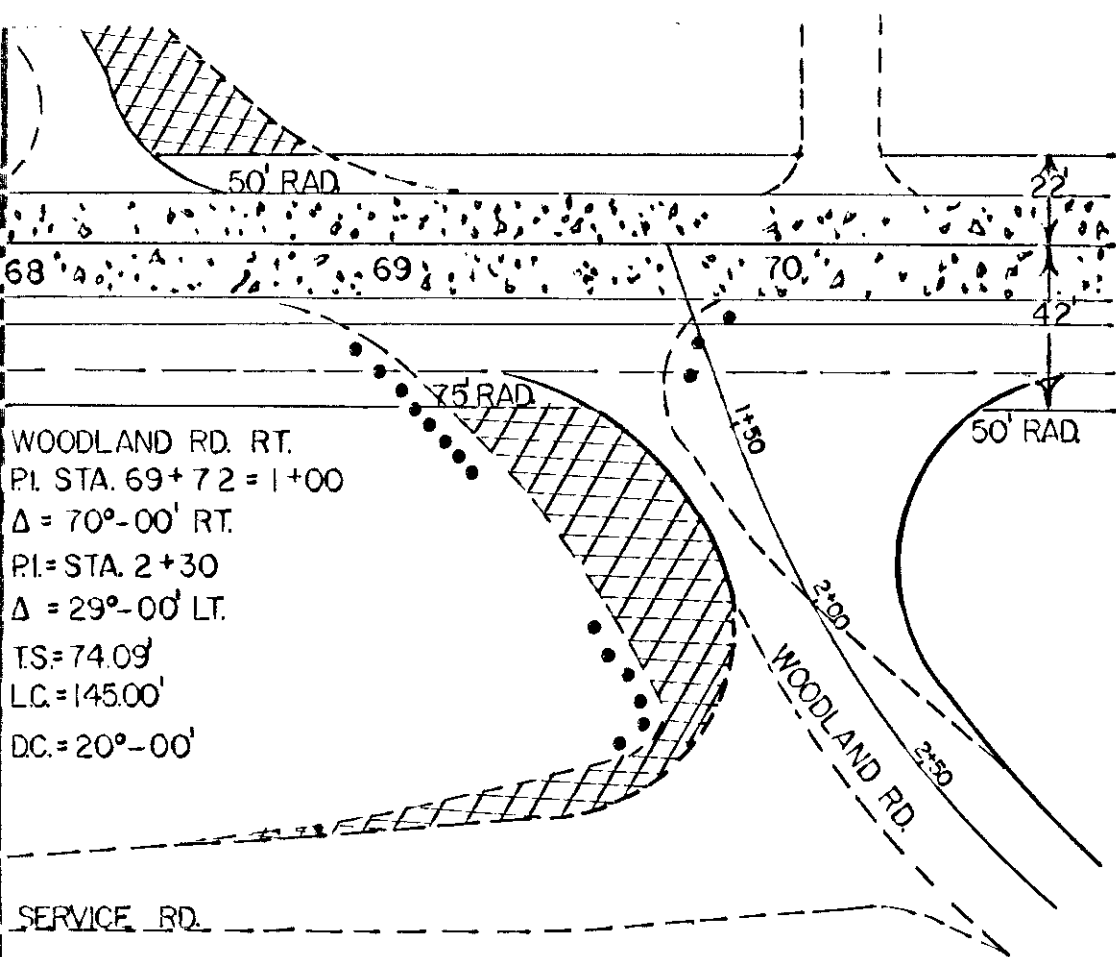

STATE OF MISSISSIPPI  
 DIVISION OF HIGHWAYS  
 CONTRACT NO. 270-2003  
 PROJECT NO. 3-003  
 SECTION 103  
 PAVING  
 NOTES: SEE GENERAL NOTES AND SPECIFICATIONS.

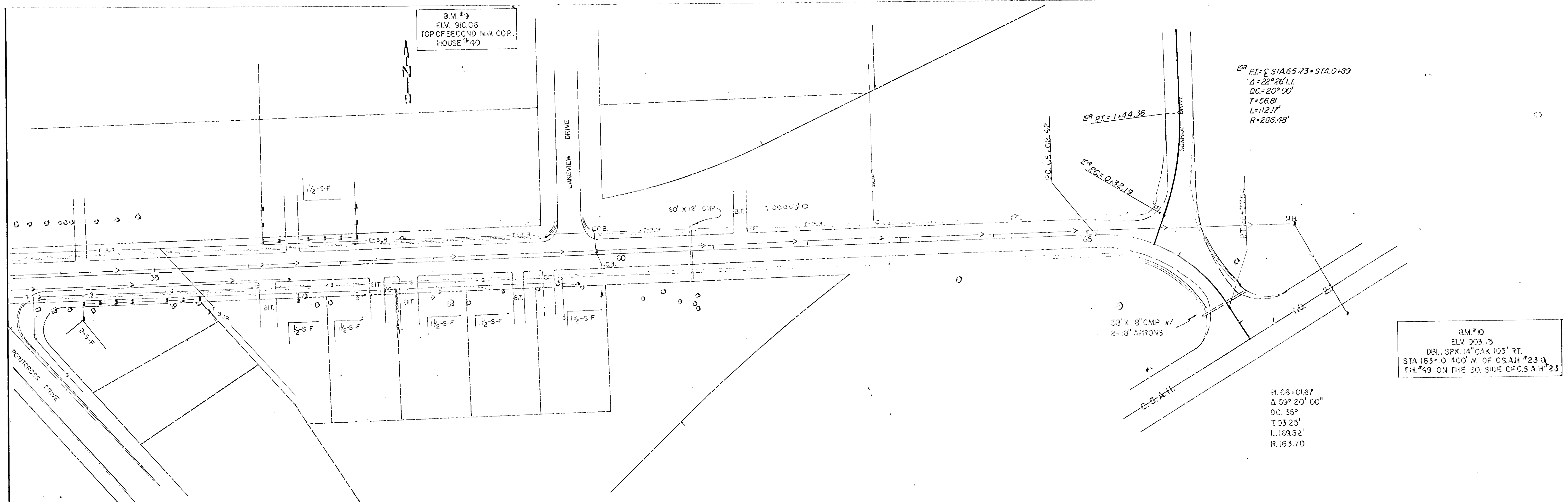

STATE OF MISSISSIPPI  
 DIVISION OF HIGHWAYS  
 CONTRACT NO. 270-2003  
 PROJECT NO. 3-003  
 SECTION 103  
 PAVING  
 NOTES: SEE GENERAL NOTES AND SPECIFICATIONS.

STATION	TYPE	ELEVATION
55+00	ASPH	905.00
55+05	ASPH	905.00
55+10	ASPH	905.00
55+15	ASPH	905.00
55+20	ASPH	905.00
55+25	ASPH	905.00
55+30	ASPH	905.00
55+35	ASPH	905.00
55+40	ASPH	905.00
55+45	ASPH	905.00
55+50	ASPH	905.00
55+55	ASPH	905.00
55+60	ASPH	905.00
55+65	ASPH	905.00
55+70	ASPH	905.00
55+75	ASPH	905.00
55+80	ASPH	905.00
55+85	ASPH	905.00
55+90	ASPH	905.00
55+95	ASPH	905.00
56+00	ASPH	905.00
56+05	ASPH	905.00
56+10	ASPH	905.00
56+15	ASPH	905.00
56+20	ASPH	905.00
56+25	ASPH	905.00
56+30	ASPH	905.00
56+35	ASPH	905.00
56+40	ASPH	905.00
56+45	ASPH	905.00
56+50	ASPH	905.00
56+55	ASPH	905.00
56+60	ASPH	905.00
56+65	ASPH	905.00
56+70	ASPH	905.00
56+75	ASPH	905.00
56+80	ASPH	905.00
56+85	ASPH	905.00
56+90	ASPH	905.00
56+95	ASPH	905.00
57+00	ASPH	905.00
57+05	ASPH	905.00
57+10	ASPH	905.00
57+15	ASPH	905.00
57+20	ASPH	905.00
57+25	ASPH	905.00
57+30	ASPH	905.00
57+35	ASPH	905.00
57+40	ASPH	905.00
57+45	ASPH	905.00
57+50	ASPH	905.00
57+55	ASPH	905.00
57+60	ASPH	905.00
57+65	ASPH	905.00
57+70	ASPH	905.00
57+75	ASPH	905.00
57+80	ASPH	905.00
57+85	ASPH	905.00
57+90	ASPH	905.00
57+95	ASPH	905.00
58+00	ASPH	905.00
58+05	ASPH	905.00
58+10	ASPH	905.00
58+15	ASPH	905.00
58+20	ASPH	905.00
58+25	ASPH	905.00
58+30	ASPH	905.00
58+35	ASPH	905.00
58+40	ASPH	905.00
58+45	ASPH	905.00
58+50	ASPH	905.00
58+55	ASPH	905.00
58+60	ASPH	905.00
58+65	ASPH	905.00
58+70	ASPH	905.00
58+75	ASPH	905.00
58+80	ASPH	905.00
58+85	ASPH	905.00
58+90	ASPH	905.00
58+95	ASPH	905.00
59+00	ASPH	905.00
59+05	ASPH	905.00
59+10	ASPH	905.00
59+15	ASPH	905.00
59+20	ASPH	905.00
59+25	ASPH	905.00
59+30	ASPH	905.00
59+35	ASPH	905.00
59+40	ASPH	905.00
59+45	ASPH	905.00
59+50	ASPH	905.00
59+55	ASPH	905.00
59+60	ASPH	905.00
59+65	ASPH	905.00
59+70	ASPH	905.00
59+75	ASPH	905.00
59+80	ASPH	905.00
59+85	ASPH	905.00
59+90	ASPH	905.00
59+95	ASPH	905.00
60+00	ASPH	905.00
60+05	ASPH	905.00
60+10	ASPH	905.00
60+15	ASPH	905.00
60+20	ASPH	905.00
60+25	ASPH	905.00
60+30	ASPH	905.00
60+35	ASPH	905.00
60+40	ASPH	905.00
60+45	ASPH	905.00
60+50	ASPH	905.00
60+55	ASPH	905.00
60+60	ASPH	905.00
60+65	ASPH	905.00
60+70	ASPH	905.00
60+75	ASPH	905.00
60+80	ASPH	905.00
60+85	ASPH	905.00
60+90	ASPH	905.00
60+95	ASPH	905.00
61+00	ASPH	905.00
61+05	ASPH	905.00
61+10	ASPH	905.00
61+15	ASPH	905.00
61+20	ASPH	905.00
61+25	ASPH	905.00
61+30	ASPH	905.00
61+35	ASPH	905.00
61+40	ASPH	905.00
61+45	ASPH	905.00
61+50	ASPH	905.00
61+55	ASPH	905.00
61+60	ASPH	905.00
61+65	ASPH	905.00
61+70	ASPH	905.00
61+75	ASPH	905.00
61+80	ASPH	905.00
61+85	ASPH	905.00
61+90	ASPH	905.00
61+95	ASPH	905.00
62+00	ASPH	905.00
62+05	ASPH	905.00
62+10	ASPH	905.00
62+15	ASPH	905.00
62+20	ASPH	905.00
62+25	ASPH	905.00
62+30	ASPH	905.00
62+35	ASPH	905.00
62+40	ASPH	905.00
62+45	ASPH	905.00
62+50	ASPH	905.00
62+55	ASPH	905.00
62+60	ASPH	905.00
62+65	ASPH	905.00
62+70	ASPH	905.00
62+75	ASPH	905.00
62+80	ASPH	905.00
62+85	ASPH	905.00
62+90	ASPH	905.00
62+95	ASPH	905.00
63+00	ASPH	905.00
63+05	ASPH	905.00
63+10	ASPH	905.00
63+15	ASPH	905.00
63+20	ASPH	905.00
63+25	ASPH	905.00
63+30	ASPH	905.00
63+35	ASPH	905.00
63+40	ASPH	905.00
63+45	ASPH	905.00
63+50	ASPH	905.00
63+55	ASPH	905.00
63+60	ASPH	905.00
63+65	ASPH	905.00
63+70	ASPH	905.00
63+75	ASPH	905.00
63+80	ASPH	905.00
63+85	ASPH	905.00
63+90	ASPH	905.00
63+95	ASPH	905.00
64+00	ASPH	905.00
64+05	ASPH	905.00
64+10	ASPH	905.00
64+15	ASPH	905.00
64+20	ASPH	905.00
64+25	ASPH	905.00
64+30	ASPH	905.00
64+35	ASPH	905.00
64+40	ASPH	905.00
64+45	ASPH	905.00
64+50	ASPH	905.00
64+55	ASPH	905.00
64+60	ASPH	905.00
64+65	ASPH	905.00
64+70	ASPH	905.00
64+75	ASPH	905.00
64+80	ASPH	905.00
64+85	ASPH	905.00
64+90	ASPH	905.00
64+95	ASPH	905.00
65+00	ASPH	905.00