

# MINNESOTA DEPARTMENT OF TRANSPORTATION ANOKA COUNTY

CONSTRUCTION PLAN FOR 1.5" BITUMINOUS MILL & 2" OVERLAY, POSSIBLE LEFT TURN LANE CONSTRUCTION/CLOSURE

LOCATED ON C.S.A.H. 9 BETWEEN TH 10 BRIDGE AND 135TH AVENUE NW / ROOSEVELT ST

COUNTY PROJ. NO. 09-16-09

C.S.A.H. 9

GROSS LENGTH 3937 FEET 0.75 MILES  
 BRIDGES-LENGTH \_\_\_\_\_ FEET \_\_\_\_\_ MILES  
 EXCEPTIONS-LENGTH \_\_\_\_\_ FEET \_\_\_\_\_ MILES  
 NET LENGTH 3937 FEET 0.75 MILES

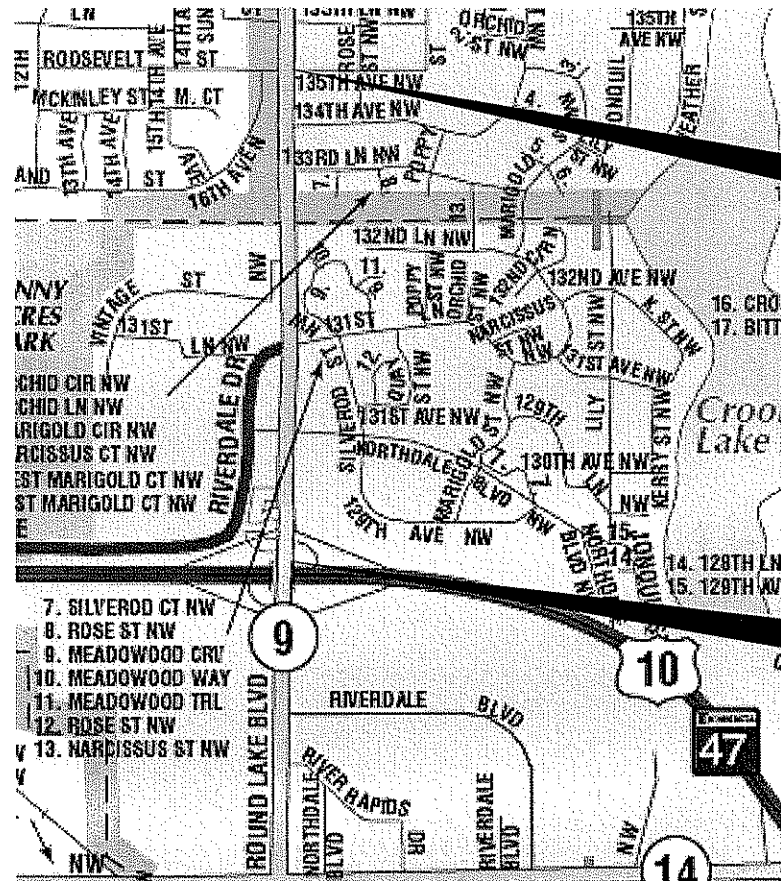

END PROJECT  
STA. 49+37

BEGIN PROJECT  
STA. 10+00

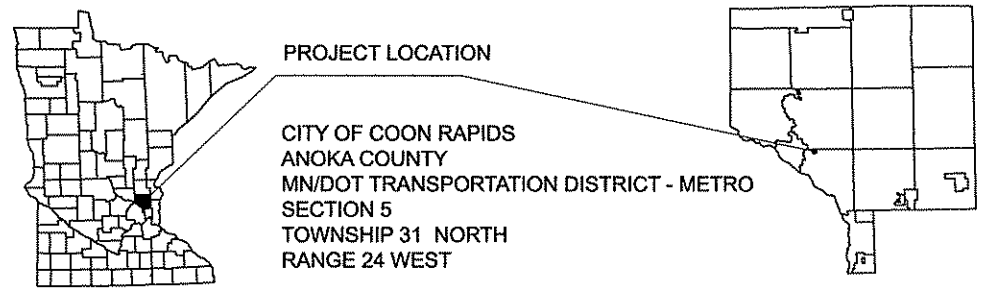

PROJECT LOCATION  
 CITY OF COON RAPIDS  
 ANOKA COUNTY  
 MN/DOT TRANSPORTATION DISTRICT - METRO  
 SECTION 5  
 TOWNSHIP 31 NORTH  
 RANGE 24 WEST

### PLAN SET

- Sheet(s)  
 1 TITLE / SEQ  
 2-5 PLANS (REMOVAL & LTL CLOSURE)  
 6-8 TYPICAL SECTIONS  
 9 DRAINAGE PROFILE  
 10-11 PAVEMENT MARKINGS

STATEMENT OF ESTIMATED QUANTITIES					
TAB NO.	ITEM NO.	ITEM	NOTE OR TAB NO.	UNIT	TOTAL EST. QUANT.
	2021.501	MOBILIZATION		LUMP SUM	1
	2102.501	PAVEMENT MESSAGE REMOVAL		SQ FT	35
	2102.502	PAVEMENT MARKING REMOVAL		LIN FT	230
	2104.501	REMOVE CONCRETE CURB		LIN FT	1132
	2104.503	REMOVE CONCRETE MEDIAN		SQ FT	1153
	2104.505	REMOVE BITUMINOUS PAVEMENT	8	SQ YD	1433
L	2104.509	REMOVE DRAINAGE STRUCTURE		EACH	1
	2104.511	SAWING CONCRETE PAVEMENT (FULL DEPTH)		LIN FT	217
	2104.513	SAWING BITUMINOUS PAVEMENT (FULL DEPTH)		LIN FT	1060
	2105.525	TOPSOIL BORROW		CU YD	36
	2211.503	AGGREGATE BASE CLASS 5	9	TON	94
	2221.501	AGGREGATE CLASS 7B	10	TON	17
	2232.501	MILL BITUMINOUS SURFACE (1.5")	14	SQ YD	42556
	2357.502	BITUMINOUS MATERIAL FOR TACK COAT	4	GALLON	2108
	2360.501	TYPE SP 12.5 WEARING COURSE MIX (4,E) (SPWEB440E)	16	TON	4798
	2360.501	TYPE SP 12.5 WEARING COURSE MIX (4,E)-STREETS & ENTRANCES	16	TON	213
	2360.609	TYPE MV3 NON-WEAR COURSE MIX FOR CB PATCH (MVNW35030 B)	11	TON	21
	2503.541	12" RCP SEWER DES 3006 CLASS V		LIN FT	12
	2503.541	24" RCP SEWER DES 3006 CLASS V		LIN FT	12
	2503.602	CONNECT TO EXISTING STORM SEWER		EACH	1
	2503.602	CONNECT TO EXISTING DRAINAGE STRUCTURE		LIN FT	1
NOTE D	2506.501	CONSTRUCT DRAINAGE STRUCTURE DESIGN DES 48-4020		EACH	1
	2506.501	CONSTRUCT DRAINAGE STRUCTURE DESIGN H		EACH	1
	2506.516	CASTING ASSEMBLY		EACH	2
	2531.501	CONCRETE CURB AND GUTTER DESIGN B618		LIN FT	289
	2531.501	CONCRETE CURB AND GUTTER DESIGN B624		LIN FT	943
	2531.503	6" CONCRETE MEDIAN	15	SQ YD	13
	2531.503	4" CONCRETE MEDIAN		SQ YD	1186
	2563.601	TRAFFIC CONTROL	12,13	LUMP SUM	1
	2563.610	POLICE OFFICER		HOURLY	20
	2564.531	SIGN PANNEL TYPE C	16	SQ FT	29
	2564.602	PAVEMENT MESSAGE (LT/RT ARROW)- HOT TAPE	3	EACH	14
	2564.603	24" SOLID LINE WHITE- HOT TAPE	3	LIN FT	359
	2564.603	4" BROKEN LINE WHITE- TEMPORARY PAINT	6	LIN FT	3150
	2564.603	4" SOLID LINE WHITE - EPOXY	3	LIN FT	9175
	2564.603	4" BROKEN LINE WHITE-EPOXY	3	LIN FT	2880
	2564.603	4" SOLID LINE YELLOW - EPOXY	3	LIN FT	6810
	2564.603	4" DOUBLE YELLOW-EPOXY	3	LIN FT	614
	2564.603	24" SOLID YELLOW-EPOXY	3	LIN FT	585
	2564.618	3' X 6' ZEBRA CROSSWALK- HOT TAPE	3	SQ FT	1908
	2565.602	LOOP DETECTOR 6' X 6'	1,2	EACH	59
	2580.523	REMOVABLE LANE TAPE	5	LIN FT	1260

- NOTES:
- WILL BE LOCATED AND MARKED BY ANOKA CO. PRIOR TO MILLING.
  - REPLACE ONLY IF DAMAGED DURING MILLING OPERATION.
  - MARKINGS TO BE IN PLACE WITH IN 72 HOURS OF FINAL MAINLINE PAVING.
  - TACK FOR MILLED BITUMINOUS AREAS. EST. AT 0.05 GAL / SQ YD.
  - TEMP LANE TAPE SKIPS TO BE PLACED ON NEW MAT AT END OF EACH PAVING DAY.
  - TEMP PAINT SKIPS FOR MARKING LANES DELINEATION ON MILLED BIT SURFACE AT END OF EACH MILLING DAY.
  - SAWCUT 2 FEET FROM LIP OF THE EXISTING CURB, AROUND EXISTING CB'S, NEW ISLAND NOSES AND LTL CLOSURE AREA.
  - LTL CLOSURE AREA (LNB & LSB) AND ISLAND NOSE AREAS MUST BE CONSTRUCTED AND COMPLETE PRIOR TO MILLING.
  - AGGREGATE BASE CLASS 5 TO BE USED FOR CONSTRUCTING LTL CLOSURE AREA.
  - AGGREGATE BASE CLASS 7B USED FOR COMPACTING AROUND CB'S IN LTL CLOSURE AREA AND TO FILL CENTER MEDIAN PRIOR TO PAVING.
  - PLACED AND COMPACTED AROUND CB'S IN LTL CLOSURE AND ISLAND NOSE AREA PRIOR TO MILLING.
  - 2-PORTABLE CHANGEABLE MESSAGEE SIGNS USED IN ADVANCE OF LTL CLOSURE AREA. 1-LSB CSAH 9 1-LNB CSAH 9 NORTH OF TH 10 BRIDGE
  - INCLUDES STOP HERE ON RED SIGNS INSTALLED AT INTERSECTION .
  - MAINLINE MILLING INCLUDES DETAIL MILLING AROUND MANHOLES, GATE VALVES, AND ALL STRUCTURES IN BIT. PAVEMENT AREA TO BE MILLED.
  - NEW CONCRETE ISLAND NOSE PAID FOR UNDER 6" CONCRETE MEDIAN
  - ALL MANHOLES MUST BE LOCATED AND PROTECTED AT ALL TIMES DURING MILLING AND PAVING OPERATIONS. CONTRACTORS RESPONSIBILITY

ITEM NO.	BASIS OF PLANNED QUANTITIES
2221.501	AGGREGATE BASE CLASS-5 1 CU = 1.8 TONS (CV)
2221.501	AGGREGATE BASE CLASS-7B 1 CU = 1.8 TONS (CV)
2357.502	BITUMINOUS MATERIAL FOR TACK COAT .05 GAL / SQ YD
2360.501	TYPE SP 12.5 WEARING COURSE MIX (4, E) (SQ YD * IN. *115 LBS)/2000 = TONS
2360.609	TYPE LV3 NON-WEAR COURSE MIX FOR CB PATCH (LVNW35030 B) (SQ YD * IN. *115 LBS)/2000 = TONS
2563.613	PORTABLE CHANGEABLE MESSAGE SIGN (2 UNITS * 8 DAYS)
2564.603	4" BROKEN LINE WHITE- TEMPORARY PAINT ((PROJECT LENGTH * 4) / 50) * 10

PLATE NO.	STANDARD PLATE DETAIL DESCRIPTION
3000L	REINFORCED CONCRETE PIPE
3006G	GASKET JOINT FOR R.C. PIPE
4006L	MANHOLE OR CATCH BASIN
4010H	CONCRETE SHORT CONE AND ADJUSTING RING
4011E	PRECAST CONCRETE BASE
4020J	MANHOLE OR CATCH BASIN
4026A	CONCRETE ENCASED CONCRETE ADJUSTING RINGS
4125D	CATCH BASIN FRAME CASTING
4134A	CURB BOX CASTING FOR CATCH BASIN
4154B	CATCH BASIN GRATE CASTING
7100H	CONCRETE CURB AND GUTTER
7111J	INSTALLATION OF CATCH BASIN CASTINGS
7113A	CONCRETE APPROACH NOSE DETAIL
8000I	STANDARD BARRICADES

NO	DATE	BY	CHKD	APPR	REVISION

NAME: P:\09-01-00\CSAH\_9\PLAN\OVERLAY TEMPLET COVER SET 0809 7:55:47 AM

I HEREBY CERTIFY THAT THIS PLAN WAS PREPARED BY ME OR UNDER MY DIRECT SUPERVISION AND THAT I AM A DULY LICENSED PROFESSIONAL ENGINEER UNDER THE LAWS OF THE STATE OF MINNESOTA.  
 PRINT NAME: Charles Cadenhead  
 SIGNATURE: *Charles Cadenhead*  
 DATE: 3/23/09 LICENSE NO. 40416

DRAWN BY: CO DATE: 2/9/2009  
 DESIGN BY: CO DATE: 2/9/2009  
 CHECKED BY: CO DATE: 2/9/2009

**ANOKA COUNTY**  
**HIGHWAY DEPT.**

STATE PROJECT NO. \_\_\_\_\_  
 STATE PROJECT NO. \_\_\_\_\_  
 STATE PROJECT NO. \_\_\_\_\_  
 STATE PROJECT NO. 09-16-09

TITLE / SEQ  
 CSAH 9  
 Sheet 1 of 11 Sheets

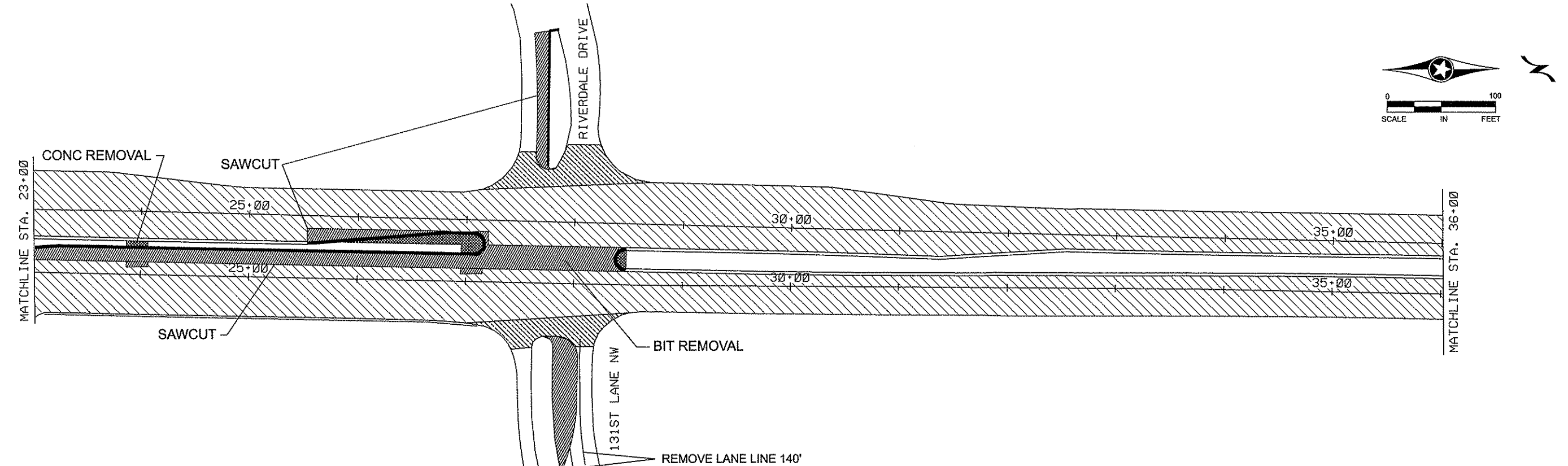
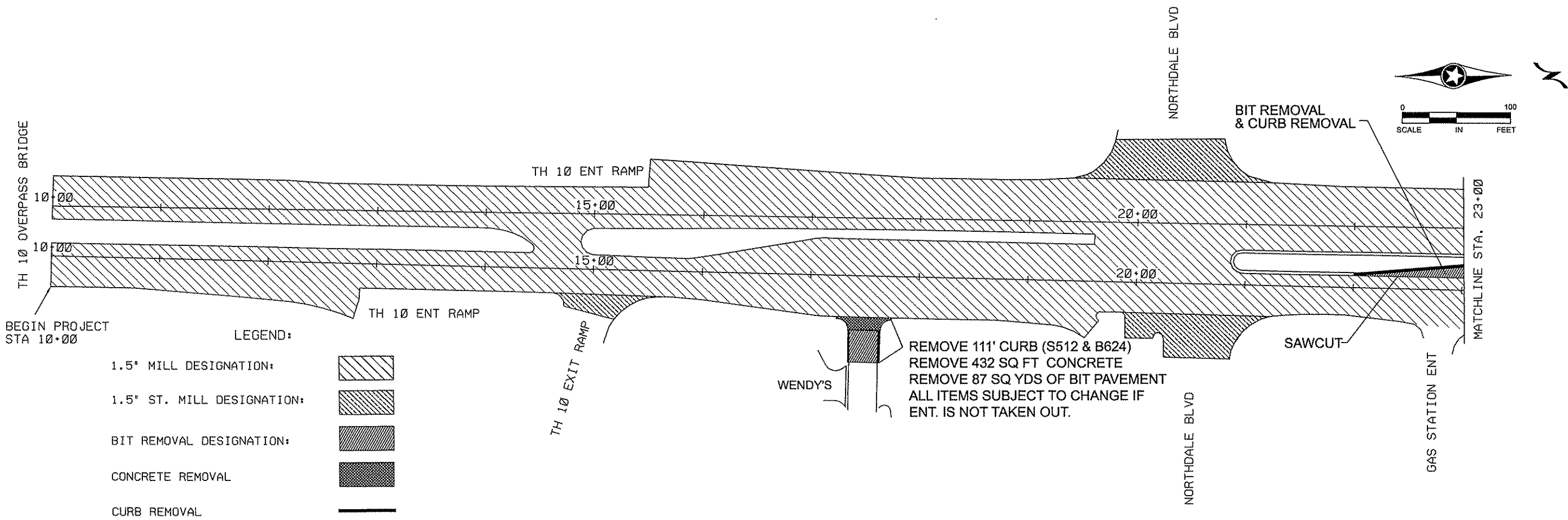

NO	DATE	BY	CKD	APPR	REVISION

NAME: P:\09-01-00\CSAH\_9\Plan\OVERLAY TEMPLAT PLAN PLAN.dgn 03/17/2009 8:22:10 AM

I HEREBY CERTIFY THAT THIS PLAN WAS PREPARED BY ME OR UNDER MY DIRECT SUPERVISION AND THAT I AM A DULY LICENSED PROFESSIONAL ENGINEER UNDER THE LAWS OF THE STATE OF MINNESOTA.

PRINT NAME: Charles Cadenhead

SIGNATURE: *Charles Cadenhead*

DATE: 3/23/09 LICENSE NO. 40415

DRAWN BY SK DATE 2/9/2009

DESIGN BY SK DATE 2/9/2009

CHECKED BY CO DATE 2/9/2009

**ANOKA COUNTY**  
HIGHWAY DEPT.

STATE PROJECT NO. \_\_\_\_\_

STATE AID PROJECT NO. \_\_\_\_\_

CITY PROJECT NO. \_\_\_\_\_

COUNTY PROJECT NO. 09-16-09

REMOVAL / MILLING PLAN  
CSAH 9

STA 10+00 TO 36+00

Sheet 2 of 11 Sheets

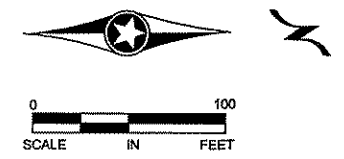

REMOVE CONCRETE CURB 15' EACH  
 REMOVE CONCRET MEDIAN 18 SQ FT EACH  
 REMOVE BIT PAVEMENT 3 SQ YDS EACH  
 CONCRETE SAWCUT 8' EACH  
 BIT SAWCUT 19' EACH

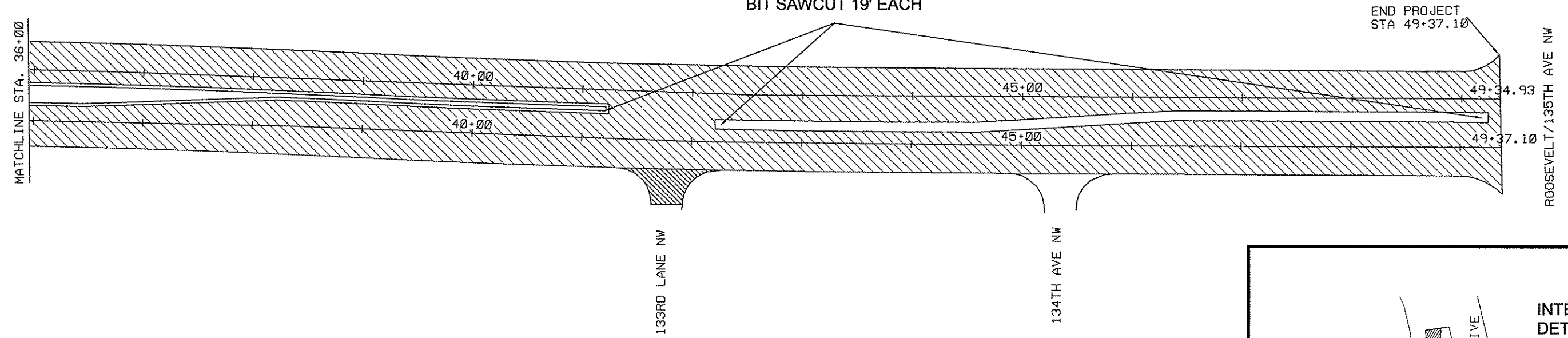

**TRAFFIC CONTROL NOTES:**

THE MULT-LANE DIVIDED SECTION OF THE TEMPORARY TRAFFIC CONTROL ZONE LAYOUTS FIELD MANUAL DATED JANUARY 2007 SHALL BE USED DURING THE NIGHTTIME MILLING AND PAVING PHASES OF THE PROJECT. THE CONTRACTOR SHALL GIVE A 2 WORKING DAY NOTICE TO REQUEST SIGNALS TO BE PUT IN FLASH

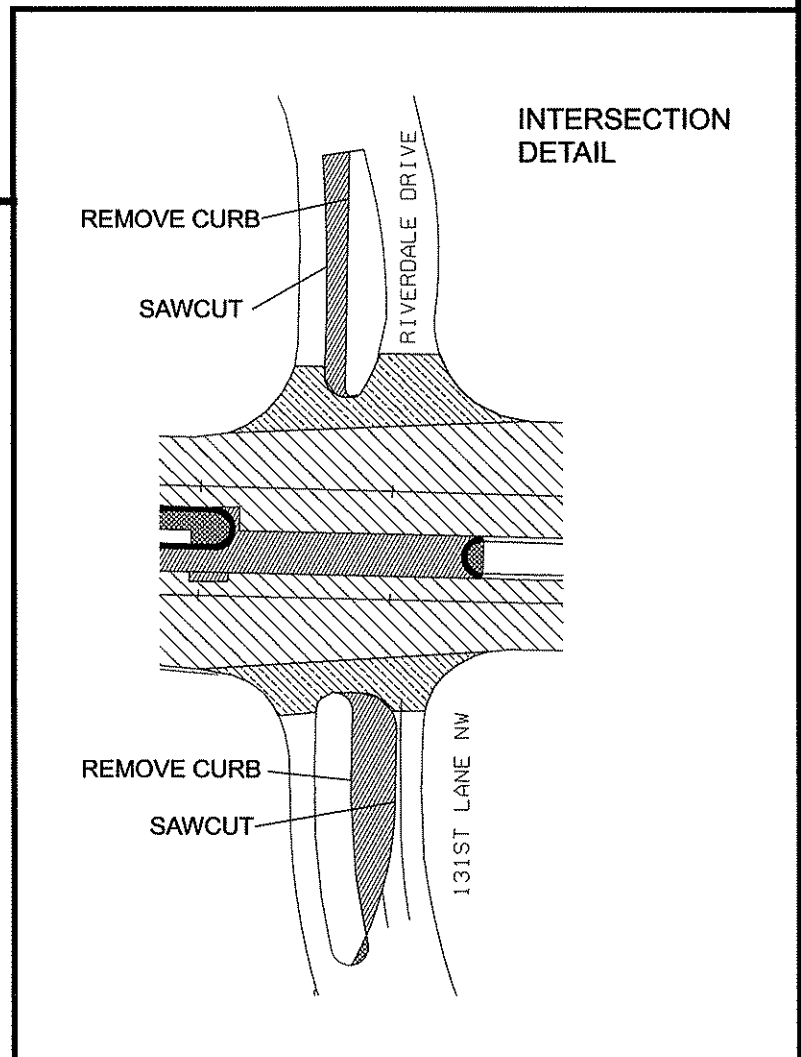

NO	DATE	BY	CHKD	APPR	REVISION

NAME: P:\09-01-00\CSAH\_9\Plan\OVERLAY TEMPLET PLAN PLAN.dgn 03/23/2009 10:08:13 AM

I HEREBY CERTIFY THAT THIS PLAN WAS PREPARED BY ME OR UNDER MY DIRECT SUPERVISION AND THAT I AM A DULY LICENSED PROFESSIONAL ENGINEER UNDER THE LAWS OF THE STATE OF MINNESOTA.

PRINT NAME: Charles Cadenhead  
 SIGNATURE: *Charles Cadenhead*  
 DATE: 3/23/09 LICENSE NO. 40416

DRAWN BY SK DATE 2/9/2009  
 DESIGN BY SK DATE 2/9/2009  
 CHECKED BY CO DATE 2/9/2009

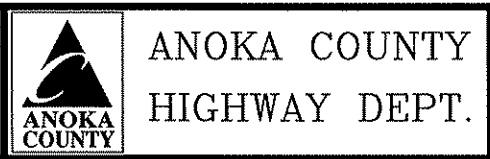

STATE PROJECT NO. \_\_\_\_\_  
 STATE AID PROJECT NO. \_\_\_\_\_  
 CITY PROJECT NO. \_\_\_\_\_  
 COUNTY PROJECT NO. 09-16-09

REMOVAL / MILLING PLAN  
 CSAH 9  
 STA 36+00 TO 49+37  
 Sheet 3 of 11 Sheets

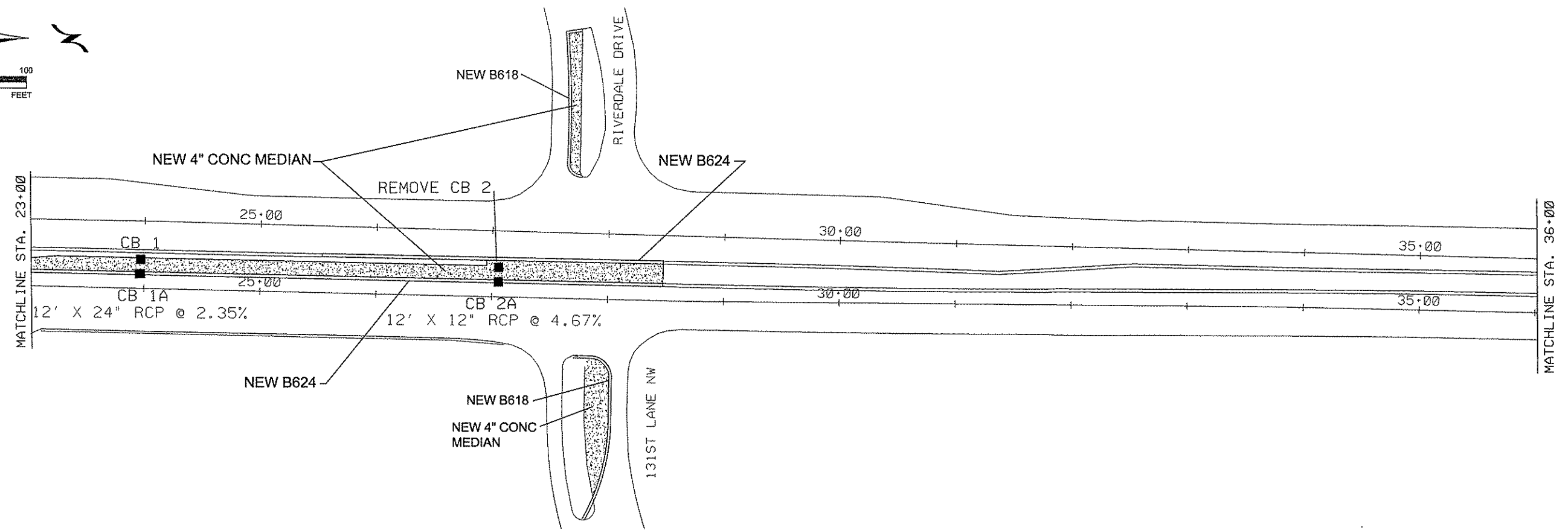
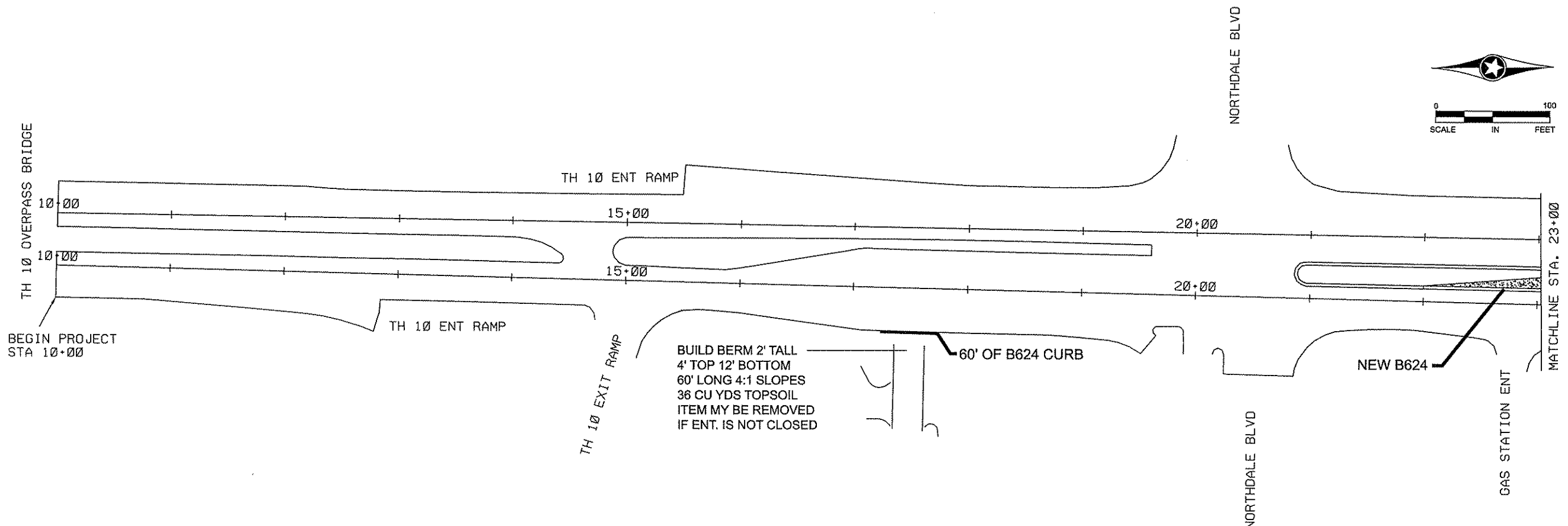

NO	DATE	BY	CKD	APPR	REVISION

NAME: P:\09-01-00\CSAH\_9\Plant\OVERLAY TEMPLET PLAN PLAN.dgn 03/17/2009 8:17:57 AM

I HEREBY CERTIFY THAT THIS PLAN WAS PREPARED BY ME OR UNDER MY DIRECT SUPERVISION AND THAT I AM A DULY LICENSED PROFESSIONAL ENGINEER UNDER THE LAWS OF THE STATE OF MINNESOTA.

PRINT NAME: Charles Cadenhead  
 SIGNATURE: *[Signature]*  
 DATE: 3/23/09 LICENSE NO. 40416

DRAWN BY SK DATE 2/9/2009  
 DESIGN BY SK DATE 2/9/2009  
 CHECKED BY CO DATE 2/9/2009

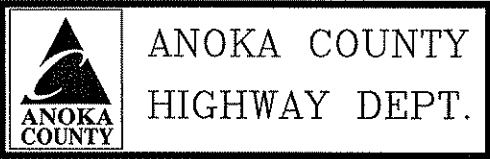

STATE PROJECT NO. \_\_\_\_\_  
 STATE AID PROJECT NO. \_\_\_\_\_  
 CITY PROJECT NO. \_\_\_\_\_  
 COUNTY PROJECT NO. 09-16-09

LTL CLOSURE PLAN  
 CSAH 9  
 STA 10+00 TO 36+00  
 Sheet 4 of 11 Sheets

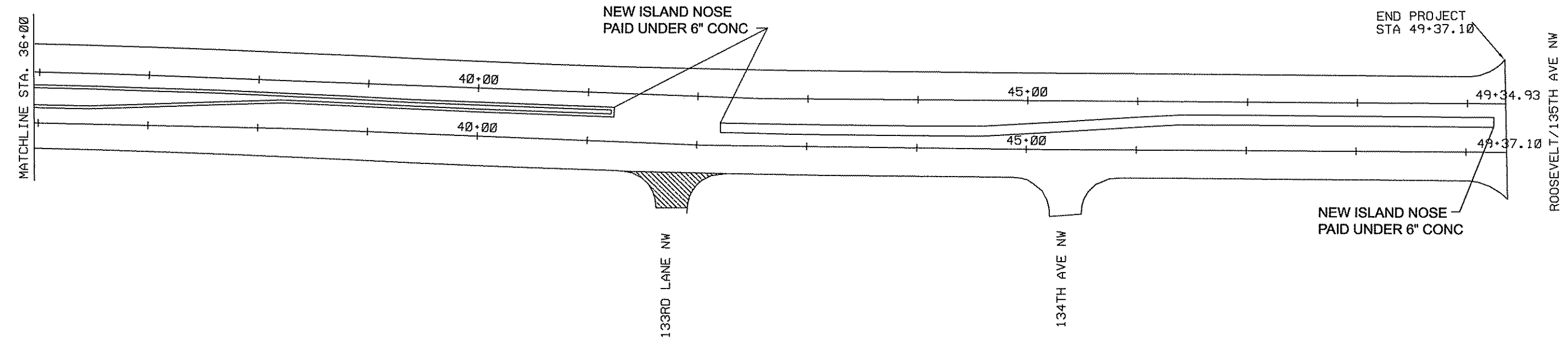
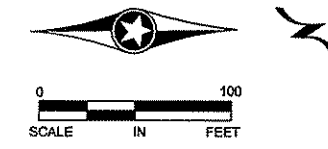

DRAINAGE TABULATION											
STR. NO	ALIGNMENT NAME	STRUCTURE LOCATION			STRUCTURE CONSTRUCTION				12" RC PIPE SEWER DES 3006 CLASS V (LIN. FT.)	24" RC PIPE SEWER DES 3006 CLASS V (LIN. FT.)	NOTES
		STATION	OFFSET	L / R	NEW/CONNECT TO EXISTING	DESIGN (B)	PAY HT. LIN. FT.	CASTING ASSEMBLY TYPE			
1A	LNB CSAH 9	23+97	13'	LT	NEW	48-4020	4.89	B-5		12	D
2A	LNB CSAH 9	27+06	13'	LT	NEW	H	2.75	B-5	12		
1	LNB CSAH 9	23+97	25'	LT	CONNECT TO EXISTING		4.62	A-7			C,E
2	LNB CSAH 9	27+06	25'	LT	REMOVE		2.86	A-7			C,E

**TRAFFIC CONTROL NOTES:**

THE MULT-LANE DIVIDED SECTION OF THE TEMPORARY TRAFFIC CONTROL ZONE LAYOUTS FIELD MANUAL DATED JANUARY 2007 SHALL BE USED DURING THE NIGHTTIME MILLING AND PAVING PHASES OF THE PROJECT. THE CONTRACTOR SHALL GIVE A 2 WORKING DAY NOTICE TO REQUEST SIGNALS TO BE PUT IN FLASH

I HEREBY CERTIFY THAT THIS PLAN WAS PREPARED BY ME OR UNDER MY DIRECT SUPERVISION AND THAT I AM A DULY LICENSED PROFESSIONAL ENGINEER UNDER THE LAWS OF THE STATE OF MINNESOTA. PRINT NAME: Charles Cadenhead SIGNATURE: <i>Charles Cadenhead</i> DATE: 3/23/09 LICENSE NO. 40416				DRAWN BY: SK DATE: 2/9/2009 DESIGN BY: SK DATE: 2/9/2009 CHECKED BY: CO DATE: 2/9/2009		<b>ANOKA COUNTY</b> <b>HIGHWAY DEPT.</b>		STATE PROJECT NO. _____ STATE AID PROJECT NO. _____ CITY PROJECT NO. _____ COUNTY PROJECT NO. 09-16-09		<b>LTL CLOSURE PLAN</b> <b>CSAH 9</b> STA 36+00 TO 49+37 Sheet 5 of 11 Sheets	
NO	DATE	BY	CKD	APPR	REVISION	NAME: P:\09-01-00\CSAH_9\Plan\OVERLAY TEMPLATE PLAN PLAN.dgn 03/23/2009 10:08:40 AM					

EXISTING STANDARD SECTION

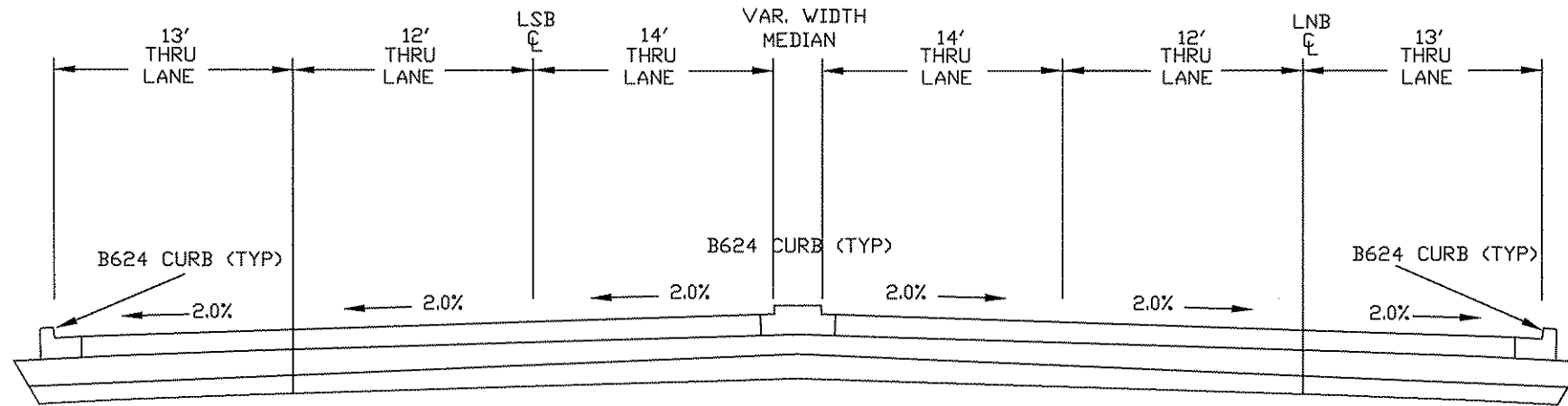

PROPOSED SECTION

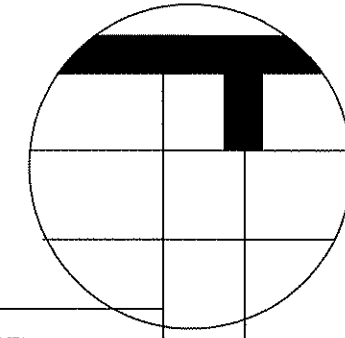
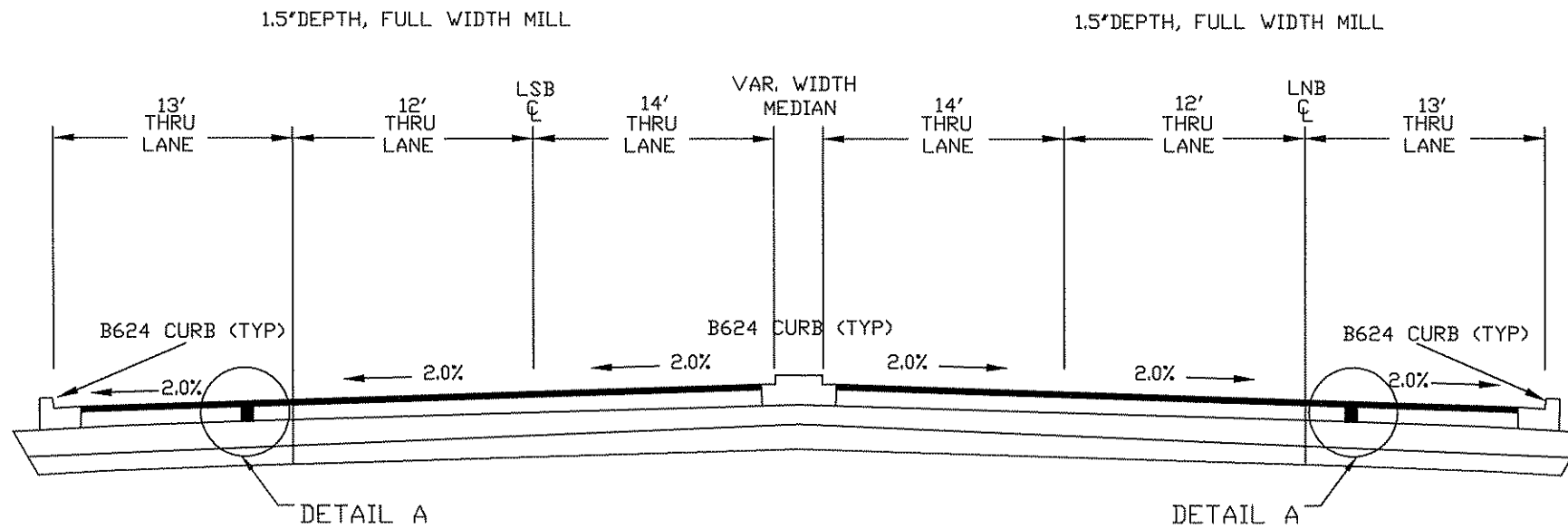

DETAIL A

MILL 1.5" OF INPLACE BITUMINOUS  
 PAVE 2" TYPE SP 12.5 WEARING COURSE MIX (SPWEB440E)  
 EXISTING BITUMINOUS

NO	DATE	BY	CKD	APPR	REVISION
NAME: P:\09-01-00\CSAH_9\Plan\OVERLAY TEMPLT TYP DETAILS.dgn					02/26/2009 9:28:32 AM

I HEREBY CERTIFY THAT THIS PLAN WAS PREPARED BY ME OR UNDER MY DIRECT SUPERVISION AND THAT I AM A DULY LICENSED PROFESSIONAL ENGINEER UNDER THE LAWS OF THE STATE OF MINNESOTA.  
 PRINT NAME: Charles Cadenhead  
 SIGNATURE: *Charles Cadenhead*  
 DATE: 3/23/09 LICENSE NO. 40416

DRAWN BY SK DATE 2/9/2009  
 DESIGN BY SK DATE 2/9/2009  
 CHECKED BY CO DATE 2/9/2009



ANOKA COUNTY  
 HIGHWAY DEPT.

STATE PROJECT NO. \_\_\_\_\_  
 STATE AID PROJECT NO. \_\_\_\_\_  
 CITY PROJECT NO. \_\_\_\_\_  
 COUNTY PROJECT NO. 09-16-09

TYPICAL SECTIONS  
 CSAH 9  
 Sheet 6 of 11 Sheets

EXISTING STANDARD SECTION

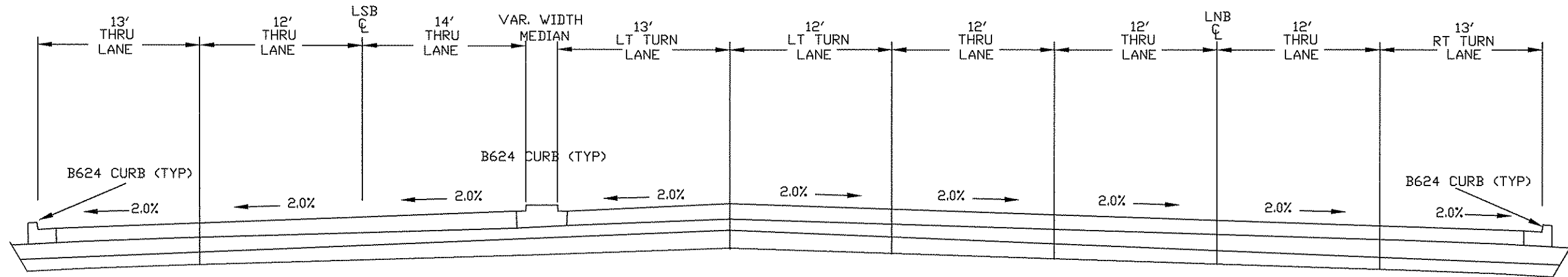

PROPOSED SECTION

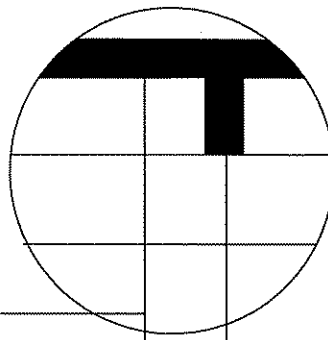
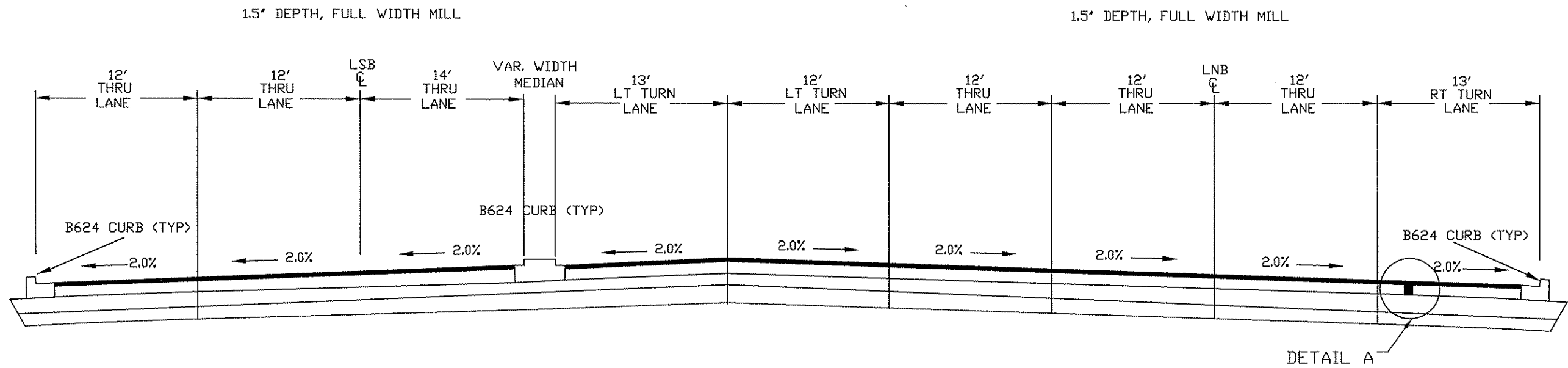

DETAIL A

MILL 1.5' OF INPLACE BITUMINOUS  
 PAVE 2" TYPE SP 12.5 WEARING COURSE MIX (SPWEB440E)  
 EXISTING BITUMINOUS

NO	DATE	BY	CKD	APPR	REVISION

NAME: P:\09-01-00\CSAH\_9\Plant\OVERLAY TEMPLAT TYP DETAILS.dgn 02/28/2009 9:25:26 AM

I HEREBY CERTIFY THAT THIS PLAN WAS PREPARED BY ME OR UNDER MY DIRECT SUPERVISION AND THAT I AM A DULY LICENSED PROFESSIONAL ENGINEER UNDER THE LAWS OF THE STATE OF MINNESOTA.  
 PRINT NAME: Charles Cadenhead  
 SIGNATURE: *Charles Cadenhead*  
 DATE: 3/23/09 LICENSE NO. 40416

DRAWN BY SK DATE 2/9/2009  
 DESIGN BY SK DATE 2/9/2009  
 CHECKED BY CO DATE 2/9/2009

**ANOKA COUNTY**  
**HIGHWAY DEPT.**

STATE PROJECT NO. \_\_\_\_\_  
 STATE AID PROJECT NO. \_\_\_\_\_  
 CITY PROJECT NO. \_\_\_\_\_  
 COUNTY PROJECT NO. 09-16-09

EXISTING STANDARD SECTION

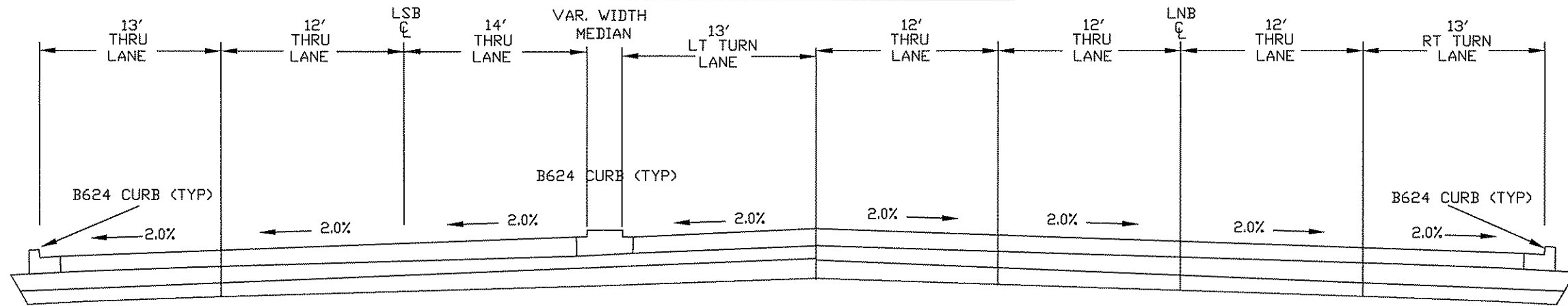

PROPOSED SECTION

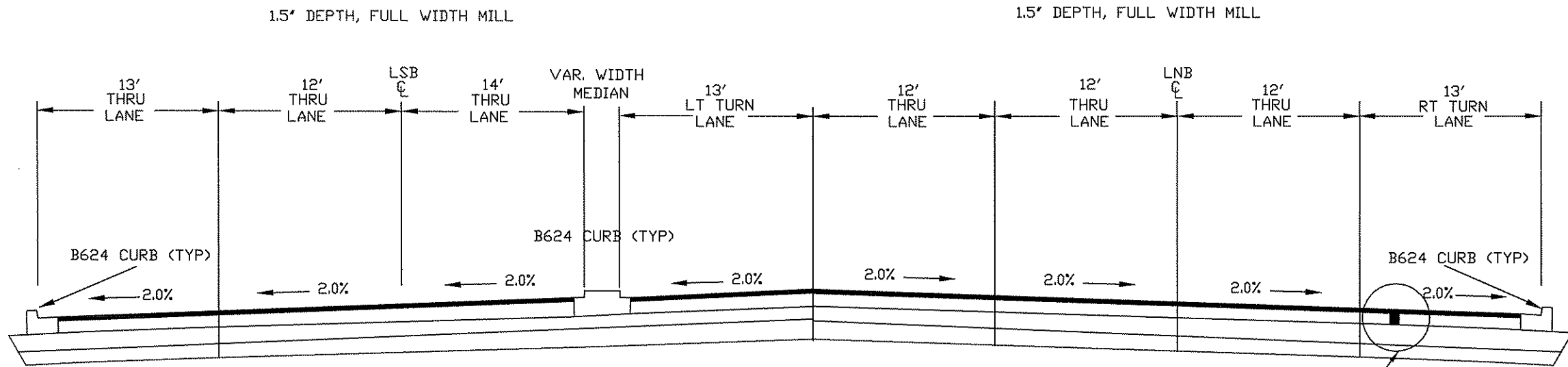

DETAIL A

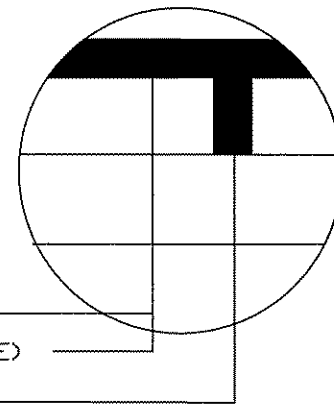

DETAIL A

MILL 1.5" OF INPLACE BITUMINOUS  
 PAVE 2" TYPE SP 12.5 WEARING COURSE MIX (SPWEB440E)  
 EXISTING BITUMINOUS

NO	DATE	BY	CHKD	APPR	REVISION
NAME: P:\09-01-00\CSAH_9\Plan\OVERLAY TEMPLAT TYP DETAILS.dgn					
02/26/2009 9:25:55 AM					

I HEREBY CERTIFY THAT THIS PLAN WAS PREPARED BY ME OR UNDER MY DIRECT SUPERVISION AND THAT I AM A DULY LICENSED PROFESSIONAL ENGINEER UNDER THE LAWS OF THE STATE OF MINNESOTA.  
 PRINT NAME: Charles Cadenhead  
 SIGNATURE: *Charles Cadenhead*  
 DATE: 3/23/09 LICENSE NO. 40416

DRAWN BY SK DATE 2/9/2009  
 DESIGN BY SK DATE 2/9/2009  
 CHECKED BY CO DATE 2/9/2009

**ANOKA COUNTY**  
**HIGHWAY DEPT.**

STATE PROJECT NO. \_\_\_\_\_  
 STATE AID PROJECT NO. \_\_\_\_\_  
 CITY PROJECT NO. \_\_\_\_\_  
 COUNTY PROJECT NO. 09-16-09



NOTE:  
 ALL PERCENTS OF PIPE NEED TO BE  
 FIELD VERIFIED. NEW PIPE IS TO MATCH  
 IN PLACE STORM SEWER PIPE. FIELD ENGINEER  
 TO DETERMINE ANY CHANGES NEEDED.

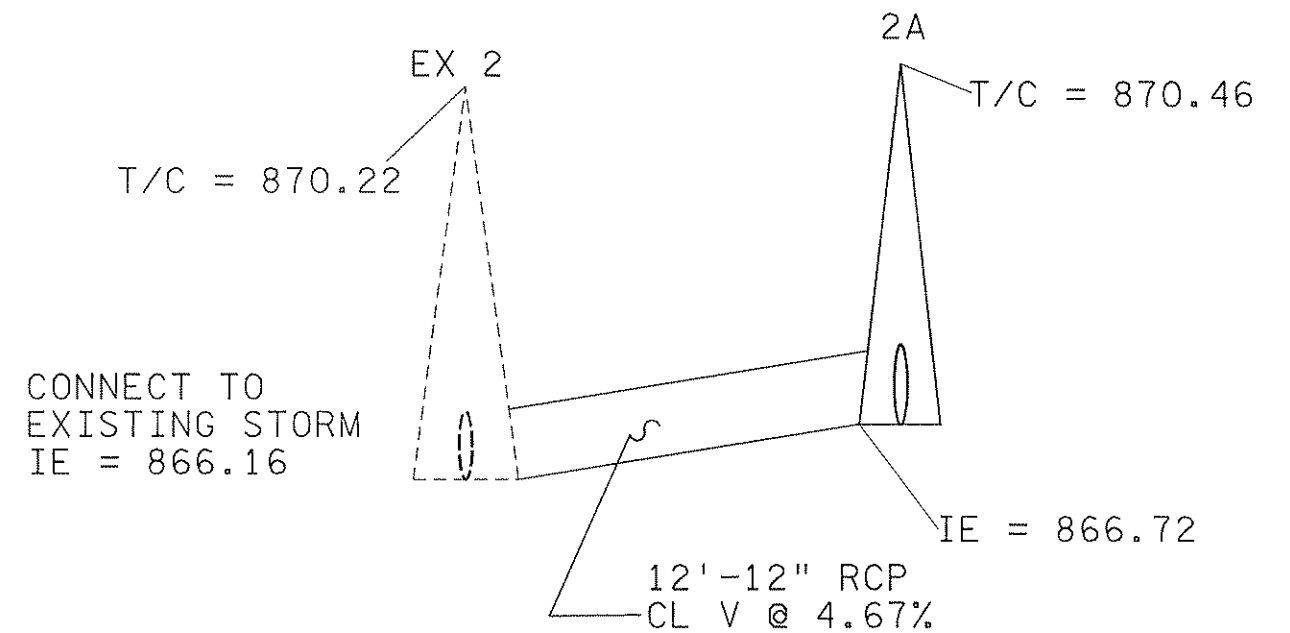
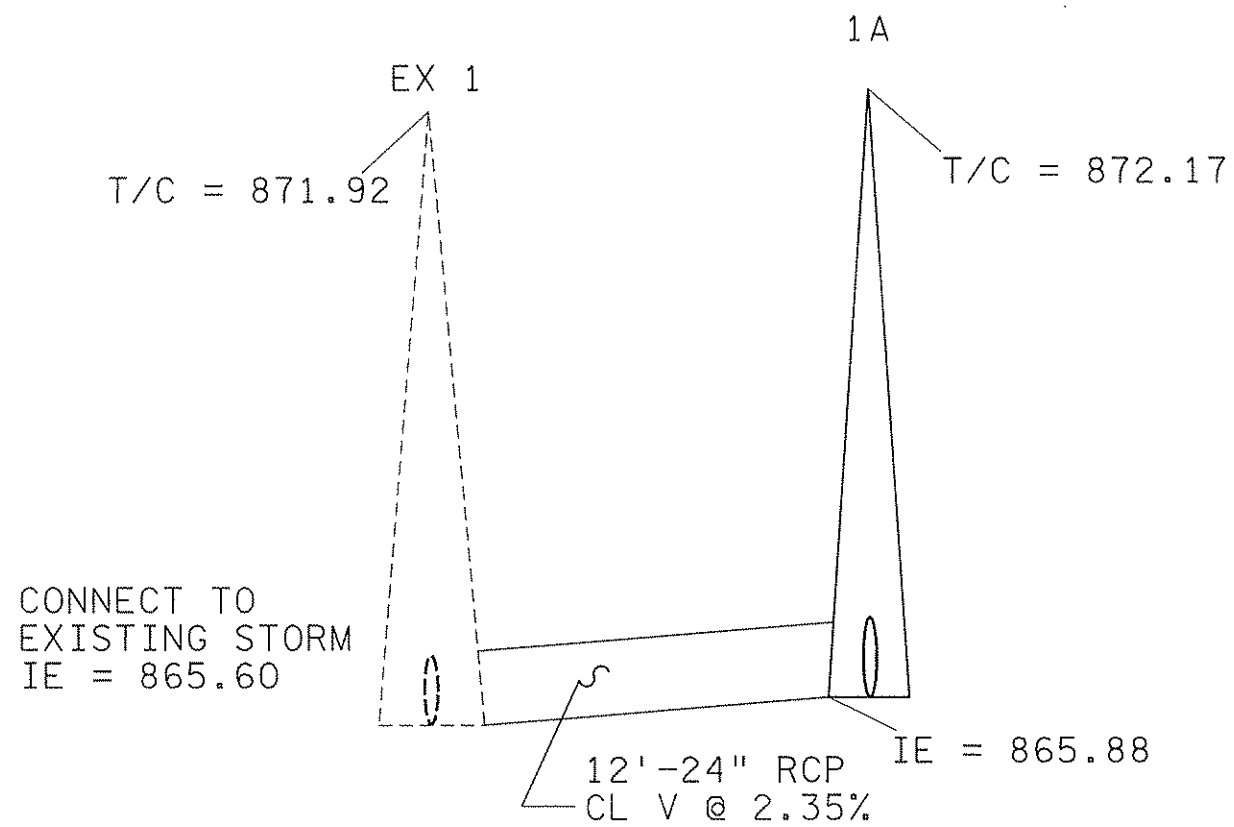

NO	DATE	BY	CKD	APPR	REVISION

NAME: P:\09-01-00\CSAH\_9\PLAN\091609\_DR PROFILE.DGN 3/12/2009 2:19:55 PM

I HEREBY CERTIFY THAT THIS PLAN WAS PREPARED BY ME OR UNDER MY DIRECT SUPERVISION AND THAT I AM A DULY LICENSED PROFESSIONAL ENGINEER UNDER THE LAWS OF THE STATE OF MINNESOTA.  
 PRINT NAME: CHARLES CADENHEAD  
 SIGNATURE: *[Signature]*  
 DATE: 3/23/09 LICENSE NO. 40416

DRAWN BY SK DATE 2/9/2009  
 DESIGN BY SK DATE 2/9/2009  
 CHECKED BY CO DATE 2/9/2009



ANOKA COUNTY  
 HIGHWAY DEPT.

STATE PROJECT NO. \_\_\_\_\_  
 STATE PROJECT NO. \_\_\_\_\_  
 CITY PROJECT NO. \_\_\_\_\_  
 COUNTY PROJECT NO. 09-16-09

DRAINAGE PROFILES  
 Sheet 9 of 11 Sheets

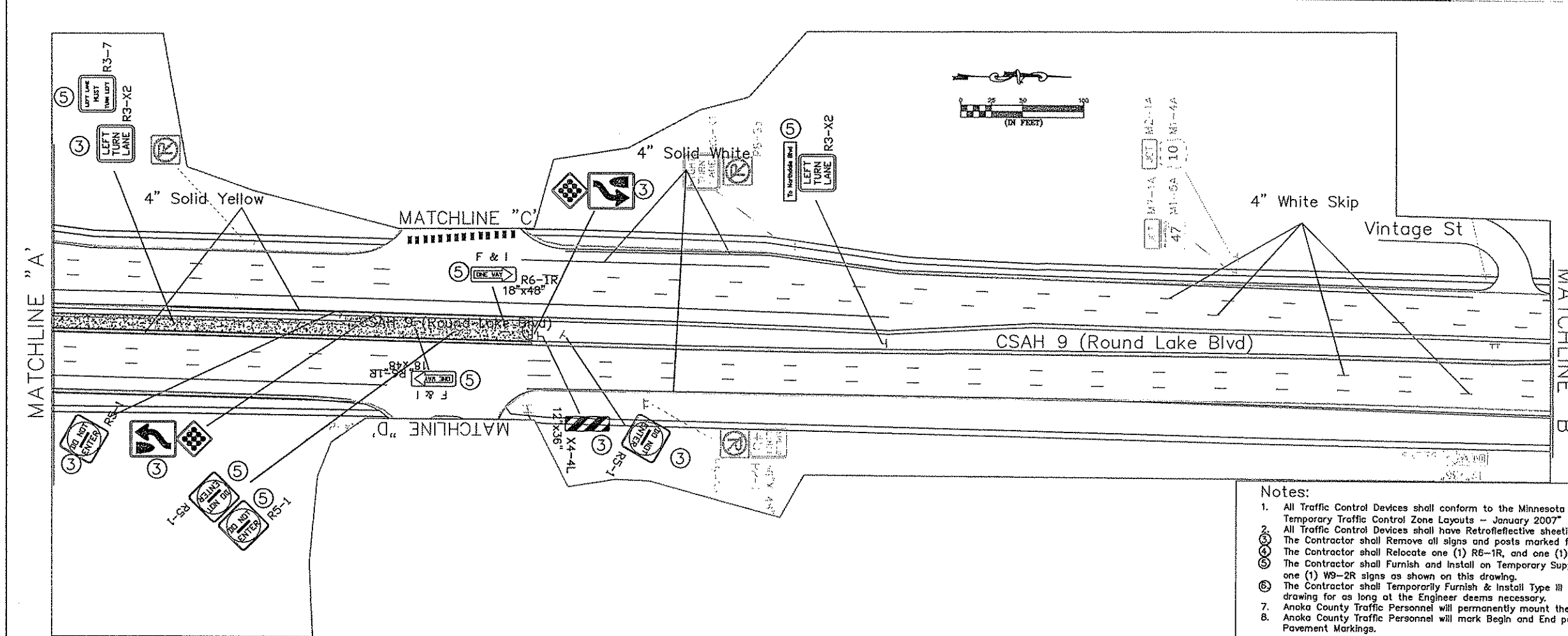
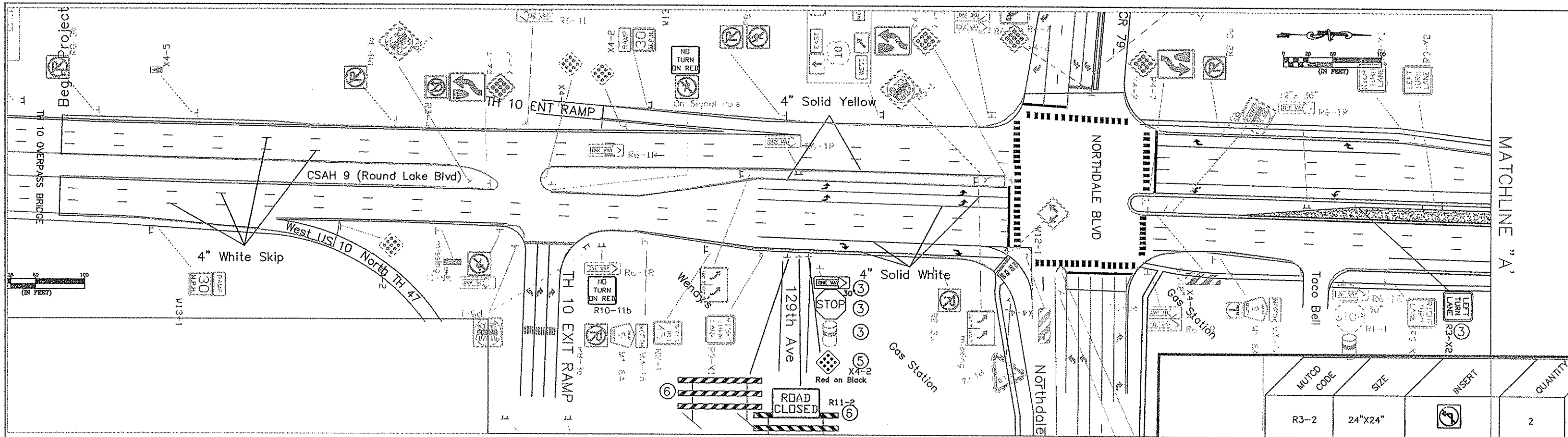

MUTCD CODE	SIZE	INSERT	QUANTITY
R3-2	24"x24"		2
R6-1R	18"x48"		2
R3-7	30"x30"		1
R3-7	30"x30"		1
	x x x		1
W9-2R	36"x36"		1
R5-1	30"x30"		2

- Notes:**
- All Traffic Control Devices shall conform to the Minnesota Manual on Uniform Traffic Control Devices, including "Field Manual for Temporary Traffic Control Zone Layouts - January 2007"
  - All Traffic Control Devices shall have Retroreflective sheeting.
  - The Contractor shall Remove all signs and posts marked for removal on this drawing.
  - The Contractor shall Relocate one (1) R6-1R, and one (1) R4-7/X4-2 sign as shown on this drawing.
  - The Contractor shall Furnish and Install on Temporary Supports two (2) R3-2, two (2) R5-1, two (2) R6-1R, three (3) R3-7 and one (1) W9-2R signs as shown on this drawing.
  - The Contractor shall Temporarily Furnish & Install Type III barricades during the reconstruction of 129th Ave as shown on the drawing for as long as the Engineer deems necessary.
  - Anoka County Traffic Personnel will permanently mount the Temped signs.
  - Anoka County Traffic Personnel will mark Begin and End points for all Pavement Marking and Message Removals; and all Permanent Pavement Markings.

I HEREBY CERTIFY THAT THIS PLAN WAS PREPARED BY ME OR UNDER MY DIRECT SUPERVISION AND THAT I AM A DULY REGISTERED PROFESSIONAL ENGINEER UNDER THE LAWS OF THE STATE OF MINNESOTA. PRINT NAME: <i>Charles L. Anderson</i> SIGNATURE: <i>[Signature]</i> DATE: <i>3/23/09</i>					DRAWN BY: <i>MTH</i> DATE: <i>03/17/09</i> DESIGN BY: _____ DATE: _____ CHECKED BY: <i>EH</i> DATE: <i>01/06/09</i>		ANOKA COUNTY HIGHWAY DEPT.	STATE PROJECT NO. _____ STATE AID PROJECT NO. _____ CITY PROJECT NO. _____ COUNTY PROJECT NO. <i>09-16-09</i>	CSAH 9 (Round Lake Blvd) From US 10 to 135th Ave NW Sheet <i>10</i> of <i>11</i> Sheets	
NO	DATE	BY	CKD	APPR	REVISION	NAME: T:\Traffic\dwg\CSAH 9 (Round Lake Lake George)\From 14 to CSAH 22.dwg 02/11/2009 2:14:27 PM				

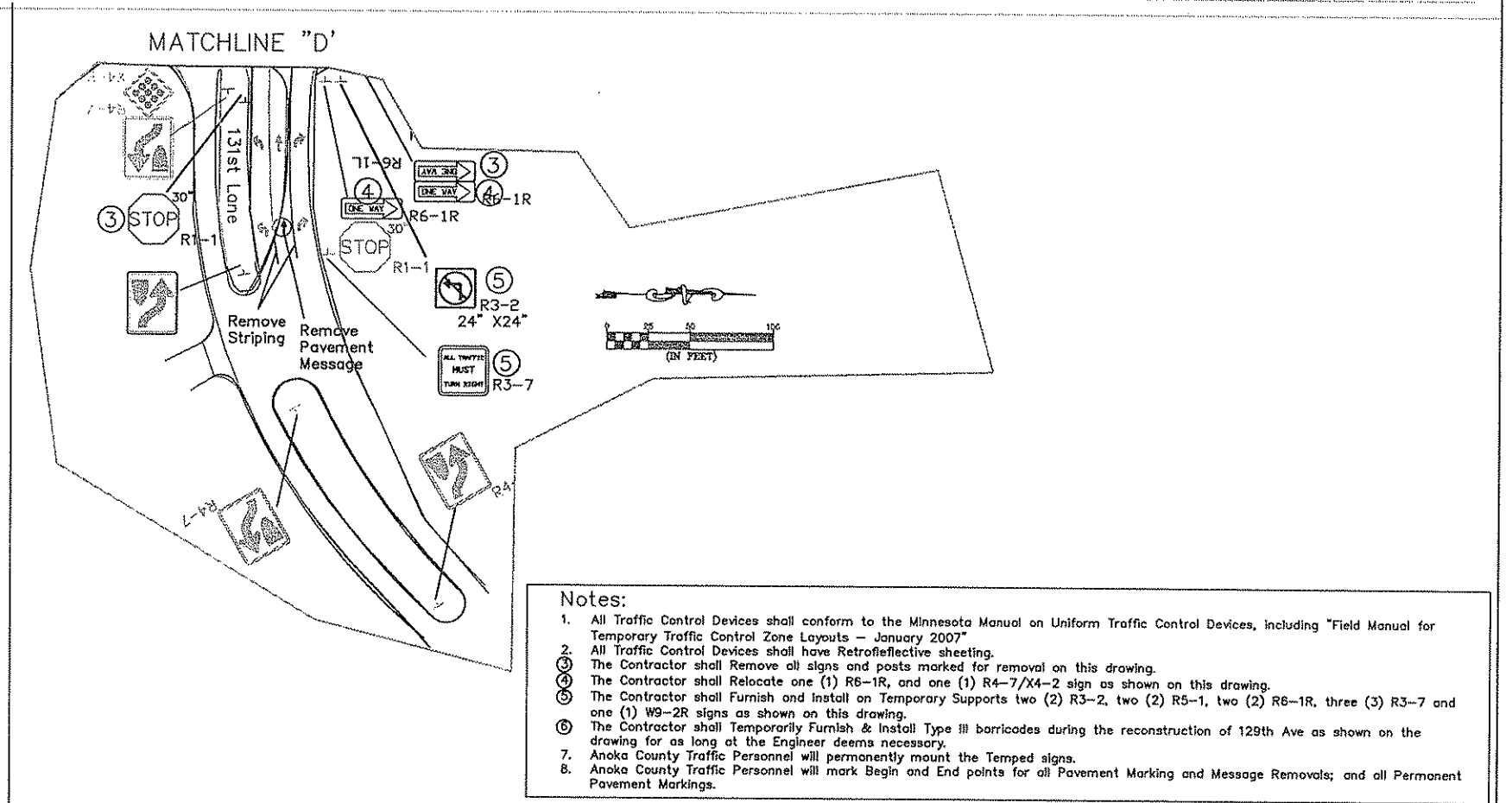
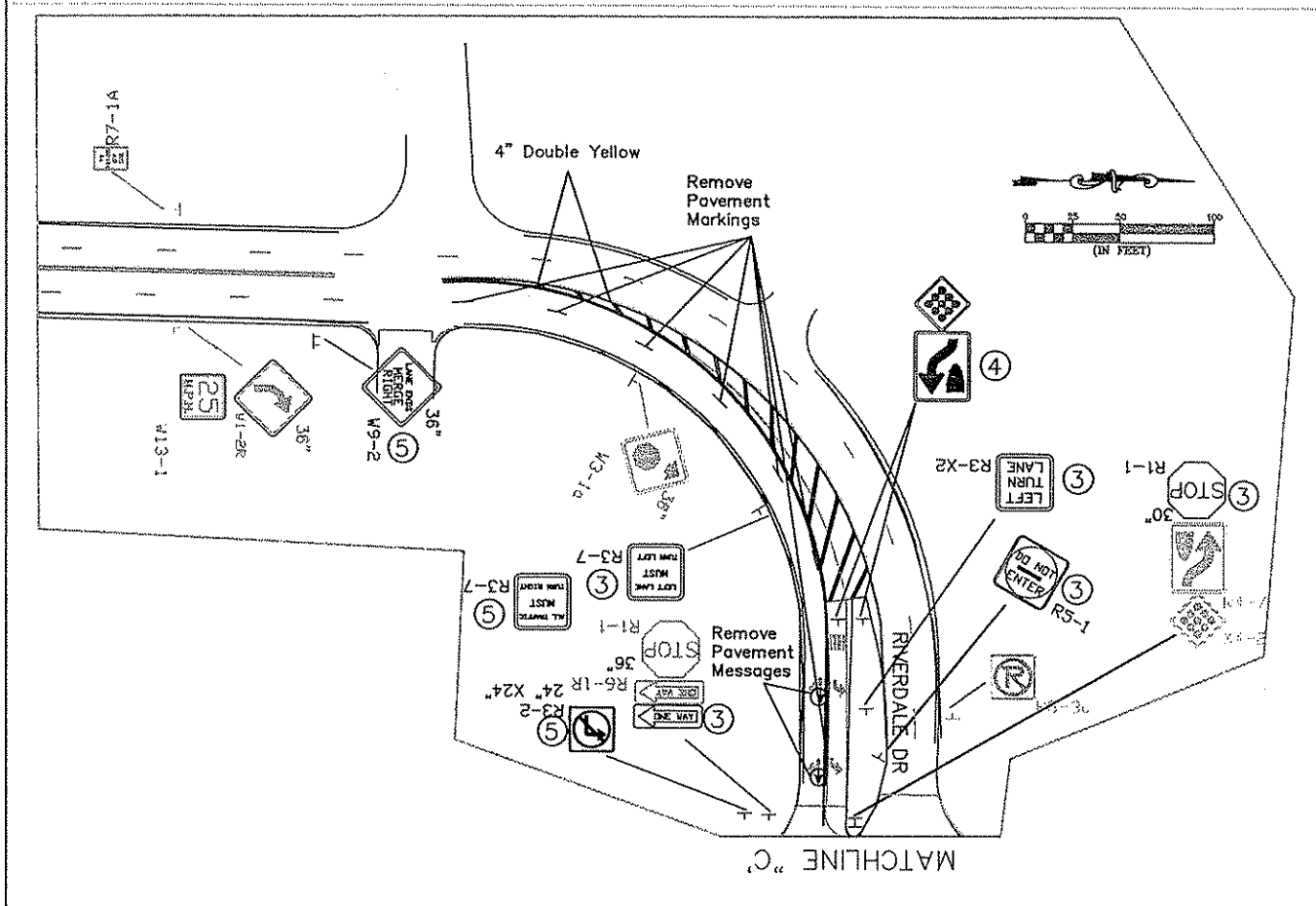
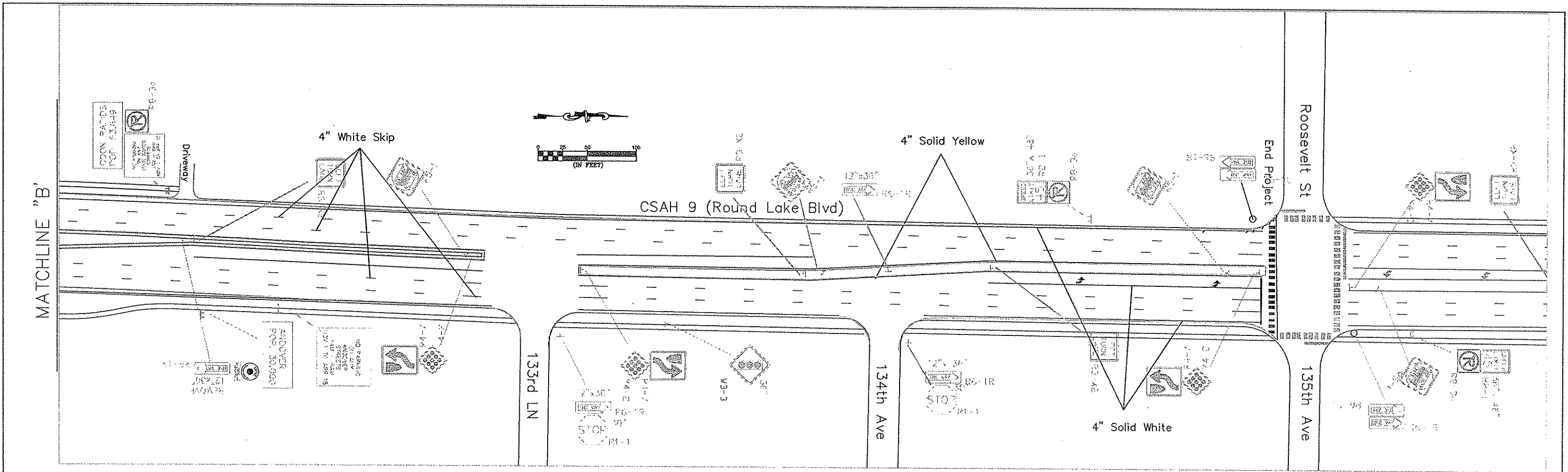

- Notes:**
- All Traffic Control Devices shall conform to the Minnesota Manual on Uniform Traffic Control Devices, including "Field Manual for Temporary Traffic Control Zone Layouts - January 2007"
  - All Traffic Control Devices shall have Retroreflective sheeting.
  - The Contractor shall Remove all signs and posts marked for removal on this drawing.
  - The Contractor shall Relocate one (1) R6-1R, and one (1) R4-7/X4-2 sign as shown on this drawing.
  - The Contractor shall Furnish and Install on Temporary Supports two (2) R3-2, two (2) R5-1, two (2) R6-1R, three (3) R3-7 and one (1) W9-2R signs as shown on this drawing.
  - The Contractor shall Temporarily Furnish & Install Type III barricades during the reconstruction of 129th Ave as shown on the drawing for as long as the Engineer deems necessary.
  - Anoka County Traffic Personnel will permanently mount the Temped signs.
  - Anoka County Traffic Personnel will mark Begin and End points for all Pavement Marking and Message Removals; and all Permanent Pavement Markings.

NO	DATE	BY	CKD	APPR	REVISION

I HEREBY CERTIFY THAT THIS PLAN WAS PREPARED BY ME OR UNDER MY DIRECT SUPERVISION AND THAT I AM A DULY REGISTERED PROFESSIONAL ENGINEER UNDER THE LAWS OF THE STATE OF MINNESOTA.

PRINT NAME: *Charles Cadzow*

SIGNATURE: *Charles Cadzow*

DATE: *3/23/09*

REG. NO. *4646*

DRAWN BY: *MTH* DATE: *03/17/09*

DESIGN BY: \_\_\_\_\_ DATE: \_\_\_\_\_

CHECKED BY: \_\_\_\_\_ DATE: \_\_\_\_\_

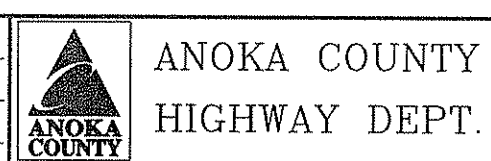

STATE PROJECT NO. \_\_\_\_\_

STATE AID PROJECT NO. \_\_\_\_\_

CITY PROJECT NO. \_\_\_\_\_

COUNTY PROJECT NO. *09-16-09*

CSAH 9 (Round Lake Blvd)  
From US 10 to  
135th Ave NW

Sheet *11* of *11* Sheets