

MINNESOTA DEPARTMENT OF TRANSPORTATION ANOKA COUNTY

CONSTRUCTION PLAN FOR 2" BITUMINOUS OVERLAY, AGGREGATE SHOULDERING
LOCATED ON C.S.A.H. 11 BETWEEN 700' WEST OF COON CREEK AND 1100' EAST OF COON CREEK

COUNTY PROJ. NO. 09-18-11
C.S.A.H. 11

GROSS LENGTH 1912 FEET 0.36 MILES
BRIDGES-LENGTH 100 FEET 0.02 MILES
EXCEPTIONS-LENGTH 100 FEET 0.02 MILES
NET LENGTH 1812 FEET 0.34 MILES

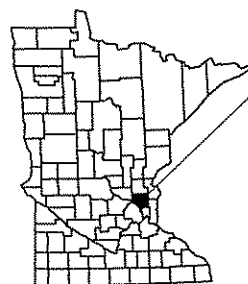
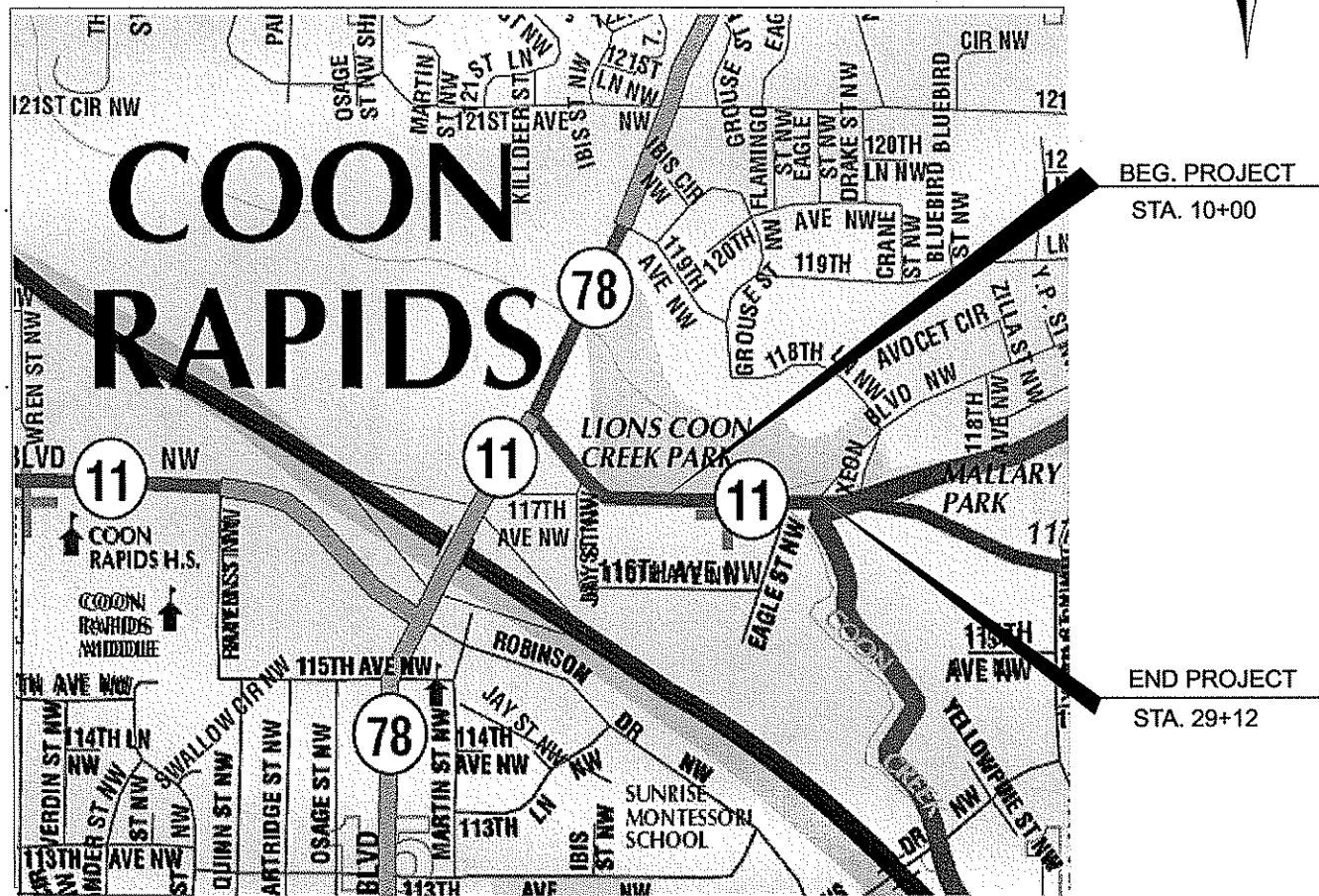

PROJECT LOCATION
CITY OF COON RAPIDS
ANOKA COUNTY
MN/DOT TRANSPORTATION DISTRICT - METRO
SECTION X
TOWNSHIP X NORTH
RANGE X WEST

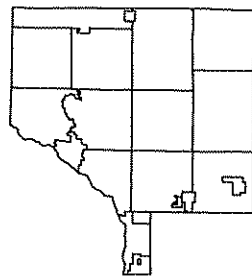

STATEMENT OF ESTIMATED QUANTITIES

09-18-11

ITEM NO.	ITEM	NOTE NO.	UNIT	TOTAL EST. QUANT.
2021.501	MOBILIZATION		LUMP SUM	1
2221.609	AGGREGATE SHOULDERING CLASS 7B	1	TON	62
2232.604	MILL BITUMINOUS SURFACE (2") (JOINTS)		SQ YD	388
2357.502	BITUMINOUS MATERIAL FOR TACK COAT		GALLON	449
2360.609	TYPE MV3 WEAR (2" MVWE35035 B) MAINLINE WEAR	1	TON	967
2360.609	TYPE MV3 WEAR (2" MVWE35035 B) STREET APPROACH WEAR	1	TON	65
2553.601	TRAFFIC CONTROL		LUMP SUM	1
2564.603	4" SOLID LINE WHITE - EPOXY		LIN FT	3624
2564.603	4" SOLID LINE YELLOW - EPOXY		LIN FT	800
2564.603	4" DOUBLE SOLID LINE YELLOW - EPOXY		LIN FT	2912
2564.603	4" BROKEN LINE YELLOW-EPOXY		LIN FT	28
2580.603	REMOVABLE LANE TAPE	2	LIN FT	153

NOTES

- NOTE 1 TRUCKING, PLACEMENT AND COMPACTION INCIDENTAL TO ITEM.
NOTE 2 TO BE PLACED PRIOR TO LEAVING SITE AT END OF DAYS PAVING.

BASIS OF PLANNED QUANTITIES

- 2221.609 AGGREGATE SHOULDERING CLASS 7B CU YDS * 1.8 = TONS
2357.502 BITUMINOUS MATERIAL FOR TACK COAT .05 GAL / SQ YD
2360.609 TYPE MV3 WEAR MIXTURE (MVWE35035 B) 115 LBS/SQYD/IN THICKNESS
2580.603 REMOVABLE LANE TAPE 4' AT 50' INTERVALS FOR SKIPS

PLAN SET

- Sheet
1 TITLE / SEQ
2 PLAN
3 TYPICALS
4-5 DETAILS
6 PAVEMENT MARKINGS

NO	DATE	BY	CKD	APPR	REVISION

NAME: P:\09-01-00\CSAH_11\PLAN\COVER SEQ.DGN 03/18/2009 8:01:00 AM

I HEREBY CERTIFY THAT THIS PLAN WAS PREPARED BY ME OR UNDER MY DIRECT SUPERVISION AND THAT I AM A DULY LICENSED PROFESSIONAL ENGINEER UNDER THE LAWS OF THE STATE OF MINNESOTA.
PRINT NAME: Charles Cadenhead
SIGNATURE: *Charles Cadenhead*
DATE: 2/23/09 LICENSE NO. 40416

DRAWN BY: JF DATE: 2/4/09
DESIGN BY: JF DATE: 2/4/09
CHECKED BY: DATE:



ANOKA COUNTY
HIGHWAY DEPT.

STATE PROJECT NO. _____
STATE PROJECT NO. _____
STATE PROJECT NO. _____
STATE PROJECT NO. 09-18-11

TITLE / SEQ
Sheet 1 of 6 Sheets

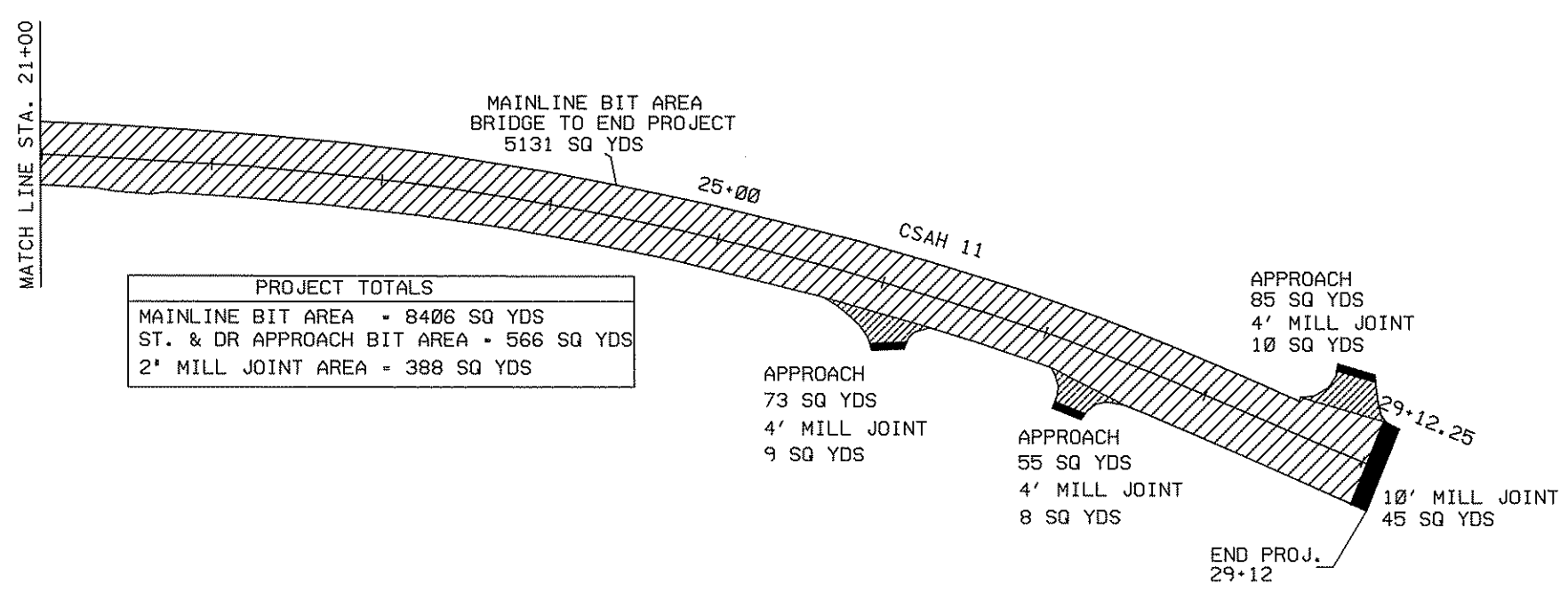
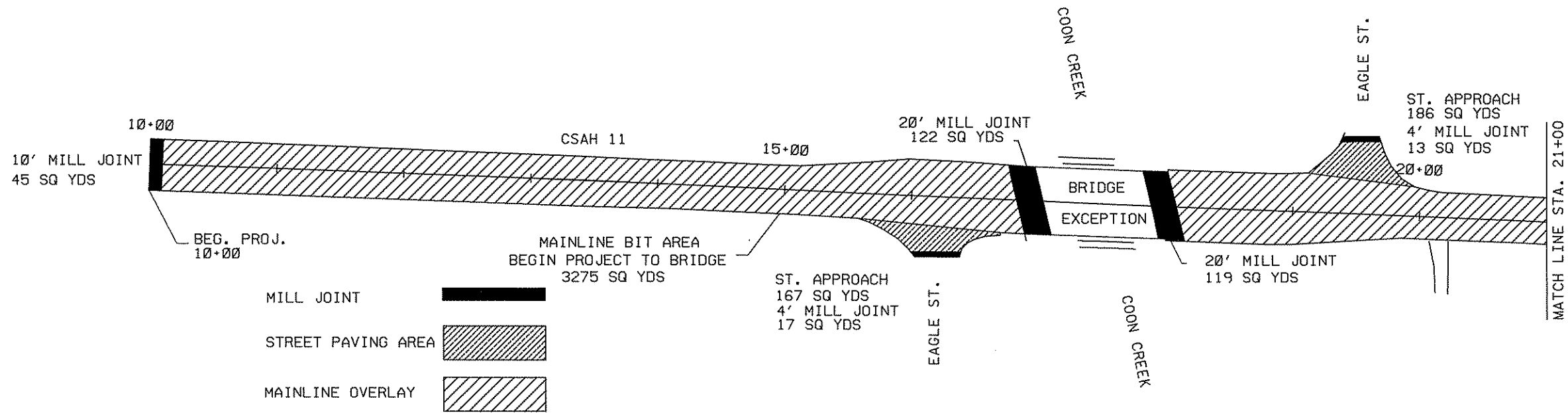

PROJECT TOTALS	
MAINLINE BIT AREA	= 8406 SQ YDS
ST. & DR APPROACH BIT AREA	= 566 SQ YDS
2' MILL JOINT AREA	= 388 SQ YDS

NO	DATE	BY	CKD	APPR	REVISION

NAME: P:109-01-00\CSAH_11\Plan\PLAN PLAN.dgn 02/05/2009 10:01:38 AM

I HEREBY CERTIFY THAT THIS PLAN WAS PREPARED BY ME OR UNDER MY DIRECT SUPERVISION AND THAT I AM A DULY LICENSED PROFESSIONAL ENGINEER UNDER THE LAWS OF THE STATE OF MINNESOTA.

PRINT NAME: Charles Cadenhead
 SIGNATURE: *Charles Cadenhead*
 DATE: 3/23/09 LICENSE NO. 40416

DRAWN BY: JF DATE: 2/4/09
 DESIGN BY: JF DATE: 2/4/09
 CHECKED BY: DATE:



**ANOKA COUNTY
HIGHWAY DEPT.**

STATE PROJECT NO. _____
 STATE AID PROJECT NO. _____
 CITY PROJECT NO. _____
 COUNTY PROJECT NO. 09-18-11

PLAN
 STA 10+00 TO 29+12
 Sheet 2 of 6 Sheets

EXISTING STANDARD SECTION

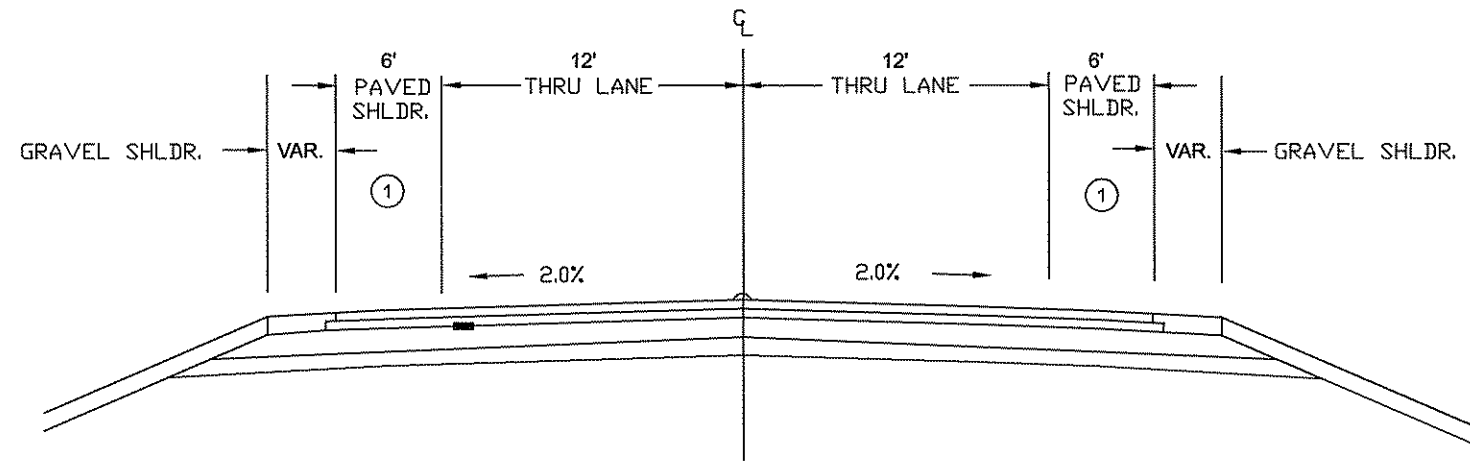

PROPOSED SECTION

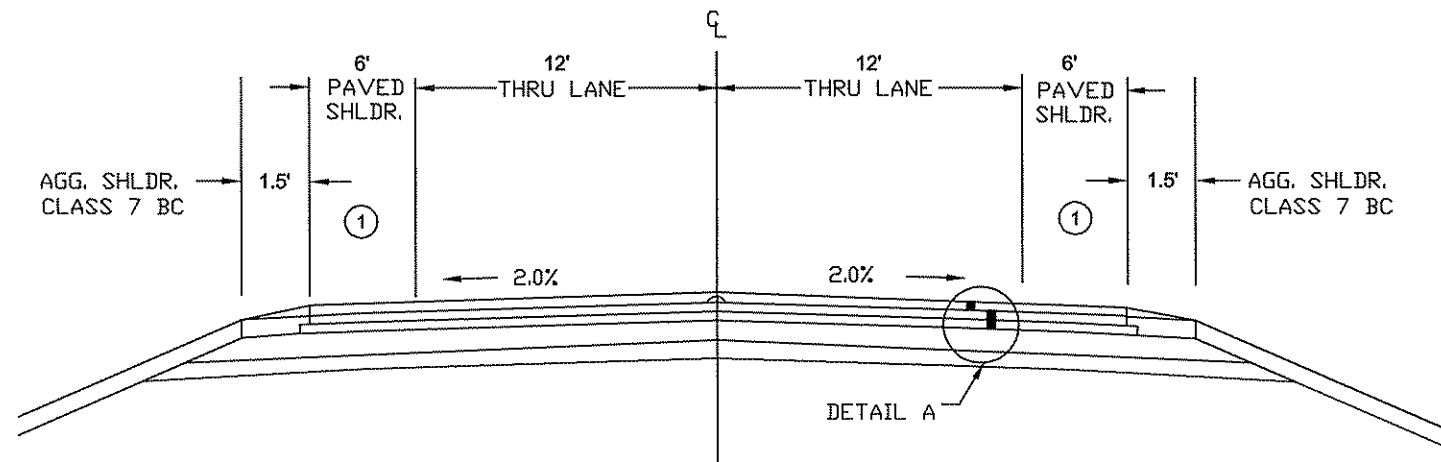

DETAIL A

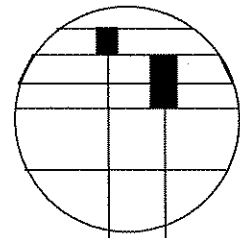

2" TYPE MV3 WEAR (MVWE35035 B)
EXISTING BITUMINOUS

① PAVED SHOULDER WIDTH VARIES AT BRIDGE.
MATCH EXISTING

NO	DATE	BY	CKD	APPR	REVISION

NAME: P:109-01-00\CSAH_11\Plan\TYP DETAILS.dgn 02/05/2009 9:15:49 AM

I HEREBY CERTIFY THAT THIS PLAN WAS PREPARED BY ME OR UNDER MY DIRECT SUPERVISION AND THAT I AM A DULY LICENSED PROFESSIONAL ENGINEER UNDER THE LAWS OF THE STATE OF MINNESOTA.

PRINT NAME: Charles Cadenhead
SIGNATURE: *Charles Cadenhead*
DATE: 3/27/09 LICENSE NO. 40416

DRAWN BY: JF DATE: 2/4/09
DESIGN BY: JF DATE: 2/4/09
CHECKED BY: _____ DATE: _____



ANOKA COUNTY
HIGHWAY DEPT.

STATE PROJECT NO. _____
STATE AID PROJECT NO. _____
CITY PROJECT NO. _____
COUNTY PROJECT NO. 09-18-11

TYPICALS
Sheet 3 of 6 Sheets

GRAVEL DR. WAYS AND FEILD ENT.

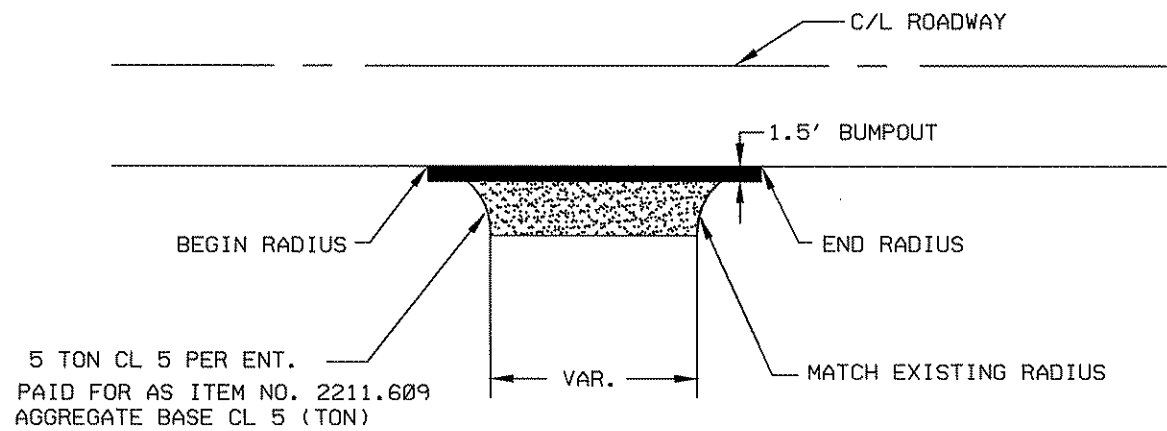

CONCRETE DR. WAYS

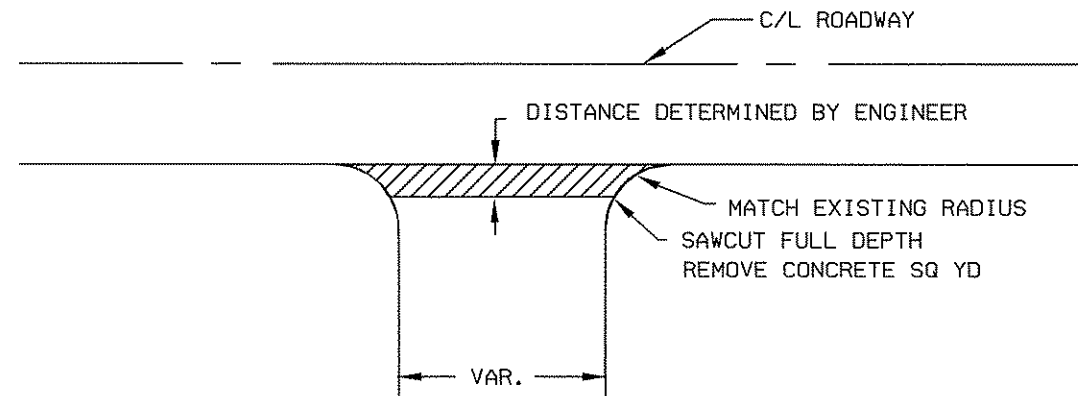

PAVED DR. WAYS

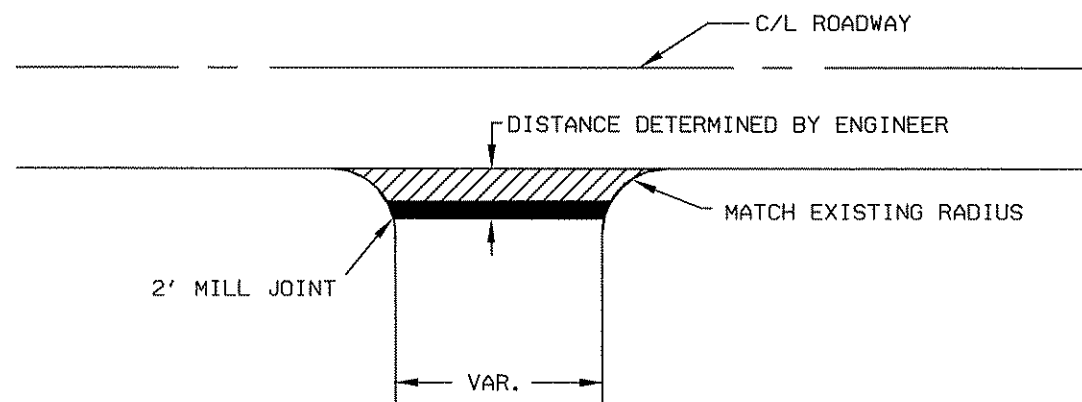

PAVED STREET APPROACHES

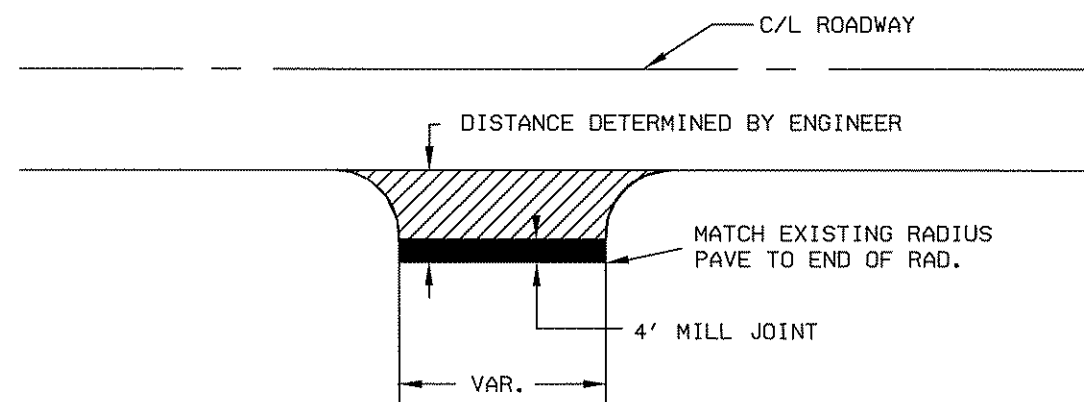

DRIVEWAYS BUMPED OUT AND PAVED WITH MAINLINE PAID AS MAINLINE.
DRIVEWAYS PAVED IN DIFFERENT OPERATION FROM MAIN LINE PAVING PAID AS ST./DR. APPROACH.

NO	DATE	BY	CHKD	APPR	REVISION

NAME: P:\09-01-00\CSAH_11\Plan\TYP DETAILS.dgn 02/05/2009 8:59:18 AM

I HEREBY CERTIFY THAT THIS PLAN WAS PREPARED BY ME OR UNDER MY DIRECT SUPERVISION AND THAT I AM A DULY LICENSED PROFESSIONAL ENGINEER UNDER THE LAWS OF THE STATE OF MINNESOTA.
PRINT NAME: Charles Cadenhead
SIGNATURE: *Charles Cadenhead*
DATE: 3/23/09 LICENSE NO. 40416

DRAWN BY JF DATE 2/4/09
DESIGN BY JF DATE 2/4/09
CHECKED BY DATE



ANOKA COUNTY
HIGHWAY DEPT.

STATE PROJECT NO. _____
STATE AID PROJECT NO. _____
CITY PROJECT NO. _____
COUNTY PROJECT NO. 09-18-11

DETAILS
Sheet 4 of 6 Sheets

PAVED DRIVEWAYS / PAVED STREETS
JOINT DETAILS

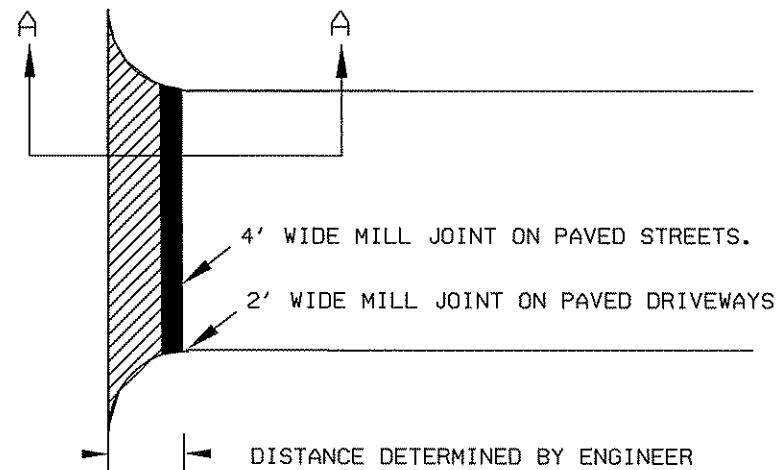

DRIVEWAYS BUMPED OUT AND PAVED WITH MAINLINE, PAID AS MAINLINE.
DRIVEWAYS PAVED IN DIFFERENT OPERATION FROM MAIN LINE PAVING PAID AS ST./DR. APPROACH.
STREETS PAID AS ST./DR. APPROACH.

JOINT DETAILS A - A

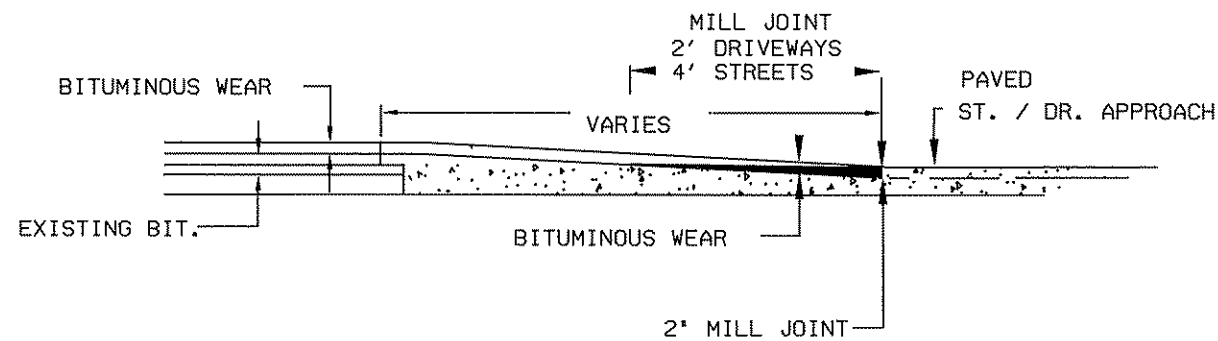

PAID AS STREET APPROACH

MAINLINE
JOINT DETAILS

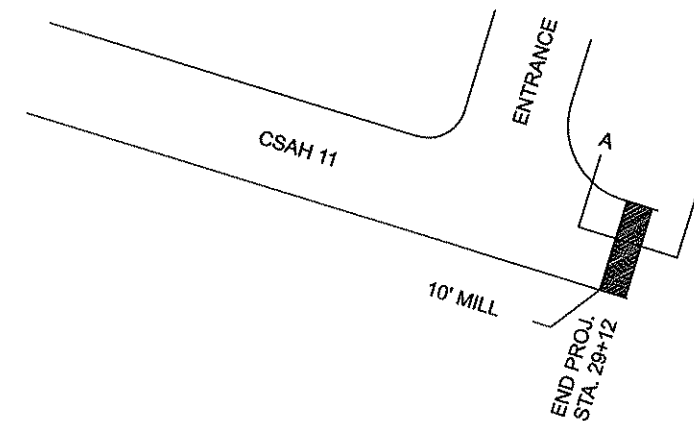
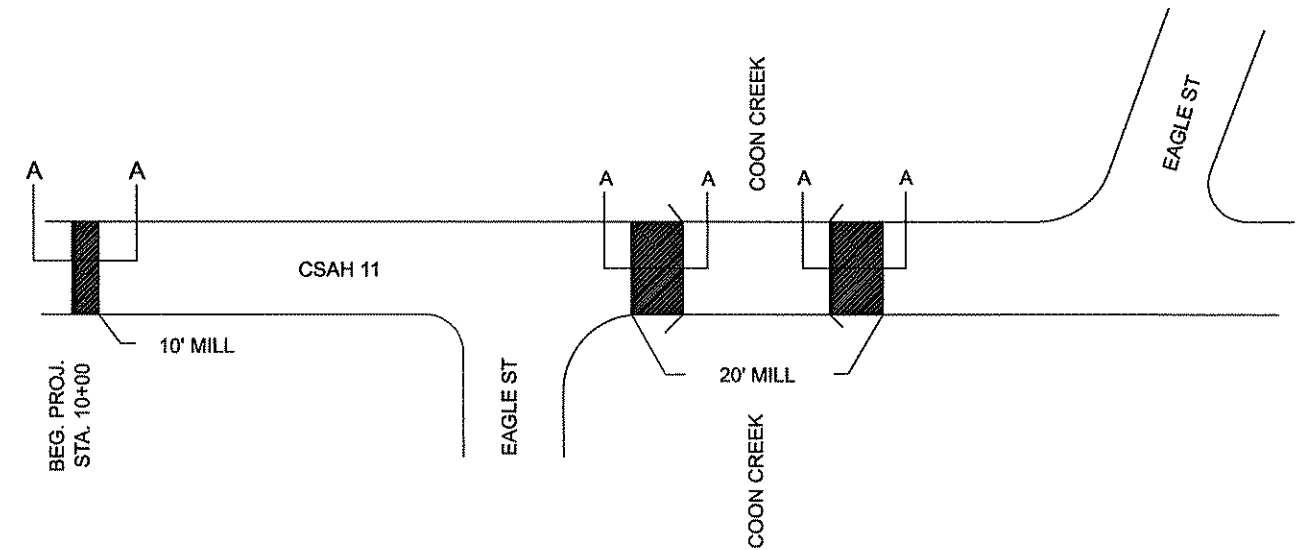

DETAIL A - A

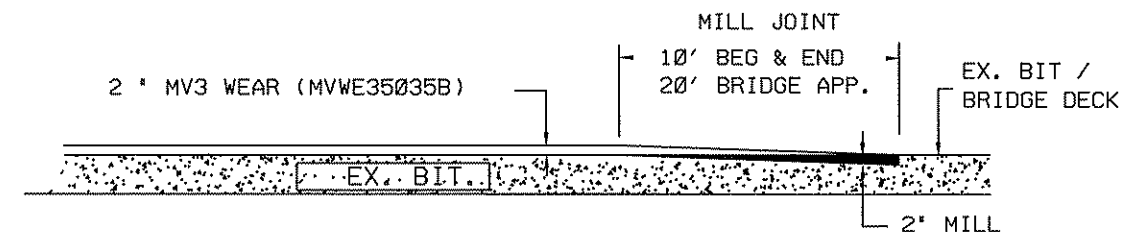

NO	DATE	BY	CKD	APPR	REVISION

NAME: P:\08-01-00\CSAH 11\Plan\TYP DETAILS.dgn 02/05/2009 8:59:36 AM

I HEREBY CERTIFY THAT THIS PLAN WAS PREPARED BY ME OR UNDER MY DIRECT SUPERVISION AND THAT I AM A DULY LICENSED PROFESSIONAL ENGINEER UNDER THE LAWS OF THE STATE OF MINNESOTA.
PRINT NAME: Charles Gadenhead
SIGNATURE: *Charles Gadenhead*
DATE: 2/3/09 LICENSE NO. 4416

DRAWN BY JF DATE 2/4/09
DESIGN BY JF DATE 2/4/09
CHECKED BY DATE



ANOKA COUNTY
HIGHWAY DEPT.

STATE PROJECT NO. _____
STATE AID PROJECT NO. _____
CITY PROJECT NO. _____
COUNTY PROJECT NO. 09-18-11

DETAILS
Sheet 5 of 6 Sheets

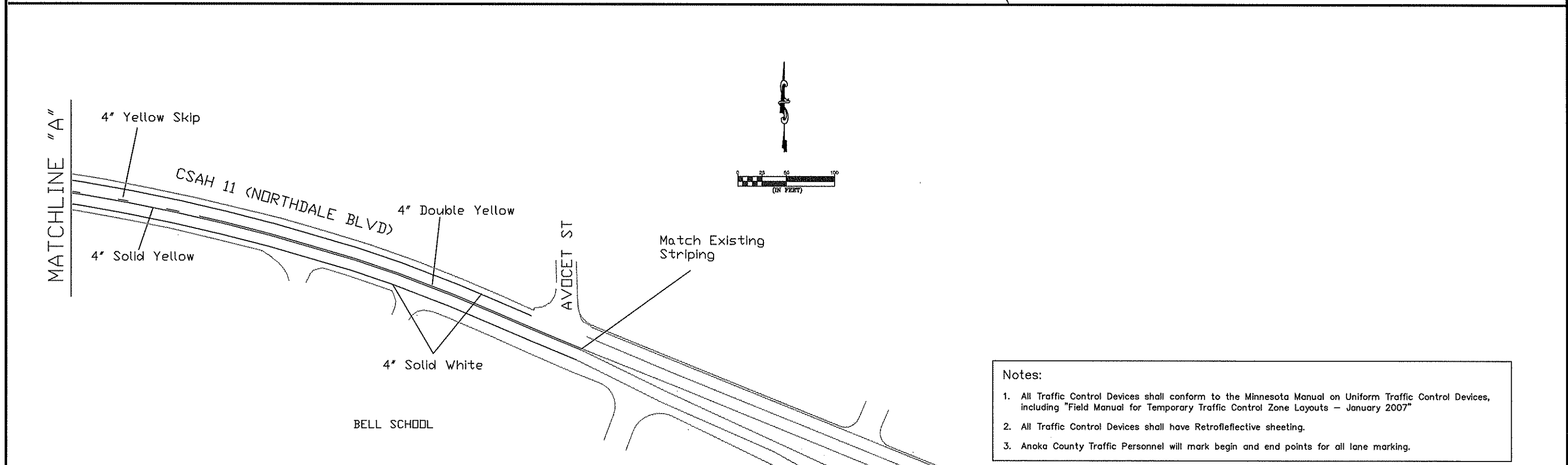
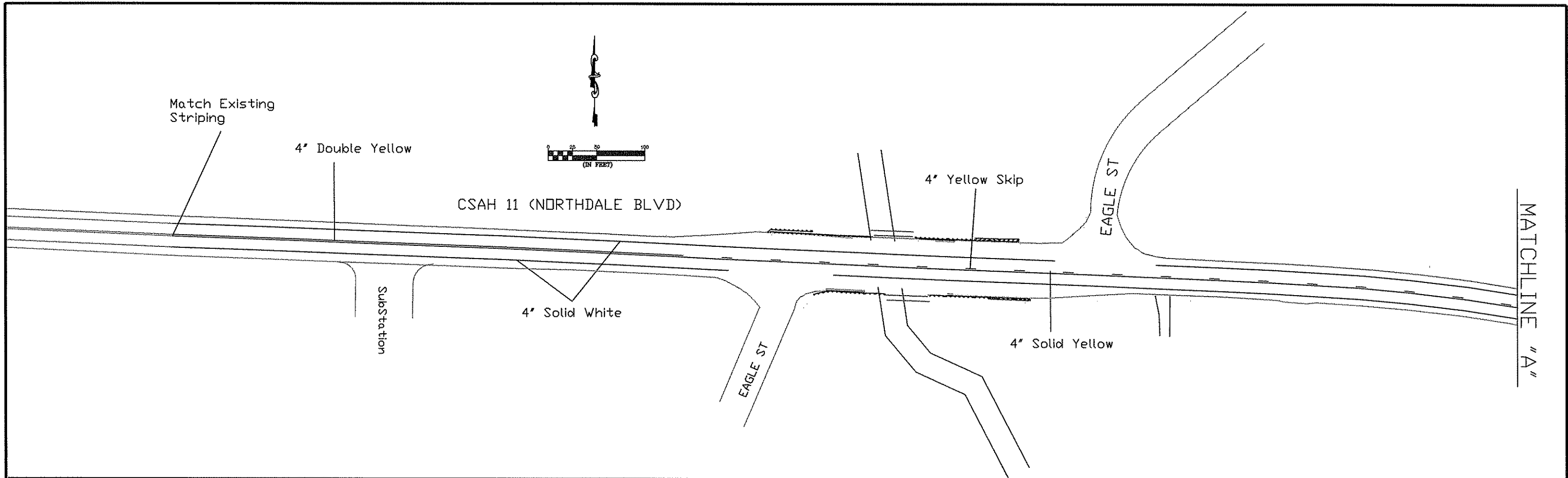

- Notes:
1. All Traffic Control Devices shall conform to the Minnesota Manual on Uniform Traffic Control Devices, including "Field Manual for Temporary Traffic Control Zone Layouts - January 2007"
 2. All Traffic Control Devices shall have Retroreflective sheeting.
 3. Anoka County Traffic Personnel will mark begin and end points for all lane marking.

NO	DATE	BY	CKD	APPR	REVISION

I HEREBY CERTIFY THAT THIS PLAN WAS PREPARED BY ME OR UNDER MY DIRECT SUPERVISION AND THAT I AM A DULY LICENSED PROFESSIONAL ENGINEER UNDER THE LAWS OF THE STATE OF MINNESOTA.

PRINT NAME: *Charles Cadenhead*
 SIGNATURE: *Charles Cadenhead*
 DATE: *5/23/09* LICENSE NO. *40416*

DRAWN BY: *MTH* DATE: *01/14/09*
 DESIGN BY: _____ DATE: _____
 CHECKED BY: _____ DATE: _____

ANOKA COUNTY
HIGHWAY DEPT.

STATE PROJECT NO. _____
 STATE AID PROJECT NO. _____
 CITY PROJECT NO. _____
 COUNTY PROJECT NO. *09-18-11*

CSAH 11
Pavement Markings

Sheet *6* of *6* Sheets