

ANOKA COUNTY HIGHWAY DEPARTMENT

CONSTRUCTION PLAN FOR:

BIT. RECLAIM, BIT. OVERLAY, BIT. CURB

CSAH NO: 22
 FROM CSAH 7
 TO CSAH 9
 FROM
 TO

COUNTY PROJECT NO: 05-08-22

GROSS LENGTH	8374 FT	1.6 MI
BRIDGES LENGTH	250 FT	0.05 MI
EXCEPTION LENGTH	FT	0.00 MI
NET LENGTH	8124 FT	1.5 MI

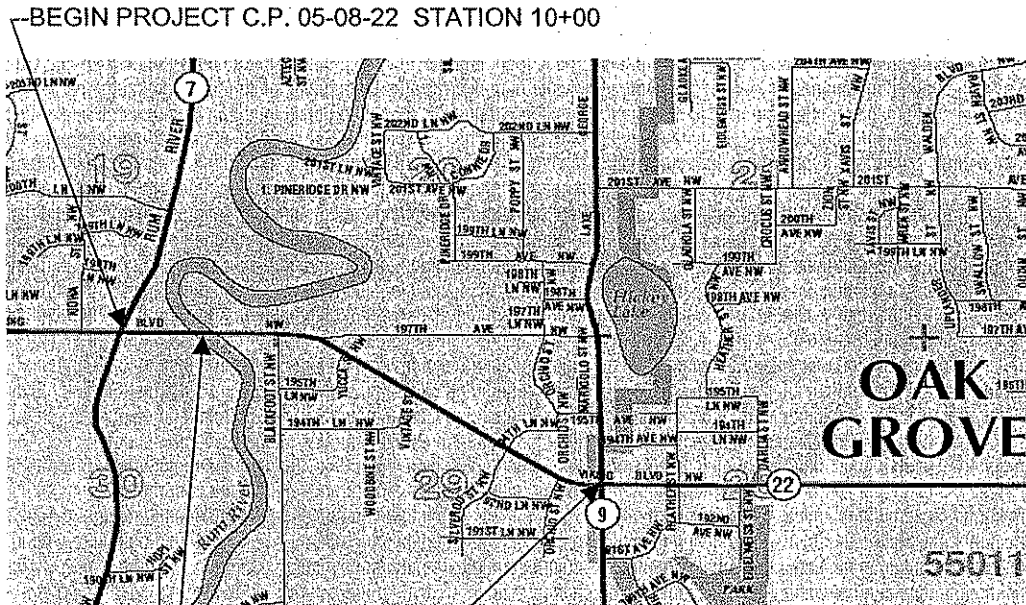

EXCEPTION
 STA 18+50 TO 20+95

--END PROJECT C.P. 05-08-22 STATION 93+74

I HEREBY CERTIFY THAT THIS PLAN WAS PREPARED BY ME OR UNDER MY DIRECT SUPERVISION AND THAT I AM A DULY LICENSED PROFESSIONAL ENGINEER UNDER THE LAWS OF THE STATE OF MINNESOTA

Andrew J. Witter
 ANDREW J. WITTER, P.E.

LIC. NO. 42757 DATE 4/14/05

GOVERNING SPECIFICATIONS:
 THE 2000 EDITION OF THE MINNESOTA DEPARTMENT OF TRANSPORTATION "STANDARD SPECIFICATIONS FOR CONSTRUCTION" SHALL GOVERN. ALL TRAFFIC CONTROL DEVICES SHALL CONFORM TO THE MMUTCD, INCLUDING "FIELD MANUAL FOR TEMPORARY TRAFFIC CONTROL ZONE LAYOUTS - JANUARY 2004."

APPROVED 4/15, 2005 *[Signature]*
 ANOKA COUNTY ENGINEER

STATEMENT OF ESTIMATED QUANTITIES

ITEM NO.	ITEM	NOTE NO.	UNIT	TOTAL EST. QUANT.
2021.501	MOBILIZATION		LUMP SUM	1
2104.503	REMOVE CONCRETE DRIVEWAY PAVEMENT		SQ YD	16
2104.511	SAW CONCRETE PAVEMENT FULL DEPTH		LIN FT	14
2105.525	TOPSOIL BORROW (LV)		CU YD	195
2123.503	MOTOR GRADER		HOUR	36
2123.521	PNEUMATIC-TIRED ROLLER		HOUR	36
2130.501	WATER		M-GAL	111
2211.501	AGGREGATE BASE CLASS 5		TON	891
2221.609	AGGREGATE SHOULDERING CLASS 7B		TON	410
2232.501	MILL BITUMINOUS SURFACE (2") (JOINTS)		SQ YD	122
2331.604	BITUMINOUS PAVEMENT RECLAMATION		SQ YD	37157
2357.502	BITUMINOUS MATERIAL FOR TACK COAT		GALLON	1515
2360.609	TYPE MV3 WEARING COURSE MIXTURE (MAINLINE) (MVWE35035 B)		TON	3224
2360.609	TYPE MV3 WEARING COURSE MIXTURE (ST./ DR.) (MVWE35035 B)		TON	14
2360.609	TYPE LV3 NON-WEARING COURSE (MAINLINE) (LVNW35030 B)		TON	3424
2360.609	TYPE LV3 NON-WEARING COURSE (ST./ DR.) (LVNW35030 B)		TON	18
2506.522	ADJUST FRAME RING AND CASTING		EACH	6
2531.507	6" CONCRETE DRIVEWAY PAVEMENT		SQ YD	16
2535.603	BITUMINOUS CURB		LIN FT	3944
2540.602	INSTALL MAIL BOX SUPPORT		EACH	19
2553.601	TRAFFIC CONTROL		LUMP SUM	1
2563.602	PORTABLE CHANGEABLE MESSAGE SIGN		UNIT DAY	10
2564.603	4" SOLID LINE WHITE - EPOXY		LIN FT	20348
2564.603	4" BROKEN LINE WHITE-EPOXY		LIN FT	50
2564.603	4" BROKEN LINE YELLOW-EPOXY		LIN FT	1395
2564.603	4" SOLID LINE YELLOW - EPOXY		LIN FT	1862
2564.603	4" DOUBLE SOLID LINE YELLOW - EPOXY		LIN FT	1400
2573.502	SILT FENCE, TYPE HEAVEY DUTY		LIN FT	3944
2575.523	EROSION CONTROL BLANKET	(1)	SQ YDS	1753
2580.603	REMOVABLE LANE TAPE		LIN FT	670

NOTES

- (1) INCLUDES SEED MIXTURE 60B AND COMMERCIAL FERTILIZER AT APPLICABLE RATES -
 SEED MIXTURE 60B @ 50 LBS / ACRE
 COMMERCIAL FERTILIZER 22-5-10 @ 500 LBS / ACRE

BASIS OF PLANNED QUANTITIES

2211.501	AGGREGATE BASE CLASS 5	CU YDS * 1.8 = TONS
2221.609	AGGREGATE SHOULDERING CLASS 7B	CU YDS * 1.8 = TONS
2357.502	BITUMINOUS MATERIAL FOR TACK COAT	.05 GAL / SQ YD
2360.609	TYPE MV3 WEAR MIXTURE (MVWE35035 B)	110 LBS/SQYD/IN THICKNESS
2360.609	TYPE LV3 NON-WEAR MIXTURE (LVNW35030 B)	110 LBS/SQYD/IN THICKNESS
2580.603	REMOVABLE LANE TAPE	4' AT 50' INTERVALS FOR SKIPS

STANDARD DETAIL PLATES

PLATE NO.	DESCRIPTION
80001	STANDARD BARRICADES

CERTIFIED BY
 PROJ. 05-08-22

Andrew J. Witter

ANDREW J. WITTER, P.E.

LIC. NO. 42757 DATE 4/14/05

SHEET NO. 2 OF 9 SHEETS

TYPICAL SECTIONS

CSAH 22 STANDARD SECTION

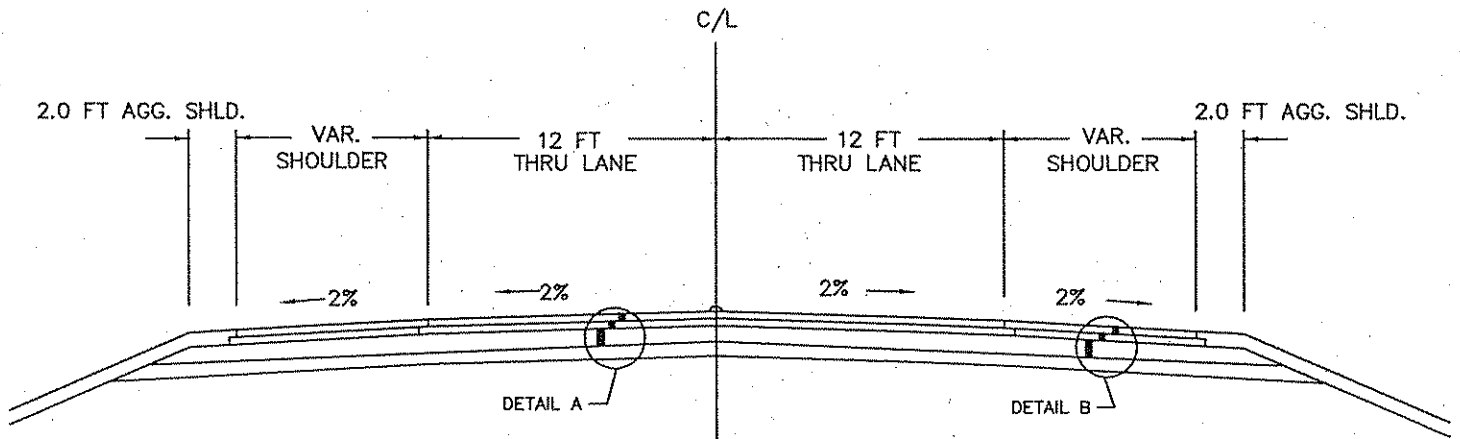

DETAIL A-PROPOSED MAINLINE

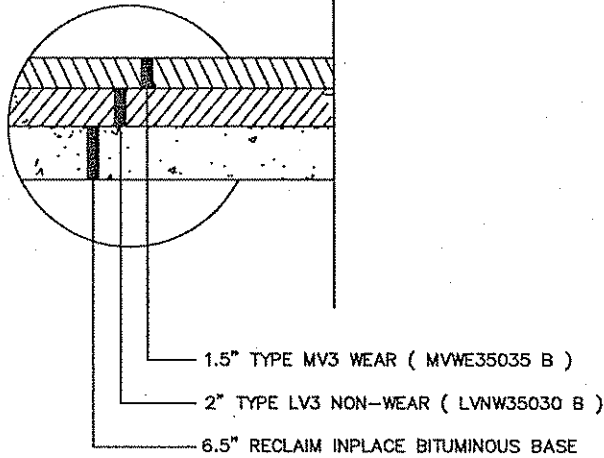

DETAIL B PROPOSED SHOULDER

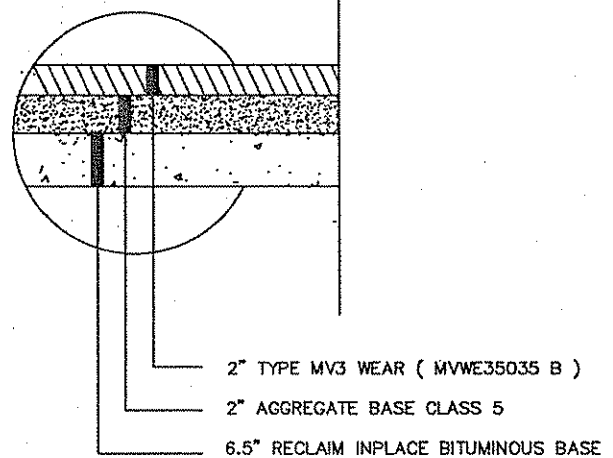

BITUMINOUS CURB DETAIL

STATION 10+00 TO 19+50 LEB
 STATION 10+00 TO 19+50 LWB
 STATION 22+00 TO 32+22 LEB
 STATION 22+00 TO 32+22 LWB

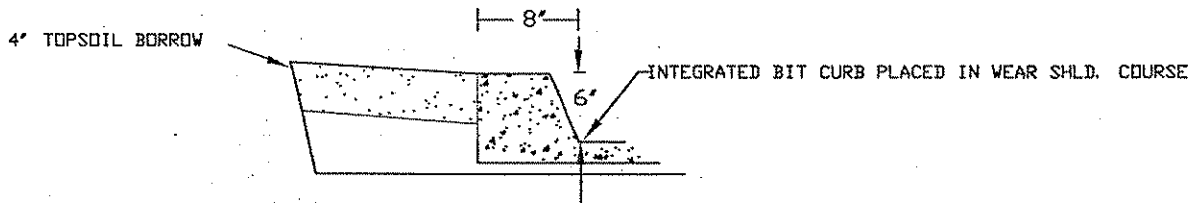

- ① EXISTING BITUMINOUS CURB TO BE RECLAIMED WITH SHOULDER
- ② PROPOSED BITUMINOUS CURB TO BE PAID AS BITUMINOUS CURB, ITEM NO. 2535. 603

NOTE: NOT TO SCALE

CERTIFIED BY Andrew J. Witter
 ANDREW J. WITTER, P.E.

C.P. 05-08-22

LIC. NO. 42757 DATE 4/14/05

SHEET NO. 3 OF 9 SHEETS

TYPICAL SECTIONS

RT. TURN LN. / BYPASS SECTION

CSAH 7,	194 TH,	SILVERROD ST.
YUCCA ST,	197 TH,	BYPASS @ BILLS
BILLS WEST,	BILLS EAST,	CSAH 9.

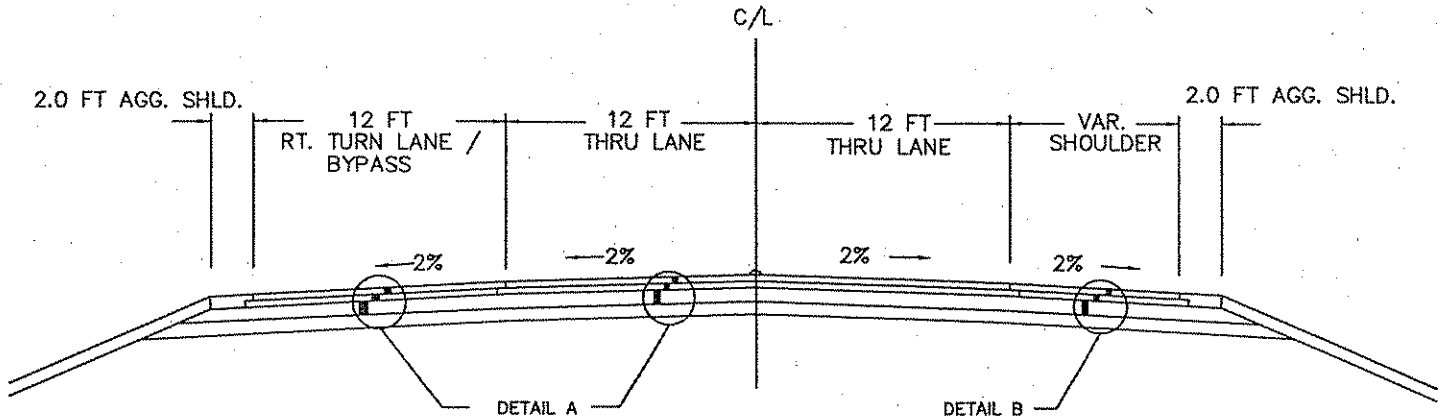

DETAIL A-PROPOSED MAINLINE / RTL / BYPASS

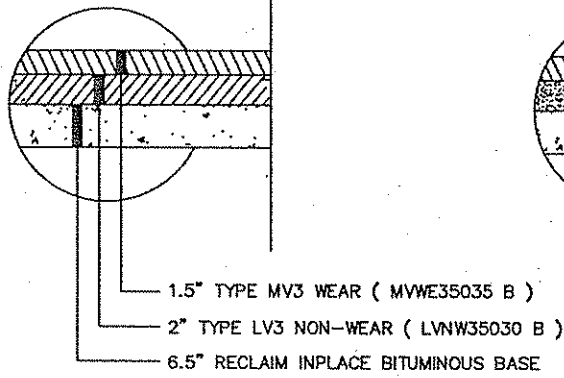

DETAIL B PROPOSED SHOULDER

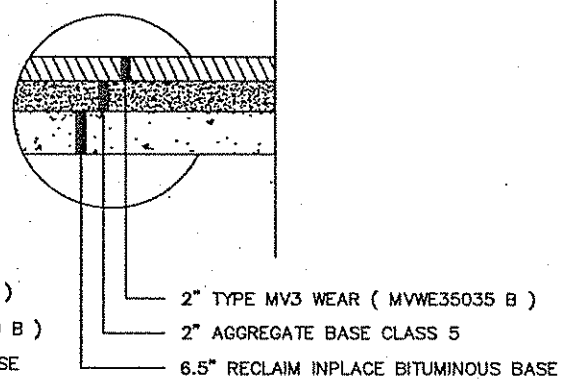

BITUMINOUS CURB DETAIL

STATION 10+00 TO 19+50 LEB
 STATION 10+00 TO 19+50 LWB
 STATION 22+00 TO 32+22 LEB
 STATION 22+00 TO 32+22 LWB

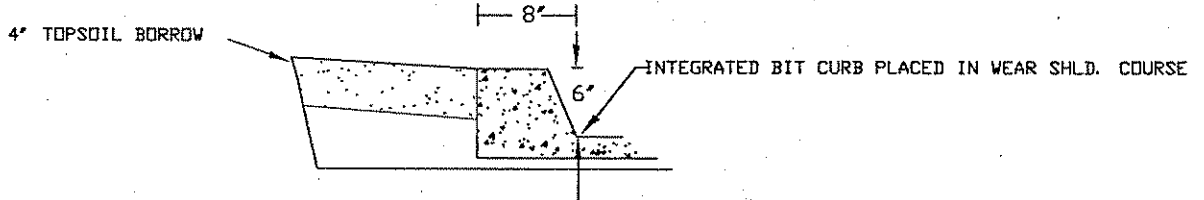

- ① EXISTING BITUMINOUS CURB TO BE RECLAIMED WITH SHOULDER
- ② PROPOSED BITUMINOUS CURB TO BE PAID AS BITUMINOUS CURB, ITEM NO. 2535.603

NOTE: NOT TO SCALE

CERTIFIED BY Andrew J. Witter
 ANDREW J. WITTER, P.E.

LIC. NO. 42757 DATE 4/14/05

C.P. 05-08-22

SHEET NO. 4 OF 9 SHEETS

TYPICAL SECTIONS

FIELD AND UNPAVED ENTRANCES

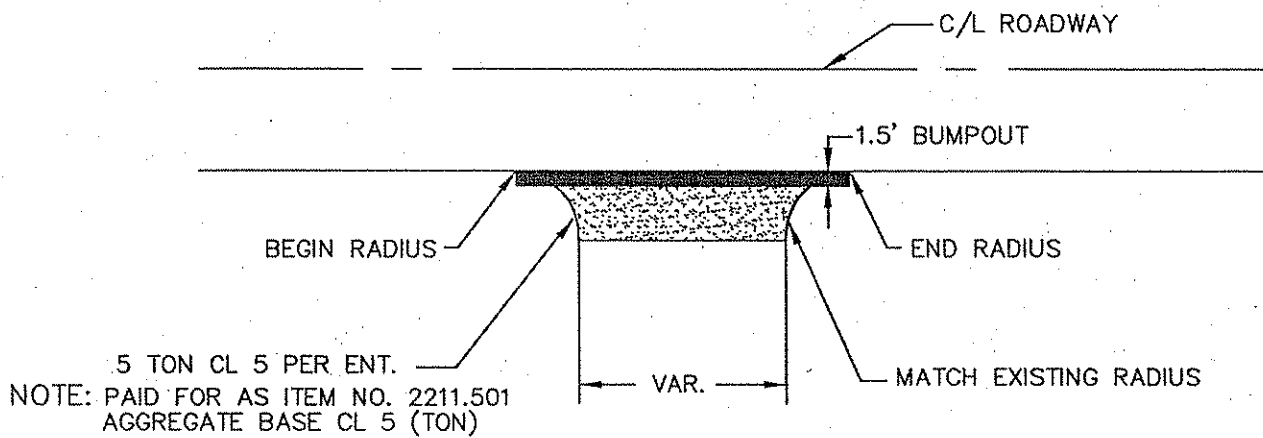

UNPAVED STREET APPROACHES

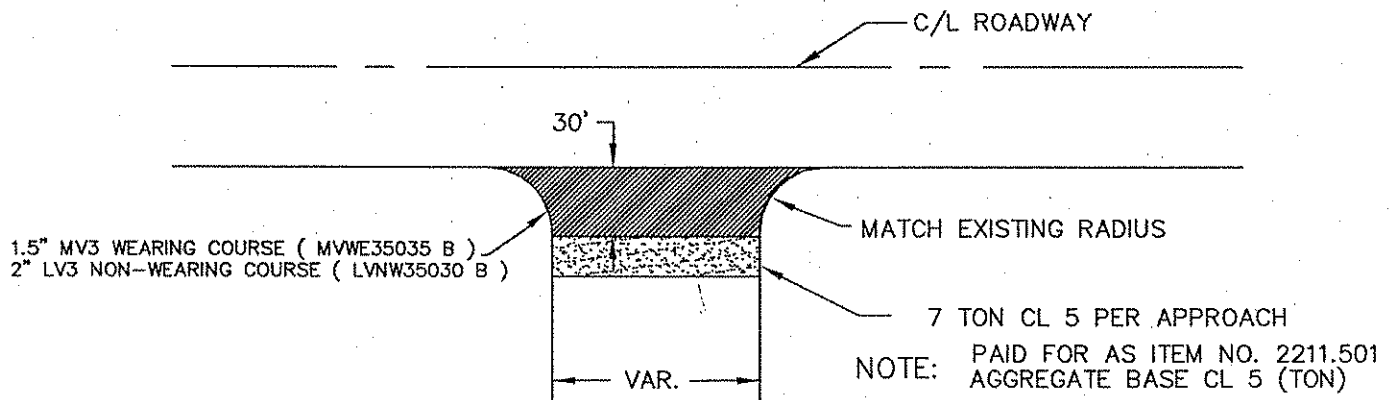

NOTE: NOT TO SCALE

CERTIFIED BY Andrew J. Witter
ANDREW J. WITTER, P.E.

C.P. 05-08-22

LIC. NO. 42757 DATE 4/14/05

SHEET NO. 5 OF 9 SHEETS

TYPICAL SECTIONS

PAVED DRIVEWAYS/PAVED STREET APPROACHES

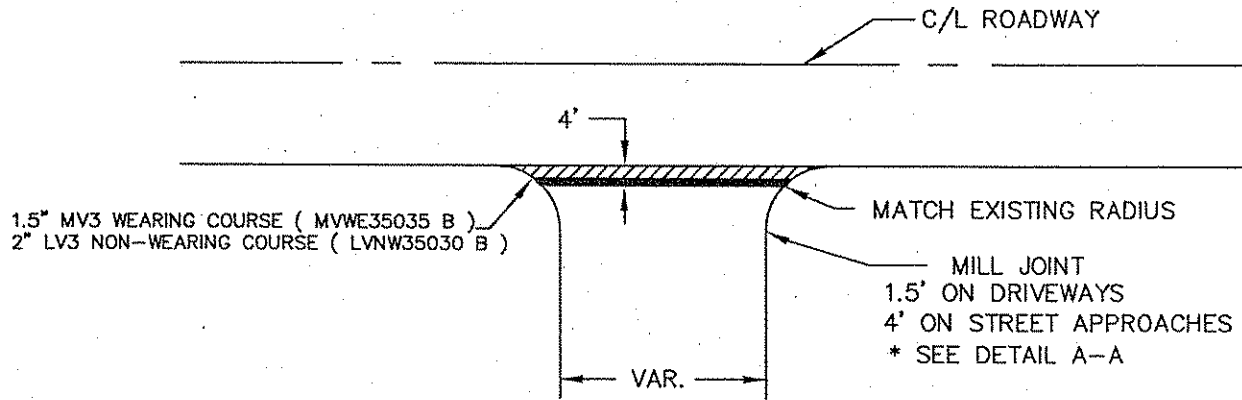

CONCRETE DRIVEWAYS

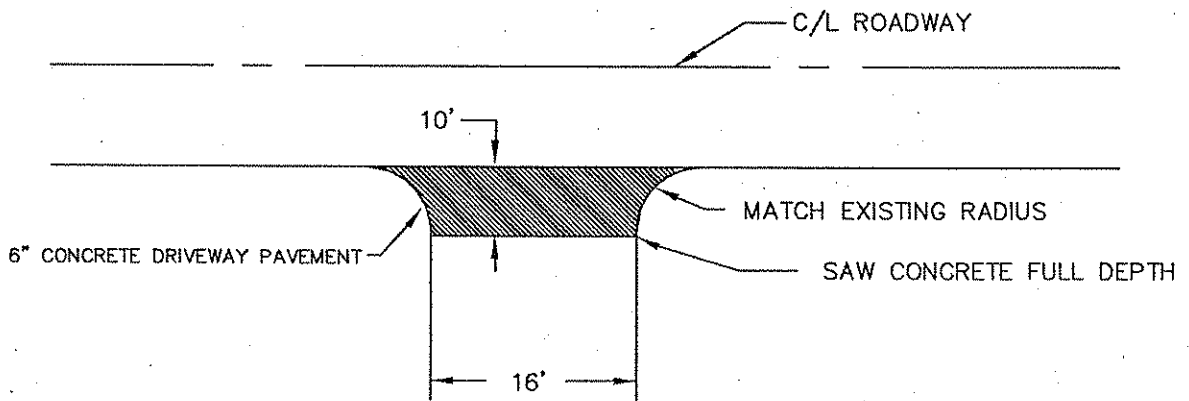

NOTE: NOT TO SCALE

CERTIFIED BY

Andrew J. Witter
ANDREW J. WITTER, P.E.

C.P. 05-08-22

LIC. NO. 42757 DATE 4/14/05

SHEET NO. 6 OF 9 SHEETS

TYPICAL SECTIONS

JOINT DETAILS DRIVEWAYS/STREET APPROACHES

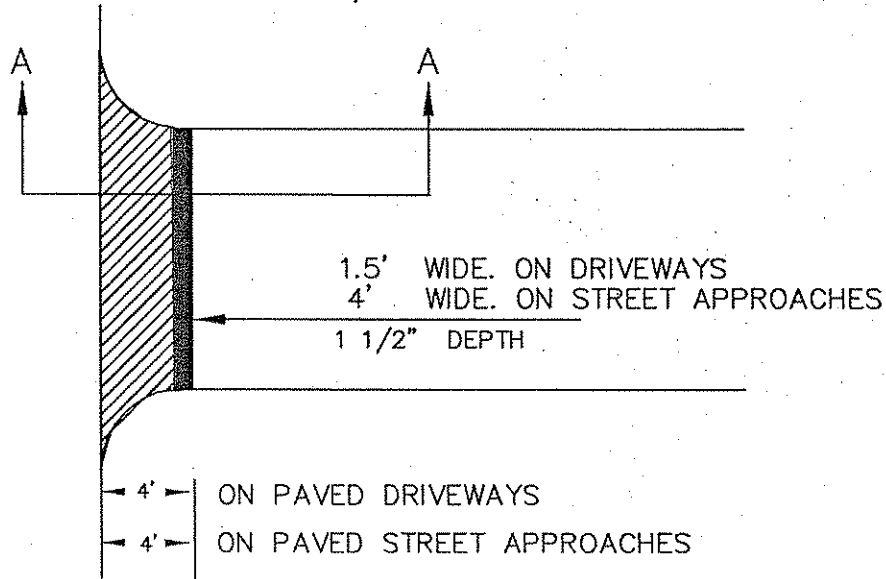

JOINT DETAILS DRIVEWAYS/STREET APPROACHES

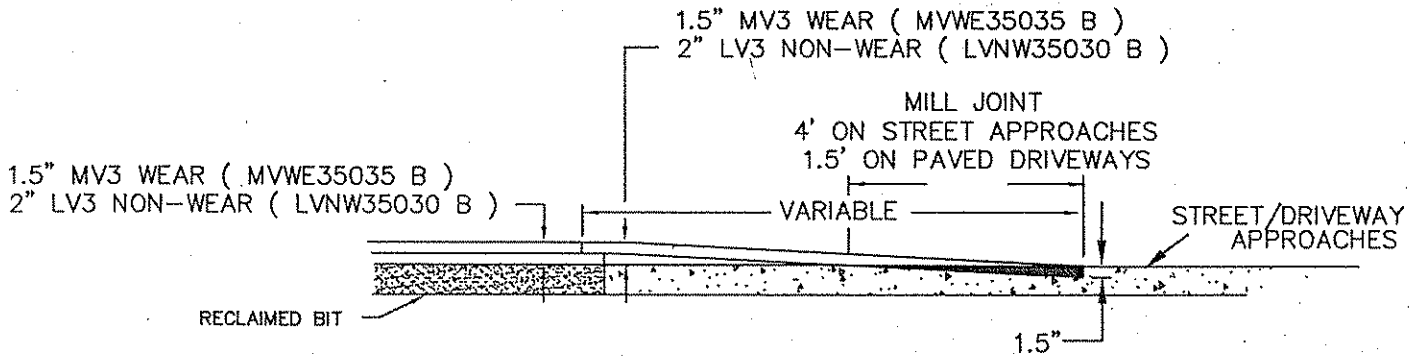

NOTE: NOT TO SCALE

CERTIFIED BY Andrew J. Witter

ANDREW J. WITTER, P.E.

LIC. NO. 42757 DATE 4/14/05

C.P. 05-08-22

SHEET NO. 7 OF 9 SHEETS

TYPICAL SECTIONS

TRANSITION DETAIL

TRANSITION LENGTH TO BE DETERMIND BY ENGINEER.

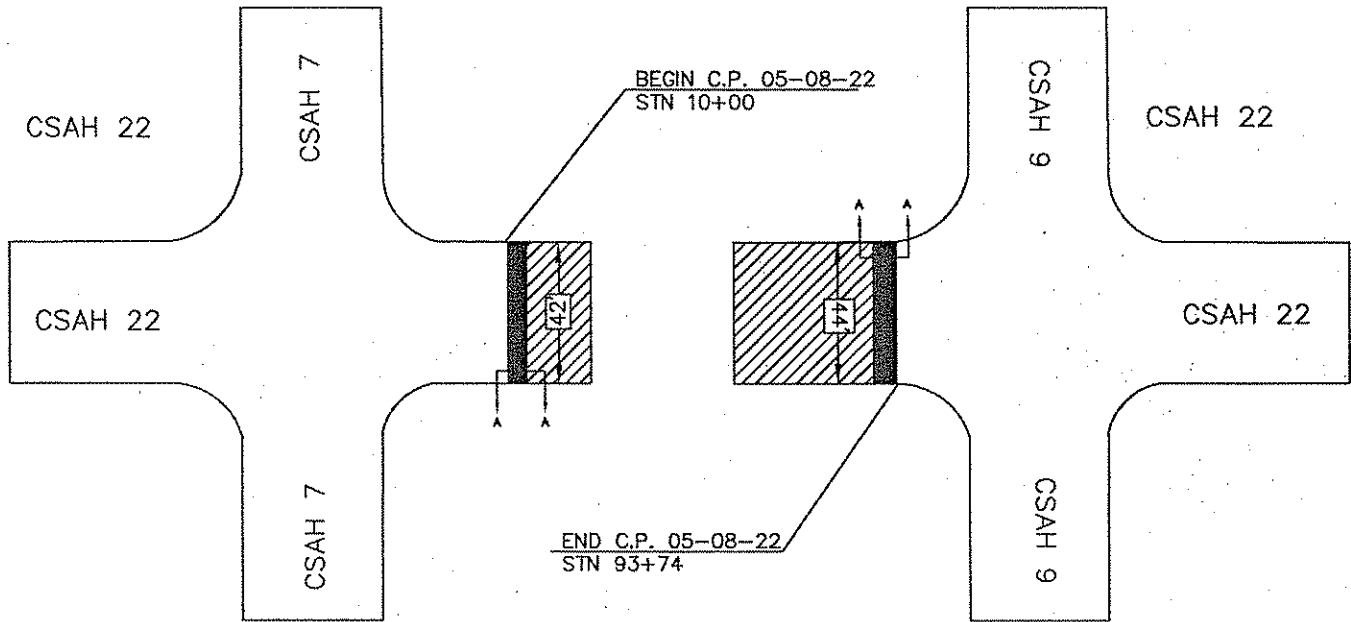

TRANSITION DETAIL A - A

TRANSITION LENGTH TO BE DETERMIND BY ENGINEER.

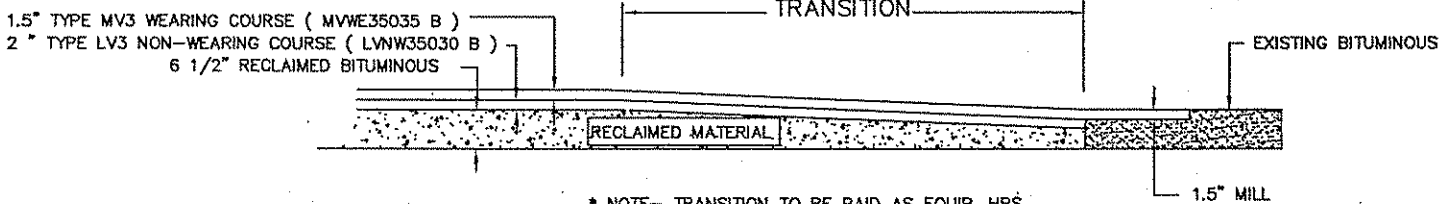

* NOTE-- TRANSITION TO BE PAID AS EQUIP. HRS FOR MOTOR GRADER & ROLLER TO MOVE AND COMPACT RECLAIMED MATERIAL FOR JOINT.

NOTE: NOT TO SCALE

CERTIFIED BY

Andrew J. Witter
 ANDREW J. WITTER, P.E.

C.P. 05-08-22

LIC. NO. 42757 DATE 4/14/05

SHEET NO. 8 OF 9 SHEETS

TYPICAL SECTIONS

TRANSITION DETAIL

TRANSITION LENGTH TO BE DETERMIND BY ENGINEER.

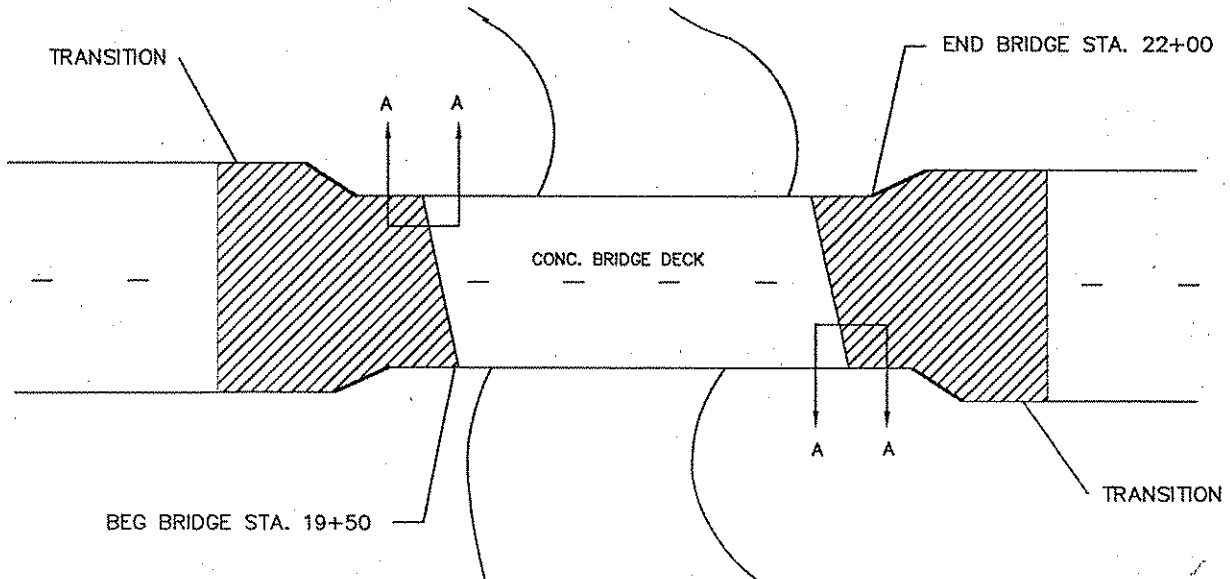

TRANSITION DETAIL A - A

TRANSITION LENGTH TO BE DETERMIND BY ENGINEER.

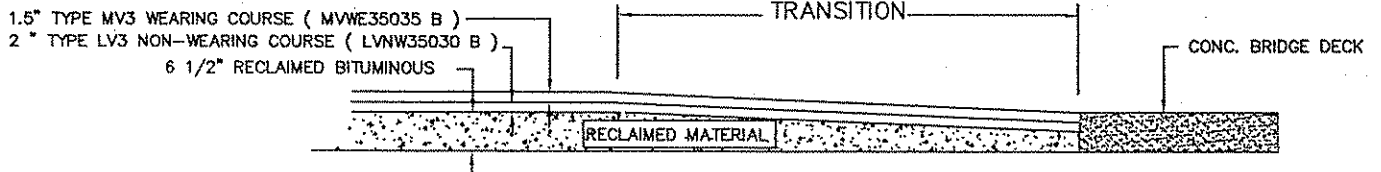

* NOTE- TRANSITION TO BE PAID AS EQUIP. HRS
FOR MOTOR GRADER & ROLLER TO MOVE AND COMPACT
RECLAIMED MATERIAL FOR JOINT.

NOTE: NOT TO SCALE

CERTIFIED BY Andrew J. Witter

ANDREW J. WITTER, P.E.

LIC. NO. 42757 DATE 4/4/05

C.P. 05-08-22

SHEET NO. 9 OF 9 SHEETS