

ANOKA COUNTY HIGHWAY DEPARTMENT

CONSTRUCTION PLAN FOR:

BIT. RECLAIM, BIT. OVERLAY, BIT. CURB

CSAH NO: 22
 FROM T.H. 47
 TO CSAH 7
 FROM
 TO

COUNTY PROJECT NO: 05-13-22
 GROSS LENGTH 6115 FT 1.2 MI
 BRIDGES LENGTH FT 0.00 MI
 EXCEPTION LENGTH FT 0.00 MI
 NET LENGTH 6115 FT 1.2 MI

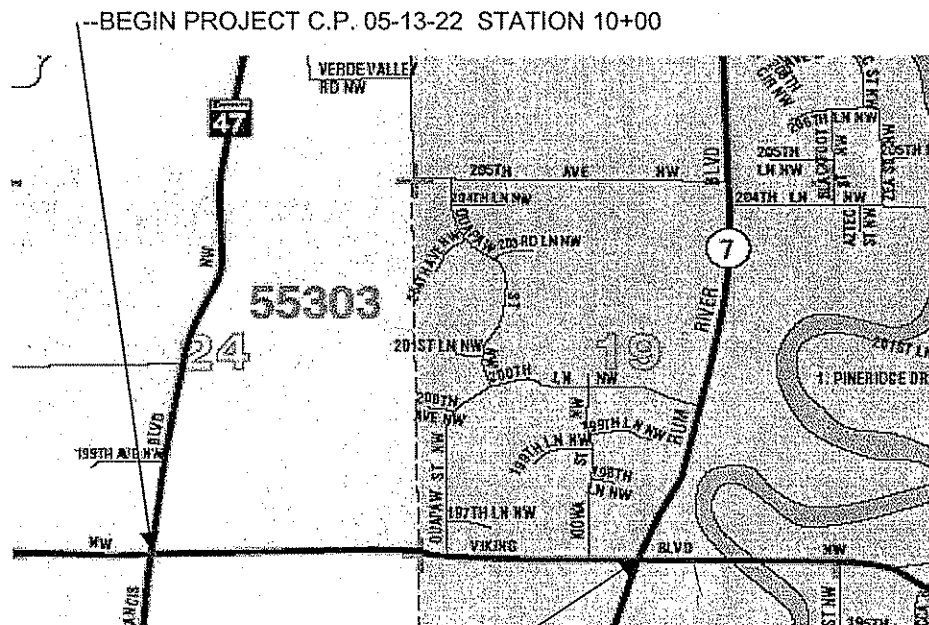

--BEGIN PROJECT C.P. 05-13-22 STATION 10+00

--END PROJECT C.P. 05-13-22 STATION 71+15

I HEREBY CERTIFY THAT THIS PLAN WAS PREPARED BY ME OR UNDER MY DIRECT SUPERVISION AND THAT I AM A DULY LICENSED PROFESSIONAL ENGINEER UNDER THE LAWS OF THE STATE OF MINNESOTA

Andrew J. Witter
 ANDREW J. WITTER, P.E.

LIC. NO. 42757 DATE 4/14/05

GOVERNING SPECIFICATIONS:

THE 2000 EDITION OF THE MINNESOTA DEPARTMENT OF TRANSPORTATION "STANDARD SPECIFICATIONS FOR CONSTRUCTION" SHALL GOVERN. ALL TRAFFIC CONTROL DEVICES SHALL CONFORM TO THE MMUTCD, INCLUDING "FIELD MANUAL FOR TEMPORARY TRAFFIC CONTROL ZONE LAYOUTS - JANUARY 2004."

APPROVED 4/15, 2005

[Signature]
 ANOKA COUNTY ENGINEER

STATEMENT OF ESTIMATED QUANTITIES

ITEM NO.	ITEM	NOTE NO.	UNIT	TOTAL EST. QUANT.
2021.501	MOBILIZATION		LUMP SUM	1
2105.525	TOPSOIL BORROW (CV)		CU YD	16
2123.503	MOTOR GRADER		HOUR	12
2123.521	PNEUMATIC-TIRED ROLLER		HOUR	12
2130.501	WATER		M-GAL	81
2211.501	AGGREGATE BASE CLASS 5		TON	1144
2221.609	AGGREGATE SHOULDERING CLASS 7B		TON	408
2232.501	MILL BITUMINOUS SURFACE (2") (JOINTS)		SQ YD	70
2331.604	BITUMINOUS PAVEMENT RECLAMATION		SQ YD	27396
2357.502	BITUMINOUS MATERIAL FOR TACK COAT		GALLON	875
2360.609	TYPE MV3 WEARING COURSE MIXTURE (MAINLINE) (MVWE35035 B)		TON	2608
2360.609	TYPE MV3 WEARING COURSE MIXTURE (ST./ DR.) (MVWE35035 B)		TON	5
2360.609	TYPE LV3 NON-WEARING COURSE (MAINLINE) (LVNW35030 B)		TON	1926
2360.609	TYPE LV3 NON-WEARING COURSE (ST./ DR.) (LVNW35030 B)		TON	7
2535.603	BITUMINOUS CURB		LIN FT	330
2540.602	INSTALL MAIL BOX SUPPORT		EACH	4
2563.601	TRAFFIC CONTROL		LUMP SUM	1
2564.603	4" SOLID LINE WHITE - EPOXY		LIN FT	15830
2564.603	4" BROKEN LINE YELLOW-EPOXY		LIN FT	1223
2564.603	4" SOLID LINE YELLOW - EPOXY		LIN FT	100
2575.523	EROSION CONTROL BLANKET	(1)	SQ YDS	147
2580.603	REMOVABLE LANE TAPE		LIN FT	489

NOTES

- (1) INCLUDES SEED MIXTURE 60B AND COMMERCIAL FERTILIZER AT APPLICABLE RATES -
 SEED MIXTURE 60B @ 50 LBS / ACRE
 COMMERCIAL FERTILIZER 22-5-10 @ 500 LBS / ACRE

BASIS OF PLANNED QUANTITIES

2211.501	AGGREGATE BASE CLASS 5	CU YDS * 1.8 = TONS
2221.609	AGGREGATE SHOULDERING CLASS 7B	CU YDS * 1.8 = TONS
2357.502	BITUMINOUS MATERIAL FOR TACK COAT	.05 GAL / SQ YD
2360.609	TYPE MV3 WEAR MIXTURE (MVWE35035 B)	110 LBS/SQYD/IN THICKNESS
2360.609	TYPE LV3 NON-WEAR MIXTURE (LVNW35030 B)	110 LBS/SQYD/IN THICKNESS
2575.523	EROSION CONTROL BLANKET	SQ YD
2580.603	REMOVABLE LANE TAPE	4' AT 50' INTERVALS

STANDARD DETAIL PLATES

PLATE NO.	DESCRIPTION
80001	STANDARD BARRICADES

CERTIFIED BY

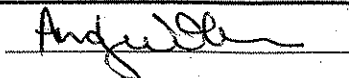

ANDREW J. WITTER, P.E.

LIC. NO. 42757 DATE 4/14/05

PROJ. 05-13-22

SHEET NO. 2 OF 8 SHEETS

TYPICAL SECTIONS

CSAH 22
 PROPOSED SECTION
 STA. 10+00 TO STA. 13+30

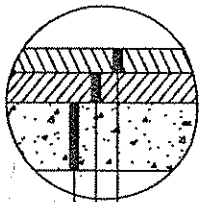
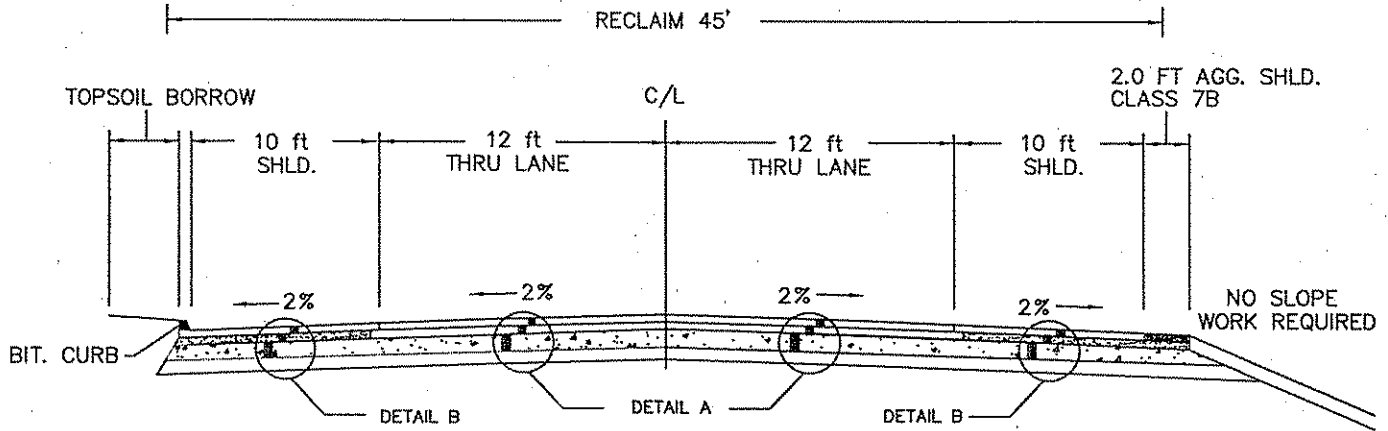

DETAIL A-PROPOSED MAINLINE

- 1.5" TYPE MV3 WEAR MIXTURE (MVWE35035 B)
- 2" TYPE LV3 NON-WEAR MIXTURE (LVNW35030 B)
- 8" RECLAIM INPLACE BITUMINOUS / AGG. BASE

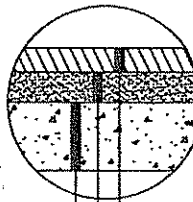

DETAIL B-PROPOSED SHOULDER

- 2" TYPE MV3 WEAR MIXTURE (MVWE35035 B)
- 2" CLASS 5
- 8" RECLAIM INPLACE BITUMINOUS / AGG. BASE

BITUMINOUS CURB DETAIL

STATION 10+00 TO 13+30 LWB

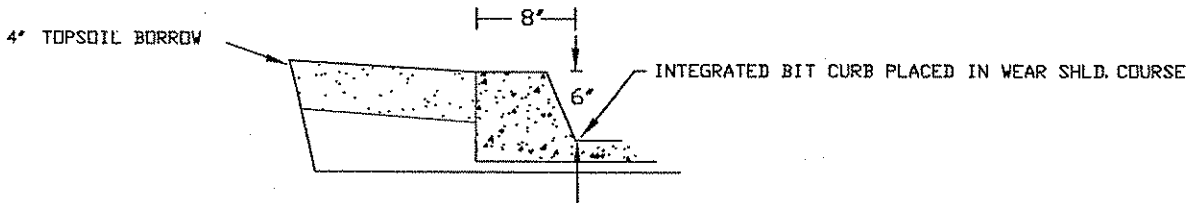

- ① EXISTING BITUMINOUS CURB TO BE RECLAIMED WITH SHOULDER
- ② PROPOSED BITUMINOUS CURB TO BE PAID AS BITUMINOUS CURB, ITEM NO. 2535.603

NOTE: NOT TO SCALE

CERTIFIED BY Andrew J. Witter

ANDREW J. WITTER, P.E.

LIC. NO. 42757 DATE 4/14/05

C.P. 05-13-22

SHEET NO. 3 OF 8 SHEETS

TYPICAL SECTIONS

CSAH 22
 PROPOSED SECTION
 STA. 13+30 TO STA. 14+90

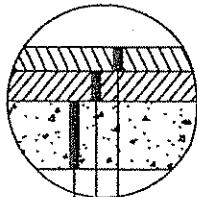
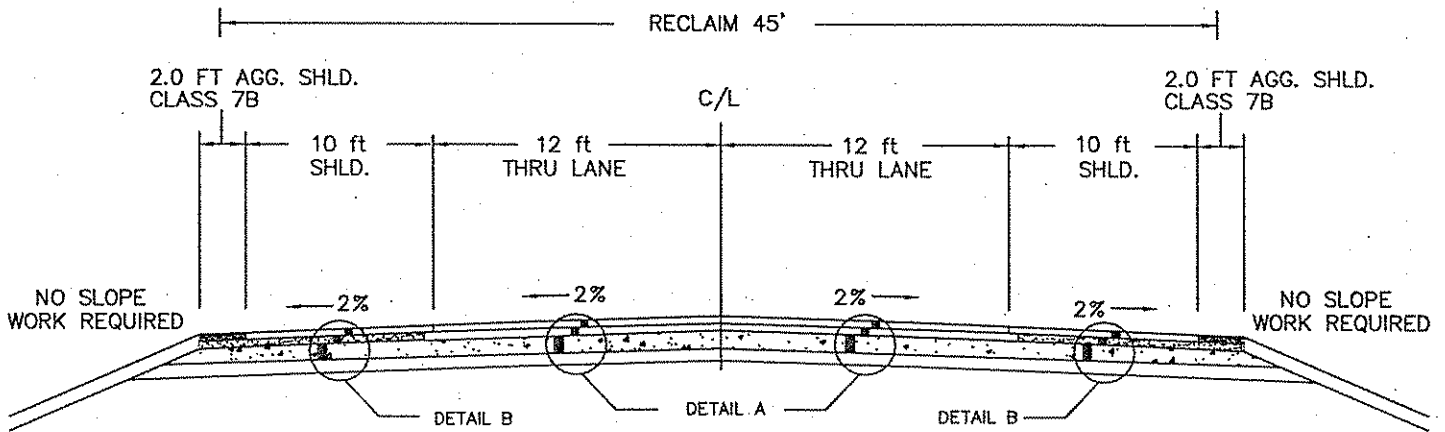

DETAIL A-PROPOSED MAINLINE

- 1.5" TYPE MV3 WEAR MIXTURE (MVWE35035 B)
- 2" TYPE LV3 NON-WEAR MIXTURE (LVNW35030 B)
- 8" RECLAIM INPLACE BITUMINOUS / AGG. BASE

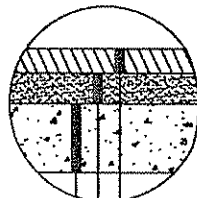

DETAIL B-PROPOSED SHOULDER

- 2" TYPE MV3 WEAR MIXTURE (MVWE35035 B)
- 2" CLASS 5
- 8" RECLAIM INPLACE BITUMINOUS / AGG. BASE

NOTE: NOT TO SCALE

CERTIFIED BY Andrew J. Witter
 ANDREW J. WITTER, P.E.

LIC. NO. 42757 DATE 4/14/05

C.P. 05-13-22

SHEET NO. 4 OF 8 SHEETS

TYPICAL SECTIONS

CSAH 22
 PROPOSED SECTION
 STA. 14+90 TO STA. 71+15

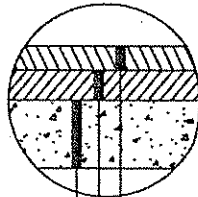
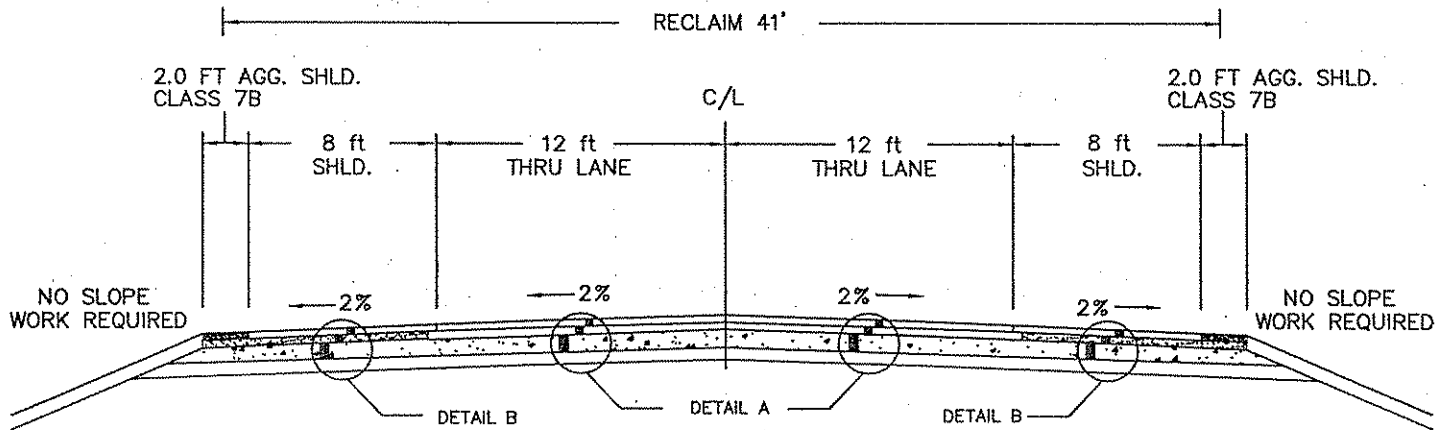

DETAIL A-PROPOSED MAINLINE

- 1.5" TYPE MV3 WEAR MIXTURE (MVWE35035 B)
- 2" TYPE LV3 NON-WEAR MIXTURE (LVNW35030 B)
- 8" RECLAIM INPLACE BITUMINOUS / AGG. BASE

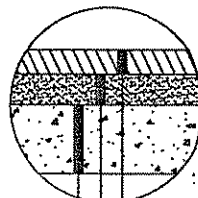

DETAIL B-PROPOSED SHOULDER

- 2" TYPE MV3 WEAR MIXTURE (MVWE35035 B)
- 2" CLASS 5
- 8" RECLAIM INPLACE BITUMINOUS / AGG. BASE

NOTE: NOT TO SCALE

CERTIFIED BY Andrew J. Witter
 ANDREW J. WITTER, P.E.

LIC. NO. 42757 DATE 4/14/05

C.P. 05-13-22

SHEET NO. 5 OF 8 SHEETS

TYPICAL SECTIONS

FIELD AND UNPAVED ENTRANCES

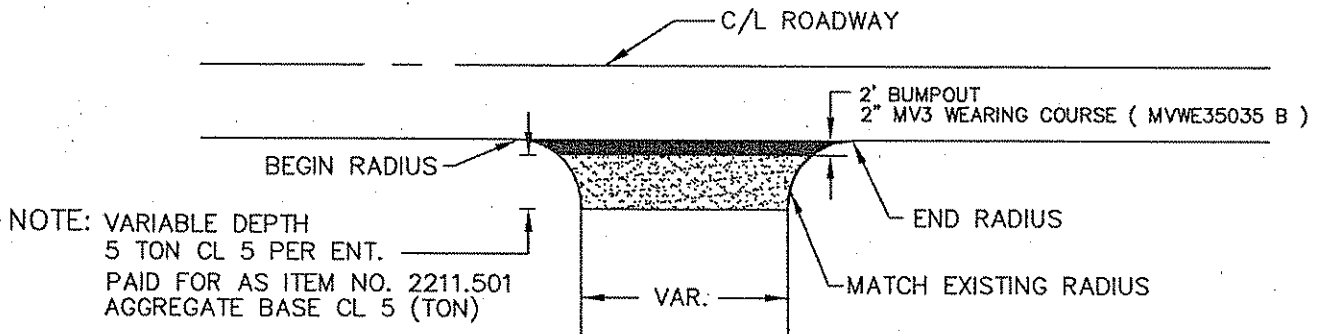

PAVED DRIVEWAYS

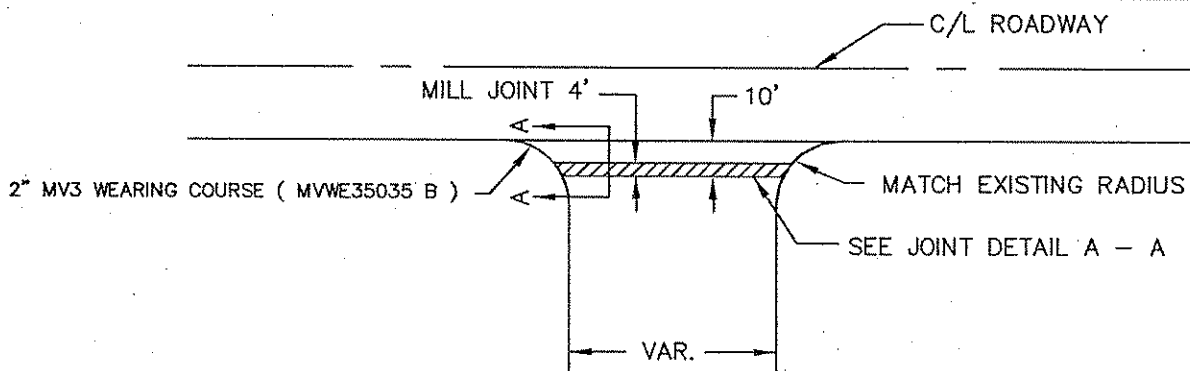

JOINT DETAIL A - A PAVED DRIVEWAYS

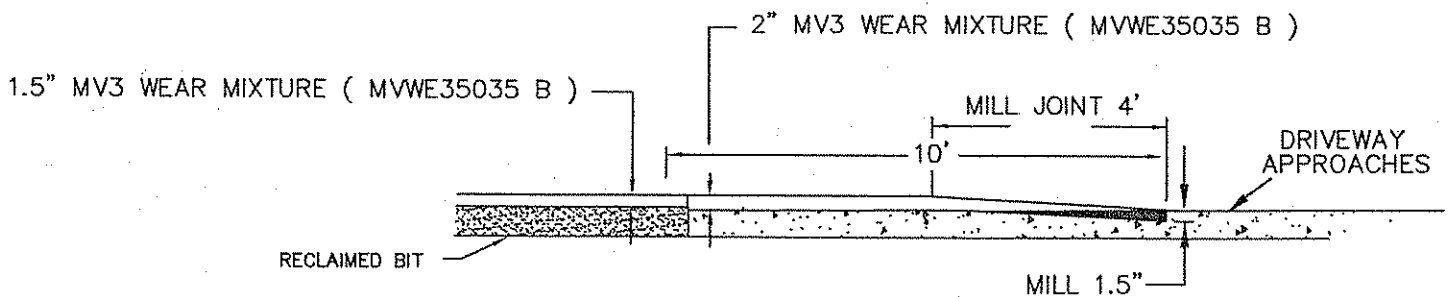

NOTE: NOT TO SCALE

CERTIFIED BY *Andrew J. Witter*

ANDREW J. WITTER, P.E.

C.P. 05-13-22

LIC. NO. 42757 DATE 4/4/05

SHEET NO. 6 OF 8 SHEETS

TYPICAL SECTIONS

PAVED STREET APPROACHES

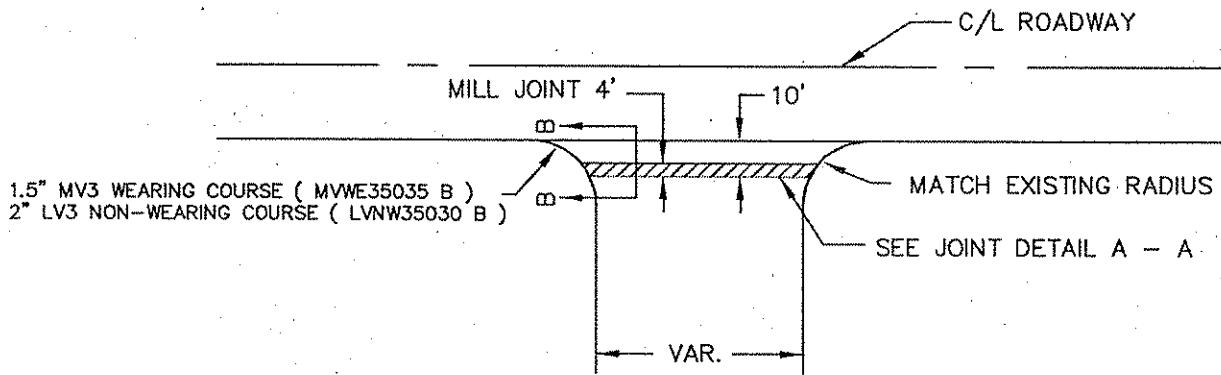

JOINT DETAIL B - B

PAVED STREET APPROACHES

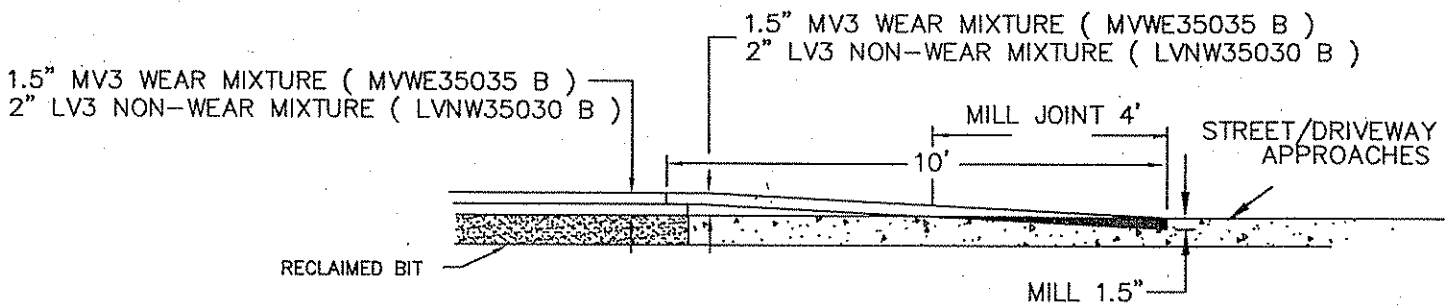

NOTE: NOT TO SCALE

CERTIFIED BY Andrew J. Witter

ANDREW J. WITTER, P.E.

C.P. 05-13-22

LIC. NO. 42757 DATE 4/14/05

SHEET NO. 7 OF 8 SHEETS

TYPICAL SECTIONS

JOINT TRANSITION DETAILS (PLAN VIEW)

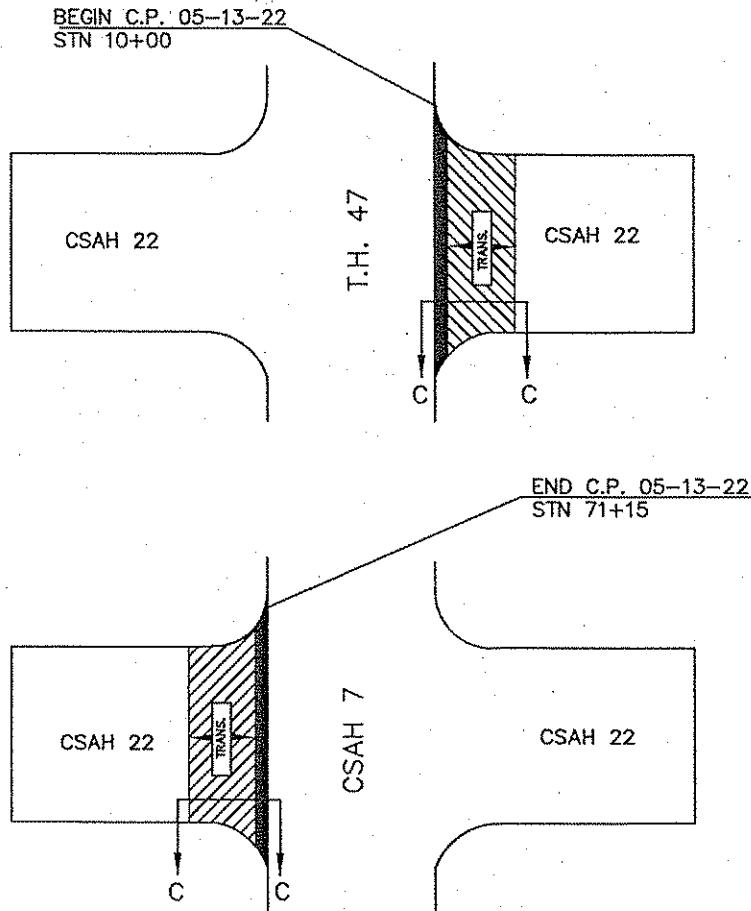

TRANSITION DETAIL C - C

TRANSITION LENGTH TO BE DETERMIND BY ENGINEER.

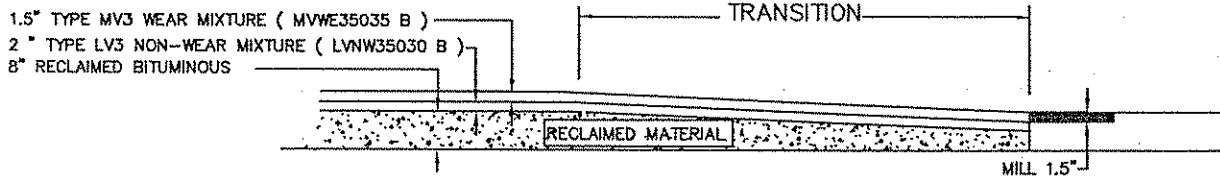

* NOTE- TRANSITION TO BE PAID AS EQUIP. HRS
FOR MOTOR GRADER & ROLLER TO MOVE AND COMPACT
RECLAIMED MATERIAL FOR JOINT.

NOTE: NOT TO SCALE

CERTIFIED BY Andrew J. Witter
ANDREW J. WITTER, P.E.

C.P. 05-13-22

LIC. NO. 42757 DATE 4/14/05

SHEET NO. 8 OF 8 SHEETS