

MINNESOTA DEPARTMENT OF TRANSPORTATION

ANOKA COUNTY

CONSTRUCTION PLAN FOR _____ BITUMINOUS RECLAMATION AND BITUMINOUS SURFACING
 LOCATED ON CSAH 26 BETWEEN 550' WEST OF CR 15 (DURANT STREET) AND CSAH 85 (TYPO CREEK DR. NE)

CSAH 26
 GROSS LENGTH 16912.00 FEET 3.203 MILES
 EXCEPTIONS-LENGTH 0.00 FEET 0.000 MILES
 NET LENGTH 16912.00 FEET 3.203 MILES

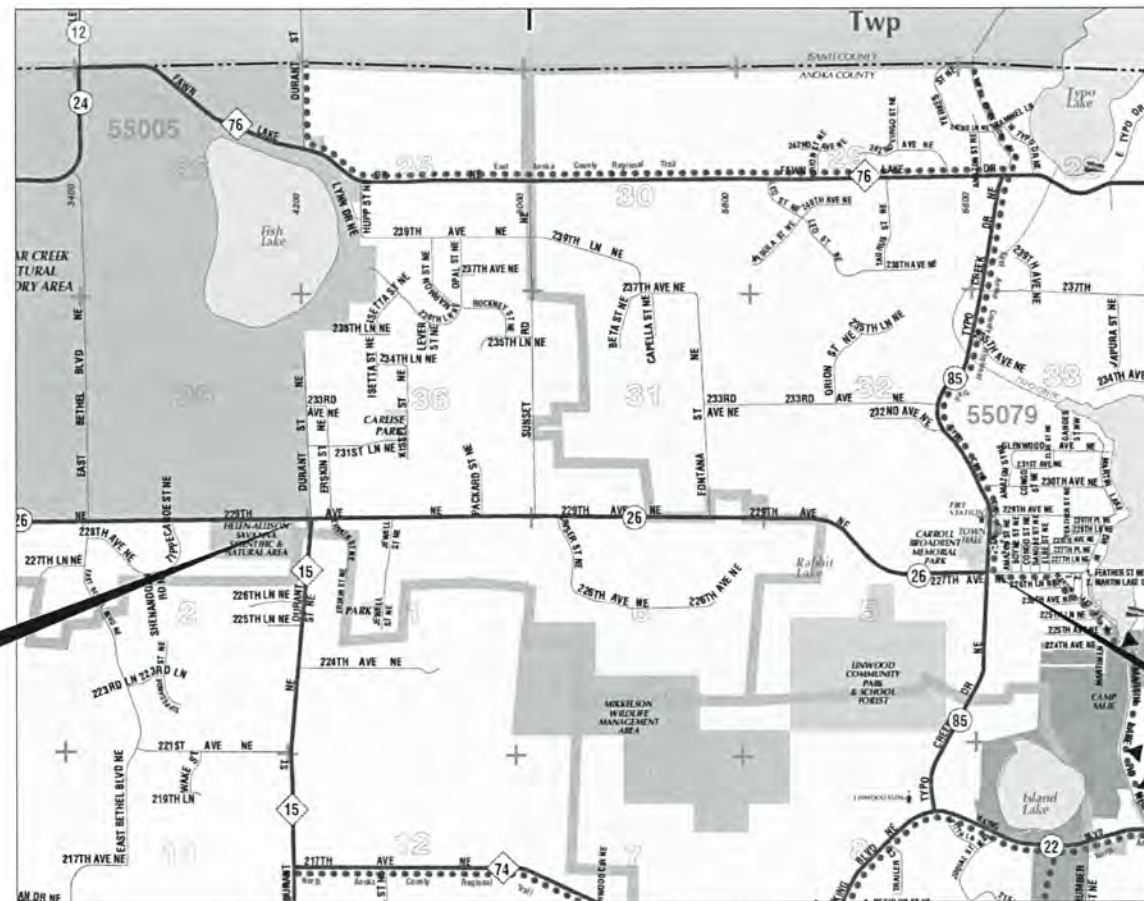

BEGIN SAP: 002-626-006
 CSAH 26, STA: 4+55.00

END SAP: 002-626-006
 CSAH 26, STA: 173+67.00

PROJECT LOCATION



GOVERNING SPECIFICATIONS
 THE 2016 EDITION OF THE MINNESOTA DEPARTMENT OF TRANSPORTATION
 "STANDARD SPECIFICATIONS FOR CONSTRUCTION" SHALL GOVERN.
 ALL TRAFFIC CONTROL DEVICES SHALL CONFORM TO THE LATEST EDITION OF
 THE MINNESOTA MANUAL ON UNIFORM TRAFFIC CONTROL DEVICES, INCLUDING
 THE LATEST FIELD MANUAL FOR TEMPORARY TRAFFIC CONTROL ZONE
 LAYOUTS.

THIS PLAN CONTAINS 25 SHEETS

INDEX

SHEET NO.	DESCRIPTION
1	TITLE SHEET
2	STATEMENT OF ESTIMATED QUANTITIES
3 - 4	TYPICAL SECTIONS
5 - 6	DETAILS
7 - 13	CONSTRUCTION PLAN
14 - 25	SIGNING AND STRIPING PLANS

Approved 4/5, 20 17
 CITY OF EAST BETHEL ENGINEER

Approved 4/5, 20 17
 ANOKA COUNTY ENGINEER

DATE 4/10/17
 DISTRICT STATE AID ENGINEER: REVIEWED FOR
 COMPLIANCE WITH STATE AID RULES/POLICY

DATE 4/10/17
 STATE AID ENGINEER: APPROVED FOR STATE AID FUNDING

DESIGN DESIGNATION (CSAH 26)			
ESAL 20	194,926	FUNCTIONAL CLASSIFICATION	B MINOR
R VALUE	40	NO. OF TRAFFIC LANES	2
ADT (2017)	1650	NO. OF PARKING LANES	0
PROJ. ADT (2037)	1650	DESIGN SPEED	50 MPH
PROJ. HCADT (2037)	97	STOPPING SIGHT DISTANCE BASED ON:	
SOIL FACTOR	NA	HEIGHT OF EYE	3.5'
		HEIGHT OF OBJECT	2.0'
		DESIGN SPEED NOT ACHIEVED AT:	
		STA. _____ TO STA. _____	MPH _____

CITY OF EAST BETHEL / LINWOOD TOWNSHIP
 ANOKA COUNTY
 MN/DOT TRANSPORTATION DISTRICT - METRO
 SECTION 36, 31, 32 & 5
 TOWNSHIP 33 & 34 NORTHWEST
 RANGE 22 & 23 WEST

NO	DATE	BY	CKD	APPR	REVISION	
	03/30/2017					11:44:19 AM

I HEREBY CERTIFY THAT THIS PLAN WAS PREPARED BY ME
 OR UNDER MY DIRECT SUPERVISION AND THAT I AM A DULY
 LICENSED PROFESSIONAL ENGINEER UNDER THE LAWS OF
 THE STATE OF MINNESOTA.
 PRINT NAME: JOSEPH J. MACPHERSON
 SIGNATURE:
 DATE: 3-30-17 LICENSE NO. 46732

DRAWN BY SPH DATE 01/13/2017
 DESIGN BY SPH DATE 01/13/2017
 CHECKED BY MJJ DATE 03/08/2017



**ANOKA COUNTY
 HIGHWAY DEPT.**

STATE AID PROJECT 002-626-006

TITLE SHEET
 Sheet 1 of 25 Sheets

STATEMENT OF ESTIMATED QUANTITIES

ITEM NUMBER	ITEM DESCRIPTION	NOTES	UNIT	TOTAL PROJECT QUANTITIES ESTIMATED
2021.501	MOBILIZATION		LUMP SUM	1
2104.501	REMOVE METAL CULVERT		LN FT	185
2104.505	REMOVE CONCRETE PAVEMENT	6	SQ YD	29
2104.505	REMOVE BITUMINOUS DRIVEWAY PAVEMENT	6	SQ YD	217
2104.505	REMOVE BITUMINOUS PAVEMENT		SQ YD	774
2104.511	SAWING CONCRETE PAVEMENT (FULL DEPTH)		LN FT	48
2104.513	SAWING BITUMINOUS PAVEMENT (FULL DEPTH)		LN FT	501
2105.602	CONSTRUCT TURN LANE (DURANT ST.)	16	EACH	1
2105.602	CONSTRUCT TURN LANE (JEWEL ST.)	16	EACH	1
2105.602	CONSTRUCT TURN LANE (FONTANA ST.)	16	EACH	1
2123.503	MOTOR GRADER	9	HOUR	10
2123.509	DOZER	18	HOUR	15
2130.501	WATER		MGAL	322
2211.501	AGGREGATE BASE CLASS 5	14	TON	771
2215.501	FULL DEPTH RECLAMATION		SQ YD	46010
2215.502	HAUL FULL DEPTH RECLAMATION (LV)	10	CU YD	200
2221.501	SHOULDER BASE AGGREGATE CLASS 5	1	TON	1765
2232.501	MILL BITUMINOUS SURFACE (2.0")	2	SQ YD	221
2357.502	BITUMINOUS MATERIAL FOR TACK COAT		GAL	2652
2360.501	TYPE SP 12.5 WEARING COURSE MX (3,B)	6, 13	TON	228
2360.501	TYPE SP 12.5 WEARING COURSE MX (4,C)		TON	12732
2501.511	15" CP PIPE CULVERT (SMOOTH)		LN FT	70
2501.511	18" CP PIPE CULVERT (SMOOTH)		LN FT	54
2501.515	48" RC PIPE APRON		EACH	2
2501.561	48" RC PIPE CULVERT DESIGN 3006 (CLASS V)		LN FT	74
2501.567	15" CS SAFETY APRON AND GRATE DESIGN 3128		EACH	4
2501.567	18" CS SAFETY APRON AND GRATE DESIGN 3128		EACH	2
2511.501	RANDOM RIPRAP CLASS III		CU YD	45
2511.515	GEOTEXTILE FILTER TYPE IV		SQ YD	123
2531.507	6" CONCRETE DRIVEWAY PAVEMENT	6	SQ YD	32
2540.602	MAIL BOX SUPPORT	3	EACH	50
2563.601	TRAFFIC CONTROL	8, 17	LUMP SUM	1
2563.613	PORTABLE CHANGEABLE MESSAGE SIGN	7	UDAY	28
2564.531	SIGN PANELS TYPE C		SQ FT	25
2573.502	SILT FENCE, TYPE MS		LN FT	1650
2574.525	COMMON TOPSOIL BORROW (LV)	11	CU YD	160
2575.523	EROSION CONTROL BLANKETS CATEGORY 0	12, 15	SQ YD	1800
2581.501	REMOVABLE PREFORMED PAVEMENT MARKING TAPE	4	LN FT	1305
2582.502	4" SOLID LINE EPOXY	5	LN FT	39250
2582.502	4" BROKEN LINE EPOXY	5	LN FT	2770
2582.502	4" DOUBLE SOLID LINE EPOXY	5	LN FT	2590

CONSTRUCTION NOTES

1	ITEM INCLUDES 7 TONS FOR EACH GRAVEL ENTRANCE AND GRAVEL STREET APPROACH.
2	ITEM INCLUDES 2" DEEP MILL AT BEGINNING AND END OF PROJECT, AND ALL PAVED STREET APPROACHES; SEE DETAILS FOR DIMENSIONS.
3	MAILBOXES ARE TO BE INSTALLED AT THE EXISTING MAILBOX LOCATION OR AS DIRECTED BY THE LOCAL POSTAL AUTHORITY. CONTRACTOR IS RESPONSIBLE FOR CONTACTING THE LOCAL POSTAL AUTHORITY. MAILBOX REMOVAL AND ALL MATERIALS ARE INCIDENTAL TO INSTALLATION.
4	CENTERLINE AND LANE DESIGNATION SKIPS TO BE APPLIED AS SOON AS POSSIBLE ON EACH NEW LIFT OF PAVEMENT; SKIPS MUST BE IN PLACE BEFORE THE CONTRACTOR LEAVES FOR THE DAY. CONTRACTOR SHALL REMOVE PRIOR TO FINAL PAINT STRIPING.
5	FINAL STRIPING SHALL BE INSTALLED WITHIN 72 HOURS OF COMPLETION OF MAINLINE WEAR COURSE PAVING.
6	CONTRACTOR IS RESPONSIBLE FOR CONTACTING PROPERTY OWNER 48 HOURS BEFORE STARTING OPERATION.
7	2 MESSAGE BOARDS, ONE ON EACH END OF PROJECT, WILL BE INSTALLED 7 DAYS PRIOR TO ANY CONSTRUCTION AND 7 DAYS PRIOR TO DETOUR; REFERENCE STRIPING PLAN FOR DETAILS.
8	ALL TRAFFIC CONTROL DEVICES SHALL CONFORM TO, AND BE INSTALLED IN ACCORDANCE WITH, THE MOST CURRENT REVISION OF THE "MINNESOTA MANUAL ON UNIFORM TRAFFIC CONTROL DEVICES." DO NOT PASS, PASS WITH CARE, NO CENTER STRIPE, AND STOP HERE ON RED SIGNS SHALL BE IN PLACE WHENEVER PAVEMENT MARKINGS ARE NOT PRESENT.
9	ITEM USED TO MOVE EXCESS RECLAIM MATERIAL AT THE RECLAIM AREA LIMITS TO CREATE A SMOOTH TRANSITION BETWEEN THE PROPOSED AND EXISTING PAVEMENT.
10	MATERIAL SHALL BE HAULED TO AND USED FOR PROFILE AND SUPER ELEVATION CORRECTION AREAS. ITEM INCLUDES PLACEMENT, SHAPING, COMPACTION AND MAINTENANCE OF MATERIAL. EXCESS MATERIAL SHALL BECOME PROPERTY OF THE CONTRACTOR.
11	ITEM USED AT THE ENGINEER'S DISCRETION FOR RESTORATION OF DISTURBED AREAS ALONG DRIVEWAY AND STREET APPROACHES.
12	TYPE 1 FERTILIZER AND TYPE 25-121 SEED ARE INCIDENTAL TO THIS ITEM.
13	STREET APPROACHES SHALL BE PAVED AFTER MAINLINE PAVING BUT BEFORE FINAL STRIPING.
14	GRAVEL BASE FOR CONCRETE AND BITUMINOUS DRIVEWAYS, BITUMINOUS APPROACHES, AND SUPERELEVATION CORRECTION AREAS.
15	ITEM FOR RESTORATION ALONG PROFILE, CROSS-SLOPE AND / OR TURNLANE AREAS.
16	ITEMS INCLUDED IN THE TURNLANE BY THE EACH ARE - COMMON EXCAVATION, SELECT GRANULAR BORROW, TOPSOIL AND AGG BASE CL-5.
17	DETOUR IS INCIDENTAL TO TRAFFIC CONTROL.
18	ITEM USED FOR DITCH GRADING FOLLOWING CONSTRUCTION OF RIGHT TURN LANES. ITEM SHALL BE USED ONLY AS NECESSARY AS DETERMINED BY THE ENGINEER.

BASIS OF PLANNED QUANTITIES

2357	BITUMINOUS MATERIAL FOR TACK COAT	0.05 GAL / SQ YD
2211	AGGREGATE BASE CLASS 5	1.8 TONS / CU YD
2360	ALL BITUMINOUS PAVEMENT	115 LBS / SQ YD / IN THICKNESS
2581	REMOVABLE PREFORM PAVEMENT MARKING TAPE	2' AT 50' INTERVALS

MNDOT STANDARD PLATES

PLATE NUMBER	DESCRIPTION
3000L	REINFORCED CONCRETE PIPE (5 SHEETS)
3006G	GASKET JOINT FOR R.C. PIPE (2 SHEETS)
3100G	CONCRETE APRON FOR REINFORCED CONCRETE PIPE
3128H	METAL SAFETY APRON & GRATE (2 SHEETS)
3133D	RIPRAP AT RCP OUTLETS
8000J	CHANNELIZERS (3 SHEETS)
9350A	MAILBOX SUPPORT (SWING-AWAY TYPE)

NEW RIGHT TURN LANES (BY THE EACH)

STREET	STATION RANGE	RTL / BYPASS	COMMON EXCAVATION (CU YDS)	GRANULAR BORROW (CV) (CU YDS)	TOPSOIL BORROW (LV) (CU YDS)	CLASS 5 (TON)
JEWELL ST	27+17 - 29+00	RTL	123	650	80	192
FONTANA	104+25 - 109+02	RTL	116	753	85	200
DURANT ST.	5+20 - 10+00	RTL	136	781	128	198
TOTALS:			375	2184	293	590

SUPERELEVATION CORRECTION TAB

STATION	POINT	LEFT GRADE	RIGHT GRADE
126+00	BEGIN SUPER LT	-2.0%	-2.0%
126+50		-1.0%	-2.0%
127+00	BEGIN SUPER RT	0.0%	-2.8%
127+50		0.8%	-3.1%
128+00		1.6%	-4.4%
128+50		3.8%	-5.0%
129+00		4.9%	-5.5%
129+50	BEGIN FULL SUPER	6.0%	-6.0%
130+00		6.0%	-6.0%
130+50		6.0%	-6.0%
131+00		6.0%	-6.0%
131+50		6.0%	-6.0%
132+00		6.0%	-6.0%
132+50		6.0%	-6.0%
133+00		6.0%	-6.0%
133+50		6.0%	-6.0%
134+00		6.0%	-6.0%
134+50		6.0%	-6.0%
135+00		6.0%	-6.0%
135+50		6.0%	-6.0%
136+00	END FULL SUPER	6.0%	-6.0%
136+50		5.2%	-5.8%
137+00		4.0%	-4.7%
137+50		2.8%	-3.7%
138+00		1.3%	-2.5%
138+50	END SUPER RT	0.0%	-2.0%
139+00		-0.7%	-2.0%
139+50		-1.5%	-2.0%
140+00	END SUPER LT	-2.0%	-2.0%
140+50		-2.0%	-2.0%

SUPERELEVATION CORRECTION TAB

STATION	POINT	LEFT GRADE	RIGHT GRADE
143+00	BEGIN SUPER RT	-2.0%	-2.0%
143+50	BEGIN SUPER LT	-2.0%	-1.0%
144+00		-2.8%	-0.3%
144+50		-3.3%	0.0%
145+00		-4.0%	1.2%
145+50		-4.8%	2.8%
146+00		-5.1%	3.5%
146+50		-5.5%	4.0%
147+00		-5.8%	4.8%
147+50		-6.0%	5.5%
148+00	BEGIN FULL SUPER	-6.0%	6.0%
148+50		-6.0%	6.0%
149+00		-6.0%	6.0%
149+50		-6.0%	6.0%
150+00		-6.0%	6.0%
150+50		-6.0%	6.0%
151+00		-6.0%	6.0%
151+50		-6.0%	6.0%
152+00		-6.0%	6.0%
152+50		-6.0%	6.0%
153+00	END FULL SUPER	-6.0%	6.0%
153+50		-5.8%	5.0%
154+00		-5.0%	4.3%
154+50		-4.3%	3.0%
155+00		-3.8%	2.0%
155+50		-3.0%	1.0%
156+00		-2.3%	0.5%
156+50	END SUPER LT	-2.0%	0.0%
157+00		-2.0%	-0.8%
157+50		-2.0%	-1.7%
158+00	END SUPER RT	-2.0%	-2.0%
158+50		-2.0%	-2.0%

I HEREBY CERTIFY THAT THIS PLAN WAS PREPARED BY ME OR UNDER MY DIRECT SUPERVISION AND THAT I AM A DULY LICENSED PROFESSIONAL ENGINEER UNDER THE LAWS OF THE STATE OF MINNESOTA.

PRINT NAME: JOSEPH J. MACPHERSON
 SIGNATURE: *[Signature]*
 DATE: 3-13-17 LICENSE NO. 48732

DRAWN BY: SPH DATE 01/13/2017

DESIGN BY: SPH DATE 01/13/2017

CHECKED BY: MJJ DATE 03/08/2017



ANOKA COUNTY
HIGHWAY DEPT.

STATE AID PROJECT 002-626-006

STATEMENT OF ESTIMATED QUANTITIES

Sheet 2 of 25 Sheets

CSAH 26 PROPOSED RIGHT TURN LANE

63+16 - 67+66
104+25 - 109+02

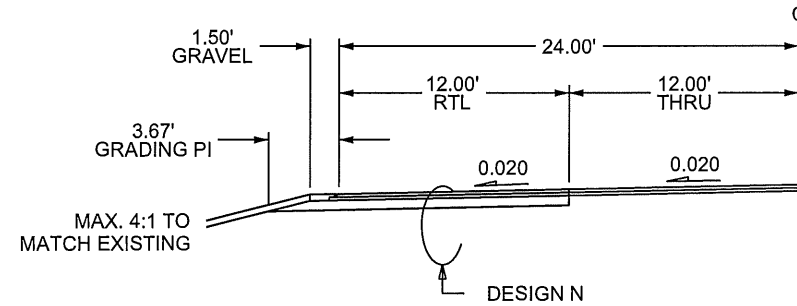

CSAH 26 RECLAIM SECTION (TURN LANES EXEMPT)

15+00 - 173+67

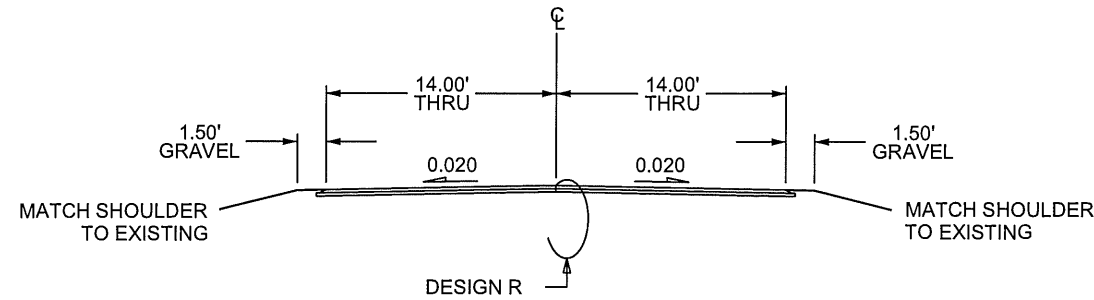

CSAH 26 PROPOSED RIGHT TURN LANE

5+20 - 10+00
24+17 - 29+00

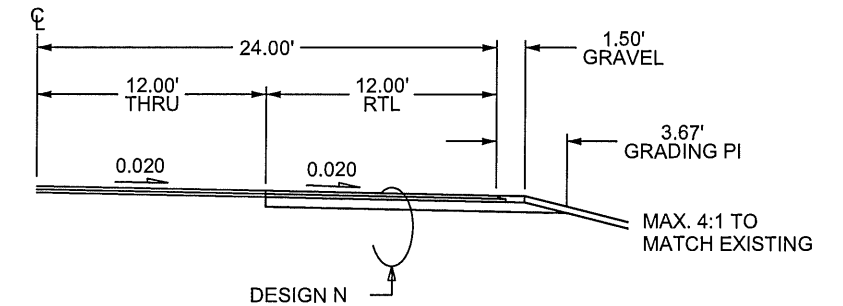

CSAH 26 EXISTING RIGHT TURN LANE

10+50 - 15+00

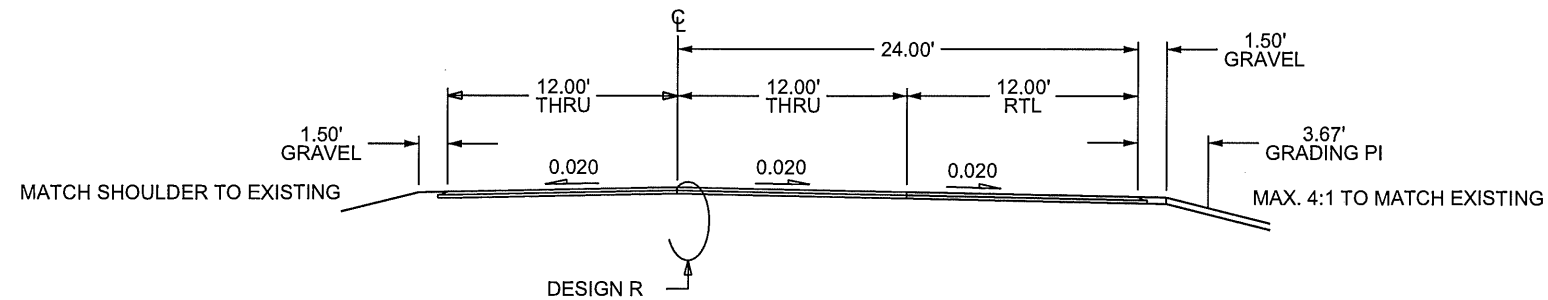

DESIGN R RECLAIM SECTION

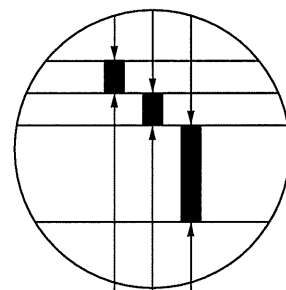

2.0" BITUMINOUS WEAR(SPWEB440C)
2.0" BITUMINOUS WEAR(SPWEB440C)
FULL DEPTH RECLAMATION

DESIGN N RIGHT TURN & BYPASS LANE

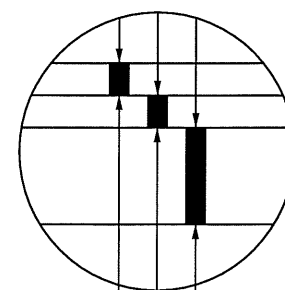

2.0" BITUMINOUS WEAR(SPWEB440C)
2.0" BITUMINOUS WEAR(SPWEB440C)
6" AGGREGATE BASE, CLASS 5

EXISTING SECTION

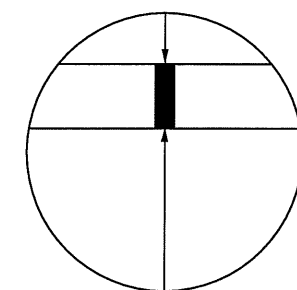

3.5" EXISTING BITUMINOUS
NO AGGREGATE BASE

* FOR INFORMATIONAL PURPOSES ONLY
CONTRACTOR SHALL FIELD VERIFY THE EXISTING SECTION

NO	DATE	BY	CKD	APPR	REVISION	03/23/2017	2:24:25 PM
NAME: P:\17-01-00\CSAH_26_(CR15-CR85)\Base\PROPOSED\PROPOSED-2d.dgn							

I HEREBY CERTIFY THAT THIS PLAN WAS PREPARED BY ME OR UNDER MY DIRECT SUPERVISION AND THAT I AM A DULY LICENSED PROFESSIONAL ENGINEER UNDER THE LAWS OF THE STATE OF MINNESOTA.

PRINT NAME: MATTHEW J. JOHN
SIGNATURE: *M.John*
DATE: 3/23/2017 LICENSE NO. 51639

DRAWN BY: SPH DATE: 01/13/2017
DESIGN BY: SPH DATE: 01/13/2017
CHECKED BY: MJJ DATE: 03/08/2017



ANOKA COUNTY
HIGHWAY DEPT.

STATE AID PROJECT 002-626-006

TYPICAL SECTIONS

Sheet 3 of 25 Sheets

dfrey

RIGHT TURN

GENERAL LAYOUT PLAN VIEW

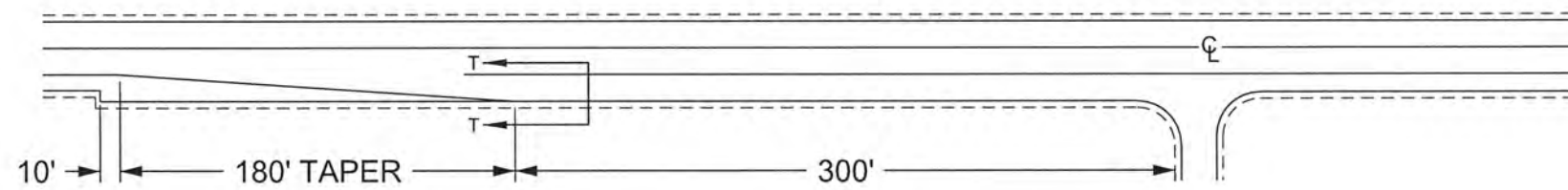

RIGHT TURN LANE

SECTION T - T

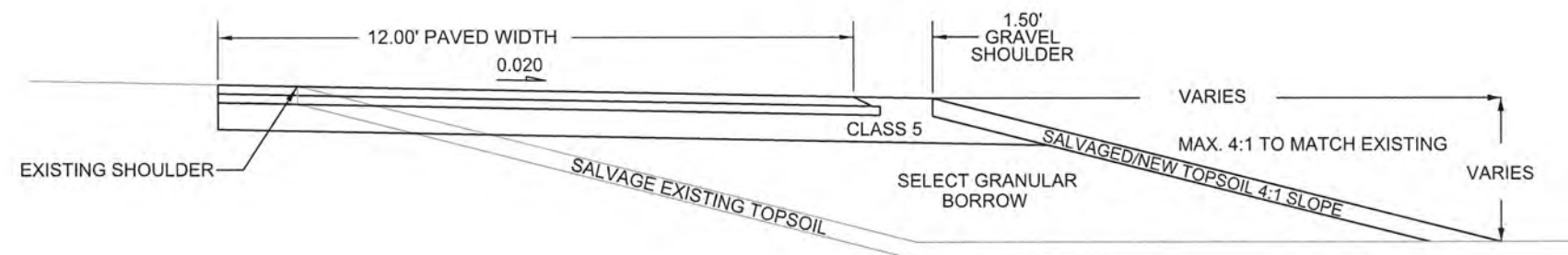

NO	DATE	BY	CKD	APPR	REVISION	DATE	TIME
						03/30/2017	11:44:26 AM

NAME: P:\17-01-00\CSAH_26_(CR15-CR85)\Base\PROPOSED\PROPOSED-2d.dgn

I HEREBY CERTIFY THAT THIS PLAN WAS PREPARED BY ME OR UNDER MY DIRECT SUPERVISION AND THAT I AM A DULY LICENSED PROFESSIONAL ENGINEER UNDER THE LAWS OF THE STATE OF MINNESOTA.

PRINT NAME: JOSEPH J. MACPHERSON
 SIGNATURE: *[Signature]*
 DATE: 3-30-17 LICENSE NO. 46732

DRAWN BY: SPH DATE: 01/13/2017
 DESIGN BY: SPH DATE: 01/13/2017
 CHECKED BY: MJJ DATE: 03/08/2017



**ANOKA COUNTY
HIGHWAY DEPT.**

STATE AID PROJECT 002-626-006

TYPICAL SECTIONS
 Sheet 4 of 25 Sheets

MAINLINE JOINT DETAIL (RECLAIM)

PLAN VIEW

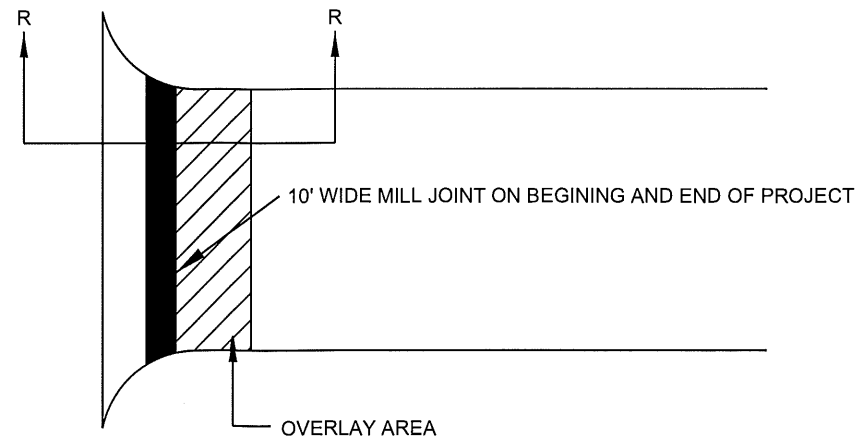

SECTION R - R

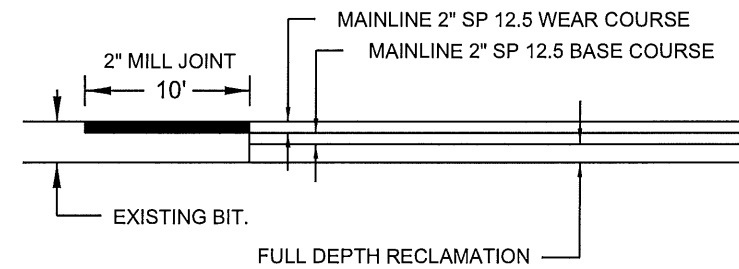

STREET APPROACH DETAIL

BITUMINOUS STREET

PLAN VIEW

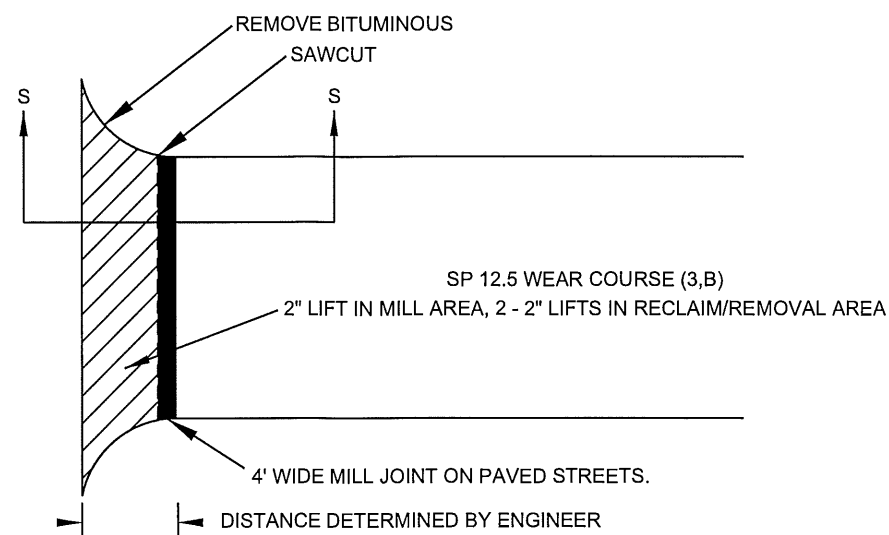

SECTION S - S

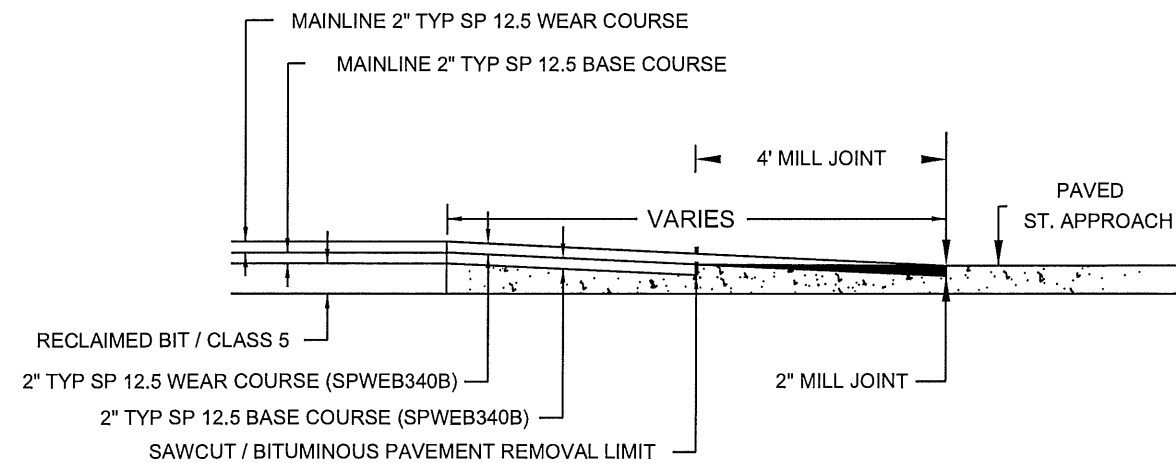

NO	DATE	BY	CKD	APPR	REVISION	03/08/2017	2:28:44 PM
NAME: P:\17-01-00\CSAH_26_(CR15-CR85)\Base\PROPOSED\PROPOSED-2d.dgn							

I HEREBY CERTIFY THAT THIS PLAN WAS PREPARED BY ME OR UNDER MY DIRECT SUPERVISION AND THAT I AM A DULY LICENSED PROFESSIONAL ENGINEER UNDER THE LAWS OF THE STATE OF MINNESOTA.

PRINT NAME: MATTHEW J. JOHN

SIGNATURE: *[Signature]*

DATE: 3/8/2017 LICENSE NO. 51639

DRAWN BY SPH DATE 01/13/2017

DESIGN BY SPH DATE 01/13/2017

CHECKED BY MJJ DATE 03/08/2017



ANOKA COUNTY
HIGHWAY DEPT.

STATE AID PROJECT 002-626-006

DETAILS

Sheet 5 of 25 Sheets

DRIVEWAY DETAIL
GRAVEL / FIELD ENTRANCE

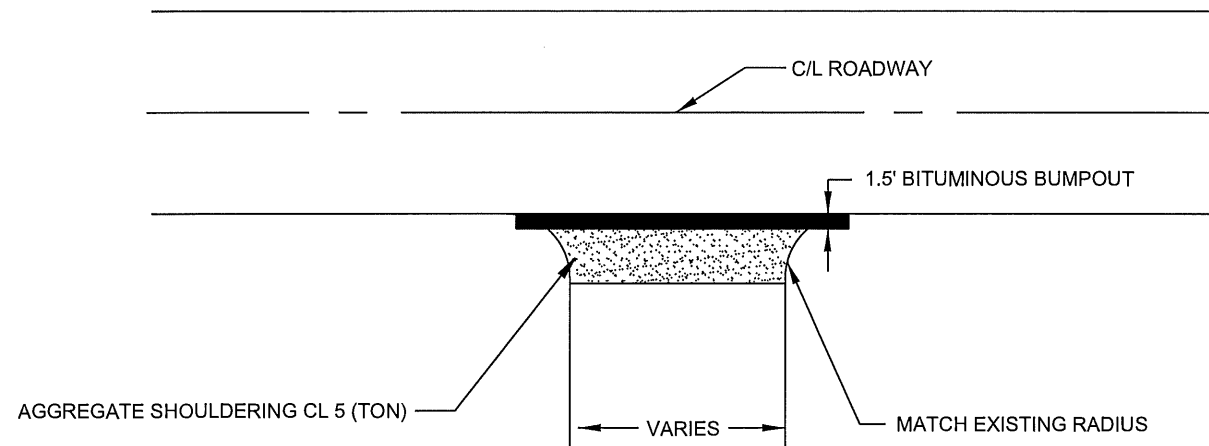

DRIVEWAY DETAIL
BITUMINOUS DRIVEWAY

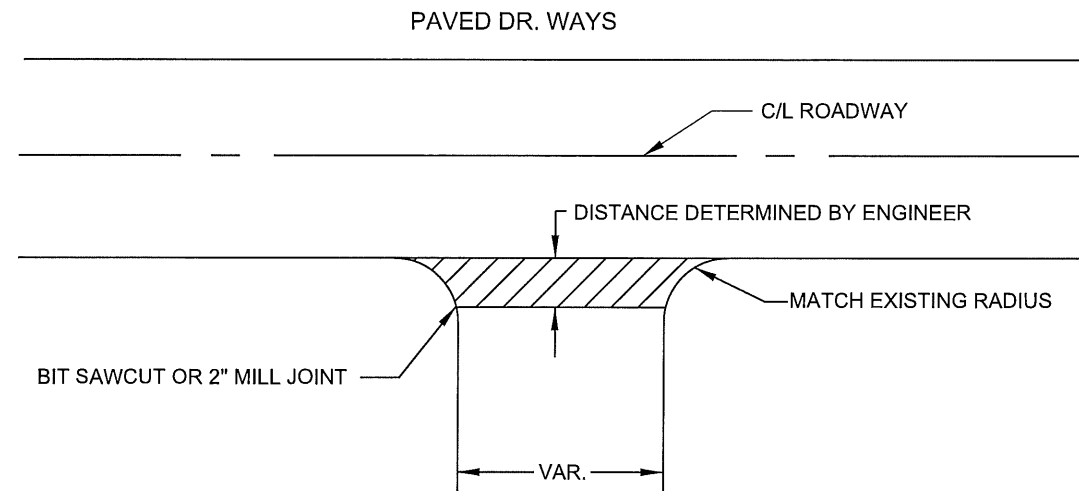

DRIVEWAYS BUMPOUT AND PAVED WITH MAINLINE PAID AS MAINLINE.
DRIVEWAYS PAVED IN DIFFERENT OPERATION FROM MAIN LINE PAVING PAID AS DRIVEWAY OR STREET APPROACH.

SHOULDER DETAIL
BITUMINOUS SAFETY EDGE
GRAVEL SHOULDER

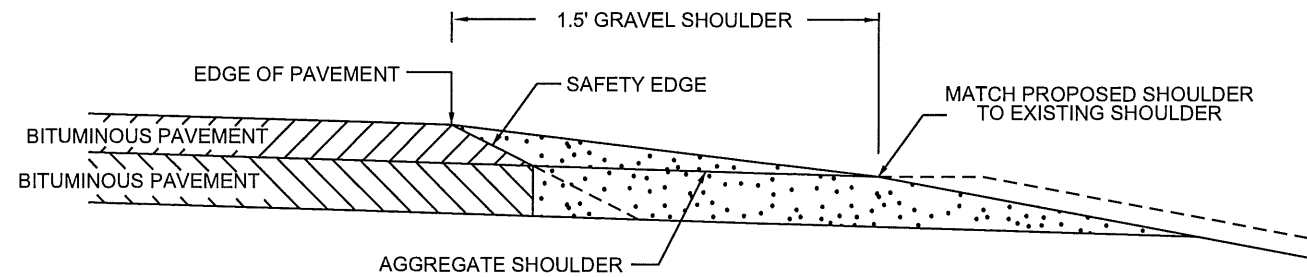

SAFETY EDGE TO BE USED IN ALL NON-CURB AREAS ON SHOULDER.

OPTIONAL DESIGN EXTENDS SAFETY EDGE DEEPER THAN 6" AND WIDER THAN 10.5". SEE SPECIAL PROVISIONS.

NO	DATE	BY	CKD	APPR	REVISION	03/08/2017	2:28:48 PM
NAME: P:\17-01-00\CSAH_26_(CR15-CR85)\Base\PROPOSED\PROPOSED-2d.dgn							

I HEREBY CERTIFY THAT THIS PLAN WAS PREPARED BY ME OR UNDER MY DIRECT SUPERVISION AND THAT I AM A DULY LICENSED PROFESSIONAL ENGINEER UNDER THE LAWS OF THE STATE OF MINNESOTA.
 PRINT NAME: MATTHEW J. JOHN
 SIGNATURE: *[Signature]*
 DATE: 3/8/2017 LICENSE NO. 51639

DRAWN BY: SPH DATE: 01/13/2017
 DESIGN BY: SPH DATE: 01/13/2017
 CHECKED BY: MJJ DATE: 03/08/2017



ANOKA COUNTY
HIGHWAY DEPT.

STATE AID PROJECT 002-626-006

DETAILS
Sheet 6 of 25 Sheets

spn005

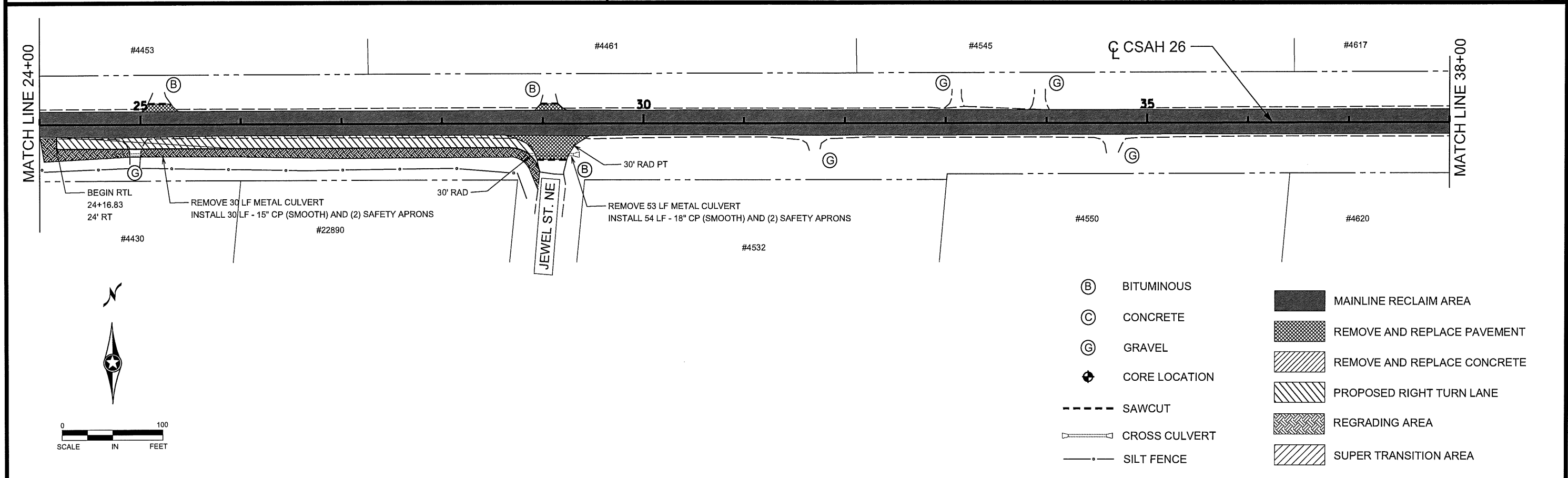
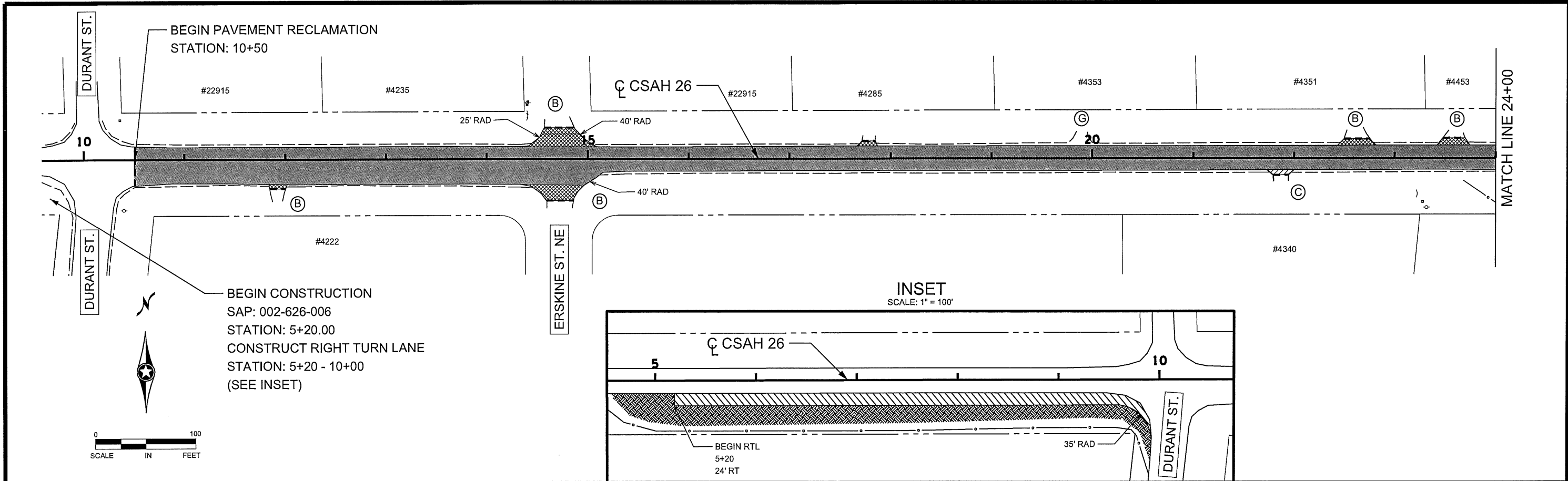

NO	DATE	BY	CKD	APPR	REVISION	03/08/2017	2:28:54 PM

NAME: P:\17-01-00\CSAH_26_(CR15-CR85)\Base\PROPOSED\PROPOSED-2d.dgn

I HEREBY CERTIFY THAT THIS PLAN WAS PREPARED BY ME OR UNDER MY DIRECT SUPERVISION AND THAT I AM A DULY LICENSED PROFESSIONAL ENGINEER UNDER THE LAWS OF THE STATE OF MINNESOTA.

PRINT NAME: MATTHEW J. JOHN

SIGNATURE: *Matthew J. John*

DATE: 3/8/2017 LICENSE NO. 51639

DRAWN BY SPH DATE 01/13/2017

DESIGN BY SPH DATE 01/13/2017

CHECKED BY MJJ DATE 03/08/2017

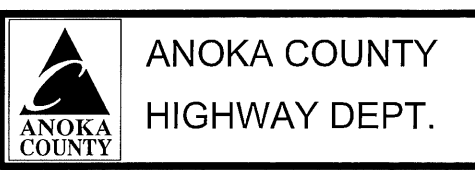

STATE AID PROJECT 002-626-006

CONSTRUCTION PLAN

STA 5+20 TO 42+00

Sheet 7 of 25 Sheets

spheacs

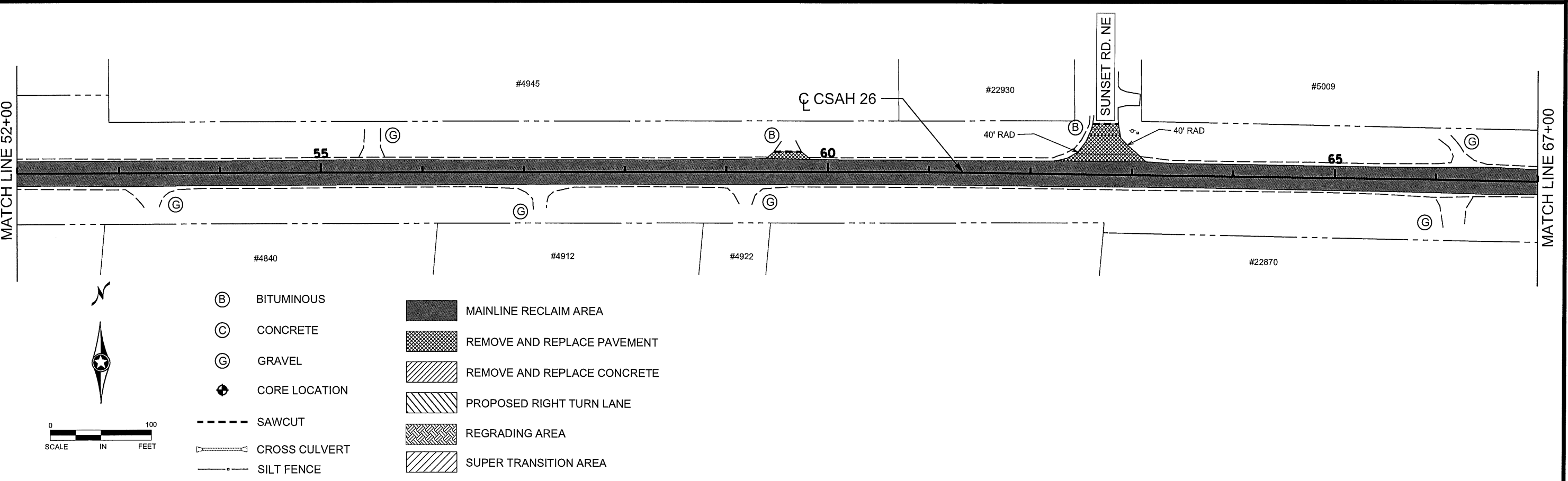
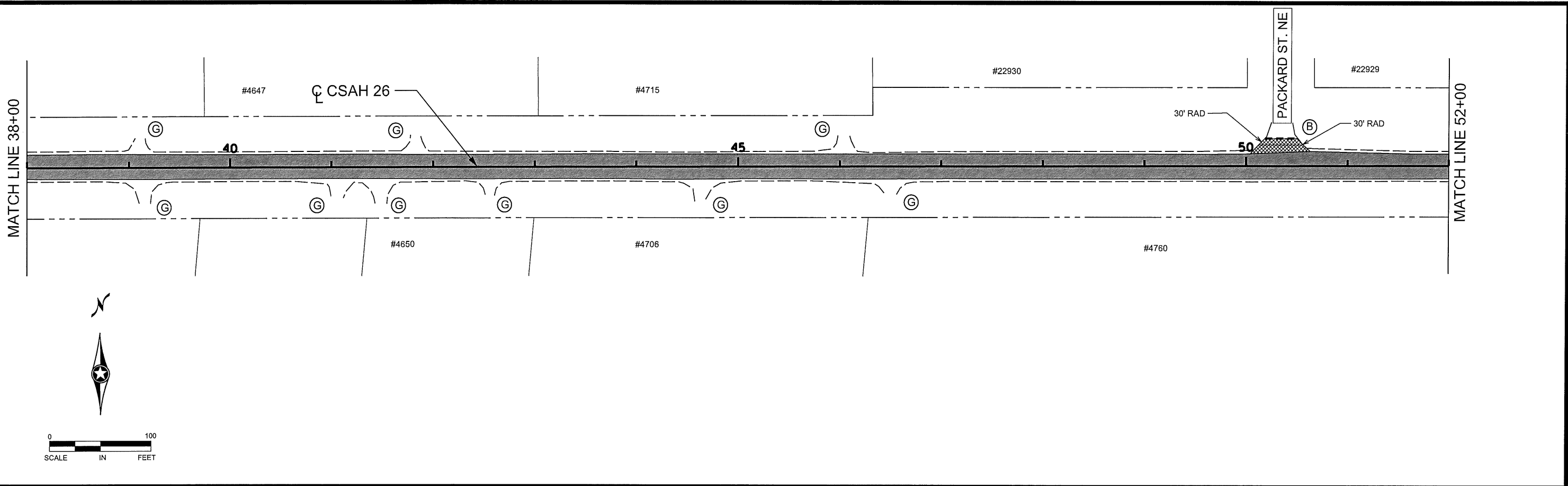

- (B) BITUMINOUS
- (C) CONCRETE
- (G) GRAVEL
- ⊕ CORE LOCATION
- SAWCUT
- ⌞ CROSS CULVERT
- SILT FENCE
- MAINLINE RECLAIM AREA
- ▨ REMOVE AND REPLACE PAVEMENT
- ▧ REMOVE AND REPLACE CONCRETE
- ▩ PROPOSED RIGHT TURN LANE
- REGRADING AREA
- SUPER TRANSITION AREA

NO	DATE	BY	CKD	APPR	REVISION	03/08/2017	2:29:00 PM
NAME: P:\17-01-00\CSAH_26_(CR15-CR85)\Base\PROPOSED\PROPOSED-2.dgn							

I HEREBY CERTIFY THAT THIS PLAN WAS PREPARED BY ME OR UNDER MY DIRECT SUPERVISION AND THAT I AM A DULY LICENSED PROFESSIONAL ENGINEER UNDER THE LAWS OF THE STATE OF MINNESOTA.

PRINT NAME: MATTHEW J. JOHN

SIGNATURE: *Matthew J. John*

DATE: 3/8/2017 LICENSE NO. 51939

DRAWN BY: SPH DATE: 01/13/2017

DESIGN BY: SPH DATE: 01/13/2017

CHECKED BY: MJJ DATE: 03/08/2017

ANOKA COUNTY
HIGHWAY DEPT.

STATE AID PROJECT 002-626-006

CONSTRUCTION PLAN

STA 42+00 TO 70+00

Sheet 8 of 25 Sheets

spheacs

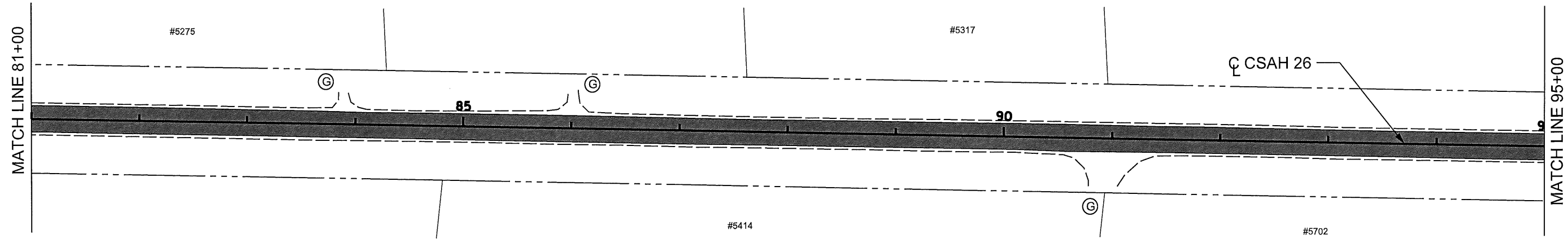
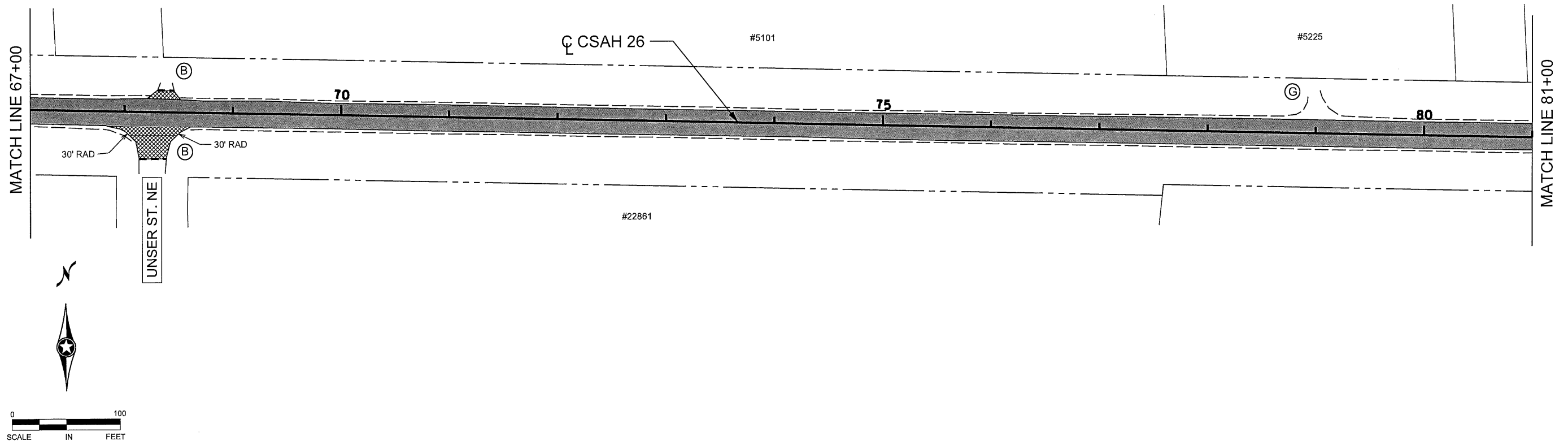

- Ⓟ BITUMINOUS
- Ⓢ CONCRETE
- Ⓤ GRAVEL
- ⊕ CORE LOCATION
- SAWCUT
- ⌒ CROSS CULVERT
- SILT FENCE
- MAINLINE RECLAIM AREA
- ▨ REMOVE AND REPLACE PAVEMENT
- ▧ REMOVE AND REPLACE CONCRETE
- ▩ PROPOSED RIGHT TURN LANE
- ▤ REGRADING AREA
- ▦ SUPER TRANSITION AREA

NO	DATE	BY	CKD	APPR	REVISION	

NAME: P:\17-01-00\CSAH_26_(CR15-CR85)\Base\PROPOSED\PROPOSED-2d.dgn

I HEREBY CERTIFY THAT THIS PLAN WAS PREPARED BY ME OR UNDER MY DIRECT SUPERVISION AND THAT I AM A DULY LICENSED PROFESSIONAL ENGINEER UNDER THE LAWS OF THE STATE OF MINNESOTA.

PRINT NAME: MATTHEW J. JOHN
 SIGNATURE: *[Signature]*
 DATE: 3/8/2017 LICENSE NO. 51639

DRAWN BY SPH DATE 01/13/2017
 DESIGN BY SPH DATE 01/13/2017
 CHECKED BY MJJ DATE 03/08/2017

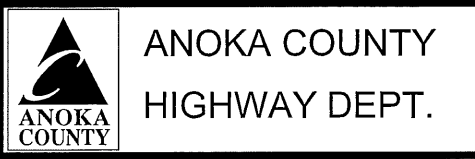

STATE AID PROJECT 002-626-006

CONSTRUCTION PLAN
 STA 70+00 TO 98+00
 Sheet 9 of 25 Sheets

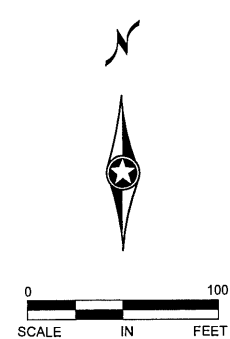
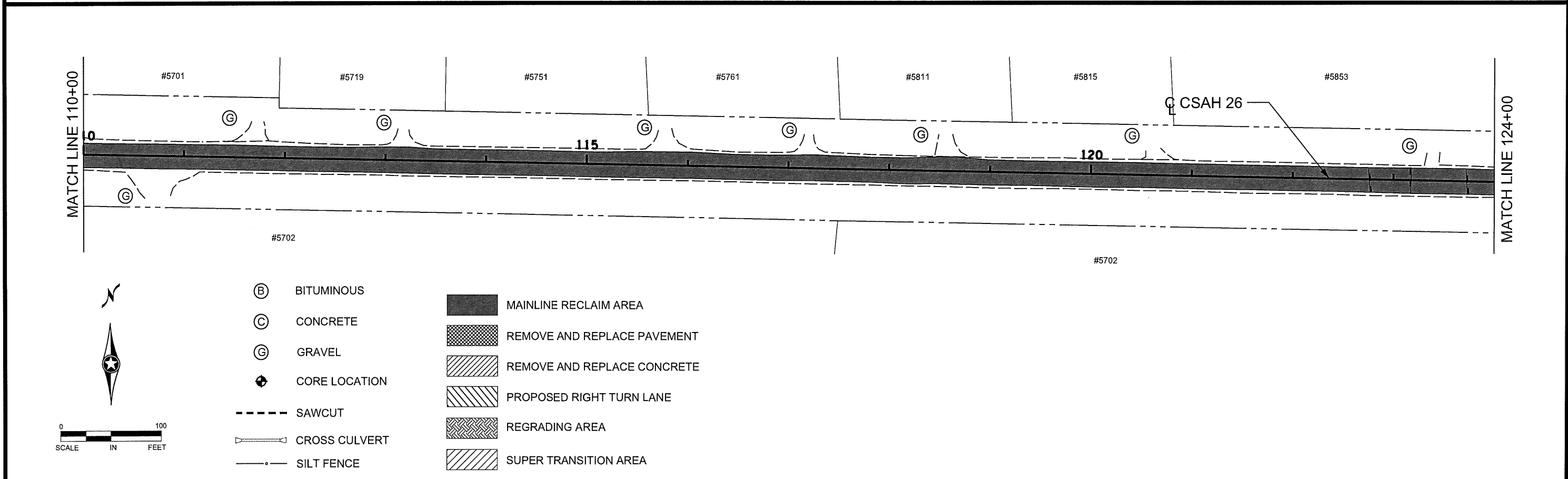
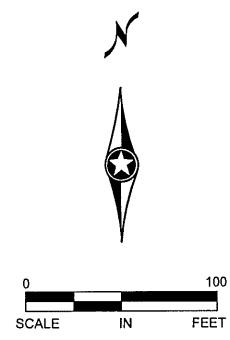
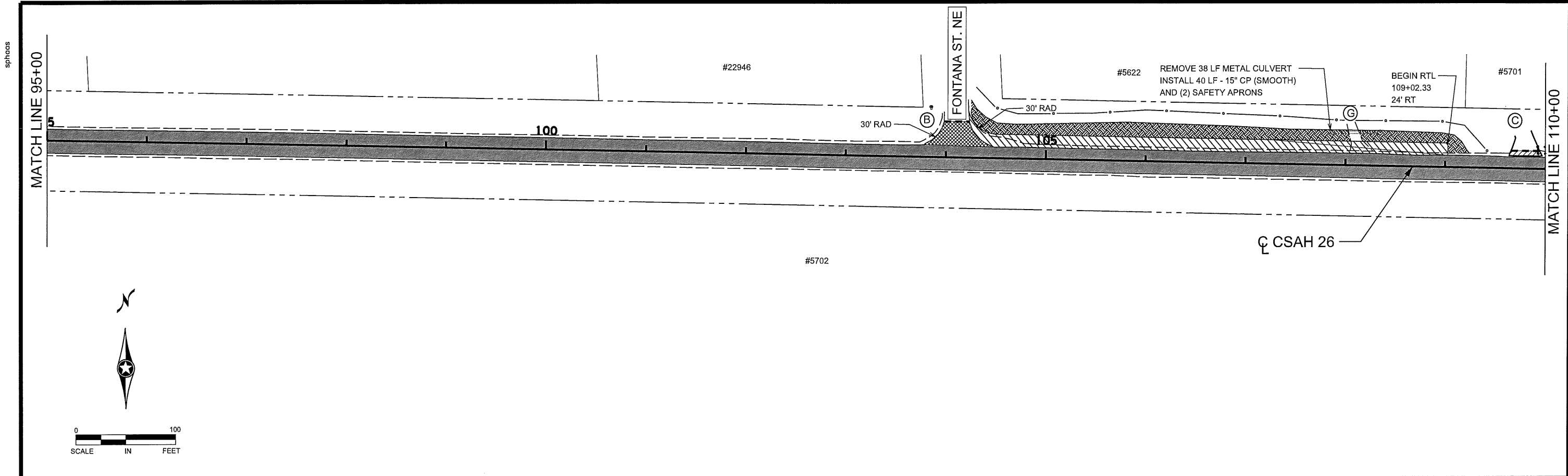

- (B) BITUMINOUS
- (C) CONCRETE
- (G) GRAVEL
- ⊕ CORE LOCATION
- SAWCUT
- +— CROSS CULVERT
- SILT FENCE
- MAINLINE RECLAIM AREA
- ▨ REMOVE AND REPLACE PAVEMENT
- ▧ REMOVE AND REPLACE CONCRETE
- ▩ PROPOSED RIGHT TURN LANE
- REGRADING AREA
- SUPER TRANSITION AREA

NO	DATE	BY	CKD	APPR	REVISION	03/08/2017	2:29:09 PM

NAME: P:\17-01-00\CSAH_26_(CR15-CR85)\Base\PROPOSED\PROPOSED-2d.dgn

I HEREBY CERTIFY THAT THIS PLAN WAS PREPARED BY ME OR UNDER MY DIRECT SUPERVISION AND THAT I AM A DULY LICENSED PROFESSIONAL ENGINEER UNDER THE LAWS OF THE STATE OF MINNESOTA.

PRINT NAME: MATTHEW J. JOHN

SIGNATURE: *Matthew J. John*

DATE: 3/8/2017 LICENSE NO. 51639

DRAWN BY: SPH DATE: 01/13/2017

DESIGN BY: SPH DATE: 01/13/2017

CHECKED BY: MJJ DATE: 03/08/2017

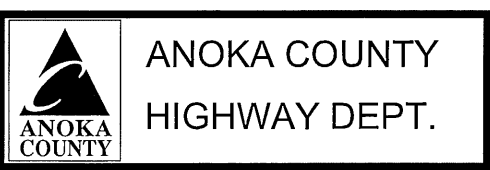

STATE AID PROJECT 002-626-006

CONSTRUCTION PLAN

STA 98+00 TO 127+00

Sheet 10 of 25 Sheets

M.John

MATCH LINE 124+00

#5915

#5961

#6005

125

PC STA: 126+77.42

ⓐ

ⓐ

ⓐ

130

#5702

135

#6075

ⓐ

ⓐ CSAH 26

PT STA: 139+29.38

MATCH LINE 140+00

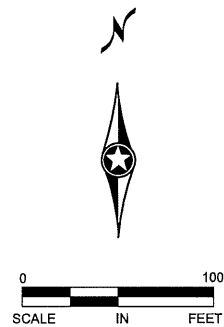

- ⓐ BITUMINOUS
- ⓐ CONCRETE
- ⓐ GRAVEL
- ⓐ CORE LOCATION
- SAWCUT
- CROSS CULVERT
- SILT FENCE
- █ MAINLINE RECLAIM AREA
- █ REMOVE AND REPLACE PAVEMENT
- █ REMOVE AND REPLACE CONCRETE
- █ PROPOSED RIGHT TURN LANE
- █ REGRADING AREA
- █ SUPER TRANSITION AREA

NO	DATE	BY	CKD	APPR	REVISION	03/23/2017	2:21:34 PM
NAME: P:\17-01-00\CSAH_26_(CR15-CR85)\Base\PROPOSED\PROPOSED-2d.dgn							

I HEREBY CERTIFY THAT THIS PLAN WAS PREPARED BY ME OR UNDER MY DIRECT SUPERVISION AND THAT I AM A DULY LICENSED PROFESSIONAL ENGINEER UNDER THE LAWS OF THE STATE OF MINNESOTA.

PRINT NAME: MATTHEW J. JOHN
 SIGNATURE: *[Signature]*
 DATE: 3/23/2017 LICENSE NO. 51839

DRAWN BY SPH DATE 01/13/2017
 DESIGN BY SPH DATE 01/13/2017
 CHECKED BY MJJ DATE 03/08/2017



ANOKA COUNTY
 HIGHWAY DEPT.

STATE AID PROJECT 002-626-006

CONSTRUCTION PLAN
 STA 127+00 TO 143+00
 Sheet 11 of 25 Sheets

M.John

MATCH LINE 140+00

#6075
 REMOVE 64 LF METAL CULVERT
 INSTALL 74 LF 48" RC PIPE CULVERT, DESIGN 3006 CL V AND (2) RC APRONS
 INSTALL GEOTEXTILE FILTER TYPE IV AND RIP RAP CL III

EXISTING / PROPOSED
 INV. ELEV.=897.56

PC STA: 143+40.27

EXISTING / PROPOSED
 INV. ELEV.=898.31

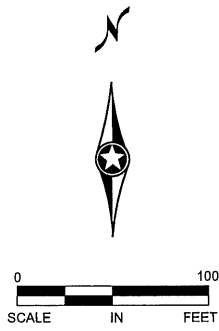

CSAH 26

#6245

150

#6275

#6311

MATCH LINE 156+00

155

#6230

#6256

#6306

- (B) BITUMINOUS
- (C) CONCRETE
- (G) GRAVEL
- ◆ CORE LOCATION
- - - SAWCUT
- ▤ CROSS CULVERT
- SILT FENCE
- MAINLINE RECLAIM AREA
- ▨ REMOVE AND REPLACE PAVEMENT
- ▧ REMOVE AND REPLACE CONCRETE
- ▩ PROPOSED RIGHT TURN LANE
- REGRADING AREA
- SUPER TRANSITION AREA

NO	DATE	BY	CKD	APPR	REVISION	
	03/23/2017					2:21:40 PM

NAME: P:\17-01-00\CSAH_26_(CR15-CR85)\Base\PROPOSED\PROPOSED-2d.dgn

I HEREBY CERTIFY THAT THIS PLAN WAS PREPARED BY ME OR UNDER MY DIRECT SUPERVISION AND THAT I AM A DULY LICENSED PROFESSIONAL ENGINEER UNDER THE LAWS OF THE STATE OF MINNESOTA.

PRINT NAME: MATTHEW J. JOHN
 SIGNATURE: *Matthew J. John*
 DATE: 3/23/2017 LICENSE NO. 51639

DRAWN BY: SPH DATE: 01/13/2017
 DESIGN BY: SPH DATE: 01/13/2017
 CHECKED BY: MJJ DATE: 03/08/2017



**ANOKA COUNTY
 HIGHWAY DEPT.**

STATE AID PROJECT 002-626-006

CONSTRUCTION PLAN
 STA 143+00 TO 159+00
 Sheet 12 of 25 Sheets

M.John

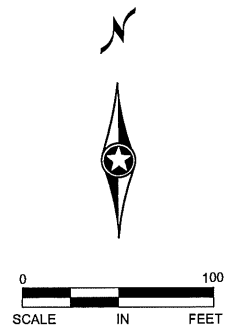
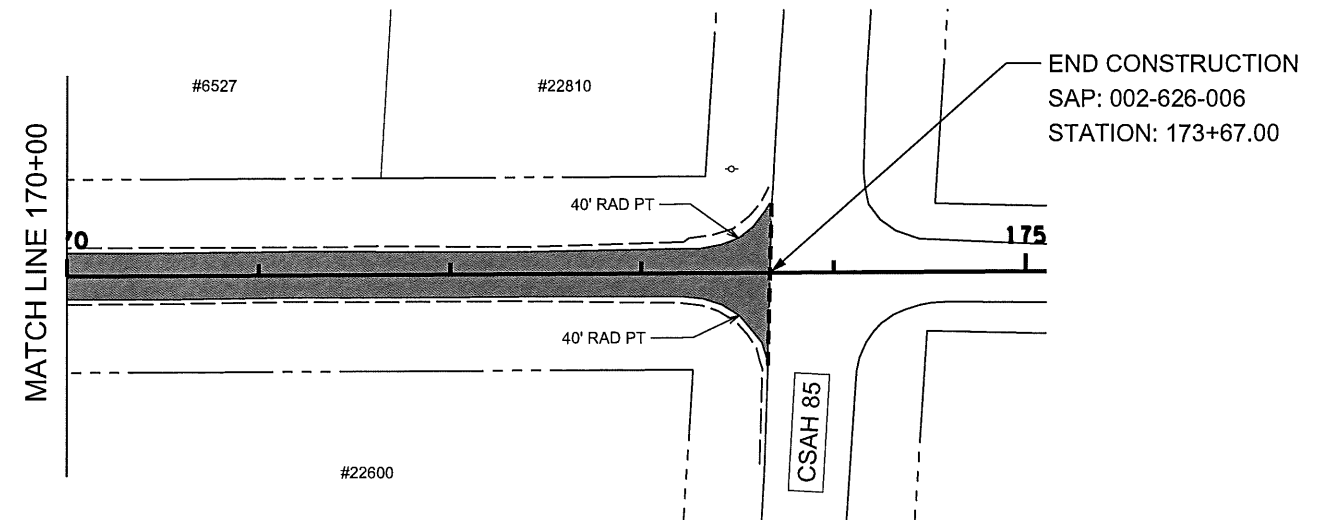
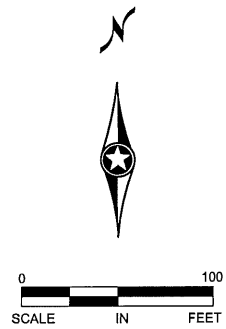
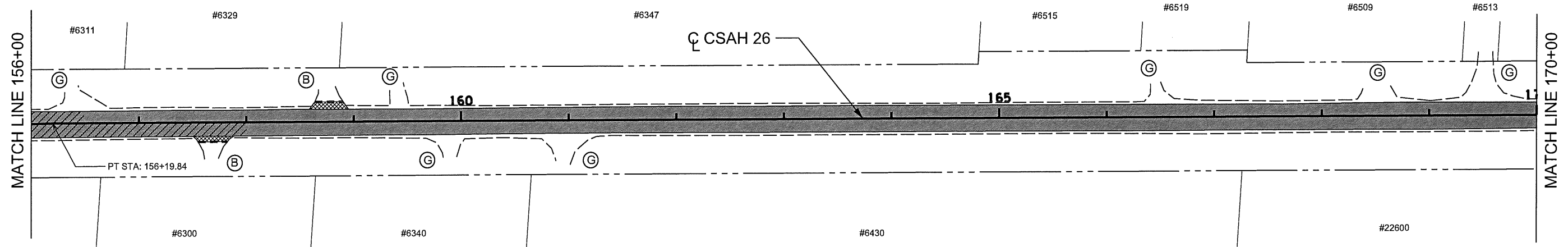

- (B) BITUMINOUS
- (C) CONCRETE
- (G) GRAVEL
- ⊕ CORE LOCATION
- SAWCUT
- CROSS CULVERT
- SILT FENCE
- █ MAINLINE RECLAIM AREA
- ▨ REMOVE AND REPLACE PAVEMENT
- ▧ REMOVE AND REPLACE CONCRETE
- ▩ PROPOSED RIGHT TURN LANE
- REGRADING AREA
- SUPER TRANSITION AREA

NO	DATE	BY	CKD	APPR	REVISION	DATE	TIME
						03/23/2017	2:21:51 PM

NAME: P:\17-01-00\CSAH_26_(CR15-CR85)\Base\PROPOSED\PROPOSED-2.dgn

I HEREBY CERTIFY THAT THIS PLAN WAS PREPARED BY ME OR UNDER MY DIRECT SUPERVISION AND THAT I AM A DULY LICENSED PROFESSIONAL ENGINEER UNDER THE LAWS OF THE STATE OF MINNESOTA.

PRINT NAME: MATTHEW J. JOHN

SIGNATURE: *Matthew J. John*

DATE: 3/23/2017 LICENSE NO. 51639

DRAWN BY SPH DATE 01/13/2017

DESIGN BY SPH DATE 01/13/2017

CHECKED BY MJJ DATE 03/08/2017

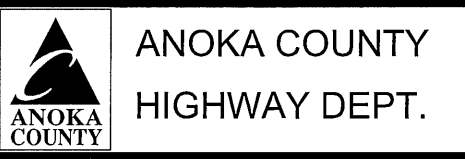

STATE AID PROJECT 002-626-006

CONSTRUCTION PLAN

STA 159+00 TO 173+67

Sheet 13 of 25 Sheets

PERMANENT PAVEMENT MARKING PLAN
NOTES AND GUIDELINES

GENERAL INFORMATION:

THE ENGINEER'S INVOLVEMENT IN THE APPLICATION OF THE MATERIAL SHALL BE LIMITED TO FIELD CONSULTATION AND INSPECTION. ANOKA COUNTY HIGHWAY DEPARTMENT WILL PLACE NECESSARY "SPOTTING" AT APPROPRIATE POINTS TO PROVIDE HORIZONTAL CONTROL FOR STRIPING AND TO DETERMINE NECESSARY STARTING AND CUTOFF POINTS, LONGITUDINAL JOINTS, PAVEMENT EDGES AND EXISTING MARKINGS MAY SERVE AS HORIZONTAL CONTROL WHEN SO DIRECTED.

EDGE LINES AND LANE LINES ARE TO BE BROKEN ONLY AT INTERSECTIONS WITH PUBLIC ROADS AND AT PRIVATE ENTRANCES IF THEY ARE CONTROLLED BY A YIELD SIGN, STOP SIGN OR TRAFFIC SIGNAL. THE BREAK POINT IS TO BE AT THE START OF THE RADIUS FOR THE INTERSECTION OR AT MARKED STOP LINES OR CROSSWALKS.

A TOLERANCE OF 1/4 INCH UNDER OR 1/4 INCH OVER THE SPECIFIED WIDTH WILL BE ALLOWED FOR STRIPING PROVIDED THE VARIATION IS GRADUAL AND DOES NOT DETRACT FROM THE GENERAL APPEARANCE. BROKEN LINE SEGMENTS MAY VARY UP TO ONE-HALF FOOT FROM THE SPECIFIED LENGTHS PROVIDED THE OVER AND UNDER VARIATIONS ARE REASONABLY COMPENSATORY. ALIGNMENT DEVIATIONS FROM THE CONTROL GUIDE SHALL NOT EXCEED 1 INCH. MATERIAL SHALL NOT BE APPLIED OVER LONGITUDINAL JOINTS, ESTABLISHMENT OF APPLICATION TOLERANCES SHALL NOT RELIEVE THE CONTRACTOR OF THEIR RESPONSIBILITY TO COMPLY AS CLOSELY AS PRACTICABLE WITH THE PLANNED DIMENSIONS.

EPOXY:

THE ROAD SURFACE SHALL BE CLEANED AT THE DIRECTION OF THE ENGINEER JUST PRIOR TO APPLICATION. PAVEMENT CLEANING SHALL CONSIST OF AT LEAST BRUSHING WITH A ROTARY BROOM (NON-METALLIC) OR AS RECOMMENDED BY THE MATERIAL MANUFACTURER AND ACCEPTABLE TO THE ENGINEER. NEW PORTLAND CEMENT CONCRETE SURFACES SHALL BE SANDBLAST CLEANED TO REMOVE ANY SURFACE TREATMENT AND/OR LAITANCE ON LOW SPEED (SPEED LIMIT 35 MPH OR LESS) URBAN PORTLAND CEMENT CONCRETE ROADWAYS. SANDBLAST CLEANING SHALL BE USED FOR ALL EPOXY PAVEMENT MARKINGS.

THE EPOXY MARKING APPLICATION SHALL IMMEDIATELY FOLLOW THE PAVEMENT CLEANING. GLASS BEANS SHALL BE APPLIED IMMEDIATELY AFTER APPLICATION OF THE EPOXY RESIN LINE TO PROVIDE AN IMMEDIATE NO-TRACK SYSTEM.

AN EPOLY RESIN LINE 4" WIDE AND 15 MILL THICKNESS (WET), REQUIRES AN APPLICATION RATE OF ONE (1) GALLON OF COMPONENTS FOR 320 FEET OF LINE. GLASS BEADS SHALL BE APPLIED AT A POUND PER GALLON RATE SUFFICIENT TO ACHIEVE AN ACCEPTABLE NO-TRACK SYSTEM.

OPERATIONS SHALL BE CONDUCTED ONLY WHEN THE ROAD PAVEMENT SURFACE TEMPERATURES ARE 50 DEGREES FAHRENHEIT OR GREATER.

PERMANENT PAVEMENT MARKINGS SHALL NOT BE PLACED OVER TEMPORARY TAPE MARKINGS.

PREFORMED THERMOPLASTIC:

THE PREFORMED THERMOPLASTIC MARKINGS SHALL BE APPLIED IN ACCORDANCE WITH THE MANUFACTURER'S RECOMMENDATIONS ON CLEAN AND DRY SURFACES. SEE SPECIAL PROVISIONS FOR PREFORMED THERMOPLASTIC MARKING SPECIFICATIONS.

PAINT:

AT THE TIME OF APPLYING THE MARKING MATERIAL, THE APPLICATION AREA SHALL BE FREE OF CONTAMINATION. THE CONTRACTOR SHALL CLEAN THE ROADWAY SURFACE PRIOR TO THE LINE APPLICATION IN A MANNER AND TO THE EXTENT REQUIRED BY THE ENGINEER.

GLASS BEADS SHALL BE APPLIED IMMEDIATELY AFTER APPLICATION OF THE PAINT LINE.

EXCEPT WHEN USED AS A TEMPORARY MARKING, PAVEMENT MARKINGS SHALL ONLY BE APPLIED IN SEASONABLE WEATHER WHEN AIR TEMPERATURE IS 50 DEGREES FARHENHEIT OR HIGHER AND SHALL NOT BE APPLIED WHEN THE WIND OR OTHER CONDITIONS CAUSE A FILM OR DUST TO BE DEPOSITED ON THE PAVEMENT SURFACE AFTER CLEANING AND BEFORE THE MARKING MATERIAL CAN BE APPLIED.

THE FILLING OF TANKS, POURING OF MATERIALS OR CLEANING OF EQUIPMENT SHALL NOT BE PERFORMED ON UNPROTECTED PAVEMENT SURFACES UNLESS ADEQUATE PROVISIONS ARE MADE TO PREVENT SPILLAGE OF MATERIAL.

PERMANENT MARKING QUANTITIES		
ITEM	UNIT	TOTAL QUANTITY
4" SOLID LINE WHITE - EPOXY PAINT	LIN FT	34300
4" SOLID LINE YELLOW - EPOXY PAINT	LIN FT	4950
4" BROKEN LINE YELLOW - EPOXY PAINT	LIN FT	2770
4" DOUBLE SOLID LINE YELLOW - EPOXY PAINT	LIN FT	2590

SYMBOLS & MATERIALS LEGEND

■ CROSSWALK BLOCK WHITE PREFORMED THERMOPLASTIC

↩ PAVEMENT MESSAGE (LEFT ARROW) PREFORMED THERMOPLASTIC

STRIPING KEY

○ CIRCLE - EPOXY □ SQUARE PREFORMED THERMOPLASTIC

△ TRIANGLE - PAINT

⬠ PENTAGON - REMOVABLE PREFORMED PLASTIC MARKING

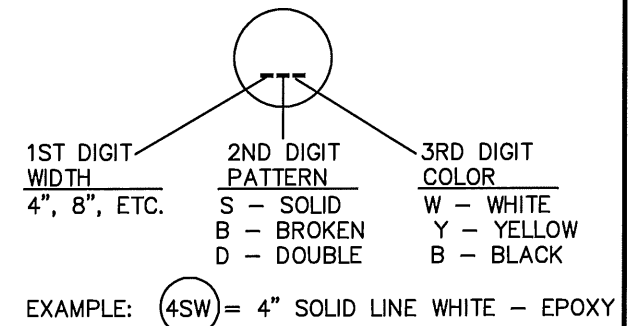

NO	DATE	BY	CKD	APPR	REVISION

NAME: P:\13-01-00\CSAH 18\Baset\TRAFFIC\Perm pvmt mkg guide notes_guidelines.dwg

I HEREBY CERTIFY THAT THIS PLAN WAS PREPARED BY ME OR UNDER MY DIRECT SUPERVISION AND THAT I AM A DULY LICENSED PROFESSIONAL ENGINEER UNDER THE LAWS OF THE STATE OF MINNESOTA.
 PRINT NAME: MATTHEW J. JOHN
 SIGNATURE: *[Signature]*
 DATE: 3/8/2017 LICENSE NO. 51639

DRAWN BY: RLB DATE: 1/30/17
 DESIGN BY: RLB DATE: 1/30/17
 CHECKED BY: JR DATE: 1/30/17



ANOKA COUNTY
HIGHWAY DEPT.

STATE PROJECT NO. _____
 STATE AID PROJECT NO. 002-626-006
 STATE AID PROJECT NO. _____
 COUNTY PROJECT NO. _____

PERMANENT MARKING TABULATION
 Sheet 14 of 25 Sheets

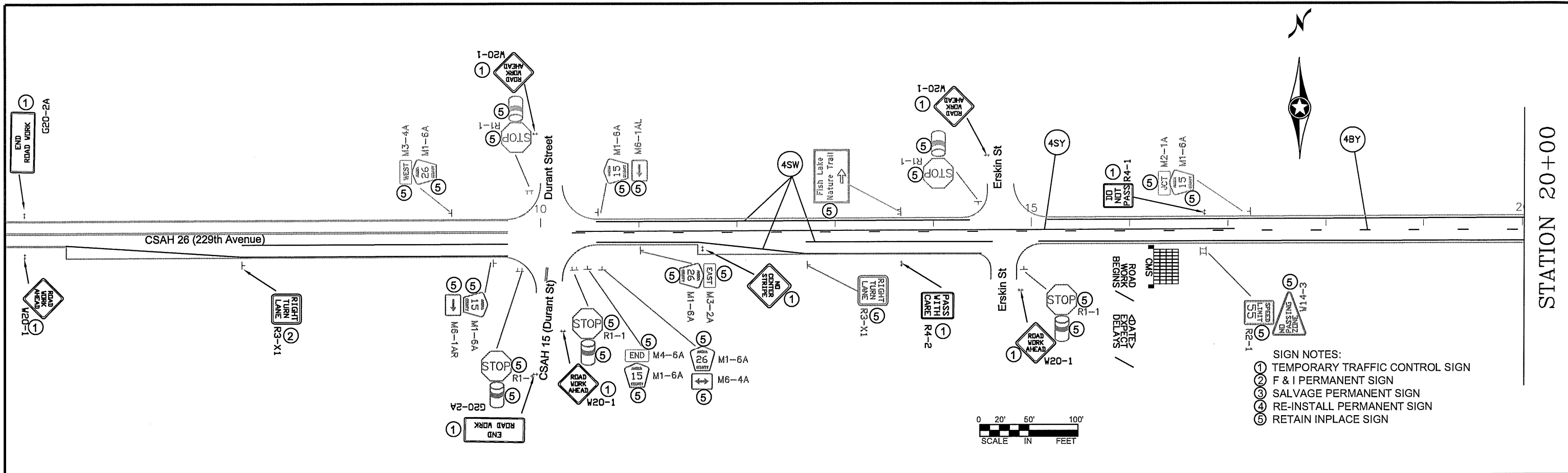

- SIGN NOTES:
- ① TEMPORARY TRAFFIC CONTROL SIGN
 - ② F & I PERMANENT SIGN
 - ③ SALVAGE PERMANENT SIGN
 - ④ RE-INSTALL PERMANENT SIGN
 - ⑤ RETAIN INPLACE SIGN

- NOTES:
- ALL TRAFFIC CONTROL DEVICES SHALL CONFORM AND BE PLACED IN ACCORDANCE TO THE "MINNESOTA MANUAL ON UNIFORM TRAFFIC CONTROL DEVICES" (MN MUTCD), INCLUDING PART VI, "FIELD MANUAL FOR TEMPORARY TRAFFIC CONTROL ZONE LAYOUTS".
 - CONTRACTOR SHALL COMPLY WITH THE LONGITUDINAL DROP-OFF GUIDELINES AS PER THE FIELD MANUAL.
 - LOCATIONS OF PAVEMENT MARKINGS ARE APPROXIMATE. EXACT LOCATIONS WILL BE DETERMINED IN THE FIELD BY THE ENGINEER.
 - CONTRACTOR SHALL SUPPLY AND INSTALL THE PORTABLE CHANGEABLE MESSAGE SIGN (CMS) A MINIMUM OF SEVEN DAYS PRIOR TO ACTUAL COMMENCEMENT OF ROAD WORK, TO A LOCATION AS SPECIFIED BY THE ENGINEER. SIGNS TO BE REMOVED WHEN ROAD WORK BEGINS. PAYMENT SHALL BE MADE AS PER ITEM 2563.613 PORTABLE CHANGEABLE MESSAGE SIGN BY THE UNIT/DAY.
 - CONTRACTOR SHALL SUPPLY AND ERECT THE TEMPORARY TRAFFIC CONTROL SIGNS AS SHOWN ON THIS DRAWING AND DETAILED IN THE SPECIAL PROVISIONS FROM THE TIME WORK COMMENCES ON THIS ROADWAY UNTIL THIS ROADWAY IS PERMANENTLY STRIPED. ALL NECESSARY TEMPORARY TRAFFIC CONTROL SIGNS SHALL BE PAID FOR AS PART OF TRAFFIC CONTROL LUMP SUM.
 - ALL PERMANENT STRIPING AND PAVEMENT MESSAGES SHALL BE PLACED WITHIN 72 HOURS OF MAINLINE PAVING.
 - ANY REQUIRED PERMANENT SIGNING SHALL BE INSTALLED THE SAME DAY AS PERMANENT STRIPING
 - ALL EXISTING SIGNING SHALL REMAIN IN PLACE DURING CONSTRUCTION. ALL SALVAGED AND REINSTALLED SIGNS SHALL BE INSTALLED ON TEMPORARY SUPPORTS UNTIL THE PERMANENT INSTALLATION CAN BE MADE. THIS WILL BE CONSIDERED AS INCIDENTAL TO INSTALL SIGN TYPE C.

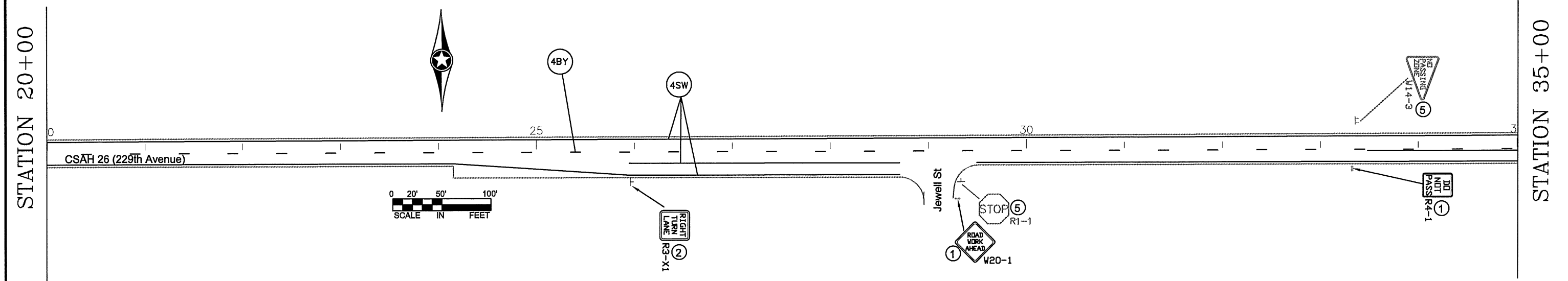

NO	DATE	BY	CKD	APPR	REVISION

NAME: P:\16-01-00\CR 26\base\Traffic\Signing_Striping.dwg

I HEREBY CERTIFY THAT THIS PLAN WAS PREPARED BY ME OR UNDER MY DIRECT SUPERVISION AND THAT I AM A DULY REGISTERED PROFESSIONAL ENGINEER UNDER THE LAWS OF THE STATE OF MINNESOTA.

PRINT NAME: MATTHEW J. JOHN

SIGNATURE: *Matthew J. John*

DATE: 3/8/2017 REG. NO. 51639

DRAWN BY: RLB DATE: 2/27/17

DESIGN BY: RLB DATE: 2/27/17

CHECKED BY: JR DATE: 2/27/17

ANOKA COUNTY
HIGHWAY DEPT.

STATE PROJECT NO. _____

STATE AID PROJECT NO. 002-626-006

STATE AID PROJECT NO. _____

COUNTY PROJECT NO. _____

TEMPORARY SIGNING,
PERMANENT SIGNING
AND STRIPING

Sheet 15 of 25 Sheets

- SIGN NOTES:
- ① TEMPORARY TRAFFIC CONTROL SIGN
 - ② F & I PERMANENT SIGN
 - ③ SALVAGE PERMANENT SIGN
 - ④ RE-INSTALL PERMANENT SIGN
 - ⑤ RETAIN INPLACE SIGN

STATION 35+00

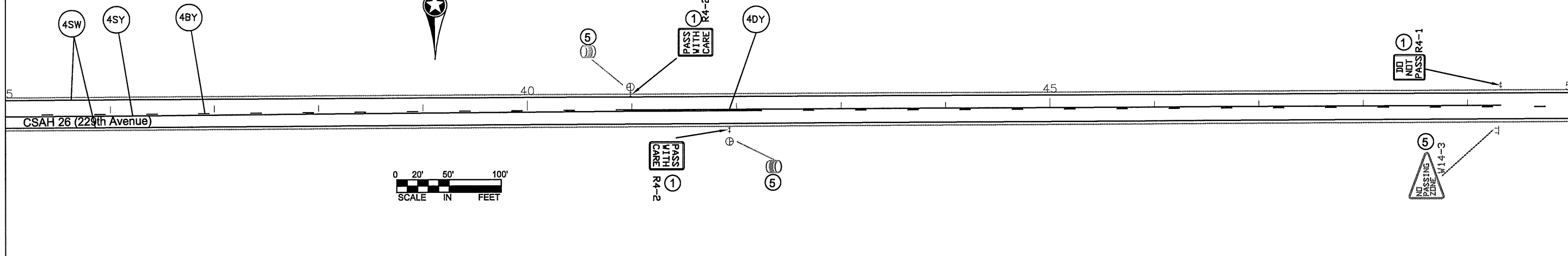

STATION 50+00

NOTES:

- ALL TRAFFIC CONTROL DEVICES SHALL CONFORM AND BE PLACED IN ACCORDANCE TO THE "MINNESOTA MANUAL ON UNIFORM TRAFFIC CONTROL DEVICES" (MN MUTCD), INCLUDING PART VI, "FIELD MANUAL FOR TEMPORARY TRAFFIC CONTROL ZONE LAYOUTS".
- CONTRACTOR SHALL COMPLY WITH THE LONGITUDINAL DROP-OFF GUIDELINES AS PER THE FIELD MANUAL.
- LOCATIONS OF PAVEMENT MARKINGS ARE APPROXIMATE. EXACT LOCATIONS WILL BE DETERMINED IN THE FIELD BY THE ENGINEER.
- CONTRACTOR SHALL SUPPLY AND INSTALL THE PORTABLE CHANGEABLE MESSAGE SIGN (CMS) A MINIMUM OF SEVEN DAYS PRIOR TO ACTUAL COMMENCEMENT OF ROAD WORK, TO A LOCATION AS SPECIFIED BY THE ENGINEER. SIGNS TO BE REMOVED WHEN ROAD WORK BEGINS. PAYMENT SHALL BE MADE AS PER ITEM 2563.613 PORTABLE CHANGEABLE MESSAGE SIGN BY THE UNIT/DAY.
- CONTRACTOR SHALL SUPPLY AND ERECT THE TEMPORARY TRAFFIC CONTROL SIGNS AS SHOWN ON THIS DRAWING AND DETAILED IN THE SPECIAL PROVISIONS FROM THE TIME WORK COMMENCES ON THIS ROADWAY UNTIL THIS ROADWAY IS PERMANENTLY STRIPED. ALL NECESSARY TEMPORARY TRAFFIC CONTROL SIGNS SHALL BE PAID FOR AS PART OF TRAFFIC CONTROL LUMP SUM.
- ALL PERMANENT STRIPING AND PAVEMENT MESSAGES SHALL BE PLACED WITHIN 72 HOURS OF MAINLINE PAVING.
- ANY REQUIRED PERMANENT SIGNING SHALL BE INSTALLED THE SAME DAY AS PERMANENT STRIPING
- ALL EXISTING SIGNING SHALL REMAIN IN PLACE DURING CONSTRUCTION. ALL SALVAGED AND REINSTALLED SIGNS SHALL BE INSTALLED ON TEMPORARY SUPPORTS UNTIL THE PERMANENT INSTALLATION CAN BE MADE. THIS WILL BE CONSIDERED AS INCIDENTAL TO INSTALL SIGN TYPE C.

STATION 50+00

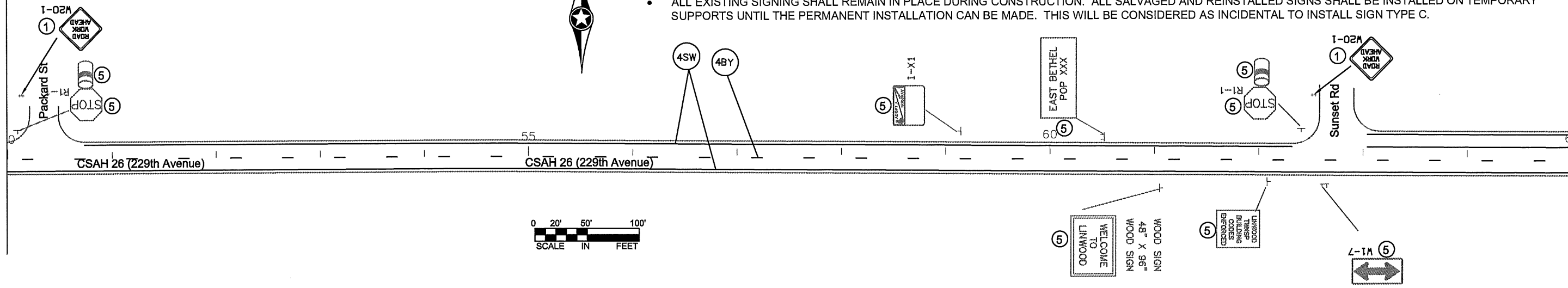

STATION 65+00

NO	DATE	BY	CKD	APPR	REVISION

NAME: P:\16-01-00\CR 26\base\Traffic\Signing_Striping.dwg

I HEREBY CERTIFY THAT THIS PLAN WAS PREPARED BY ME OR UNDER MY DIRECT SUPERVISION AND THAT I AM A DULY REGISTERED PROFESSIONAL ENGINEER UNDER THE LAWS OF THE STATE OF MINNESOTA.

PRINT NAME: MATTHEW J. JOHN

SIGNATURE: *Matthew J. John*

DATE: 3/8/2017 REG. NO. 51639

DRAWN BY: RLB DATE: 2/27/17

DESIGN BY: RLB DATE: 2/27/17

CHECKED BY: JR DATE: 2/27/17



ANOKA COUNTY
HIGHWAY DEPT.

STATE PROJECT NO. _____

STATE AID PROJECT NO. 002-626-006

STATE AID PROJECT NO. _____

COUNTY PROJECT NO. _____

TEMPORARY SIGNING,
PERMANENT SIGNING
AND STRIPING

Sheet 16 of 25 Sheets

STATION 65+00

STATION 80+00

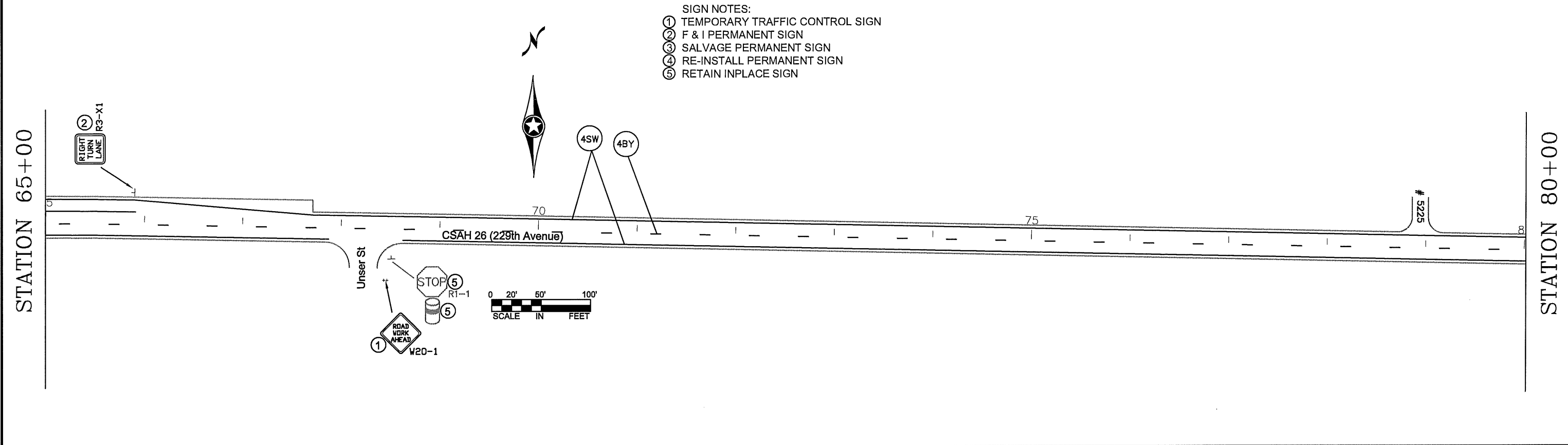

STATION 80+00

STATION 95+00

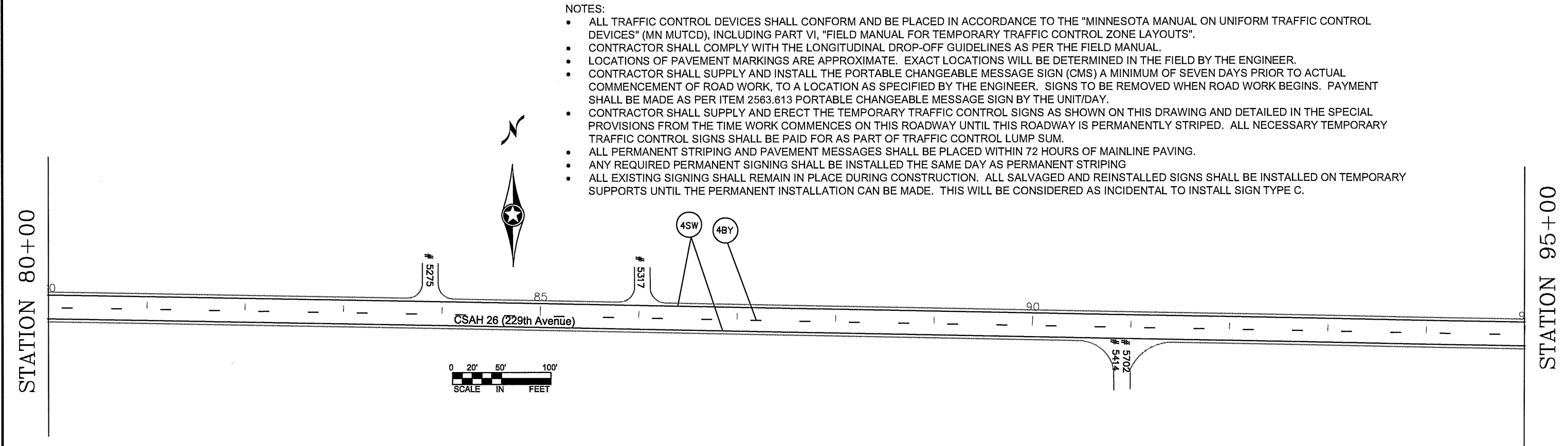

- SIGN NOTES:
- ① TEMPORARY TRAFFIC CONTROL SIGN
 - ② F & I PERMANENT SIGN
 - ③ SALVAGE PERMANENT SIGN
 - ④ RE-INSTALL PERMANENT SIGN
 - ⑤ RETAIN INPLACE SIGN

NOTES:

- ALL TRAFFIC CONTROL DEVICES SHALL CONFORM AND BE PLACED IN ACCORDANCE TO THE "MINNESOTA MANUAL ON UNIFORM TRAFFIC CONTROL DEVICES" (MN MUTCD), INCLUDING PART VI, "FIELD MANUAL FOR TEMPORARY TRAFFIC CONTROL ZONE LAYOUTS".
- CONTRACTOR SHALL COMPLY WITH THE LONGITUDINAL DROP-OFF GUIDELINES AS PER THE FIELD MANUAL.
- LOCATIONS OF PAVEMENT MARKINGS ARE APPROXIMATE. EXACT LOCATIONS WILL BE DETERMINED IN THE FIELD BY THE ENGINEER.
- CONTRACTOR SHALL SUPPLY AND INSTALL THE PORTABLE CHANGEABLE MESSAGE SIGN (CMS) A MINIMUM OF SEVEN DAYS PRIOR TO ACTUAL COMMENCEMENT OF ROAD WORK, TO A LOCATION AS SPECIFIED BY THE ENGINEER. SIGNS TO BE REMOVED WHEN ROAD WORK BEGINS. PAYMENT SHALL BE MADE AS PER ITEM 2563.613 PORTABLE CHANGEABLE MESSAGE SIGN BY THE UNIT/DAY.
- CONTRACTOR SHALL SUPPLY AND ERECT THE TEMPORARY TRAFFIC CONTROL SIGNS AS SHOWN ON THIS DRAWING AND DETAILED IN THE SPECIAL PROVISIONS FROM THE TIME WORK COMMENCES ON THIS ROADWAY UNTIL THIS ROADWAY IS PERMANENTLY STRIPED. ALL NECESSARY TEMPORARY TRAFFIC CONTROL SIGNS SHALL BE PAID FOR AS PART OF TRAFFIC CONTROL LUMP SUM.
- ALL PERMANENT STRIPING AND PAVEMENT MESSAGES SHALL BE PLACED WITHIN 72 HOURS OF MAINLINE PAVING.
- ANY REQUIRED PERMANENT SIGNING SHALL BE INSTALLED THE SAME DAY AS PERMANENT STRIPING
- ALL EXISTING SIGNING SHALL REMAIN IN PLACE DURING CONSTRUCTION. ALL SALVAGED AND REINSTALLED SIGNS SHALL BE INSTALLED ON TEMPORARY SUPPORTS UNTIL THE PERMANENT INSTALLATION CAN BE MADE. THIS WILL BE CONSIDERED AS INCIDENTAL TO INSTALL SIGN TYPE C.

NO	DATE	BY	CKD	APPR	REVISION

I HEREBY CERTIFY THAT THIS PLAN WAS PREPARED BY ME OR UNDER MY DIRECT SUPERVISION AND THAT I AM A DULY REGISTERED PROFESSIONAL ENGINEER UNDER THE LAWS OF THE STATE OF MINNESOTA.

PRINT NAME: MATTHEW J. JOHN

SIGNATURE: *Matthew J. John*

DATE: 3/8/2017 REG. NO. 51639

DRAWN BY: RLB DATE: 2/27/17

DESIGN BY: RLB DATE: 2/27/17

CHECKED BY: JR DATE: 2/27/17

ANOKA COUNTY
HIGHWAY DEPT.



STATE PROJECT NO. _____

STATE AID PROJECT NO. 002-626-006

STATE AID PROJECT NO. _____

COUNTY PROJECT NO. _____

STATION 95+00

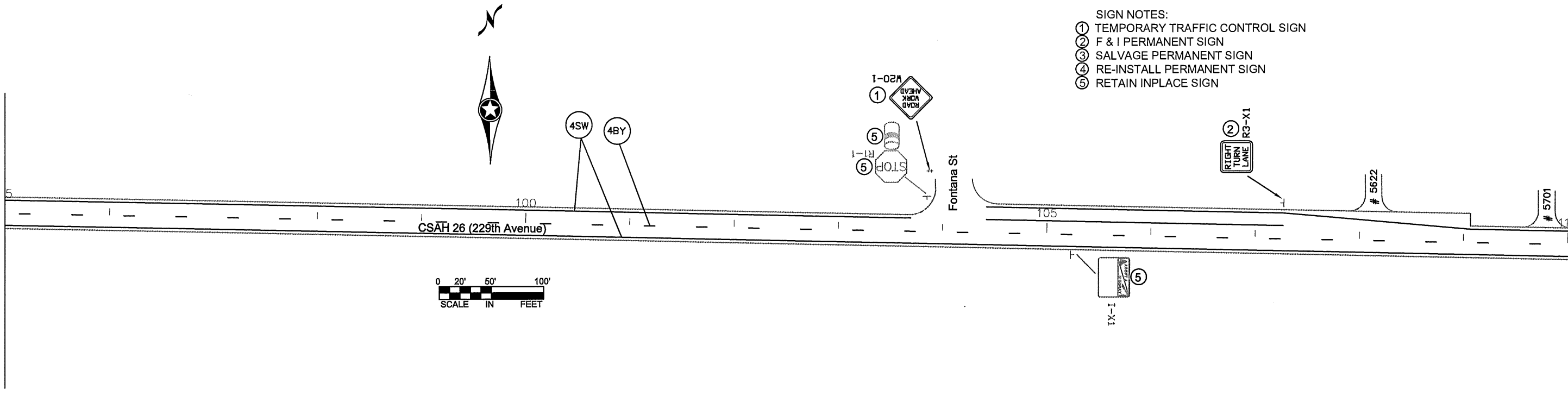

STATION 110+00

NOTES:

- ALL TRAFFIC CONTROL DEVICES SHALL CONFORM AND BE PLACED IN ACCORDANCE TO THE "MINNESOTA MANUAL ON UNIFORM TRAFFIC CONTROL DEVICES" (MN MUTCD), INCLUDING PART VI, "FIELD MANUAL FOR TEMPORARY TRAFFIC CONTROL ZONE LAYOUTS".
- CONTRACTOR SHALL COMPLY WITH THE LONGITUDINAL DROP-OFF GUIDELINES AS PER THE FIELD MANUAL.
- LOCATIONS OF PAVEMENT MARKINGS ARE APPROXIMATE. EXACT LOCATIONS WILL BE DETERMINED IN THE FIELD BY THE ENGINEER.
- CONTRACTOR SHALL SUPPLY AND INSTALL THE PORTABLE CHANGEABLE MESSAGE SIGN (CMS) A MINIMUM OF SEVEN DAYS PRIOR TO ACTUAL COMMENCEMENT OF ROAD WORK, TO A LOCATION AS SPECIFIED BY THE ENGINEER. SIGNS TO BE REMOVED WHEN ROAD WORK BEGINS. PAYMENT SHALL BE MADE AS PER ITEM 2563.613 PORTABLE CHANGEABLE MESSAGE SIGN BY THE UNIT/DAY.
- CONTRACTOR SHALL SUPPLY AND ERECT THE TEMPORARY TRAFFIC CONTROL SIGNS AS SHOWN ON THIS DRAWING AND DETAILED IN THE SPECIAL PROVISIONS FROM THE TIME WORK COMMENCES ON THIS ROADWAY UNTIL THIS ROADWAY IS PERMANENTLY STRIPED. ALL NECESSARY TEMPORARY TRAFFIC CONTROL SIGNS SHALL BE PAID FOR AS PART OF TRAFFIC CONTROL LUMP SUM.
- ALL PERMANENT STRIPING AND PAVEMENT MESSAGES SHALL BE PLACED WITHIN 72 HOURS OF MAINLINE PAVING.
- ANY REQUIRED PERMANENT SIGNING SHALL BE INSTALLED THE SAME DAY AS PERMANENT STRIPING
- ALL EXISTING SIGNING SHALL REMAIN IN PLACE DURING CONSTRUCTION. ALL SALVAGED AND REINSTALLED SIGNS SHALL BE INSTALLED ON TEMPORARY SUPPORTS UNTIL THE PERMANENT INSTALLATION CAN BE MADE. THIS WILL BE CONSIDERED AS INCIDENTAL TO INSTALL SIGN TYPE C.

STATION 110+00

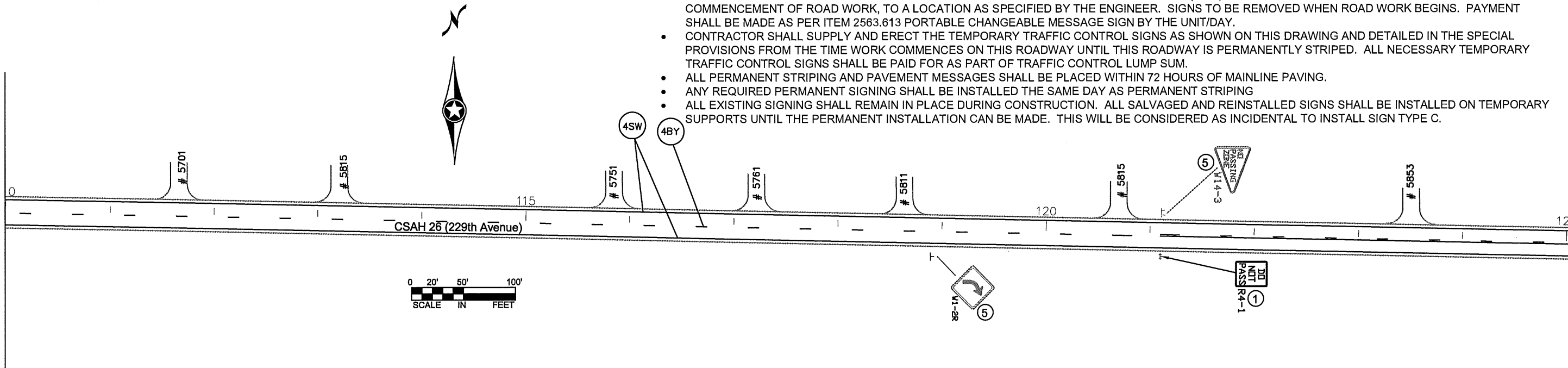

STATION 125+00

NO	DATE	BY	CKD	APPR	REVISION

I HEREBY CERTIFY THAT THIS PLAN WAS PREPARED BY ME OR UNDER MY DIRECT SUPERVISION AND THAT I AM A DULY REGISTERED PROFESSIONAL ENGINEER UNDER THE LAWS OF THE STATE OF MINNESOTA.
 PRINT NAME: MATTHEW J. JOHN
 SIGNATURE: *[Signature]*
 DATE: 3/8/2017 REG. NO. 51639

DRAWN BY: RLB DATE: 2/27/17
 DESIGN BY: RLB DATE: 2/27/17
 CHECKED BY: JR DATE: 2/27/17



ANOKA COUNTY
 HIGHWAY DEPT.

STATE PROJECT NO. _____
 STATE AID PROJECT NO. 002-626-006
 STATE AID PROJECT NO. _____
 COUNTY PROJECT NO. _____

TEMPORARY SIGNING,
 PERMANENT SIGNING
 AND STRIPING
 Sheet 18 of 25 Sheets

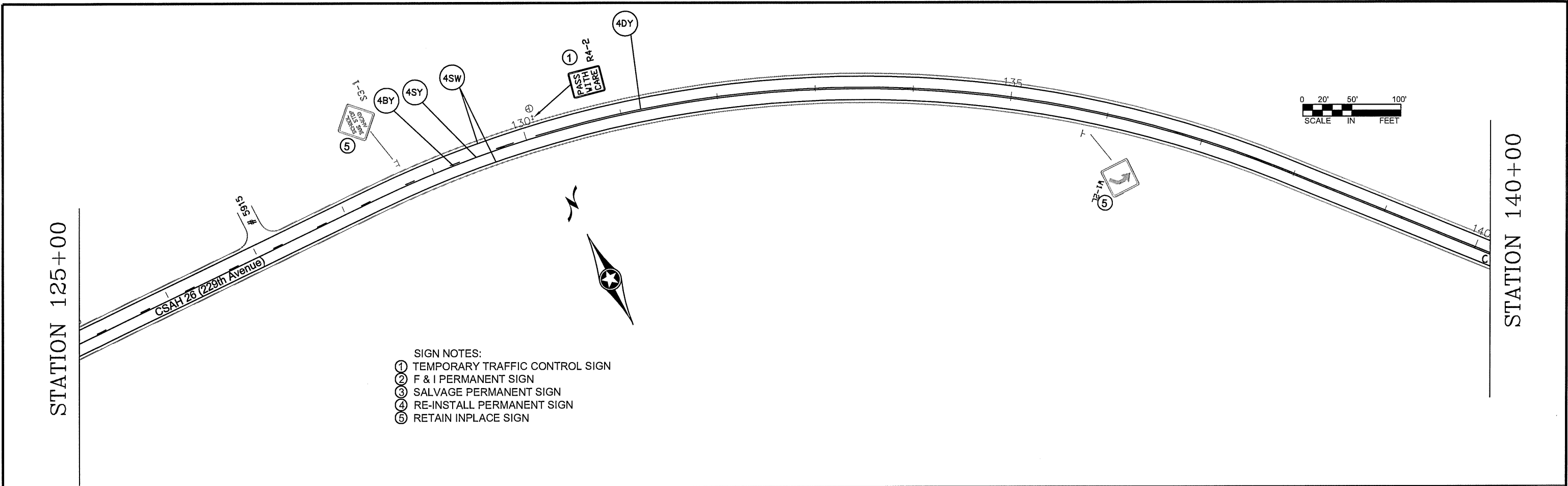

- SIGN NOTES:
- ① TEMPORARY TRAFFIC CONTROL SIGN
 - ② F & I PERMANENT SIGN
 - ③ SALVAGE PERMANENT SIGN
 - ④ RE-INSTALL PERMANENT SIGN
 - ⑤ RETAIN INPLACE SIGN

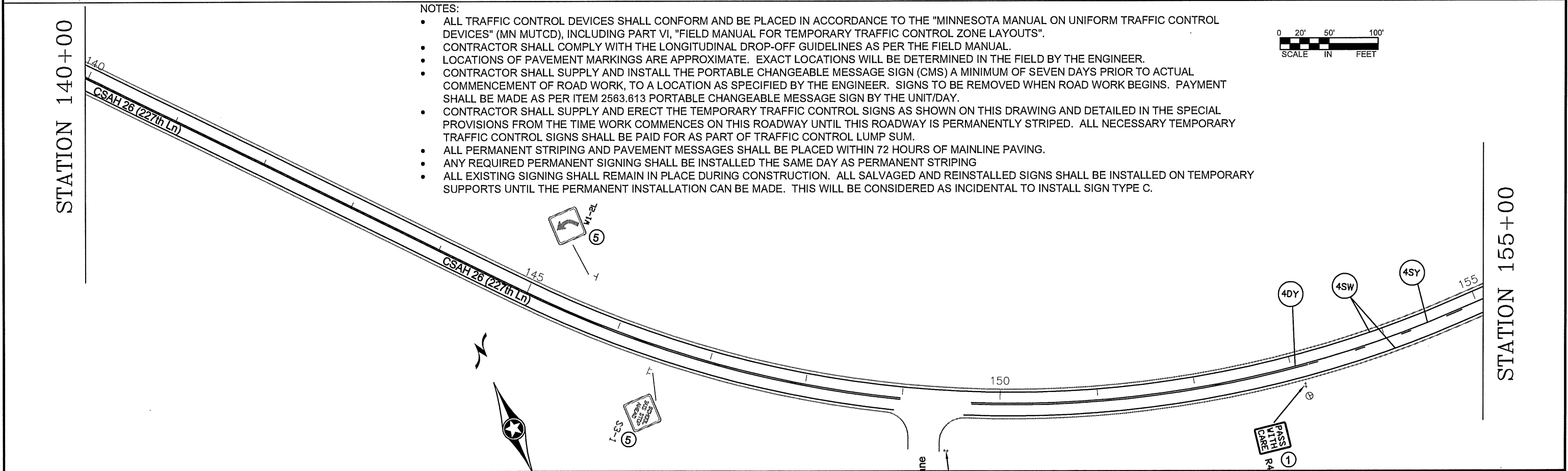

NOTES:

- ALL TRAFFIC CONTROL DEVICES SHALL CONFORM AND BE PLACED IN ACCORDANCE TO THE "MINNESOTA MANUAL ON UNIFORM TRAFFIC CONTROL DEVICES" (MN MUTCD), INCLUDING PART VI, "FIELD MANUAL FOR TEMPORARY TRAFFIC CONTROL ZONE LAYOUTS".
- CONTRACTOR SHALL COMPLY WITH THE LONGITUDINAL DROP-OFF GUIDELINES AS PER THE FIELD MANUAL.
- LOCATIONS OF PAVEMENT MARKINGS ARE APPROXIMATE. EXACT LOCATIONS WILL BE DETERMINED IN THE FIELD BY THE ENGINEER.
- CONTRACTOR SHALL SUPPLY AND INSTALL THE PORTABLE CHANGEABLE MESSAGE SIGN (CMS) A MINIMUM OF SEVEN DAYS PRIOR TO ACTUAL COMMENCEMENT OF ROAD WORK, TO A LOCATION AS SPECIFIED BY THE ENGINEER. SIGNS TO BE REMOVED WHEN ROAD WORK BEGINS. PAYMENT SHALL BE MADE AS PER ITEM 2563.613 PORTABLE CHANGEABLE MESSAGE SIGN BY THE UNIT/DAY.
- CONTRACTOR SHALL SUPPLY AND ERECT THE TEMPORARY TRAFFIC CONTROL SIGNS AS SHOWN ON THIS DRAWING AND DETAILED IN THE SPECIAL PROVISIONS FROM THE TIME WORK COMMENCES ON THIS ROADWAY UNTIL THIS ROADWAY IS PERMANENTLY STRIPED. ALL NECESSARY TEMPORARY TRAFFIC CONTROL SIGNS SHALL BE PAID FOR AS PART OF TRAFFIC CONTROL LUMP SUM.
- ALL PERMANENT STRIPING AND PAVEMENT MESSAGES SHALL BE PLACED WITHIN 72 HOURS OF MAINLINE PAVING.
- ANY REQUIRED PERMANENT SIGNING SHALL BE INSTALLED THE SAME DAY AS PERMANENT STRIPING
- ALL EXISTING SIGNING SHALL REMAIN IN PLACE DURING CONSTRUCTION. ALL SALVAGED AND REINSTALLED SIGNS SHALL BE INSTALLED ON TEMPORARY SUPPORTS UNTIL THE PERMANENT INSTALLATION CAN BE MADE. THIS WILL BE CONSIDERED AS INCIDENTAL TO INSTALL SIGN TYPE C.

NO	DATE	BY	CKD	APPR	REVISION

I HEREBY CERTIFY THAT THIS PLAN WAS PREPARED BY ME OR UNDER MY DIRECT SUPERVISION AND THAT I AM A DULY REGISTERED PROFESSIONAL ENGINEER UNDER THE LAWS OF THE STATE OF MINNESOTA.

PRINT NAME: MATTHEW J. JOHN
 SIGNATURE: *Matthew J. John*
 DATE: 3/8/2017 REG. NO. 51639

DRAWN BY: RLB DATE: 2/27/17
 DESIGN BY: RLB DATE: 2/27/17
 CHECKED BY: JR DATE: 2/27/17

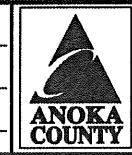

ANOKA COUNTY
 HIGHWAY DEPT.

STATE PROJECT NO. _____
 STATE AID PROJECT NO. 002-626-006
 STATE AID PROJECT NO. _____
 COUNTY PROJECT NO. _____

TEMPORARY SIGNING,
 PERMANENT SIGNING
 AND STRIPING

Sheet 19 of 25 Sheets

STATION 155+00

STATION 170+00

- SIGN NOTES:
- ① TEMPORARY TRAFFIC CONTROL SIGN
 - ② F & I PERMANENT SIGN
 - ③ SALVAGE PERMANENT SIGN
 - ④ RE-INSTALL PERMANENT SIGN
 - ⑤ RETAIN INPLACE SIGN

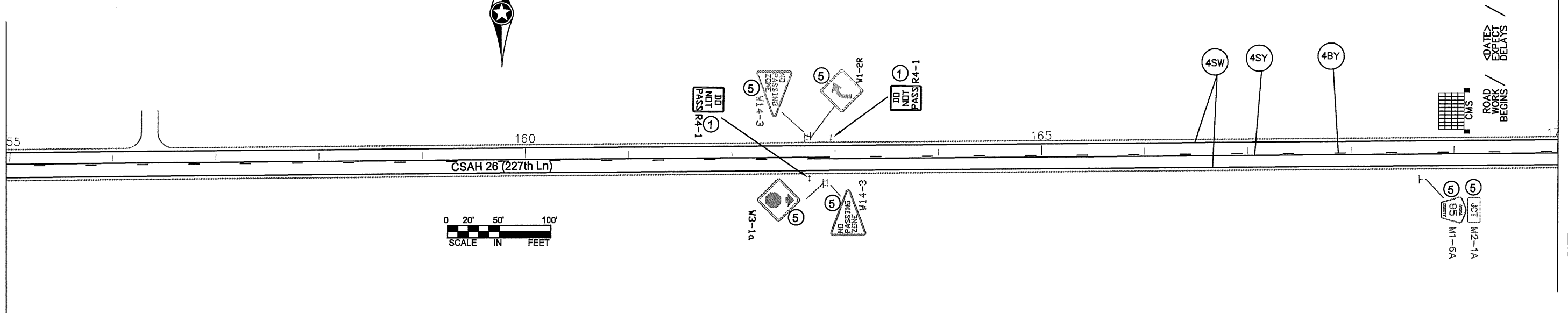

STATION 170+00

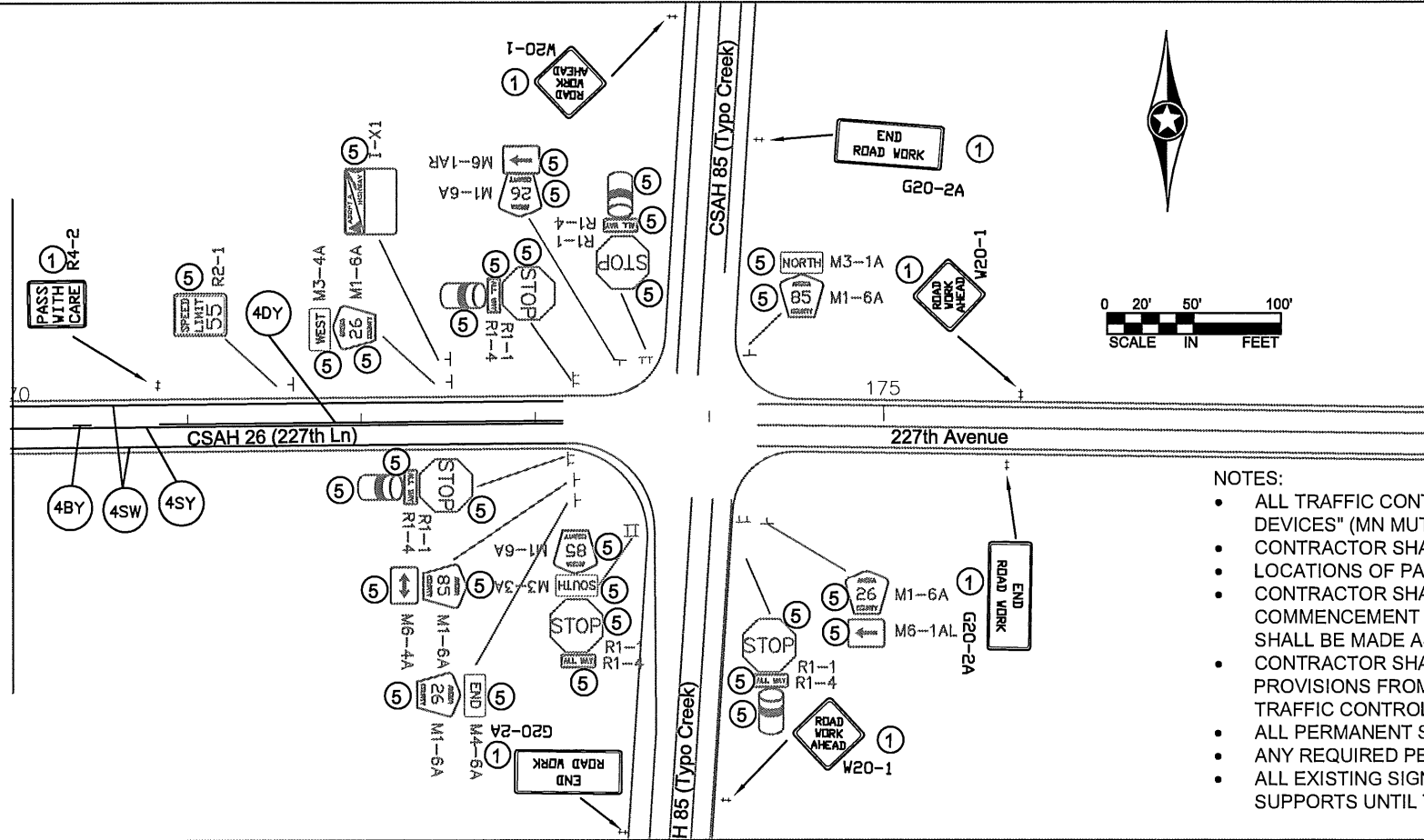

- NOTES:
- ALL TRAFFIC CONTROL DEVICES SHALL CONFORM AND BE PLACED IN ACCORDANCE TO THE "MINNESOTA MANUAL ON UNIFORM TRAFFIC CONTROL DEVICES" (MN MUTCD), INCLUDING PART VI, "FIELD MANUAL FOR TEMPORARY TRAFFIC CONTROL ZONE LAYOUTS".
 - CONTRACTOR SHALL COMPLY WITH THE LONGITUDINAL DROP-OFF GUIDELINES AS PER THE FIELD MANUAL.
 - LOCATIONS OF PAVEMENT MARKINGS ARE APPROXIMATE. EXACT LOCATIONS WILL BE DETERMINED IN THE FIELD BY THE ENGINEER.
 - CONTRACTOR SHALL SUPPLY AND INSTALL THE PORTABLE CHANGEABLE MESSAGE SIGN (CMS) A MINIMUM OF SEVEN DAYS PRIOR TO ACTUAL COMMENCEMENT OF ROAD WORK, TO A LOCATION AS SPECIFIED BY THE ENGINEER. SIGNS TO BE REMOVED WHEN ROAD WORK BEGINS. PAYMENT SHALL BE MADE AS PER ITEM 2563.613 PORTABLE CHANGEABLE MESSAGE SIGN BY THE UNIT/DAY.
 - CONTRACTOR SHALL SUPPLY AND ERECT THE TEMPORARY TRAFFIC CONTROL SIGNS AS SHOWN ON THIS DRAWING AND DETAILED IN THE SPECIAL PROVISIONS FROM THE TIME WORK COMMENCES ON THIS ROADWAY UNTIL THIS ROADWAY IS PERMANENTLY STRIPED. ALL NECESSARY TEMPORARY TRAFFIC CONTROL SIGNS SHALL BE PAID FOR AS PART OF TRAFFIC CONTROL LUMP SUM.
 - ALL PERMANENT STRIPING AND PAVEMENT MESSAGES SHALL BE PLACED WITHIN 72 HOURS OF MAINLINE PAVING.
 - ANY REQUIRED PERMANENT SIGNING SHALL BE INSTALLED THE SAME DAY AS PERMANENT STRIPING
 - ALL EXISTING SIGNING SHALL REMAIN IN PLACE DURING CONSTRUCTION. ALL SALVAGED AND REINSTALLED SIGNS SHALL BE INSTALLED ON TEMPORARY SUPPORTS UNTIL THE PERMANENT INSTALLATION CAN BE MADE. THIS WILL BE CONSIDERED AS INCIDENTAL TO INSTALL SIGN TYPE C.

NO	DATE	BY	CKD	APPR	REVISION

I HEREBY CERTIFY THAT THIS PLAN WAS PREPARED BY ME OR UNDER MY DIRECT SUPERVISION AND THAT I AM A DULY REGISTERED PROFESSIONAL ENGINEER UNDER THE LAWS OF THE STATE OF MINNESOTA.

PRINT NAME: MATTHEW J. JOHN
 SIGNATURE: *Matthew J. John*
 DATE: 3/8/2017 REG. NO. 51639

DRAWN BY: RLB DATE: 2/27/17
 DESIGN BY: RLB DATE: 2/27/17
 CHECKED BY: JR DATE: 2/27/17

ANOKA COUNTY
HIGHWAY DEPT.

STATE PROJECT NO. _____
 STATE AID PROJECT NO. 002-626-006
 STATE AID PROJECT NO. _____
 COUNTY PROJECT NO. _____

TEMPORARY SIGNING,
 PERMANENT SIGNING
 AND STRIPING

Sheet 20 of 25 Sheets

TEMPORARY TRAFFIC CONTROL SIGNS						
M.U.T.C.D. CODE	SIZE	PANEL AREA FT. ²	INSERT	QUANTITY	No. POST	MOUNTING HEIGHT (TO PAVEMENT FACE) FT.
W20-1	48" x 48"	16.00		AS NEEDED (ESTIMATED 14)		
W8-12	48" x 48"	16.00		2	2	7.0'
R4-1	24" x 30"	5.00		6	1	7.0'
R4-2	24" x 30"	5.00		6	1	7.0'
G20-2A	48" x 24"	8.00		5	2	7.0'
W8-1A	48" x 48"	16.00		AS NEEDED		
W8-1A	48" x 48"	16.00		AS NEEDED		
W8-8	48" x 48"	16.00		AS NEEDED		
W8-9	48" x 48"	16.00		AS NEEDED		
W8-23	48" x 48"	16.00		AS NEEDED		
W8-11	48" x 48"	16.00		AS NEEDED		
CMS sign to be installed a minimum of seven days prior to actual commencement of road work. Signs to be removed when road work begins.					2	

SIGN PANELS TYPE C							E
M.U.T.C.D. CODE	SIZE	INSERT	QUANTITY	SQ FT PANEL AREA	SQ FT TOTAL AREA	MOUNTING POST PER INSTALLATION	MOUNTING HEIGHT
R3-X1	30" x 30"		4	6.25	25.00	1	7.0'

NOTES:

- ALL TRAFFIC CONTROL DEVICES SHALL CONFORM AND BE PLACED IN ACCORDANCE TO THE "MINNESOTA MANUAL ON UNIFORM TRAFFIC CONTROL DEVICES" (MN MUTCD), INCLUDING PART VI, "FIELD MANUAL FOR TEMPORARY TRAFFIC CONTROL ZONE LAYOUTS".
- CONTRACTOR SHALL COMPLY WITH THE LONGITUDINAL DROP-OFF GUIDELINES AS PER THE FIELD MANUAL.
- LOCATIONS OF PAVEMENT MARKINGS ARE APPROXIMATE. EXACT LOCATIONS WILL BE DETERMINED IN THE FIELD BY THE ENGINEER.
- CONTRACTOR SHALL SUPPLY AND INSTALL THE PORTABLE CHANGEABLE MESSAGE SIGN (CMS) A MINIMUM OF SEVEN DAYS PRIOR TO ACTUAL COMMENCEMENT OF ROAD WORK, TO A LOCATION AS SPECIFIED BY THE ENGINEER. SIGNS TO BE REMOVED WHEN ROAD WORK BEGINS. PAYMENT SHALL BE MADE AS PER ITEM 2563.613 PORTABLE CHANGEABLE MESSAGE SIGN BY THE UNIT/DAY.
- CONTRACTOR SHALL SUPPLY AND ERECT THE TEMPORARY TRAFFIC CONTROL SIGNS AS SHOWN ON THIS DRAWING AND DETAILED IN THE SPECIAL PROVISIONS FROM THE TIME WORK COMMENCES ON THIS ROADWAY UNTIL THIS ROADWAY IS PERMANENTLY STRIPED. ALL NECESSARY TEMPORARY TRAFFIC CONTROL SIGNS SHALL BE PAID FOR AS PART OF TRAFFIC CONTROL LUMP SUM.
- ALL PERMANENT STRIPING AND PAVEMENT MESSAGES SHALL BE PLACED WITHIN 72 HOURS OF MAINLINE PAVING.
- ANY REQUIRED PERMANENT SIGNING SHALL BE INSTALLED THE SAME DAY AS PERMANENT STRIPING
- ALL EXISTING SIGNING SHALL REMAIN IN PLACE DURING CONSTRUCTION. ALL SALVAGED AND REINSTALLED SIGNS SHALL BE INSTALLED ON TEMPORARY SUPPORTS UNTIL THE PERMANENT INSTALLATION CAN BE MADE. THIS WILL BE CONSIDERED AS INCIDENTAL TO INSTALL SIGN TYPE C.

CHANGEABLE MESSAGE BOARD - MESSAGE SEQUENCE LAYOUT

		R	O	A	D		
		W	O	R	K		
		B	E	G	I	N	S

	<	D	A	T	E	>	
	E	X	P	E	C	T	
	D	E	L	A	Y	S	

CMS sign to be installed a minimum of seven days prior to actual commencement of road work. Signs to be removed when road work begins.

NO	DATE	BY	CKD	APPR	REVISION

NAME: P:\16-01-00\CR 26\base\Traffic\Signing_Striping.dwg

I HEREBY CERTIFY THAT THIS PLAN WAS PREPARED BY ME OR UNDER MY DIRECT SUPERVISION AND THAT I AM A DULY REGISTERED PROFESSIONAL ENGINEER UNDER THE LAWS OF THE STATE OF MINNESOTA.

PRINT NAME: MATTHEW J. JOHN
 SIGNATURE:
 DATE: 3/8/2017 REG. NO. 51639

DRAWN BY: RLB DATE: 2/27/17
 DESIGN BY: RLB DATE: 2/27/17
 CHECKED BY: JR DATE: 2/27/17

ANOKA COUNTY
HIGHWAY DEPT.

STATE PROJECT NO. _____
 STATE AID PROJECT NO. 002-626-006
 STATE AID PROJECT NO. _____
 COUNTY PROJECT NO. _____

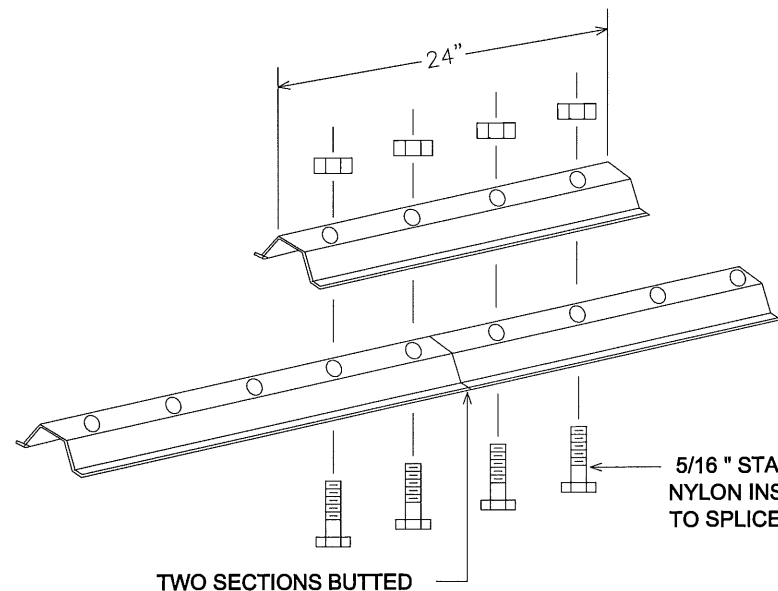

**LATERAL BRACE OR STRINGER
SPLICE DETAIL (EXPLODED VIEW)**

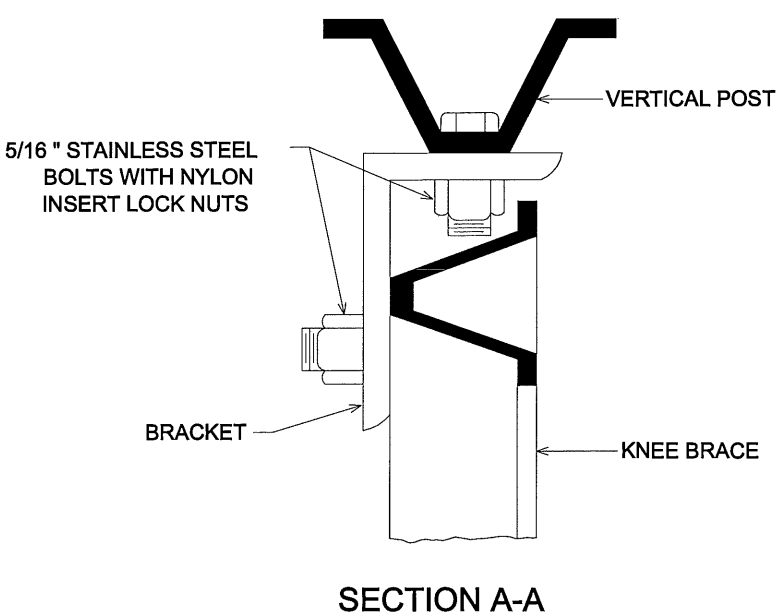

SECTION A-A

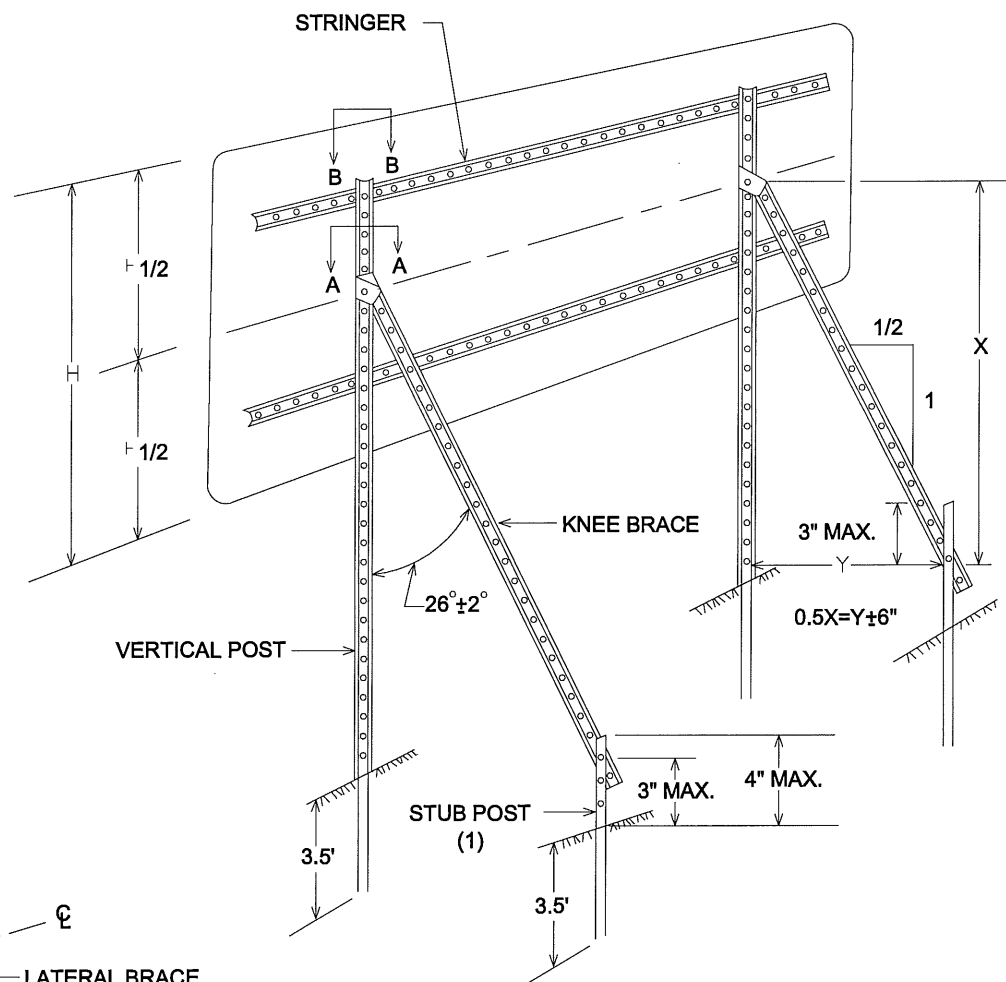

**TYPICAL "A-FRAME" INSTALLATION
TYPE "D" SIGNS**

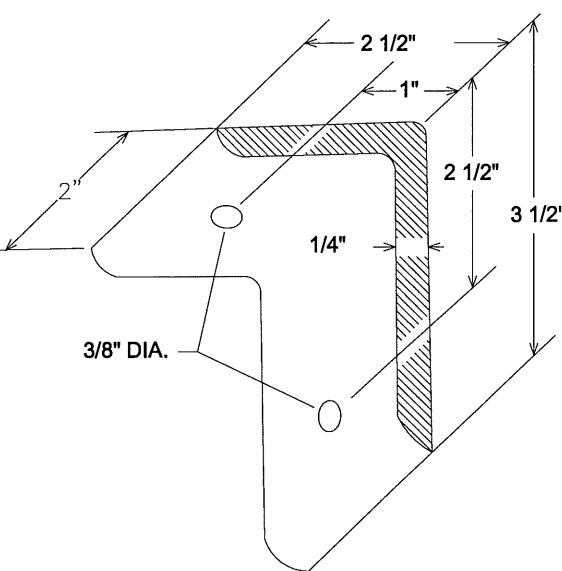

A-FRAME BRACKET

(STEEL MN/DOT 3306 GALVANIZED PER MN/DOT 3394)

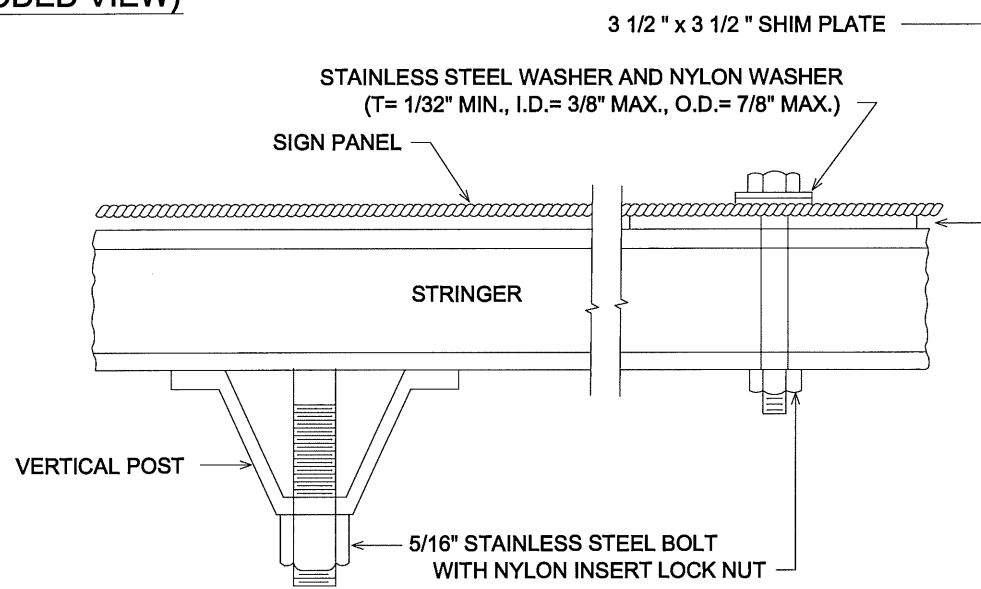

SECTION B-B

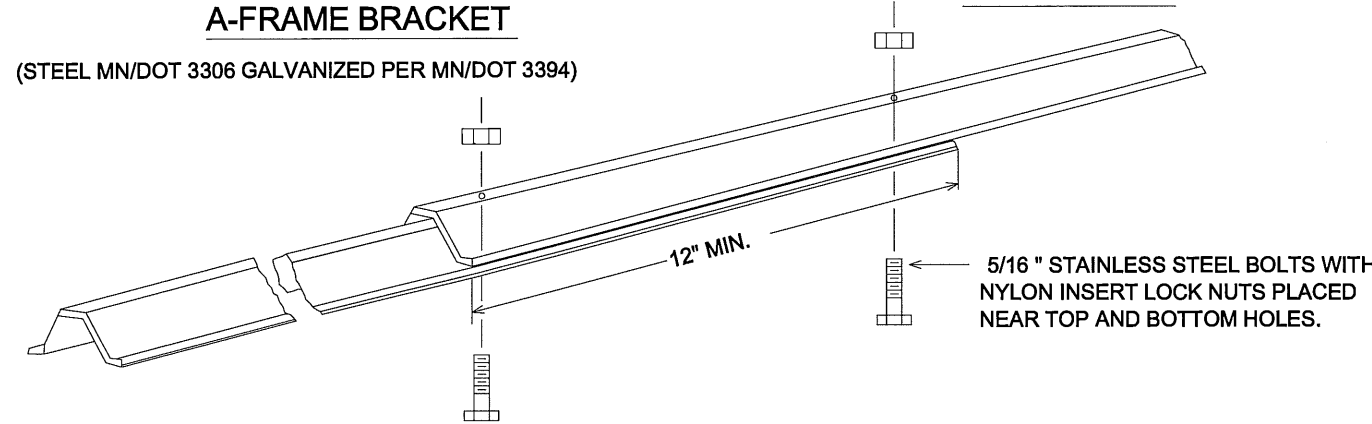

KNEE BRACE SPLICE

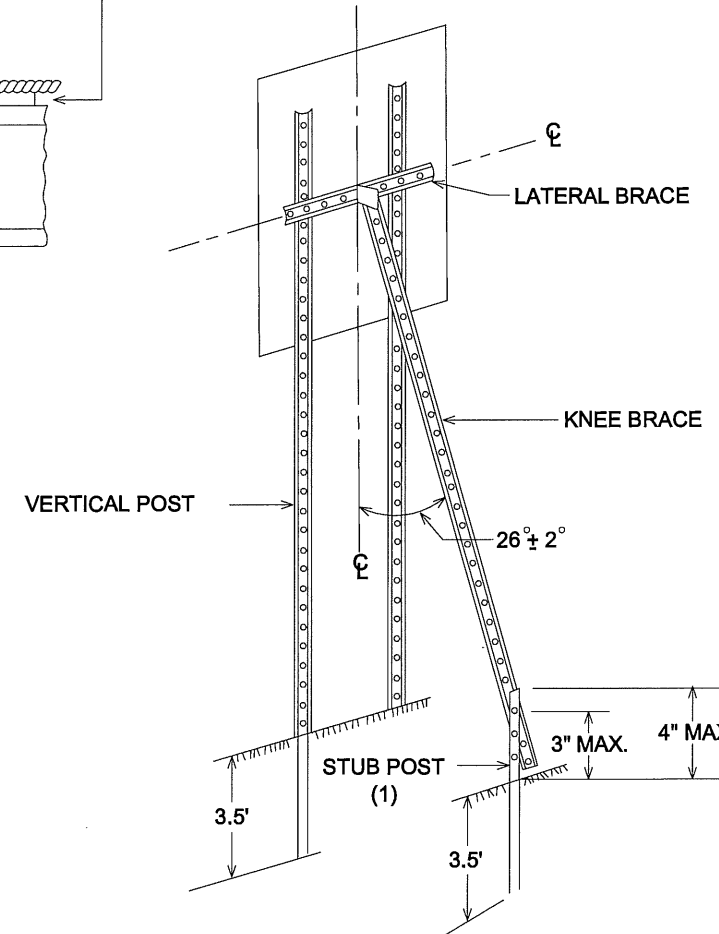

**TYPICAL "A-FRAME" INSTALLATION
TYPE "C" SIGNS**

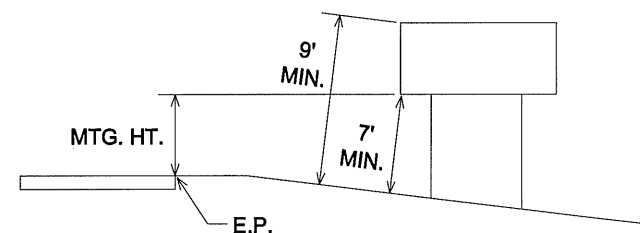

TYPICAL MOUNTING

(1) OFFSET STUB POST 1' TOWARD ROADWAY
RELATIVE TO VERTICAL POST.

**TYPE C & D SIGN
STRUCTURAL DETAILS**

NO	DATE	BY	CKD	APPR	REVISION

I HEREBY CERTIFY THAT THIS PLAN WAS PREPARED BY ME OR UNDER MY DIRECT SUPERVISION AND THAT I AM A DULY REGISTERED PROFESSIONAL ENGINEER UNDER THE LAWS OF THE STATE OF MINNESOTA.
 PRINT NAME: MATHEW J. JOHN
 SIGNATURE: *[Signature]*
 DATE: 3/8/2017 REG. NO. 51639

DRAWN BY: RLB DATE: 2/27/17
 DESIGN BY: RLB DATE: 2/27/17
 CHECKED BY: JR DATE: 2/27/17



**ANOKA COUNTY
HIGHWAY DEPT.**

STATE PROJECT NO. _____
 STATE AID PROJECT NO. 002-626-006
 STATE AID PROJECT NO. _____
 COUNTY PROJECT NO. _____

SIGNING & STRIPING
DETAILS
 Sheet 22 of 25 Sheets

RURAL

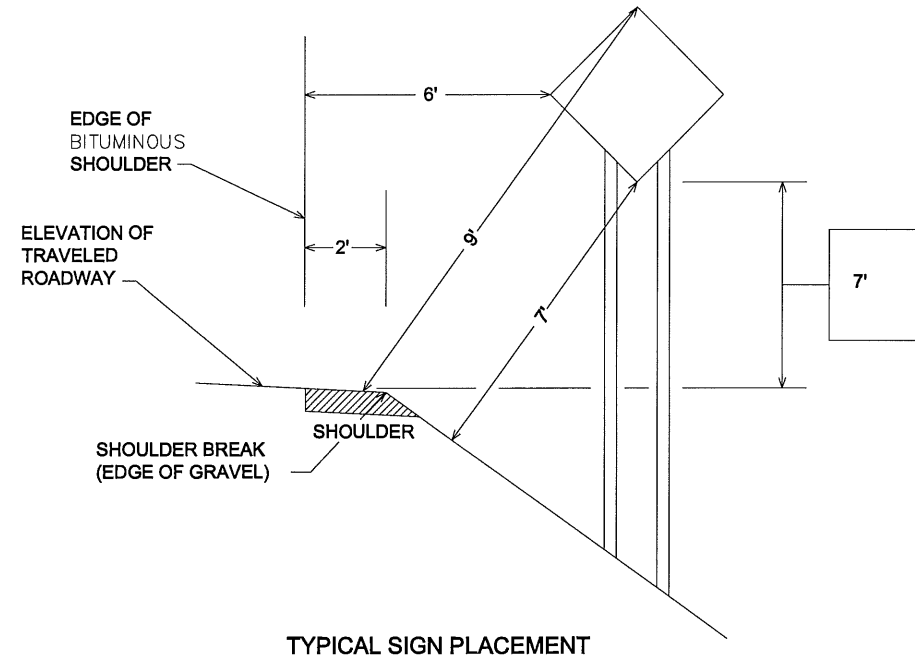

TYPICAL SIGN PLACEMENT

URBAN

* 2' - NARROW BOULEVARD (< 8' WIDE)
6' - WIDE BOULEVARD

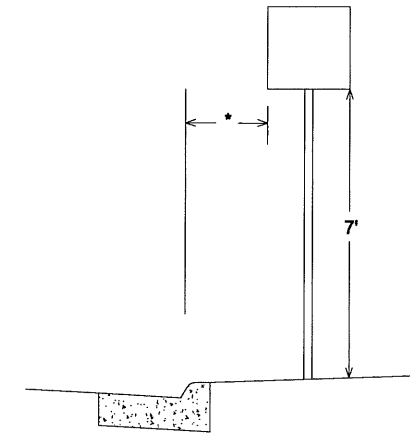

TYPICAL SIGN PLACEMENT

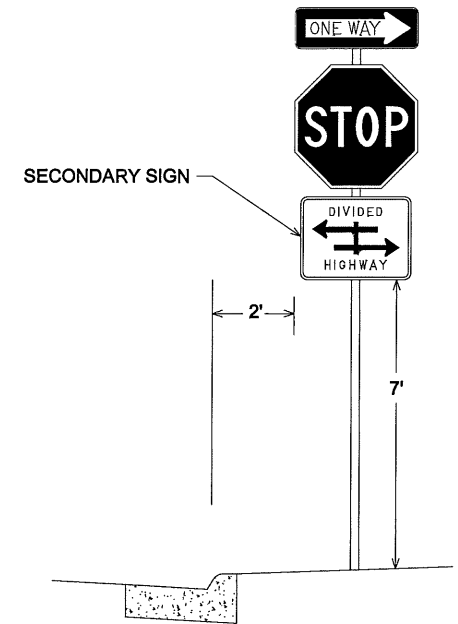

- NOTE:
- ALL DIMENSIONS ARE MINIMUMS
 - MAINTAIN 2' CLEAR FROM SIGNS TO BITUMINOUS TRAIL

I HEREBY CERTIFY THAT THIS PLAN WAS PREPARED BY ME OR UNDER MY DIRECT SUPERVISION AND THAT I AM A DULY REGISTERED PROFESSIONAL ENGINEER UNDER THE LAWS OF THE STATE OF MINNESOTA.
 PRINT NAME: MATHEW J. JOHN
 SIGNATURE: *MatheW J. John*
 DATE: 3/8/2017 REG. NO. 51639

DRAWN BY: RLB 2/27/17
 DESIGN BY: RLB 2/27/17
 CHECKED BY: JR 2/27/17



ANOKA COUNTY
 HIGHWAY DEPT.

STATE PROJECT NO. _____
 STATE AID PROJECT NO. 002-626-006
 STATE AID PROJECT NO. _____
 COUNTY PROJECT NO. _____

SIGNING & STRIPING
 DETAILS
 Sheet 23 of 25 Sheets

NO	DATE	BY	CKD	APPR	REVISION

M. U. T. C. D. CODE	SIZE	INSERT	QUANTITY	M. U. T. C. D. CODE	SIZE	INSERT	QUANTITY
W20-1	48' x 48'		• 1	TYPE III	8 FOOT		• 2
W20-2	48' x 48'		• 1	TYPE III	8 FOOT		• 2
W20-3	48' x 48'		• 5	G20-X2	132' x 108'		• 2
W20-100P	24' x 18'		• 2				
W20-100P	24' x 18'		• 2				
M4-10R	48' x 18'		SEE NOTE ②	G20-X2	132' x 108'		• 1
TYPE III	8 FOOT		• 1				
M4-10L	48' x 18'		SEE NOTE ②	G20-X1	60' x 48'		• 2
TYPE III	8 FOOT		• 1				
R11-2	48' x 30'		SEE NOTE ②	M4-8A	24' x 12'		• 3
TYPE III	8 FOOT		• 2	M3-4A	24' x 12'		• 3
				M1-6A	24' x 24'		• 0
					21' x 15'		• 0
							• 5
R11-3	48' x 30'		SEE NOTE ②	M4-8A	24' x 12'		• 1
TYPE III	8 FOOT		• 1	M3-2A	24' x 12'		• 1
				M1-6A	24' x 24'		• 3
					21' x 15'		• 3
							• 4
R11-3	48' x 30'		SEE NOTE ②	M4-6A	24' x 12'		• 2
TYPE III	8 FOOT		• 1	M4-8A	24' x 12'		
				M1-6A	24' x 24'		

* SIGN TO BE INSTALLED A MINIMUM OF SEVEN DAYS PRIOR TO ACTUAL CLOSING DATE OF ROAD CLOSURE AND IMPLEMENTATION OF DETOUR SIGING. SIGNS TO BE REMOVED AT TIME OF DETOUR INSTALLATION.

NOTES:

- 1) ALL TRAFFIC CONTROL DEVICES SHALL CONFORM TO THE MOST RECENT EDITION OF THE MINNESOTA MANUAL ON UNIFORM TRAFFIC CONTROL DEVICES, INCLUDING THE FIELD MANUAL DATED JANUARY, 2014.
- 2) ALL TYPE III BARRICADES SHALL BE REFLECTORIZED ON BOTH SIDES. BARRICADES MARKINGS SHALL BE SLANTED IN ACCORDANCE WITH THE M. U. T. C. D.