

MINNESOTA DEPARTMENT OF TRANSPORTATION ANOKA COUNTY

CONSTRUCTION PLAN FOR BITUMINOUS RECLAMATION, BITUMINOUS SURFACING, AND CURB & GUTTER

LOCATED ON CSAH 60 BETWEEN EAST LAKE NETTA DR AND LEXINGTON AVE

GOVERNING SPECIFICATIONS

THE 2016 EDITION OF THE MINNESOTA DEPARTMENT OF TRANSPORTATION "STANDARD SPECIFICATIONS FOR CONSTRUCTION" SHALL GOVERN. ALL TRAFFIC CONTROL DEVICES SHALL CONFORM AND BE INSTALLED IN ACCORDANCE TO THE "MINNESOTA MANUAL ON UNIFORM TRAFFIC CONTROL DEVICES" (MNMUTCD), AND PART VI, "FIELD MANUAL FOR TEMPORARY TRAFFIC CONTROL ZONE LAYOUTS."

THIS PLAN CONTAINS 16 SHEETS

INDEX

SHEET NO.	DESCRIPTION
1	TITLE SHEET
2	STATEMENT OF ESTIMATED QUANTITIES
3-4	TYPICAL SECTIONS
5-6	DETAILS
7-10	CONSTRUCTION PLAN
11-16	SIGNING AND STRIPING PLANS

END CP 16-13-60
CSAH 60, STA: 11+70

BEGIN CP 16-13-60
CSAH 60, STA: 103+62

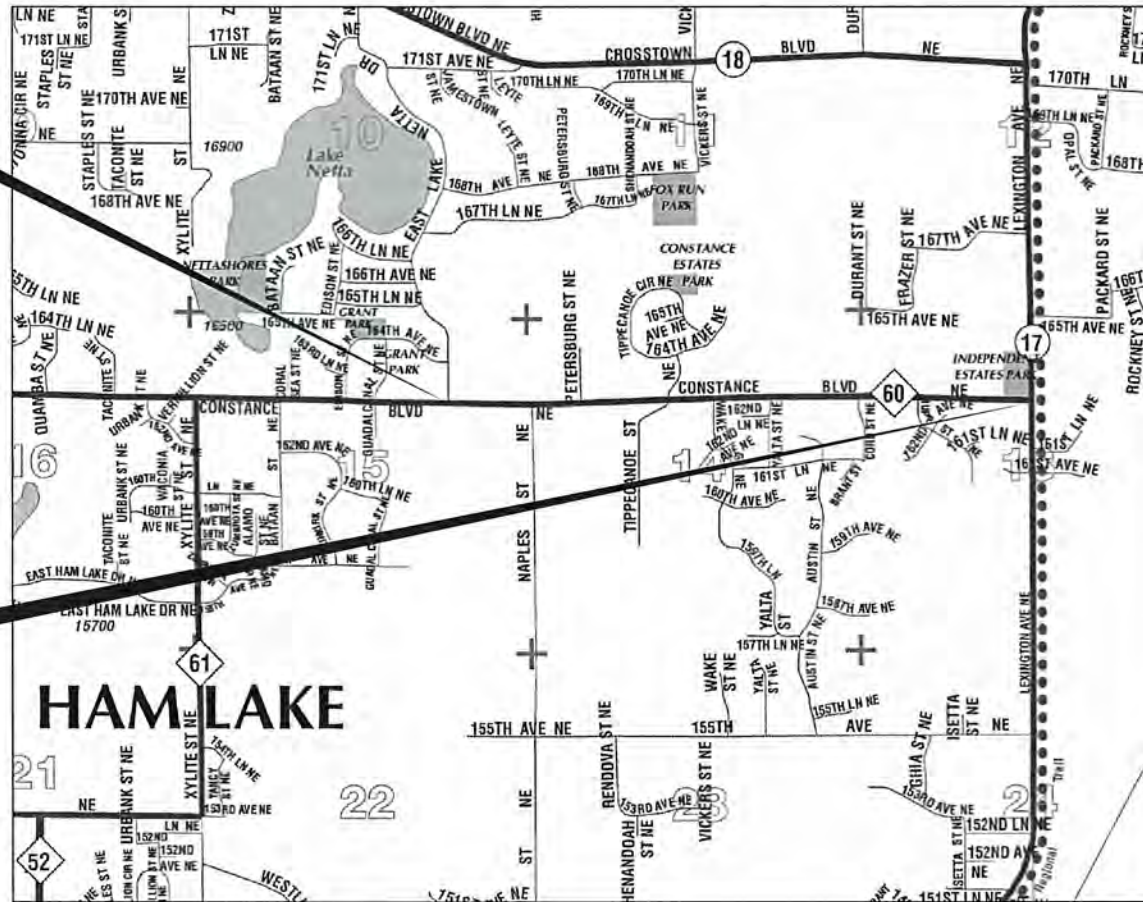

PROJECT LOCATION



CSAH 60	
GROSS LENGTH	9192 FEET 1.741 MILES
EXCEPTIONS-LENGTH	0.00 FEET 0.000 MILES
NET LENGTH	9192 FEET 1.741 MILES
DESIGN SPEED	55 MPH
CURRENT ADT	2500

CITY OF HAM LAKE
ANOKA COUNTY
MN/DOT TRANSPORTATION DISTRICT - METRO
SECTION 13, 14, 15
TOWNSHIP 32 NORTHWEST
RANGE 23 WEST

Approved: 4/11/2016
ANOKA COUNTY ENGINEER

NO	DATE	BY	CKD	APPR	REVISION	TIME

NAME: P:\16-01-00\CR_60[E_Lk_Netta-CSAH17]Base\PROPOSED\PLAN.dgn

I HEREBY CERTIFY THAT THIS PLAN WAS PREPARED BY ME OR UNDER MY DIRECT SUPERVISION AND THAT I AM A DULY LICENSED PROFESSIONAL ENGINEER UNDER THE LAWS OF THE STATE OF MINNESOTA.

PRINT NAME: MATTHEW J. JOHN
SIGNATURE: 4/6/2016
DATE: 4/6/2016 LICENSE NO. 51639

DRAWN BY: JJ DATE: 03/24/2016
DESIGN BY: JJ DATE: 03/24/2016
CHECKED BY: MJJ DATE: 03/24/2016

ANOKA COUNTY
HIGHWAY DEPT.

COUNTY PROJECT 16-13-60

TITLE SHEET
Sheet 1 of 16 Sheets

jkjohnso

STATEMENT OF ESTIMATED QUANTITIES

ITEM NUMBER	ITEM DESCRIPTION	NOTES	UNIT	TOTAL PROJECT QUANTITIES ESTIMATED
2021.501	MOBILIZATION		LUMP SUM	1
2104.501	REMOVE PIPE CULVERTS		LN FT	69
2104.501	REMOVE BITUMINOUS CURB		LN FT	234
2104.505	REMOVE BITUMINOUS DRIVEWAY PAVEMENT	1	SQ YD	1113
2104.505	REMOVE BITUMINOUS PAVEMENT		SQ YD	1214
2104.513	SAWING BITUMINOUS PAVEMENT		LN FT	1085
2105.523	COMMON BORROW (LV)		CU YD	70
2105.601	TEMPORARY STREAM DIVERSION SYSTEM		LUMP SUM	1
2123.503	MOTOR GRADER	3	HOUR	20
2123.509	DOZER	4	HOUR	10
2130.501	WATER		MGAL	200
2211.501	AGGREGATE BASE CLASS 5		TON	1630
2215.501	FULL DEPTH RECLAMATION		SQ YD	42225
2221.501	SHOULDER BASE AGGREGATE CLASS 5	5	TON	436
2232.501	MILL BITUMINOUS SURFACE (2.0")	6	SQ YD	304
2331.607	HAUL BIT PAVEMENT RECLAMATION (LV)	14	CU YD	109
2357.502	BITUMINOUS MATERIAL FOR TACK COAT		GAL	1495
2360.501	TYPE SP 12.5 WEARING COURSE MIX (3,B)	2	TON	407
2360.501	TYPE SP 12.5 WEARING COURSE MIX (4,E)		TON	8125
2411.507	CONCRETE FLUME	13	EACH	1
2501.511	54" CP PIPE CULVERT (SMOOTH)		LN FT	230
2511.501	RANDOM RIPRAP CLASS II		CU YD	6
2531.501	CONCRETE CURB & GUTTER DESIGN B624		LN FT	337
2540.602	MAIL BOX SUPPORT	7	EACH	30
2563.601	TRAFFIC CONTROL	8	LUMP SUM	1
2563.613	PORTABLE CHANGEABLE MESSAGE SIGN	9	UNIT DAY	14
2573.502	SILT FENCE, TYPE MS		LN FT	153
2573.505	FLOTATION SILT CURTAIN TYPE MOVING WATER		LN FT	25
2574.525	COMMON TOPSOIL BORROW	4	CU YD	100
2575.523	EROSION CONTROL BLANKETS CATEGORY 0	4, 10	SQ YD	300
2581.501	REMOVABLE PREFORMED PAVEMENT MARKING TAPE	11	LN FT	740
2582.502	4" SOLID LINE EPOXY	12	LN FT	21385
2582.502	4" BROKEN LINE EPOXY	12	LN FT	2050

BASIS OF PLANNED QUANTITIES

PLATE NUMBER	DESCRIPTION	QUANTITY
2357	BITUMINOUS MATERIAL FOR TACK COAT	0.05 GAL / SQ YD
2211	AGGREGATE BASE CLASS 5	1.8 TONS / CU YD
2360	ALL BITUMINOUS PAVEMENT	115 LBS / SQ YD / IN THICKNESS
2581	REMOVABLE PREFORM PAVEMENT MARKING TAPE	2' AT 50' INTERVALS

MNDOT STANDARD PLATES

PLATE NUMBER	DESCRIPTION
7100H	CONCRETE CURB AND GUTTER

CONSTRUCTION NOTES

1	CONTRACTOR IS RESPONSIBLE FOR CONTACTING PROPERTY OWNER 48 HOURS BEFORE STARTING OPERATION.
2	ITEM FOR BITUMINOUS DRIVEWAYS AND STREET APPROACHES.
3	ITEM USED TO MOVE EXCESS RECLAIM MATERIAL AT THE RECLAIM AREA LIMITS TO CREATE A SMOOTH TRANSITION BETWEEN THE PROPOSED AND EXISTING PAVEMENT
4	ITEM USED TO STRIP AND REPLACE EXISTING TOPSOIL AND TO EXCAVATE, STOCKPILE, AND REGRADE EXISTING MATERIAL BEHIND CURB.
5	ITEM INCLUDES 7 TONS FOR EACH GRAVEL ENTRANCE AND GRAVEL STREET APPROACH.
6	ITEM INCLUDES 2" DEEP MILL AT BEGINNING AND END OF PROJECT, ALL PAVED ST APPROACHES, AND DRIVEWAYS; SEE DETAILS FOR DIMENSIONS
7	MAILBOXES SHALL BE INSTALLED AT THE EXISTING MAILBOX LOCATION OR AS DIRECTED BY THE LOCAL POSTAL AUTHORITY, CONTRACTOR IS RESPONSIBLE FOR CONTACTING LOCAL POSTAL AUTHORITY. MAILBOX REMOVAL AND ALL MATERIALS ARE INCIDENTAL TO INSTALLATION.
8	ALL TRAFFIC CONTROL DEVICES SHALL CONFORM TO AND BE INSTALLED IN ACCORDANCE WITH THE "MINNESOTA MANUAL ON UNIFORM TRAFFIC CONTROL DEVICES." DO NOT PASS, PASS WITH CARE, NO CENTER STRIPE, AND STOP HERE ON RED SIGNS SHALL BE INPLACE WHENEVER PERMANENT PAVEMENT MARKINGS ARE NOT PRESENT.
9	2 MESSAGE BOARDS, ONE ON THE EACH END OF PROJECT WILL BE INSTALLED 7 DAYS PRIOR TO ANY CONSTRUCTION; REFERENCE STRIPING PLAN FOR DETAILS.
10	TYPE 1 FERTILIZER AND TYPE 25-121 SEED ARE INCIDENTAL TO THIS ITEM.
11	CENTERLINE AND LANE DESIGNATION SKIPS TO BE APPLIED AS SOON AS POSSIBLE ON EACH NEW LIFT OF PAVEMENT; SKIPS MUST BE INPLACE BEFORE THE CONTRACTOR LEAVES FOR THE DAY. CONTRACTOR IS TO REMOVE PRIOR TO FINAL PAINT STRIPING.
12	FINAL STRIPING SHALL BE INSTALLED WITHIN 72 HOURS OF COMPLETION OF MAINLINE WEAR COURSE PAVING.
13	GEOTEXTILE FILTER TYPE IV IS INCIDENTAL
14	TO BE USED AT ENGINEERS DISGRESSION FOR GRADE AND PROFILE CORRECTION

NO	DATE	BY	CKD	APPR	REVISION	
	04/05/2016					3:08:47 PM

NAME: P:\16-01-00\CR_60(E_Lk_Netta-CSAH17)\Base\PROPOSEDIPLAN.dgn

I HEREBY CERTIFY THAT THIS PLAN WAS PREPARED BY ME OR UNDER MY DIRECT SUPERVISION AND THAT I AM A DULY LICENSED PROFESSIONAL ENGINEER UNDER THE LAWS OF THE STATE OF MINNESOTA.

PRINT NAME: MATTHEW J. JOHN
 SIGNATURE: *Matthew J. John*
 DATE: 4/6/2016 LICENSE NO. 51639

DRAWN BY JJ DATE 04/05/2016
 DESIGN BY JJ DATE 04/05/2016
 CHECKED BY MJJ DATE 04/05/2016



**ANOKA COUNTY
HIGHWAY DEPT.**

COUNTY PROJECT 16-13-60

STATEMENT OF ESTIMATED QUANTITIES
 Sheet 2 of 16 Sheets

CONSTANCE BLVD - CSAH 60 MAINLINE RECLAIM SECTION

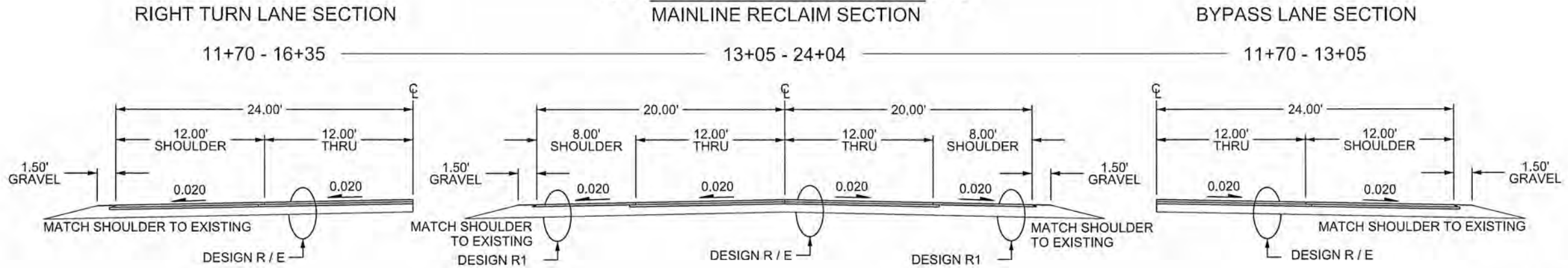

DESIGN R RECLAIM MAINLINE SECTION

2.0" BITUMINOUS WEAR (SPWEB440E)
 2.0" BITUMINOUS WEAR (SPWEB440E)
 RECLAIMED BITUMINOUS

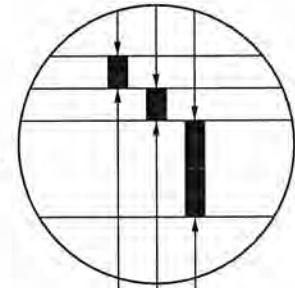

CONSTANCE BLVD - CSAH 60 MAINLINE RECLAIM SECTION

24+04 - 27+40

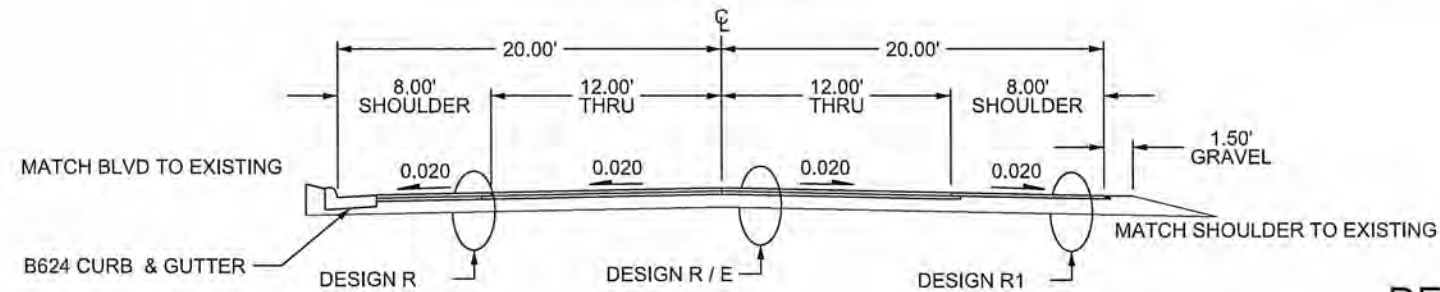

DESIGN R1 RECLAIM SHOULDER SECTION

2.0" BITUMINOUS WEAR (SPWEB440E)
 2.0" AGGREGATE BASE CLASS 5
 RECLAIMED BITUMINOUS

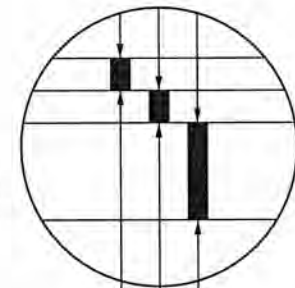

DESIGN E EXISTING SECTION

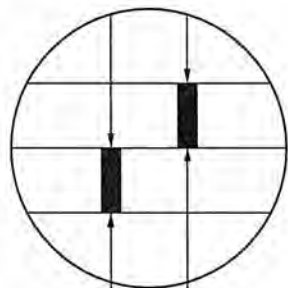

4" EXISTING BITUMINOUS
 4" EXISTING AGGREGATE BASE

NO	DATE	BY	CHKD	APPR	REVISION
	03/24/2016				

NAME: P:\16-01-00\CR_60\E_LK_Nelta-CSAH17\BaselPROPOSEDPLAN.dgn

I HEREBY CERTIFY THAT THIS PLAN WAS PREPARED BY ME OR UNDER MY DIRECT SUPERVISION AND THAT I AM A DULY LICENSED PROFESSIONAL ENGINEER UNDER THE LAWS OF THE STATE OF MINNESOTA.

PRINT NAME: MATTHEW J. JOHN
 SIGNATURE: *Matthew J. John*
 DATE: 4/6/2016 LICENSE NO. 51639

DRAWN BY: JJ DATE: 03/24/2016
 DESIGN BY: JJ DATE: 03/24/2016
 CHECKED BY: MJJ DATE: 03/24/2016



ANOKA COUNTY
 HIGHWAY DEPT.

COUNTY PROJECT 16-13-60

TYPICAL SECTIONS
 Sheet 3 of 16 Sheets

Johnso

CONSTANCE BLVD - CSAH 60 RECLAIM SECTION

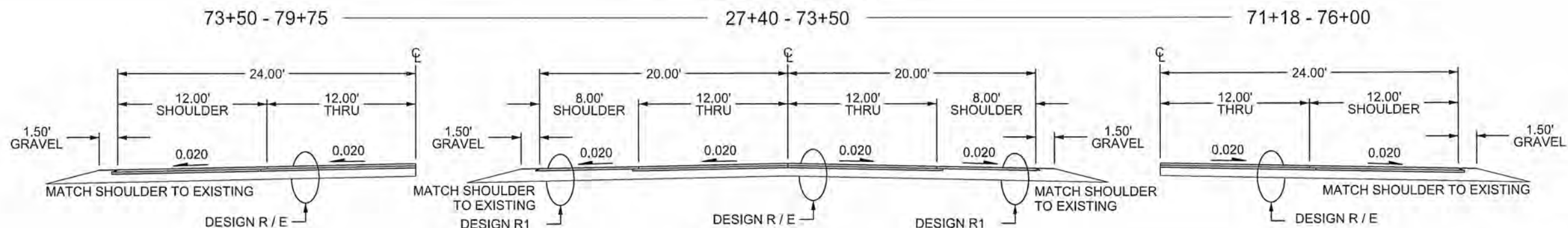

DESIGN R RECLAIM MAINLINE SECTION

- 2.0" BITUMINOUS WEAR (SPWEB440E)
- 2.0" BITUMINOUS WEAR (SPWEB440E)
- RECLAIMED BITUMINOUS

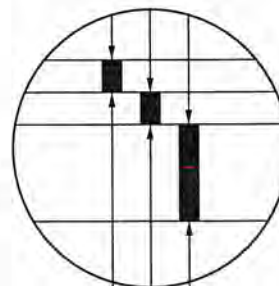

CONSTANCE BLVD - CSAH 60 RECLAIM SECTION

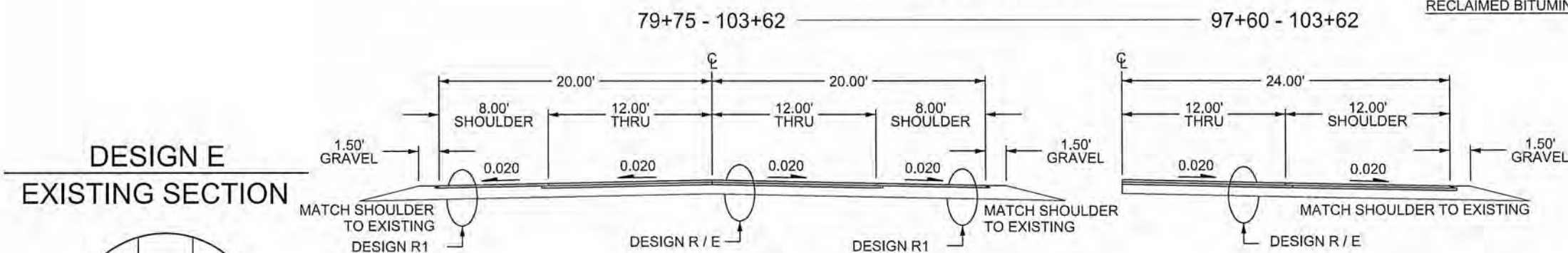

DESIGN E EXISTING SECTION

DESIGN R1 RECLAIM SHOULDER SECTION

- 2.0" BITUMINOUS WEAR (SPWEB440E)
- 2.0" AGGREGATE BASE CLASS 5
- RECLAIMED BITUMINOUS

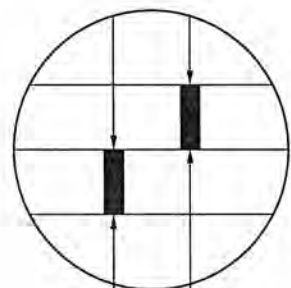

- 4" EXISTING BITUMINOUS
- 4" EXISTING AGGREGATE BASE

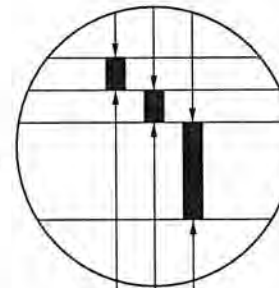

I HEREBY CERTIFY THAT THIS PLAN WAS PREPARED BY ME OR UNDER MY DIRECT SUPERVISION AND THAT I AM A DULY LICENSED PROFESSIONAL ENGINEER UNDER THE LAWS OF THE STATE OF MINNESOTA.

PRINT NAME: MATTHEW J. JOHN
 SIGNATURE: *[Signature]*
 DATE: 4/6/2016 LICENSE NO. 51833

DRAWN BY: JJ DATE: 03/24/2016

DESIGN BY: JJ DATE: 03/24/2016

CHECKED BY: MJJ DATE: 03/24/2016



ANOKA COUNTY
HIGHWAY DEPT.

COUNTY PROJECT 16-13-60

TYPICAL SECTIONS

Sheet 4 of 16 Sheets

NO	DATE	BY	CKD	APPR	REVISION		
	03/24/2016					9:08:25 AM	

NAME: P:\16-01-00\CR_60\E_Lk_Netta-CSAH17\Bases\PROPOSED\PLAN.dgn

MAINLINE JOINT DETAIL

PLAN VIEW

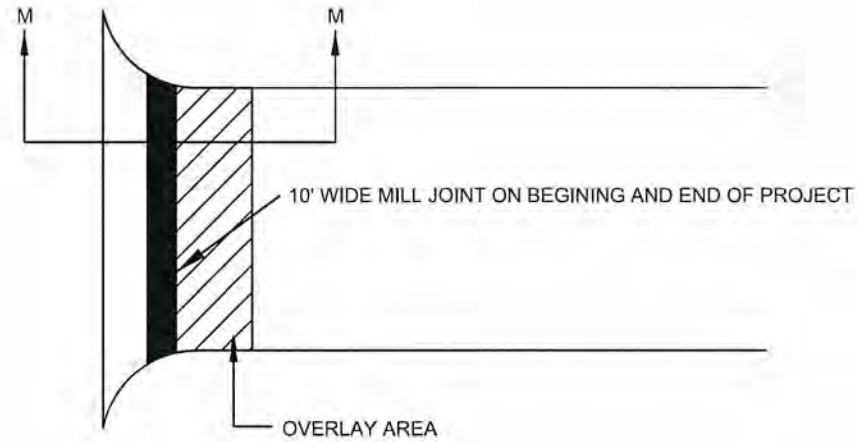

SECTION M - M

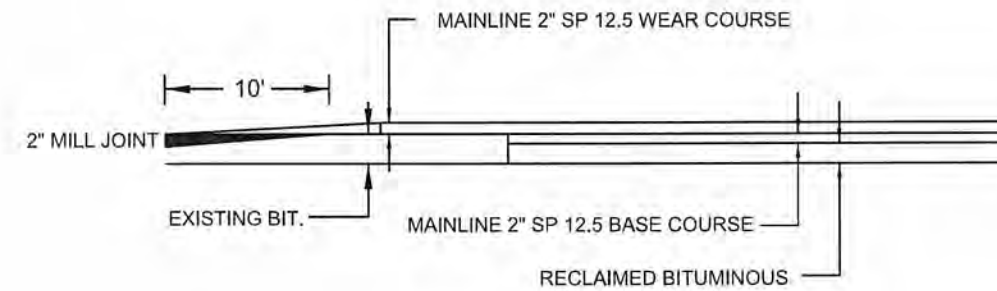

DRIVEWAY DETAIL GRAVEL / FIELD ENTRANCE

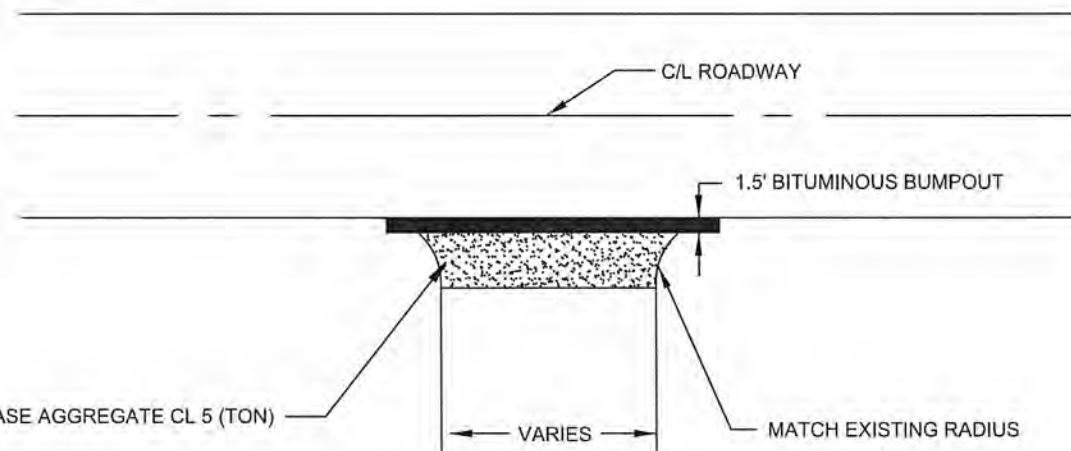

SHOULDER DETAIL BITUMINOUS SAFETY EDGE GRAVEL SHOULDER

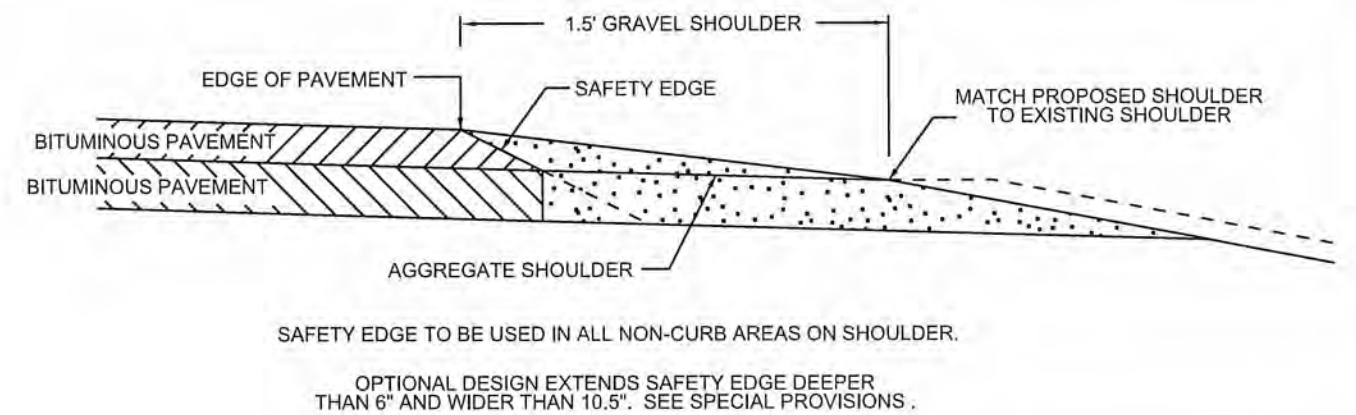

NO	DATE	BY	CKD	APPR	REVISION	03/24/2016	9:08:27 AM
NAME: P:\16-01-00\CR_60(E_Lk_Nelta-CSAH17)\Base\PROPOSED\PLAN.dgn							

I HEREBY CERTIFY THAT THIS PLAN WAS PREPARED BY ME OR UNDER MY DIRECT SUPERVISION AND THAT I AM A DULY LICENSED PROFESSIONAL ENGINEER UNDER THE LAWS OF THE STATE OF MINNESOTA.

PRINT NAME: MATTHEW J. JOHN

SIGNATURE: *Matthew J. John*

DATE: 4/6/2016 LICENSE NO. 51639

DRAWN BY JJ DATE 03/24/2016

DESIGN BY JJ DATE 03/24/2016

CHECKED BY MJJ DATE 03/24/2016

ANOKA COUNTY
HIGHWAY DEPT.

COUNTY PROJECT 16-13-60

DETAILS

Sheet 5 of 16 Sheets

jkphnso

STREET APPROACH DETAIL

BITUMINOUS STREET

PLAN VIEW

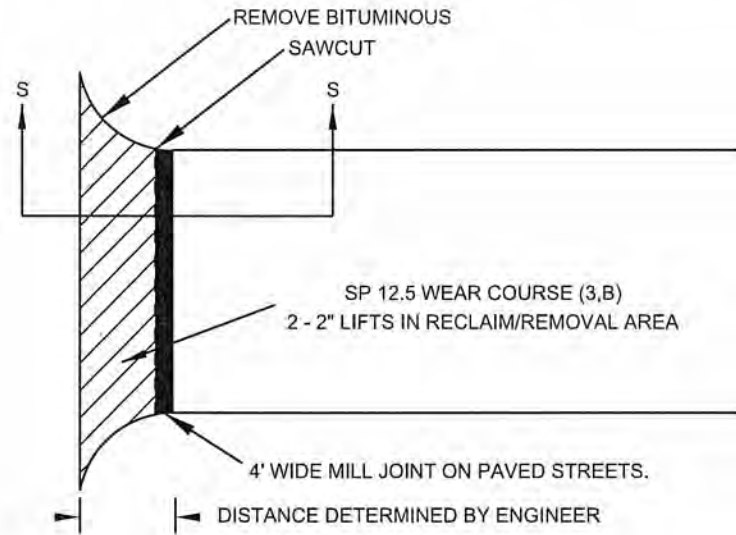

SECTION S - S

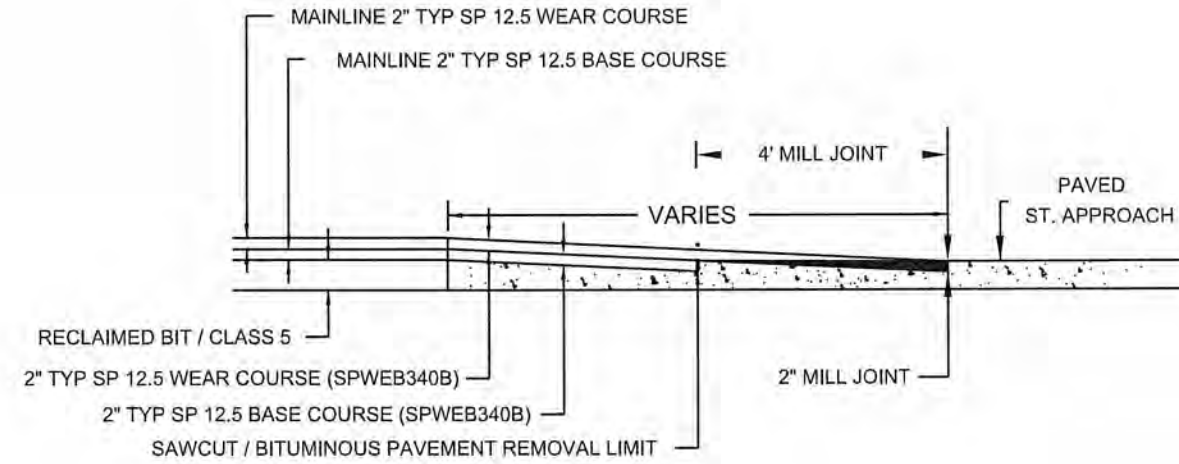

DRIVEWAY DETAIL

BITUMINOUS

PLAN VIEW

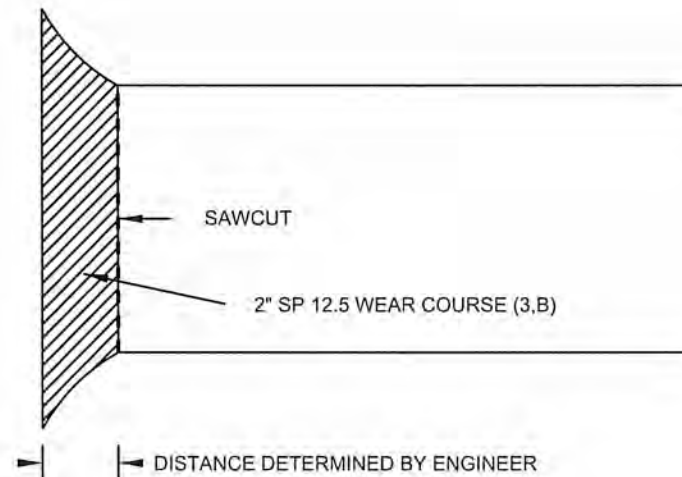

STREET APPROACH DETAIL

UNPAVED STREET

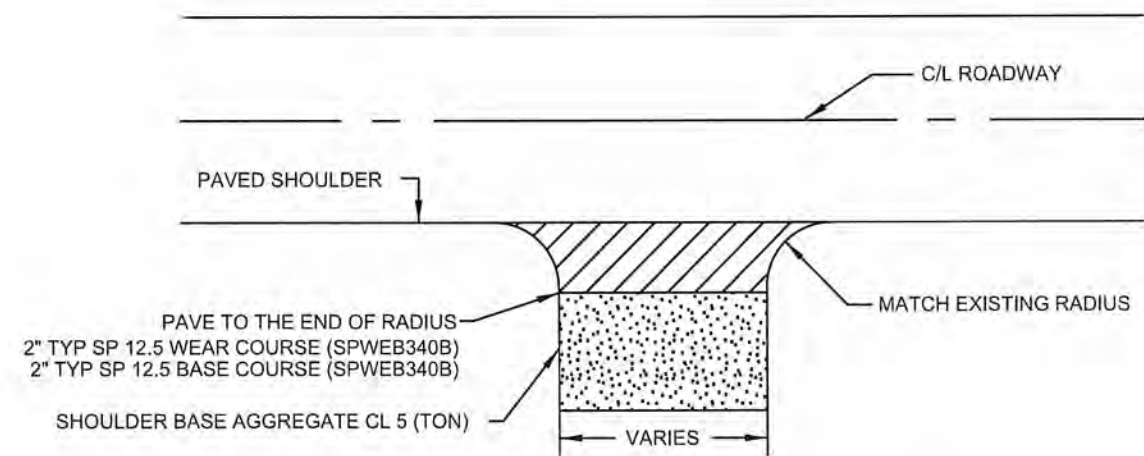

UNPAVED STREET APPROACHES, PAVED SEPRATE FROM MAINLINE

NO	DATE	BY	CKD	APPR	REVISION	03/24/2016	9:08:27 AM
NAME: P:\16-01-00\CR_60\E_Lk_Netta-CSAH17\Base\PROPOSED\PLAN.dgn							

I HEREBY CERTIFY THAT THIS PLAN WAS PREPARED BY ME OR UNDER MY DIRECT SUPERVISION AND THAT I AM A DULY LICENSED PROFESSIONAL ENGINEER UNDER THE LAWS OF THE STATE OF MINNESOTA.

PRINT NAME: MATTHEW J. JOHN

SIGNATURE: *Matthew J. John*

DATE: 4/6/2016 LICENSE NO. 51639

DRAWN BY JJ DATE 03/24/2016

DESIGN BY JJ DATE 03/24/2016

CHECKED BY MJJ DATE 03/24/2016



ANOKA COUNTY
HIGHWAY DEPT.

COUNTY PROJECT 16-13-60

DETAILS

Sheet 6 of 16 Sheets

Johnso

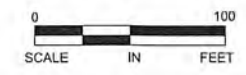
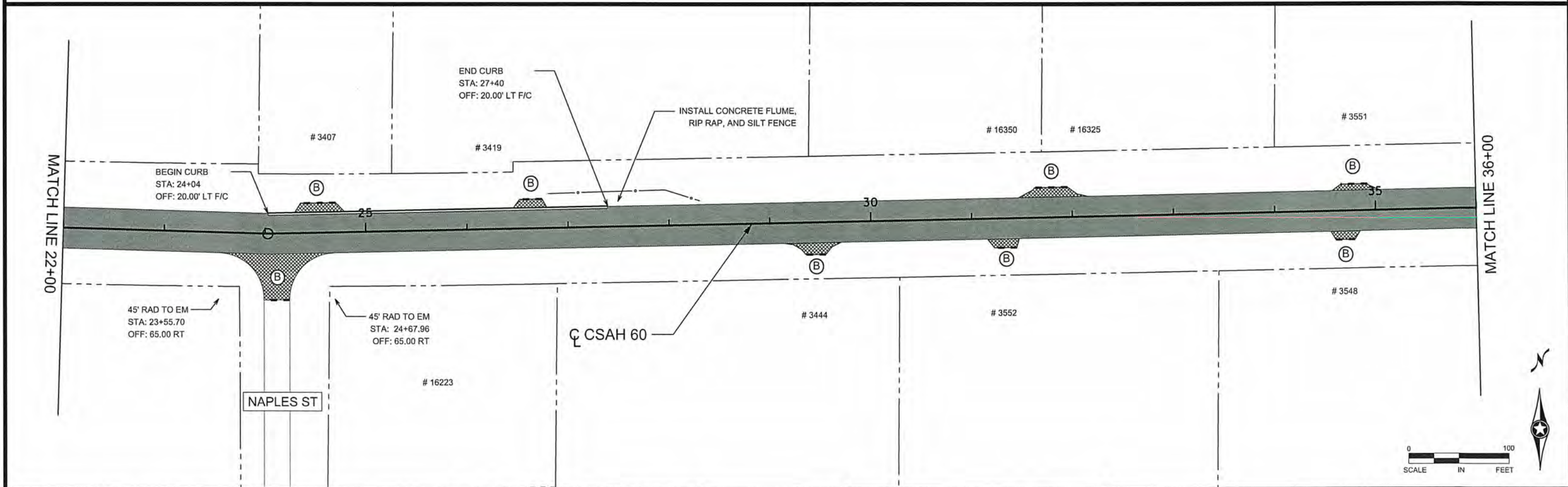
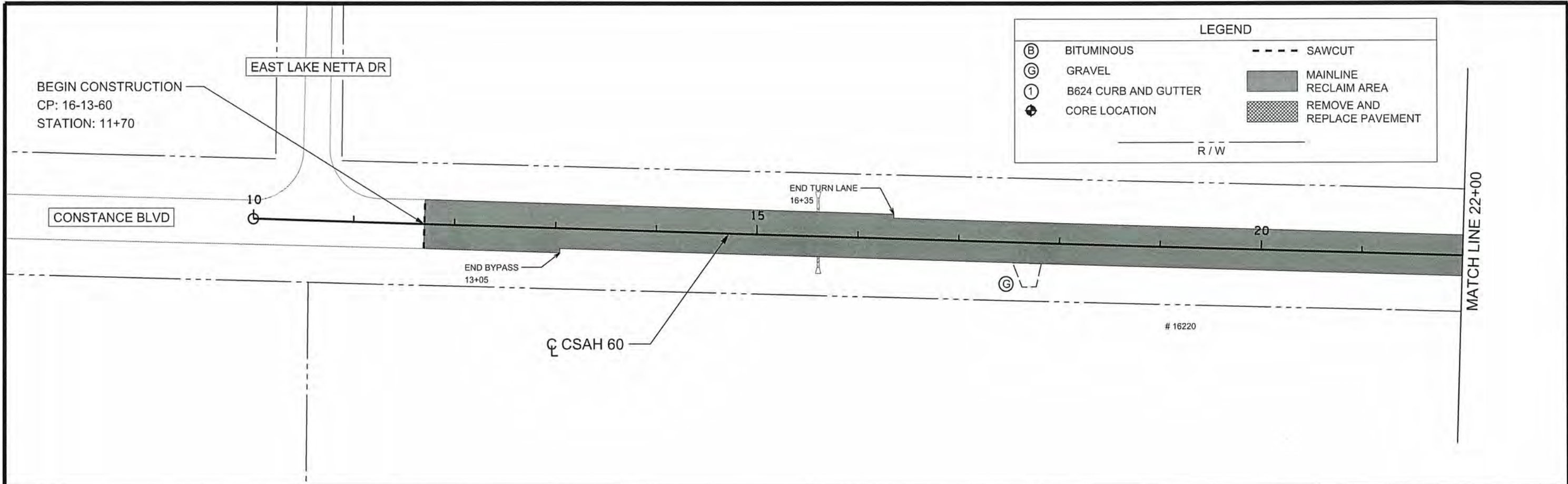

NO	DATE	BY	CKD	APPR	REVISION	DATE	TIME

I HEREBY CERTIFY THAT THIS PLAN WAS PREPARED BY ME OR UNDER MY DIRECT SUPERVISION AND THAT I AM A DULY LICENSED PROFESSIONAL ENGINEER UNDER THE LAWS OF THE STATE OF MINNESOTA.

PRINT NAME: MATTHEW J. JOHN

SIGNATURE: *Matthew J. John*

DATE: 4/6/2016 LICENSE NO. 51639

DRAWN BY JJ DATE 03/24/2016

DESIGN BY JJ DATE 03/24/2016

CHECKED BY MJJ DATE 03/24/2016

ANOKA COUNTY
HIGHWAY DEPT.

COUNTY PROJECT 16-13-60

CONSTRUCTION PLAN
STA 10+00 TO 36+00
Sheet 7 of 16 Sheets

J. Johnson

PIPE TAB AND NOTES			
STATION	OFFSET		DESCRIPTION
45+14.54	-57.16	LOWER EXISTING INVERT 1 FOOT - VERIFY WITH ENGINEER	WEST PIPE, NORTH PIPE END
44+89.51	55.08	LOWER EXISTING INVERT 1 FOOT - VERIFY WITH ENGINEER	WEST PIPE, SOUTH PIPE END
45+20.88	-55.75	LOWER EXISTING INVERT 1 FOOT - VERIFY WITH ENGINEER	EAST PIPE, NORTH PIPE END
44+95.86	56.5	LOWER EXISTING INVERT 1 FOOT - VERIFY WITH ENGINEER	EAST PIPE, SOUTH PIPE END

- REMOVE EXISING 84" CMP, ITEM 2104.501
- INSTALL TWIN 54" PLASTIC PIPE AT NEW LOCATION - PER ENGINEER, ITEM 2501.511
- REGRADE DITCH SLOPES, ITEM 2105.523

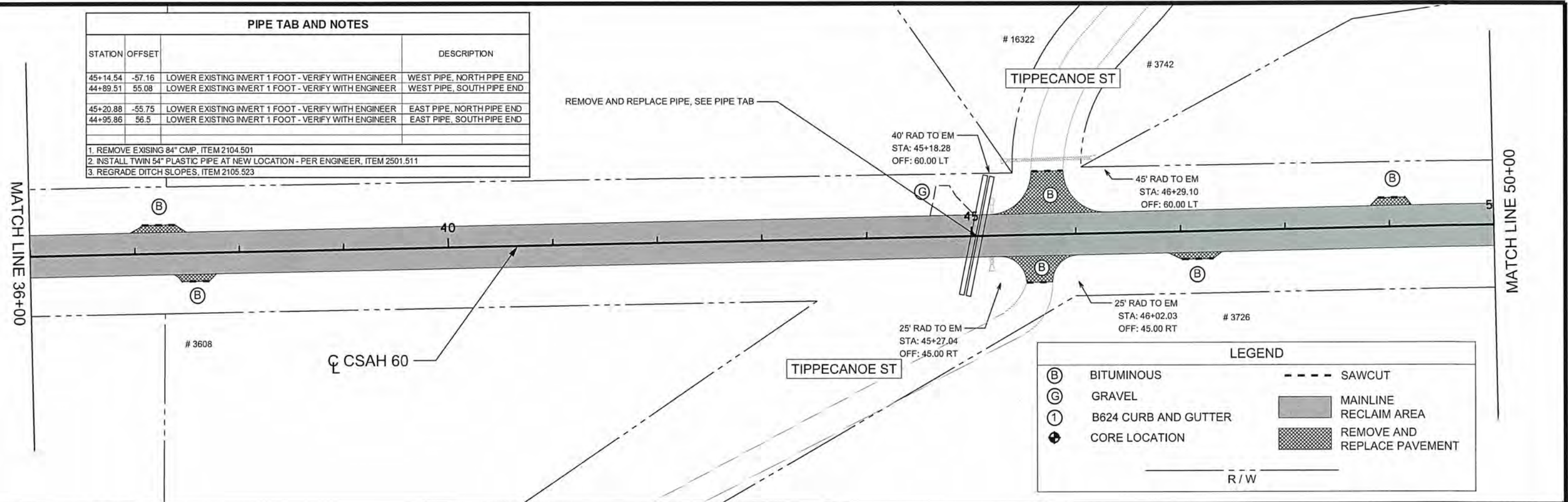

LEGEND			
(B)	BITUMINOUS	---	SAWCUT
(G)	GRAVEL	[Hatched Box]	REMOVE AND REPLACE PAVEMENT
(1)	B624 CURB AND GUTTER	[Solid Grey Box]	MAINLINE RECLAIM AREA
(+)	CORE LOCATION	[Dashed Line]	R/W

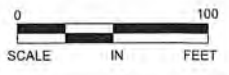
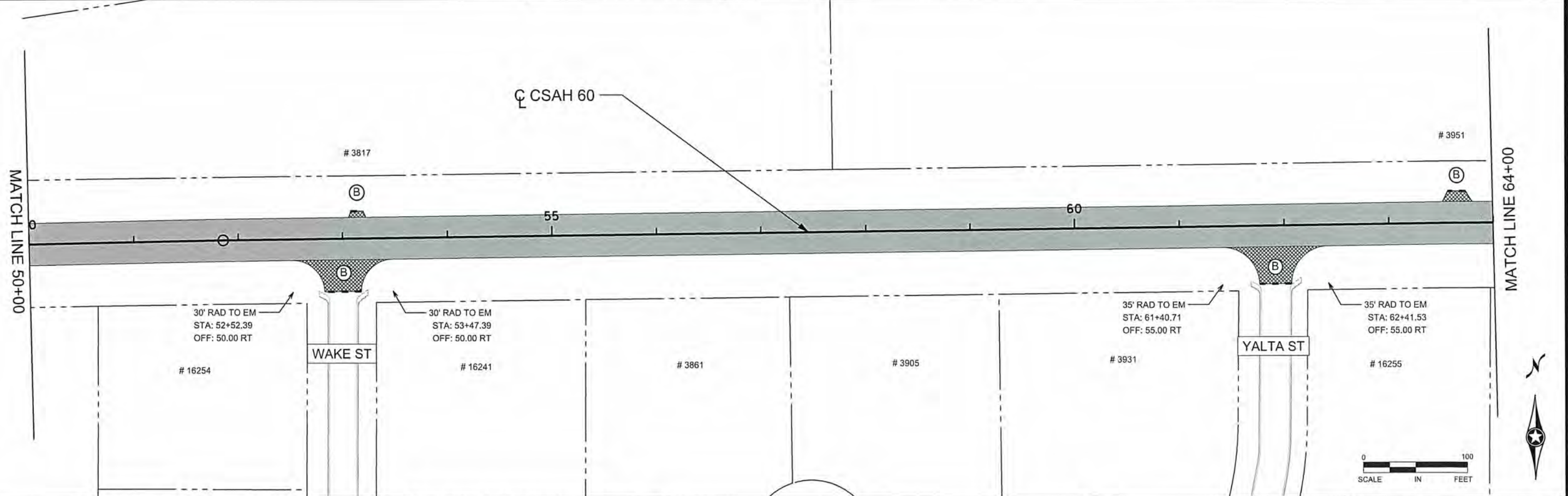

NO	DATE	BY	CKD	APPR	REVISION	
	04/05/2016					3:08:57 PM

NAME: P:\16-01-00\CR_60(E_Lk_Netta-CSAH17)\Base\PROPOSED\PLAN.dgn

I HEREBY CERTIFY THAT THIS PLAN WAS PREPARED BY ME OR UNDER MY DIRECT SUPERVISION AND THAT I AM A DULY LICENSED PROFESSIONAL ENGINEER UNDER THE LAWS OF THE STATE OF MINNESOTA.

PRINT NAME: MATTHEW J. JOHN

SIGNATURE: *Matthew J. John*

DATE: 4/6/2016 LICENSE NO. 51639

DRAWN BY JJ DATE 04/05/2016

DESIGN BY JJ DATE 04/05/2016

CHECKED BY MJJ DATE 04/05/2016

ANOKA COUNTY
HIGHWAY DEPT.

COUNTY PROJECT 16-13-60

CONSTRUCTION PLAN
STA 36+00 TO 64+00
Sheet 8 of 16 Sheets

jk.johnso

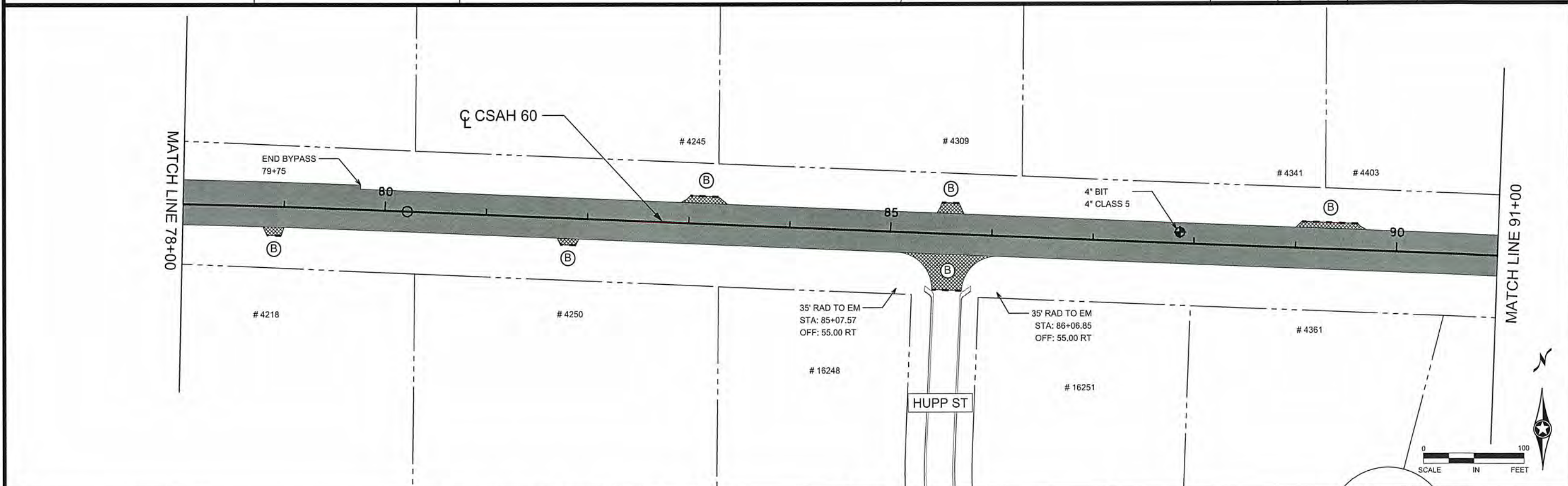
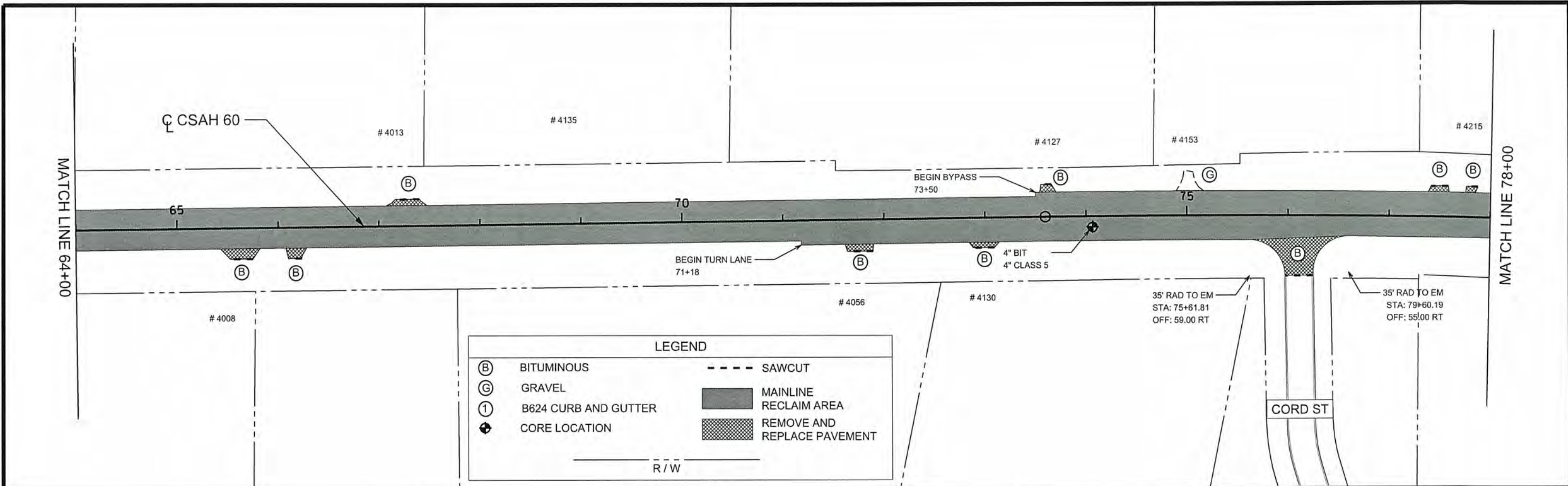

NO	DATE	BY	CKD	APPR	REVISION	
	03/24/2016					9:08:28 AM

NAME: P:\16-01-00\CR_60\E_Lk_Netta-CSAH17\Bases\PROPOSED\PLAN.dgn

I HEREBY CERTIFY THAT THIS PLAN WAS PREPARED BY ME OR UNDER MY DIRECT SUPERVISION AND THAT I AM A DULY LICENSED PROFESSIONAL ENGINEER UNDER THE LAWS OF THE STATE OF MINNESOTA.

PRINT NAME: MATTHEW J. JOHN
 SIGNATURE: *Matthew J. John*
 DATE: 4/9/2016 LICENSE NO. 51639

DRAWN BY JJ DATE 03/24/2016
 DESIGN BY JJ DATE 03/24/2016
 CHECKED BY MJJ DATE 03/24/2016

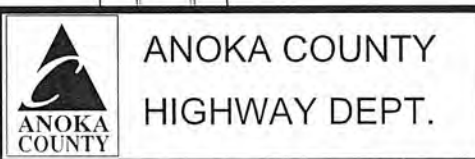

ANOKA COUNTY
 HIGHWAY DEPT.
 COUNTY PROJECT 16-13-60

CONSTRUCTION PLAN
 STA 64+00 TO 91+00
 Sheet 9 of 16 Sheets

pkjohnso

LEGEND

- (B) BITUMINOUS
- (G) GRAVEL
- (1) B624 CURB AND GUTTER
- ⊕ CORE LOCATION
- SAWCUT
- █ MAINLINE RECLAIM AREA
- ▨ REMOVE AND REPLACE PAVEMENT
- R/W

MATCH LINE 91+00

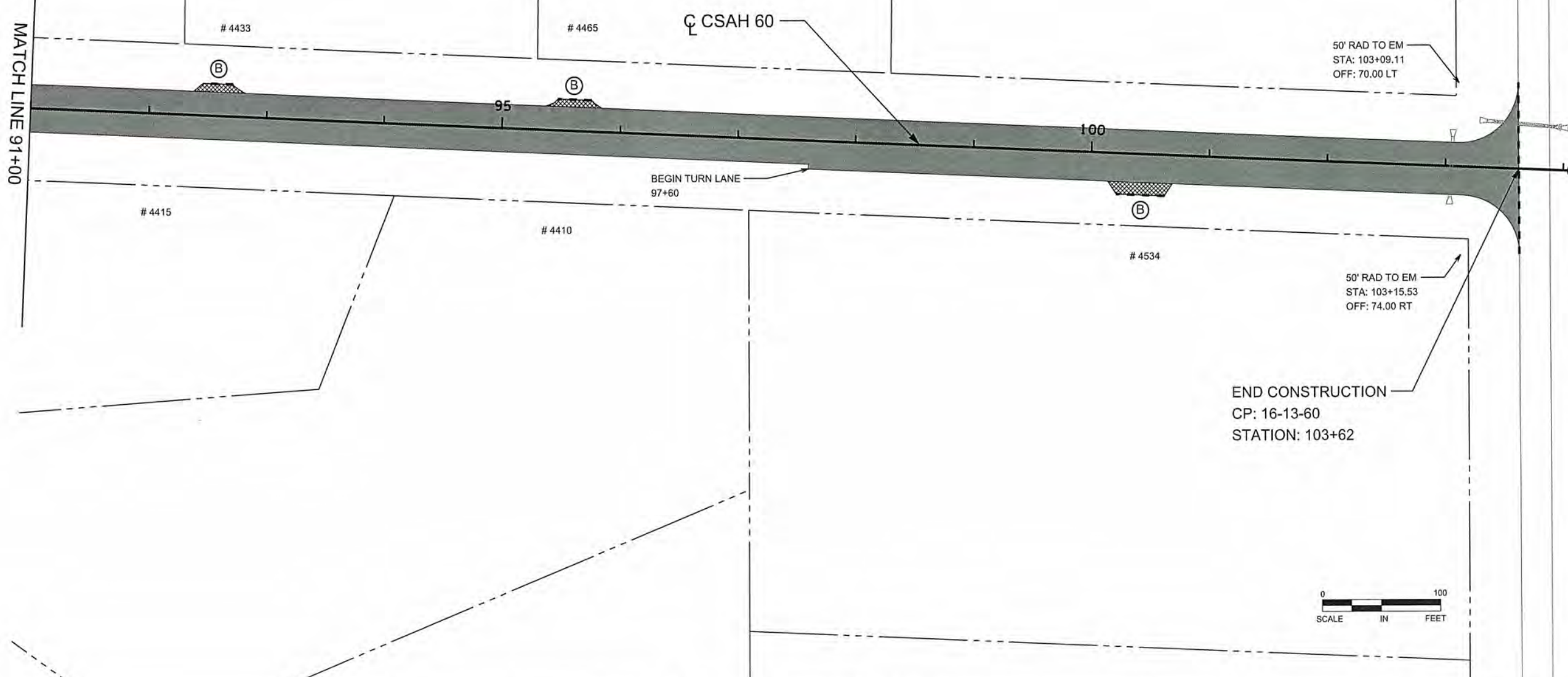

LEXINGTON AVE



NO	DATE	BY	CKD	APPR	REVISION	DATE	TIME

I HEREBY CERTIFY THAT THIS PLAN WAS PREPARED BY ME OR UNDER MY DIRECT SUPERVISION AND THAT I AM A DULY LICENSED PROFESSIONAL ENGINEER UNDER THE LAWS OF THE STATE OF MINNESOTA.

PRINT NAME: MATTHEW J. JOHN
 SIGNATURE: *Matthew J. John*
 DATE: 4/6/2016 LICENSE NO. 51639

DRAWN BY JJ DATE 03/24/2016
 DESIGN BY JJ DATE 03/24/2016
 CHECKED BY MJJ DATE 03/24/2016

ANOKA COUNTY
HIGHWAY DEPT.

COUNTY PROJECT 16-13-60

CONSTRUCTION PLAN
 STA 91+00 TO 103+62
 Sheet 10 of 16 Sheets

PERMANENT PAVEMENT MARKING PLAN
NOTES AND GUIDELINES

GENERAL INFORMATION:

THE ENGINEER'S INVOLVEMENT IN THE APPLICATION OF THE MATERIAL SHALL BE LIMITED TO FIELD CONSULTATION AND INSPECTION. ANOKA COUNTY HIGHWAY DEPARTMENT WILL PLACE NECESSARY "SPOTTING" AT APPROPRIATE POINTS TO PROVIDE HORIZONTAL CONTROL FOR STRIPING AND TO DETERMINE NECESSARY STARTING AND CUTOFF POINTS, LONGITUDINAL JOINTS, PAVEMENT EDGES AND EXISTING MARKINGS MAY SERVE AS HORIZONTAL CONTROL WHEN SO DIRECTED.

EDGE LINES AND LANE LINES ARE TO BE BROKEN ONLY AT INTERSECTIONS WITH PUBLIC ROADS AND AT PRIVATE ENTRANCES IF THEY ARE CONTROLLED BY A YIELD SIGN, STOP SIGN OR TRAFFIC SIGNAL. THE BREAK POINT IS TO BE AT THE START OF THE RADIUS FOR THE INTERSECTION OR AT MARKED STOP LINES OR CROSSWALKS.

A TOLERANCE OF 1/4 INCH UNDER OR 1/4 INCH OVER THE SPECIFIED WIDTH WILL BE ALLOWED FOR STRIPING PROVIDED THE VARIATION IS GRADUAL AND DOES NOT DETRACT FROM THE GENERAL APPEARANCE. BROKEN LINE SEGMENTS MAY VARY UP TO ONE-HALF FOOT FROM THE SPECIFIED LENGTHS PROVIDED THE OVER AND UNDER VARIATIONS ARE REASONABLY COMPENSATORY. ALIGNMENT DEVIATIONS FROM THE CONTROL GUIDE SHALL NOT EXCEED 1 INCH. MATERIAL SHALL NOT BE APPLIED OVER LONGITUDINAL JOINTS, ESTABLISHMENT OF APPLICATION TOLERANCES SHALL NOT RELIEVE THE CONTRACTOR OF THEIR RESPONSIBILITY TO COMPLY AS CLOSELY AS PRACTICABLE WITH THE PLANNED DIMENSIONS.

EPOXY:

THE ROAD SURFACE SHALL BE CLEANED AT THE DIRECTION OF THE ENGINEER JUST PRIOR TO APPLICATION. PAVEMENT CLEANING SHALL CONSIST OF AT LEAST BRUSHING WITH A ROTARY BROOM (NON-METALLIC) OR AS RECOMMENDED BY THE MATERIAL MANUFACTURER AND ACCEPTABLE TO THE ENGINEER. NEW PORTLAND CEMENT CONCRETE SURFACES SHALL BE SANDBLAST CLEANED TO REMOVE ANY SURFACE TREATMENT AND/OR LAITANCE ON LOW SPEED (SPEED LIMIT 35 MPH OR LESS) URBAN PORTLAND CEMENT CONCRETE ROADWAYS. SANDBLAST CLEANING SHALL BE USED FOR ALL EPOXY PAVEMENT MARKINGS.

THE EPOXY MARKING APPLICATION SHALL IMMEDIATELY FOLLOW THE PAVEMENT CLEANING. GLASS BEADS SHALL BE APPLIED IMMEDIATELY AFTER APPLICATION OF THE EPOXY RESIN LINE TO PROVIDE AN IMMEDIATE NO-TRACK SYSTEM.

AN EPOXY RESIN LINE 4" WIDE AND 15 MILL THICKNESS (WET), REQUIRES AN APPLICATION RATE OF ONE (1) GALLON OF COMPONENTS FOR 320 FEET OF LINE. GLASS BEADS SHALL BE APPLIED AT A POUND PER GALLON RATE SUFFICIENT TO ACHIEVE AN ACCEPTABLE NO-TRACK SYSTEM.

OPERATIONS SHALL BE CONDUCTED ONLY WHEN THE ROAD PAVEMENT SURFACE TEMPERATURES ARE 50 DEGREES FAHRENHEIT OR GREATER.

PERMANENT PAVEMENT MARKINGS SHALL NOT BE PLACED OVER TEMPORARY TAPE MARKINGS.

PREFORMED THERMOPLASTIC:

THE PREFORMED THERMOPLASTIC MARKINGS SHALL BE APPLIED IN ACCORDANCE WITH THE MANUFACTURER'S RECOMMENDATIONS ON CLEAN AND DRY SURFACES. SEE SPECIAL PROVISIONS FOR PREFORMED THERMOPLASTIC MARKING SPECIFICATIONS.

PAINT:

AT THE TIME OF APPLYING THE MARKING MATERIAL, THE APPLICATION AREA SHALL BE FREE OF CONTAMINATION. THE CONTRACTOR SHALL CLEAN THE ROADWAY SURFACE PRIOR TO THE LINE APPLICATION IN A MANNER AND TO THE EXTENT REQUIRED BY THE ENGINEER.

GLASS BEADS SHALL BE APPLIED IMMEDIATELY AFTER APPLICATION OF THE PAINT LINE.

EXCEPT WHEN USED AS A TEMPORARY MARKING, PAVEMENT MARKINGS SHALL ONLY BE APPLIED IN SEASONABLE WEATHER WHEN AIR TEMPERATURE IS 50 DEGREES FARHENHEIT OR HIGHER AND SHALL NOT BE APPLIED WHEN THE WIND OR OTHER CONDITIONS CAUSE A FILM OR DUST TO BE DEPOSITED ON THE PAVEMENT SURFACE AFTER CLEANING AND BEFORE THE MARKING MATERIAL CAN BE APPLIED.

THE FILLING OF TANKS, POURING OF MATERIALS OR CLEANING OF EQUIPMENT SHALL NOT BE PERFORMED ON UNPROTECTED PAVEMENT SURFACES UNLESS ADEQUATE PROVISIONS ARE MADE TO PREVENT SPILLAGE OF MATERIAL.

PERMANENT MARKING QUANTITIES		
ITEM	UNIT	TOTAL QUANTITY
4" SOLID LINE WHITE - EPOXY PAINT	LIN FT	19465
4" BROKEN LINE WHITE - EPOXY PAINT	LIN FT	100
4" SOLID LINE YELLOW - EPOXY PAINT	LIN FT	1920
4" BROKEN LINE YELLOW - EPOXY PAINT	LIN FT	1950
4" DOUBLE SOLID LINE YELLOW - EPOXY PAINT	LIN FT	0

SYMBOLS & MATERIALS LEGEND

- CROSSWALK BLOCK WHITE PREFORMED THERMOPLASTIC
- ↩ PAVEMENT MESSAGE (LEFT ARROW) PREFORMED THERMOPLASTIC

STRIPING KEY

- CIRCLE - EPOXY
- SQUARE PREFORMED THERMOPLASTIC
- △ TRIANGLE - PAINT
- ⬠ PENTAGON - REMOVABLE PREFORMED PLASTIC MARKING

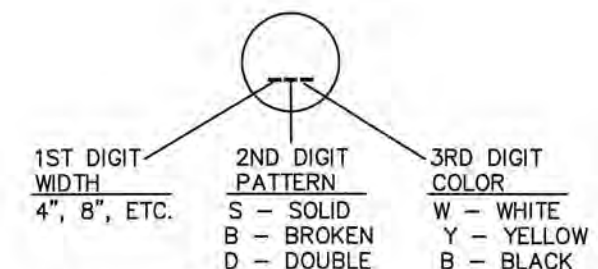

EXAMPLE: (4SW) = 4" SOLID LINE WHITE - EPOXY

NO	DATE	BY	CKD	APPR	REVISION

I HEREBY CERTIFY THAT THIS PLAN WAS PREPARED BY ME OR UNDER MY DIRECT SUPERVISION AND THAT I AM A DULY LICENSED PROFESSIONAL ENGINEER UNDER THE LAWS OF THE STATE OF MINNESOTA.
 PRINT NAME: MATTHEW J. JOHN
 SIGNATURE: *Matthew J. John*
 DATE: 4/6/2016 LICENSE NO. 51639

DRAWN BY: RLB DATE: 2/14/14
 DESIGN BY: RLB DATE: 2/14/14
 CHECKED BY: JR DATE: 2/14/14



ANOKA COUNTY
HIGHWAY DEPT.

STATE PROJECT NO. _____
 STATE AID PROJECT NO. _____
 STATE AID PROJECT NO. _____
 COUNTY PROJECT NO. 16-13-60

PERMANENT MARKING
TABULATION
 Sheet 11 of 16 Sheets

- SIGN NOTES:
- ① TEMPORARY TRAFFIC CONTROL SIGN
 - ② F & I PERMANENT SIGN
 - ③ SALVAGE PERMANENT SIGN
 - ④ RE-INSTALL PERMANENT SIGN
 - ⑤ RETAIN INPLACE SIGN

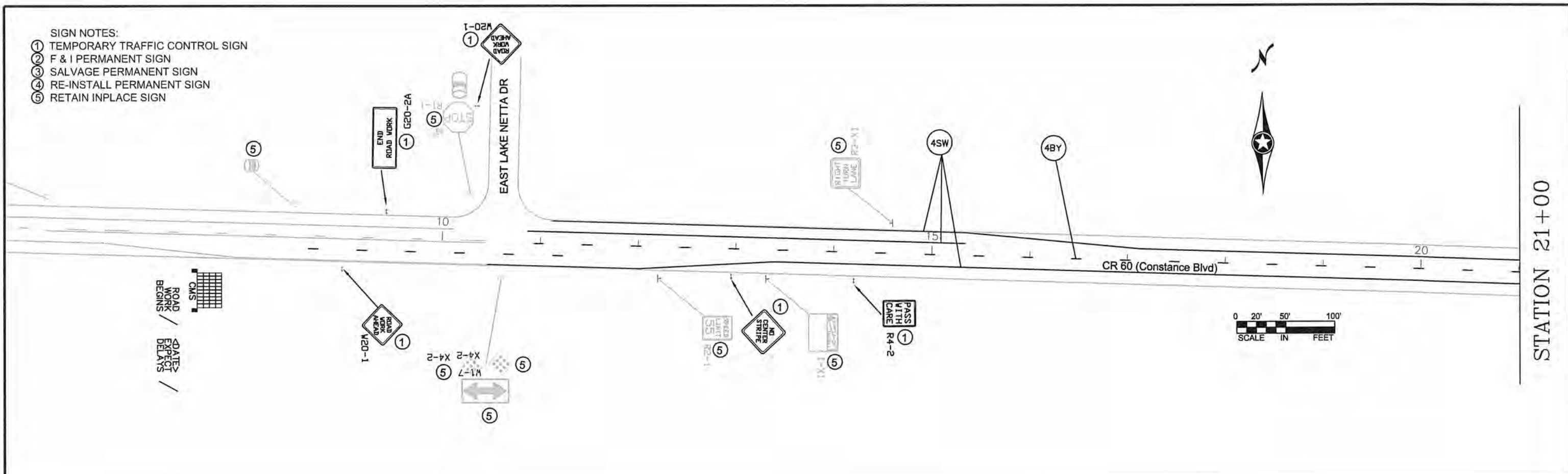

NOTES:

- ALL TRAFFIC CONTROL DEVICES SHALL CONFORM AND BE PLACED IN ACCORDANCE TO THE "MINNESOTA MANUAL ON UNIFORM TRAFFIC CONTROL DEVICES" (MN MUTCD), INCLUDING PART VI, "FIELD MANUAL FOR TEMPORARY TRAFFIC CONTROL ZONE LAYOUTS".
- CONTRACTOR SHALL COMPLY WITH THE LONGITUDINAL DROP-OFF GUIDELINES AS PER THE FIELD MANUAL.
- LOCATIONS OF PAVEMENT MARKINGS ARE APPROXIMATE. EXACT LOCATIONS WILL BE DETERMINED IN THE FIELD BY THE ENGINEER.
- CONTRACTOR SHALL SUPPLY AND INSTALL THE PORTABLE CHANGEABLE MESSAGE SIGN (CMS) A MINIMUM OF SEVEN DAYS PRIOR TO ACTUAL COMMENCEMENT OF ROAD WORK, TO A LOCATION AS SPECIFIED BY THE ENGINEER. SIGNS TO BE REMOVED WHEN ROAD WORK BEGINS. PAYMENT SHALL BE MADE AS PER ITEM 2563.613 PORTABLE CHANGEABLE MESSAGE SIGN BY THE UNIT/DAY.
- CONTRACTOR SHALL SUPPLY AND ERECT THE TEMPORARY TRAFFIC CONTROL SIGNS AS SHOWN ON THIS DRAWING AND DETAILED IN THE SPECIAL PROVISIONS FROM THE TIME WORK COMMENCES ON THIS ROADWAY UNTIL THIS ROADWAY IS PERMANENTLY STRIPED. ALL NECESSARY TEMPORARY TRAFFIC CONTROL SIGNS SHALL BE PAID FOR AS PART OF TRAFFIC CONTROL LUMP SUM.
- ALL PERMANENT STRIPING AND PAVEMENT MESSAGES SHALL BE PLACED WITHIN 72 HOURS OF MAINLINE PAVING.
- ANY REQUIRED PERMANENT SIGNING SHALL BE INSTALLED THE SAME DAY AS PERMANENT STRIPING
- ALL EXISTING SIGNING SHALL REMAIN IN PLACE DURING CONSTRUCTION. ALL SALVAGED AND REINSTALLED SIGNS SHALL BE INSTALLED ON TEMPORARY SUPPORTS UNTIL THE PERMANENT INSTALLATION CAN BE MADE. THIS WILL BE CONSIDERED AS INCIDENTAL TO INSTALL SIGN TYPE C.

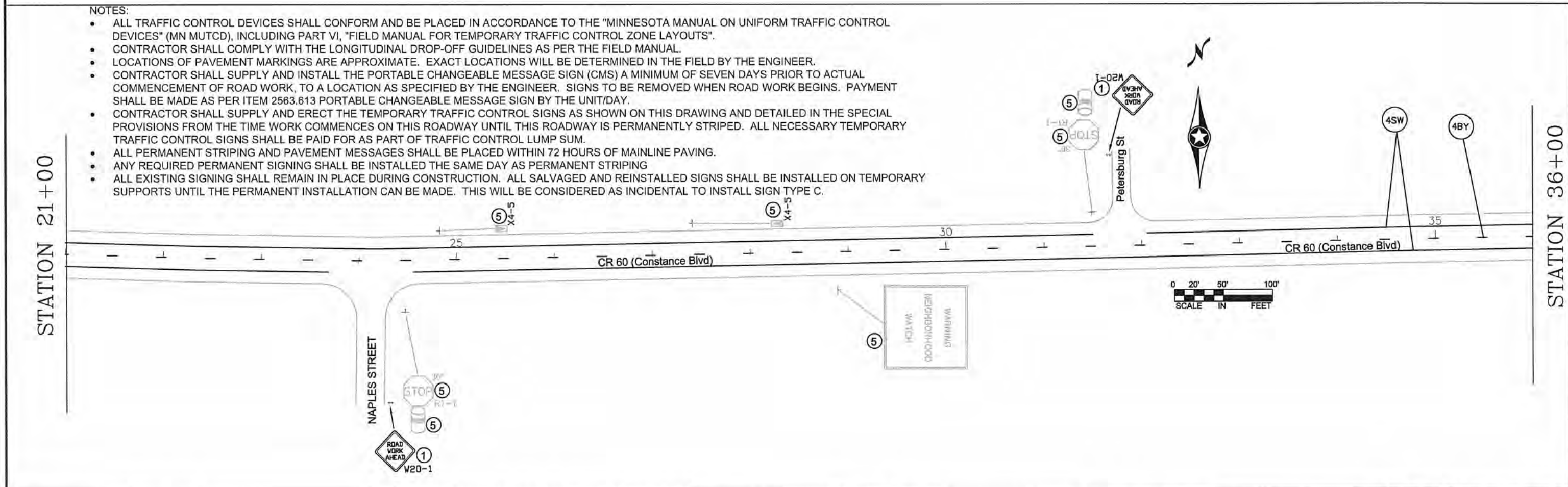

NO	DATE	BY	CKD	APPR	REVISION

I HEREBY CERTIFY THAT THIS PLAN WAS PREPARED BY ME OR UNDER MY DIRECT SUPERVISION AND THAT I AM A DULY REGISTERED PROFESSIONAL ENGINEER UNDER THE LAWS OF THE STATE OF MINNESOTA.

PRINT NAME: MATTHEW J. JOHN

SIGNATURE: *Matthew J. John*

DATE: 4/6/2016 REG. NO. 51639

DRAWN BY: RLB DATE: 2/17/16

DESIGN BY: RLB DATE: 2/17/16

CHECKED BY: JR DATE: 2/17/16

ANOKA COUNTY
HIGHWAY DEPT.

STATE PROJECT NO. _____

STATE AID PROJECT NO. _____

STATE AID PROJECT NO. _____

COUNTY PROJECT NO. 16-13-60

TEMPORARY SIGNING,
PERMANENT SIGNING
AND STRIPING

Sheet 12 of 16 Sheets

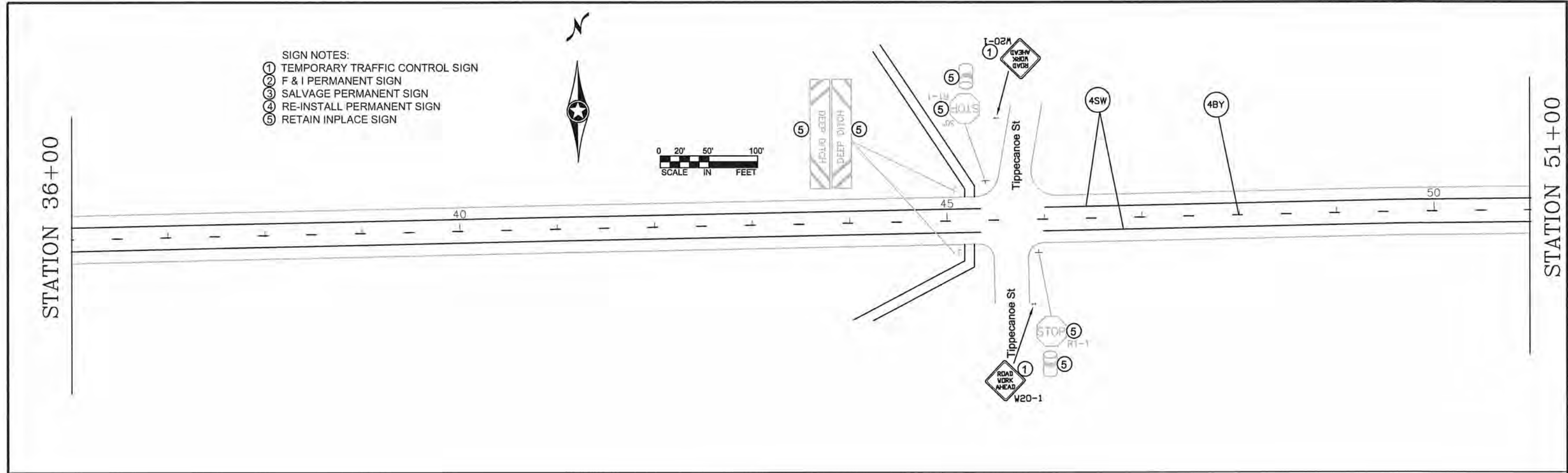

- SIGN NOTES:
- ① TEMPORARY TRAFFIC CONTROL SIGN
 - ② F & I PERMANENT SIGN
 - ③ SALVAGE PERMANENT SIGN
 - ④ RE-INSTALL PERMANENT SIGN
 - ⑤ RETAIN INPLACE SIGN

NOTES:

- ALL TRAFFIC CONTROL DEVICES SHALL CONFORM AND BE PLACED IN ACCORDANCE TO THE "MINNESOTA MANUAL ON UNIFORM TRAFFIC CONTROL DEVICES" (MN MUTCD), INCLUDING PART VI, "FIELD MANUAL FOR TEMPORARY TRAFFIC CONTROL ZONE LAYOUTS".
- CONTRACTOR SHALL COMPLY WITH THE LONGITUDINAL DROP-OFF GUIDELINES AS PER THE FIELD MANUAL.
- LOCATIONS OF PAVEMENT MARKINGS ARE APPROXIMATE. EXACT LOCATIONS WILL BE DETERMINED IN THE FIELD BY THE ENGINEER.
- CONTRACTOR SHALL SUPPLY AND INSTALL THE PORTABLE CHANGEABLE MESSAGE SIGN (CMS) A MINIMUM OF SEVEN DAYS PRIOR TO ACTUAL COMMENCEMENT OF ROAD WORK, TO A LOCATION AS SPECIFIED BY THE ENGINEER. SIGNS TO BE REMOVED WHEN ROAD WORK BEGINS. PAYMENT SHALL BE MADE AS PER ITEM 2563.613 PORTABLE CHANGEABLE MESSAGE SIGN BY THE UNIT/DAY.
- CONTRACTOR SHALL SUPPLY AND ERECT THE TEMPORARY TRAFFIC CONTROL SIGNS AS SHOWN ON THIS DRAWING AND DETAILED IN THE SPECIAL PROVISIONS FROM THE TIME WORK COMMENCES ON THIS ROADWAY UNTIL THIS ROADWAY IS PERMANENTLY STRIPED. ALL NECESSARY TEMPORARY TRAFFIC CONTROL SIGNS SHALL BE PAID FOR AS PART OF TRAFFIC CONTROL LUMP SUM.
- ALL PERMANENT STRIPING AND PAVEMENT MESSAGES SHALL BE PLACED WITHIN 72 HOURS OF MAINLINE PAVING.
- ANY REQUIRED PERMANENT SIGNING SHALL BE INSTALLED THE SAME DAY AS PERMANENT STRIPING
- ALL EXISTING SIGNING SHALL REMAIN IN PLACE DURING CONSTRUCTION. ALL SALVAGED AND REINSTALLED SIGNS SHALL BE INSTALLED ON TEMPORARY SUPPORTS UNTIL THE PERMANENT INSTALLATION CAN BE MADE. THIS WILL BE CONSIDERED AS INCIDENTAL TO INSTALL SIGN TYPE C.

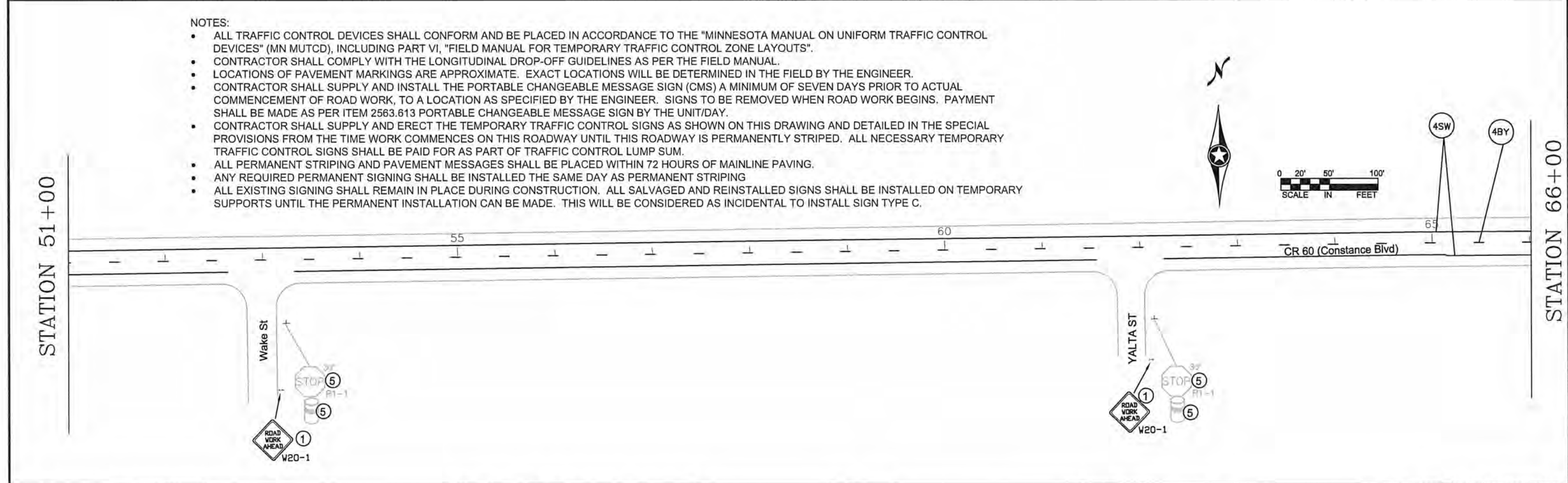

NO	DATE	BY	CKD	APPR	REVISION

NAME: P:\16-01-00\CR 60\base\Traffic\Signing_Striplng.dwg

I HEREBY CERTIFY THAT THIS PLAN WAS PREPARED BY ME OR UNDER MY DIRECT SUPERVISION AND THAT I AM A DULY REGISTERED PROFESSIONAL ENGINEER UNDER THE LAWS OF THE STATE OF MINNESOTA.

PRINT NAME: MATTHEW J. JOHN

SIGNATURE: *Matthew J. John*

DATE: 4/6/2016 REG. NO. 51639

DRAWN BY: RLB DATE: 2/17/16

DESIGN BY: RLB DATE: 2/17/16

CHECKED BY: JR DATE: 2/17/16

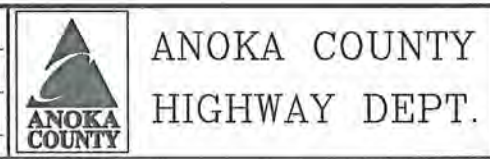

STATE PROJECT NO. _____

STATE AID PROJECT NO. _____

STATE AID PROJECT NO. _____

COUNTY PROJECT NO. 16-13-60

TEMPORARY SIGNING,
PERMANENT SIGNING
AND STRIPING

Sheet 13 of 16 Sheets

- SIGN NOTES:
- ① TEMPORARY TRAFFIC CONTROL SIGN
 - ② F & I PERMANENT SIGN
 - ③ SALVAGE PERMANENT SIGN
 - ④ RE-INSTALL PERMANENT SIGN
 - ⑤ RETAIN INPLACE SIGN

STATION 66+00

STATION 81+00

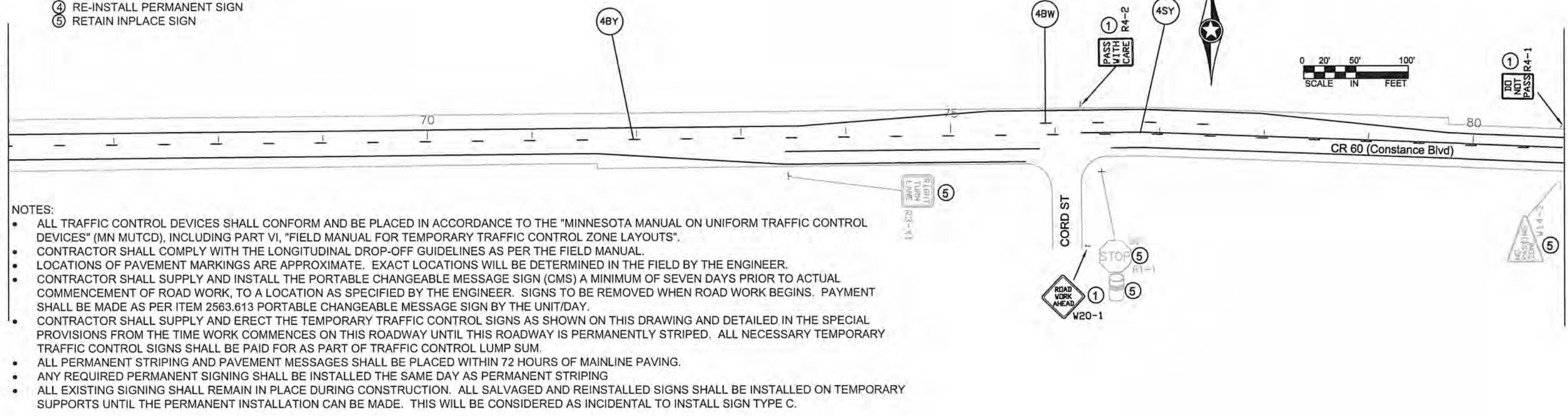

NOTES:

- ALL TRAFFIC CONTROL DEVICES SHALL CONFORM AND BE PLACED IN ACCORDANCE TO THE "MINNESOTA MANUAL ON UNIFORM TRAFFIC CONTROL DEVICES" (MN MUTCD), INCLUDING PART VI, "FIELD MANUAL FOR TEMPORARY TRAFFIC CONTROL ZONE LAYOUTS".
- CONTRACTOR SHALL COMPLY WITH THE LONGITUDINAL DROP-OFF GUIDELINES AS PER THE FIELD MANUAL.
- LOCATIONS OF PAVEMENT MARKINGS ARE APPROXIMATE. EXACT LOCATIONS WILL BE DETERMINED IN THE FIELD BY THE ENGINEER.
- CONTRACTOR SHALL SUPPLY AND INSTALL THE PORTABLE CHANGEABLE MESSAGE SIGN (CMS) A MINIMUM OF SEVEN DAYS PRIOR TO ACTUAL COMMENCEMENT OF ROAD WORK, TO A LOCATION AS SPECIFIED BY THE ENGINEER. SIGNS TO BE REMOVED WHEN ROAD WORK BEGINS. PAYMENT SHALL BE MADE AS PER ITEM 2563.613 PORTABLE CHANGEABLE MESSAGE SIGN BY THE UNIT/DAY.
- CONTRACTOR SHALL SUPPLY AND ERECT THE TEMPORARY TRAFFIC CONTROL SIGNS AS SHOWN ON THIS DRAWING AND DETAILED IN THE SPECIAL PROVISIONS FROM THE TIME WORK COMMENCES ON THIS ROADWAY UNTIL THIS ROADWAY IS PERMANENTLY STRIPED. ALL NECESSARY TEMPORARY TRAFFIC CONTROL SIGNS SHALL BE PAID FOR AS PART OF TRAFFIC CONTROL LUMP SUM.
- ALL PERMANENT STRIPING AND PAVEMENT MESSAGES SHALL BE PLACED WITHIN 72 HOURS OF MAINLINE PAVING.
- ANY REQUIRED PERMANENT SIGNING SHALL BE INSTALLED THE SAME DAY AS PERMANENT STRIPING
- ALL EXISTING SIGNING SHALL REMAIN IN PLACE DURING CONSTRUCTION. ALL SALVAGED AND REINSTALLED SIGNS SHALL BE INSTALLED ON TEMPORARY SUPPORTS UNTIL THE PERMANENT INSTALLATION CAN BE MADE. THIS WILL BE CONSIDERED AS INCIDENTAL TO INSTALL SIGN TYPE C.

STATION 81+00

STATION 96+00

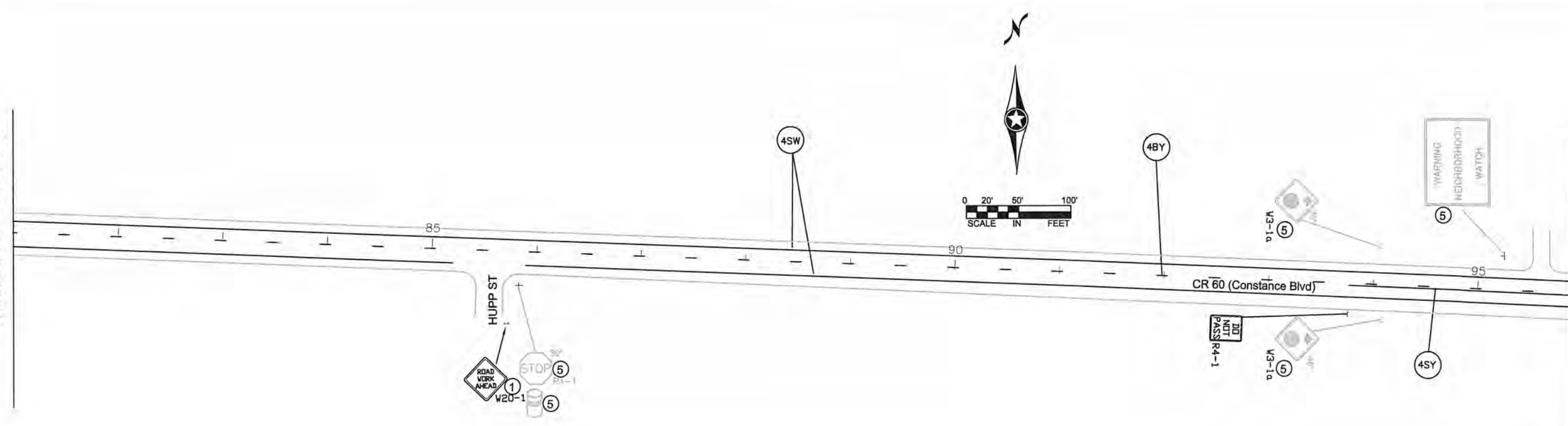

I HEREBY CERTIFY THAT THIS PLAN WAS PREPARED BY ME OR UNDER MY DIRECT SUPERVISION AND THAT I AM A DULY REGISTERED PROFESSIONAL ENGINEER UNDER THE LAWS OF THE STATE OF MINNESOTA.
 PRINT NAME: MATTHEW J. JOHN
 SIGNATURE: *Matthew J. John*
 DATE: 4/6/2016 REG. NO. 51639

DRAWN BY: RLB DATE: 2/17/16
 DESIGN BY: RLB DATE: 2/17/16
 CHECKED BY: JR DATE: 2/17/16



ANOKA COUNTY
 HIGHWAY DEPT.

STATE PROJECT NO. _____
 STATE AID PROJECT NO. _____
 STATE AID PROJECT NO. _____
 COUNTY PROJECT NO. 16-13-60

TEMPORARY SIGNING,
 PERMANENT SIGNING
 AND STRIPING
 Sheet 14 of 16 Sheets

NO	DATE	BY	CKD	APPR	REVISION

NAME: P:\16-01-00\CR 60\base\Traffic\Signing_Striping.dwg

STATION 96+00

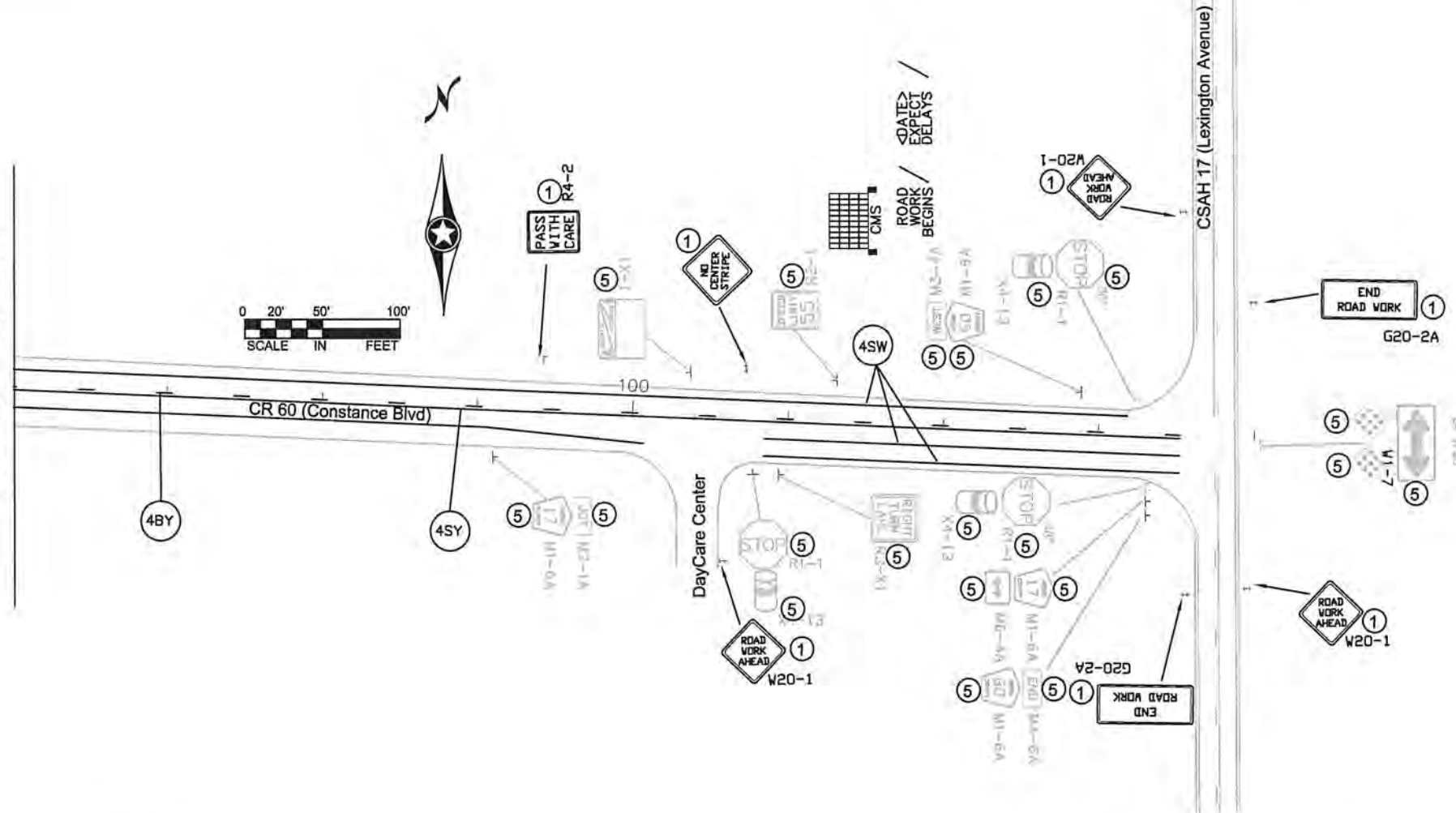
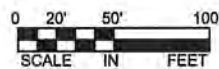

- SIGN NOTES:
- ① TEMPORARY TRAFFIC CONTROL SIGN
 - ② F & I PERMANENT SIGN
 - ③ SALVAGE PERMANENT SIGN
 - ④ RE-INSTALL PERMANENT SIGN
 - ⑤ RETAIN INPLACE SIGN

- NOTES:
- ALL TRAFFIC CONTROL DEVICES SHALL CONFORM AND BE PLACED IN ACCORDANCE TO THE "MINNESOTA MANUAL ON UNIFORM TRAFFIC CONTROL DEVICES" (MN MUTCD), INCLUDING PART VI, "FIELD MANUAL FOR TEMPORARY TRAFFIC CONTROL ZONE LAYOUTS".
 - CONTRACTOR SHALL COMPLY WITH THE LONGITUDINAL DROP-OFF GUIDELINES AS PER THE FIELD MANUAL.
 - LOCATIONS OF PAVEMENT MARKINGS ARE APPROXIMATE. EXACT LOCATIONS WILL BE DETERMINED IN THE FIELD BY THE ENGINEER.
 - CONTRACTOR SHALL SUPPLY AND INSTALL THE PORTABLE CHANGEABLE MESSAGE SIGN (CMS) A MINIMUM OF SEVEN DAYS PRIOR TO ACTUAL COMMENCEMENT OF ROAD WORK, TO A LOCATION AS SPECIFIED BY THE ENGINEER. SIGNS TO BE REMOVED WHEN ROAD WORK BEGINS. PAYMENT SHALL BE MADE AS PER ITEM 2563.613 PORTABLE CHANGEABLE MESSAGE SIGN BY THE UNIT/DAY.
 - CONTRACTOR SHALL SUPPLY AND ERECT THE TEMPORARY TRAFFIC CONTROL SIGNS AS SHOWN ON THIS DRAWING AND DETAILED IN THE SPECIAL PROVISIONS FROM THE TIME WORK COMMENCES ON THIS ROADWAY UNTIL THIS ROADWAY IS PERMANENTLY STRIPED. ALL NECESSARY TEMPORARY TRAFFIC CONTROL SIGNS SHALL BE PAID FOR AS PART OF TRAFFIC CONTROL LUMP SUM.
 - ALL PERMANENT STRIPING AND PAVEMENT MESSAGES SHALL BE PLACED WITHIN 72 HOURS OF MAINLINE PAVING.
 - ANY REQUIRED PERMANENT SIGNING SHALL BE INSTALLED THE SAME DAY AS PERMANENT STRIPING
 - ALL EXISTING SIGNING SHALL REMAIN IN PLACE DURING CONSTRUCTION. ALL SALVAGED AND REINSTALLED SIGNS SHALL BE INSTALLED ON TEMPORARY SUPPORTS UNTIL THE PERMANENT INSTALLATION CAN BE MADE. THIS WILL BE CONSIDERED AS INCIDENTAL TO INSTALL SIGN TYPE C.

I HEREBY CERTIFY THAT THIS PLAN WAS PREPARED BY ME OR UNDER MY DIRECT SUPERVISION AND THAT I AM A DULY REGISTERED PROFESSIONAL ENGINEER UNDER THE LAWS OF THE STATE OF MINNESOTA.
 PRINT NAME: MATTHEW J. JOHN
 SIGNATURE: *Matthew J. John*
 DATE: 4/6/2016 REG. NO. 51639

DRAWN BY: RLB DATE: 2/17/16
 DESIGN BY: RLB DATE: 2/17/16
 CHECKED BY: JIR DATE: 2/17/16



ANOKA COUNTY
 HIGHWAY DEPT.

STATE PROJECT NO. _____
 STATE AID PROJECT NO. _____
 STATE AID PROJECT NO. _____
 COUNTY PROJECT NO. 16-13-60

TEMPORARY SIGNING,
 PERMANENT SIGNING
 AND STRIPING
 Sheet 15 of 16 Sheets

NO	DATE	BY	CKD	APPR	REVISION

NAME: P:\16-01-00\CR 60\base\Traffic\Signing_Striping.dwg

TEMPORARY TRAFFIC CONTROL SIGNS

M.U.T.C.D. CODE	SIZE	PANEL AREA FT. ²	INSERT	QUANTITY		MOUNTING HEIGHT TO PAVEMENT EDGE) FT.
					No. POST	
W8-12	48" x 48"	16.00		2	2	7.0'
R4-1	24" x 30"	5.00		2	1	7.0'
R4-2	24" x 30"	5.00		3	1	7.0'
G20-2A	48" x 24"	8.00		3	2	7.0'
W8-1A	48" x 48"	16.00		AS NEEDED		
W8-1A	48" x 48"	16.00		AS NEEDED		
W8-8	48" x 48"	16.00		AS NEEDED		
W8-9	48" x 48"	16.00		AS NEEDED		
	48" x 48"	16.00		AS NEEDED		
W8-11	48" x 48"	16.00		AS NEEDED		
W20-1	48" x 48"	16.00		AS NEEDED (ESTIMATED 13)		
CMS sign to be installed a minimum of seven days prior to actual commencement of road work. Signs to be removed when road work begins.				2		

NOTES:

- ALL TRAFFIC CONTROL DEVICES SHALL CONFORM AND BE PLACED IN ACCORDANCE TO THE "MINNESOTA MANUAL ON UNIFORM TRAFFIC CONTROL DEVICES" (MN MUTCD), INCLUDING PART VI, "FIELD MANUAL FOR TEMPORARY TRAFFIC CONTROL ZONE LAYOUTS".
- CONTRACTOR SHALL COMPLY WITH THE LONGITUDINAL DROP-OFF GUIDELINES AS PER THE FIELD MANUAL.
- LOCATIONS OF PAVEMENT MARKINGS ARE APPROXIMATE. EXACT LOCATIONS WILL BE DETERMINED IN THE FIELD BY THE ENGINEER.
- CONTRACTOR SHALL SUPPLY AND INSTALL THE PORTABLE CHANGEABLE MESSAGE SIGN (CMS) A MINIMUM OF SEVEN DAYS PRIOR TO ACTUAL COMMENCEMENT OF ROAD WORK, TO A LOCATION AS SPECIFIED BY THE ENGINEER. SIGNS TO BE REMOVED WHEN ROAD WORK BEGINS. PAYMENT SHALL BE MADE AS PER ITEM 2563.613 PORTABLE CHANGEABLE MESSAGE SIGN BY THE UNIT/DAY.
- CONTRACTOR SHALL SUPPLY AND ERECT THE TEMPORARY TRAFFIC CONTROL SIGNS AS SHOWN ON THIS DRAWING AND DETAILED IN THE SPECIAL PROVISIONS FROM THE TIME WORK COMMENCES ON THIS ROADWAY UNTIL THIS ROADWAY IS PERMANENTLY STRIPED. ALL NECESSARY TEMPORARY TRAFFIC CONTROL SIGNS SHALL BE PAID FOR AS PART OF TRAFFIC CONTROL LUMP SUM.
- ALL PERMANENT STRIPING AND PAVEMENT MESSAGES SHALL BE PLACED WITHIN 72 HOURS OF MAINLINE PAVING.
- ANY REQUIRED PERMANENT SIGNING SHALL BE INSTALLED THE SAME DAY AS PERMANENT STRIPING
- ALL EXISTING SIGNING SHALL REMAIN IN PLACE DURING CONSTRUCTION. ALL SALVAGED AND REINSTALLED SIGNS SHALL BE INSTALLED ON TEMPORARY SUPPORTS UNTIL THE PERMANENT INSTALLATION CAN BE MADE. THIS WILL BE CONSIDERED AS INCIDENTAL TO INSTALL SIGN TYPE C.

CHANGEABLE MESSAGE BOARD - MESSAGE SEQUENCE LAYOUT

		R	O	A	D		
		W	O	R	K		
		B	E	G	I	N	S

	<	D	A	T	E	>	
		E	X	P	E	C	T
		D	E	L	A	Y	S

CMS sign to be installed a minimum of seven days prior to actual commencement of road work. Signs to be removed when road work begins.

I HEREBY CERTIFY THAT THIS PLAN WAS PREPARED BY ME OR UNDER MY DIRECT SUPERVISION AND THAT I AM A DULY REGISTERED PROFESSIONAL ENGINEER UNDER THE LAWS OF THE STATE OF MINNESOTA.
 PRINT NAME: MATTHEW J. JOHN
 SIGNATURE: *Matthew J. John*
 DATE: 4/6/2016 REG. NO. 51639

DRAWN BY: RLB DATE: 2/17/16
 DESIGN BY: RLB DATE: 2/17/16
 CHECKED BY: JR DATE: 2/17/16



ANOKA COUNTY
 HIGHWAY DEPT.

STATE PROJECT NO. _____
 STATE AID PROJECT NO. _____
 STATE AID PROJECT NO. _____
 COUNTY PROJECT NO. 16-13-60

TRAFFIC CONTROL
 QUANTITY
 Sheet 16 of 16 Sheets