

STATE OF MINNESOTA
 DEPARTMENT OF TRANSPORTATION
 CONSTRUCTION PLAN FOR BITUMINOUS OVERLAY

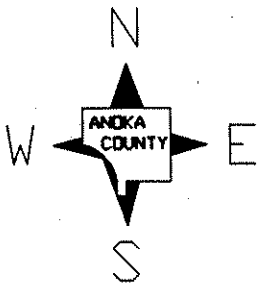

COUNTY STATE AID HIGHWAY NO. _____
 COUNTY ROAD NO. 73
 From C.S.A.H. 24
 To COUNTY LINE (245TH AVE)
 From _____
 To _____
 COUNTY PROJECT NO. 92-21-73

GROSS LENGTH 5770 FEET 1.09 MILES
 BRIDGES LENGTH 0 FEET 0 MILES
 EXCEPTIONS LENGTH 0 FEET 0 MILES
 NET LENGTH 5770 FEET 1.09 MILES

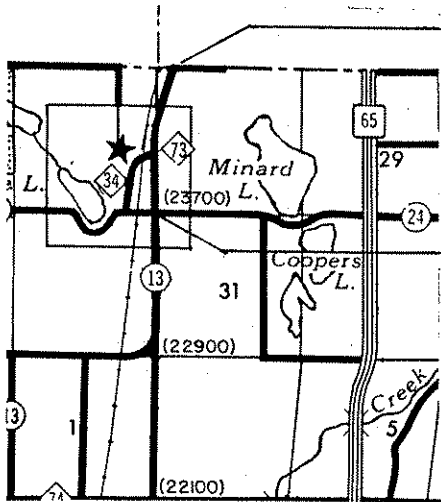

END 92-21-73

BEGIN 92-21-73

DESIGN SPEED

35 & 55 MPH.

ALL APPLICABLE FEDERAL, STATE AND LOCAL LAWS AND ORDINANCES WILL BE COMPLIED WITH IN THE CONSTRUCTION OF THIS PROJECT.

I HEREBY CERTIFY THAT THIS PLAN WAS PREPARED BY ME OR UNDER MY DIRECT SUPERVISION AND THAT I AM A DULY REGISTERED PROFESSIONAL ENGINEER UNDER THE LAWS OF THE STATE OF MINN.

Paul K. Rued
 COUNTY ENGINEER DATE 5-22-92
ANKA COUNTY REG. NO. **6549**

RECOMMENDED FOR APPROVAL _____, 19____
 DISTRICT ENGINEER

RECOMMENDED FOR APPROVAL _____

APPROVED _____, 19____
 STATE AID ENGINEER

COUNTY PROJECT 92-21-73

STATE AID PROJECT _____ (C.R. 73) (CSAH) SHEET 1 OF 4 SHEETS

	ITEM NO	ITEM	UNIT	TOTAL EST. QUANT
①	2331.508	TYPE 41 WEARING COURSE MIXTURE	TON	1349
	2357.502	BITUMINOUS MATERIAL FOR TACK COAT	GAL.	818
	2580.501	TEMPORARY LANE MARKING	RD.STA.	58
②	2123.503	MOTOR GRADER	HOUR	4

- ① INCLUDES 30 TONS FOR STREET APPROACHES AND ENTRANCES
- ② SHOULDER PREPARATION PRIOR TO PAVING

BASIS OF PLANNED QUANTITIES

2331 TYPE 41 WEARING COURSE MIXTURE: 110 LBS/SQ.YD. PER 1"

2357 BITUMINOUS MATERIAL FOR TACK COAT: 0.05 GAL/SQ.YD.

STANDARD DETAIL PLATES	
PLATE NO.	DESCRIPTION
0004 A	SPECIFICATION REFERENCE TO STANDARD PLATES
8000 I	STANDARD BARRICADES

TYPICAL SECTIONS

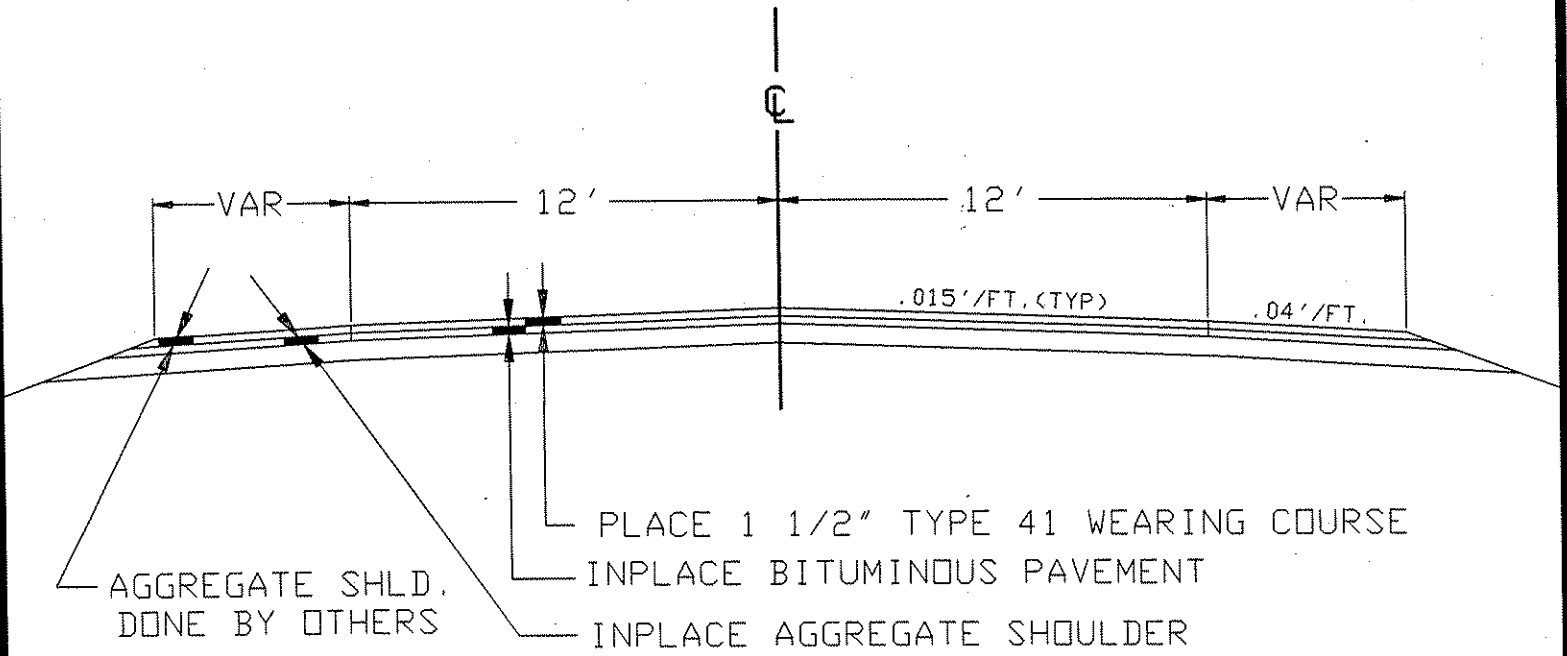

NOTE:

NOT TO SCALE

TYPICAL ENTRANCES

PAVED AND UNPAVED STREETS

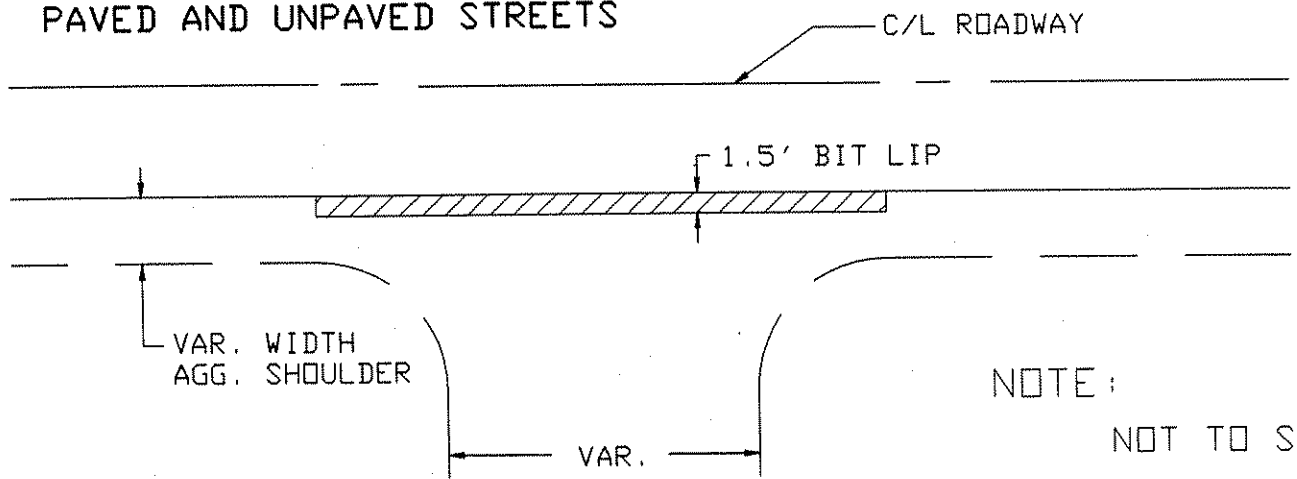

PRIVATE ENTRANCES

