

Date : 6/1/05

Count Number : TMC0509

Location : CSAH 1 (East River Rd.)

@ CR 132 (85th Ave.)

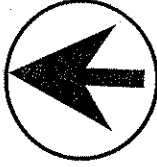

North

CSAH 1

18945

#2

9083	D	45
6782	M	
2256	T	

9862

CR 132

8469

#3

2571	G	4311
25	H	
1715	J	

4158

95

#1

139

44	C	12
	B	10
	A	22

Park Entrance

CSAH 1

8519

#4

17715

	LANES OF APPROACH			TOTAL
	RIGHT TURN LANE	LEFT TURN LANE	THRU LANES	
#1	0	1	1	2
#2	1	1	2	4
#3	1	1	0	2
#4	1	1	2	4

25	M	9196
7279	L	
1892	K	

Anoka County Highway Department  
Traffic Volume and Turning  
Movement Study

Anoka County Highway Department  
Traffic Engineering  
Traffic Volume and Turning Movement Study

File Name : TMC0509  
Site Code : 00000509  
Start Date : 06/01/2005  
Page No : 1

Weather: Sunny and Mild  
Counter: TDC-8  
Counted by: Danielle/Samantha

Groups Printed- Unshifted

Start Time	CSAH 1 Southbound					CR 132 Westbound					CSAH 1 Northbound					PARK ENTRANCE Eastbound					Exclu. Total	Inclu. Total	Int. Total
	Left	Thru	Right	Heavy	App. Total	Left	Thru	Right	Heavy	App. Total	Left	Thru	Right	Heavy	App. Total	Left	Thru	Right	Heavy	App. Total			
06:00	13	174	0	0	187	18	0	8	2	26	0	32	15	1	47	0	0	0	0	0	3	260	263
06:15	15	261	0	0	276	13	0	4	0	17	0	28	8	0	36	0	0	0	0	0	0	329	329
06:30	27	363	0	2	390	22	0	10	1	32	0	30	17	1	47	0	0	0	0	0	4	469	473
06:45	47	414	0	3	461	16	0	17	1	33	0	31	26	5	57	0	0	0	0	0	9	551	560
Total	102	1212	0	5	1314	69	0	39	4	108	0	121	66	7	187	0	0	0	0	0	16	1609	1625
07:00	28	374	0	0	402	28	1	21	3	50	0	60	25	4	85	0	0	0	0	0	7	537	544
07:15	37	420	0	4	457	25	0	12	1	37	0	60	23	2	83	0	0	1	0	1	7	578	585
07:30	37	438	0	5	475	25	0	13	3	38	0	42	26	2	68	0	0	0	0	0	10	581	591
07:45	55	403	0	5	458	20	0	8	2	28	0	55	22	5	77	0	0	0	0	0	12	563	575
Total	157	1635	0	14	1792	98	1	54	9	153	0	217	96	13	313	0	0	1	0	1	36	2259	2295
08:00	34	283	0	6	317	22	0	14	2	36	0	43	19	2	62	0	0	0	0	0	10	415	425
08:15	33	250	0	6	283	17	0	27	0	44	1	36	16	1	53	0	0	0	0	0	7	380	387
08:30	28	171	0	0	199	29	1	24	2	54	1	52	17	5	70	0	0	0	0	0	7	323	330
08:45	37	89	1	8	127	23	0	11	1	34	0	49	19	6	68	0	1	0	0	1	15	230	245
Total	132	793	1	20	926	91	1	76	5	168	2	180	71	14	253	0	1	0	0	1	39	1348	1387
09:00	34	93	0	5	127	19	0	27	7	46	1	47	21	2	69	1	0	0	0	1	14	243	257
09:15	38	70	0	1	108	22	0	12	3	34	0	43	9	3	52	0	0	0	0	0	7	194	201
09:30	34	58	0	9	92	16	0	32	5	48	0	42	20	2	62	0	0	0	0	0	16	202	218
09:45	34	66	2	2	102	12	1	37	1	50	1	34	22	7	57	0	0	0	0	0	10	209	219
Total	140	287	2	17	429	69	1	108	16	178	2	166	72	14	240	1	0	0	0	1	47	848	895
10:00	32	53	0	5	85	15	0	25	4	40	0	40	15	2	55	0	0	1	0	1	11	181	192
10:15	36	53	0	3	89	27	0	16	1	43	0	48	31	4	79	0	0	0	0	0	8	211	219
10:30	33	56	1	4	90	16	1	23	2	40	0	38	14	1	52	1	0	0	0	1	7	183	190
10:45	28	50	1	4	79	20	0	37	1	57	0	58	17	4	75	1	0	0	0	1	9	212	221
Total	129	212	2	16	343	78	1	101	8	180	0	184	77	11	261	2	0	1	0	3	35	787	822
11:00	31	70	0	2	101	22	1	28	2	51	0	57	17	4	74	0	0	0	0	0	8	226	234
11:15	34	48	1	4	83	13	1	35	3	49	0	55	29	7	84	0	1	1	0	2	14	218	232
11:30	35	52	7	8	94	29	2	34	3	65	1	43	26	4	70	0	0	0	0	0	15	229	244
11:45	31	56	0	6	87	38	0	34	1	72	0	67	25	5	92	1	0	1	0	2	12	253	265
Total	131	226	8	20	365	102	4	131	9	237	1	222	97	20	320	1	1	2	0	4	49	926	975
12:00	44	62	1	3	107	31	0	38	2	69	1	62	26	3	89	0	0	0	0	0	8	265	273
12:15	29	58	0	1	87	25	0	32	3	57	0	63	34	2	97	0	0	1	0	1	6	242	248
12:30	38	82	0	2	120	35	3	46	2	84	0	66	32	3	98	0	0	0	0	0	7	302	309
12:45	44	62	0	6	106	22	0	27	2	49	1	60	23	1	84	0	0	0	0	0	9	239	248
Total	155	264	1	12	420	113	3	143	9	259	2	251	115	9	368	0	0	1	0	1	30	1048	1078
13:00	35	52	0	2	87	48	0	48	5	96	1	41	29	2	71	0	0	0	0	0	9	254	263
13:15	37	57	0	3	94	31	1	46	2	78	0	69	36	4	105	0	0	0	0	0	9	277	286
13:30	37	52	0	2	89	24	1	28	1	53	0	67	26	3	93	0	0	0	0	0	6	235	241
13:45	30	59	1	4	90	25	2	53	2	80	0	65	35	6	100	0	0	0	0	0	12	270	282
Total	139	220	1	11	360	128	4	175	10	307	1	242	126	15	369	0	0	0	0	0	36	1036	1072
14:00	34	68	1	3	103	36	0	44	3	80	0	93	29	4	122	1	0	0	0	1	10	306	316
14:15	30	64	0	3	94	21	1	42	1	64	1	93	26	3	120	0	0	0	0	0	7	278	285
14:30	32	79	0	4	111	15	0	53	1	68	0	113	30	3	143	1	0	0	0	1	8	323	331
14:45	38	54	0	6	92	30	0	39	2	69	1	135	43	11	179	0	0	0	0	0	19	340	359
Total	134	265	1	16	400	102	1	178	7	281	2	434	128	21	564	2	0	0	0	2	44	1247	1291
15:00	27	56	1	2	84	24	0	56	2	80	1	188	32	3	221	0	0	1	0	1	7	386	393
15:15	30	81	0	6	111	18	1	44	2	63	1	221	42	7	264	1	0	0	0	1	15	439	454
15:30	39	65	0	4	104	43	0	94	5	137	1	276	44	11	321	0	0	0	0	0	20	562	582
15:45	62	75	1	1	138	25	0	71	0	96	1	352	62	6	415	0	0	0	0	0	7	649	656
Total	158	277	2	13	437	110	1	265	9	376	4	1037	180	27	1221	1	0	1	0	2	49	2036	2085
16:00	60	102	0	2	162	41	1	80	3	122	0	333	42	6	375	0	1	1	0	2	11	661	672
16:15	42	72	1	3	115	30	0	62	0	92	1	360	62	5	423	1	0	0	0	1	8	631	639
16:30	36	62	0	4	98	41	0	86	0	127	0	375	50	4	425	0	0	0	0	0	8	650	658
16:45	56	83	0	1	139	43	0	62	1	105	1	396	70	4	467	0	0	0	0	0	6	711	717
Total	194	319	1	10	514	155	1	290	4	446	2	1464	224	19	1690	1	1	1	0	3	33	2653	2686

Anoka County Highway Department  
Traffic Engineering  
Traffic Volume and Turning Movement Stud

File Name : TMC0509  
Site Code : 00000509  
Start Date : 06/01/2005  
Page No : 2

Weather: Sunny and Mild  
Counter: TDC-8  
Counted by: Danielle/Samantha

Groups Printed- Unshifted

Start Time	CSAH 1 Southbound					CR 132 Westbound					CSAH 1 Northbound					PARK ENTRANCE Eastbound					Exclu. Total	Inclu. Total	Int. Total
	Left	Thru	Right	Heavy	App. Total	Left	Thru	Right	Heavy	App. Total	Left	Thru	Right	Heavy	App. Total	Left	Thru	Right	Heavy	App. Total			
Factor	1.0	1.0	1.0	1.0		1.0	1.0	1.0	1.0		1.0	1.0	1.0	1.0		1.0	1.0	1.0	1.0				
17:00	52	66	0	3	118	47	0	77	2	124	0	411	57	3	468	0	0	0	0	0	8	710	718
17:15	57	73	0	0	130	29	0	76	1	105	0	463	57	3	520	0	0	0	0	0	4	755	759
17:30	50	67	1	4	118	26	1	91	1	118	0	306	61	3	367	0	0	0	0	0	8	603	611
17:45	49	75	8	1	132	34	3	75	0	112	1	278	48	4	327	2	2	0	0	4	5	575	580
Total	208	281	9	8	498	136	4	319	4	459	1	1458	223	13	1682	2	2	0	0	4	25	2643	2668
18:00	41	60	1	2	102	26	0	64	2	90	0	228	35	3	263	1	0	1	0	2	7	457	464
18:15	32	79	5	2	116	33	0	57	1	90	2	169	42	1	213	0	0	2	0	2	4	421	425
18:30	48	53	2	2	103	37	1	52	0	90	2	114	48	2	164	0	2	1	0	3	4	360	364
18:45	33	63	2	0	98	28	0	59	2	87	1	81	34	1	116	1	0	0	0	1	3	302	305
Total	154	255	10	6	419	124	1	232	5	357	5	592	159	7	756	2	2	4	0	8	18	1540	1558
19:00	39	44	0	2	83	33	0	37	0	70	0	91	31	2	122	1	0	0	0	1	4	276	280
19:15	35	42	5	0	82	27	0	42	0	69	0	67	23	1	90	1	0	0	0	1	1	242	243
19:30	38	60	1	0	99	31	0	39	1	70	2	53	24	0	79	1	0	0	0	1	1	249	250
19:45	30	45	1	1	76	29	0	35	1	64	0	49	26	0	75	7	0	1	0	8	2	223	225
Total	142	191	7	3	340	120	0	153	2	273	2	260	104	3	366	10	0	1	0	11	8	990	998
20:00	33	46	0	0	79	40	0	44	0	84	0	59	21	1	80	0	0	0	0	0	1	243	244
20:15	24	54	0	0	78	17	0	50	0	67	0	71	26	0	97	0	0	0	0	0	0	242	242
20:30	22	45	0	0	67	32	0	43	0	75	1	67	18	0	86	0	2	0	0	2	0	230	230
20:45	21	50	0	2	71	30	1	48	1	79	0	59	16	0	75	0	0	0	0	0	3	225	228
Total	100	195	0	2	295	119	1	185	1	305	1	256	81	1	338	0	2	0	0	2	4	940	944
21:00	20	37	0	0	57	38	1	43	1	82	0	59	30	2	89	0	1	0	0	1	3	229	232
21:15	29	45	0	1	74	26	0	29	0	55	0	48	15	0	63	0	0	0	0	0	1	192	193
21:30	17	42	0	0	59	23	0	33	0	56	0	45	20	0	65	0	0	0	0	0	0	180	180
21:45	15	26	0	0	41	14	0	17	1	31	0	43	8	0	51	0	0	0	0	0	1	123	124
Total	81	150	0	1	231	101	1	122	2	224	0	195	73	2	268	0	1	0	0	1	5	724	729
Grand Total	225	678	45	174	9083	171	25	257	104	4311	25	727	189	196	9196	22	10	12	0	44	474	22634	23108
Approch %	24.8	74.7	0.5			39.8	0.6	59.6			0.3	79.2	20.6			50.0	22.7	27.3					
Total %	10.0	30.0	0.2	40.1		7.6	0.1	11.4	19.0		0.1	32.2	8.4	40.6		0.1	0.0	0.1	0.2		2.1	97.9	

**ANOKA COUNTY HIGHWAY  
PC-WARRANTS  
TRAFFIC SIGNAL WARRANT ANALYSIS**

Study Name : TMC0509  
Study Date : 06/03/05  
Page No. : 1

**Signal Warrants - Summary**

**Major Street Approaches**

**Northbound: CSAH 1**  
Number of Lanes: 2  
Approach Speed: 45  
Total Approach Volume: 9,196

**Southbound: CSAH 1**  
Number of Lanes: 2  
Approach Speed: 45  
Total Approach Volume: 9,083

**Minor Street Approaches**

**Eastbound: PARK ENTRANCE**  
Number of Lanes: 2  
  
Total Approach Volume: 44

**Westbound: CR 132**  
Number of Lanes: 2  
  
Total Approach Volume: 4,311

**Warrant Summary** (Rural values apply.)

<b>Warrant 1 - Eight Hour Vehicular Volumes</b> .....	<b>Satisfied</b>
<b>Warrant 1A - Minimum Vehicular Volume</b> ..... <b>Satisfied</b>	
Required volumes reached for 15 hours, 8 are needed	
<b>Warrant 1B - Interruption of Continuous Traffic</b> ..... <b>Satisfied</b>	
Required volumes reached for 14 hours, 8 are needed	
<b>Warrant 1 A&amp;B - Combination of Warrants</b> ..... <b>Satisfied</b>	
Required volumes reached for 14 hours, 8 are needed	
<b>Warrant 2 - Four Hour Volumes</b> .....	<b>Satisfied</b>
Number of hours (15) volumes exceed minimum >= minimum required (4).	
<b>Warrant 3 - Peak Hour</b> .....	<b>Satisfied</b>
<b>Warrant 3A - Peak Hour Delay</b> ..... <b>Satisfied</b>	
Number of hours (53) volumes exceed minimum >= required (1). Delay data not evaluated.	
<b>Warrant 3B - Peak Hour Volumes</b> ..... <b>Satisfied</b>	
Volumes exceed minimums for at least one hour.	
<b>Warrant 4 - Pedestrian Volumes</b> .....	<b>Not Evaluated</b>
<b>Warrant 5 - School Crossing</b> .....	<b>Not Evaluated</b>
<b>Warrant 6 - Coordinated Signal System</b> .....	<b>Not Evaluated</b>
<b>Warrant 7 - Crash Experience</b> .....	<b>Not Evaluated</b>
<b>Warrant 8 - Roadway Network</b> .....	<b>Not Evaluated</b>

# ANOKA COUNTY HIGHWAY PC-WARRANTS TRAFFIC SIGNAL WARRANT ANALYSIS

Study Name : TMC0509  
Study Date : 06/03/05  
Page No. : 2

## Signal Warrants - Summary

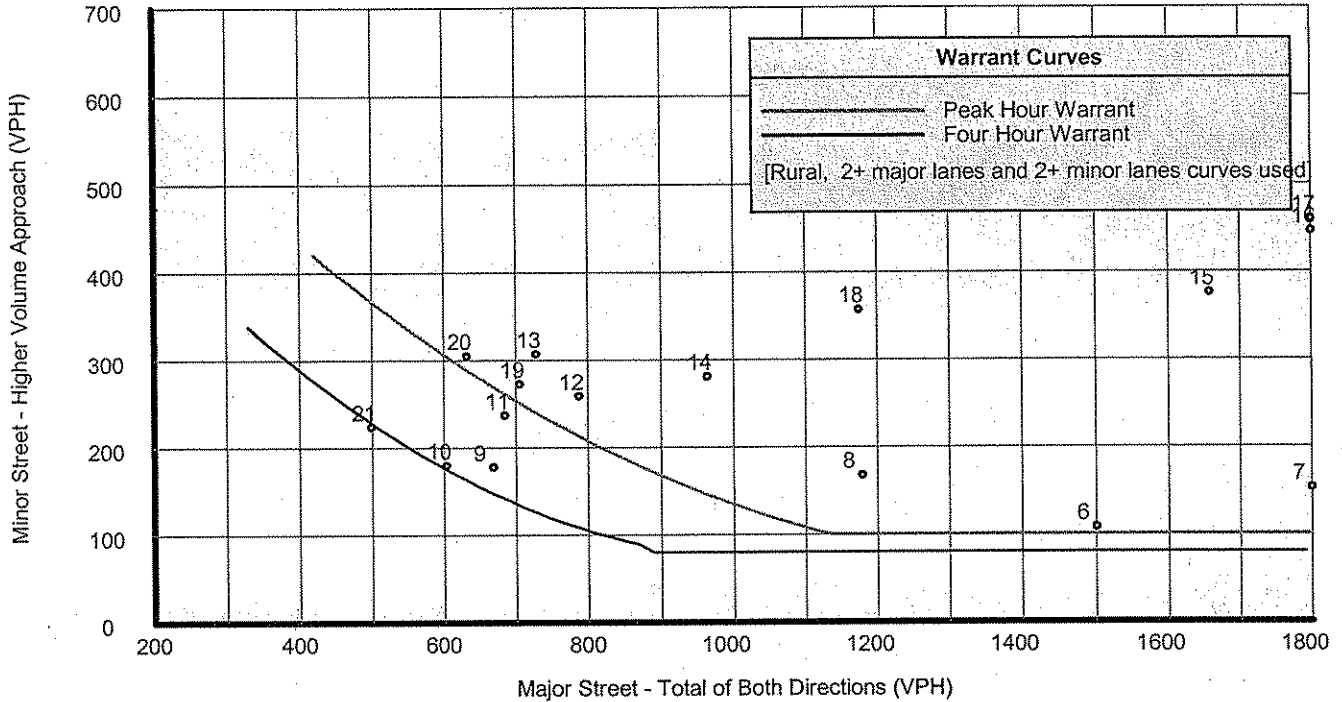

### Analysis of 8-Hour Volume Warrants:

Hour Begin	Major Total	Higher Minor		War-1A			War-1B			War-1A&B		
		Vol	Dir	Major Crit	Minor Crit	Meets?	Major Crit	Minor Crit	Meets?	Major Crit	Minor Crit	Meets?
00:00	0	0	EB	420-No	140-No	---	630-No	70-No	---	504-No	112-No	---
01:00	0	0	EB	420-No	140-No	---	630-No	70-No	---	504-No	112-No	---
02:00	0	0	EB	420-No	140-No	---	630-No	70-No	---	504-No	112-No	---
03:00	0	0	EB	420-No	140-No	---	630-No	70-No	---	504-No	112-No	---
04:00	0	0	EB	420-No	140-No	---	630-No	70-No	---	504-No	112-No	---
05:00	0	0	EB	420-No	140-No	---	630-No	70-No	---	504-No	112-No	---
06:00	1,501	108	WB	420-Yes	140-No	Major	630-Yes	70-Yes	Both	504-Yes	112-No	Major
07:00	2,105	153	WB	420-Yes	140-Yes	Both	630-Yes	70-Yes	Both	504-Yes	112-Yes	Both
08:00	1,179	168	WB	420-Yes	140-Yes	Both	630-Yes	70-Yes	Both	504-Yes	112-Yes	Both
09:00	669	178	WB	420-Yes	140-Yes	Both	630-Yes	70-Yes	Both	504-Yes	112-Yes	Both
10:00	604	180	WB	420-Yes	140-Yes	Both	630-No	70-Yes	Minor	504-Yes	112-Yes	Both
11:00	685	237	WB	420-Yes	140-Yes	Both	630-Yes	70-Yes	Both	504-Yes	112-Yes	Both
12:00	788	259	WB	420-Yes	140-Yes	Both	630-Yes	70-Yes	Both	504-Yes	112-Yes	Both
13:00	729	307	WB	420-Yes	140-Yes	Both	630-Yes	70-Yes	Both	504-Yes	112-Yes	Both
14:00	964	281	WB	420-Yes	140-Yes	Both	630-Yes	70-Yes	Both	504-Yes	112-Yes	Both
15:00	1,658	376	WB	420-Yes	140-Yes	Both	630-Yes	70-Yes	Both	504-Yes	112-Yes	Both
16:00	2,204	446	WB	420-Yes	140-Yes	Both	630-Yes	70-Yes	Both	504-Yes	112-Yes	Both
17:00	2,180	459	WB	420-Yes	140-Yes	Both	630-Yes	70-Yes	Both	504-Yes	112-Yes	Both
18:00	1,175	357	WB	420-Yes	140-Yes	Both	630-Yes	70-Yes	Both	504-Yes	112-Yes	Both
19:00	706	273	WB	420-Yes	140-Yes	Both	630-Yes	70-Yes	Both	504-Yes	112-Yes	Both
20:00	633	305	WB	420-Yes	140-Yes	Both	630-Yes	70-Yes	Both	504-Yes	112-Yes	Both
21:00	499	224	WB	420-Yes	140-Yes	Both	630-No	70-Yes	Minor	504-No	112-Yes	Minor
22:00	0	0	EB	420-No	140-No	---	630-No	70-No	---	504-No	112-No	---
23:00	0	0	EB	420-No	140-No	---	630-No	70-No	---	504-No	112-No	---

**ANOKA COUNTY HIGHWAY  
PC-WARRANTS  
TRAFFIC SIGNAL WARRANT ANALYSIS**

Study Name : TMC0509  
Study Date : 06/03/05

**Multi-Way Stop Warrant Report**

**Major Street Approaches**

**Northbound: CSAH 1**  
Total Approach Volume: 9,196  
Approach Speed: 45

**Southbound: CSAH 1**  
Total Approach Volume: 9,083  
Approach Speed: 45

**Minor Street Approaches**

**Eastbound: PARK ENTRANCE**  
Total Approach Volume: 44

**Westbound: CR 132**  
Total Approach Volume: 4,311

**Warrant Summary**

<b>Criteria A - Interim Measure</b> .....	Not Evaluated
If traffic signals are justified, stop signs can be installed as an interim measure.	
<b>Criteria B - Crash Experience</b> .....	Not Evaluated
<b>Criteria C - Minimum Volumes and Delays</b> .....	Satisfied
Delay data not evaluated Required volumes reached for 15 hours, 8 are needed	
<b>Criteria D - 80% of Volumes, Delays, and Crashes</b> .....	Not Evaluated
Delay data not evaluated Required volumes reached for 0 hours, 8 are needed	

**Analysis of 8-Hour Volume Warrants:**

Time	Major Total	Minor Total	Crit C			Crit D		
			Major	Minor Crit	Meets?	Major Crit	Minor Crit	Meets?
00:00 - 01:00	0	0	210-No	140-No	No	240-No	160-No	No
01:00 - 02:00	0	0	210-No	140-No	No	240-No	160-No	No
02:00 - 03:00	0	0	210-No	140-No	No	240-No	160-No	No
03:00 - 04:00	0	0	210-No	140-No	No	240-No	160-No	No
04:00 - 05:00	0	0	210-No	140-No	No	240-No	160-No	No
05:00 - 06:00	0	0	210-No	140-No	No	240-No	160-No	No
06:00 - 07:00	1,501	108	210-Yes	140-No	Major	240-Yes	160-No	Major
07:00 - 08:00	2,105	154	210-Yes	140-Yes	Both	240-Yes	160-No	Major
08:00 - 09:00	1,179	169	210-Yes	140-Yes	Both	240-Yes	160-Yes	Both
09:00 - 10:00	669	179	210-Yes	140-Yes	Both	240-Yes	160-Yes	Both
10:00 - 11:00	604	183	210-Yes	140-Yes	Both	240-Yes	160-Yes	Both
11:00 - 12:00	685	241	210-Yes	140-Yes	Both	240-Yes	160-Yes	Both
12:00 - 13:00	788	260	210-Yes	140-Yes	Both	240-Yes	160-Yes	Both
13:00 - 14:00	729	307	210-Yes	140-Yes	Both	240-Yes	160-Yes	Both
14:00 - 15:00	964	283	210-Yes	140-Yes	Both	240-Yes	160-Yes	Both
15:00 - 16:00	1,658	378	210-Yes	140-Yes	Both	240-Yes	160-Yes	Both
16:00 - 17:00	2,204	449	210-Yes	140-Yes	Both	240-Yes	160-Yes	Both
17:00 - 18:00	2,180	463	210-Yes	140-Yes	Both	240-Yes	160-Yes	Both
18:00 - 19:00	1,175	365	210-Yes	140-Yes	Both	240-Yes	160-Yes	Both
19:00 - 20:00	706	284	210-Yes	140-Yes	Both	240-Yes	160-Yes	Both
20:00 - 21:00	633	307	210-Yes	140-Yes	Both	240-Yes	160-Yes	Both
21:00 - 22:00	499	225	210-Yes	140-Yes	Both	240-Yes	160-Yes	Both
22:00 - 23:00	0	0	210-No	140-No	No	240-No	160-No	No
23:00 - 00:00	0	0	210-No	140-No	No	240-No	160-No	No

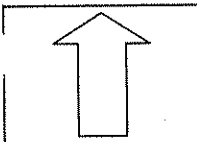

COUNT LOCATION:

CSAH 1 (East River Rd.) @

DATE:

06/01/2005

CR 132 (85th Ave.)

<b>NORTH</b>
APP. #1 = Park Entrance
APP. #2 = CSAH 1
APP. #3 = CR 132
APP. #4 = CSAH 1

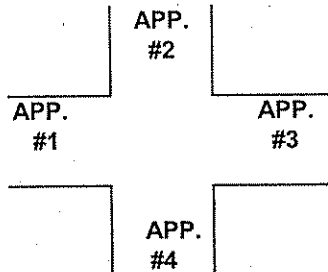

- HEAVY VEHICLE- ANY VEHICLE HAVING MORE THAN FOUR TIRES TOUCHING THE PAVEMENT
- A. TRUCKS- A HEAVY VEHICLE INVOLVED PRIMARILY IN THE TRANSPORT OF GOODS OR IN THE DELIVERY OF A SERVICE.
  - B. RV- A HEAVY VEHICLE OPERATED BY A PRIVATE MOTORIST AND INVOLVED IN THE TRANSPORT OF RECREATIONAL EQUIPMENT OR FACILITIES.
  - C. BUSES- A HEAVY VEHICLE INVOLVED IN THE TRANSPORTATION OF GROUPS OF PEOPLE.

TIME	PEDESTRIANS				15 MIN TOT	HEAVY VEHICLES		
	APP. #1	APP. #2	APP. #3	APP. #4		TRUCKS	RV	BUS
6:00-6:15AM						1		2
6:15-6:30								
6:30-6:45						2		2
6:45-7:00						3		6
<b>HOURLY TOTAL</b>						<b>HOURLY TOTAL</b>		<b>16</b>
7:00-7:15		1			1	3		4
7:15-7:30		1			1	5		1
7:30-7:45		1	2		3	10		4
7:45-8:00						6		4
<b>HOURLY TOTAL</b>					<b>5</b>	<b>HOURLY TOTAL</b>		<b>37</b>
8:00-8:15						8		2
8:15-8:30		1	1		2	6		
8:30-8:45		1			1	9		2
8:45-9:00						12		2
<b>HOURLY TOTAL</b>					<b>3</b>	<b>HOURLY TOTAL</b>		<b>41</b>
9:00-9:15						9		5
9:15-9:30		1			1	7		
9:30-9:45		2			2	11		5
9:45-10:00						9		
<b>HOURLY TOTAL</b>					<b>3</b>	<b>HOURLY TOTAL</b>		<b>46</b>
10:00-10:15		1			1	10		1
10:15-10:30		1		1	2	6		2
10:30-10:45						6		
10:45-11:00			4		4	9		1
<b>HOURLY TOTAL</b>					<b>7</b>	<b>HOURLY TOTAL</b>		<b>35</b>
11:00-11:15	1				1	7		1
11:15-11:30	1		1		2	13		1
11:30-11:45			1		1	13		
11:45-12:00						10		2
<b>HOURLY TOTAL</b>					<b>4</b>	<b>HOURLY TOTAL</b>		<b>47</b>
12:00-12:15						6		2
12:15-12:30						4		
12:30-12:45			1		1	7		
12:45-1:00	1				1	6		1
<b>HOURLY TOTAL</b>					<b>2</b>	<b>HOURLY TOTAL</b>		<b>26</b>
1:00-1:15						8		
1:15-1:30				1	1	9		
1:30-1:45			3		3	5		1
1:45-2:00			1		1	10		2
<b>HOURLY TOTAL</b>					<b>5</b>	<b>HOURLY TOTAL</b>		<b>35</b>
<b>TOTAL</b>					<b>29</b>	<b>TOTAL</b>		<b>283</b>

1  
2  
3  
4  
5  
6  
7  
8  
9  
10  
11  
12  
13  
14  
15  
16  
17  
18  
19  
20  
21  
22  
23  
24  
25  
26  
27  
28  
29  
30  
31  
32

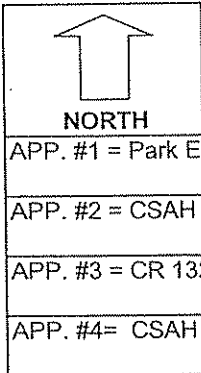

**COUNT LOCATION:**

CSAH 1 (East River Rd.) @  
CR 132 (85th Ave.)

**DATE:**

06/02/2005

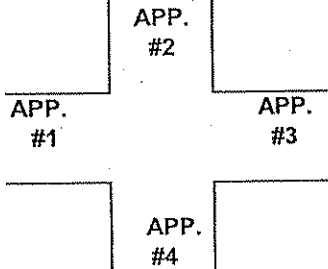

HEAVY VEHICLE- ANY VEHICLE HAVING MORE THAN FOUR TIRES TOUCHING THE PAVEMENT

A. TRUCKS- A HEAVY VEHICLE INVOLVED PRIMARILY IN THE TRANSPORT OF GOODS OR IN THE DELIVERY OF A SERVICE.

B. RV- A HEAVY VEHICLE OPERATED BY A PRIVATE MOTORIST AND INVOLVED IN THE TRANSPORT OF RECREATIONAL EQUIPMENT OR FACILITIES.

C. BUSES- A HEAVY VEHICLE INVOLVED IN THE TRANSPORTATION OF GROUPS OF PEOPLE.

TIME	PEDESTRIANS					HEAVY VEHICLES		
	APP. #1	APP. #2	APP. #3	APP. #4	15 MIN TOT	TRUCKS	RV	BUS
2:00-2:15PM	1				1	9		1
2:15-2:30	1		2		3	7		
2:30-2:45	1				1	6	1	1
2:45-3:00		1			1	13		6
<b>HOURLY TOTAL</b>					<b>6</b>	<b>HOURLY TOTAL</b>		<b>44</b>
3:00-3:15	1				1	5		3
3:15-3:30			1			11		4
3:30-3:45						13		7
3:45-4:00	2		2		4	7		1
<b>HOURLY TOTAL</b>					<b>5</b>	<b>HOURLY TOTAL</b>		<b>51</b>
4:00-4:15	4		3		7	6		5
4:15-4:30			2	2	4	8		2
4:30-4:45	1		4		5	4		3
4:45-5:00			2		2	3		1
<b>HOURLY TOTAL</b>					<b>18</b>	<b>HOURLY TOTAL</b>		<b>32</b>
5:00-5:15	1		1			7		
5:15-5:30	1		1		2	1		3
5:30-5:45	3		1		4	6		2
5:45-6:00	1	1	3		5	4		1
<b>HOURLY TOTAL</b>					<b>11</b>			<b>24</b>
6:00-6:15	2		3	1	6	5		2
6:15-6:30			2		2	3		1
6:30-6:45				2	2	5		
6:45-7:00	1				1	1		1
<b>HOURLY TOTAL</b>					<b>11</b>	<b>HOURLY TOTAL</b>		<b>18</b>
7:00-7:15			1		1	2		2
7:15-7:30			2		2	1		
7:30-7:45	4				4	1		
7:45-8:00	1		6		7	1		1
<b>HOURLY TOTAL</b>					<b>14</b>	<b>HOURLY TOTAL</b>		<b>8</b>
8:00-8:15	4	1	1		6			1
8:15-8:30	4	3						
8:30-8:45			2		2			
8:45-9:00		2	3		5	1		2
<b>HOURLY TOTAL</b>					<b>13</b>	<b>HOURLY TOTAL</b>		<b>4</b>
9:00-9:15						3		
9:15-9:30			1	1	2	1		
9:30-9:45			1		1			
9:45-10:00								1
<b>HOURLY TOTAL</b>					<b>3</b>	<b>HOURLY TOTAL</b>		<b>5</b>
<b>TOTAL</b>						<b>TOTAL</b>		<b>469</b>

1  
2  
3  
4  
5  
6  
7  
8  
9  
10  
11  
12  
13  
14  
15  
16  
17  
18  
19  
20  
21  
22  
23  
24  
25  
26  
27  
28  
29  
30  
31  
32