

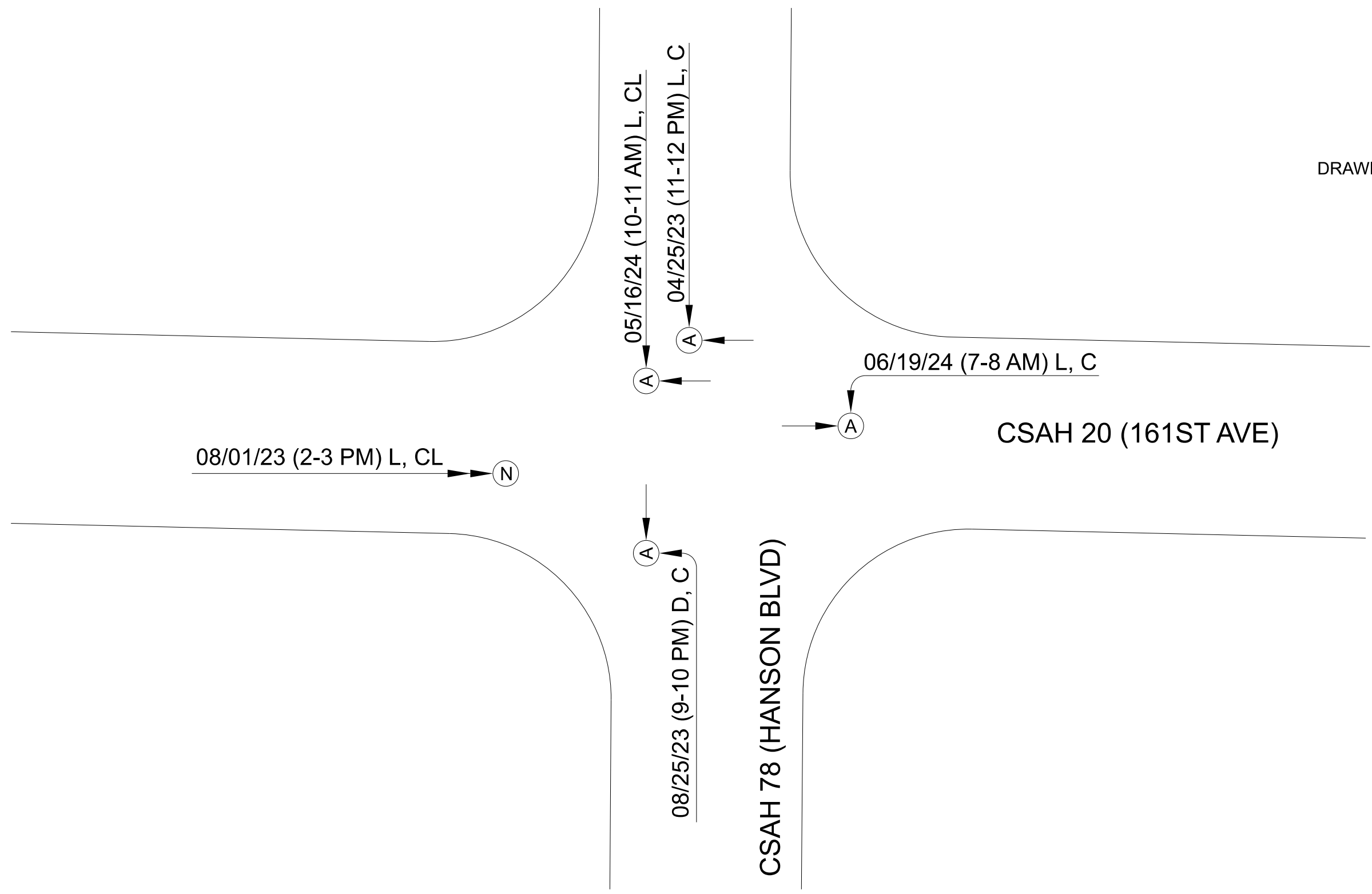

DRAWING NOT TO SCALE



← DATE, TIME, LIGHT, WEATHER

- OVERTURN
- FIRE OR EXPLOSION
- MOVING VEHICLE
- REAR END
- BACKING VEHICLE
- COLLISION WITH FIXED OBJECT
- SIDE SWIPE SAME DIRECTION
- SIDE SWIPE OPPOSITE DIRECTION
- PARKED VEHICLE
- MOTORCYCLE
- DEER
- PEDESTRIAN
- BICYCLE
- FIXED OBJECT
- RIGHT ANGLE
- VEHICLE OUT OF CONTROL
- LEFT TURN INTO ONCOMING TRAFFIC

ADT: 32990  
 ACCIDENT RATE: 0.28 CR INDEX: 0.10  
 SEVERITY RATE: 0.94 FAR INDEX: 1.88

| LIGHT  | WEATHER   | SEVERITY CODE  |
|--|---|--|
| L = LIGHT<br>DN = DAWN<br>DU = DUSK<br>D = DARK<br>X = UNKNOWN | C = CLEAR<br>CL = CLOUDY<br>R = RAIN<br>S = SNOW/SLEET<br>X = OTHER/UNKNOWN | (N) PROPERTY DAMAGE<br>(C) POSSIBLE INJURY<br>(B) MINOR INJURY<br>(A) SERIOUS INJURY<br>(K) FATALITY |



**ANOKA COUNTY  
HIGHWAY DEPT.**

**COLLISION  
DIAGRAM**

CSAH 78 (HANSON BLVD) @  
 CSAH 20 (161ST AVE)  
 JAN 2023 TO JUNE 2024

Sheet   1   of   1   Sheets



# Crash Case Listing

## CSAH 78 @ CSAH 20

| Route System | Route Number | Measure | Co | City    | Incident Number | Date     | Time Day of Week | Basic Type | Num Veh | Sev |
|--------------|--------------|---------|----|---------|-----------------|----------|------------------|------------|---------|-----|
| 04-CSAH      | 20           | 3.965   | 02 | Andover | 01123900        | 08/01/23 | 1447 TUE         | Rear End   | 2       | N   |
| 04-CSAH      | 20           | 3.970   | 02 | Andover | 01177218        | 05/16/24 | 1002 THU         | Angle      | 2       | A   |
| 04-CSAH      | 20           | 3.973   | 02 | Andover | 01127812        | 08/25/23 | 2139 FRI         | Angle      | 2       | A   |
| 04-CSAH      | 78           | 7.154   | 02 | Andover | 01184217        | 06/19/24 | 0725 WED         | Other      | 2       | A   |
| 04-CSAH      | 78           | 7.158   | 02 | Andover | 01095483        | 04/25/23 | 1123 TUE         | Angle      | 3       | A   |

Selection Filter:

WORK AREA: County('659447','2') - FILTER: Year('2023','2024') - SPATIAL FILTER APPLIED

Analyst:

Notes:

Andrea Schmid

Jan 2023 to June 2024

## ACCIDENT AND SEVERITY RATES FOR AN INTERSECTION

|                                      |                   |  |
|--------------------------------------|-------------------|--|
| Intersection:                        | CSAH 78 @ CSAH 20 |  |
| Study Start Date:                    | 01/01/2023        |  |
| Study End Date:                      | 06/30/2024        |  |
| Length of study in years:            | 1.50              | Days = 546.4861      Weighted              |
| Intersection ADT:                    | 32990             | Total Accidents = 5                        |
| Number of Fatal Accidents:           | 0                 | Total Fatal Accidents = 0      0           |
| Number of "A" P.I. Accidents:        | 4                 | Total "A" Injury Accidents = 4      16     |
| Number of "B" P.I. Accidents:        | 0                 | Total "B" Injury Accidents = 0      0      |
| Number of "C" P.I. Accidents:        | 0                 | Total "C" Injury Accidents = 0      0      |
| Number of Property Damage Accidents: | 1                 | Total Property Damage Accidents = 1      1 |
|                                      |                   | Sum of weighted accidents = 17             |
| Accident Rate (AR) =                 | 0.28              |  |
| Severity Rate (SR) =                 | 0.94              |  |

# Intersection Safety Screening

Intersection: CSAH 78 @ CSAH 20

---

*Statewide Averages based on 2018-2022 crashes*

| Crashes by Crash Severity |          |
|---------------------------|----------|
| Fatal (K)                 | 0        |
| Serious Injury (A)        | 4        |
| Minor Injury (B)          | 0        |
| Possible Injury (C)       | 0        |
| Property Damage (PDO)     | 1        |
| <b>Total Crashes</b>      | <b>5</b> |

| Intersection Characteristics |        |
|------------------------------|--------|
| Entering Volume              | 32,990 |
| Environment                  | Rural  |
| Lighting                     | Lit    |
| Traffic Control              | Signal |

*Annual crash cost* = \$643,000

*Statewide comparison* = Signal, Low Volume (<=20K)

| Total Crash Rate      |             |
|-----------------------|-------------|
| Observed              | 0.083       |
| Statewide Average     | 0.548       |
| Critical Rate         | 0.800       |
| <b>Critical Index</b> | <b>0.10</b> |

| Fatal & Serious Injury Crash Rate |             |
|-----------------------------------|-------------|
| Observed                          | 6.640       |
| Statewide Average                 | 1.024       |
| Critical Rate                     | 3.530       |
| <b>Critical Index</b>             | <b>1.88</b> |

*The observed crash rate is the number of crashes per million entering vehicles (MEV). The critical rate is a statistical comparison based on similar intersections statewide. An observed crash rate greater than the critical rate indicates that the intersection operates outside the expected, normal range. The critical index reports the magnitude of this difference (i.e. observed crash rate ÷ critical crash rate).*

*The observed total crash rate for this period is 0.08 per MEV; this is 90% below the critical rate. Based on similar statewide intersections, an additional 44 crashes over the five years would indicate this intersection operates outside the normal range.*

*The observed fatal and serious injury crash rate for this period is 6.64 per 100 MEV; this is 1.9 times the critical rate. This site may be a sustained severe crash location.*