

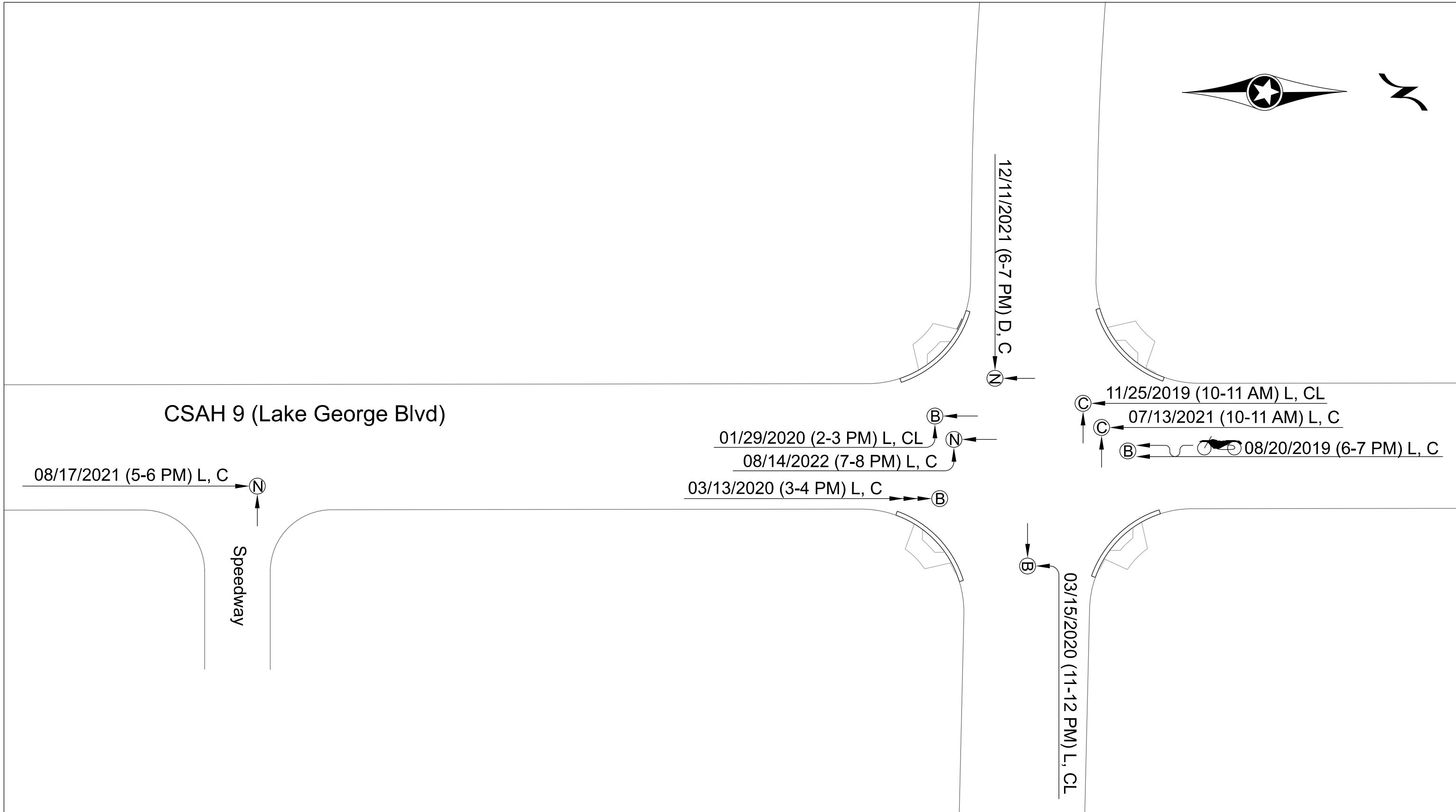

CSAH 9 (Lake George Blvd)



DATE, TIME, LIGHT, WEATHER

- OVERTURN
- FIRE OR EXPLOSION
- MOVING VEHICLE
- REAR END
- BACKING VEHICLE
- COLLISION WITH FIXED OBJECT
- SIDE SWIPE SAME DIRECTION
- SIDE SWIPE OPPOSITE DIRECTION
- PARKED VEHICLE
- MOTORCYCLE
- DEER
- PEDESTRIAN
- BICYCLE
- FIXED OBJECT
- RIGHT ANGLE
- VEHICLE OUT OF CONTROL
- LEFT TURN INTO ONCOMING TRAFFIC

ADT: 17569  
 ACCIDENT RATE: 0.25 CR INDEX: 0.29  
 SEVERITY RATE: 0.56 FAR INDEX: 0.00

LIGHT	WEATHER	SEVERITY CODE
L = LIGHT DN = DAWN DU = DUSK D = DARK X = UNKNOWN	C = CLEAR CL = CLOUDY R = RAIN S = SNOW/SLEET X = OTHER/UNKNOWN	(N) PROPERTY DAMAGE (C) POSSIBLE INJURY (B) MINOR INJURY (A) SERIOUS INJURY (K) FATALITY



ANOKA COUNTY  
HIGHWAY DEPT.

COLLISION  
DIAGRAM

CSAH 22 (VIKING BLVD) @  
CSAH 9 (LAKE GEORGE BLVD)  
JAN 2018 TO DEC 2022