

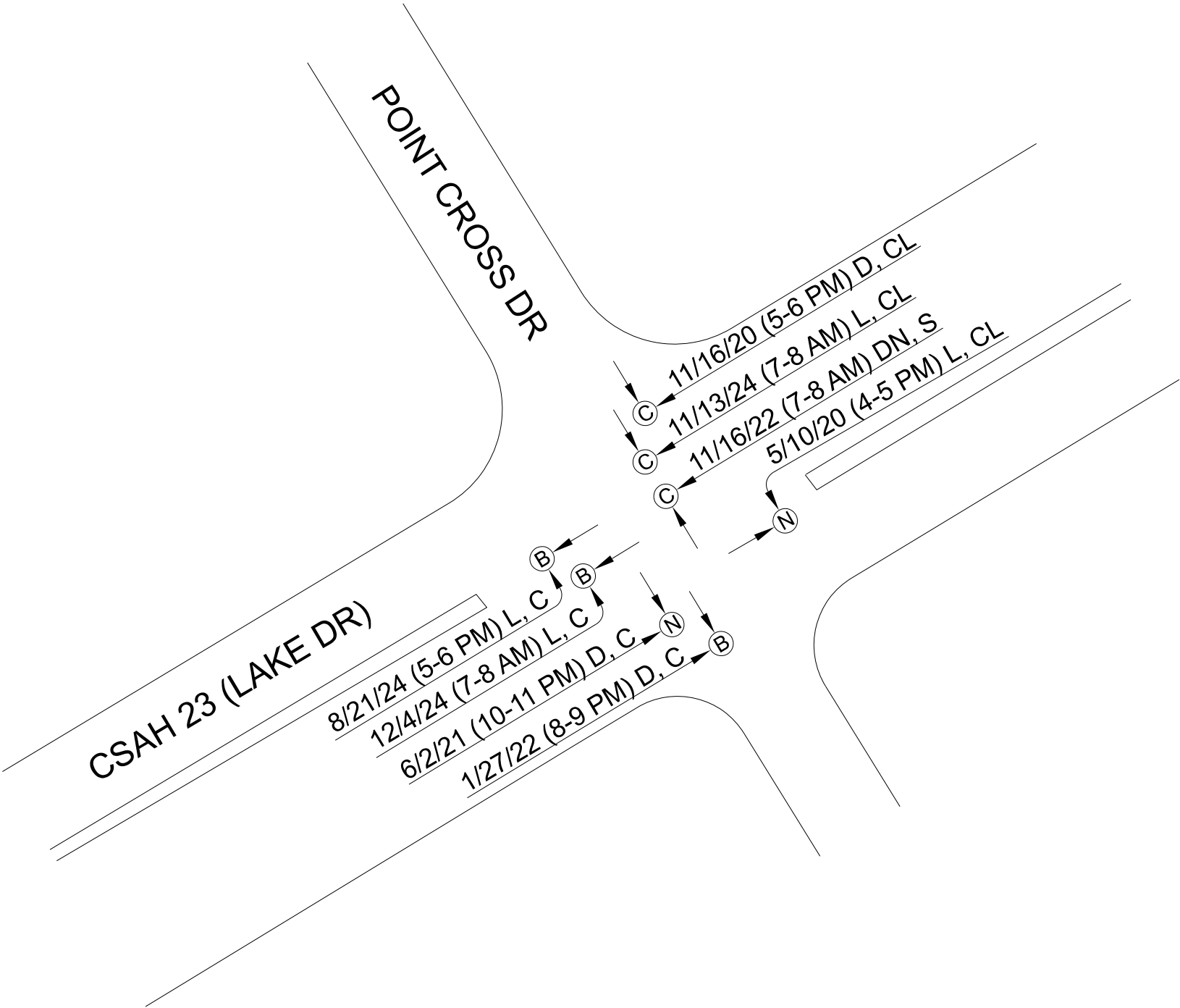

DRAWING NOT TO SCALE



DATE, TIME, LIGHT, WEATHER			<div><div><div><div><div></div><div>OVERTURN</div></div><div><div></div><div>FIRE OR EXPLOSION</div></div><div><div></div><div>MOVING VEHICLE</div></div><div><div></div><div>REAR END</div></div><div><div></div><div>BACKING VEHICLE</div></div><div><div></div><div>COLLISION WITH FIXED OBJECT</div></div><div><div></div><div>SIDE SWIPE SAME DIRECTION</div></div><div><div></div><div>SIDE SWIPE OPPOSITE DIRECTION</div></div></div><div><div><div><div></div><div>PARKED VEHICLE</div></div><div><div></div><div>MOTORCYCLE</div></div><div><div></div><div>DEER</div></div><div><div></div><div>PEDESTRIAN</div></div><div><div></div><div>BICYCLE</div></div><div><div></div><div>FIXED OBJECT</div></div><div><div></div><div>RIGHT ANGLE</div></div></div><div><div><div><div></div><div>VEHICLE OUT OF CONTROL</div></div><div><div></div><div>LEFT TURN INTO ONCOMING TRAFFIC</div></div></div></div></div></div></div>		ADT: 10951 ACCIDENT RATE: 0.40 CR INDEX: 1.05 SEVERITY RATE: 0.85 FAR INDEX: 0.00	
LIGHT	WEATHER	SEVERITY CODE	<div><div></div><div>ANOKA COUNTY HIGHWAY DEPT.</div></div> <div>COLLISION DIAGRAM</div>		CSAH 23 @ POINTCROSS DR JAN 2020 TO DEC 2024	
L = LIGHT DN = DAWN DU = DUSK D = DARK X = UNKNOWN	C = CLEAR CL = CLOUDY R = RAIN S = SNOW/SLEET X = OTHER/UNKNOWN	(N) PROPERTY DAMAGE (C) POSSIBLE INJURY (B) MINOR INJURY (A) SERIOUS INJURY (K) FATALITY			Sheet <u> 1 </u> of <u> 1 </u> Sheets	

ACCIDENT AND SEVERITY RATES FOR AN INTERSECTION

Intersection:	CSAH 23 @ Pointcross Dr		
Study Start Date:	01/01/2020		
Study End Date:	12/31/2024		
Length of study in years:	5.00	Days = 1825	Weighted
Intersection ADT:	10951	Total Accidents = 8	
Number of Fatal Accidents:	0	Total Fatal Accidents = 0	0
Number of "A" P.I. Accidents:	0	Total "A" Injury Accidents = 0	0
Number of "B" P.I. Accidents:	3	Total "B" Injury Accidents = 3	9
Number of "C" P.I. Accidents:	3	Total "C" Injury Accidents = 3	6
Number of Property Damage Accidents:	2	Total Property Damage Accidents = 2	2
		Sum of weighted accidents =	17
Accident Rate (AR) =	0.40		
Severity Rate (SR) =	0.85		

Intersection Safety Screening

Intersection: CSAH 23 @ Pointcross Dr

Statewide Averages based on 2018-2022 crashes

Crashes by Crash Severity	
Fatal (K)	0
Serious Injury (A)	0
Minor Injury (B)	3
Possible Injury (C)	3
Property Damage (PDO)	2
Total Crashes	8

Intersection Characteristics	
Entering Volume	10,951
Environment	Urban
Lighting	Lit
Traffic Control	Thru-Stop

Annual crash cost = \$234,000

Statewide comparison = Urban, Thru/STOP

Total Crash Rate	
Observed	0.400
Statewide Average	0.138
Critical Rate	0.380
Critical Index	1.05

Fatal & Serious Injury Crash Rate	
Observed	0.000
Statewide Average	0.350
Critical Rate	4.550
Critical Index	0.00

The observed crash rate is the number of crashes per million entering vehicles (MEV). The critical rate is a statistical comparison based on similar intersections statewide. An observed crash rate greater than the critical rate indicates that the intersection operates outside the expected, normal range. The critical index reports the magnitude of this difference (i.e. observed crash rate ÷ critical crash rate).

The observed total crash rate for this period is 0.40 per MEV; this is 1.1 times the critical rate. If crashes were reduced by 1 over five years, this intersection would perform within normal range.

The observed fatal and serious injury crash rate for this period is 0.00 per 100 MEV; this is 100% below the critical rate. The intersection operates within the normal range.