

← DATE, TIME, LIGHT, WEATHER

- OVERTURN
- FIRE OR EXPLOSION
- MOVING VEHICLE
- REAR END
- BACKING VEHICLE
- COLLISION WITH FIXED OBJECT
- SIDE SWIPE SAME DIRECTION
- SIDE SWIPE OPPOSITE DIRECTION

- MOTORCYCLE
- DEER
- PEDESTRIAN
- BICYCLE
- FIXED OBJECT
- RIGHT ANGLE

- VEHICLE OUT OF CONTROL
- LEFT TURN INTO ONCOMING TRAFFIC



**ANOKA COUNTY
HIGHWAY DEPT.**

ADT: 20505
ACCIDENT RATE: 0.48 CR INDEX: 0.62
SEVERITY RATE: 0.76 FAR INDEX: 0.00

**COLLISION
DIAGRAM**

CSAH 1 (COON RAPIDS BLVD)
@ XAVIS ST
JAN 2018 TO MARCH 2023

Sheet 1 of 2 Sheets

LIGHT

L = LIGHT
DN = DAWN
DU = DUSK
D = DARK
X = UNKNOWN

WEATHER

C = CLEAR
CL = CLOUDY
R = RAIN
S = SNOW/SLEET
X = OTHER/UNKNOWN

SEVERITY CODE

(N) PROPERTY DAMAGE
(C) POSSIBLE INJURY
(B) MINOR INJURY
(A) SERIOUS INJURY
(K) FATALITY

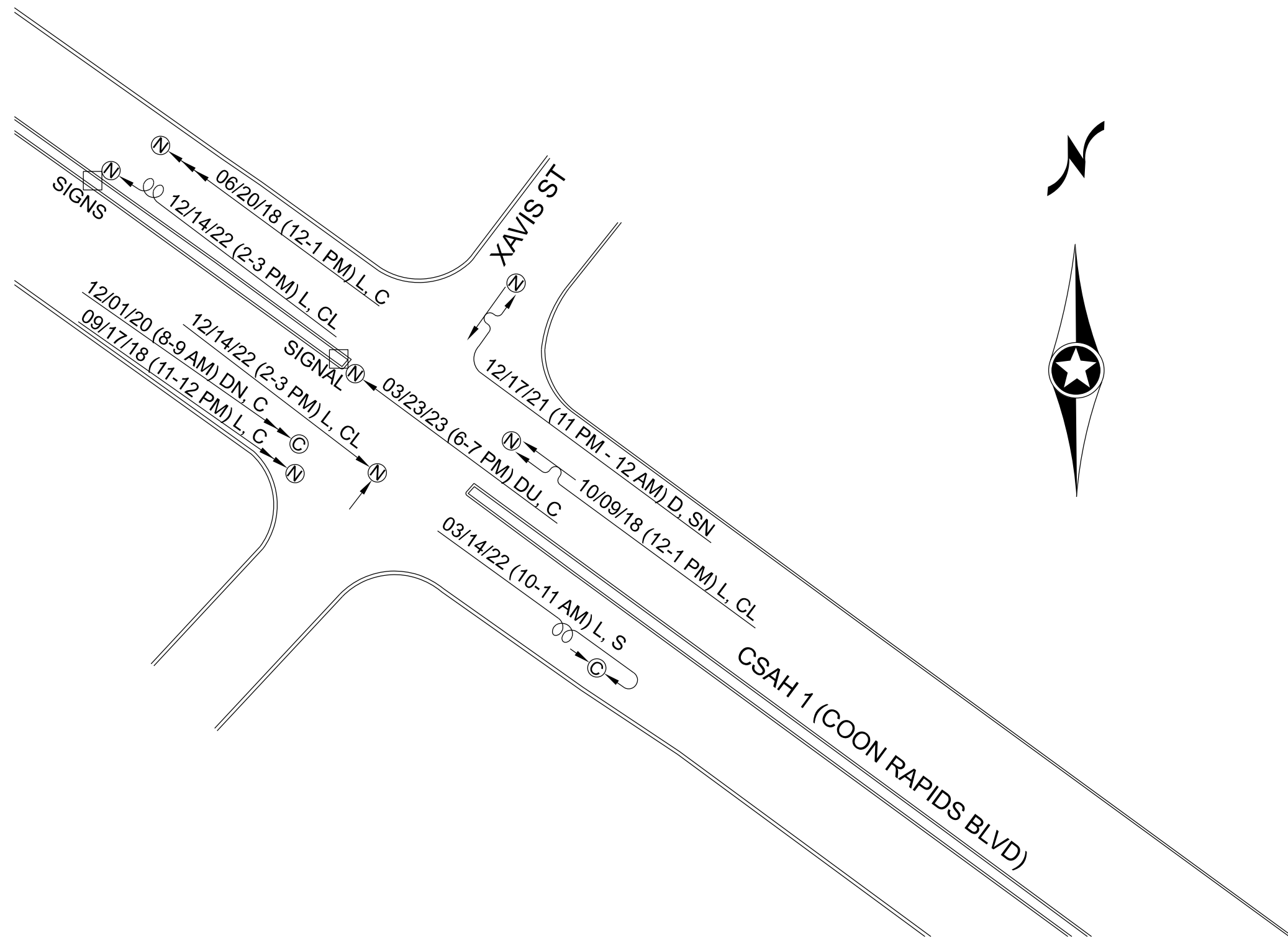

DATE, TIME, LIGHT, WEATHER

- ☒ OVERTURN
- 🔥 FIRE OR EXPLOSION
- ➡ MOVING VEHICLE
- ↔ REAR END
- ↔↔↔ BACKING VEHICLE
- ☐➡ COLLISION WITH FIXED OBJECT
- ↔↔ SIDE SWIPE SAME DIRECTION
- ↔↔ SIDE SWIPE OPPOSITE DIRECTION

- 🚗 PARKED VEHICLE
- 🏍️ MOTORCYCLE
- 🦌 DEER
- 🚶 PEDESTRIAN
- 🚲 BICYCLE
- ☐ FIXED OBJECT
- ⊥ RIGHT ANGLE
- 🌀 VEHICLE OUT OF CONTROL
- ↔ LEFT TURN INTO ONCOMING TRAFFIC



**ANOKA COUNTY
HIGHWAY DEPT.**

ADT: 20505
ACCIDENT RATE: 0.48 CR INDEX: 0.62
SEVERITY RATE: 0.76 FAR INDEX: 0.00

**COLLISION
DIAGRAM**

CSAH 1 (COON RAPIDS BLVD)
@ XAVIS ST
JAN 2018 TO MARCH 2023

Sheet 2 of 2 Sheets

LIGHT

L = LIGHT
DN = DAWN
DU = DUSK
D = DARK
X = UNKNOWN

WEATHER

C = CLEAR
CL = CLOUDY
R = RAIN
S = SNOW/SLEET
X = OTHER/UNKNOWN

SEVERITY CODE

Ⓝ PROPERTY DAMAGE
Ⓞ POSSIBLE INJURY
Ⓟ MINOR INJURY
Ⓠ SERIOUS INJURY
Ⓡ FATALITY

ACCIDENT AND SEVERITY RATES FOR AN INTERSECTION

Intersection:	CSAH 1 @ XAVIS ST	
Study Start Date:	01/01/2018	
Study End Date:	03/31/2023	
Length of study in years:	5.25	Days = 1916.25 Weighted
Intersection ADT:	20505	Total Accidents = 19
Number of Fatal Accidents:	0	Total Fatal Accidents = 0 0
Number of "A" P.I. Accidents:	0	Total "A" Injury Accidents = 0 0
Number of "B" P.I. Accidents:	4	Total "B" Injury Accidents = 4 12
Number of "C" P.I. Accidents:	3	Total "C" Injury Accidents = 3 6
Number of Property Damage Accidents:	12	Total Property Damage Accidents = 12 12
		Sum of weighted accidents = 30
Accident Rate (AR) =	0.48	
Severity Rate (SR) =	0.76	

Intersection Safety Screening

Intersection: CSAH 1 @ XAVIS ST

Statewide Averages based on 2016-2020 crashes

Crashes by Crash Severity	
Fatal (K)	0
Serious Injury (A)	0
Minor Injury (B)	4
Possible Injury (C)	3
Property Damage (PDO)	12
Total Crashes	19

Intersection Characteristics	
Entering Volume	20,505
Environment	Urban
Lighting	Lit
Traffic Control	Signal

Annual crash cost = \$287,200

Statewide comparison = Signal, Low Volume (<=20K)

Total Crash Rate	
Observed	0.507
Statewide Average	0.508
Critical Rate	0.820
Critical Index	0.62

Fatal & Serious Injury Crash Rate	
Observed	0.000
Statewide Average	0.690
Critical Rate	3.760
Critical Index	0.00

The observed crash rate is the number of crashes per million entering vehicles (MEV). The critical rate is a statistical comparison based on similar intersections statewide. An observed crash rate greater than the critical rate indicates that the intersection operates outside the expected, normal range. The critical index reports the magnitude of this difference (i.e. observed crash rate ÷ critical crash rate).

The observed total crash rate for this period is 0.51 per MEV; this is 38% below the critical rate. Based on similar statewide intersections, an additional 12 crashes over the five years would indicate this intersection operates outside the normal range.

The observed fatal and serious injury crash rate for this period is 0.00 per 100 MEV; this is 100% below the critical rate. The intersection operates within the normal range.



Notes: Jan 2018 to March 2023

05/18/2023MnCMAT 2.0.0