



Anoka County
MINNESOTA
Respectful, Innovative, Fiscally Responsible

ANOKA COUNTY TRANSPORTATION DIVISION

1440 BUNKER LAKE BLVD NW

ANDOVER, MN 55304

763-324-3176

highwaypermits@co.anoka.mn.us

REVISED
RIGHT OF WAY
PERMIT NUMBER
23-056

CSAH 54

CR

APPLICATION FOR PERMIT FOR INSTALLATION OF UTILITIES OR PLACING OBSTRUCTIONS ON THE COUNTY HIGHWAY SYSTEM
ALL APPLICANTS MUST BE REGISTERED PRIOR TO PERMIT APPROVAL

REVISED W2200374

WORK TO START ON

WORK TO BE COMPLETED ON

DURATION OF JOB

ARE YOU BEING ASKED TO RELOCATE DUE TO A COUNTY PROJECT?

ANOKA COUNTY PROJECT NUMBER

APPLICANT NAME

CONTACT PERSON

/ Hilary Frerich

ADDRESS

CITY

PHONE NUMBER

EMAIL

COMPANY OR INDIVIDUAL PERFORMING WORK

/ Schroeder Construction

CONTACT PERSON

PHONE NUMBER

EMAIL

ADDRESS OF WORK SITE

CITY

NATURE OF WORK

METHOD OF INSTALLATION/CONSTRUCTION

and potholing (6" diameter)

SURFACE TO BE DISTURBED

SITE PLAN

WILL TRAFFIC BE OBSTRUCTED?

TRAFFIC CONTROL PLAN

DITCH

**TO BE
SUBMITTED**

**TO BE
SUBMITTED**

GRAVEL

VIA EMAIL

VIA EMAIL

BITUMINOUS

CONCRETE

NONE

DEPTH FROM SURFACE

SIZE AND KIND OF PIPE/CABLE

NUMBER OF EXCAVATIONS

SIZE OF EXCAVATIONS

LOCATION OF EXCAVATIONS

Pothole SB lane - approx. 5' off of the curb, in a driveway turn lane for 7087 20th Ave S,

ADDITIONAL DOCUMENTS

TO BE SUBMITTED VIA EMAIL - CITY/MNDOT PERMITS, PHOTOS OF AREA, ETC.

THIS PERMIT COVERS THE RIGHT OF WAY IN ANOKA COUNTY ONLY

ACHD reserves the right to make changes to these special conditions.



Anoka County

MINNESOTA

Respectful. Innovative. Fiscally Responsible

ANOKA COUNTY TRANSPORTATION DIVISION

1440 BUNKER LAKE BLVD NW

ANDOVER, MN 55304

PERMIT PHONE: 763-324-3176

highwaypermits@co.anoka.mn.us

GENERAL INFORMATION

ONE PERMIT MUST BE APPROVED FOR EACH COUNTY ROAD ON WHICH WORK WILL BE PERFORMED PRIOR TO ANY WORK WITHIN THE RIGHT OF WAY BY ANY UTILITY/CONTRACTOR. EMERGENCY CONDITIONS WHICH THREATEN THE SAFETY OF THE PUBLIC AND REQUIRE IMMEDIATE REPAIR ARE EXCEPTIONS TO THIS RULE. UNDER THOSE CIRCUMSTANCES, THE UTILITY/CONTRACTOR, IS PERMITTED TO BEGIN AND/OR COMPLETE THE NECESSARY REPAIRS. ACTD SHALL BE NOTIFIED OF EMERGENCY REPAIRS AS SOON AS FEASIBLE AND A WRITTEN PERMIT IS TO BE COMPLETED WITHIN TWO BUSINESS DAYS OF OCCURRENCE.

A LICENSE-PERMIT BOND IS GENERALLY REQUIRED OF THE CONTRACTOR AS PART OF THE REGISTRATION PROCESS. THE AMOUNT OF WHICH WILL BE DETERMINED BY THE NATURE OF THE UTILITY WORK.

A SKETCH OR DRAWING SHALL ACCOMPANY EACH PERMIT APPLICATION WHICH WILL SHOW THE LOCATION OF THE PROPOSED WORK/UTILITY WITH REFERENCE TO THE COUNTY HIGHWAY CENTER LINE AND RIGHT OF WAY LINE. A COMPLETE SET OF PLANS IS REQUIRED FOR ALL SEWER/WATER PROJECTS.

IT SHALL BE THE RESPONSIBILITY OF THE APPLICANT TO DETERMINE WHICH OF THE SPECIAL CONDITIONS APPLY TO EACH PERMIT.

THE ANOKA COUNTY TRANSPORTATION DIVISION (ACTD) RESERVES THE RIGHT TO REVOKE ANY UTILITY PERMIT AND HALT WORK, IF, UPON INSPECTION OF ANY JOB SITE, THE SPECIAL CONDITIONS ARE NOT MET, AND/OR A HAZARD EXISTS FOR THE APPLICANT OR PUBLIC SAFETY IS THREATENED. **THE FAILURE TO COMPLY WITH THE TERMS AND CONDITIONS OF ANY APPLICABLE FEDERAL, STATE, REGIONAL, AND LOCAL LAWS, RULES AND REGULATIONS, INCLUDING ANY PROVISION OF ANOKA COUNTY'S RIGHT-OF-WAY ORDINANCE SHALL BE CAUSE FOR IMMEDIATE REVOCATION OF A PERMIT.**

THE APPLICANT SHALL NOTIFY ACTD IMMEDIATELY UPON COMPLETION OF PROJECT SO THAT THE ACTD CAN INSPECT THE SITE TO DETERMINE WHETHER OR NOT RESTORATION HAS BEEN SATISFACTORILY COMPLETED.

THE UNDERSIGNED, HEREBY ACCEPTS THE TERMS AND CONDITIONS OF THIS PERMIT AND THE REGULATIONS OF ANOKA COUNTY, AND AGREES TO FULLY COMPLY THEREWITH TO THE SATISFACTION OF THE ACTD. THE COUNTY OF ANOKA, ITS OFFICIALS, EMPLOYEES, AND AGENTS, SHALL BE HELD HARMLESS, BY THE APPLICANT/PERMITTEE, FROM ANY DEMANDS, CLAIMS, LAWSUITS, OR DAMAGES RELATING TO THE WORK DESCRIBED IN THIS PERMIT.

APPLICANT'S SIGNATURE

DATE

AUTHORIZATION OF PERMIT

IN CONSIDERATION OF THE APPLICANT'S AGREEMENT TO COMPLY IN ALL RESPECTS WITH THE REGULATIONS OF THE ACTD COVERING SUCH OPERATIONS, PERMISSION IS HEREBY GRANTED FOR THE WORK TO BE DONE AS DESCRIBED IN THE ABOVE APPLICATION. SAID WORK TO BE DONE IN ACCORDANCE WITH THE GENERAL CONDITIONS LISTED ABOVE AND THE SPECIAL CONDITIONS REQUIRED AS HEREBY STATED. IT IS EXPRESSLY UNDERSTOOD THAT THIS PERMIT IS CONDITIONED UPON REPLACEMENT OR RESTORATION OF THE COUNTY HIGHWAY AND ITS RIGHT OF WAY TO THEIR ORIGINAL OR TO A SATISFACTORY CONDITION. IT IS FURTHER UNDERSTOOD THAT THIS PERMIT IS ISSUED SUBJECT TO THE APPROVAL OF LOCAL CITY OR TOWNSHIP AUTHORITIES HAVING JOINT SUPERVISION OVER SAID STREET OR HIGHWAY.

APPROVED BY: *Susan Burgmeier*

TITLE: *Associate Traffic Technician*

DATE

THIS PERMIT COVERS THE RIGHT OF WAY IN ANOKA COUNTY ONLY
ACHD reserves the right to make changes to these special conditions.



ANOKA COUNTY TRANSPORTATION DIVISION

1440 BUNKER LAKE BLVD NW

ANDOVER, MN 55304

PERMIT PHONE: 763-324-3176

highwaypermits@co.anoka.mn.us

SPECIAL CONDITIONS

TRAFFIC CONTROL

- 1) DETOURS
 - a) DETAILED DETOUR LAYOUTS SHALL BE SUBMITTED TO THE TRAFFIC ENGINEER FOR APPROVAL.
 - b) NO DETOURS SHALL BE PERMITTED WITHOUT PRIOR APPROVAL OF THE ANOKA COUNTY TRAFFIC ENGINEER.
 - c) TEN DAYS NOTICE MUST BE GIVEN PRIOR TO THE INSTALLATION OF ANY DETOUR.
 - d) IT SHALL BE THE RESPONSIBILITY OF THE APPLICANT TO NOTIFY ANOKA COUNTY CENTRAL COMMUNICATIONS, LOCAL GOVERNMENT BODIES, AND ANY AFFECTED BUS COMPANIES TEN DAYS PRIOR TO ANY ROAD CLOSURES/DETOURS.
 - e) IMMEDIATELY UPON COMPLETION OF WORK AND/OR DETOURS, ALL POSTS, BARRICADES, AND SIGNS SHALL BE REMOVED FROM THE RIGHT OF WAY.
- 2) TRAFFIC CONTROL DEVICES
 - a) ALL TRAFFIC CONTROL DEVICES, BARRICADES, FLASHERS, ETC., SHALL BE FURNISHED BY THE APPLICANT AND SHALL BE IN ACCORDANCE WITH THE MOST RECENT EDITION OF THE MINNESOTA MANUAL ON UNIFORM TRAFFIC CONTROL DEVICES AND TEMPORARY TRAFFIC CONTROL ZONE LAYOUTS – FIELD MANUAL OF THE SAME MANUAL.

CONSTRUCTION REQUIREMENTS

- 1) OPEN CUTTING OF BITUMINOUS OR CONCRETE SURFACED ROADS WILL BE ALLOWED ONLY AT THE DISCRETION OF THE COUNTY ENGINEER.
- 2) NEITHER SUPPLIES NOR EXCAVATION MATERIALS SHALL BE PLACED ON THE BITUMINOUS OR CONCRETE SURFACE AT ANY TIME.
- 3) NO TRENCHES WILL BE ALLOWED TO REMAIN OPEN OVERNIGHT.
- 4) MATERIALS REMOVED FROM THE TRENCH SHALL BE USED AS BACKFILL INSOFAR AS THEY ARE SUITABLE. ALL BACKFILL MATERIAL SHALL CONFORM TO MNDOT SPECIFICATIONS FOR COMPACTION. THE USE OF HEAVY EQUIPMENT ON TOP OF TRENCH, SLAPPING WITH BACKHOE BUCKET AND/OR BACKCASTING TO ACHIEVE COMPACTION IS PROHIBITED. ANY ADDITIONAL MATERIAL REQUIRED TO BACK FILL TO THE ORIGINAL GRADE SHALL BE FURNISHED BY THE APPLICANT AT NO EXPENSE TO THE ACTD. ALL THE BASE AND SURFACE COURSES DAMAGED DURING CONSTRUCTION OPERATIONS SHALL BE RESTORED TO A CONDITION EQUAL TO OR BETTER THAN BEFORE OPERATIONS BEGAN. THE APPLICANT SHALL BE RESPONSIBLE FOR AND RESTORE ANY SETTLEMENT.
- 5) ALL CULVERTS, DITCHES, SHOULDERS, AND BACKSLOPES SHALL BE RESTORED TO THEIR ORIGINAL CONDITION UNLESS OTHERWISE DIRECTED BY THE ACTD. SHOULDERS WHICH HAVE BEEN PREVIOUSLY CONSTRUCTED OR RECONSTRUCTED WITH SPECIAL MATERIALS SHALL BE REPLACED IN KIND. RESTORATION OF SIGNS, GUARDRAILS, GUARDPOSTS, ETC., ARE THE SOLE RESPONSIBILITY OF THE APPLICANT AND SHALL BE RESTORED TO THEIR ORIGINAL CONDITION.
- 6) ALL ROADWAY MAINTENANCE REQUIRED WITHIN THE LIMITS OF THE UTILITY PROJECT THAT IS RELATED TO THE APPLICANT'S ACTIVITIES SHALL BE THE SOLE RESPONSIBILITY OF THE APPLICANT FOR ONE YEAR AFTER COMPLETION OF THE PROJECT. UPON COMPLETION OF THE RESTORATION WORK, THE APPLICANT SHALL REQUEST A FINAL INSPECTION BY THE ACTD. THE ACTD'S APPROVED COMPLETION DATE SHALL BE THE STARTING DATE OF THE APPLICANT'S ONE YEAR RESPONSIBILITY.

HORIZONTAL BORING AND JACKING

- 1) ALL HARD SURFACE ROADWAYS SHALL BE JACKED OR BORED.
- 2) ALL CROSSINGS OF ANOKA COUNTY MAINTAINED ROADBEDS SHALL BE MADE BY BORING INSIDE A CASING OR CARRIER PIPE, OR BY JACKING UNLESS OTHERWISE DIRECTED BY THE ANOKA COUNTY ENGINEER. THE AUGER SHALL LAD THE CASING OR CARRIER PIPE BY AT LEAST SIX INCHES WHENEVER POSSIBLE AND NEVER LEAD THE CARRIER PIPE BY MORE THAN ONE INCH.
- 3) THE USE OF PNEUMATIC DEVICES TO FACILITATE THE ROADBED CROSSINGS WILL BE ALLOWED IN MOST CASES WITH PRIOR APPROVAL. IN THE EVENT APPROVAL IS NOT GRANTED AND APPLICANT USES A PNEUMATIC DEVICE TO CROSS A ROADBED AND ENCOUNTERS AN OBSTRUCTION AND/OR UNSTABLE SUBBASE MATERIAL WHICH MAKES FORWARD OR REVERSE MOTION OF PNEUMATIC DEVICE IMPOSSIBLE, SAID PNEUMATIC DEVICE THEN BECOMES PART OF THE ROADWAY SUBBASE AND PERMISSION TO EXCAVATE TO RETRIEVE DEVICE WILL NOT BE GRANTED.
- 4) IF A PNEUMATIC DEVICE IS USED FOR THE WORK PERMITTED HEREIN, THE INSTALLATION MUST BE KEPT TO A MINIMUM OF FOUR FEET BELOW THE SURFACE OF THE ROADWAY IF THE PNEUMATIC DEVICE IS LESS THAN TWO INCHES IN DIAMETER, AND A MINIMUM OF FIVE FEET BELOW THE SURFACE OF THE ROADWAY IF THE PNEUMATIC DEVICE IS TWO INCHES IN DIAMETER OR LARGER.

BITUMINOUS RESTORATION

- 1) THE LOCATIONS AND DIMENSIONS OF ALL OPENINGS TO BE MADE IN THE BITUNINOUS SUFACE SHALL BE APPROVED BY THE ACTD PRIOR TO ANY CUTTING OR ANY SURFACE OPENING OPERATIONS.
- 2) ALL OPENINGS IN BITUMINOUS SURFACES SHALL BE CUT IN A STRAIGHT LINE WITH THE SIDES SMOOTH AND VERTICAL. NO RAGGED EDGES WILL BE PERMITTED. CUTTING SHALL BE DONE WITH A CONCRETE SAW.
- 3) ALL NECESSARY DUST CONTROL OPERATIONS SHALL BE CARRIED OUT BY THE APPLICANT AT NO EXPENSE TO ANOKA COUNTY.
- 4) THE MINIMUM REQUIREMENT FOR SUBGRADE REPLACEMENT SHALL BE THE UPPER TWELVE INCHES OF MATERIAL AND SHALL MEET MNDOT SPECIFICATIONS FOR CLASS FIVE PLACED IN SIX INCH LAYERS COMPACTED TO ONE HUNDRED PERCENT OF OPTIMUM DENSITY.
- 5) ALL MANHOLE CASINGS, GATE VALVES, AND OTHER UTILITY STRUCTURES SHALL BE SET ONE QUARTER INCH BELOW THE TOP OF THE FINISHED SURFACE.
- 6) BITUMINOUS TACK COAT MATERIALS AND APPLICATION THEREOF SHALL CONFORM TO MNDOT SPECIFICATION 2357.
- 7) ALL BITUMINOUS SURFACING SHALL BE REPLACED AS SOON AS PRACTICAL AFTER THE BASE CONSTRUCTION. ALL BITUMINOUS SURFACING SHALL BE MACHINE LAID. ANY EXCEPTIONS MUST BE APPROVED BY THE ACTD. BITUMINOUS SURFACING SHALL BE REPLACED TO ORIGINAL PAVEMENT DEPTH OR TO A MINIMUM OF SIX INCHES OF BITUMINOUS MIXTURE (2360), WHICHEVER IS GREATER. BITUMINOUS MIXTURES MUST BE PLACED IN LIFTS NOT EXCEEDING THREE INCHES IN THICKNESS FOR BASE AND BINDER COURSES AND NOT EXCEEDING TWO INCHES FOR THE WEAR COURSE.
- 8) ALL SURFACE RESTORATION REGARDLESS OF SIZE SHALL CONFORM TO EXISTING GRADES.
- 9) ANY UNNECESSARY OR NEGLIGENT DAMAGE TO BITUMINOUS SURFACE IN CONJUNCTION WITH THE INSTALLATION AND/OR REPAIR OF A UTILITY SHALL BE CUT OUT AND REPLACED IN KIND AS DIRECTED BY THE ACTD.

***THIS PERMIT COVERS THE RIGHT OF WAY IN ANOKA COUNTY ONLY
ACHD reserves the right to make changes to these special conditions.***



ANOKA COUNTY TRANSPORTATION DIVISION

1440 BUNKER LAKE BLVD NW

ANDOVER, MN 55304

PERMIT PHONE: 763-324-3176

highwaypermits@co.anoka.mn.us

CONCRETE RESTORATION

- 1) CURB AND GUTTER, SIDEWALKS, AND DRIVEWAYS SHALL BE RESTORED IN ACCORDANCE WITH MNDOT SPECIFICATIONS 2531 AND 2521.

UTILITY LINES

- 1) THERE SHALL BE ONLY A SINGLE POLE LINE ON THE COUNTY RIGHT OF WAY ON EITHER SIDE OF THE CENTER LINE THEREOF.
- 2) EXACT LOCATIONS OF LONGITUDINAL INSTALLATIONS ON COUNTY HIGHWAYS SHALL BE LOCATED AS DIRECTED BY THE ACTD.

SECTION CORNER MONUMENTS

- 1) UTILITY LOCATIONS SHALL NOT INTERFERE WITH THE LOCATION OF ANY SECTION, QUARTER, WITNESS, OR RIGHT OF WAY MONUMENTS. FOR ASSISTANCE IN LOCATIONS, CONTACT THE ANOKA COUNTY SURVEYOR'S OFFICE.
- 2) THE APPLICANT SHALL BE RESPONSIBLE FOR REPLACEMENT OF ANY EXISTING PROPERTY IRONS DISTURBED DURING CONSTRUCTION.
- 3) THE APPLICANT SHALL NOTIFY THE ANOKA COUNTY SURVEYOR'S OFFICE THREE WORKING DAYS IN ADVANCE OF ANY ANTICIPATED DISTURBANCE OF ANY SECTION, QUARTER, WITNESS, OR RIGHT OF WAY MONUMENTS.
- 4) ANY MONUMENT DISTURBED DURING THE COURSE OF CONSTRUCTION SHALL BE RESET BY THE ANOKA COUNTY SURVEYOR'S OFFICE AT THE EXPENSE OF THE APPLICANT.

ATTACHING TO BRIDGES/STRUCTURES

- 1) NO UTILITY IS PERMITTED TO BE HUNG FROM, OR OTHERWISE ATTACHED TO ANY BRIDGE OR STRUCTURE WITHOUT HAVING DETAILED PLANS APPROVED BY THE ANOKA COUNTY ENGINEER. THESE PLANS ARE TO SHOW APPROACHES TO THE STRUCTURE, METHOD OF INSTALLATION, TYPE, AND DIMENSION OF HOUSING FOR THE UTILITY.

INITIAL

SPECIAL CONDITIONS FOR ADVANCE NOTIFICATION FOR COMMENCEMENT & COMPLETION OF WORK

PERMIT HOLDER:

PERMIT NUMBER:

ROAD NUMBER:

CONTRACTOR CONTACT:

PERMIT ACTIVE DATE:

PERMIT EXPIRE DATE:

ALL SUBCONTRACTORS, INSTALLERS, AND CREW SHALL POSSESS A COPY OF ALL DOCUMENTS IN RELATION TO THE APPROVED PERMIT PRIOR TO THE COMMENCEMENT OF WORK AND BE KEPT ON SITE. THIS INCLUDES, BUT IS NOT LIMITED TO, THE FOLLOWING:

- APPROVED PERMIT
- NOTIFICATION SHEET
- ANY/ALL TRAFFIC CONTROL LAYOUTS/PLANS

SPECIAL CONDITIONS

- ALL TRAFFIC CONTROL SHALL BE IN ACCORDANCE WITH THE MOST CURRENT VERSION OF THE MNDOT TEMPORARY TRAFFIC CONTROL FIELD MANUAL
- SHALL USE A SHOULDER CLOSURE (LAYOUT 8) IF ANY PORTION OF THE SHOULDER IS ENCROACHED
- SHALL USE A RTL CLOSURE (LAYOUT 33), 9AM-3PM ONLY, IF ANY PORTION OF THE ROAD IS ENCROACHED
- SHALL USE A FLAGGING OPERATION (LAYOUT 16), 9AM-3PM ONLY, IF ANY PORTION OF THE ROAD IS ENCROACHED
- ALL TRAFFIC CONTROL DEVICES SHALL BE REMOVED, SIGNS TURNED, LAID DOWN, OR COVERED AT THE END OF EACH WORK DAY, OR WHEN NO WORK IS TAKING PLACE UNLESS WRITTEN APPROVAL STATING OTHERWISE
- SHALL NOTIFY ANDREA SCHMID (andrea.schmid@co.anoka.mn.us or 763-324-3128) 48 HOURS PRIOR TO THE COMMENCEMENT OF WORK WITH THE PERMIT NUMBER, THE DATE/TIME WORK IS TO BE PERFORMED, AND THE ESTIMATED DURATION OF WORK
- SHALL NOTIFY ANDREA SCHMID (andrea.schmid@co.anoka.mn.us or 763-324-3128) WHEN WORK IS COMPLETE
- NO WORK DURING INCLEMENT WEATHER OR WHEN PLOWS ARE OUT IN ANY CAPACITY
- NO PARKING/WORK ON THE SIDEWALK OR TRAIL WITHOUT PRIOR AUTHORIZATION FROM THE CITY
- SHALL CONTACT ANOKA COUNTY SIGNAL DEPARTMENT @ 651-801-8969 FOR SIGNAL RELATED WORK

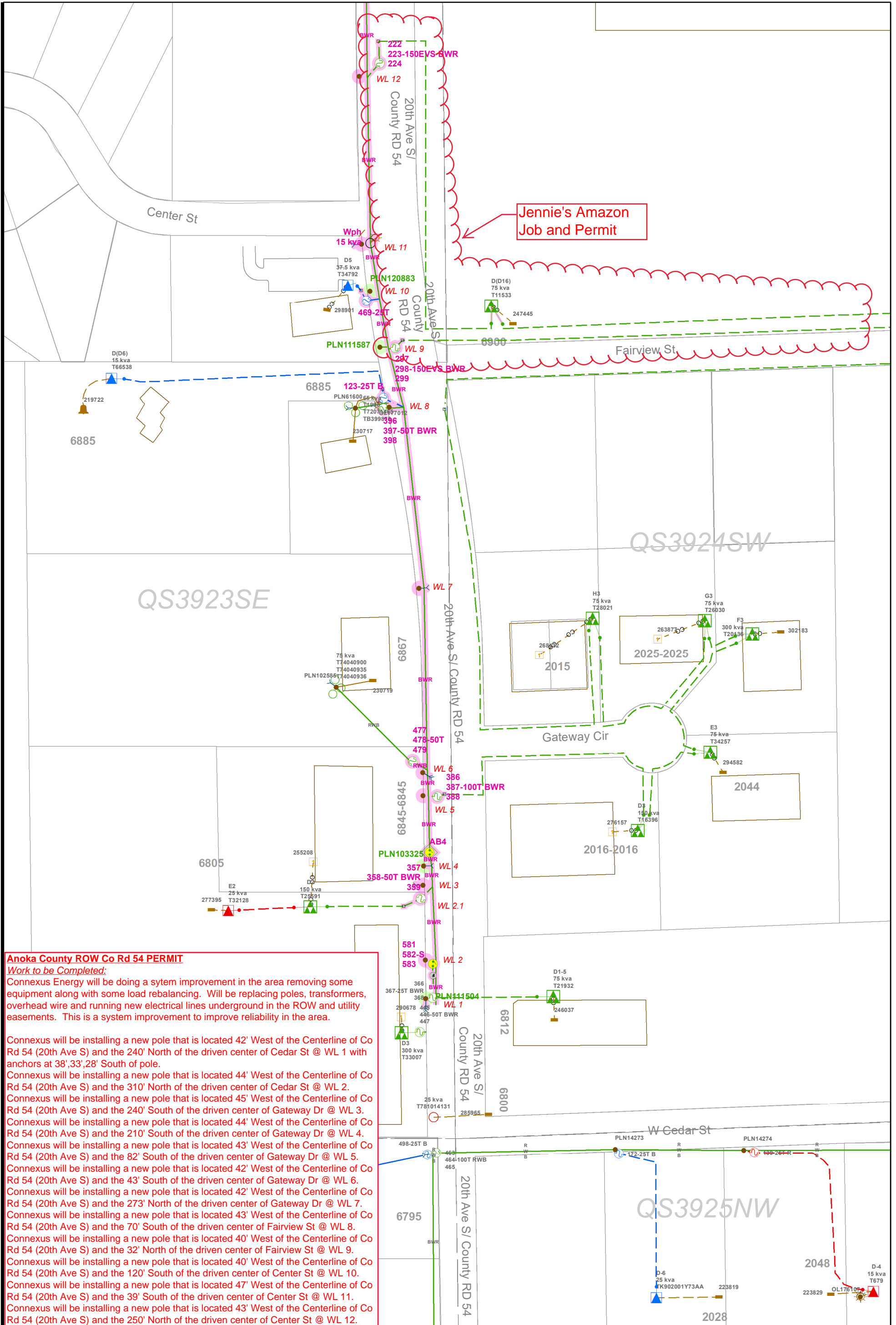

Anoka County ROW Co Rd 54 PERMIT

Work to be Completed:

Connexus Energy will be doing a system improvement in the area removing some equipment along with some load rebalancing. Will be replacing poles, transformers, overhead wire and running new electrical lines underground in the ROW and utility easements. This is a system improvement to improve reliability in the area.

Connexus will be installing a new pole that is located 42' West of the Centerline of Co Rd 54 (20th Ave S) and the 240' North of the driven center of Cedar St @ WL 1 with anchors at 38',33',28' South of pole.

Connexus will be installing a new pole that is located 44' West of the Centerline of Co Rd 54 (20th Ave S) and the 310' North of the driven center of Cedar St @ WL 2.

Connexus will be installing a new pole that is located 45' West of the Centerline of Co Rd 54 (20th Ave S) and the 240' South of the driven center of Gateway Dr @ WL 3.

Connexus will be installing a new pole that is located 44' West of the Centerline of Co Rd 54 (20th Ave S) and the 210' South of the driven center of Gateway Dr @ WL 4.

Connexus will be installing a new pole that is located 43' West of the Centerline of Co Rd 54 (20th Ave S) and the 82' South of the driven center of Gateway Dr @ WL 5.

Connexus will be installing a new pole that is located 42' West of the Centerline of Co Rd 54 (20th Ave S) and the 43' South of the driven center of Gateway Dr @ WL 6.

Connexus will be installing a new pole that is located 42' West of the Centerline of Co Rd 54 (20th Ave S) and the 273' North of the driven center of Gateway Dr @ WL 7.

Connexus will be installing a new pole that is located 43' West of the Centerline of Co Rd 54 (20th Ave S) and the 70' South of the driven center of Fairview St @ WL 8.

Connexus will be installing a new pole that is located 40' West of the Centerline of Co Rd 54 (20th Ave S) and the 32' North of the driven center of Fairview St @ WL 9.

Connexus will be installing a new pole that is located 40' West of the Centerline of Co Rd 54 (20th Ave S) and the 120' South of the driven center of Center St @ WL 10.

Connexus will be installing a new pole that is located 47' West of the Centerline of Co Rd 54 (20th Ave S) and the 39' South of the driven center of Center St @ WL 11.

Connexus will be installing a new pole that is located 43' West of the Centerline of Co Rd 54 (20th Ave S) and the 250' North of the driven center of Center St @ WL 12.

CONNEXUS ENERGY
14601 Ramsey Blvd.
Ramsey, MN 55303

WBR 24 20TH AVE SOUTH OF MAIN REBUILD 3/0 ACSR

Addr: 6867 20TH AVE S

City: CENTERVILLE

T/R/S: T31 R22 S

Crew Sign Off: _____

Date: _____



WO#: W2200374

Date: 1/31/2023

Designer: DAN MESSNER
763.323.2678

THIS PRINT REPRESENTS THE LOCATION OF ELECTRICAL FACILITIES AS OF THE PRINTED DATE TO THE BEST OF OUR KNOWLEDGE. THIS INFORMATION IS INTENDED FOR GENERAL USE ONLY AND IS NOT TO BE USED FOR EXCAVATION PURPOSES. STATE LAW REQUIRES ANYONE DIGGING, GRADING OR EXCAVATING TO OBTAIN A FIELD LOCATION OF ALL UTILITIES. CALL GOPHER STATE ONE CALL FOR A FIELD LOCATION AT 1-800-252-1166.

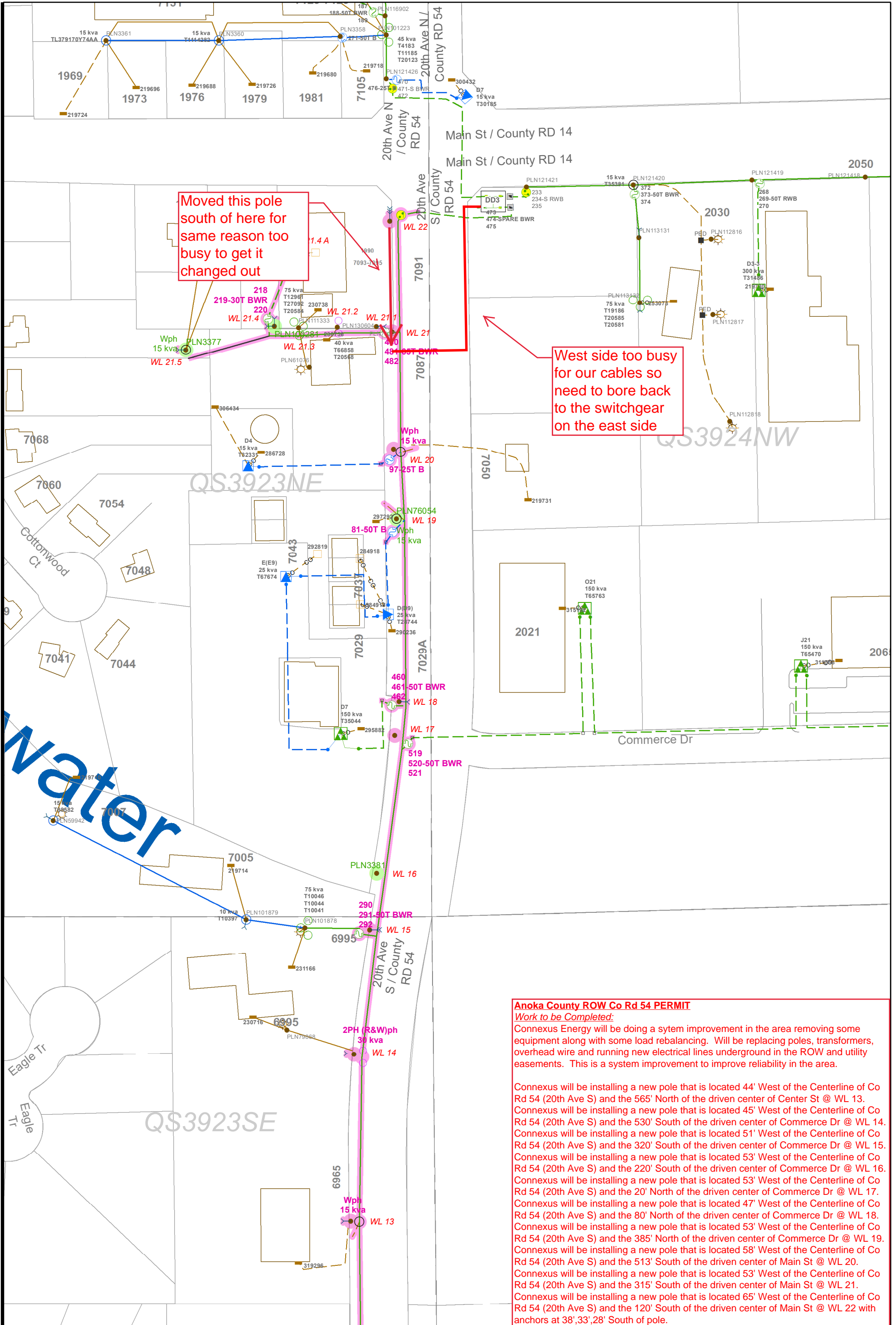

Moved this pole south of here for same reason too busy to get it changed out

West side too busy for our cables so need to bore back to the switchgear on the east side

Anoka County ROW Co Rd 54 PERMIT
Work to be Completed:
 Connexus Energy will be doing a system improvement in the area removing some equipment along with some load rebalancing. Will be replacing poles, transformers, overhead wire and running new electrical lines underground in the ROW and utility easements. This is a system improvement to improve reliability in the area.

Connexus will be installing a new pole that is located 44' West of the Centerline of Co Rd 54 (20th Ave S) and the 565' North of the driven center of Center St @ WL 13.
 Connexus will be installing a new pole that is located 45' West of the Centerline of Co Rd 54 (20th Ave S) and the 530' South of the driven center of Commerce Dr @ WL 14.
 Connexus will be installing a new pole that is located 51' West of the Centerline of Co Rd 54 (20th Ave S) and the 320' South of the driven center of Commerce Dr @ WL 15.
 Connexus will be installing a new pole that is located 53' West of the Centerline of Co Rd 54 (20th Ave S) and the 220' South of the driven center of Commerce Dr @ WL 16.
 Connexus will be installing a new pole that is located 53' West of the Centerline of Co Rd 54 (20th Ave S) and the 20' North of the driven center of Commerce Dr @ WL 17.
 Connexus will be installing a new pole that is located 47' West of the Centerline of Co Rd 54 (20th Ave S) and the 80' North of the driven center of Commerce Dr @ WL 18.
 Connexus will be installing a new pole that is located 53' West of the Centerline of Co Rd 54 (20th Ave S) and the 385' North of the driven center of Commerce Dr @ WL 19.
 Connexus will be installing a new pole that is located 58' West of the Centerline of Co Rd 54 (20th Ave S) and the 513' South of the driven center of Main St @ WL 20.
 Connexus will be installing a new pole that is located 53' West of the Centerline of Co Rd 54 (20th Ave S) and the 315' South of the driven center of Main St @ WL 21.
 Connexus will be installing a new pole that is located 65' West of the Centerline of Co Rd 54 (20th Ave S) and the 120' South of the driven center of Main St @ WL 22 with anchors at 38', 33', 28' South of pole.

THIS PRINT REPRESENTS THE LOCATION OF ELECTRICAL FACILITIES AS OF THE PRINTED DATE TO THE BEST OF OUR KNOWLEDGE. THIS INFORMATION IS INTENDED FOR GENERAL USE ONLY AND IS NOT TO BE USED FOR EXCAVATION PURPOSES. STATE LAW REQUIRES ANYONE DIGGING, GRADING OR EXCAVATING TO OBTAIN A FIELD LOCATION OF ALL UTILITIES. CALL GOPHER STATE ONE CALL FOR A FIELD LOCATION AT 1-800-252-1166.

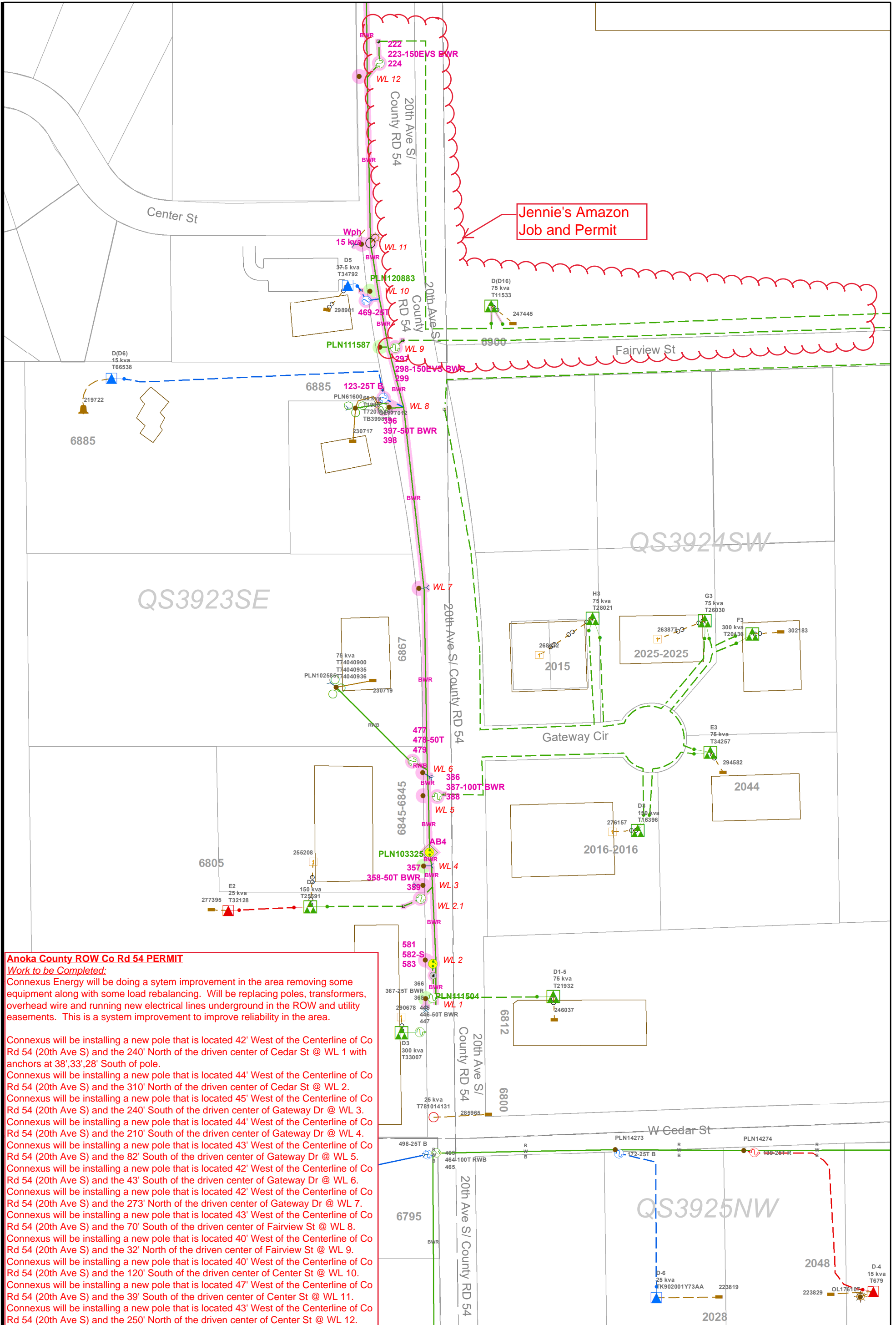

Jennie's Amazon Job and Permit

Anoka County ROW Co Rd 54 PERMIT

Work to be Completed:

Connexus Energy will be doing a system improvement in the area removing some equipment along with some load rebalancing. Will be replacing poles, transformers, overhead wire and running new electrical lines underground in the ROW and utility easements. This is a system improvement to improve reliability in the area.

Connexus will be installing a new pole that is located 42' West of the Centerline of Co Rd 54 (20th Ave S) and the 240' North of the driven center of Cedar St @ WL 1 with anchors at 38',33',28' South of pole.

Connexus will be installing a new pole that is located 44' West of the Centerline of Co Rd 54 (20th Ave S) and the 310' North of the driven center of Cedar St @ WL 2.

Connexus will be installing a new pole that is located 45' West of the Centerline of Co Rd 54 (20th Ave S) and the 240' South of the driven center of Gateway Dr @ WL 3.

Connexus will be installing a new pole that is located 44' West of the Centerline of Co Rd 54 (20th Ave S) and the 210' South of the driven center of Gateway Dr @ WL 4.

Connexus will be installing a new pole that is located 43' West of the Centerline of Co Rd 54 (20th Ave S) and the 82' South of the driven center of Gateway Dr @ WL 5.

Connexus will be installing a new pole that is located 42' West of the Centerline of Co Rd 54 (20th Ave S) and the 43' South of the driven center of Gateway Dr @ WL 6.

Connexus will be installing a new pole that is located 42' West of the Centerline of Co Rd 54 (20th Ave S) and the 273' North of the driven center of Gateway Dr @ WL 7.

Connexus will be installing a new pole that is located 43' West of the Centerline of Co Rd 54 (20th Ave S) and the 70' South of the driven center of Fairview St @ WL 8.

Connexus will be installing a new pole that is located 40' West of the Centerline of Co Rd 54 (20th Ave S) and the 32' North of the driven center of Fairview St @ WL 9.

Connexus will be installing a new pole that is located 40' West of the Centerline of Co Rd 54 (20th Ave S) and the 120' South of the driven center of Center St @ WL 10.

Connexus will be installing a new pole that is located 47' West of the Centerline of Co Rd 54 (20th Ave S) and the 39' South of the driven center of Center St @ WL 11.

Connexus will be installing a new pole that is located 43' West of the Centerline of Co Rd 54 (20th Ave S) and the 250' North of the driven center of Center St @ WL 12.

CONNEXUS ENERGY
 14601 Ramsey Blvd.
 Ramsey, MN 55303

WBR 24 20TH AVE SOUTH OF MAIN REBUILD 3/0 ACSR

Addr: 6867 20TH AVE S

City: CENTERVILLE

T/R/S: T31 R22 S

Crew Sign Off: _____

Date: _____

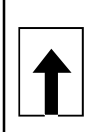

WO#: W2200374

Date: 1/31/2023

Designer: DAN MESSNER
 763.323.2678

THIS PRINT REPRESENTS THE LOCATION OF ELECTRICAL FACILITIES AS OF THE PRINTED DATE TO THE BEST OF OUR KNOWLEDGE. THIS INFORMATION IS INTENDED FOR GENERAL USE ONLY AND IS NOT TO BE USED FOR EXCAVATION PURPOSES. STATE LAW REQUIRES ANYONE DIGGING, GRADING OR EXCAVATING TO OBTAIN A FIELD LOCATION OF ALL UTILITIES. CALL GOPHER STATE ONE CALL FOR A FIELD LOCATION AT 1-800-252-1166.

1:1,800

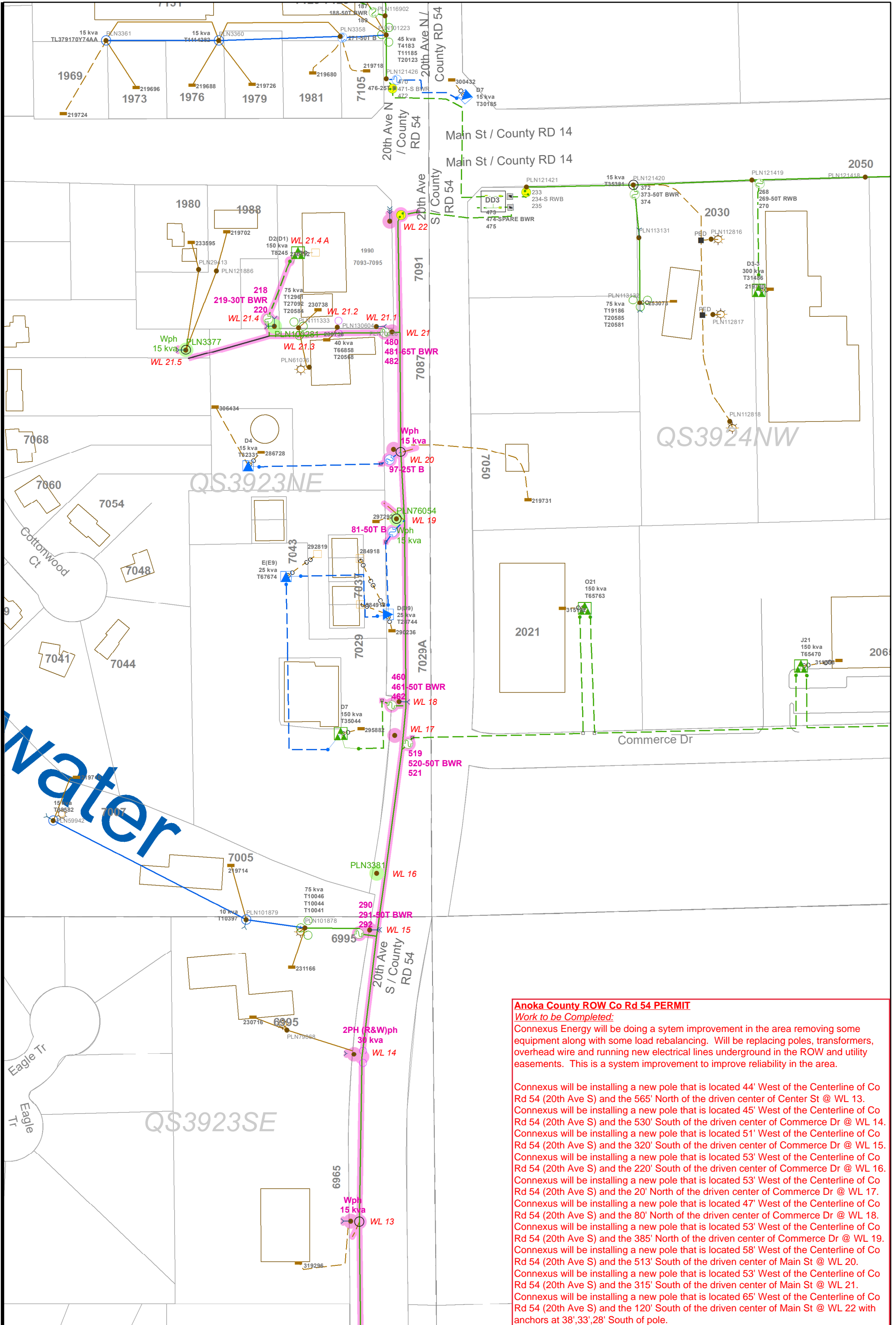

Anoka County ROW Co Rd 54 PERMIT
Work to be Completed:
 Connexus Energy will be doing a system improvement in the area removing some equipment along with some load rebalancing. Will be replacing poles, transformers, overhead wire and running new electrical lines underground in the ROW and utility easements. This is a system improvement to improve reliability in the area.

Connexus will be installing a new pole that is located 44' West of the Centerline of Co Rd 54 (20th Ave S) and the 565' North of the driven center of Center St @ WL 13.
 Connexus will be installing a new pole that is located 45' West of the Centerline of Co Rd 54 (20th Ave S) and the 530' South of the driven center of Commerce Dr @ WL 14.
 Connexus will be installing a new pole that is located 51' West of the Centerline of Co Rd 54 (20th Ave S) and the 320' South of the driven center of Commerce Dr @ WL 15.
 Connexus will be installing a new pole that is located 53' West of the Centerline of Co Rd 54 (20th Ave S) and the 220' South of the driven center of Commerce Dr @ WL 16.
 Connexus will be installing a new pole that is located 53' West of the Centerline of Co Rd 54 (20th Ave S) and the 20' North of the driven center of Commerce Dr @ WL 17.
 Connexus will be installing a new pole that is located 47' West of the Centerline of Co Rd 54 (20th Ave S) and the 80' North of the driven center of Commerce Dr @ WL 18.
 Connexus will be installing a new pole that is located 53' West of the Centerline of Co Rd 54 (20th Ave S) and the 385' North of the driven center of Commerce Dr @ WL 19.
 Connexus will be installing a new pole that is located 58' West of the Centerline of Co Rd 54 (20th Ave S) and the 513' South of the driven center of Main St @ WL 20.
 Connexus will be installing a new pole that is located 53' West of the Centerline of Co Rd 54 (20th Ave S) and the 315' South of the driven center of Main St @ WL 21.
 Connexus will be installing a new pole that is located 65' West of the Centerline of Co Rd 54 (20th Ave S) and the 120' South of the driven center of Main St @ WL 22 with anchors at 38', 33', 28' South of pole.

CONNEXUS ENERGY
 14601 Ramsey Blvd.
 Ramsey, MN 55303

THIS PRINT REPRESENTS THE LOCATION OF ELECTRICAL FACILITIES AS OF THE PRINTED DATE TO THE BEST OF OUR KNOWLEDGE. THIS INFORMATION IS INTENDED FOR GENERAL USE ONLY AND IS NOT TO BE USED FOR EXCAVATION PURPOSES. STATE LAW REQUIRES ANYONE DIGGING, GRADING OR EXCAVATING TO OBTAIN A FIELD LOCATION OF ALL UTILITIES. CALL GOPHER STATE ONE CALL FOR A FIELD LOCATION AT 1-800-252-1166.

WBR 24 20TH AVE SOUTH OF MAIN REBUILD 3/0 ACSR
Addr: 7015 20TH AVE S
City: CENTERVILLE
T/R/S: T31 R22 S
Crew Sign Off: _____
Date: _____

WO#: W2200374
Date: 1/31/2023
Designer: DAN MESSNER
 763.323.2678

↑

1:1,800

Page 2 of 2



New pothole location (facing NB
towards CSAH 14)



New pothole location (facing WB - curb)