



ANOKA COUNTY TRANSPORTATION DIVISION

1440 BUNKER LAKE BLVD NW

ANDOVER, MN 55304

763-324-3176

highwaypermits@co.anoka.mn.us

**RIGHT OF WAY
PERMIT NUMBER
23-063**

CSAH 23

CR

**APPLICATION FOR PERMIT FOR INSTALLATION OF UTILITIES OR PLACING OBSTRUCTIONS ON THE COUNTY HIGHWAY SYSTEM
ALL APPLICANTS MUST BE REGISTERED PRIOR TO PERMIT APPROVAL**

WORK TO START ON

WORK TO BE COMPLETED ON

DURATION OF JOB

ARE YOU BEING ASKED TO RELOCATE DUE TO A COUNTY PROJECT?

ANOKA COUNTY PROJECT NUMBER

APPLICANT NAME

CONTACT PERSON

ADDRESS

CITY

PHONE NUMBER

EMAIL

COMPANY OR INDIVIDUAL PERFORMING WORK

CONTACT PERSON

PHONE NUMBER

EMAIL

ADDRESS OF WORK SITE

CITY

NATURE OF WORK

METHOD OF INSTALLATION/CONSTRUCTION

SURFACE TO BE DISTURBED

SITE PLAN

WILL TRAFFIC BE OBSTRUCTED?

TRAFFIC CONTROL PLAN

DITCH

**TO BE
SUBMITTED**

**TO BE
SUBMITTED**

GRAVEL

VIA EMAIL

VIA EMAIL

BITUMINOUS

CONCRETE

NONE

DEPTH FROM SURFACE

SIZE AND KIND OF PIPE/CABLE

NUMBER OF EXCAVATIONS

SIZE OF EXCAVATIONS

LOCATION OF EXCAVATIONS

ADDITIONAL DOCUMENTS

TO BE SUBMITTED VIA EMAIL - CITY/MNDOT PERMITS, PHOTOS OF AREA, ETC.

THIS PERMIT COVERS THE RIGHT OF WAY IN ANOKA COUNTY ONLY

ACHD reserves the right to make changes to these special conditions.



ANOKA COUNTY TRANSPORTATION DIVISION

1440 BUNKER LAKE BLVD NW
 ANDOVER, MN 55304
 PERMIT PHONE: 763-324-3176
 highwaypermits@co.anoka.mn.us

GENERAL INFORMATION	
ONE PERMIT MUST BE APPROVED FOR EACH COUNTY ROAD ON WHICH WORK WILL BE PERFORMED PRIOR TO ANY WORK WITHIN THE RIGHT OF WAY BY ANY UTILITY/CONTRACTOR. EMERGENCY CONDITIONS WHICH THREATEN THE SAFETY OF THE PUBLIC AND REQUIRE IMMEDIATE REPAIR ARE EXCEPTIONS TO THIS RULE. UNDER THOSE CIRCUMSTANCES, THE UTILITY/CONTRACTOR, IS PERMITTED TO BEGIN AND/OR COMPLETE THE NECESSARY REPAIRS. ACTD SHALL BE NOTIFIED OF EMERGENCY REPAIRS AS SOON AS FEASIBLE AND A WRITTEN PERMIT IS TO BE COMPLETED WITHIN TWO BUSINESS DAYS OF OCCURRENCE.	
A LICENSE-PERMIT BOND IS GENERALLY REQUIRED OF THE CONTRACTOR AS PART OF THE REGISTRATION PROCESS. THE AMOUNT OF WHICH WILL BE DETERMINED BY THE NATURE OF THE UTILITY WORK.	
A SKETCH OR DRAWING SHALL ACCOMPANY EACH PERMIT APPLICATION WHICH WILL SHOW THE LOCATION OF THE PROPOSED WORK/UTILITY WITH REFERENCE TO THE COUNTY HIGHWAY CENTER LINE AND RIGHT OF WAY LINE. A COMPLETE SET OF PLANS IS REQUIRED FOR ALL SEWER/WATER PROJECTS.	
IT SHALL BE THE RESPONSIBILITY OF THE APPLICANT TO DETERMINE WHICH OF THE SPECIAL CONDITIONS APPLY TO EACH PERMIT.	
THE ANOKA COUNTY TRANSPORTATION DIVISION (ACTD) RESERVES THE RIGHT TO REVOKE ANY UTILITY PERMIT AND HALT WORK, IF, UPON INSPECTION OF ANY JOB SITE, THE SPECIAL CONDITIONS ARE NOT MET, AND/OR A HAZARD EXISTS FOR THE APPLICANT OR PUBLIC SAFETY IS THREATENED. THE FAILURE TO COMPLY WITH THE TERMS AND CONDITIONS OF ANY APPLICABLE FEDERAL, STATE, REGIONAL, AND LOCAL LAWS, RULES AND REGULATIONS, INCLUDING ANY PROVISION OF ANOKA COUNTY'S RIGHT-OF-WAY ORDINANCE SHALL BE CAUSE FOR IMMEDIATE REVOCATION OF A PERMIT.	
THE APPLICANT SHALL NOTIFY ACTD IMMEDIATELY UPON COMPLETION OF PROJECT SO THAT THE ACTD CAN INSPECT THE SITE TO DETERMINE WHETHER OR NOT RESTORATION HAS BEEN SATISFACTORILY COMPLETED.	
THE UNDERSIGNED, HEREBY ACCEPTS THE TERMS AND CONDITIONS OF THIS PERMIT AND THE REGULATIONS OF ANOKA COUNTY, AND AGREES TO FULLY COMPLY THEREWITH TO THE SATISFACTION OF THE ACTD. THE COUNTY OF ANOKA, ITS OFFICIALS, EMPLOYEES, AND AGENTS, SHALL BE HELD HARMLESS, BY THE APPLICANT/PERMITTEE, FROM ANY DEMANDS, CLAIMS, LAWSUITS, OR DAMAGES RELATING TO THE WORK DESCRIBED IN THIS PERMIT.	
APPLICANT'S SIGNATURE <i>Luke Bastil</i>	DATE

AUTHORIZATION OF PERMIT	
IN CONSIDERATION OF THE APPLICANT'S AGREEMENT TO COMPLY IN ALL RESPECTS WITH THE REGULATIONS OF THE ACTD COVERING SUCH OPERATIONS, PERMISSION IS HEREBY GRANTED FOR THE WORK TO BE DONE AS DESCRIBED IN THE ABOVE APPLICATION. SAID WORK TO BE DONE IN ACCORDANCE WITH THE GENERAL CONDITIONS LISTED ABOVE AND THE SPECIAL CONDITIONS REQUIRED AS HEREBY STATED. IT IS EXPRESSLY UNDERSTOOD THAT THIS PERMIT IS CONDITIONED UPON REPLACEMENT OR RESTORATION OF THE COUNTY HIGHWAY AND ITS RIGHT OF WAY TO THEIR ORIGINAL OR TO A SATISFACTORY CONDITION. IT IS FURTHER UNDERSTOOD THAT THIS PERMIT IS ISSUED SUBJECT TO THE APPROVAL OF LOCAL CITY OR TOWNSHIP AUTHORITIES HAVING JOINT SUPERVISION OVER SAID STREET OR HIGHWAY.	
APPROVED BY: <i>Susan Burgmeier</i> TITLE: <i>Associate Traffic Technician</i>	DATE 03/08/2023

THIS PERMIT COVERS THE RIGHT OF WAY IN ANOKA COUNTY ONLY
ACHD reserves the right to make changes to these special conditions.



ANOKA COUNTY TRANSPORTATION DIVISION

1440 BUNKER LAKE BLVD NW

ANDOVER, MN 55304

PERMIT PHONE: 763-324-3176

highwaypermits@co.anoka.mn.us

SPECIAL CONDITIONS

TRAFFIC CONTROL

- 1) DETOURS
 - a) DETAILED DETOUR LAYOUTS SHALL BE SUBMITTED TO THE TRAFFIC ENGINEER FOR APPROVAL.
 - b) NO DETOURS SHALL BE PERMITTED WITHOUT PRIOR APPROVAL OF THE ANOKA COUNTY TRAFFIC ENGINEER.
 - c) TEN DAYS NOTICE MUST BE GIVEN PRIOR TO THE INSTALLATION OF ANY DETOUR.
 - d) IT SHALL BE THE RESPONSIBILITY OF THE APPLICANT TO NOTIFY ANOKA COUNTY CENTRAL COMMUNICATIONS, LOCAL GOVERNMENT BODIES, AND ANY AFFECTED BUS COMPANIES TEN DAYS PRIOR TO ANY ROAD CLOSURES/DETOURS.
 - e) IMMEDIATELY UPON COMPLETION OF WORK AND/OR DETOURS, ALL POSTS, BARRICADES, AND SIGNS SHALL BE REMOVED FROM THE RIGHT OF WAY.
- 2) TRAFFIC CONTROL DEVICES
 - a) ALL TRAFFIC CONTROL DEVICES, BARRICADES, FLASHERS, ETC., SHALL BE FURNISHED BY THE APPLICANT AND SHALL BE IN ACCORDANCE WITH THE MOST RECENT EDITION OF THE MINNESOTA MANUAL ON UNIFORM TRAFFIC CONTROL DEVICES AND TEMPORARY TRAFFIC CONTROL ZONE LAYOUTS – FIELD MANUAL OF THE SAME MANUAL.

CONSTRUCTION REQUIREMENTS

- 1) OPEN CUTTING OF BITUMINOUS OR CONCRETE SURFACED ROADS WILL BE ALLOWED ONLY AT THE DISCRETION OF THE COUNTY ENGINEER.
- 2) NEITHER SUPPLIES NOR EXCAVATION MATERIALS SHALL BE PLACED ON THE BITUMINOUS OR CONCRETE SURFACE AT ANY TIME.
- 3) NO TRENCHES WILL BE ALLOWED TO REMAIN OPEN OVERNIGHT.
- 4) MATERIALS REMOVED FROM THE TRENCH SHALL BE USED AS BACKFILL INSOFAR AS THEY ARE SUITABLE. ALL BACKFILL MATERIAL SHALL CONFORM TO MNDOT SPECIFICATIONS FOR COMPACTION. THE USE OF HEAVY EQUIPMENT ON TOP OF TRENCH, SLAPPING WITH BACKHOE BUCKET AND/OR BACKCASTING TO ACHIEVE COMPACTION IS PROHIBITED. ANY ADDITIONAL MATERIAL REQUIRED TO BACK FILL TO THE ORIGINAL GRADE SHALL BE FURNISHED BY THE APPLICANT AT NO EXPENSE TO THE ACTD. ALL THE BASE AND SURFACE COURSES DAMAGED DURING CONSTRUCTION OPERATIONS SHALL BE RESTORED TO A CONDITION EQUAL TO OR BETTER THAN BEFORE OPERATIONS BEGAN. THE APPLICANT SHALL BE RESPONSIBLE FOR AND RESTORE ANY SETTLEMENT.
- 5) ALL CULVERTS, DITCHES, SHOULDERS, AND BACKSLOPES SHALL BE RESTORED TO THEIR ORIGINAL CONDITION UNLESS OTHERWISE DIRECTED BY THE ACTD. SHOULDERS WHICH HAVE BEEN PREVIOUSLY CONSTRUCTED OR RECONSTRUCTED WITH SPECIAL MATERIALS SHALL BE REPLACED IN KIND. RESTORATION OF SIGNS, GUARDRAILS, GUARDPOSTS, ETC., ARE THE SOLE RESPONSIBILITY OF THE APPLICANT AND SHALL BE RESTORED TO THEIR ORIGINAL CONDITION.
- 6) ALL ROADWAY MAINTENANCE REQUIRED WITHIN THE LIMITS OF THE UTILITY PROJECT THAT IS RELATED TO THE APPLICANT'S ACTIVITIES SHALL BE THE SOLE RESPONSIBILITY OF THE APPLICANT FOR ONE YEAR AFTER COMPLETION OF THE PROJECT. UPON COMPLETION OF THE RESTORATION WORK, THE APPLICANT SHALL REQUEST A FINAL INSPECTION BY THE ACTD. THE ACTD'S APPROVED COMPLETION DATE SHALL BE THE STARTING DATE OF THE APPLICANT'S ONE YEAR RESPONSIBILITY.

HORIZONTAL BORING AND JACKING

- 1) ALL HARD SURFACE ROADWAYS SHALL BE JACKED OR BORED.
- 2) ALL CROSSINGS OF ANOKA COUNTY MAINTAINED ROADBEDS SHALL BE MADE BY BORING INSIDE A CASING OR CARRIER PIPE, OR BY JACKING UNLESS OTHERWISE DIRECTED BY THE ANOKA COUNTY ENGINEER. THE AUGER SHALL LEAD THE CASING OR CARRIER PIPE BY AT LEAST SIX INCHES WHENEVER POSSIBLE AND NEVER LEAD THE CARRIER PIPE BY MORE THAN ONE INCH.
- 3) THE USE OF PNEUMATIC DEVICES TO FACILITATE THE ROADBED CROSSINGS WILL BE ALLOWED IN MOST CASES WITH PRIOR APPROVAL. IN THE EVENT APPROVAL IS NOT GRANTED AND APPLICANT USES A PNEUMATIC DEVICE TO CROSS A ROADBED AND ENCOUNTERS AN OBSTRUCTION AND/OR UNSTABLE SUBBASE MATERIAL WHICH MAKES FORWARD OR REVERSE MOTION OF PNEUMATIC DEVICE IMPOSSIBLE, SAID PNEUMATIC DEVICE THEN BECOMES PART OF THE ROADWAY SUBBASE AND PERMISSION TO EXCAVATE TO RETRIEVE DEVICE WILL NOT BE GRANTED.
- 4) IF A PNEUMATIC DEVICE IS USED FOR THE WORK PERMITTED HEREIN, THE INSTALLATION MUST BE KEPT TO A MINIMUM OF FOUR FEET BELOW THE SURFACE OF THE ROADWAY IF THE PNEUMATIC DEVICE IS LESS THAN TWO INCHES IN DIAMETER, AND A MINIMUM OF FIVE FEET BELOW THE SURFACE OF THE ROADWAY IF THE PNEUMATIC DEVICE IS TWO INCHES IN DIAMETER OR LARGER.

BITUMINOUS RESTORATION

- 1) THE LOCATIONS AND DIMENSIONS OF ALL OPENINGS TO BE MADE IN THE BITUMINOUS SURFACE SHALL BE APPROVED BY THE ACTD PRIOR TO ANY CUTTING OR ANY SURFACE OPENING OPERATIONS.
- 2) ALL OPENINGS IN BITUMINOUS SURFACES SHALL BE CUT IN A STRAIGHT LINE WITH THE SIDES SMOOTH AND VERTICAL. NO RAGGED EDGES WILL BE PERMITTED. CUTTING SHALL BE DONE WITH A CONCRETE SAW.
- 3) ALL NECESSARY DUST CONTROL OPERATIONS SHALL BE CARRIED OUT BY THE APPLICANT AT NO EXPENSE TO ANOKA COUNTY.
- 4) THE MINIMUM REQUIREMENT FOR SUBGRADE REPLACEMENT SHALL BE THE UPPER TWELVE INCHES OF MATERIAL AND SHALL MEET MNDOT SPECIFICATIONS FOR CLASS FIVE PLACED IN SIX INCH LAYERS COMPACTED TO ONE HUNDRED PERCENT OF OPTIMUM DENSITY.
- 5) ALL MANHOLE CASINGS, GATE VALVES, AND OTHER UTILITY STRUCTURES SHALL BE SET ONE QUARTER INCH BELOW THE TOP OF THE FINISHED SURFACE.
- 6) BITUMINOUS TACK COAT MATERIALS AND APPLICATION THEREOF SHALL CONFORM TO MNDOT SPECIFICATION 2357.
- 7) ALL BITUMINOUS SURFACING SHALL BE REPLACED AS SOON AS PRACTICAL AFTER THE BASE CONSTRUCTION. ALL BITUMINOUS SURFACING SHALL BE MACHINE LAID. ANY EXCEPTIONS MUST BE APPROVED BY THE ACTD. BITUMINOUS SURFACING SHALL BE REPLACED TO ORIGINAL PAVEMENT DEPTH OR TO A MINIMUM OF SIX INCHES OF BITUMINOUS MIXTURE (2360), WHICHEVER IS GREATER. BITUMINOUS MIXTURES MUST BE PLACED IN LIFTS NOT EXCEEDING THREE INCHES IN THICKNESS FOR BASE AND BINDER COURSES AND NOT EXCEEDING TWO INCHES FOR THE WEAR COURSE.
- 8) ALL SURFACE RESTORATION REGARDLESS OF SIZE SHALL CONFORM TO EXISTING GRADES.
- 9) ANY UNNECESSARY OR NEGLIGENT DAMAGE TO BITUMINOUS SURFACE IN CONJUNCTION WITH THE INSTALLATION AND/OR REPAIR OF A UTILITY SHALL BE CUT OUT AND REPLACED IN KIND AS DIRECTED BY THE ACTD.

THIS PERMIT COVERS THE RIGHT OF WAY IN ANOKA COUNTY ONLY
ACHD reserves the right to make changes to these special conditions.



ANOKA COUNTY TRANSPORTATION DIVISION

1440 BUNKER LAKE BLVD NW

ANDOVER, MN 55304

PERMIT PHONE: 763-324-3176

highwaypermits@co.anoka.mn.us

CONCRETE RESTORATION

- 1) CURB AND GUTTER, SIDEWALKS, AND DRIVEWAYS SHALL BE RESTORED IN ACCORDANCE WITH MNDOT SPECIFICATIONS 2531 AND 2521.

UTILITY LINES

- 1) THERE SHALL BE ONLY A SINGLE POLE LINE ON THE COUNTY RIGHT OF WAY ON EITHER SIDE OF THE CENTER LINE THEREOF.
- 2) EXACT LOCATIONS OF LONGITUDINAL INSTALLATIONS ON COUNTY HIGHWAYS SHALL BE LOCATED AS DIRECTED BY THE ACTD.

SECTION CORNER MONUMENTS

- 1) UTILITY LOCATIONS SHALL NOT INTERFERE WITH THE LOCATION OF ANY SECTION, QUARTER, WITNESS, OR RIGHT OF WAY MONUMENTS. FOR ASSISTANCE IN LOCATIONS, CONTACT THE ANOKA COUNTY SURVEYOR'S OFFICE.
- 2) THE APPLICANT SHALL BE RESPONSIBLE FOR REPLACEMENT OF ANY EXISTING PROPERTY IRONS DISTURBED DURING CONSTRUCTION.
- 3) THE APPLICANT SHALL NOTIFY THE ANOKA COUNTY SURVEYOR'S OFFICE THREE WORKING DAYS IN ADVANCE OF ANY ANTICIPATED DISTURBANCE OF ANY SECTION, QUARTER, WITNESS, OR RIGHT OF WAY MONUMENTS.
- 4) ANY MONUMENT DISTURBED DURING THE COURSE OF CONSTRUCTION SHALL BE RESET BY THE ANOKA COUNTY SURVEYOR'S OFFICE AT THE EXPENSE OF THE APPLICANT.

ATTACHING TO BRIDGES/STRUCTURES

- 1) NO UTILITY IS PERMITTED TO BE HUNG FROM, OR OTHERWISE ATTACHED TO ANY BRIDGE OR STRUCTURE WITHOUT HAVING DETAILED PLANS APPROVED BY THE ANOKA COUNTY ENGINEER. THESE PLANS ARE TO SHOW APPROACHES TO THE STRUCTURE, METHOD OF INSTALLATION, TYPE, AND DIMENSION OF HOUSING FOR THE UTILITY.

INITIAL

SPECIAL CONDITIONS FOR ADVANCE NOTIFICATION FOR COMMENCEMENT & COMPLETION OF WORK

PERMIT HOLDER:

PERMIT NUMBER:

ROAD NUMBER:

CONTRACTOR CONTACT:

PERMIT ACTIVE DATE:

PERMIT EXPIRE DATE:

ALL SUBCONTRACTORS, INSTALLERS, AND CREW SHALL POSSESS A COPY OF ALL DOCUMENTS IN RELATION TO THE APPROVED PERMIT PRIOR TO THE COMMENCEMENT OF WORK AND BE KEPT ON SITE. THIS INCLUDES, BUT IS NOT LIMITED TO, THE FOLLOWING:

- APPROVED PERMIT
- NOTIFICATION SHEET
- ANY/ALL TRAFFIC CONTROL LAYOUTS/PLANS

SPECIAL CONDITIONS

- ALL TRAFFIC CONTROL SHALL BE IN ACCORDANCE WITH THE MOST CURRENT VERSION OF THE MNDOT TEMPORARY TRAFFIC CONTROL FIELD MANUAL
- SHALL USE A SHOULDER CLOSURE (LAYOUT 8) IF ANY PORTION OF THE SHOULDER IS ENCROACHED
- NO CLOSURES WITHOUT PRIOR APPROVAL FROM ACHD
- ALL TRAFFIC CONTROL DEVICES SHALL BE REMOVED, SIGNS TURNED, LAID DOWN, OR COVERED AT THE END OF EACH WORK DAY, OR WHEN NO WORK IS TAKING PLACE UNLESS WRITTEN APPROVAL STATING OTHERWISE
- SHALL NOTIFY ANDREA SCHMID (andrea.schmid@co.anoka.mn.us or 763-324-3128) 48 HOURS PRIOR TO THE COMMENCEMENT OF WORK WITH THE PERMIT NUMBER, THE DATE/TIME WORK IS TO BE PERFORMED, AND THE ESTIMATED DURATION OF WORK
- SHALL NOTIFY ANDREA SCHMID (andrea.schmid@co.anoka.mn.us or 763-324-3128) WHEN WORK IS COMPLETE
- NO WORK DURING INCLEMENT WEATHER OR WHEN PLOWS ARE OUT IN ANY CAPACITY
- 60" UNDER CSAH 23
- PITS TO BE PROTECTED AT ALL TIMES. TO BE BACKFILLED IF UNATTENDED OR OVERNIGHT

Project Note: AE to UG due to Poles being removed. Most Rear Easement Poles are staying.

Map 1 of 2

CONTACT INFO:
 USI Contact: Laura
 651-249-5108
 Lmorrison@USI-Universal.com
 Comcast Contact: Luke
 651-262-6600
 Luke_Bastil@Comcast.com

**Forced Relo
 Connexus Pole Removal
 4 Inner Dr
 Circle Pines, MN
 JB0001316049
 Node: CRCP006
 Legacy:**

PED (NEW)	(EXISTING)	UTILITY POLE	LOCK BOX
VAULT (NEW)	(EXISTING)	JUNCTION BOX	JUNCTION BOX
NEW UG PLACEMENT		UTILITY, MECHANICAL, DATA ROOM	
EXISTING CONDUIT		FOOTAGE	
AERIAL PLACEMENT		SPLICE CASE	
INTERNAL PLACEMENT		FIBER PANEL	
.860 CABLE		BUILDING ADDRESS	
.715 CABLE			
TAP (2-PORT)			
TAP (4-PORT)			
TAP (8-PORT)			

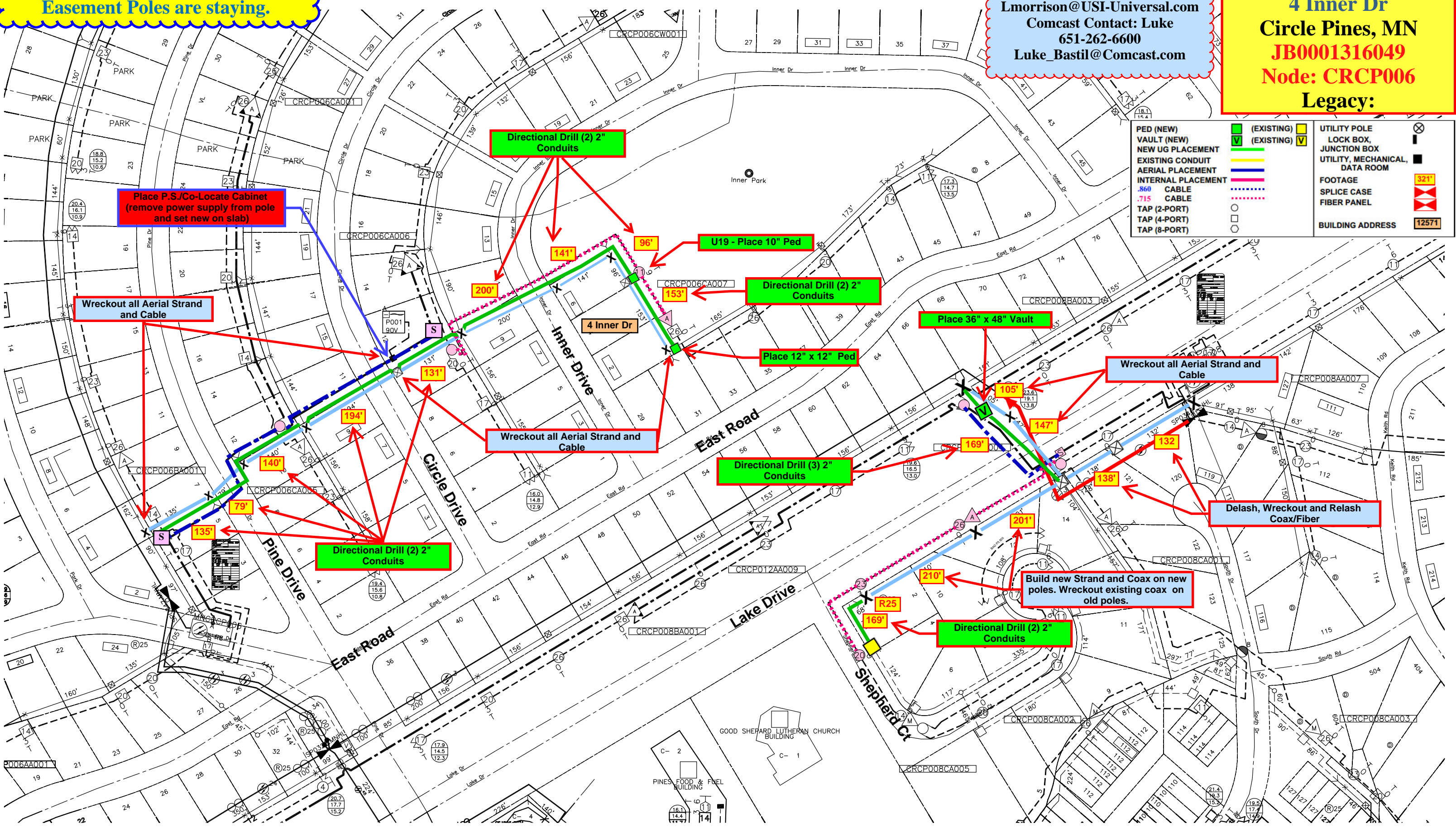

GOOD SHEPARD LUTHERAN CHURCH BUILDING
 PINES FOOD & FUEL BUILDING

Project Note: AE to UG due to Poles being removed. Most Rear Easement Poles are staying.

Map 2 of 2

CONTACT INFO:
 USI Contact: Laura
 651-249-5108
 Lmorrison@USI-Universal.com
 Comcast Contact: Luke
 651-262-6600
 Luke_Bastil@Comcast.com

Forced Relo
Connexus Pole Removal
4 Inner Dr
Circle Pines, MN
JB0001316049
Node: CRCP006
Legacy:

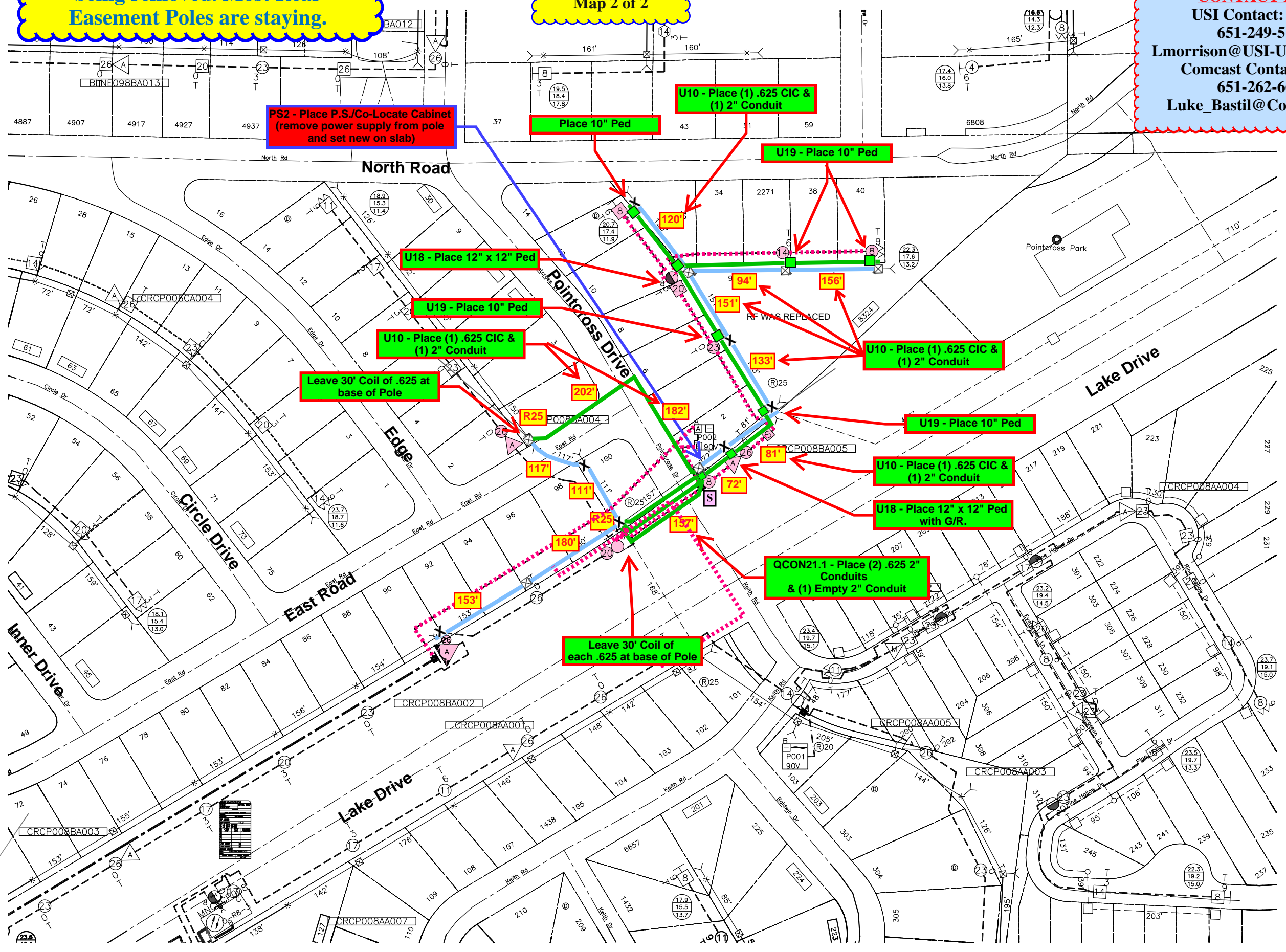

PED (NEW)	(EXISTING)	UTILITY POLE	⊗
VAULT (NEW)	(EXISTING)	LOCK BOX,	⊠
NEW UG PLACEMENT		JUNCTION BOX	⊞
EXISTING CONDUIT		UTILITY, MECHANICAL,	⊞
AERIAL PLACEMENT		DATA ROOM	⊞
INTERNAL PLACEMENT		FOOTAGE	⊞
.860 CABLE		SPLICE CASE	⊞
.715 CABLE		FIBER PANEL	⊞
TAP (2-PORT)		BUILDING ADDRESS	⊞
TAP (4-PORT)			
TAP (8-PORT)			