

APPLICATION FOR PERMIT FOR INSTALLATION OF UTILITIES OR PLACING OBSTRUCTIONS ON THE COUNTY HIGHWAY SYSTEM
ALL APPLICANTS MUST BE REGISTERED PRIOR TO PERMIT APPROVAL

APPLICANT NAME

Centurylink/ Lumen

CONTACT PERSON

Susan Blue

ADDRESS

2050 4th st

CITY

WHITE BEAR LAKE MN 55110

PHONE NUMBER

6513782650

EMAIL

SUSAN.BLUE@centurylink.COM

COMPANY OR INDIVIDUAL PERFORMING WORK

TELCOM CONST

CONTACT PERSON

JEREMY OLSON

EMAIL

jeremy.olson@telcomconstruction.com

PHONE NUMBER

612-628-1854

PERMIT WORK TO START

08/01/2025

CMS

PERMIT WORK TO BE COMPLETED

12/01/2025

DURATION OF JOB

2-3 DAYS

ARE YOU BEING ASKED TO RELOCATE DUE TO A COUNTY PROJECT?

Yes

ANOKA COUNTY PROJECT NUMBER

SP 002-606-014 CSAH 6

WORK SITE ADDRESS

CO RD 6

CITY

Fridley

METHOD OF INSTALLATION/CONSTRUCTION

Work to be coordinated with project contractor.

NATURE OF WORK

Lumen to adjust existing cables for proposed storm sewer and adjust a manhole lid to finished grade

SURFACE TO BE DISTURBED

DITCH/BLVD

☒ GRAVEL

BITUMINOUS

CONCRETE

NONE

SITE PLAN



IF THE ROADWAY IS ENCROACHED, YOU MUST ATTACH A TRAFFIC CONTROL PLAN AND/OR REFERENCE THE MOST CURRENT VERSION OF THE MN TEMPORARY TRAFFIC CONTROL FIELD MANUAL (3+ DAYS REQUIRES PLANS TO BE SIGNED BY A LICENSED PE).

IS SIGNING AND STRIPING REQUIRED?

No

DEPTH FROM SURFACE

30

(60" minimum under county roads)

SIZE AND KIND OF PIPE/CABLE

2 way pvc

NUMBER OF EXCAVATIONS

2

SIZE OF EXCAVATIONS

4'x4'

(Length, width, and depth)

LOCATION OF EXCAVATIONS

ALL EXCAVATIONS ARE TO BE PROTECTED AT ALL TIMES AND THEN BACKFILLED WHEN UNATTENDED AND/OR OVERNIGHT

Specific written descriptions of excavations - if shown on attached drawing, drawing shall be specific with depth and distance from centerline, curb, or other distinguishable location. Traffic control plans cannot be approved without specific excavation descriptions.

County Road 6 and 5th St. as well as County Road 6 and 7th St.

Anoka County
MINNESOTA

Respectful. Innovative. Fiscally Responsible

ANOKA COUNTY TRANSPORTATION DIVISION

1440 BUNKER LAKE BLVD NW

ANDOVER, MN 55304

PERMIT PHONE: 763-324-3176

highwaypermits@anokacountymn.gov

GENERAL INFORMATION

One permit must be approved for each county road on which work will be performed prior to any work within the right of way by any utility/contractor. Emergency conditions which threaten the safety of the public and require immediate repair are exceptions to this rule. Under those circumstances, the utility/contractor is permitted to begin and/or complete the necessary repairs. The Anoka County Transportation Division (ACTD) shall be notified of emergency repairs as soon as feasible and a written permit is to be completed within two business days of occurrence.

A license-permit bond is generally required of the contractor as part of the registration process, the amount of which will be determined by the nature of the utility work.

A sketch or drawing shall accompany each permit application which will show the location of the proposed work/utility with reference to the county highway center line and right of way line. A complete set of plans is required for all sewer/water projects.

It shall be the responsibility of the applicant to determine which of the special conditions apply to each permit.

ACTD reserves the right to revoke any utility permit and halt work, if, upon inspection of any job site, the special conditions are not met, and/or a hazard exists for the applicant or public safety is threatened. **The failure to comply with the terms and conditions of any applicable Federal, State, Regional, and local laws, rules and regulations, including any provision of Anoka County's Right-of-Way Ordinance shall be cause for immediate revocation of a permit.**

The applicant shall notify ACTD immediately upon completion of project so that the ACTD can inspect the site to determine if restoration has been satisfactorily completed.

The undersigned hereby accepts the terms and conditions of this permit and the regulations of Anoka County, and agrees to fully comply therewith to the satisfaction of the ACTD. The county of Anoka, its officials, employees, and agents, shall be held harmless, by the applicant/permittee, from any demands, claims, lawsuits, or damages relating to the work described in this permit.

APPLICANT'S SIGNATURE

DocuSigned by:

SUSAN E BLUE

716E40FE5C664C4...

DATE 5/21/2025

AUTHORIZATION OF PERMIT

In consideration of the applicant's agreement to comply in all respects with the regulations of the ACTD covering such operations, permission is hereby granted for the work to be done as described in the above application. Said work to be done in accordance with the general conditions listed above and the special conditions required as hereby stated. It is expressly understood that this permit is conditioned upon replacement or restoration of the county highway and its right of way to their original or to a satisfactory condition. It is further understood that this permit is issued subject to the approval of local city or township authorities having joint supervision over said street or highway.

APPROVED BY:

TITLE: Traffic Technician

DATE

NOT VALID UNLESS SIGNED BY ANOKA COUNTY

THIS PERMIT COVERS THE RIGHT OF WAY IN ANOKA COUNTY ONLY
ACTD reserves the right to make changes to these special conditions.



ANOKA COUNTY TRANSPORTATION DIVISION
1440 BUNKER LAKE BLVD NW
ANDOVER, MN 55304
PERMIT PHONE: 763-324-3176
highwaypermits@anokacountymn.gov

SPECIAL CONDITIONS

TRAFFIC CONTROL

- 1) Detours
 - a) Detailed detour layouts shall be submitted to the traffic engineer for approval.
 - b) No detours shall be permitted without prior approval of the Anoka county traffic engineer.
 - c) A ten day notice must be given prior to the installation of any detour.
 - d) It shall be the responsibility of the applicant to notify Anoka county central communications, local government bodies, and any affected bus companies ten days prior to any road closures/detours.
 - e) Immediately upon completion of work and/or detours, all posts, barricades, and signs shall be removed from the right of way.
- 2) Traffic control devices
 - a) All traffic control devices, barricades, flashers, etc., shall be furnished by the applicant and shall be in accordance with the most recent edition of the Minnesota manual on uniform traffic control devices and temporary traffic control zone layouts – field manual of the same manual.

CONSTRUCTION REQUIREMENTS

- 1) Open cutting of bituminous or concrete surfaced roads will be allowed only at the discretion of the county engineer.
- 2) Neither supplies nor excavation materials shall be placed on the bituminous or concrete surface at any time.
- 3) No trenches will be allowed to remain open overnight.
- 4) Materials removed from the trench shall be used as backfill insofar as they are suitable. All backfill material shall conform to MNDOT specifications for compaction. The use of heavy equipment on top of trench, slapping with backhoe bucket and/or back casting to achieve compaction is prohibited. Any additional material required to back fill to the original grade shall be furnished by the applicant at no expense to the ACTD. All the base and surface courses damaged during construction operations shall be restored to a condition equal to or better than before operations began. The applicant shall be responsible for and restore any settlement.
- 5) All culverts, ditches, shoulders, and backslopes shall be restored to their original condition unless otherwise directed by the ACTD. Shoulders which have been previously constructed or reconstructed with special materials shall be replaced in kind. Restoration of signs, guardrails, guard posts, etc., are the sole responsibility of the applicant and shall be restored to their original condition.
- 6) All roadway maintenance required within the limits of the utility project that is related to the applicant's activities shall be the sole responsibility of the applicant for one year after completion of the project. Upon completion of the restoration work, the applicant shall request a final inspection by the ACTD. The ACTD's approved completion date shall be the starting date of the applicant's one-year responsibility.

HORIZONTAL BORING AND JACKING

- 1) All hard surface roadways shall be jacked or bored.
- 2) All crossings of Anoka County maintained roadbeds, shall be made by boring inside a casing or carrier pipe, or by jacking unless otherwise directed by the Anoka County Engineer. The auger shall lead the casing or carrier pipe by at least six inches whenever possible and never lead the carrier pipe by more than one inch.
- 3) The use of pneumatic devices to facilitate the roadbed crossings will be allowed in most cases with prior approval. In the event approval is not granted and applicant uses a pneumatic device to cross a roadbed and encounters an obstruction and/or unstable subbase material which makes forward or reverse motion of pneumatic device impossible, said pneumatic device then becomes part of the roadway subbase and permission to excavate to retrieve device will not be granted.
- 4) If a pneumatic device is used for the work permitted herein, the installation must be kept to a minimum of four feet below the surface of the roadway if the pneumatic device is less than two inches in diameter, and a minimum of five feet below the surface of the roadway if the pneumatic device is two inches in diameter or larger.

BITUMINOUS RESTORATION

- 1) The locations and dimensions of all openings to be made in the bituminous surface shall be approved by the ACTD prior to any cutting or any surface opening operations.
- 2) All openings in bituminous surfaces shall be cut in a straight line with the sides smooth and vertical. No ragged edges will be permitted. Cutting shall be done with a concrete saw.
- 3) All necessary dust control operations shall be carried out by the applicant at no expense to Anoka County.
- 4) The minimum requirement for subgrade replacement shall be the upper twelve inches of material and shall meet MNDOT specifications for class five placed in six inch layers compacted to one hundred percent of optimum density.
- 5) All manhole casings, gate valves, and other utility structures shall be set one quarter inch below the top of the finished surface.
- 6) Bituminous tack coat materials and application thereof shall conform to MNDOT specification 2357.
- 7) All bituminous surfacing shall be replaced as soon as practicable after the base construction. All bituminous surfacing shall be machine laid. Any exceptions must be approved by the ACTD. Bituminous surfacing shall be replaced to original pavement depth or to a minimum of six inches of bituminous mixture (2360), whichever is greater. Bituminous mixtures must be placed in lifts not exceeding three inches in thickness for base and binder courses and not exceeding two inches for the wear course.
- 8) All surface restoration regardless of size shall conform to existing grades.
- 9) Any unnecessary or negligent damage to bituminous surface in conjunction with the installation and/or repair of a utility shall be cut out and replaced in kind as directed by the ACTD.



ANOKA COUNTY TRANSPORTATION DIVISION
1440 BUNKER LAKE BLVD NW
ANDOVER, MN 55304
PERMIT PHONE: 763-324-3176
highwaypermits@anokacountymn.gov

CONCRETE RESTORATION

- 1) Curb and gutter, sidewalks, and driveways shall be restored in accordance with MNDOT specifications 2531 and 2521.

UTILITY LINES

- 1) There shall be only a single pole line on the county right of way on either side of the center line thereof.
2) Exact locations of longitudinal installations on county highways shall be located as directed by the ACTD.

SECTION CORNER MONUMENTS

- 1) Utility locations shall not interfere with the location of any section, quarter, witness, or right of way monuments. For assistance in locations, contact the Anoka County Surveyor’s Office.
2) The applicant shall be responsible for replacement of any existing property irons disturbed during construction.
3) The applicant shall notify the Anoka County Surveyor’s Office three working days in advance of any anticipated disturbance of any section, quarter, witness, or right of way monuments.
4) Any monument disturbed during the course of construction, shall be reset by the Anoka County Surveyor’s Office at the expense of the applicant.

ATTACHING TO BRIDGES/STRUCTURES

- 1) No utility is permitted to be hung from, or otherwise attached to, any bridge or structure without having detailed plans approved by the Anoka County Engineer. These plans are to show approaches to the structure, method of installation, type, and dimension of housing for the utility.

ADDITIONAL PROVISIONS

- 1) All subcontractors, installers, and crew shall possess a physical or electronic copy of all documents in relation to the approved permit prior to the commencement of work and be kept on site. This includes, but it not limited to the following:
a) Approved permit
b) Any/all traffic control plans and/or layouts
2) Shall notify Anoka County Permits at 763-324-3176 or highwaypermits@anokacountymn.gov
a) At least 36 hours prior to the commencement of work
b) With time frame of proposed of work
c) Anticipated traffic control
d) When work is complete - including restorations - to request a final inspection
3) No work during inclement weather or when plows are out in any capacity
4) All traffic control shall be in accordance with the most current version of the MnDOT Temporary Traffic Control Field Manual
5) For staking of right-of way or proposed infrastructure, contact Chris Osterhus at 763-324-3189 a minimum of 48 hours prior to the commencement of work.

INITIAL ^{DS}
SEB

CITY OF FRIDLEY, MN - ANOKA COUNTY

SP 002-606-014 CSAH 6 & 7th St NE

LOCATED ON INTERSECTION OF CENTRAL AVE NE & MISSISSIPPI ST

EXISTING LUMEN FACILITIES

PROJECT P.265535 / TERR-1015668

PLANS PREPARED FOR

LUMEN®

LUMEN ENGINEER: Rand Olson
EMAIL: randall.olson@lumen.com
PHONE: 612-987-6852
LUMEN CONSTRUCTION CONTACT: Paul Holmes
EMAIL: Paul.Holmes@lumen.com
PHONE: 612-759-7996
WIRECENTER: FRDLMNFR

PLANS PREPARED BY

TERRA
A CONGRUEX® COMPANY

TT ENGINEER: BRANDON AMAN
PHONE: 701.866.7952
EMAIL: BAMAN@TERRATECHLLC.NET

PROJECT CONTACT

OWNER: Anoka County
PHONE:
EMAIL:
PROJECT ENGINEER: Becky Krugerud
PHONE:
EMAIL: bkrugerud@srfconsulting.com
SURVEY/STAKING:
PHONE:
EMAIL:
ROAD CONTRACTOR: TBD
PHONE: TBD
EMAIL: TBD

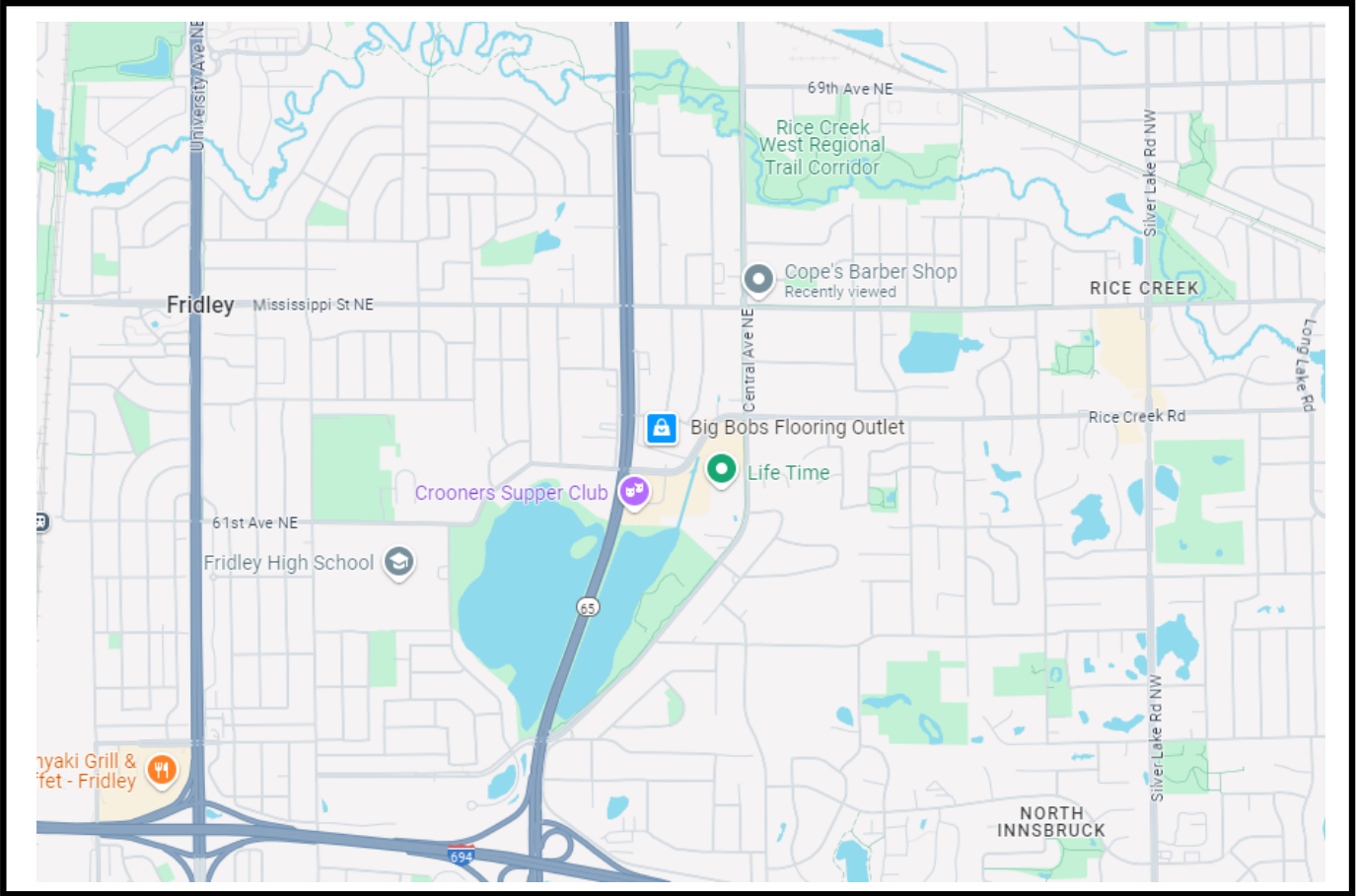

LOCATION MAP
NOT TO SCALE

FOR REFERENCE ONLY

PERMITS REQUIRED: ☒ YES ☐ NO

- ☐ CITY: CITY
- ☒ COUNTY: COUNTY
- ☐ STATE: STATE
- ☐ RAILROAD: RR
- ☐ PIPELINE: PIPELINE
- ☐ DNR: DNR
- ☐ MISCELLANEOUS: MISC.

CUTS REQUIRED: ☐ YES ☒ NO

- ☐ FIBER OPTIC
- ☐ COPPER

MIGRATIONS REQUIRED: ☐ YES ☒ NO

PRECONSTRUCTION MEETING DATE: 7/1/2025
EXPECTED ROADWAY CONSTRUCTION START DATE: 8/1/2025

NOTES:

ALL EXISTING AND PROPOSED CONDITIONS ARE BASED ON INFORMATION PROVIDED BY OTHERS. LUMEN CANNOT BE RESPONSIBLE FOR THE ACCURACY OF INFORMATION AND/OR PLANS PROVIDED BY OUTSIDE PARTIES. FACILITY LOCATIONS, DEPTHS AND ELEVATIONS SHOULD BE FIELD VERIFIED PRIOR TO CONSTRUCTION.

PROPOSED DESIGN MODIFICATIONS ARE RECOMMENDATIONS ONLY AND SHOULD BE VERIFIED PRIOR TO CONSTRUCTION.

REVISION	DATE

MINNESOTA DEPARTMENT OF TRANSPORTATION
CITY OF FRIDLEY, ANOKA COUNTY, MINNESOTA

CONSTRUCTION PLAN FOR ROUNDABOUT, GRADING, BITUMINOUS SURFACING, DRAINAGE, LIGHTING, RETAINING WALLS AND ADA IMPROVEMENTS

SP 002-606-014, SP 127-020-036 LOCATED ON CSAH 6 FROM 440 FEET WEST OF 5TH STREET TO 510 FEET EAST OF 7TH STREET

(CSAH 6) STATE PROJ. NO. 002-606-014
STATE PROJ. NO. 127-020-036

GROSS LENGTH 1,591.18 FEET 0.301 MILES
BRIDGES-LENGTH FEET MILES
EXCEPTIONS-LENGTH FEET MILES
NET LENGTH 1,591.18 FEET 0.301 MILES
REF. POINT TO REF. POINT
LENGTH AND DESCRIPTION BASED UPON (EB CSAH 6)

BEGIN SP 002-606-014
SP 127-020-036
EB CSAH 6 STA 199+29.16

END SP 002-606-014
SP 127-020-036
EB CSAH 6
STA 215+20.34

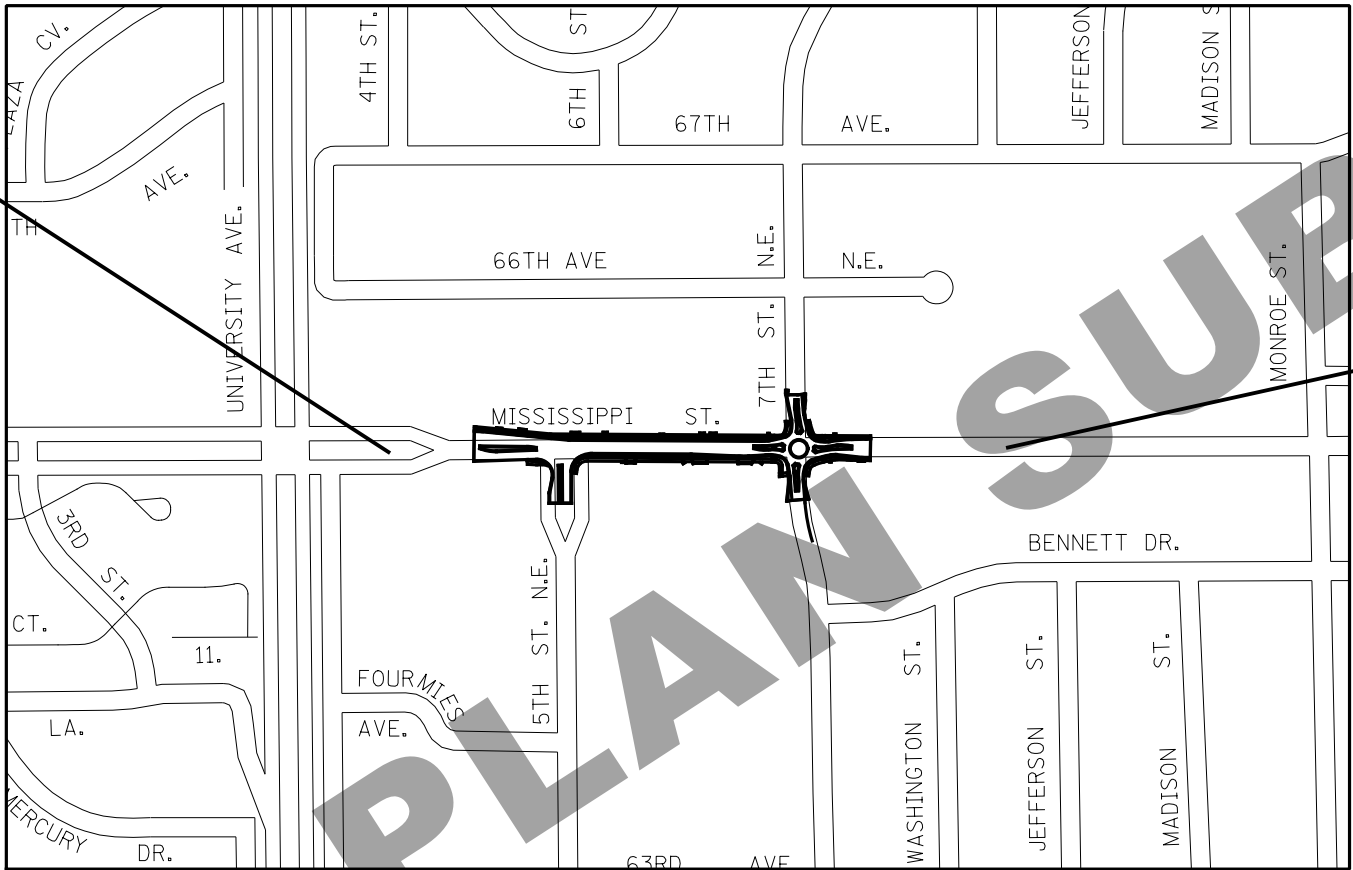

SCALES	
INDEX MAP	500'
PLAN	60'
PROFILE HORIZ.	100'
VERT.	10'
CROSS SECTION	20'

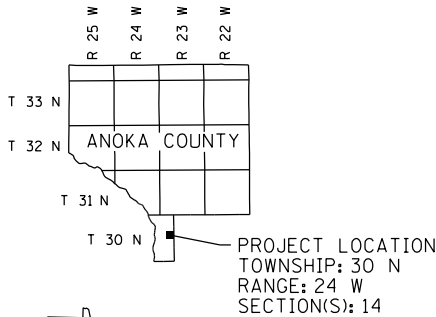

PLAN REVISIONS		
DATE	SHEET NO.	APPROVED BY

DESIGN DESIGNATION
FOR:

R-VALUE
ADT (Current Year) 2025 =
ADT (Future Year) 2045 =
PAVEMENT DESIGN
FUNCTIONAL CLASSIFICATION
NO. OF TRAFFIC LANES
NO. OF PARKING LANES
ESALS (20)
Design Speed
Based on Sight Distance
Height of eye / Height of Object
Design Speed not achieved at:

CSAH 6
SP 002-606-014
SP 127-020-036

20
7,600
10,500 (2045)
10 TON
MINOR ARTERIAL
2
N/A
1,101,000 (20 YRS.)
35 MPH
STOPPING
3.5' / 2.0'
ROUNDABOUT

TRAIL

X
X
X
X
X
X
X
X
X
X

FOR PLANS AND UTILITIES SYMBOLS SEE TECHNICAL MANUAL

STATE PROJ. NO. CHARGE IDENTIFIER

MINN. PROJ. NO. HSIP XXXX (XXX)

GOVERNING SPECIFICATIONS

THE 2020 EDITION OF THE MINNESOTA DEPARTMENT OF TRANSPORTATION "STANDARD SPECIFICATIONS FOR CONSTRUCTION" SHALL GOVERN.

ALL TRAFFIC CONTROL DEVICES SHALL CONFORM AND BE PLACED IN ACCORDANCE TO THE "MINNESOTA MANUAL ON UNIFORM TRAFFIC CONTROL DEVICES" (MN MUTCD) AND PART VI, "FIELD MANUAL FOR TEMPORARY TRAFFIC CONTROL ZONE LAYOUTS".

INDEX

SHEET NO.	SHEET DESCRIPTION
1	TITLE SHEET
2	GENERAL LAYOUT
3-4	STATEMENT OF ESTIMATED QUANTITIES
5	STANDARD PLATES
6	EARTHWORK TABULATIONS AND SUMMARY
7	CONSTRUCTION AND SOILS NOTES
8-9	TABULATIONS
10	INPLACE UTILITY TABULATIONS
11-17	TYPICAL SECTIONS
18	MISCELLANEOUS DETAILS
19-47	STANDARD PLAN SHEETS
48-60	TRAFFIC CONTROL AND STAGING PLANS
61-65	ALIGNMENT PLANS AND TABULATIONS
66-67	TOPOGRAPHY AND UTILITY PLANS
68-69	REMOVAL PLANS
70-71	CONSTRUCTION PLANS
72-73	INTERSECTION DETAILS
74-75	PEDESTRIAN CURB RAMP DETAILS
76-78	DRIVEWAY DETAILS
79-82	PROFILES
83	RETAINING WALL PLAN AND PROFILE
84-85	SUPERELEVATION PLANS
86-87	DRAINAGE PLANS
88-93	DRAINAGE TABULATIONS, PROFILES AND DETAILS
94-97	STORMWATER POLLUTION PREVENTION PLANS
98-99	EROSION CONTROL AND TURF ESTABLISHMENT PLANS
100-102	LIGHTING PLANS AND DETAILS
103-113	SIGNING PLANS AND DETAILS
114-117	PAVEMENT MARKING DETAILS AND PLANS
118	CROSS SECTION LAYOUT PLANS
X1-X12	CROSS SECTIONS

THIS PLAN CONTAINS 130 SHEETS



I HEREBY CERTIFY THAT THIS PLAN WAS PREPARED BY ME OR UNDER MY DIRECT SUPERVISION AND THAT I AM A DULY LICENSED PROFESSIONAL ENGINEER UNDER THE LAWS OF THE STATE OF MINNESOTA.

SIGNATURE
DATE XX/XX/XXXX LIC. NO. 58755 PRINT NAME ZACHARIAH F. HEIMER

APPROVED ANOKA COUNTY ENGINEER 20

APPROVED CITY ENGINEER, CITY OF FRIDLEY 20

DISTRICT STATE AID ENGINEER
REVIEWED FOR COMPLIANCE WITH STATE AID AND FEDERAL AID RULES/POLICY 20

STATE AID ENGINEER
APPROVED FOR STATE AID AND FEDERAL AID FUNDING 20

THIS PLAN AND/OR SPECIFICATION WAS PREPARED SPECIFICALLY FOR THIS PROJECT, AND ANY RE-USE OF DETAILS OR SPECIFICATIONS ON OTHER PROJECTS IS NOT INTENDED OR AUTHORIZED BY THE DESIGNER. LIABILITY FOR ANY RE-USE ON OTHER PROJECTS IS THE RESPONSIBILITY OF THE PERSON, AGENCY, OR CORPORATION USING PLAN OR SPECIFICATION DATA FROM THIS PROJECT.

THE SUBSURFACE UTILITY INFORMATION IN THIS PLAN IS UTILITY QUALITY LEVEL D. THIS QUALITY LEVEL WAS DETERMINED ACCORDING TO GUIDELINES OF C/ASCE 38-22, ENTITLED "STANDARD GUIDELINES FOR INVESTIGATING AND DOCUMENTING EXISTING UTILITIES".

STATE PROJ. NO. 002-606-014
STATE PROJ. NO. 127-020-036

SHEET NO. 1 OF 118 SHEETS

XXX

TOPOGRAPHY AND UTILITY PLAN
SHEET NO.

XXX

REMOVAL PLAN SHEET NO.

XXX

CONSTRUCTION PLAN SHEET NO.

XXX

DRAINAGE PLAN SHEET NO.

XXX

EROSION CONTROL AND TURF
ESTABLISHMENT PLAN SHEET NO.

INPLACE ROADWAY

■

PROPOSED CONSTRUCTION

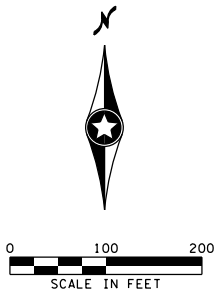

ANOKA

COUNTY

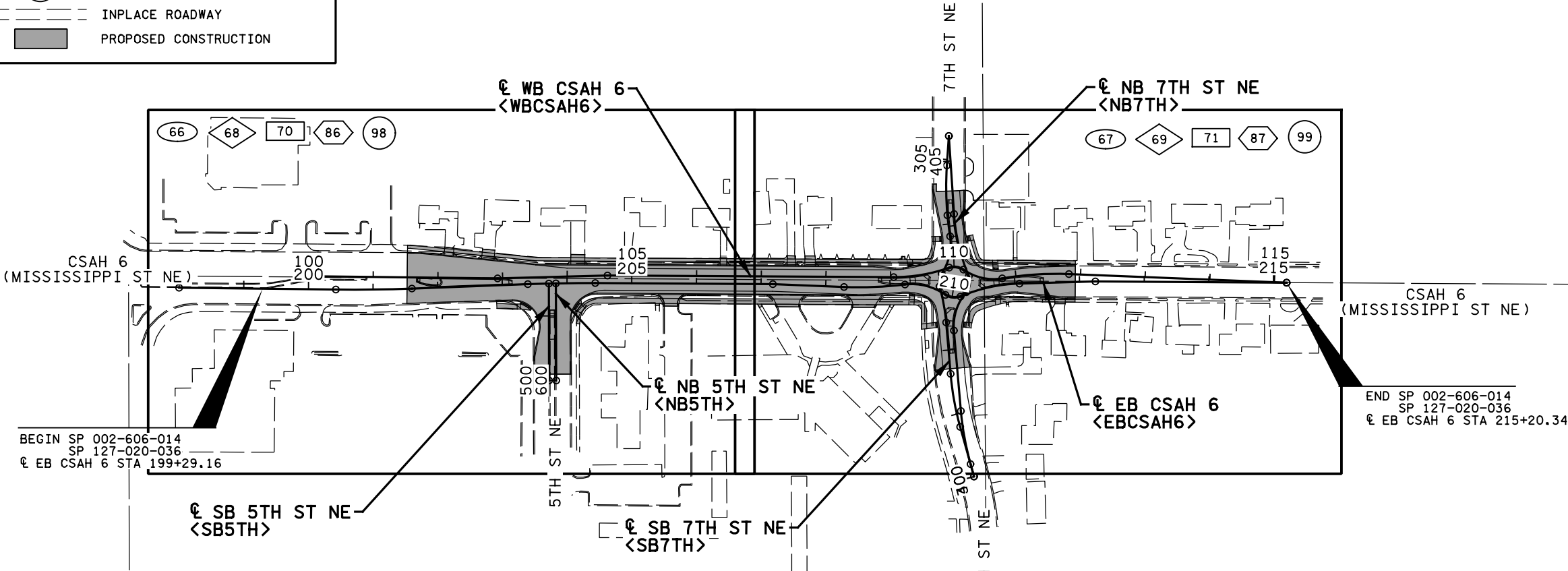

CITY

OF

FRIDLEY

					I hereby certify that this plan, specification, or report was prepared by me or under my direct supervision and that I am a duly Licensed Professional Engineer under the laws of the State of Minnesota.		STATE PROJECT NO. 002-606-014		DRAWN BY M. WENDLER		<div>LSRF</div>	ANOKA COUNTY, MINNESOTA		SHEET 2 OF 118
					Print Name: ZACHARIAH F. HEIMER				DESIGNED BY M. WENDLER					
					Date License # 58755		STATE PROJECT NO. 127-020-036		CHECKED BY Z. HEIMER					
NO	DATE	BY	CKD	APPR	REVISION				COMM. NO. 2417338					
												GENERAL LAYOUT		
												SP 002-606-014, SP 127-020-036		

3:07:14 PM
H:\Projects\17000\17338\TechData\CADD\Design\Plans\Inplace\Inplace.dgn

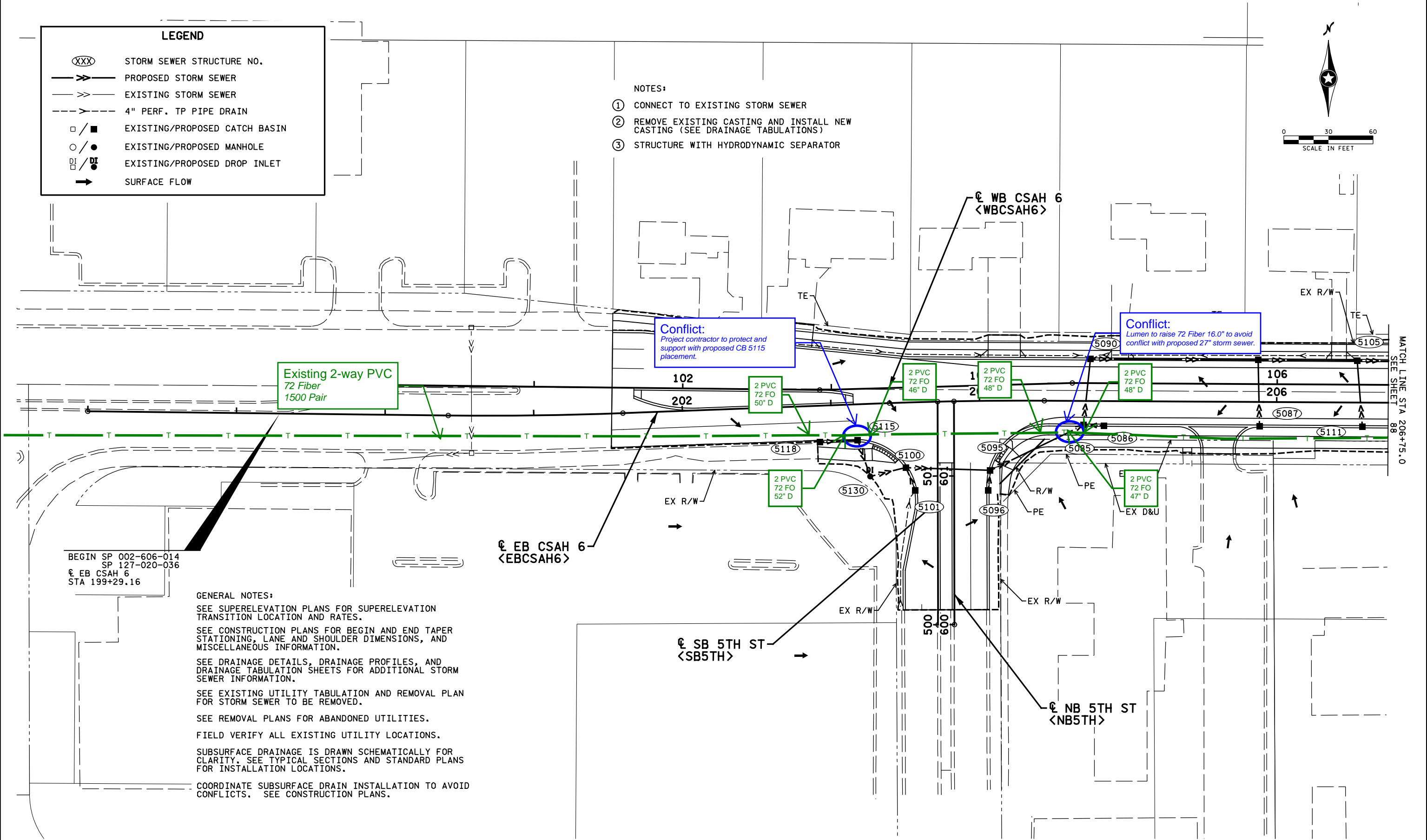

					<div>I hereby certify that this plan, specification, or report was prepared by me or under my direct supervision and that I am a duly Licensed Professional Engineer under the laws of the State of Minnesota.</div> <div>Print Name: ANDREW TOAY</div> <div>Date _____ License # 56747</div>	STATE PROJECT NO. 002-606-014		<div>DRAWN BY K. HAUSER</div> <div>DESIGNED BY K. HAUSER</div> <div>CHECKED BY A. TOAY</div> <div>COMM. NO. 2417338</div>		<div>ANOKA COUNTY, MINNESOTA</div> <div>DRAINAGE PLANS</div> <div>SP 002-606-014, SP 127-020-036</div>	<div>SHEET</div> <div>87</div> <div>OF</div> <div>118</div>
						STATE PROJECT NO. 127-020-036		<div>LSRF</div>			
NO DATE BY CKD APPR REVISION											
...\\FinalPlanC\\17338_dr01.dgn											

9:21:33 AM 4/12/2025 C:\Users\17000\17338\TechData\CADD\Design\Plans\InaIP IanC\17338_dr01.dgn

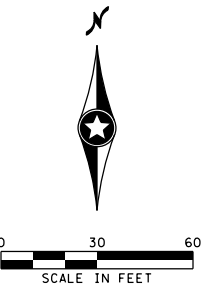
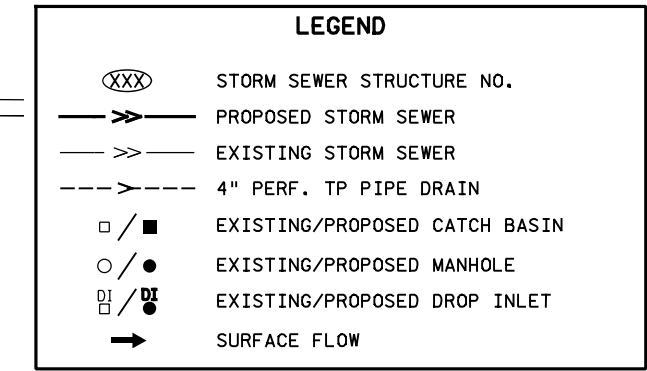

- ① CONNECT TO EXISTING STORM SEWER
- ② REMOVE EXISTING CASTING AND INSTALL NEW CASTING (SEE DRAINAGE TABULATIONS)
- ③ STRUCTURE WITH HYDRODYNAMIC SEPARATOR

NO	DATE	BY	CKD	APPR	REVISION
...\\FinaIPlanC\17338_dr02.dgn					

Date _____ License # 56747



SHEET
88
OF
118

P.167105 / TERR-1015668

Fridley, MN

Conflict:

Lumen to raise 72 Fiber 16.0" to avoid conflict with proposed 27" storm sewer.

Conflict:

Lumen to slide 400 pair cable 5.0' west to avoid conflict with proposed CB 5059. Project contractor to protect and support for proposed 36" storm sewer pipe placement.

Existing MH #8121

9" roof, 17" adjustment rings, 10" casting, 32" lid
(Lumen to raise manhole lid 5.0' to meet finished grade)

Mississippi St NE

Mississippi St NE

Mississippi St NE

Mississ

VICKIE KENDALL

5th St NE

7th St NE

Bennett Dr NE

Village Green Apartments

Certificate Of Completion

Envelope Id: A5BF693C-B98F-4495-82AF-79DE59FC4F45
Subject: SUSAN E BLUE - ROW Permit Application
Source Envelope:
Document Pages: 10
Certificate Pages: 4
AutoNav: Enabled
Envelopeld Stamping: Enabled
Time Zone: (UTC-06:00) Central Time (US & Canada)

Status: Sent

Envelope Originator:
Highway Permits
Anoka County Government Center
2100 3rd Avenue
Anoka, MN 55303
highwaypermits@anokacountymn.gov
IP Address: 155.70.23.45

Record Tracking

Status: Original 5/21/2025 12:32:11 PM	Holder: Highway Permits highwaypermits@anokacountymn.gov	Location: DocuSign
Security Appliance Status: Connected	Pool: StateLocal	
Storage Appliance Status: Connected	Pool: Anoka County	Location: Docusign

Signer Events

SUSAN E BLUE
SUSAN.BLUE@LUMEN.COM
Security Level:
DocuSign.email
ID: 1
5/21/2025 12:32:12 PM

Signature

DocuSigned by:

716F40FF5C664C4...

Signature Adoption: Pre-selected Style
Using IP Address: 155.70.23.45

Timestamp

Sent: 5/21/2025 12:32:12 PM
Viewed: 5/21/2025 12:32:20 PM
Signed: 5/21/2025 12:36:08 PM

Electronic Record and Signature Disclosure:
Accepted: 10/18/2023 11:18:43 AM
ID: 510c6dce-1bec-4ced-81d4-2b503e4118b4

Susan Burgmeier
Susan.Burgmeier@anokacountymn.gov
Associate Traffic Technician
Anoka County
Signing Group: Highway Permits
Security Level: Email, Account Authentication
(Optional)

Sent: 5/21/2025 12:36:10 PM
Viewed: 5/21/2025 1:59:32 PM

Electronic Record and Signature Disclosure:
Accepted: 5/13/2025 9:49:10 AM
ID: 66e21fba-4219-43be-84f5-6d6b8ad710ae

In Person Signer Events	Signature	Timestamp
Editor Delivery Events	Status	Timestamp
Agent Delivery Events	Status	Timestamp
Intermediary Delivery Events	Status	Timestamp
Certified Delivery Events	Status	Timestamp
Carbon Copy Events	Status	Timestamp

SUSAN E BLUE
SUSAN.BLUE@LUMEN.COM
Security Level: Email, Account Authentication
(Optional)

Electronic Record and Signature Disclosure:

Carbon Copy Events	Status	Timestamp
--------------------	--------	-----------

Not Offered via DocuSign

Witness Events	Signature	Timestamp
----------------	-----------	-----------

Notary Events	Signature	Timestamp
---------------	-----------	-----------

Envelope Summary Events	Status	Timestamps
-------------------------	--------	------------

Envelope Sent	Hashed/Encrypted	5/21/2025 12:32:12 PM
Envelope Updated	Security Checked	5/21/2025 12:36:08 PM
Certified Delivered	Security Checked	5/21/2025 1:59:32 PM

Payment Events	Status	Timestamps
----------------	--------	------------

Electronic Record and Signature Disclosure		
--	--	--

ELECTRONIC RECORD AND SIGNATURE DISCLOSURE

The following information constitutes Anoka County's (we, us or Company) written notices or disclosures relating to your use of DocuSign in relation to Anoka County's license. Described below are the terms and conditions for providing notices and disclosures electronically through the DocuSign system. Please read the information below carefully and thoroughly, and if you agree to this Electronic Record and Signature Disclosure (ERSD), please confirm your agreement by selecting the check-box next to 'I agree to use electronic records and signatures' before clicking 'CONTINUE' within the DocuSign system.

Getting paper copies

At any time, you may request from us a paper copy of any record provided or made available electronically to you by us. You will have the ability to download and print documents we send to you through the DocuSign system during and immediately after the signing session and, if you elect to create a DocuSign account, you may access the documents for a limited period of time (30 days) after the documents are first sent to you. At any time, if you request paper copies of any documents, you may be charged a fee. You may request paper copies from us by following the procedure described below.

Withdrawing your consent

If you decide to receive notices, disclosures and documents from us electronically, you may change your mind and tell us that going forward you want to receive documents only in paper format. Please note, processing time will be slowed down dramatically as we will be required to print and send the document through the mail and await your return of the documents. The process to change the method of receipt is described below.

All notices and disclosures will be sent to you electronically

Upon your acceptance to receive electronic notifications, all required notices, disclosures, authorizations, acknowledgements, and other documents that are required to be provided or made available to you during the course of our relationship with you will be provided electronically through the DocuSign system. All of the required documents will be provided to you at the address that you have given us.

How to contact Anoka County:

You may change your preferred method of contact whether electronically, or paper copies, or change your email address. You may also request paper copies of certain information from us, or withdraw your prior consent to receive documents. Please use the contact information below for your request and in the body of your correspondence, identify your desired action. If you are

changing an email address, please include your prior email address as well as your new address. If you no longer wish to receive future documents in electronic format, please include that request in the body of your email.

Email: helpdesk@co.anoka.mn.us

Phone: (763)-324-4110

Address: Anoka County Government Center
Attn: Information Technology, #300
2100 3rd Avenue
Anoka, MN 55303

Required hardware and software

The minimum system requirements for using the DocuSign system may change over time. The current system requirements are found here: <https://support.docusign.com/guides/signer-guide-signing-system-requirements>.

ACKNOWLEDGEMENT

To confirm your access to the electronic notices and disclosures, which will be similar to other electronic notices and disclosures that we may provide to you, please acknowledge that you have read this ERSD by selecting the check-box next to 'I agree to use electronic records and signatures' before clicking 'CONTINUE' within the DocuSign system.

By selecting the check-box next to 'I agree to use electronic records and signatures', you confirm that:

- You can access and read this Electronic Record and Signature Disclosure; and
- You can print this Electronic Record and Signature Disclosure, or save or send this Electronic Record and Disclosure to a location where you can print it, for future reference and access; and
- Until or unless you notify Anoka County as described above, you consent to receive exclusively through electronic means all notices, disclosures, authorizations, acknowledgements, and other documents that are required to be provided or made available to you by Anoka County during the course of your relationship with Anoka County.