

APPLICATION FOR PERMIT FOR INSTALLATION OF UTILITIES OR PLACING OBSTRUCTIONS ON THE COUNTY HIGHWAY SYSTEM  
ALL APPLICANTS MUST BE REGISTERED PRIOR TO PERMIT APPROVAL

APPLICANT NAME

Xcel Energy - Rebecca Cone

CONTACT PERSON

Rebecca Cone

ADDRESS

825 Rice St.

CITY

St. Paul, MN 55117

PHONE NUMBER

8166488088

EMAIL

rebecca.cone@xcelenergy.com

COMPANY OR INDIVIDUAL PERFORMING WORK

Xcel Energy - Rebecca Cone

CONTACT PERSON

Rebecca Cone

EMAIL

rebecca.cone@xcelenergy.com

PHONE NUMBER

816-648-8088

PERMIT WORK TO START

10/31/2025

PERMIT WORK TO BE COMPLETED

10/31/2026

DURATION OF JOB

30 days

ARE YOU BEING ASKED TO RELOCATE DUE TO A COUNTY PROJECT?

No

ANOKA COUNTY PROJECT NUMBER

WORK SITE ADDRESS

Multiple \*See Sketch

CITY

Fridley

METHOD OF INSTALLATION/CONSTRUCTION

Hand dig/Auger

NATURE OF WORK

Xcel Energy OH Line Rebuild along CNC073 - 822 90th Ave NW - PH1

SURFACE TO BE DISTURBED

X

DITCH/BLVD

BITUMINOUS

MEDIAN/ISLAND

SIDEWALK/TRAIL

X

AERIAL/NONE

SITE PLAN



IF THE ROADWAY IS ENCROACHED, YOU MUST ATTACH A TRAFFIC CONTROL PLAN AND/OR REFERENCE THE MOST CURRENT VERSION OF THE MN TEMPORARY TRAFFIC CONTROL FIELD MANUAL (72+ HOURS REQUIRES PLANS TO BE SIGNED BY A MINNESOTA LICENSED PE).

Multiple traffic control needed - all contractors will adhere to MN Field Manual standard layouts for closures

DEPTH FROM SURFACE

6'

(60" minimum under county roads)

SIZE AND KIND OF PIPE/CABLE

N/A

NUMBER OF EXCAVATIONS

4+

IS PERMANENT SIGNING AND STRIPING REQUIRED?

No

LOCATION AND SIZE OF EXCAVATIONS

ALL EXCAVATIONS ARE TO BE PROTECTED AND THEN BACKFILLED WHEN UNATTENDED AND/OR OVERNIGHT - STEEL PLATING MAY BE USED ONLY IF APPROVED PRIOR TO USE

Specific written descriptions of excavations - if shown on attached drawing, drawing shall be specific with depth and distance from centerline, curb, or other distinguishable location. Traffic control plans cannot be approved without specific excavation descriptions.

Multiple \*See sketch

THIS PERMIT COVERS THE RIGHT OF WAY IN ANOKA COUNTY ONLY

ACTD reserves the right to make changes to these special conditions.

1 | Page



# ANOKA COUNTY TRANSPORTATION DIVISION

1440 BUNKER LAKE BLVD NW

ANDOVER, MN 55304

PERMIT PHONE: 763-324-3176

highwaypermits@anokacountymn.gov

GENERAL INFORMATION	
One permit must be approved for each county road on which work will be performed prior to any work within the right of way by any utility/contractor. Emergency conditions which threaten the safety of the public and require immediate repair are exceptions to this rule. Under those circumstances, the utility/contractor is permitted to begin and/or complete the necessary repairs. The Anoka County Transportation Division (ACTD) shall be notified of emergency repairs as soon as feasible and a written permit is to be completed within two business days of occurrence.	
A license-permit bond is generally required of the contractor as part of the registration process, the amount of which will be determined by the nature of the utility work.	
A sketch or drawing shall accompany each permit application which will show the location of the proposed work/utility with reference to the county highway center line and right of way line. A complete set of plans is required for all sewer/water projects.	
It shall be the responsibility of the applicant to determine which of the special conditions apply to each permit.	
ACTD reserves the right to revoke any utility permit and halt work, if, upon inspection of any job site, the special conditions are not met, and/or a hazard exists for the applicant or public safety is threatened. <b>The failure to comply with the terms and conditions of any applicable Federal, State, Regional, and local laws, rules and regulations, including any provision of Anoka County's Right-of-Way Ordinance shall be cause for immediate revocation of a permit.</b>	
Anoka County hereby adopts and incorporates by reference the standards established by the Minnesota Pollution Control Agency's NPDES/SDS Construction Stormwater General Permit MNR100001 (CSW Permit) as amended in its entirety as now constituted and from time to time amended.	
The applicant shall notify ACTD immediately upon completion of project so that the ACTD can inspect the site to determine if restoration has been satisfactorily completed.	
The undersigned hereby accepts the terms and conditions of this permit and the regulations of Anoka County, and agrees to fully comply therewith to the satisfaction of the ACTD. The county of Anoka, its officials, employees, and agents, shall be held harmless, by the applicant/permittee, from any demands, claims, lawsuits, or damages relating to the work described in this permit.	
APPLICANT'S SIGNATURE	<div style="border: 1px solid black; padding: 5px;"> <div style="display: flex; justify-content: space-between;"> <div> <p><small>Signed by:</small></p> <p><i>Xcel Energy - Rebecca Cone</i></p> <p><small>EA87D69B3069430...</small></p> </div> <div> <p>DATE <b>10/22/2025</b></p> </div> </div> </div>
AUTHORIZATION OF PERMIT	
In consideration of the applicant's agreement to comply in all respects with the regulations of the ACTD covering such operations, permission is hereby granted for the work to be done as described in the above application. Said work to be done in accordance with the general conditions listed above and the special conditions required as hereby stated. It is expressly understood that this permit is conditioned upon replacement or restoration of the county highway and its right of way to their original or to a satisfactory condition. It is further understood that this permit is issued subject to the approval of local city or township authorities having joint supervision over said street or highway.	
APPROVED BY:  TITLE: Engineering Technician	DATE

NOT VALID UNLESS SIGNED BY ANOKA COUNTY

THIS PERMIT COVERS THE RIGHT OF WAY IN ANOKA COUNTY ONLY  
**ACTD reserves the right to make changes to these special conditions.**



ANOKA COUNTY TRANSPORTATION DIVISION  
1440 BUNKER LAKE BLVD NW  
ANDOVER, MN 55304  
PERMIT PHONE: 763-324-3176  
highwaypermits@anokacountymn.gov

SPECIAL CONDITIONS
<p><u>TRAFFIC CONTROL</u></p> <p>1) Detours</p> <ul style="list-style-type: none"><li>a) Detailed detour layouts shall be submitted to the Anoka County Traffic Engineer for approval.</li><li>b) No detours shall be permitted without prior approval of the Anoka County Traffic Engineer.</li><li>c) A ten day notice must be given prior to the installation of any detour.</li><li>d) It shall be the responsibility of the applicant to notify Anoka County Central Communications, local government bodies, and any affected bus companies ten days prior to any road closures/detours.</li><li>e) Immediately upon completion of work and/or detours, all posts, barricades, and signs shall be removed from the right of way.</li></ul> <p>2) Traffic control devices</p> <ul style="list-style-type: none"><li>a) All traffic control devices, barricades, flashers, etc., shall be furnished by the applicant and shall be in accordance with the most recent edition of the Minnesota Manual on Uniform Traffic Control Devices and temporary traffic control zone layouts – field manual of the same manual.</li></ul>
<p><u>CONSTRUCTION REQUIREMENTS</u></p> <p>1) Open cutting of bituminous or concrete surfaced roads will be allowed only at the discretion of the County Engineer.</p> <p>2) Neither supplies nor excavation materials shall be placed on the bituminous or concrete surface at any time.</p> <p>3) No trenches will be allowed to remain open overnight.</p> <p>4) Materials removed from the trench shall be used as backfill insofar as they are suitable. All backfill material shall conform to MNDOT specifications for compaction. The use of heavy equipment on top of trench, slapping with backhoe bucket and/or back casting to achieve compaction is prohibited. Any additional material required to back fill to the original grade shall be furnished by the applicant at no expense to the ACTD. All the base and surface courses damaged during construction operations shall be restored to a condition equal to or better than before operations began. The applicant shall be responsible for and restore any settlement.</p> <p>5) All culverts, ditches, shoulders, and backslopes shall be restored to their original condition unless otherwise directed by the ACTD. Shoulders which have been previously constructed or reconstructed with special materials shall be replaced in kind. Restoration of signs, guardrails, guard posts, etc., are the sole responsibility of the applicant and shall be restored to their original condition.</p> <p>6) All roadway maintenance required within the limits of the utility project that is related to the applicant's activities shall be the sole responsibility of the applicant for one year after completion of the project. Upon completion of the restoration work, the applicant shall request a final inspection by the ACTD. The ACTD's approved completion date shall be the starting date of the applicant's one-year responsibility.</p>
<p><u>HORIZONTAL BORING AND JACKING</u></p> <p>1) All hard surface roadways shall be jacked or bored.</p> <p>2) All crossings of Anoka County maintained roadbeds, shall be made by boring inside a casing or carrier pipe, or by jacking unless otherwise directed by the Anoka County Engineer. The auger shall lead the casing or carrier pipe by at least six inches whenever possible and never lead the carrier pipe by more than one inch.</p> <p>3) The use of pneumatic devices to facilitate the roadbed crossings will be allowed in most cases with prior approval. In the event approval is not granted and applicant uses a pneumatic device to cross a roadbed and encounters an obstruction and/or unstable subbase material which makes forward or reverse motion of pneumatic device impossible, said pneumatic device then becomes part of the roadway subbase and permission to excavate to retrieve device will not be granted.</p> <p>4) If a pneumatic device is used for the work permitted herein, the installation must be kept to a minimum of four feet below the surface of the roadway if the pneumatic device is less than two inches in diameter, and a minimum of five feet below the surface of the roadway if the pneumatic device is two inches in diameter or larger.</p>
<p><u>BITUMINOUS RESTORATION</u></p> <p>1) The locations and dimensions of all openings to be made in the bituminous surface shall be approved by the ACTD prior to any cutting or any surface opening operations.</p> <p>2) All openings in bituminous surfaces shall be cut in a straight line with the sides smooth and vertical. No ragged edges will be permitted. Cutting shall be done with a concrete saw.</p> <p>3) All necessary dust control operations shall be carried out by the applicant at no expense to Anoka County.</p> <p>4) The minimum requirement for subgrade replacement shall be the upper twelve inches of material and shall meet MNDOT specifications for class five placed in six inch layers compacted to one hundred percent of optimum density.</p> <p>5) All manhole casings, gate valves, and other utility structures shall be set one quarter inch below the top of the finished surface.</p> <p>6) Bituminous tack coat materials and application thereof shall conform to MNDOT specification 2357.</p> <p>7) All bituminous surfacing shall be replaced as soon as practicable after the base construction. All bituminous surfacing shall be machine laid. Any exceptions must be approved by the ACTD. Bituminous surfacing shall be replaced to original pavement depth or to a minimum of six inches of bituminous mixture (2360), whichever is greater. Bituminous mixtures must be placed in lifts not exceeding three inches in thickness for base and binder courses and not exceeding two inches for the wear course.</p> <p>8) All surface restoration regardless of size shall conform to existing grades.</p> <p>9) Any unnecessary or negligent damage to bituminous surface in conjunction with the installation and/or repair of a utility shall be cut out and replaced in kind as directed by the ACTD.</p>



ANOKA COUNTY TRANSPORTATION DIVISION  
1440 BUNKER LAKE BLVD NW  
ANDOVER, MN 55304  
PERMIT PHONE: 763-324-3176  
highwaypermits@anokacountymn.gov

<p><u>CONCRETE RESTORATION</u></p> <p>1) Curb and gutter, sidewalks, and driveways shall be restored in accordance with MNDOT specifications 2531 and 2521.</p>
<p><u>UTILITY LINES</u></p> <p>1) There shall be only a single pole line on the county right of way on either side of the center line thereof. 2) Exact locations of longitudinal installations on county highways shall be located as directed by the ACTD.</p>
<p><u>SECTION CORNER MONUMENTS</u></p> <p>1) The permit holder shall notify the Anoka County Surveyor’s Office at 763-324-3111 at least 3 business days prior to any anticipated disturbance of any section, quarter, meander, witness corner, or right of way monument. 2) Utility locations shall not interfere with the location of any section, quarter, meander, witness corner, or right of way monument. For assistance in locations, contact the Anoka County Surveyor’s Office. 3) The permit holder shall be responsible for replacement of any existing property irons disturbed during construction. 4) Any monument disturbed during the course of construction shall be reset by the Anoka County Surveyor’s Office at the expense of the permit holder.</p>
<p><u>ATTACHING TO BRIDGES/STRUCTURES</u></p> <p>1) No utility is permitted to be hung from, or otherwise attached to, any bridge or structure without having detailed plans approved by the Anoka County Engineer. These plans are to show approaches to the structure, method of installation, type, and dimension of housing for the utility.</p>
<p><u>ADDITIONAL PROVISIONS</u></p> <p>1) All subcontractors, installers, and crew shall possess a physical or electronic copy of all documents in relation to the approved permit prior to the commencement of work and be kept on site. This includes, but it not limited to the following: a) Approved permit b) Any/all traffic control plans and/or layouts 2) Shall notify Anoka County Permits at 763-324-3176 or highwaypermits@anokacountymn.gov a) At least 3 business days prior to the commencement of work b) With time frame of proposed of work c) Anticipated traffic control d) When work is complete - including restorations - to request a final inspection 3) No work during inclement weather or when plows are out in any capacity 4) All traffic control shall be in accordance with the most current version of the MnDOT Temporary Traffic Control Field Manual 5) For staking of right-of way or proposed infrastructure, contact Chris Osterhus at 763-324-3189 a minimum of 48 hours prior to the commencement of work.</p>

INITIAL	<div>Initial</div> <div>XERL</div>
---------	------------------------------------



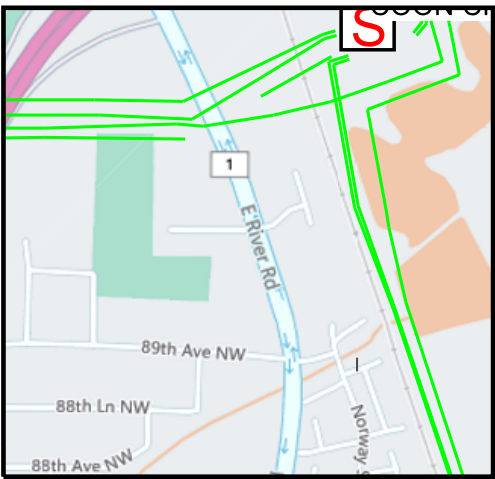
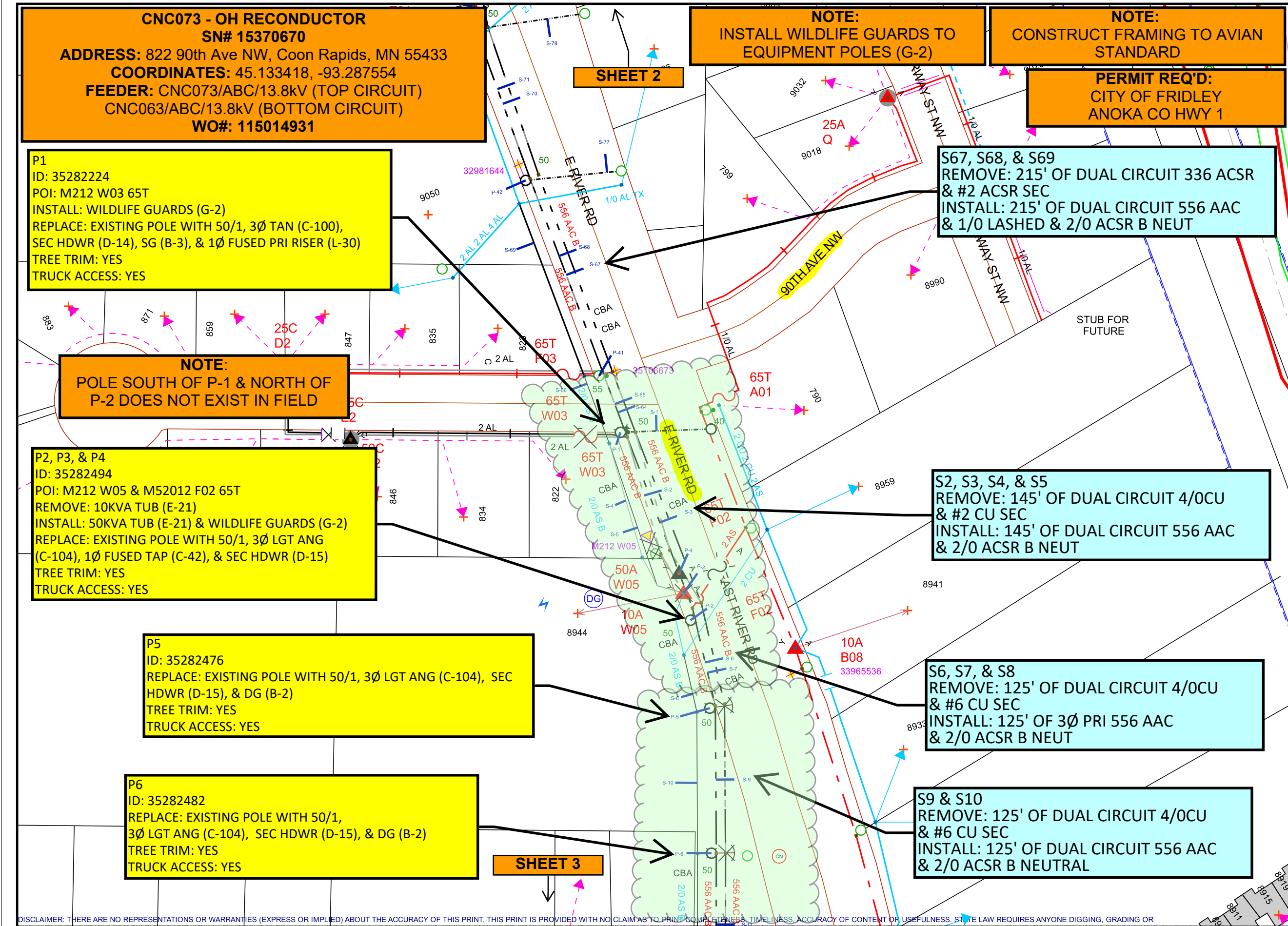

**DESIGNER: MATTHEW VOLPE**  
(361) 960-9421  
MATTHEW.VOLPE@XCELENERGY.COM

Work Order Information	
Service Request #	: 000015370670
Design Number	: 000001226641
Designer/Planner ID	: 327025
Designer/Planner Name	:
Designer/Planner Ph #	: (000) 000-0000
Manager Approval	:

Joint Utility	
E:	G:
T:	C:

Design Location	
Division	: Maple Grove
County	: Anoka
City	: Coon Rapids
Address	: SEE CALLOUT
T: 31N	R: 24W S: 35
Map #	: M52012 Permit : SEE CALLOUT

Electric	
Feeder:	Voltage:
Phase:	Bkup Dev ID:

Gas	
System	: Pressure
Size	: Material
Dead End	:

Work Order # :  
Date: 09/29/2025  
Sketch: # Of # Sketch Data  
Scale: 1" equals 100'



**CONSTRUCTION USE ONLY**  
☐ NO CHANGES (BUILT AS DESIGNED)  
☐ CHANGES MADE AS INDICATED  
(ALL URD MUST HAVE ACTUAL MEASUREMENTS FROM THE FIELD SITE)

RFO  
FOREMAN \_\_\_\_\_ DATE \_\_\_\_\_  
TEAM LEADER \_\_\_\_\_

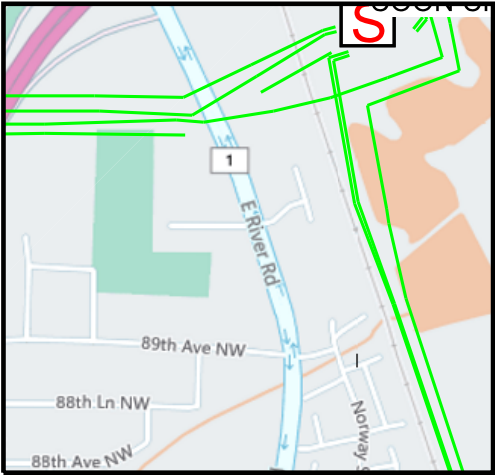
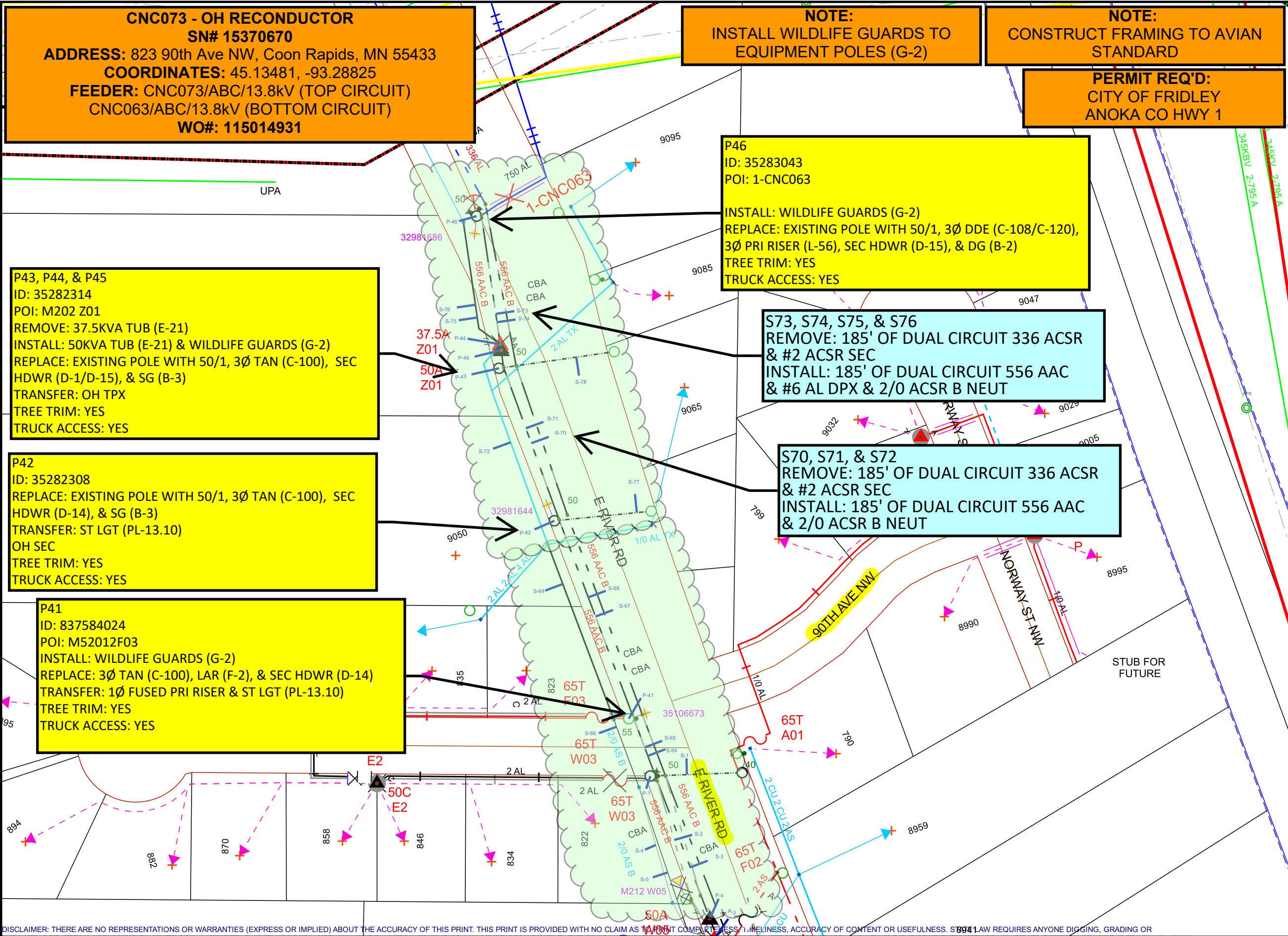

**DESIGNER: MATTHEW VOLPE**  
(361) 960-9421  
MATTHEW.VOLPE@XCELENERGY.COM

Work Order Information

Service Request #	: 000015370670
Design Number	: 000001226641
Designer/Planner ID	: 327025
Designer/Planner Name	:
Designer/Planner Ph #	: (000) 000-0000
Manager Approval	:

Joint Utility

E:	G:
T:	C:

Design Location

Division	:	Maple Grove			
County	:	Anoka			
City	:	Coon Rapids			
Address	:	SEE CALLOUT			
T: 31N	R: 24W	S: 35			
Map #	:	M52002	Permit	:	SEE CALLOUT

Electric

Feeder:	Voltage:
Phase:	Bkup Dev ID:

Gas

System	: Pressure
Size	: Material
Dead End	:

Work Order # :

Date: 09/29/2025  
Sketch: # Of # Sketch Data  
Scale: 1" equals 100'



CONSTRUCTION USE ONLY

- ☐ NO CHANGES (BUILT AS DESIGNED)  
☐ CHANGES MADE AS INDICATED  
(ALL URD MUST HAVE ACTUAL  
MEASUREMENTS FROM THE FIELD SITE)

RFO  
FOREMAN \_\_\_\_\_ DATE \_\_\_\_\_  
TEAM LEADER \_\_\_\_\_

DISCLAIMER: THERE ARE NO REPRESENTATIONS OR WARRANTIES (EXPRESS OR IMPLIED) ABOUT THE ACCURACY OF THIS PRINT. THIS PRINT IS PROVIDED WITH NO CLAIM AS TO THE COMPLETENESS, TIMELINESS, ACCURACY OF CONTENT OR USEFULNESS. STATE LAW REQUIRES ANYONE DIGGING, GRADING OR EXCAVATING TO OBTAIN A PRIOR FIELD LOCATE OF ALL UTILITIES. THIS PRINT DOES NOT DISCHARGE THIS REQUIREMENT OR ANY OTHER REQUIREMENT. THE COMPANY AND ITS AFFILIATES ASSUME NO LEGAL RESPONSIBILITY OR LIABILITY FOR THE RECIPIENT'S USE (OR ANY OTHER PARTIES' USE) OF THE PRINT, INCLUDING THE RECIPIENTS INTENDED PURPOSE IN USING THE PRINT. NO COMPANY EMPLOYEE OR OTHER PARTY HAS BEEN AUTHORIZED TO PROVIDE THIS PRINT FOR PLANNING OR ESTIMATING PURPOSES; RELY ON THIS PRINT AT YOUR OWN RISK. BY ACCEPTING THIS PRINT, THE RECIPIENT & ANY OTHER PARTY RECEIVING A COPY OF THE PRINT ACKNOWLEDGES AND AGREES TO THIS DISCLAIMER. For All Field Locates Call 811

THIS DOCUMENT IS XCEL ENERGY CONFIDENTIALS AND PROPRIETARY INFORMATION AND MAY NOT BE REPRODUCED IN WHOLE, OR IN PART, NOR MAY ANY OF THE INFORMATION CONTAINED HEREIN BE DISCLOSED WITHOUT THE CONSENT OF XCEL ENERGY. CONFIDENTIALS AND PROPRIETARY INFORMATION © 2019 XCEL ENERGY INC. | XCEL ENERGY IS REGISTERED TRADEMARK OF XCEL ENERGY INC



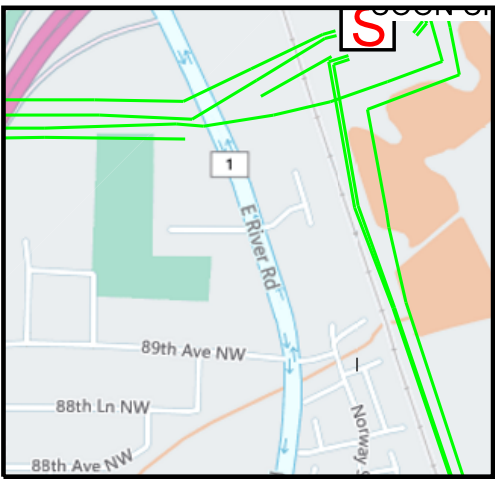
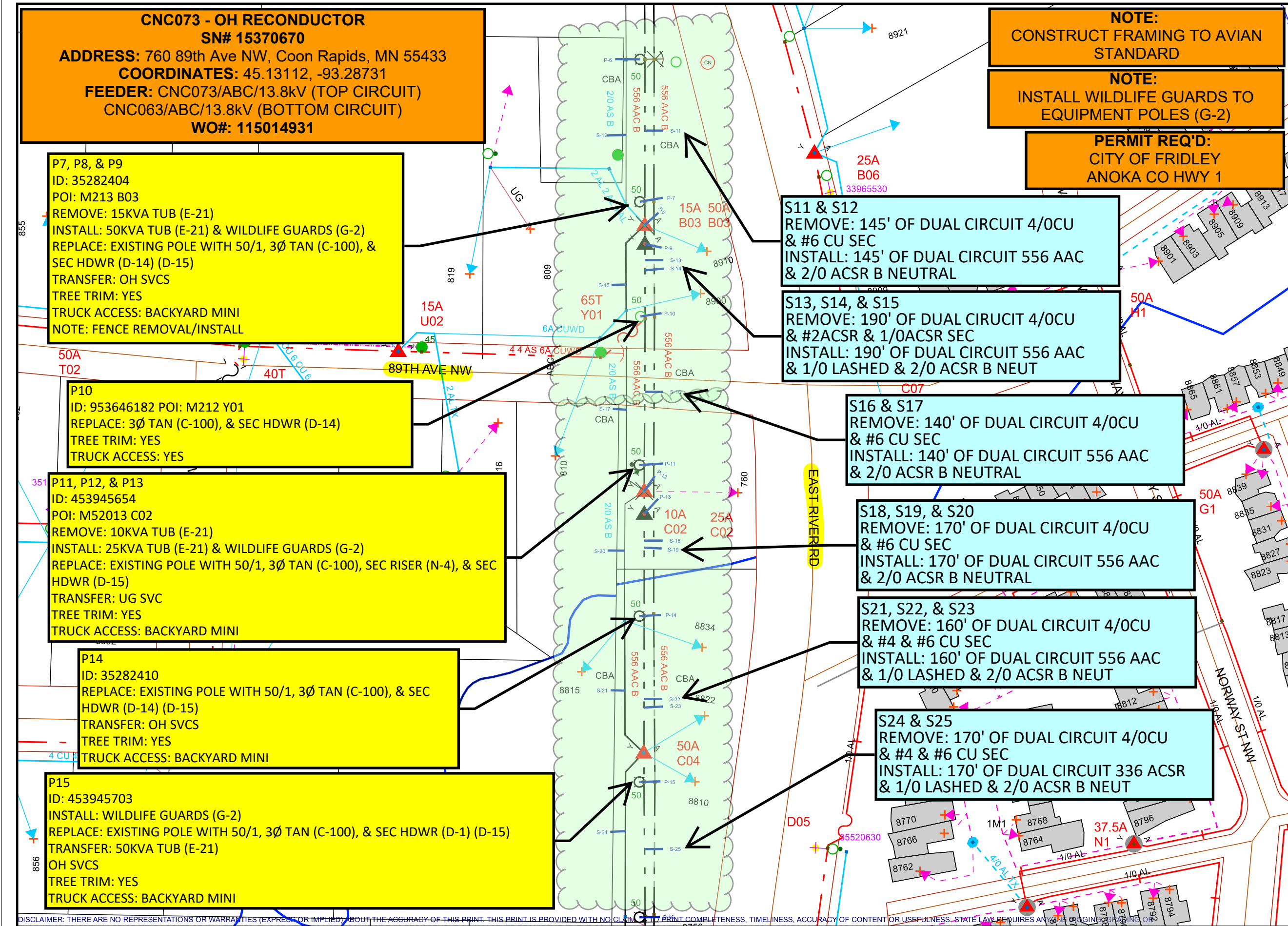

**DESIGNER: MATTHEW VOLPE**  
(361) 960-9421  
MATTHEW.VOLPE@XCELENERGY.COM

Work Order Information	
Service Request #	: 000015370670
Design Number	: 000001226641
Designer/Planner ID	: 327025
Designer/Planner Name	:
Designer/Planner Ph #	: (000) 000-0000
Manager Approval	:

Joint Utility	
E:	G:
T:	C:

Design Location	
Division	: Maple Grove
County	: Anoka
City	: Coon Rapids
Address	: SEE CALLOUT
T: 31N	R: 24W S: 36
Map #	: M52013
Permit	: SEE CALLOUT

Electric	
Feeder:	Voltage:
Phase:	Bkup Dev ID:

Gas	
System	: Pressure
Size	: Material
Dead End	:

Work Order #	:
Date:	09/29/2025
Sketch:	# Of # Sketch Data
Scale:	1" equals 100'



**CONSTRUCTION USE ONLY**

☐ NO CHANGES (BUILT AS DESIGNED)

☐ CHANGES MADE AS INDICATED  
(ALL URD MUST HAVE ACTUAL MEASUREMENTS FROM THE FIELD SITE)

RFO \_\_\_\_\_  
FOREMAN \_\_\_\_\_ DATE \_\_\_\_\_  
TEAM LEADER \_\_\_\_\_

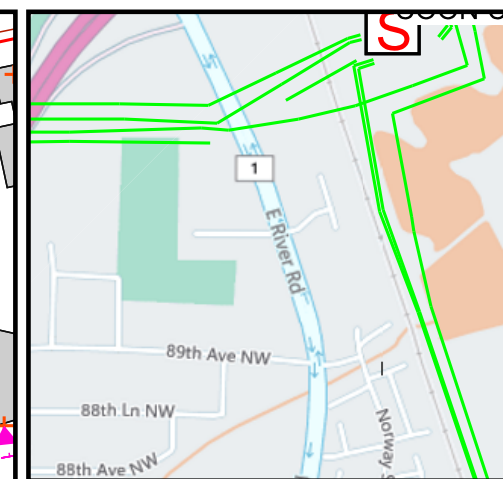
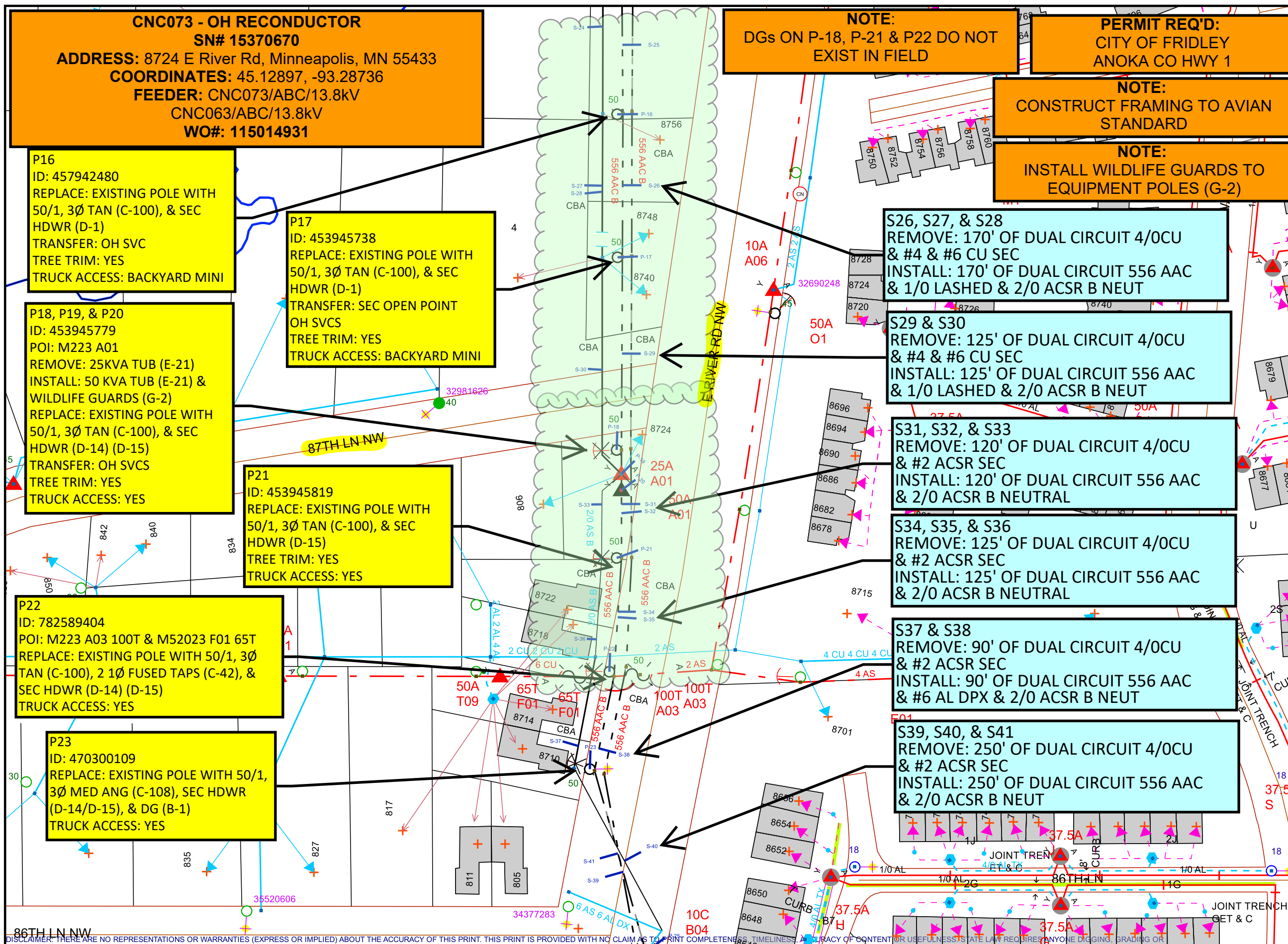

**DESIGNER: MATTHEW VOLPE**  
**(361) 960-9421**  
**MATTHEW.VOLPE@XCELENERGY.COM**

Work Order Information		
Service Request #	:	000015370670
Design Number	:	000001226641
Designer/Planner ID	:	327025
Designer/Planner Name	:	
Designer/Planner Ph #	:	(000) 000-0000
Manager Approval	:	

Joint Utility	
E:	G:
T:	C:

Design Location
-----------------

Division	:	Maple Grove
County	:	Anoka
City	:	Coon Rapids
Address	:	SEE CALLOUT
T: 31N	R: 24W	S: 36
Map #	: M52023	Permit : SEE CALLOUT

Electric	
Feeder:	Voltage:
Phase:	Bkup Dev ID:

Gas	
System :	Pressure :
Size :	Material :
Dead End :	

Work Order # :

Date: 09/29/2025

Sketch: # Of # Sketch Data

Scale: 1" equals 100'

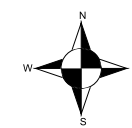

CONSTRUCTION USE ONLY

- ☐ NO CHANGES (BUILT AS DESIGNED)
- ☐ CHANGES MADE AS INDICATED  
(ALL URD MUST HAVE ACTUAL MEASUREMENTS FROM THE FIELD SITE)

RFO \_\_\_\_\_  
FOREMAN \_\_\_\_\_ DATE \_\_\_\_\_  
TEAM LEADER \_\_\_\_\_



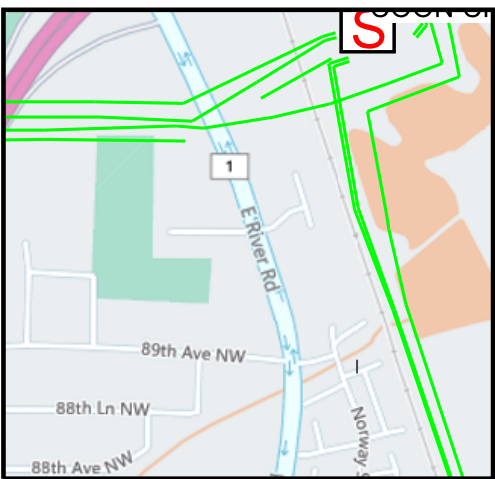
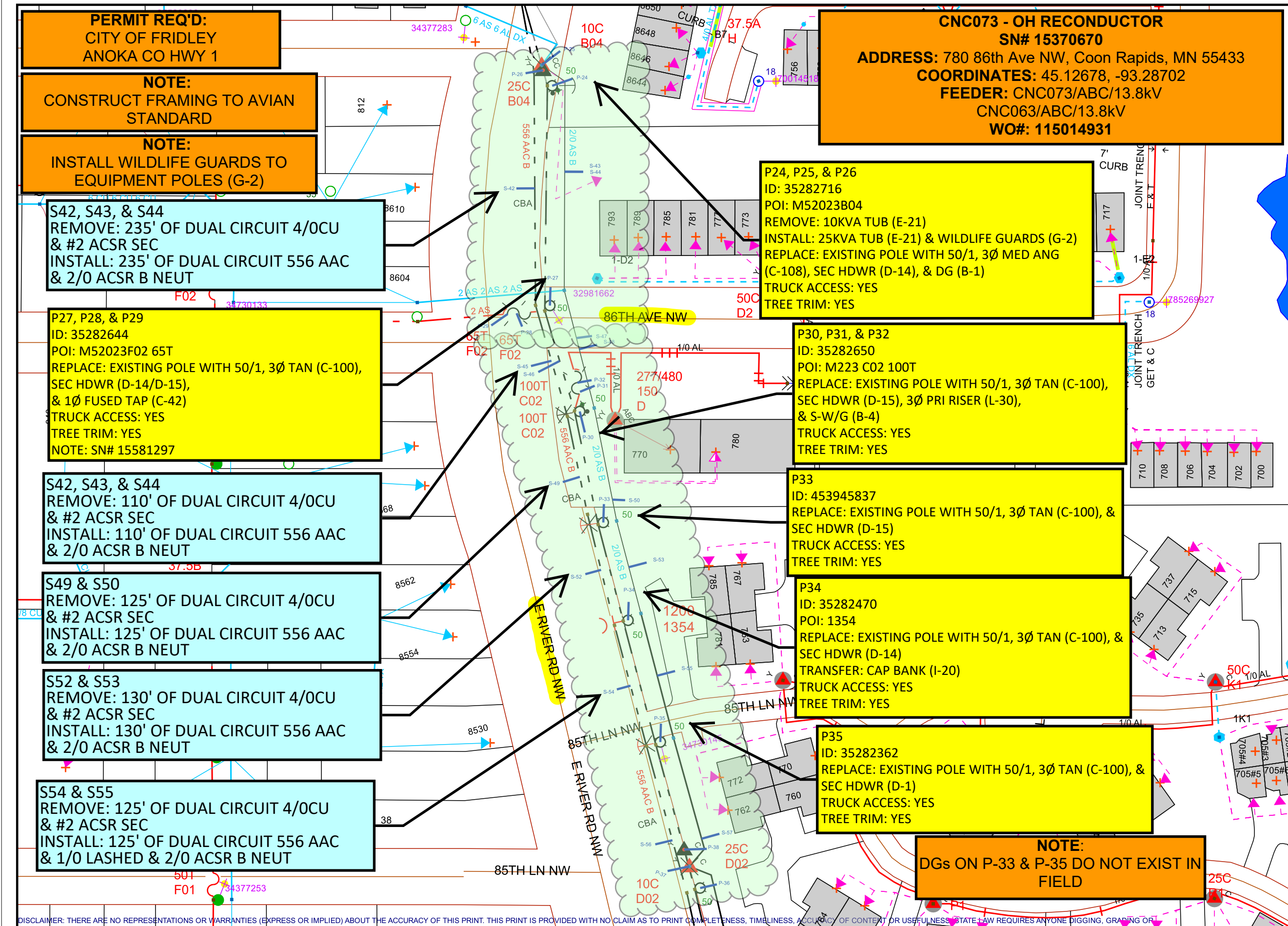

**DESIGNER: MATTHEW VOLPE**  
(361) 960-9421  
MATTHEW.VOLPE@XCELENERGY.COM

Work Order Information	
Service Request #	000015370670
Design Number	000001226641
Designer/Planner ID	327025
Designer/Planner Name	
Designer/Planner Ph #	(000) 000-0000
Manager Approval	
Joint Utility	
E:	G:
T:	C:
Design Location	
Division	Maple Grove
County	Anoka
City	Coon Rapids
Address	SEE CALLOUT
T: 31N R: 24W S: 36	
Map #	M52023
Permit	SEE CALLOUT
Electric	
Feeder:	Voltage:
Phase:	Bkup Dev ID:
Gas	
System	Pressure
Size	Material
Dead End	
Work Order #	
Date: 09/29/2025	
Sketch: # Of # Sketch Data	
Scale: 1" equals 100'	

**CONSTRUCTION USE ONLY**

- ☐ NO CHANGES (BUILT AS DESIGNED)  
☐ CHANGES MADE AS INDICATED  
(ALL URD MUST HAVE ACTUAL MEASUREMENTS FROM THE FIELD SITE)

RFO  
FOREMAN \_\_\_\_\_ DATE \_\_\_\_\_  
TEAM LEADER \_\_\_\_\_

DISCLAIMER: THERE ARE NO REPRESENTATIONS OR WARRANTIES (EXPRESS OR IMPLIED) ABOUT THE ACCURACY OF THIS PRINT. THIS PRINT IS PROVIDED WITH NO CLAIM AS TO PRINT COMPLETENESS, TIMELINESS, ACCURACY OF CONTENT OR USEFULNESS. STATE LAW REQUIRES ANYONE DIGGING, GRADING OR EXCAVATING TO OBTAIN A PRIOR FIELD LOCATE OF ALL UTILITIES. THIS PRINT DOES NOT DISCHARGE THIS REQUIREMENT OR ANY OTHER REQUIREMENT. THE COMPANY AND ITS AFFILIATES ASSUME NO LEGAL RESPONSIBILITY OR LIABILITY FOR THE RECIPIENT'S USE (OR ANY OTHER PARTIES' USE) OF THE PRINT, INCLUDING THE RECIPIENT'S INTENDED PURPOSE IN USING THE PRINT. NO COMPANY EMPLOYEE OR OTHER PARTY HAS BEEN AUTHORIZED TO PROVIDE THIS PRINT FOR PLANNING OR ESTIMATING PURPOSES; RELY ON THIS PRINT AT YOUR OWN RISK. BY ACCEPTING THIS PRINT, THE RECIPIENT & ANY OTHER PARTY RECEIVING A COPY OF THE PRINT ACKNOWLEDGES AND AGREES TO THIS DISCLAIMER. For All Field Locates Call 811

THIS DOCUMENT IS XCEL ENERGY CONFIDENTIALS AND PROPRIETARY INFORMATION AND MAY NOT BE REPRODUCED IN WHOLE, OR IN PART, NOR MAY ANY OF THE INFORMATION CONTAINED HEREIN BE DISCLOSED WITHOUT THE CONSENT OF XCEL ENERGY. CONFIDENTIALS AND PROPRIETARY INFORMATION © 2019 XCEL ENERGY INC. | XCEL ENERGY IS REGISTERED TRADEMARK OF XCEL ENERGY INC



### Certificate Of Completion

Envelope Id: CF3C4F86-3BE1-4442-854F-A81801072C44

Subject: Xcel Energy - Rebecca Cone - ROW Permit Application

Source Envelope:

Document Pages: 10

Certificate Pages: 4

AutoNav: Enabled

Envelopeld Stamping: Enabled

Time Zone: (UTC-06:00) Central Time (US & Canada)

Status: Sent

Envelope Originator:

Highway Permits

Anoka County Government Center

2100 3rd Avenue

Anoka, MN 55303

highwaypermits@anokacountymn.gov

IP Address: 208.87.234.201

### Record Tracking

Status: Original

10/22/2025 10:33:47 AM

Security Appliance Status: Connected

Storage Appliance Status: Connected

Holder: Highway Permits

highwaypermits@anokacountymn.gov

Pool: StateLocal

Pool: Anoka County

Location: DocuSign

Location: Docusign

### Signer Events

Xcel Energy - Rebecca Cone

rebecca.cone@xcelenergy.com

Security Level:

DocuSign.email

ID: 1

10/22/2025 10:33:50 AM

### Signature

Signed by:  
  
EA87D69B3069430...

Signature Adoption: Pre-selected Style

Using IP Address: 208.87.234.201

### Timestamp

Sent: 10/22/2025 10:33:48 AM

Viewed: 10/22/2025 10:35:05 AM

Signed: 10/22/2025 10:51:21 AM

### Electronic Record and Signature Disclosure:

Accepted: 8/7/2025 10:01:00 PM

ID: 10ed20c8-2422-4626-9094-ec6897e95452

Susan Burgmeier

Susan.Burgmeier@anokacountymn.gov

Associate Traffic Technician

Anoka County

Signing Group: Highway Permits

Security Level: Email, Account Authentication  
(Optional)

Sent: 10/22/2025 10:51:24 AM

Viewed: 10/22/2025 10:52:35 AM

### Electronic Record and Signature Disclosure:

Accepted: 8/20/2025 10:28:44 AM

ID: f14e5ec1-b35c-434b-b98d-96e8f3993340

### In Person Signer Events

### Signature

### Timestamp

### Editor Delivery Events

### Status

### Timestamp

### Agent Delivery Events

### Status

### Timestamp

### Intermediary Delivery Events

### Status

### Timestamp

### Certified Delivery Events

### Status

### Timestamp

### Carbon Copy Events

### Status

### Timestamp

Xcel Energy - Rebecca Cone

rebecca.cone@xcelenergy.com

Security Level: Email, Account Authentication  
(Optional)

### Electronic Record and Signature Disclosure:

Carbon Copy Events	Status	Timestamp
--------------------	--------	-----------

Not Offered via DocuSign

Witness Events	Signature	Timestamp
----------------	-----------	-----------

Notary Events	Signature	Timestamp
---------------	-----------	-----------

Envelope Summary Events	Status	Timestamps
-------------------------	--------	------------

Envelope Sent	Hashed/Encrypted	10/22/2025 10:33:48 AM
Envelope Updated	Security Checked	10/22/2025 10:51:21 AM
Certified Delivered	Security Checked	10/22/2025 10:52:35 AM

Payment Events	Status	Timestamps
----------------	--------	------------

Electronic Record and Signature Disclosure		
--	--	--

## **ELECTRONIC RECORD AND SIGNATURE DISCLOSURE**

The following information constitutes Anoka County's (we, us or Company) written notices or disclosures relating to your use of DocuSign in relation to Anoka County's license. Described below are the terms and conditions for providing notices and disclosures electronically through the DocuSign system. Please read the information below carefully and thoroughly, and if you agree to this Electronic Record and Signature Disclosure (ERSD), please confirm your agreement by selecting the check-box next to 'I agree to use electronic records and signatures' before clicking 'CONTINUE' within the DocuSign system.

### **Getting paper copies**

At any time, you may request from us a paper copy of any record provided or made available electronically to you by us. You will have the ability to download and print documents we send to you through the DocuSign system during and immediately after the signing session and, if you elect to create a DocuSign account, you may access the documents for a limited period of time (30 days) after the documents are first sent to you. At any time, if you request paper copies of any documents, you may be charged a fee. You may request paper copies from us by following the procedure described below.

### **Withdrawing your consent**

If you decide to receive notices, disclosures and documents from us electronically, you may change your mind and tell us that going forward you want to receive documents only in paper format. Please note, processing time will be slowed down dramatically as we will be required to print and send the document through the mail and await your return of the documents. The process to change the method of receipt is described below.

### **All notices and disclosures will be sent to you electronically**

Upon your acceptance to receive electronic notifications, all required notices, disclosures, authorizations, acknowledgements, and other documents that are required to be provided or made available to you during the course of our relationship with you will be provided electronically through the DocuSign system. All of the required documents will be provided to you at the address that you have given us.

### **How to contact Anoka County:**

You may change your preferred method of contact whether electronically, or paper copies, or change your email address. You may also request paper copies of certain information from us, or withdraw your prior consent to receive documents. Please use the contact information below for your request and in the body of your correspondence, identify your desired action. If you are

changing an email address, please include your prior email address as well as your new address. If you no longer wish to receive future documents in electronic format, please include that request in the body of your email.

Email: [helpdesk@co.anoka.mn.us](mailto:helpdesk@co.anoka.mn.us)

Phone: (763)-324-4110

Address: Anoka County Government Center  
Attn: Information Technology, #300  
2100 3rd Avenue  
Anoka, MN 55303

### **Required hardware and software**

The minimum system requirements for using the DocuSign system may change over time. The current system requirements are found here: <https://support.docusign.com/guides/signer-guide-signing-system-requirements>.

### **ACKNOWLEDGEMENT**

To confirm your access to the electronic notices and disclosures, which will be similar to other electronic notices and disclosures that we may provide to you, please acknowledge that you have read this ERSD by selecting the check-box next to 'I agree to use electronic records and signatures' before clicking 'CONTINUE' within the DocuSign system.

By selecting the check-box next to 'I agree to use electronic records and signatures', you confirm that:

- You can access and read this Electronic Record and Signature Disclosure; and
- You can print this Electronic Record and Signature Disclosure, or save or send this Electronic Record and Disclosure to a location where you can print it, for future reference and access; and
- Until or unless you notify Anoka County as described above, you consent to receive exclusively through electronic means all notices, disclosures, authorizations, acknowledgements, and other documents that are required to be provided or made available to you by Anoka County during the course of your relationship with Anoka County.