

SIGNAL HEAD CHART

FACE	R	Y	FYA	G
2-1, 2-2, 2-3	●	●		●
4-1, 4-2, 4-3	●	●		●
5-1, 5-2	←	←	←	←
6-1, 6-2, 6-3	●	●		●

-ALL SIGNAL INDICATIONS SHALL BE 12" LED
 -ALL SIGNAL HEADS SHALL BE BLACK POLYCARBONATE WITH BACKGROUND SHIELDS
 -FYA DENOTES FLASHING YELLOW ARROW

*SEE PAGE 15 FOR INTERCONNECT LAYOUT

④ PA100 POLE FOUNDATION
 TYPE PA100-A-35-D30-9 (DAVT AT 350 DEG)
 1-PAIR SWING AWAY HINGES
 1-ANGLE MOUNT SIGNAL OVERHEAD AT 0°
 1-STRAIGHT MOUNT SIGNALS OVERHEAD AT 12°
 1-ANGLE MOUNT SIGNAL AT 90 DEG
 1-ANGLE MOUNT C. D. PED HEADS AT 90 DEG
 * 1-ONE WAY EVP DETECTOR AND CONFIRMATORY LIGHT (PHASES 6)
 LUMINAIRE-30' LED
 1-PED PB AND SIGN (LT ARROW) (PB6-2)
 1-TYPE D SIGN (D-1) (SEE SIGN DETAILS)
 3" RSC CONDUIT TO HH 8:
 1-12/C #14
 2-4/C #14
 1-3/C #14 (LUM)
 1-2/C #14
 1-3/C #20
 1-1/C #6 INS. GR.

① PA100 POLE FOUNDATION
 TYPE PA100-A-D30-9 (DAVT AT 350 DEG)
 2-STRAIGHT MOUNT C. D. PED HEADS AT 0 & 90 DEG
 1-ANGLE MOUNT SIGNAL AT 90 DEG
 LUMINAIRE-30' LED
 1-PED PB AND SIGN (RT ARROW) (PB4-1)
 1-PED PB AND SIGN (LT ARROW) (PB6-1)
 3" RSC CONDUIT TO HH 1:
 1-12/C #14
 2-4/C #14
 1-3/C #14 (LUM)
 2-2/C #14
 1-1/C #6 INS. GR.
 1-F/O INTERCONNECT

(A) EQUIPMENT PAD (SEE DETAIL SHEET)
 SERVICE CABINET (SSB)
 CONTROLLER AND CABINET (COUNTY FURNISHED)

LOOP DETECTOR CHART

NUMBER	SIZE (FT)	LOCATION	FUNCTION
D5-1	2-6x6	20 & 50	CALL & EXTEND
D5-2	2-6x6	5 & 35	CALL & EXTEND
D4-1	1-6x6	120	EXTEND ONLY
D4-2	1-6x6	120	CALL & EXTEND
D4-3	2-6x6	5 & 20	DELAY CALL IMMEDIATE EXTEND
D4-4	2-6x6	5 & 20	CALL
D2-1, D2-2	6x6	475	CALL & EXTEND
D6-1, D6-2	6x6	475	CALL & EXTEND

-ALL LOOP DETECTORS SHALL BE PVC UNLESS NOTED OTHERWISE
 -LOCATION: DISTANCE FROM CROSSWALK/STOP BAR IN FEET

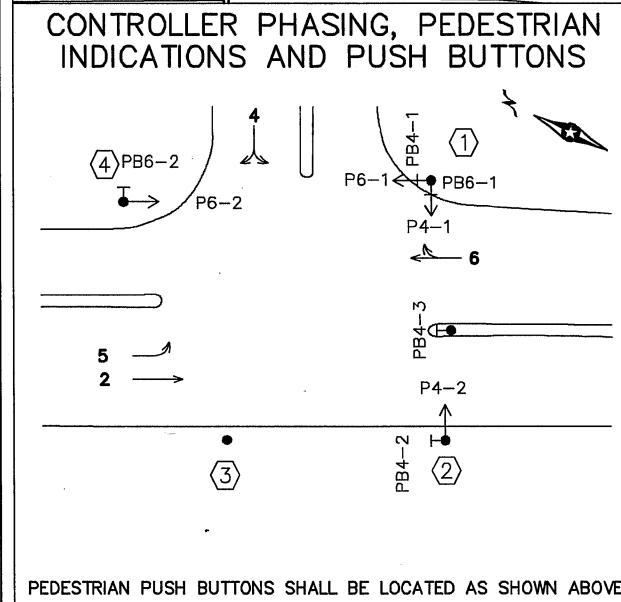
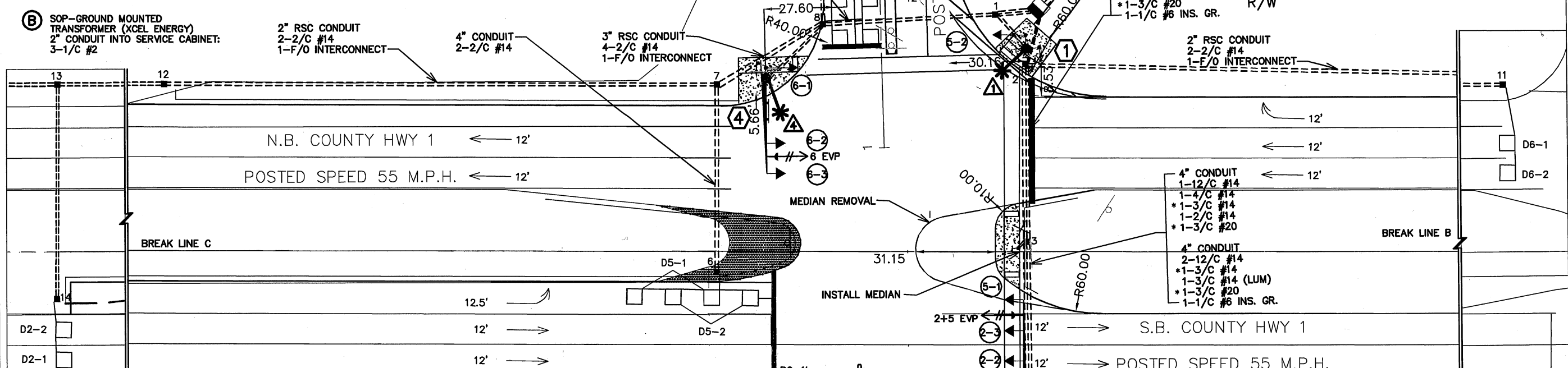

③ PA100 POLE FOUNDATION
 TYPE PA100-A-45
 1-PAIR SWING AWAY HINGES
 1-ANGLE MOUNT SIGNAL OVERHEAD AT 0°
 1-ANGLE MOUNT SIGNAL AT 180 DEG
 * 1-ONE WAY EVP DETECTOR AND CONFIRMATORY LIGHT (LED) (PHASE 4)
 1-TYPE D SIGN (D-2) (SEE SIGN DETAILS)
 3" RSC CONDUIT TO HH 5:
 1-12/C #14
 * 1-3/C #14
 * 1-3/C #20
 1-1/C #6 INS. GR.

② PA100 POLE FOUNDATION
 TYPE PA100-A-45-D30-9 (DAVT AT 350 DEG)
 1-PAIR SWING AWAY HINGES
 2-STRAIGHT MOUNT SIGNALS OVERHEAD AT 12° AND 24°
 1-ANGLE MOUNT SIGNAL AT 0 DEG
 1-ANGLE MOUNT C. D. PED HEAD AT 0 DEG
 * 1-ONE WAY EVP DETECTOR AND CONFIRMATORY LIGHT (LED) (PHASES 2+5)
 1-PED PB AND SIGN (LT ARROW) (PB4-2)
 LUMINAIRE-30' LED
 1-R10-X12 SIGN ADJACENT TO HEAD (5-1)
 1-TYPE D SIGN (D-1) (SEE SIGN DETAILS)
 3" RSC CONDUIT TO HH 4:
 2-12/C #14
 1-4/C #14
 1-3/C #14
 1-3/C #14 (LUM)
 1-2/C #14
 1-3/C #20
 1-1/C #6 INS. GR.

SIGNAL SYSTEM OPERATION

- THE SIGNAL SYSTEM FLASH MODE IS ALL RED.
 - NORMAL OPERATION IS 8 PHASE, WITH PHASE 5 BEING FLASHING YELLOW ARROWS BY TIME OF DAY.
 - PHASES 2 AND 6 SHALL BE ON VEHICLE RECALL.

- NOTES:
- SEE SPECIAL PROVISIONS FOR COUNTY FURNISHED MATERIALS.
 - THE EXACT LOCATION OF HANDHOLES, POLES, LOOP DETECTORS AND EQUIPMENT PAD, SHALL BE VERIFIED IN THE FIELD BY ANOKA COUNTY TRAFFIC OFFICE PERSONNEL.
 - THE CONTRACTOR IS RESPONSIBLE FOR COORDINATING THE CONNECTION OF THE POWER FOR THE TRAFFIC SIGNAL SYSTEM.
 - FOR TYPE D SIGNS SEE DETAIL SHEET. ALL SIGNS REQUIRED ARE INCIDENTAL.
 - FOR PAVEMENT MARKINGS SEE DETAIL SHEET. PAVEMENT MARKINGS ARE INCIDENTAL.
 - FOR CONSTRUCTION OF PEDESTRIAN CURB RAMPS, CONCRETE WALK AND MEDIAN WORK SEE DETAIL SHEET.
 - THIS PLAN SPECIFIES CONDUIT SIZES, TYPES, AND GENERAL LOCATIONS. THE EXACT LOCATIONS WILL BE DETERMINED IN THE FIELD. CONDUITS UNDER THE ROADWAYS REQUIRE BORING.
 - ALL NEW CONDUIT SHALL CARRY 1/C#6 GREEN INSULATED GROUNDING CONDUCTOR AS SHOWN IN THE PLAN.
 - ITEMS DENOTED WITH AN * ARE INCLUDED IN PAYMENT FOR THE EVP SYSTEM PAY ITEM.

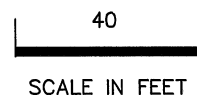

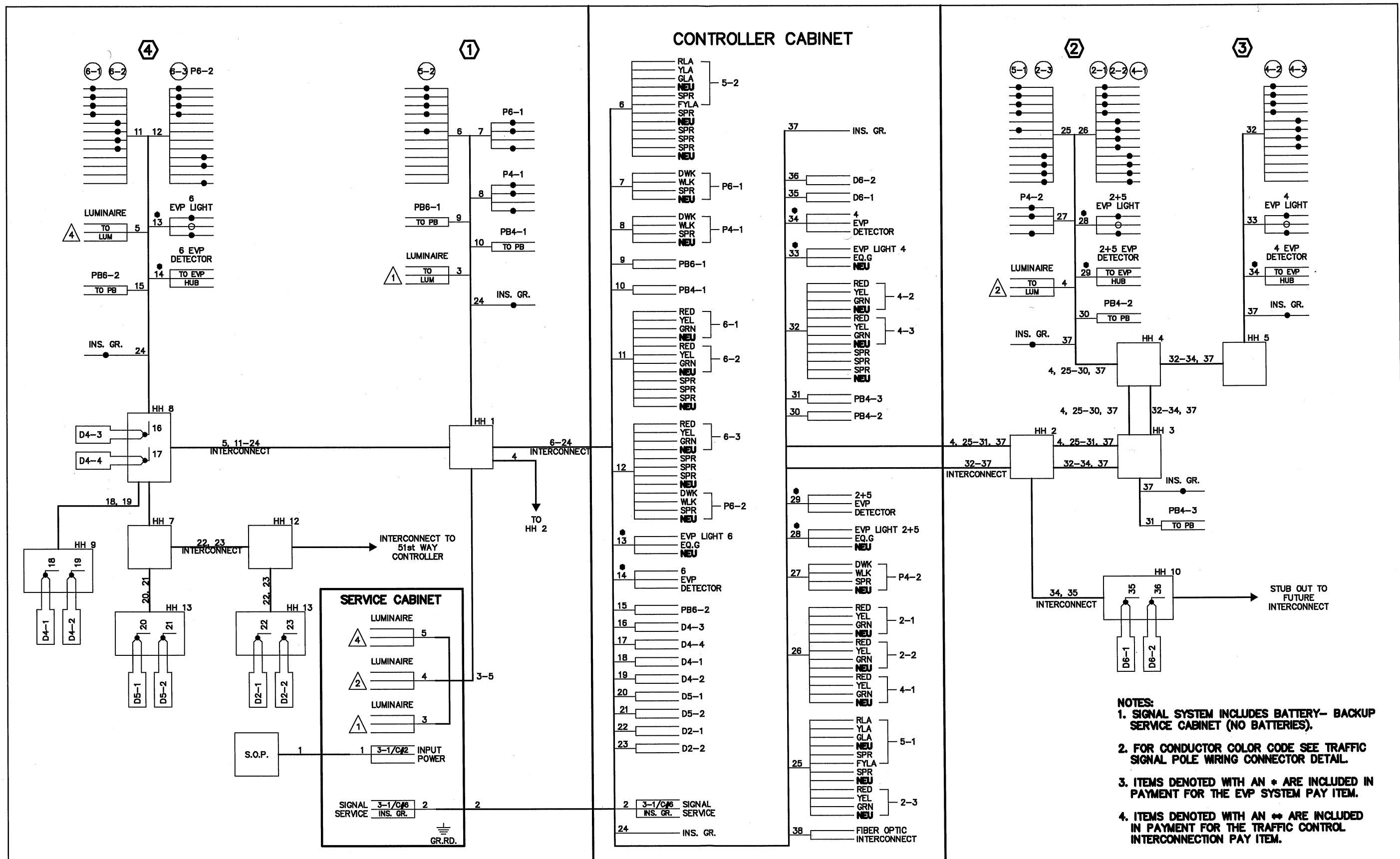

- NOTES:**
1. SIGNAL SYSTEM INCLUDES BATTERY- BACKUP SERVICE CABINET (NO BATTERIES).
 2. FOR CONDUCTOR COLOR CODE SEE TRAFFIC SIGNAL POLE WIRING CONNECTOR DETAIL.
 3. ITEMS DENOTED WITH AN * ARE INCLUDED IN PAYMENT FOR THE EVP SYSTEM PAY ITEM.
 4. ITEMS DENOTED WITH AN ** ARE INCLUDED IN PAYMENT FOR THE TRAFFIC CONTROL INTERCONNECTION PAY ITEM.

BY	DATE	REVISIONS	SYSTEM ID: XXXXX	T.E. XXXX	INTERSECTION LAYOUT TRAFFIC CONTROL SIGNAL SYSTEM CO. HWY 1 AND NORTHERN STACKS CT. IN FRIDLEY, ANOKA COUNTY	CERTIFIED BY <i>[Signature]</i> LIC. NO. 22428 DATE: 4/9/15	DRAWN BY: EDP CKD BY: SJM DATE: 4/9/15
			METER ADDRESS: _____				
			MASTER ID: _____	T.E. _____			

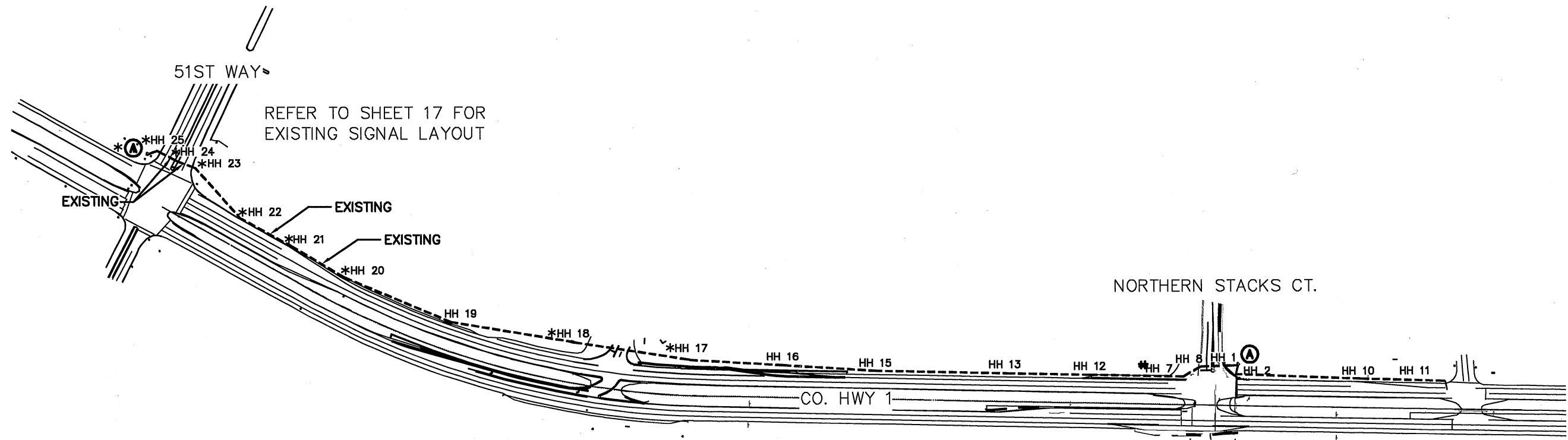

REFER TO SHEET 17 FOR EXISTING SIGNAL LAYOUT

* DENOTES EXISTING

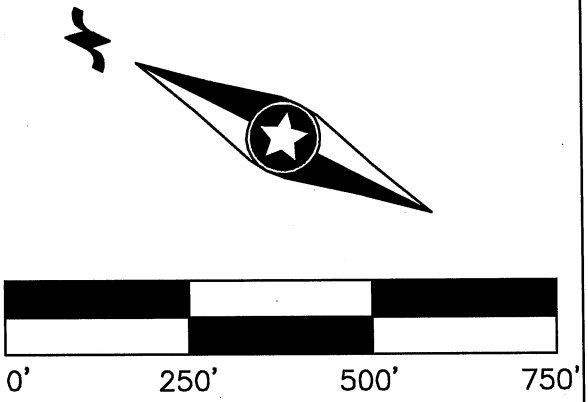

NOTES:

1. IT SHALL BE THE CONTRACTOR'S RESPONSIBILITY TO UTILIZE THE "ONE CALL EXCAVATION NOTICE SYSTEM" (TELEPHONE NUMBER 800-252-1166). THIS IS REQUIRED BY MINNESOTA STATUTE 2160.
2. UNLESS NOTED AS INPLACE, ALL INTERCONNECT SYSTEMS SHALL BE FURNISHED AND INSTALLED.

		REVISIONS	SYSTEM ID: XXXXX _____ T.E. XXXX	INTERCONNECTION LAYOUT TRAFFIC CONTROL SIGNAL SYSTEM CO. HWY 1 AND NORTHERN STACKS CT. IN FRIDLEY, ANOKA COUNTY	DRAWN BY: EDP CKD BY: SJM DATE: 4/9/15
			METER ADDRESS: _____	CERTIFIED BY: <i>[Signature]</i> <small>LICENSED PROFESSIONAL ENGINEER</small>	LIC. NO. 22428 DATE: 4/9/15
			MASTER ID: _____ T.E. _____		SHEET NO. 15 OF 18 SHEETS