

TIME: 3:09:11 PM

PLOTTED: 22-APR-2026

PLOT NAME: d002612039_435sgpc
PATH & FILENAME: Projects\A-A\AnokaCounty\23190000\04_Production\01_CAD\Highway\Sheets\002612039_435sgpc.dgn

SIGNAL HEAD CHART					LOOP DETECTOR CHART			
FACE	R	Y	FYA	G	NUMBER	SIZE (FT)	LOCATION	FUNCTION
1-1, 1-2	←	←	←	←	D1-1, D5-1	3-6X6	20, 35, 50	1
2-1, 2-2, 2-3	●	●	●	●	D1-2, D5-2	6X6	5	1
3-1, 3-2	←	←	←	←	D2-1, D2-2	6X6	625	1
4-1, 4-2	●	●	●	●	D2-3	6X6	5	11
5-1, 5-2	←	←	←	←	D2-4, D2-5	6X6	5	11
6-1, 6-2, 6-3	●	●	●	●	D3-1, D7-1	3-6X6	20, 35, 50	1
7-1, 7-2	←	←	←	←	D3-2, D7-2	6X6	5	1
8-1, 8-2	●	●	●	●	D4-1	6X6	275	3, 8
					D4-2	6X6	20	7
					D4-3	6X6	5	7, 11
					D6-1, D6-2	6X6	625	1
					D6-3	6X6	5	11
					D6-4, D6-5	6X6	5	11
					D8-1	6X6	175	3, 8
					D8-2	6X6	20	7
					D8-3	6X6	5	7, 11

-ALL SIGNAL INDICATIONS SHALL BE 12" LED
 -ALL SIGNAL HEADS SHALL BE BLACK POLYCARBONATE WITH BACKGROUND SHIELDS
 -FYA DENOTES FLASHING YELLOW ARROW

-ALL LOOP DETECTORS SHALL BE PVC UNLESS NOTED OTHERWISE
 -LOCATION: DISTANCE FROM CROSSWALK/STOP BAR IN FEET

LOOP DETECTOR FUNCTIONS:
 1 - CALL AND EXTEND
 3 - EXTEND ONLY
 7 - DELAYED CALL - IMMEDIATE EXTEND
 8 - CARRY OVER (STRETCH)
 11 - SPECIAL DETECTOR (COUNT)

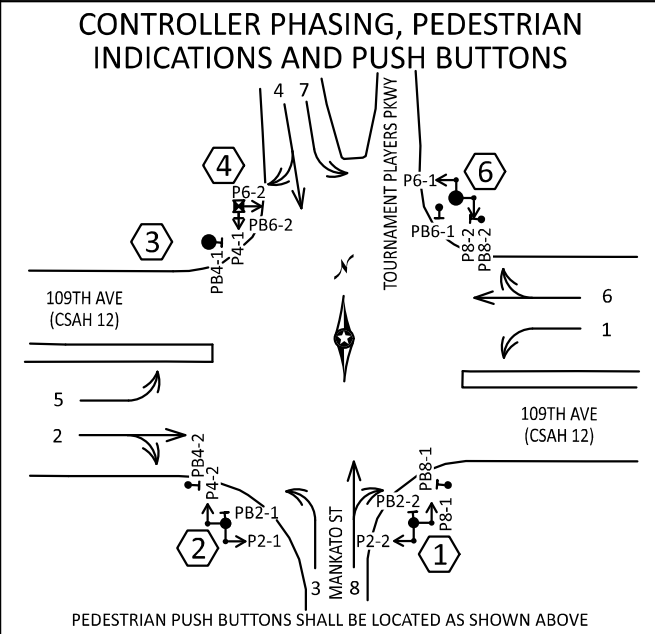
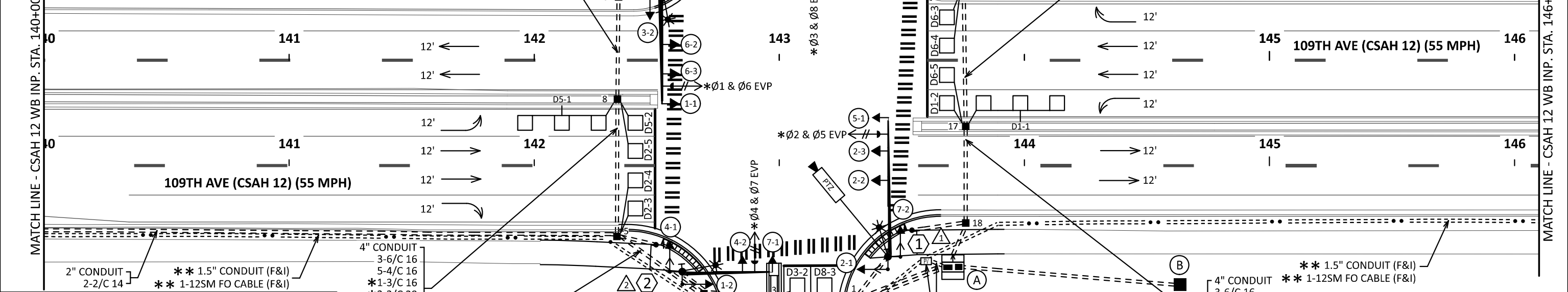

SIGNAL SYSTEM OPERATION

- THE SIGNAL SYSTEM FLASH MODE IS ALL RED.

- NORMAL OPERATION IS 8 PHASE, WITH PHASE(S) 1, 3, 5, 7 BEING FLASHING YELLOW ARROWS BY TIME OF DAY.

- PHASES 2 AND 6 SHALL BE ON VEHICLE RECALL.

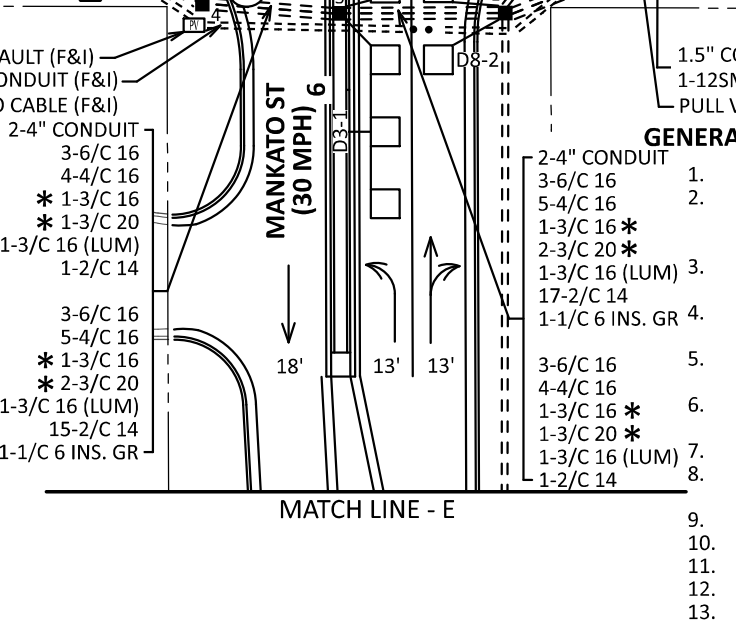

GENERAL NOTES:

- SEE THE SPECIAL PROVISIONS FOR COUNTY FURNISHED MATERIALS.
- THE EXACT LOCATION OF THE HANDHOLES, LOOP DETECTORS, UNDERGROUND CONDUIT, PULL VAULTS, AND THE EQUIPMENT PAD ARE DETERMINED IN THE FIELD. VERIFY THE LOCATIONS OF ALL SIGNAL COMPONENTS WITH ANOKA COUNTY PERSONNEL. CONDUITS UNDER ROADWAYS TYPICALLY REQUIRE BORING.
- IN SITU SOIL INCLUDES SANDY GRANULAR SOILS WITH A HIGH WATER TABLE. DRILLED SHAFT FOUNDATIONS WILL NEED TO BE CASED AND TELESCOPING MAY BE REQUIRED FOR LONGER SHAFTS.
- THE CONTRACTOR IS RESPONSIBLE FOR COORDINATING THE CONNECTION OF THE POWER FOR THE TRAFFIC SIGNAL SYSTEM WITH THE POWER COMPANY.
- CONTRACTOR SHALL TERMINATE FIBER OPTIC CABLE WITHIN TRAFFIC SIGNAL CABINETS IN THE CONTRACTOR PROVIDED TERMINATION PANEL. SEE SPECIAL PROVISIONS.
- ALL SIGNAL MOUNTED SIGNS ARE INCLUDED IN PAYMENT WITH THE LUMP SUM SIGNAL SYSTEM A PAY ITEM. SEE SIGNING DETAIL SHEET FOR SIGNAL MOUNTED SIGNS.
- PAVEMENT MARKINGS ARE PAID FOR SEPARATELY. SEE PAVEMENT MARKING PLANS.
- CONSTRUCTION OF PEDESTRIAN CURB RAMPS, CONCRETE WALK AND MEDIAN WORK ARE INCLUDED WITH THE ADA PLAN AND ARE PAID FOR SEPARATELY.
- USE PVC OR HDPE FOR NEW CONDUIT. CONDUIT SIZES ARE NOMINAL DIAMETER.
- ITEMS DENOTED WITH * ARE INCLUDED IN PAYMENT FOR THE EVP SYSTEM PAY ITEM.
- ITEMS DENOTED WITH ** ARE INCLUDED IN PAYMENT FOR THE TRAFFIC CONTROL INTERCONNECT PAY ITEM.
- ALL ITEMS ARE TO BE FURNISHED AND INSTALLED BY THE CONTRACTOR UNLESS OTHERWISE NOTED.
- PTZ CAMERA AND BRACKETING MUST BE GROUNDED.

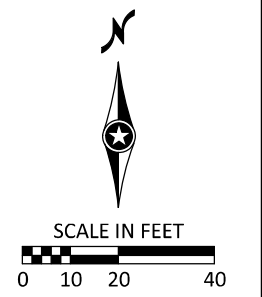

NO.	DATE	BY	DESCRIPTION OF REVISIONS

DES: DAF
 DRW: DAF
 CHK: CJA

I HEREBY CERTIFY THAT THIS SHEET WAS PREPARED BY ME OR UNDER MY DIRECT SUPERVISION AND THAT I AM A DULY LICENSED PROFESSIONAL ENGINEER UNDER THE LAWS OF THE STATE OF MINNESOTA

SIGNATURE: *CAITLIN J. ANDRESS*
 PRINTED NAME: CAITLIN J. ANDRESS
 LIC. NO. 58936 DATE: 22-APR-2026



SIGNAL PLAN
 PERMANENT SIGNAL SYSTEM A

ANOKA COUNTY
 INTERSECTION IMPROVEMENTS

SHEET NO. 149
 TOTAL SHEETS 181

TIME: 3:09:12 PM

PLOTTED: 22-APR-2026

PLOT NAME: d002612039_435sgpc PATH & FILENAME: Projects\A-A\AnokaCounty\23190000\04_Production\01_CAD\Highway\Sheets\d002612039_435sgpc.dgn

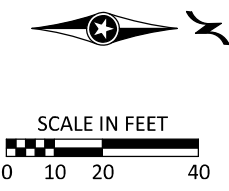
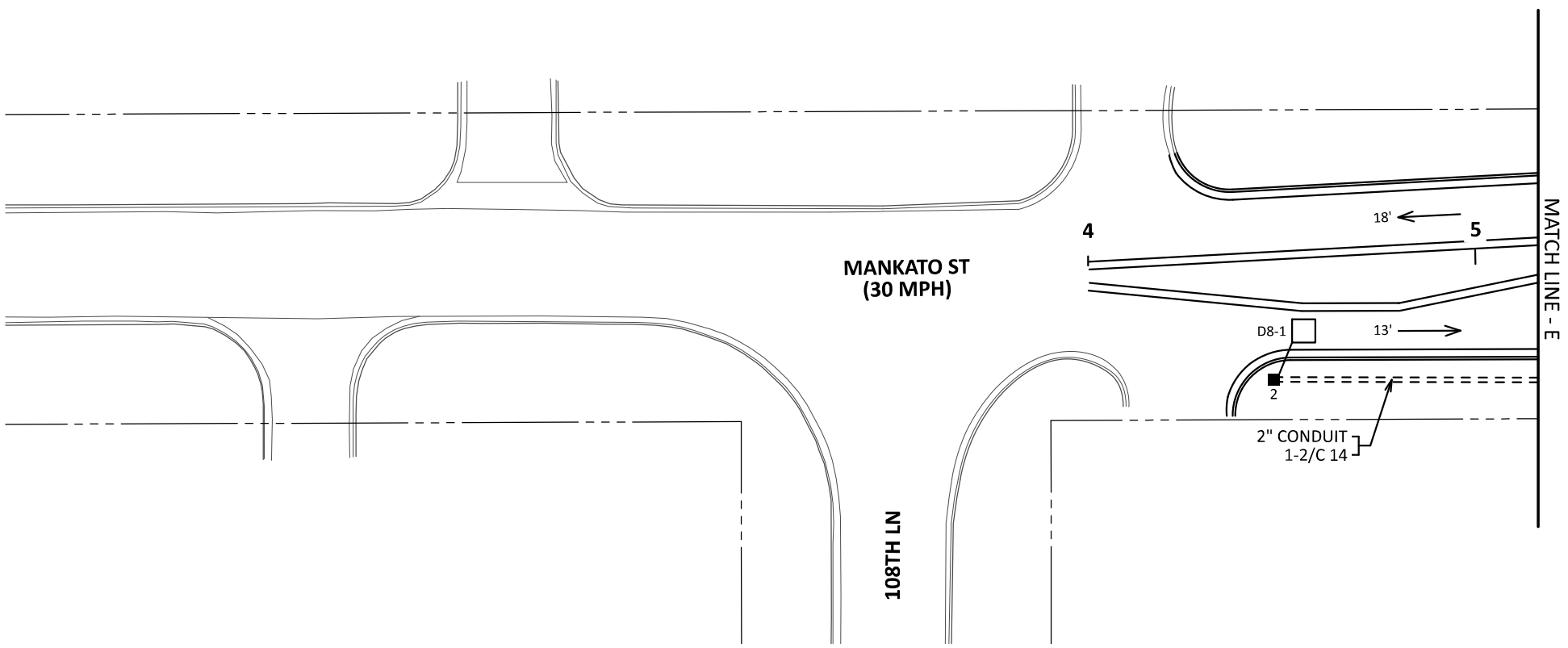
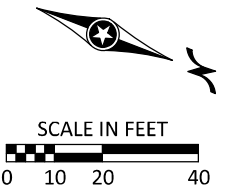
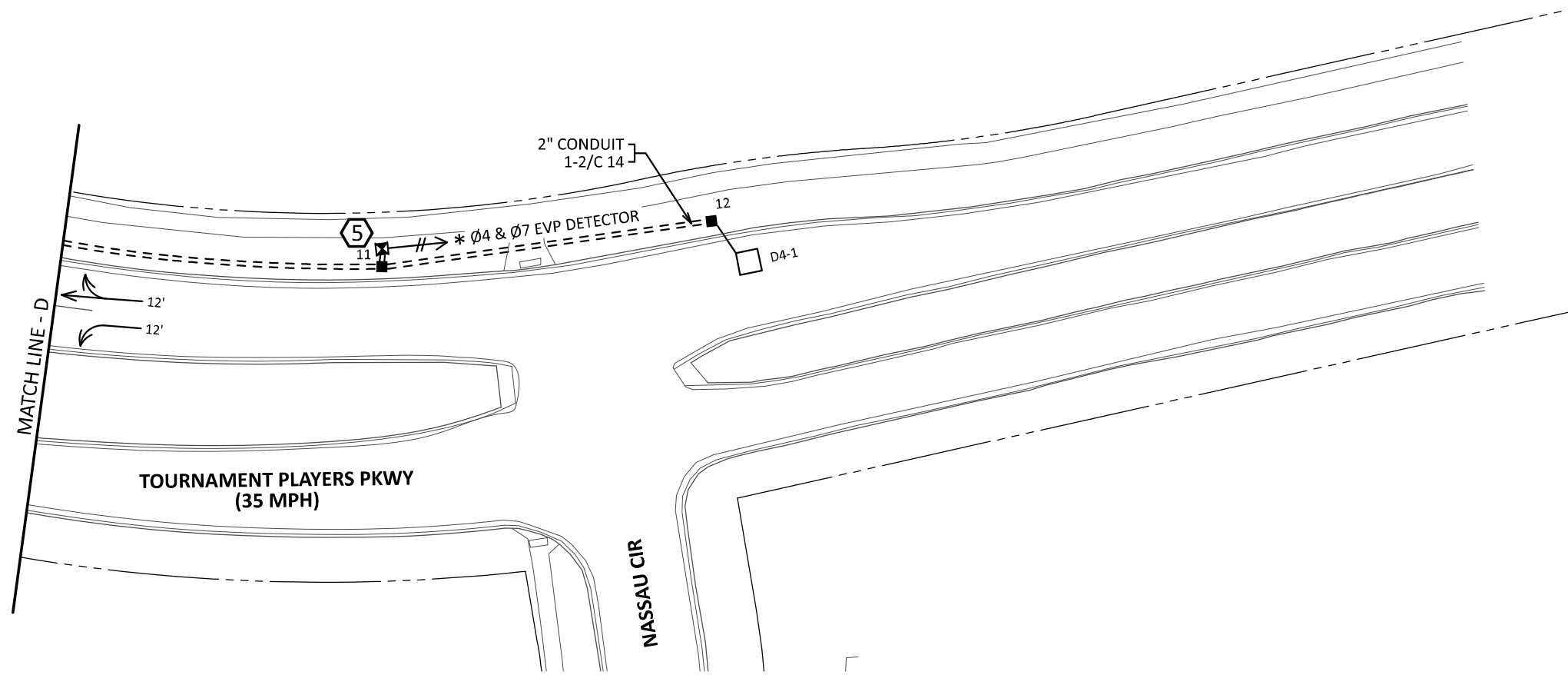

PLOT NAME: d002612039_435sgpc

PATH & FILENAME: Projects\A-A\AnokaCounty\23190000\04_Production\01_CAD\Highway\Sheets\d002612039_435sgpc.dgn

NO.	DATE	BY	DESCRIPTION OF REVISIONS

DES: DAF
 DRW: DAF
 CHK: CJA

I HEREBY CERTIFY THAT THIS SHEET WAS PREPARED BY ME OR UNDER MY DIRECT SUPERVISION AND THAT I AM A DULY LICENSED PROFESSIONAL ENGINEER UNDER THE LAWS OF THE STATE OF MINNESOTA

SIGNATURE: *Caitlin J. Andress*
 PRINTED NAME: CAITLIN J. ANDRESS
 LIC. NO. 58936 DATE: 22-APR-2026



SIGNAL PLAN
 PERMANENT SIGNAL SYSTEM A

ANOKA COUNTY INTERSECTION IMPROVEMENTS
 SAP 002-612-015, SAP 002-612-039, SAP 002-652-015, SAP 106-020-045, SAP 106-130-010, SAP 106-133-002

SHEET NO. 150
 TOTAL SHEETS 181

TIME: 3:09:11 PM

PLOTTED: 22-APR-2026

PLOT NAME: d002612039_435sgpc PATH & FILENAME: Projects\A-A\AnokaCounty\23190000\04_Production\01_CAD\Highway\Sheets\d002612039_435sgpc.dgn

PLOT NAME: d002612039_435sgpc

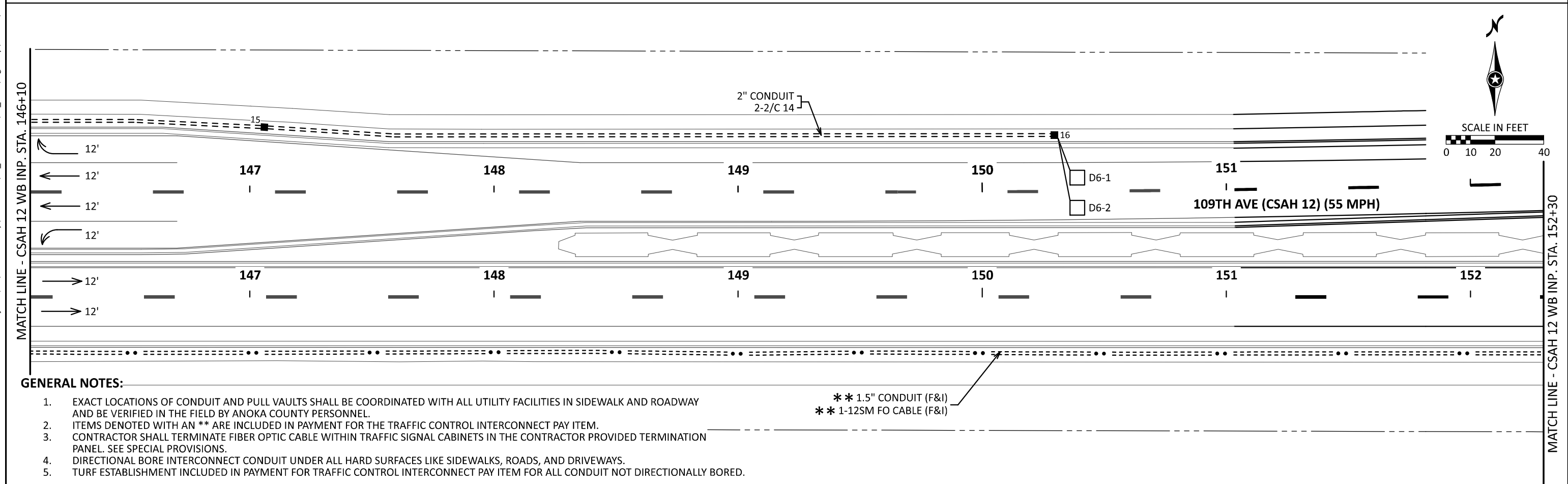
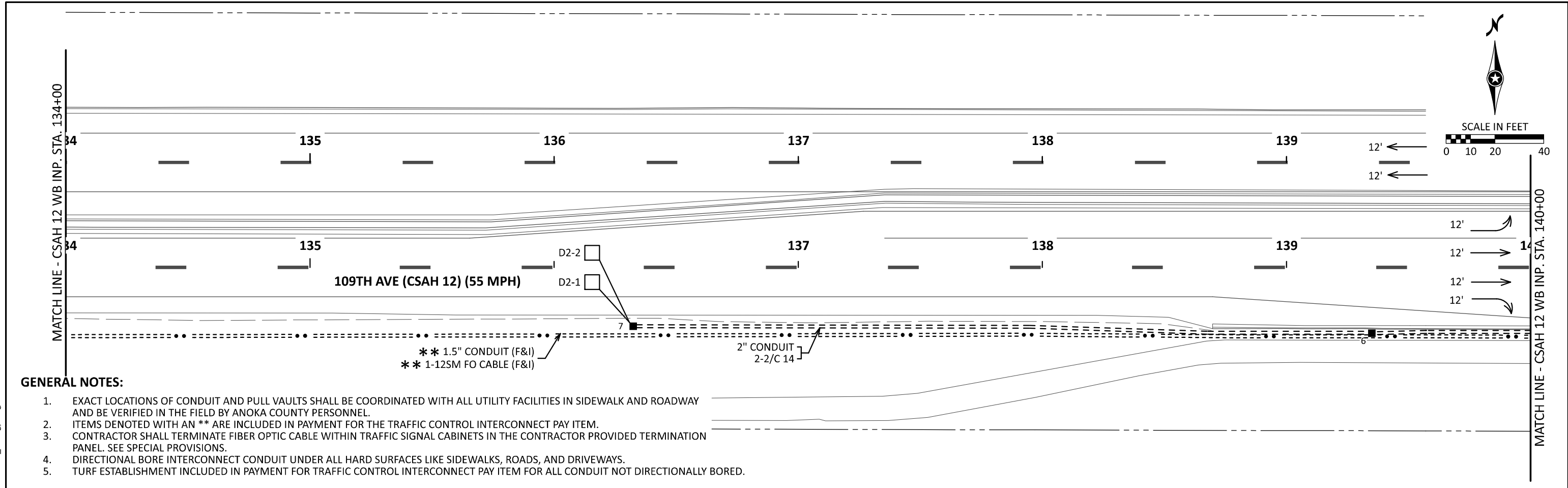

				DES: DAF	I HEREBY CERTIFY THAT THIS SHEET WAS PREPARED BY ME OR UNDER MY DIRECT SUPERVISION AND THAT I AM A DULY LICENSED PROFESSIONAL ENGINEER UNDER THE LAWS OF THE STATE OF MINNESOTA	SIGNATURE: <i>Caitlin J. Andress</i> PRINTED NAME: CAITLIN J. ANDRESS LIC. NO. 58936 DATE: 22-APR-2026		SIGNAL PLAN PERMANENT SIGNAL SYSTEM A	ANOKA COUNTY INTERSECTION IMPROVEMENTS		SHEET NO. 148	
				DRW: DAF					SAP 002-612-015, SAP 002-612-039, SAP 002-652-015, SAP 106-020-045, SAP 106-130-010, SAP 106-133-002		TOTAL SHEETS 181	
NO.	DATE	BY	DESCRIPTION OF REVISIONS	CHK: CJA								

TIME: 3:09:37 PM

PLOTTED: 22-APR-2026

PLOT NAME: d002612039_435sgpb
PATH & FILENAME: Projects\A-F\AnokaCounty\23190000\04_Production\01_CAD\Highway\Sheets\d002612039_435sgpb.dgn

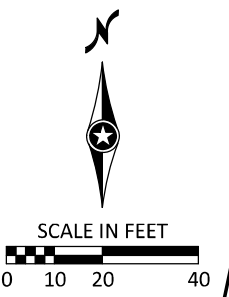
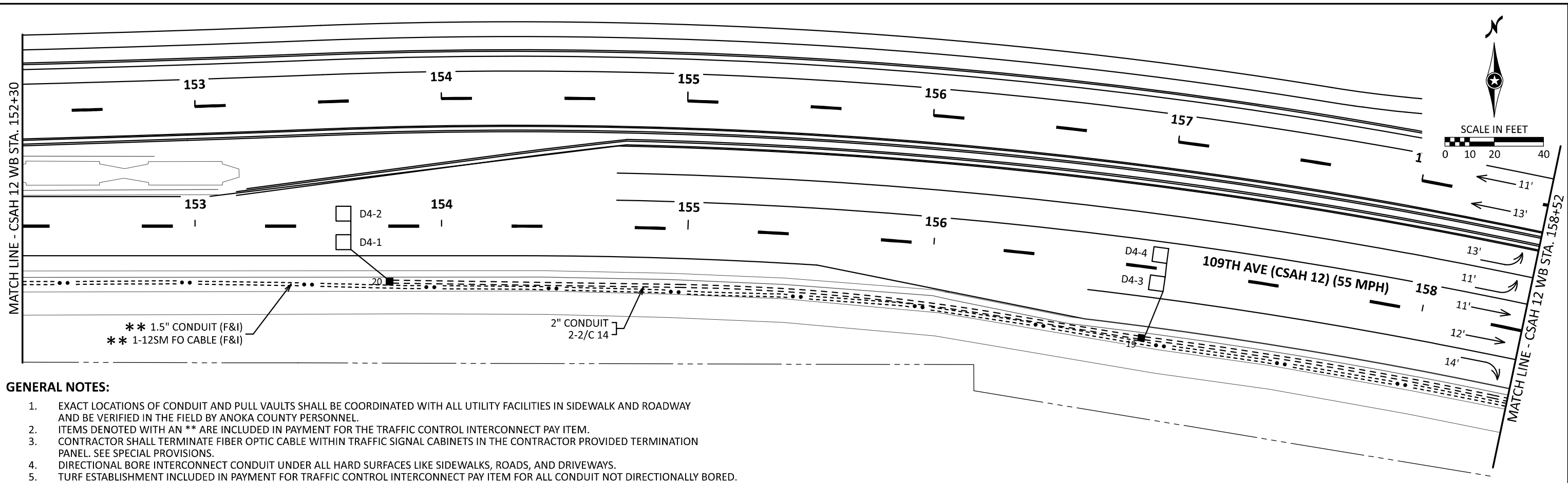

GENERAL NOTES:

1. EXACT LOCATIONS OF CONDUIT AND PULL VAULTS SHALL BE COORDINATED WITH ALL UTILITY FACILITIES IN SIDEWALK AND ROADWAY AND BE VERIFIED IN THE FIELD BY ANOKA COUNTY PERSONNEL.
2. ITEMS DENOTED WITH AN ** ARE INCLUDED IN PAYMENT FOR THE TRAFFIC CONTROL INTERCONNECT PAY ITEM.
3. CONTRACTOR SHALL TERMINATE FIBER OPTIC CABLE WITHIN TRAFFIC SIGNAL CABINETS IN THE CONTRACTOR PROVIDED TERMINATION PANEL. SEE SPECIAL PROVISIONS.
4. DIRECTIONAL BORE INTERCONNECT CONDUIT UNDER ALL HARD SURFACES LIKE SIDEWALKS, ROADS, AND DRIVEWAYS.
5. TURF ESTABLISHMENT INCLUDED IN PAYMENT FOR TRAFFIC CONTROL INTERCONNECT PAY ITEM FOR ALL CONDUIT NOT DIRECTIONALLY BORED.

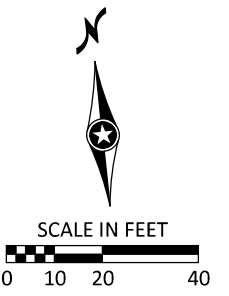
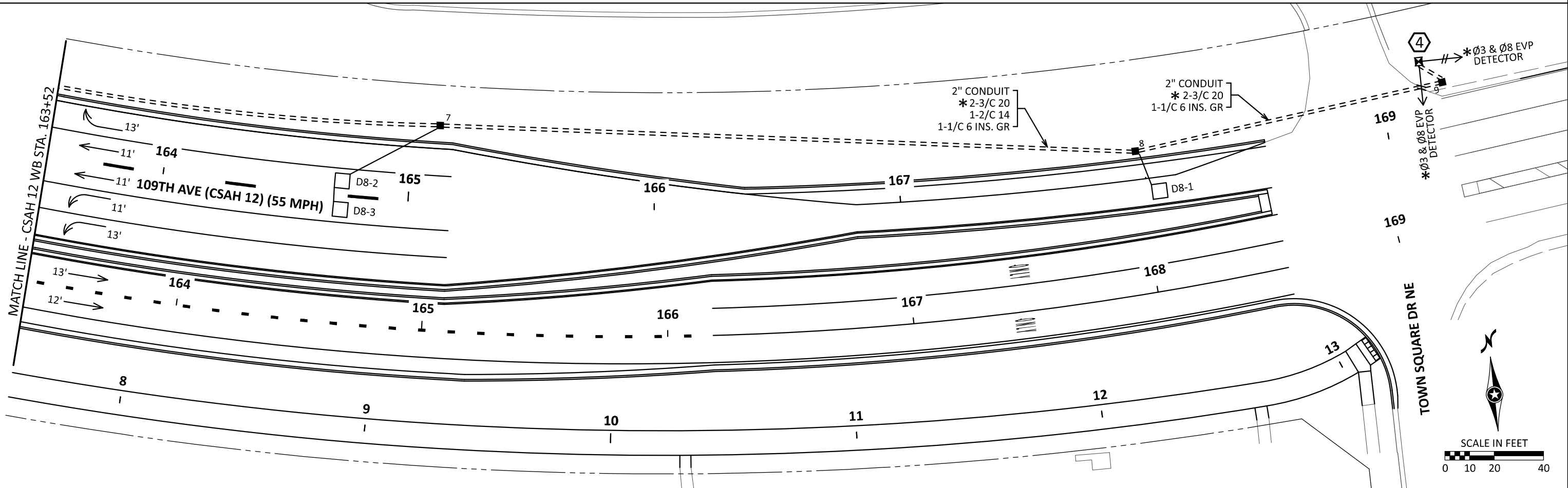

NO.	DATE	BY	DESCRIPTION OF REVISIONS

DES: DAF
 DRW: DAF
 CHK: CJA

I HEREBY CERTIFY THAT THIS SHEET WAS PREPARED BY ME OR UNDER MY DIRECT SUPERVISION AND THAT I AM A DULY LICENSED PROFESSIONAL ENGINEER UNDER THE LAWS OF THE STATE OF MINNESOTA

SIGNATURE: *Caitlin J. Andress*
 PRINTED NAME: CAITLIN J. ANDRESS
 LIC. NO. 58936 DATE: 22-APR-2026



SIGNAL PLAN
 PERMANENT SIGNAL SYSTEM B

ANOKA COUNTY INTERSECTION IMPROVEMENTS
 SAP 002-612-015, SAP 002-612-039, SAP 002-652-015, SAP 106-020-045, SAP 106-130-010, SAP 106-133-002

SHEET NO. 155
 TOTAL SHEETS 181

④ X=512325.0230 Y=148491.9493
 10' PEDESTAL POLE PLUS BASE
 2-STRAIGHT MOUNT C.D. PED HEADS AT 0 AND 270 DEG (P4-1, P6-2)
 1-APS PB AND SIGN (RT ARROW) (PB6-2) AND APS PB MOUNTING SPACERS
 3" CONDUIT INTO HH 10:
 2-4/C 16
 1-2/C 14
 1-1/C 6 INS. GR.

③ X=512315.7121 Y=148481.9656
 PA100 POLE FOUNDATION
 TYPE PA100-A-45-D30-9 (DAVIT AT 350 DEG) (COUNTY FURNISHED)
 1-ANGLE MOUNT SIGNAL OVERHEAD AT 0' (1-1)
 2-STRAIGHT MOUNT SIGNALS OVERHEAD AT 11' AND 23' (6-3, 6-2)
 2-ANGLE MOUNT SIGNALS AT 90 AND 180 DEG (3-2, 6-1)
 * 1-ONE WAY EVP DETECTOR AND CONFIRMATORY LIGHT (PHASES 1+6) (COUNTY FURNISHED)
 1-APS PB AND SIGN (LT ARROW)(PB4-1) AND APS PB POLE MOUNT ADAPTOR
 1-LUMINAIRE-LED (FOR 30' MOUNTING HEIGHT) (LUM-3)
 1-R6-1(R) "ONE WAY" MOUNTED ON POLE FACING NORTH
 1-R6-1(L) "ONE WAY" MOUNTED ON POLE FACING SOUTH
 1-R10-X12 SIGN ADJACENT TO HEAD (1-1)
 1-SIGN (L MANKATO ST TOURN. PLAYERS PKWY R) (SEE SIGN DETAILS)
 3" CONDUIT INTO HH 9:
 3-6/C 16
 3-4/C 16
 * 1-3/C 16
 * 1-3/C 20
 1-3/C 16 (LUM)
 1-2/C 14
 1-1/C 6 INS. GR.

② X=512323.7563 Y=148366.6693
 PA90 POLE FOUNDATION
 TYPE PA90-A-35-D30-9 (DAVIT AT 350 DEG) (COUNTY FURNISHED)
 1-ANGLE MOUNT SIGNAL OVERHEAD AT 0' (7-1)
 1-STRAIGHT MOUNT SIGNAL OVERHEAD AT 11' (4-2)
 2-ANGLE MOUNT SIGNALS AT 90 AND 180 DEG (1-2, 4-1)
 2-ANGLE MOUNT C. D. PED HEADS AT 90 AND 180 DEG (P2-1, P4-2)
 * 1-ONE WAY EVP DETECTOR AND CONFIRMATORY LIGHT (PHASES 4+7) (COUNTY FURNISHED)
 1-LUMINAIRE-LED (FOR 30' MOUNTING HEIGHT) (LUM-2)
 1-APS PB AND SIGN (LT ARROW)(PB2-1) AND APS PB POLE MOUNT ADAPTOR
 1-R6-1(R) "ONE WAY" MOUNTED ON POLE FACING WEST
 1-R6-1(L) "ONE WAY" MOUNTED ON POLE FACING EAST
 1-R10-X12 SIGN ADJACENT TO HEAD (7-1)
 1-SIGN (109TH AVE) (SEE SIGN DETAILS)
 3" CONDUIT INTO HH 4:
 3-6/C 16
 4-4/C 16
 * 1-3/C 16
 * 1-3/C 20
 1-3/C 16 (LUM)
 1-2/C 14
 1-1/C 6 INS. GR.

⑤ X=512291.2103 Y=148680.0692
 10' PEDESTAL POLE PLUS BASE
 * 1-ONE WAY EVP DETECTOR (PHASES 4+7)
 3" CONDUIT INTO HH 11:
 * 1-3/C 20
 1-1/C 6 INS. GR.

⑥ X=512416.9706 Y=148500.6970
 PA100 POLE FOUNDATION
 TYPE PA100-A-45-D30-9 (DAVIT AT 350 DEG) (COUNTY FURNISHED)
 1-ANGLE MOUNT SIGNAL OVERHEAD AT 0' (3-1)
 1-STRAIGHT MOUNT SIGNALS OVERHEAD AT 11' (8-2)
 2-ANGLE MOUNT SIGNALS AT 90 AND 180 DEG (5-2, 8-1)
 2-ANGLE MOUNT C. D. PED HEADS AT 90 AND 180 DEG (P6-1, P8-2)
 * 1-ONE WAY EVP DETECTOR AND CONFIRMATORY LIGHT (PHASES 3+8) (COUNTY FURNISHED)
 1-LUMINAIRE-LED (FOR 30' MOUNTING HEIGHT) (LUM-4)
 1-R6-1(R) "ONE WAY" MOUNTED ON POLE FACING EAST
 1-R6-1(L) "ONE WAY" MOUNTED ON POLE FACING WEST
 1-R10-X12 SIGN ADJACENT TO HEAD (3-1)
 1-SIGN (109TH AVE) (SEE SIGN DETAILS)
 3" CONDUIT INTO HH 13:
 3-6/C 16
 4-4/C 16
 * 1-3/C 16
 * 1-3/C 20
 1-3/C 16 (LUM)
 1-1/C 6 INS. GR.



① X=512407.6501 Y=148372.7542
 PA100 POLE FOUNDATION
 TYPE PA100-A-55-X6-300 CAM 350 (DAVIT AT 350 DEG) (COUNTY FURNISHED)
 (INCLUDES LIGHTNING ROD, 7/16" GROUND BRAID AND GROUND ROD)
 1-PTZ VIDEO CAMERA (COUNTY FURNISHED)
 1-ANGLE MOUNT SIGNAL OVERHEAD AT 0' (5-1)
 2-STRAIGHT MOUNT SIGNALS OVERHEAD AT 12' AND 24' (2-3, 2-2)
 2-ANGLE MOUNT SIGNALS AT 90 AND 180 DEG (7-2, 2-1)
 2-ANGLE MOUNT C. D. PED HEADS AT 90 AND 180 DEG (P8-1, P2-2)
 * 1-ONE WAY EVP DETECTOR AND CONFIRMATORY LIGHT (PHASES 2+5) (COUNTY FURNISHED)
 1-LUMINAIRE-LED (FOR 30' MOUNTING HEIGHT) (LUM-1)
 1-APS PB AND SIGN (RT ARROW)(PB2-2) AND APS PB POLE MOUNT ADAPTOR
 1-R6-1(R) "ONE WAY" MOUNTED ON POLE FACING SOUTH
 1-R6-1(L) "ONE WAY" MOUNTED ON POLE FACING NORTH
 1-R10-X12 SIGN ADJACENT TO HEAD (5-1)
 1-SIGN (L TOURN. PLAYERS PKWY MANKATO ST R) (SEE SIGN DETAILS)
 3" CONDUIT INTO HH 1:
 3-6/C 16
 5-4/C 16
 * 1-3/C 16
 * 1-3/C 20
 1-3/C 16 (LUM)
 1-2/C 14
 1-CAT 5E (PTZ)
 1-1/C 6 INS. GR.

Ⓐ EQUIPMENT PAD (SEE DETAIL SHEET)
 SERVICE CABINET WITH BATTERY BACKUP (SEE DETAIL SHEET)
 CONTROLLER AND CABINET (COUNTY FURNISHED)
 2-4" CONDUIT TO HH 1: 4" CONDUIT TO HH 18:
 3-6/C 16 3-6/C 16
 5-4/C 16 4-4/C 16
 * 1-3/C 16 * 1-3/C 16
 * 2-3/C 20 * 1-3/C 20
 20-2/C 14 10-2/C 14
 1-1/C 6 INS. GR. 1-1/C 6 INS. GR.

6-6/C 16
 9-4/C 16
 * 2-3/C 16
 * 2-3/C 20
 2-2/C 14
 1-CAT 5E (PTZ)
 GROUND WIRE AND GROUND ROD - MIN 8' OUT FROM PAD
 2-2" AND 1-3" CONDUIT STUBBED OUT (CAPPED BOTH ENDS)
 * * 1.5" CONDUIT TO TMS VAULT:
 * * 1-FO CABLE (12SM)
 CONTROLLER CABINET TO SERVICE CABINET:
 2" CONDUIT
 3-1/C 6
 CONTROLLER CABINET TO SERVICE CABINET (COMMS):
 2" CONDUIT
 1-6PR 19
 SERVICE CABINET TO GROUND MOUNTED SOP:
 2" CONDUIT
 3-1/C 2

SERVICE CABINET TO HH 1:
 2" CONDUIT
 3-3/C 16 (LUM)
 SERVICE CABINET TO HH 18:
 2" CONDUIT
 1-3/C 16 (LUM)
 SERVICE CABINET TO EXTERNAL GR. RD.:
 1" CONDUIT
 1-1/C 6 INS. GR.
 (SEE EQUIPMENT PAD LAYOUT)

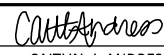
Ⓑ SOP-GROUND MOUNTED (CONNEXUS)
 2" CONDUIT INTO SERVICE CABINET
 3-1/C 2

			DES: DAF	I HEREBY CERTIFY THAT THIS SHEET WAS PREPARED BY ME OR UNDER MY DIRECT SUPERVISION AND THAT I AM A DULY LICENSED PROFESSIONAL ENGINEER UNDER THE LAWS OF THE STATE OF MINNESOTA	SIGNATURE:  PRINTED NAME: CAITLIN J. ANDRESS LIC. NO. 58936 DATE: 22-APR-2026		SIGNAL PLAN PERMANENT SIGNAL SYSTEM A	ANOKA COUNTY INTERSECTION IMPROVEMENTS	SHEET NO. 151
			DRW: DAF					SAP 002-612-015, SAP 002-612-039, SAP 002-652-015, SAP 106-020-045, SAP 106-130-010, SAP 106-133-002	TOTAL SHEETS 181
NO.	DATE	BY	DESCRIPTION OF REVISIONS					CHK: CJA	

TIME: 3:09:13 PM

PLOTTED: 22-APR-2026

PLOT NAME: d002612039_435sgpc PATH & FILENAME: Projects\A-A\AnokaCounty\23190000\04_Production\01_CAD\Highway\Sheets\d002612039_435sgpc.dgn

CONTROLLER CABINET

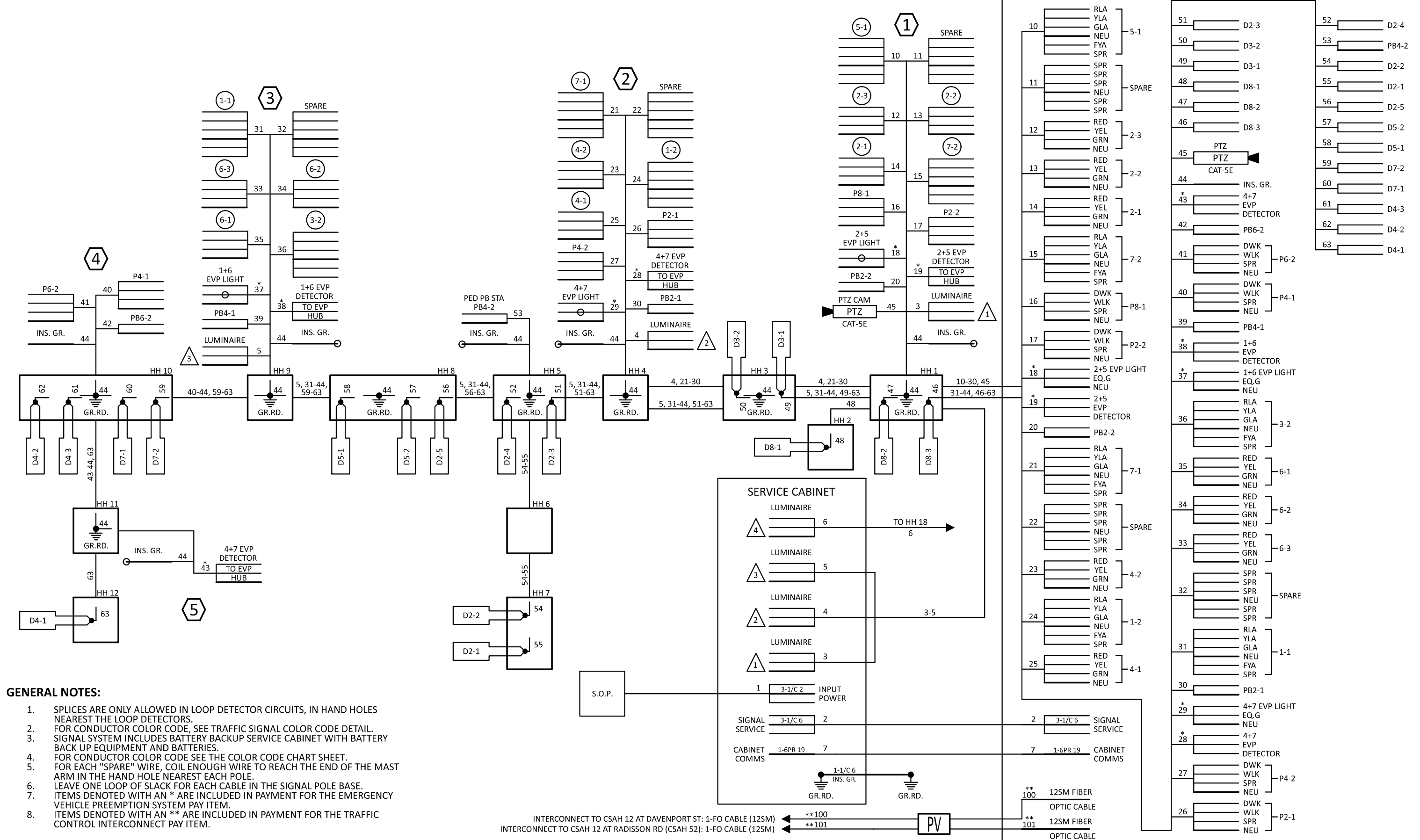

GENERAL NOTES:

1. SPLICES ARE ONLY ALLOWED IN LOOP DETECTOR CIRCUITS, IN HAND HOLES NEAREST THE LOOP DETECTORS.
2. FOR CONDUCTOR COLOR CODE, SEE TRAFFIC SIGNAL COLOR CODE DETAIL.
3. SIGNAL SYSTEM INCLUDES BATTERY BACKUP SERVICE CABINET WITH BATTERY BACK UP EQUIPMENT AND BATTERIES.
4. FOR CONDUCTOR COLOR CODE SEE THE COLOR CODE CHART SHEET.
5. FOR EACH "SPARE" WIRE, COIL ENOUGH WIRE TO REACH THE END OF THE MAST ARM IN THE HAND HOLE NEAREST EACH POLE.
6. LEAVE ONE LOOP OF SLACK FOR EACH CABLE IN THE SIGNAL POLE BASE.
7. ITEMS DENOTED WITH AN * ARE INCLUDED IN PAYMENT FOR THE EMERGENCY VEHICLE PREEMPTION SYSTEM PAY ITEM.
8. ITEMS DENOTED WITH AN ** ARE INCLUDED IN PAYMENT FOR THE TRAFFIC CONTROL INTERCONNECT PAY ITEM.

INTERCONNECT TO CSAH 12 AT DAVENPORT ST: 1-FO CABLE (12SM)
 INTERCONNECT TO CSAH 12 AT RADISSON RD (CSAH 52): 1-FO CABLE (12SM)

NO.	DATE	BY	DESCRIPTION OF REVISIONS

DES: DAF
 DRW: DAF
 CHK: CJA

I HEREBY CERTIFY THAT THIS SHEET WAS PREPARED BY ME OR UNDER MY DIRECT SUPERVISION AND THAT I AM A DULY LICENSED PROFESSIONAL ENGINEER UNDER THE LAWS OF THE STATE OF MINNESOTA

SIGNATURE: *Caitlin J. Andress*
 PRINTED NAME: CAITLIN J. ANDRESS
 LIC. NO. 58936 DATE: 22-APR-2026



SIGNAL PLAN
 PERMANENT SIGNAL SYSTEM A

ANOKA COUNTY INTERSECTION IMPROVEMENTS		SHEET NO.
SAP 002-612-015, SAP 002-612-039, SAP 002-652-015, SAP 106-020-045, SAP 106-130-010, SAP 106-133-002		152
TOTAL SHEETS		181

CONTROLLER CABINET

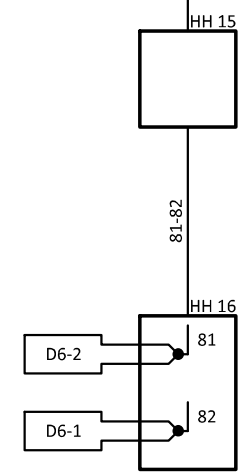
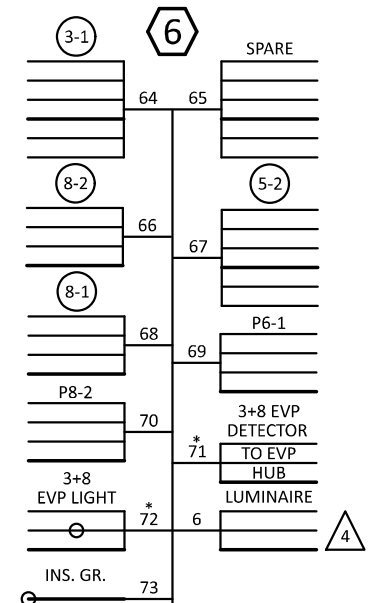
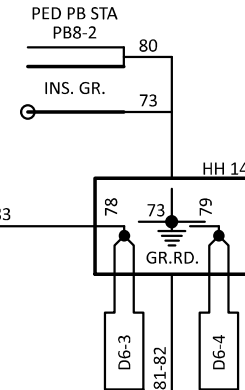
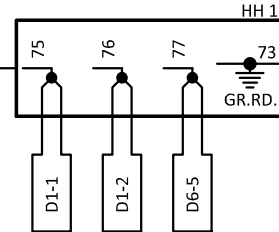
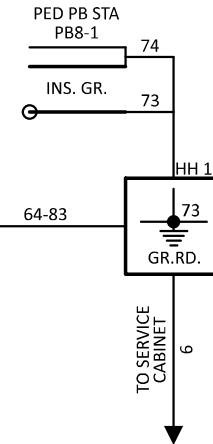
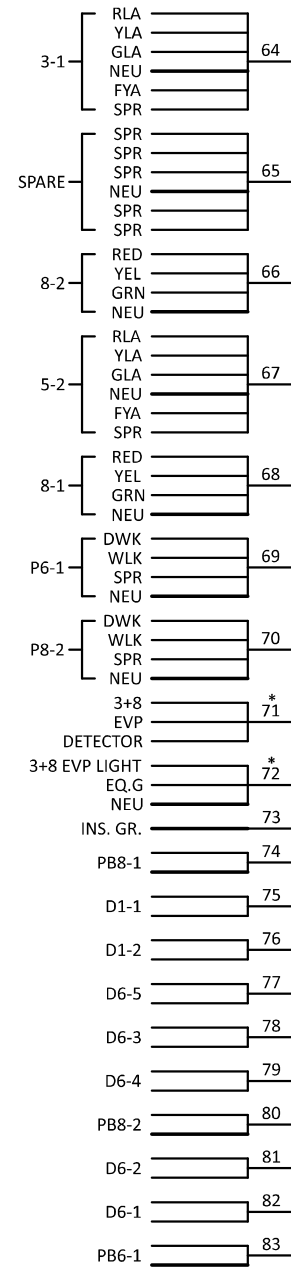

GENERAL NOTES:

1. SPLICES ARE ONLY ALLOWED IN LOOP DETECTOR CIRCUITS, IN HAND HOLES NEAREST THE LOOP DETECTORS.
2. FOR CONDUCTOR COLOR CODE, SEE TRAFFIC SIGNAL COLOR CODE DETAIL.
3. SIGNAL SYSTEM INCLUDES BATTERY BACKUP SERVICE CABINET WITH BATTERY BACK UP EQUIPMENT AND BATTERIES.
4. FOR CONDUCTOR COLOR CODE SEE THE COLOR CODE CHART SHEET.
5. FOR EACH "SPARE" WIRE, COIL ENOUGH WIRE TO REACH THE END OF THE MAST ARM IN THE HAND HOLE NEAREST EACH POLE.
6. LEAVE ONE LOOP OF SLACK FOR EACH CABLE IN THE SIGNAL POLE BASE.
7. ITEMS DENOTED WITH AN * ARE INCLUDED IN PAYMENT FOR THE EMERGENCY VEHICLE PREEMPTION SYSTEM PAY ITEM.
8. ITEMS DENOTED WITH AN ** ARE INCLUDED IN PAYMENT FOR THE TRAFFIC CONTROL INTERCONNECT PAY ITEM.

PLOT NAME: d002612039_435sgpc
 PATH & FILENAME: Projects\A-A\AnokaCounty\23190000\04_Production\01_CAD\Highway\Sheets\d002612039_435sgpc.dgn
 PLOTTED: 22-APR-2026
 TIME: 3:09:14 PM

DES: DAF	DRW: DAF	CHK: CJA	
NO.	DATE	BY	DESCRIPTION OF REVISIONS

I HEREBY CERTIFY THAT THIS SHEET WAS PREPARED BY ME OR UNDER MY DIRECT SUPERVISION AND THAT I AM A DULY LICENSED PROFESSIONAL ENGINEER UNDER THE LAWS OF THE STATE OF MINNESOTA.
 SIGNATURE: *CAITLIN J. ANDRESS*
 PRINTED NAME: CAITLIN J. ANDRESS
 LIC. NO. 58936 DATE: 22-APR-2026



SIGNAL PLAN
 PERMANENT SIGNAL SYSTEM A

ANOKA COUNTY INTERSECTION IMPROVEMENTS		SHEET NO. 153
SAP 002-612-015, SAP 002-612-039, SAP 002-652-015, SAP 106-020-045, SAP 106-130-010, SAP 106-133-002		TOTAL SHEETS 181

TIME: 3:08:58 PM

PLOTTED: 22-APR-2026

PLOT NAME: d002612039_435sqpg
PATH & FILENAME: Projects\A-F\AnokaCounty\23190000\04_Production\01_CAD\Highway\Sheets\d002612039_435sqpg.dgn

PLOT NAME: d002612039_435sqpg
PATH & FILENAME: Projects\A-F\AnokaCounty\23190000\04_Production\01_CAD\Highway\Sheets\d002612039_435sqpg.dgn

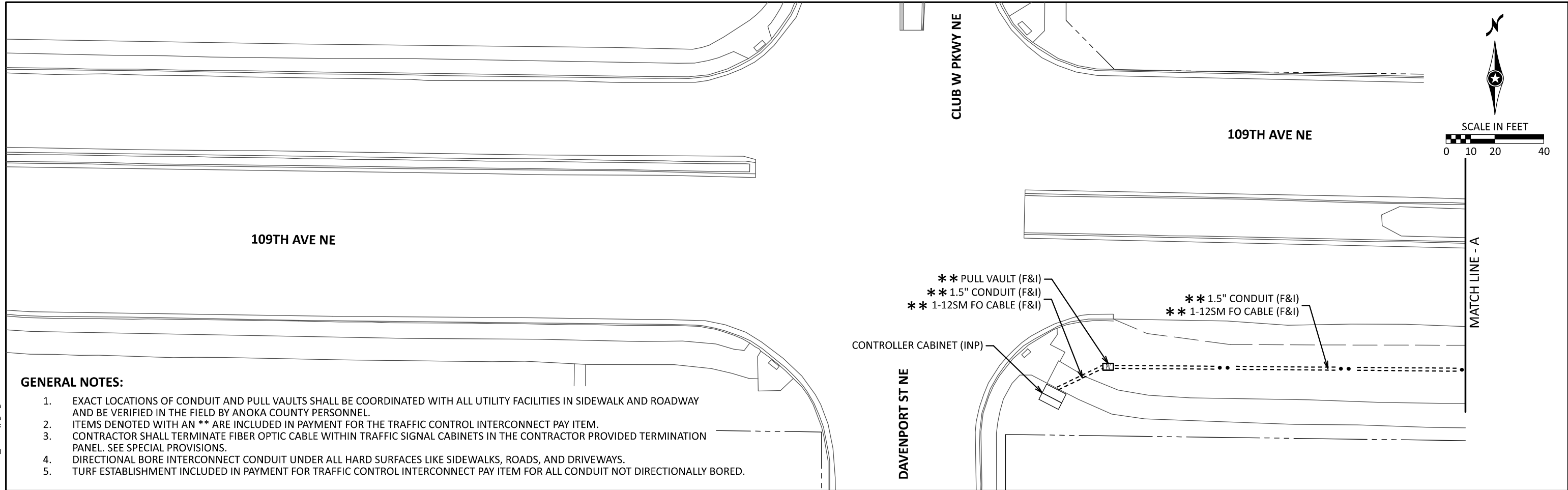

GENERAL NOTES:

1. EXACT LOCATIONS OF CONDUIT AND PULL VAULTS SHALL BE COORDINATED WITH ALL UTILITY FACILITIES IN SIDEWALK AND ROADWAY AND BE VERIFIED IN THE FIELD BY ANOKA COUNTY PERSONNEL.
2. ITEMS DENOTED WITH AN ** ARE INCLUDED IN PAYMENT FOR THE TRAFFIC CONTROL INTERCONNECT PAY ITEM.
3. CONTRACTOR SHALL TERMINATE FIBER OPTIC CABLE WITHIN TRAFFIC SIGNAL CABINETS IN THE CONTRACTOR PROVIDED TERMINATION PANEL. SEE SPECIAL PROVISIONS.
4. DIRECTIONAL BORE INTERCONNECT CONDUIT UNDER ALL HARD SURFACES LIKE SIDEWALKS, ROADS, AND DRIVEWAYS.
5. TURF ESTABLISHMENT INCLUDED IN PAYMENT FOR TRAFFIC CONTROL INTERCONNECT PAY ITEM FOR ALL CONDUIT NOT DIRECTIONALLY BORED.

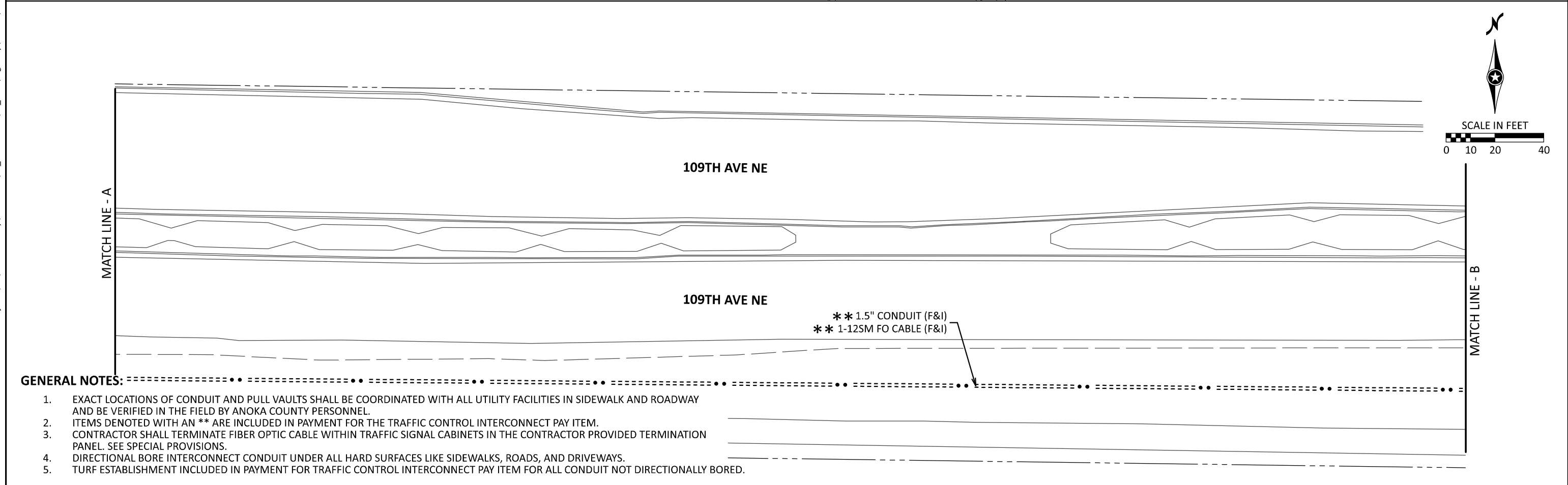

GENERAL NOTES:

1. EXACT LOCATIONS OF CONDUIT AND PULL VAULTS SHALL BE COORDINATED WITH ALL UTILITY FACILITIES IN SIDEWALK AND ROADWAY AND BE VERIFIED IN THE FIELD BY ANOKA COUNTY PERSONNEL.
2. ITEMS DENOTED WITH AN ** ARE INCLUDED IN PAYMENT FOR THE TRAFFIC CONTROL INTERCONNECT PAY ITEM.
3. CONTRACTOR SHALL TERMINATE FIBER OPTIC CABLE WITHIN TRAFFIC SIGNAL CABINETS IN THE CONTRACTOR PROVIDED TERMINATION PANEL. SEE SPECIAL PROVISIONS.
4. DIRECTIONAL BORE INTERCONNECT CONDUIT UNDER ALL HARD SURFACES LIKE SIDEWALKS, ROADS, AND DRIVEWAYS.
5. TURF ESTABLISHMENT INCLUDED IN PAYMENT FOR TRAFFIC CONTROL INTERCONNECT PAY ITEM FOR ALL CONDUIT NOT DIRECTIONALLY BORED.

			DES: DAF	I HEREBY CERTIFY THAT THIS SHEET WAS PREPARED BY ME OR UNDER MY DIRECT SUPERVISION AND THAT I AM A DULY LICENSED PROFESSIONAL ENGINEER UNDER THE LAWS OF THE STATE OF MINNESOTA	SIGNATURE: <i>CAITLIN J. ANDRESS</i>		SIGNAL PLAN TRAFFIC CONTROL INTERCONNECT	ANOKA COUNTY INTERSECTION IMPROVEMENTS		SHEET NO. 146
			DRW: DAF		PRINTED NAME: CAITLIN J. ANDRESS			SAP 002-612-015, SAP 002-612-039, SAP 002-652-015, SAP 106-020-045, SAP 106-130-010, SAP 106-133-002	TOTAL SHEETS 181	
NO.	DATE	BY	CHK: CJA		DATE: 22-APR-2026					

TIME: 3:08:58 PM

PLOTTED: 22-APR-2026

PLOT NAME: d002612039_435sqpg
PATH & FILENAME: Projects\A-F\AnokaCounty\23190000\04_Production\01_CAD\Highway\Sheets\d002612039_435sqpg.dgn

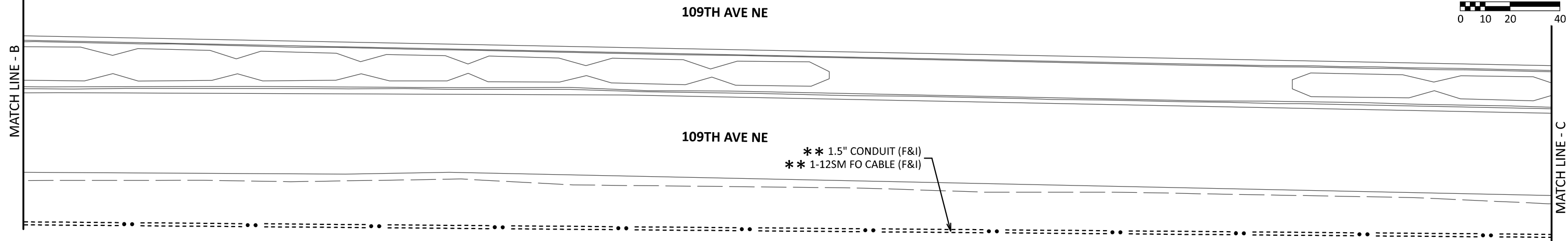
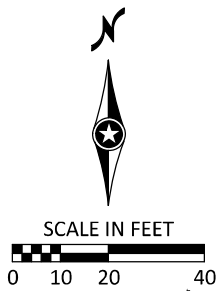

GENERAL NOTES:

1. EXACT LOCATIONS OF CONDUIT AND PULL VAULTS SHALL BE COORDINATED WITH ALL UTILITY FACILITIES IN SIDEWALK AND ROADWAY AND BE VERIFIED IN THE FIELD BY ANOKA COUNTY PERSONNEL.
2. ITEMS DENOTED WITH AN ** ARE INCLUDED IN PAYMENT FOR THE TRAFFIC CONTROL INTERCONNECT PAY ITEM.
3. CONTRACTOR SHALL TERMINATE FIBER OPTIC CABLE WITHIN TRAFFIC SIGNAL CABINETS IN THE CONTRACTOR PROVIDED TERMINATION PANEL. SEE SPECIAL PROVISIONS.
4. DIRECTIONAL BORE INTERCONNECT CONDUIT UNDER ALL HARD SURFACES LIKE SIDEWALKS, ROADS, AND DRIVEWAYS.
5. TURF ESTABLISHMENT INCLUDED IN PAYMENT FOR TRAFFIC CONTROL INTERCONNECT PAY ITEM FOR ALL CONDUIT NOT DIRECTIONALLY BORED.

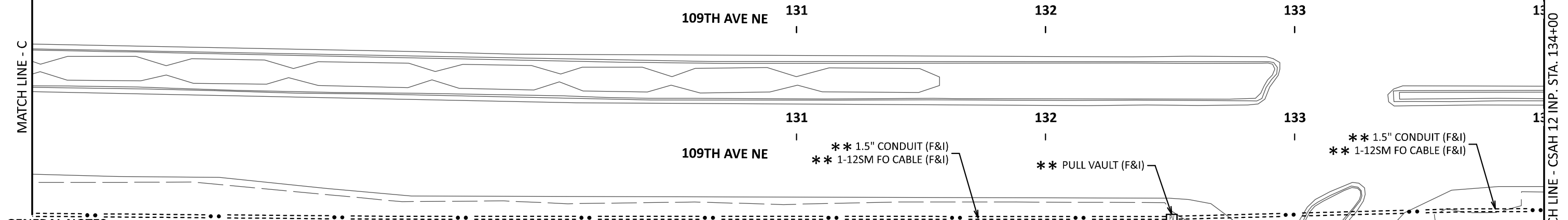
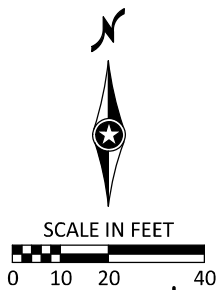

GENERAL NOTES:

1. EXACT LOCATIONS OF CONDUIT AND PULL VAULTS SHALL BE COORDINATED WITH ALL UTILITY FACILITIES IN SIDEWALK AND ROADWAY AND BE VERIFIED IN THE FIELD BY ANOKA COUNTY PERSONNEL.
2. ITEMS DENOTED WITH AN ** ARE INCLUDED IN PAYMENT FOR THE TRAFFIC CONTROL INTERCONNECT PAY ITEM.
3. CONTRACTOR SHALL TERMINATE FIBER OPTIC CABLE WITHIN TRAFFIC SIGNAL CABINETS IN THE CONTRACTOR PROVIDED TERMINATION PANEL. SEE SPECIAL PROVISIONS.
4. DIRECTIONAL BORE INTERCONNECT CONDUIT UNDER ALL HARD SURFACES LIKE SIDEWALKS, ROADS, AND DRIVEWAYS.
5. TURF ESTABLISHMENT INCLUDED IN PAYMENT FOR TRAFFIC CONTROL INTERCONNECT PAY ITEM FOR ALL CONDUIT NOT DIRECTIONALLY BORED.

DES:	DAF	I HEREBY CERTIFY THAT THIS SHEET WAS PREPARED BY ME OR UNDER MY DIRECT SUPERVISION AND THAT I AM A DULY LICENSED PROFESSIONAL ENGINEER UNDER THE LAWS OF THE STATE OF MINNESOTA
DRW:	DAF	
CHK:	CJA	

SIGNATURE: *CAITLIN J. ANDRESS*
 PRINTED NAME: CAITLIN J. ANDRESS
 LIC. NO. 58936 DATE: 22-APR-2026



SIGNAL PLAN
 TRAFFIC CONTROL INTERCONNECT

ANOKA COUNTY INTERSECTION IMPROVEMENTS		SHEET NO. 147
SAP 002-612-015, SAP 002-612-039, SAP 002-652-015, SAP 106-020-045, SAP 106-130-010, SAP 106-133-002		TOTAL SHEETS 181