

F & I N.M.C. LOOP DETECTORS			
NUMBER	SIZE (FT.)	LOCATION	FUNCTION
D2-1	6x6	475'	1
D2-2	6x6	475'	1
D4-1	6x6	180'	3,8
D4-2	6x6	180'	3,8
D4-3	2-6x6	0' & 15'	7
D4-4	2-6x6	0' & 15'	1
D5-1	2-6x6	15' & 45'	1
D5-2	2-6x6	0' & 30'	1
D6-1	6x6	475'	1
D6-2	6x6	475'	1

LOOP DETECTORS FUNCTIONS:

- 1) CALL AND EXTEND
- 3) EXTEND ONLY
- 7) DELAYED CALL, IMMEDIATE EXTEND
- 8) CARRY OVER (STRETCH)

NOTE: LOCATION=DISTANCE FROM STOP BAR TO FRONT OF LOOP DETECTOR.

CONTROLLER PHASING, PEDESTRIAN INDICATIONS AND PUSH BUTTONS

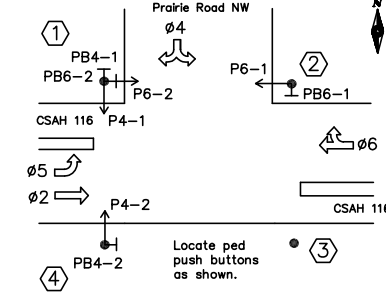

SIGNAL SYSTEM OPERATIONS:

- SIGNAL SYSTEM FLASH MODE SHALL BE ALL RED.
- NORMAL OPERATION SHALL BE 4 PHASE, WITH PHASE 5 BEING A FLASHING YELLOW ARROW (FLASH BY TIME OF DAY).
- VEHICLE SIGNAL PHASES 2 AND 6 SHALL OPERATE ON RECALL.

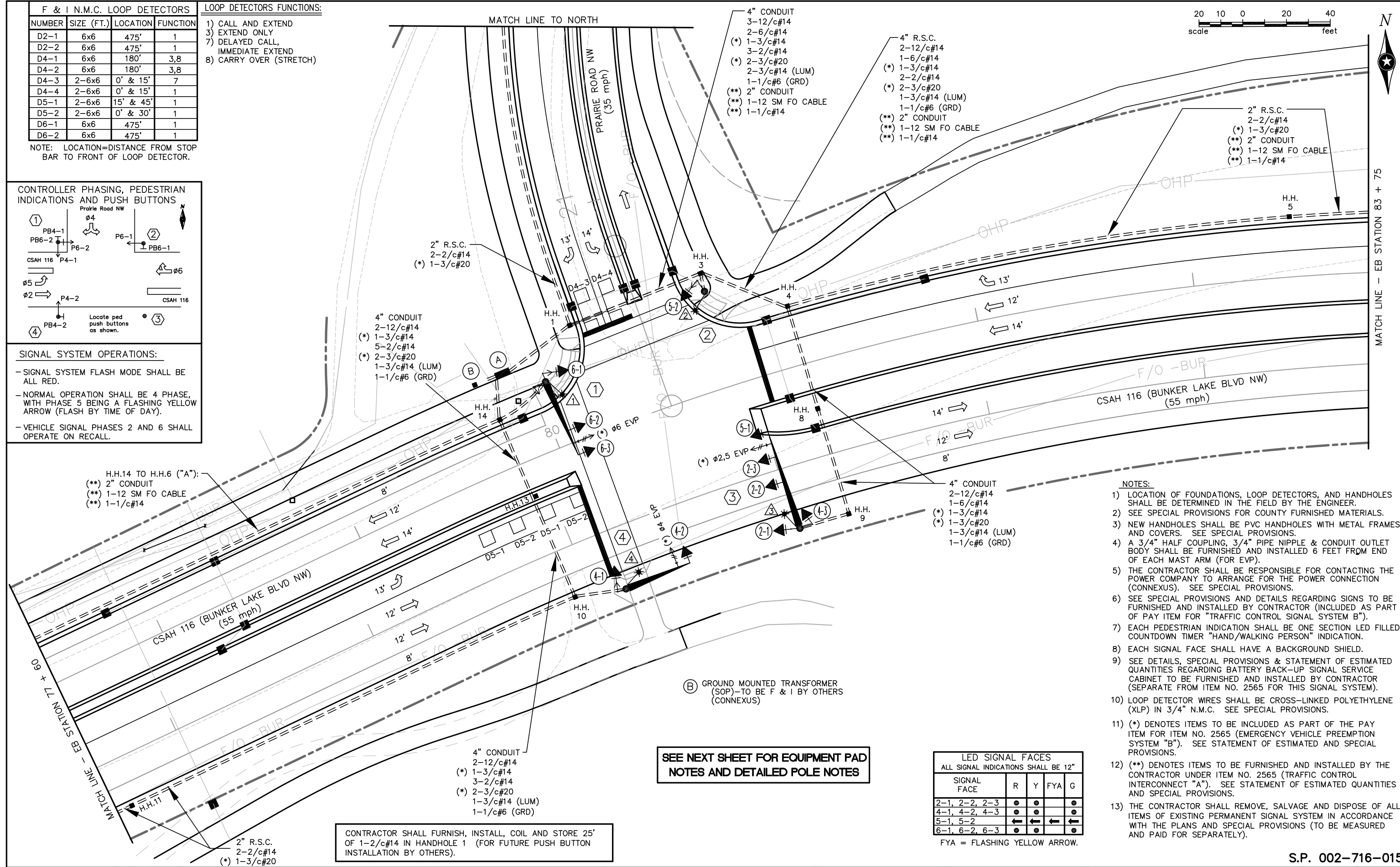
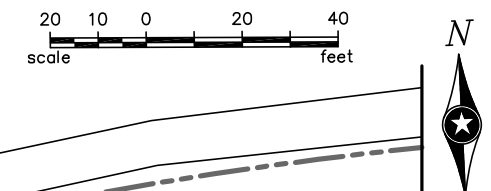

- NOTES:**
- 1) LOCATION OF FOUNDATIONS, LOOP DETECTORS, AND HANDHOLES SHALL BE DETERMINED IN THE FIELD BY THE ENGINEER.
 - 2) SEE SPECIAL PROVISIONS FOR COUNTY FURNISHED MATERIALS.
 - 3) NEW HANDHOLES SHALL BE PVC HANDHOLES WITH METAL FRAMES AND COVERS. SEE SPECIAL PROVISIONS.
 - 4) A 3/4" HALF COUPLING, 3/4" PIPE NIPPLE & CONDUIT OUTLET BODY SHALL BE FURNISHED AND INSTALLED 6 FEET FROM END OF EACH MAST ARM (FOR EVP).
 - 5) THE CONTRACTOR SHALL BE RESPONSIBLE FOR CONTACTING THE POWER COMPANY TO ARRANGE FOR THE POWER CONNECTION (CONNEXUS). SEE SPECIAL PROVISIONS.
 - 6) SEE SPECIAL PROVISIONS AND DETAILS REGARDING SIGNS TO BE FURNISHED AND INSTALLED BY CONTRACTOR (INCLUDED AS PART OF PAY ITEM FOR "TRAFFIC CONTROL SIGNAL SYSTEM B").
 - 7) EACH PEDESTRIAN INDICATION SHALL BE ONE SECTION LED FILLED COUNTDOWN TIMER "HAND/WALKING PERSON" INDICATION.
 - 8) EACH SIGNAL FACE SHALL HAVE A BACKGROUND SHIELD.
 - 9) SEE DETAILS, SPECIAL PROVISIONS & STATEMENT OF ESTIMATED QUANTITIES REGARDING BATTERY BACK-UP SIGNAL SERVICE CABINET TO BE FURNISHED AND INSTALLED BY CONTRACTOR (SEPARATE FROM ITEM NO. 2565 FOR THIS SIGNAL SYSTEM).
 - 10) LOOP DETECTOR WIRES SHALL BE CROSS-LINKED POLYETHYLENE (XLP) IN 3/4" N.M.C. SEE SPECIAL PROVISIONS.
 - 11) (*) DENOTES ITEMS TO BE INCLUDED AS PART OF THE PAY ITEM FOR ITEM NO. 2565 (EMERGENCY VEHICLE PREEMPTION SYSTEM "B"). SEE STATEMENT OF ESTIMATED AND SPECIAL PROVISIONS.
 - 12) (**) DENOTES ITEMS TO BE FURNISHED AND INSTALLED BY THE CONTRACTOR UNDER ITEM NO. 2565 (TRAFFIC CONTROL INTERCONNECT "A"). SEE STATEMENT OF ESTIMATED QUANTITIES AND SPECIAL PROVISIONS.
 - 13) THE CONTRACTOR SHALL REMOVE, SALVAGE AND DISPOSE OF ALL ITEMS OF EXISTING PERMANENT SIGNAL SYSTEM IN ACCORDANCE WITH THE PLANS AND SPECIAL PROVISIONS (TO BE MEASURED AND PAID FOR SEPARATELY).

LED SIGNAL FACES
ALL SIGNAL INDICATIONS SHALL BE 12"

SIGNAL FACE	R	Y	FYA	G
2-1, 2-2, 2-3	●	●	●	●
4-1, 4-2, 4-3	●	●	●	●
5-1, 5-2	←	←	←	←
6-1, 6-2, 6-3	●	●	●	●

FYA = FLASHING YELLOW ARROW.

SEE NEXT SHEET FOR EQUIPMENT PAD NOTES AND DETAILED POLE NOTES

CONTRACTOR SHALL FURNISH, INSTALL, COIL AND STORE 25' OF 1-2/c#14 IN HANDHOLE 1 (FOR FUTURE PUSH BUTTON INSTALLATION BY OTHERS).

DRAWN BY: LC/JMG	NO.	BY	DATE	REVISIONS
DESIGNER: JMG				
CHECKED BY: JMG				
DESIGN TEAM				

I HEREBY CERTIFY THAT THIS PLAN WAS PREPARED BY ME OR UNDER MY DIRECT SUPERVISION AND THAT I AM A DULY LICENSED PROFESSIONAL ENGINEER UNDER THE LAWS OF THE STATE OF MINNESOTA.

John M. Gray
Name: John M. Gray, PE
Lic. No. 22457
Date: February 19, 2016

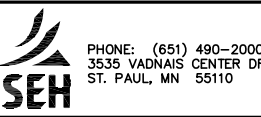

ANOKA COUNTY
CITY OF ANDOVER

TRAFFIC CONTROL SIGNAL SYSTEM 'B'
INTERSECTION LAYOUT
CSAH 116 AT PRAIRIE ROAD NW

FILE NO. ANOKC 132658
356
SIGNAL SHEET 482
15 OF 32

S.P. 002-716-015

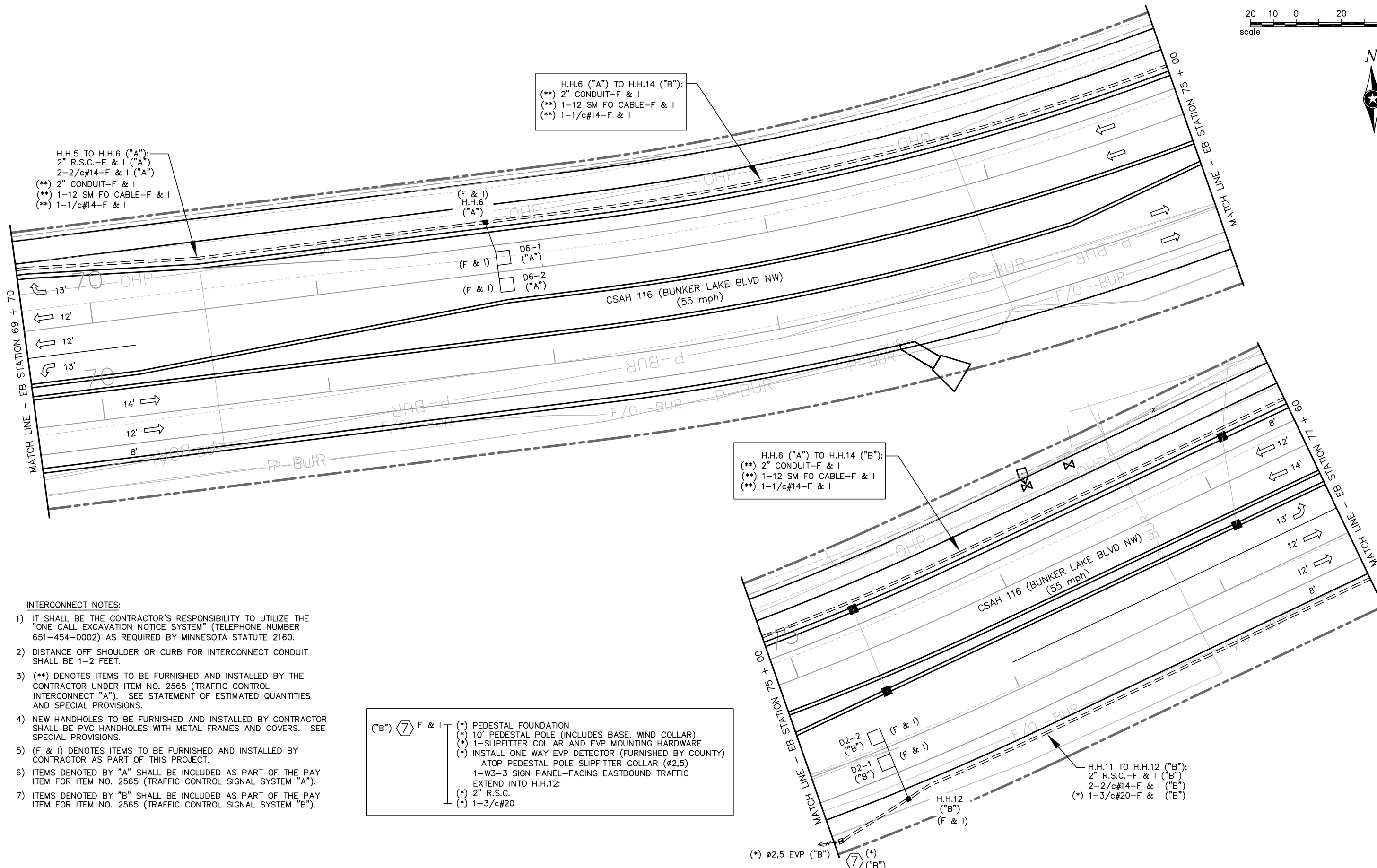
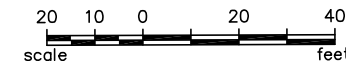

INTERCONNECT NOTES:

- 1) IT SHALL BE THE CONTRACTOR'S RESPONSIBILITY TO UTILIZE THE "ONE CALL EXCAVATION NOTICE SYSTEM" (TELEPHONE NUMBER 651-454-0002) AS REQUIRED BY MINNESOTA STATUTE 2160.
- 2) DISTANCE OFF SHOULDER OR CURB FOR INTERCONNECT CONDUIT SHALL BE 1-2 FEET.
- 3) (**) DENOTES ITEMS TO BE FURNISHED AND INSTALLED BY THE CONTRACTOR UNDER ITEM NO. 2565 (TRAFFIC CONTROL INTERCONNECT "A"). SEE STATEMENT OF ESTIMATED QUANTITIES AND SPECIAL PROVISIONS.
- 4) NEW HANDHOLES TO BE FURNISHED AND INSTALLED BY CONTRACTOR SHALL BE PVC HANDHOLES WITH METAL FRAMES AND COVERS. SEE SPECIAL PROVISIONS.
- 5) (F & I) DENOTES ITEMS TO BE FURNISHED AND INSTALLED BY CONTRACTOR AS PART OF THIS PROJECT.
- 6) ITEMS DENOTED BY "A" SHALL BE INCLUDED AS PART OF THE PAY ITEM FOR ITEM NO. 2565 (TRAFFIC CONTROL SIGNAL SYSTEM "A").
- 7) ITEMS DENOTED BY "B" SHALL BE INCLUDED AS PART OF THE PAY ITEM FOR ITEM NO. 2565 (TRAFFIC CONTROL SIGNAL SYSTEM "B").

(*) PEDESTAL FOUNDATION
 (*) 10' PEDESTAL POLE (INCLUDES BASE, WIND COLLAR)
 (*) 1-SLIPFITTER COLLAR AND EVP MOUNTING HARDWARE
 (*) INSTALL ONE WAY EVP DETECTOR (FURNISHED BY COUNTY)
 ATOP PEDESTAL POLE SLIPFITTER COLLAR (Ø2,5)
 1-W3-3 SIGN PANEL-FACING EASTBOUND TRAFFIC
 EXTEND INTO H.H.12:
 (*) 2" R.S.C.
 (*) 1-3/c#20

DRAWN BY: LC/JMG				
DESIGNER: JMG				
CHECKED BY: JMG				
DESIGN TEAM	NO.	BY	DATE	REVISIONS

HEREBY CERTIFY THAT THIS PLAN WAS PREPARED BY ME OR UNDER MY DIRECT SUPERVISION AND THAT I AM A DULY LICENSED PROFESSIONAL ENGINEER UNDER THE LAWS OF THE STATE OF MINNESOTA.

John M. Gray
 Name: John M. Gray, PE
 Lic. No. 22457
 Date: February 19, 2016

SEH
 PHONE: (651) 490-2000
 3535 VADNAIS CENTER DR.
 ST. PAUL, MN 55110

ANOKA COUNTY
 CITY OF ANDOVER

TRAFFIC CONTROL SIGNAL SYSTEMS 'A-B'
 INTERSECTION LAYOUT
 CSAH 116 (SYCAMORE ST TO PRAIRIE ROAD)

S.P. 002-716-015
 FILE NO. ANOKC 132658
 SIGNAL SHEET 14 OF 32
355
482

- (*) PEDESTAL FOUNDATION
 (*) 10' PEDESTAL POLE (INCLUDES BASE, WIND COLLAR)
 (*) 1-SLIPFITTER COLLAR AND EVP MOUNTING HARDWARE
 (*) INSTALL ONE WAY EVP DETECTOR (FURNISHED BY COUNTY)
 ATOP PEDESTAL POLE SLIPFITTER COLLAR (#6)
 1-W3-3 SIGN PANEL-FACING WESTBOUND TRAFFIC
 EXTEND INTO H.H.7:
 (*) 2" R.S.C.
 (*) 1-3/c#20

NOTE SCALE CHANGE FROM OTHER PLAN SHEETS.



MATCH LINE - EB STATION 83 + 75

MATCH LINE - EB STATION 93 + 50

- H.H.5 TO H.H.6 ("B"):
 2" R.S.C.-F & I ("B")
 2-2/c#14-F & I ("B")
 (*) 1-3/c#20-F & I ("B")
 (**) 2" CONDUIT-F & I
 (**) 1-12 SM FO CABLE-F & I
 (**) 1-1/c#14-F & I

- H.H.6 TO H.H.7 ("B"):
 (*) 2" R.S.C.-F & I ("B")
 (*) 1-3/c#20-F & I ("B")
 (**) 2" CONDUIT-F & I
 (**) 1-12 SM FO CABLE-F & I
 (**) 1-1/c#14-F & I

- H.H.7 ("B") TO H.H.153:
 (**) 2" CONDUIT-F & I
 (**) 1-12 SM FO CABLE-F & I
 (**) 1-1/c#14-F & I

INTERCONNECT NOTES:

- 1) IT SHALL BE THE CONTRACTOR'S RESPONSIBILITY TO UTILIZE THE "ONE CALL EXCAVATION NOTICE SYSTEM" (TELEPHONE NUMBER 651-454-0002) AS REQUIRED BY MINNESOTA STATUTE 2160.
- 2) DISTANCE OFF SHOULDER OR CURB FOR INTERCONNECT CONDUIT SHALL BE 1-2 FEET.
- 3) (**) DENOTES ITEMS TO BE FURNISHED AND INSTALLED BY THE CONTRACTOR UNDER ITEM NO. 2565 (TRAFFIC CONTROL INTERCONNECT "A"). SEE STATEMENT OF ESTIMATED QUANTITIES AND SPECIAL PROVISIONS.
- 4) NEW HANDHOLES TO BE FURNISHED AND INSTALLED BY CONTRACTOR SHALL BE PVC HANDHOLES WITH METAL FRAMES AND COVERS. SEE SPECIAL PROVISIONS.
- 5) (F & I) DENOTES ITEMS TO BE FURNISHED AND INSTALLED BY CONTRACTOR AS PART OF THIS PROJECT.
- 6) ITEMS DENOTED BY "B" SHALL BE INCLUDED AS PART OF THE PAY ITEM FOR ITEM NO. 2565 (TRAFFIC CONTROL SIGNAL SYSTEM "B").

DRAWN BY: LC/JMG
 DESIGNER: JMG
 CHECKED BY: JMG

DESIGN TEAM	NO.	BY	DATE	REVISIONS

I HEREBY CERTIFY THAT THIS PLAN WAS PREPARED BY ME OR UNDER MY DIRECT SUPERVISION AND THAT I AM A DULY LICENSED PROFESSIONAL ENGINEER UNDER THE LAWS OF THE STATE OF MINNESOTA.

John M. Gray
 Name: John M. Gray, PE
 Lic. No. 22457
 Date: February 19, 2016

SEH
 PHONE: (651) 490-2000
 3535 VADNAIS CENTER DR.
 ST. PAUL, MN 55110

ANOKA COUNTY
 CITY OF ANDOVER

TRAFFIC SIGNAL SYSTEM "B"/INTERCONNECT
INTERSECTION LAYOUT
 CSAH 116 (PRAIRIE RD TO GOLDENROD ST)

FILE NO. ANOKC 132658
359
 SIGNAL SHEET
 18 OF 32
482

S.P. 002-716-015

NOTE SCALE CHANGE FROM OTHER PLAN SHEETS.

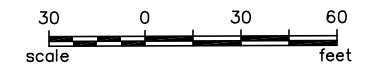

INTERCONNECT NOTES:

- 1) IT SHALL BE THE CONTRACTOR'S RESPONSIBILITY TO UTILIZE THE "ONE CALL EXCAVATION NOTICE SYSTEM" (TELEPHONE NUMBER 651-454-0002) AS REQUIRED BY MINNESOTA STATUTE 2160.
- 2) DISTANCE OFF SHOULDER OR CURB FOR INTERCONNECT CONDUIT SHALL BE 1-2 FEET.
- 3) (**) DENOTES ITEMS TO BE FURNISHED AND INSTALLED BY THE CONTRACTOR UNDER ITEM NO. 2565 (TRAFFIC CONTROL INTERCONNECT "A"). SEE STATEMENT OF ESTIMATED QUANTITIES AND SPECIAL PROVISIONS.
- 4) NEW HANDHOLES TO BE FURNISHED AND INSTALLED BY CONTRACTOR SHALL BE PVC HANDHOLES WITH METAL FRAMES AND COVERS. SEE SPECIAL PROVISIONS.
- 5) (F & I) DENOTES ITEMS TO BE FURNISHED AND INSTALLED BY CONTRACTOR AS PART OF THIS PROJECT.
- 6) ITEMS DENOTED BY "B" SHALL BE INCLUDED AS PART OF THE PAY ITEM FOR ITEM NO. 2565 (TRAFFIC CONTROL SIGNAL SYSTEM "B").

H.H.7 ("B") TO H.H.153:
 H.H.153 TO H.H.154:
 (**) 2" CONDUIT-F & I
 (**) 1-12 SM FO CABLE-F & I
 (**) 1-1/c#14-F & I

(**) H.H.153
 (F & I)

H.H.153 TO H.H.154:
 (**) 2" CONDUIT-F & I
 (**) 1-12 SM FO CABLE-F & I
 (**) 1-1/c#14-F & I

(**) H.H.154
 (F & I)

H.H.154 TO H.H.155:
 (**) 2" CONDUIT-F & I
 (**) 1-12 SM FO CABLE-F & I
 (**) 1-1/c#14-F & I

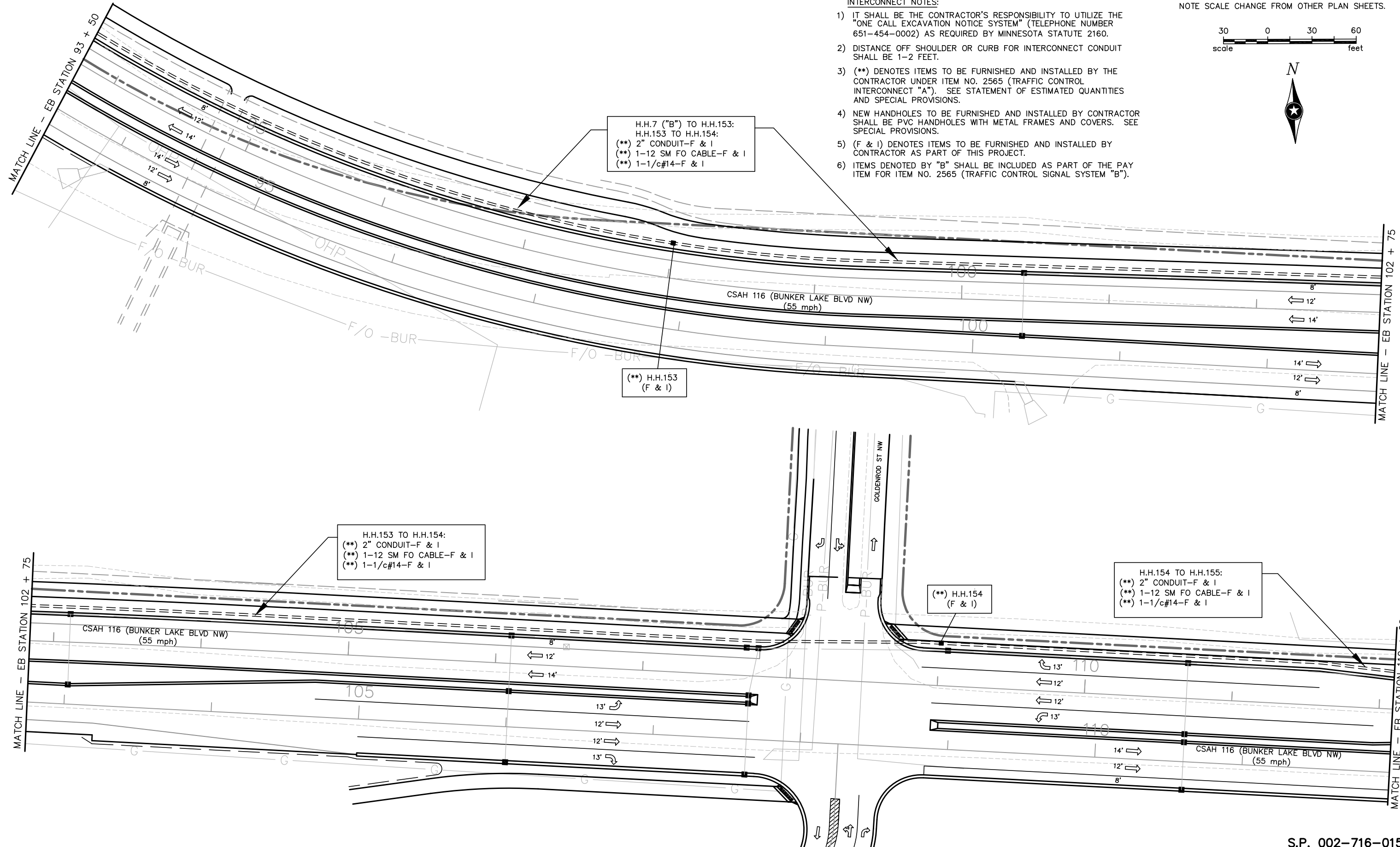

DRAWN BY: LC/JMG				
DESIGNER: JMG				
CHECKED BY: JMG				
DESIGN TEAM	NO.	BY	DATE	REVISIONS

I HEREBY CERTIFY THAT THIS PLAN WAS PREPARED BY ME OR UNDER MY DIRECT SUPERVISION AND THAT I AM A DULY LICENSED PROFESSIONAL ENGINEER UNDER THE LAWS OF THE STATE OF MINNESOTA.

John M. Gray
 Name: John M. Gray, PE
 Lic. No. 22457
 Date: February 19, 2016

SEH
 PHONE: (651) 490-2000
 3535 VADNAIS CENTER DR.
 ST. PAUL, MN 55110

ANOKA COUNTY
 CITY OF ANDOVER

TRAFFIC CONTROL INTERCONNECT
INTERSECTION LAYOUT
 CSAH 116 (PRAIRIE RD TO BUTTERNUT ST)

FILE NO. ANOKC 132658
 SIGNAL SHEET 19 OF 32
360
482

S.P. 002-716-015

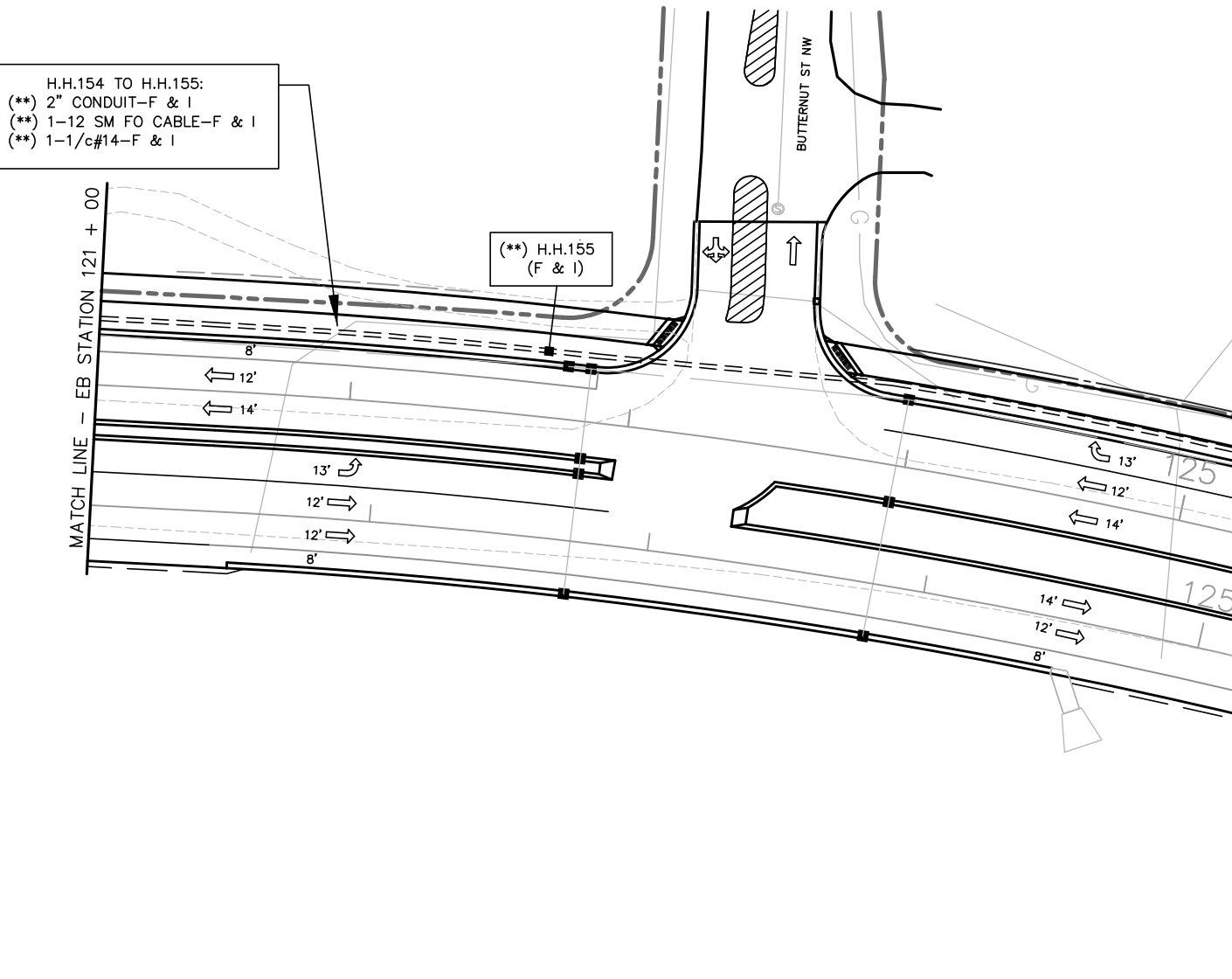
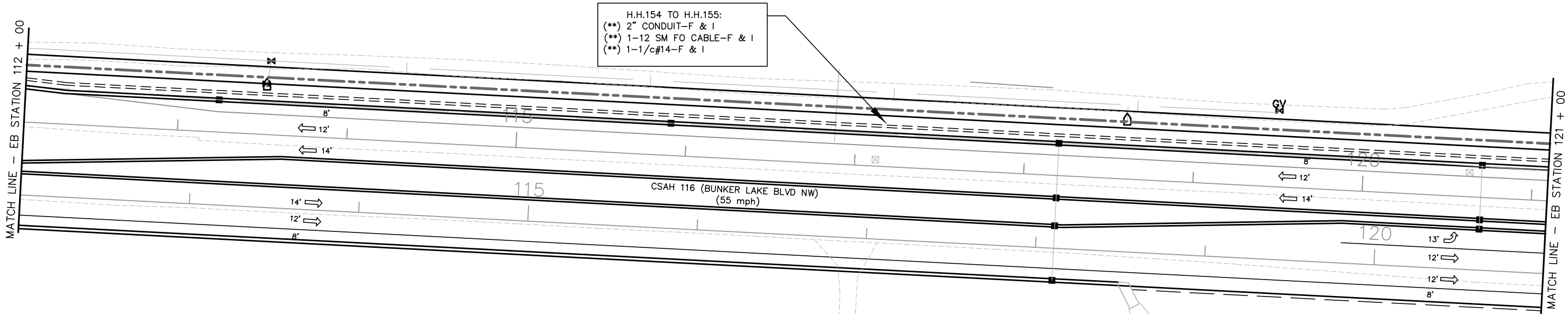

- INTERCONNECT NOTES:**
- 1) IT SHALL BE THE CONTRACTOR'S RESPONSIBILITY TO UTILIZE THE "ONE CALL EXCAVATION NOTICE SYSTEM" (TELEPHONE NUMBER 651-454-0002) AS REQUIRED BY MINNESOTA STATUTE 2160.
 - 2) DISTANCE OFF SHOULDER OR CURB FOR INTERCONNECT CONDUIT SHALL BE 1-2 FEET.
 - 3) (**) DENOTES ITEMS TO BE FURNISHED AND INSTALLED BY THE CONTRACTOR UNDER ITEM NO. 2565 (TRAFFIC CONTROL INTERCONNECT "A"). SEE STATEMENT OF ESTIMATED QUANTITIES AND SPECIAL PROVISIONS.
 - 4) NEW HANDHOLES TO BE FURNISHED AND INSTALLED BY CONTRACTOR SHALL BE PVC HANDHOLES WITH METAL FRAMES AND COVERS. SEE SPECIAL PROVISIONS.
 - 5) (F & I) DENOTES ITEMS TO BE FURNISHED AND INSTALLED BY CONTRACTOR AS PART OF THIS PROJECT.

NOTE SCALE CHANGE FROM OTHER PLAN SHEETS.

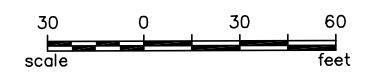

H.H.155 TO H.H.156:
 (** 2" CONDUIT-F & I
 (** 1-12 SM FO CABLE-F & I
 (** 1-1/c#14-F & I

DRAWN BY: LC/JMG
 DESIGNER: JMG
 CHECKED BY: JMG

DESIGN TEAM	NO.	BY	DATE	REVISIONS

I HEREBY CERTIFY THAT THIS PLAN WAS PREPARED BY ME OR UNDER MY DIRECT SUPERVISION AND THAT I AM A DULY LICENSED PROFESSIONAL ENGINEER UNDER THE LAWS OF THE STATE OF MINNESOTA.

John M. Gray
 Name: John M. Gray, PE
 Lic. No. 22457
 Date: February 19, 2016

SEH
 PHONE: (651) 490-2000
 3535 VADNAIS CENTER DR.
 ST. PAUL, MN 55110

ANOKA COUNTY
 CITY OF ANDOVER

TRAFFIC CONTROL INTERCONNECT
INTERSECTION LAYOUT
 CSAH 116 (GOLDENROD ST TO JEFFERSON ST)

FILE NO. ANOKC 132658
 SIGNAL SHEET 20 OF 32
361
482

S.P. 002-716-015

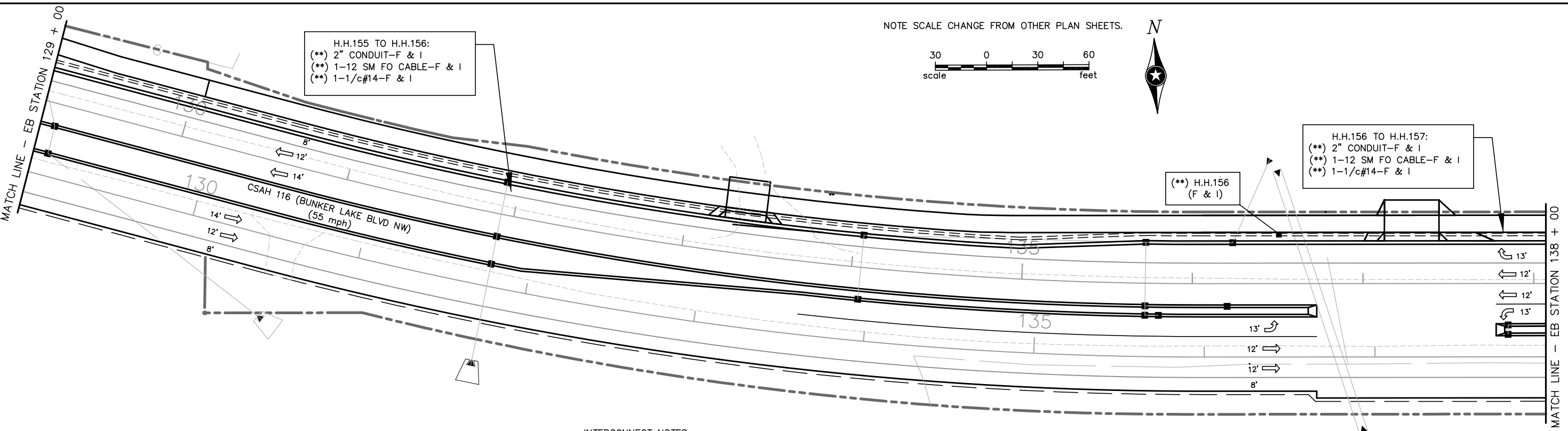

NOTE SCALE CHANGE FROM OTHER PLAN SHEETS.

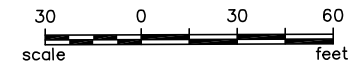

H.H.155 TO H.H.156:
 (**) 2" CONDUIT-F & I
 (**) 1-12 SM FO CABLE-F & I
 (**) 1-1/c#14-F & I

H.H.156 TO H.H.157:
 (**) 2" CONDUIT-F & I
 (**) 1-12 SM FO CABLE-F & I
 (**) 1-1/c#14-F & I

(**) H.H.156
 (F & I)

INTERCONNECT NOTES:

- 1) IT SHALL BE THE CONTRACTOR'S RESPONSIBILITY TO UTILIZE THE "ONE CALL EXCAVATION NOTICE SYSTEM" (TELEPHONE NUMBER 651-454-0002) AS REQUIRED BY MINNESOTA STATUTE 2160.
- 2) DISTANCE OFF SHOULDER OR CURB FOR INTERCONNECT CONDUIT SHALL BE 1-2 FEET.
- 3) (**) DENOTES ITEMS TO BE FURNISHED AND INSTALLED BY THE CONTRACTOR UNDER ITEM NO. 2565 (TRAFFIC CONTROL INTERCONNECT "A"). SEE STATEMENT OF ESTIMATED QUANTITIES AND SPECIAL PROVISIONS.
- 4) NEW HANDHOLES TO BE FURNISHED AND INSTALLED BY CONTRACTOR SHALL BE PVC HANDHOLES WITH METAL FRAMES AND COVERS. SEE SPECIAL PROVISIONS.
- 5) (F & I) DENOTES ITEMS TO BE FURNISHED AND INSTALLED BY CONTRACTOR AS PART OF THIS PROJECT.

H.H.156 TO H.H.157:
 (**) 2" CONDUIT-F & I
 (**) 1-12 SM FO CABLE-F & I
 (**) 1-1/c#14-F & I

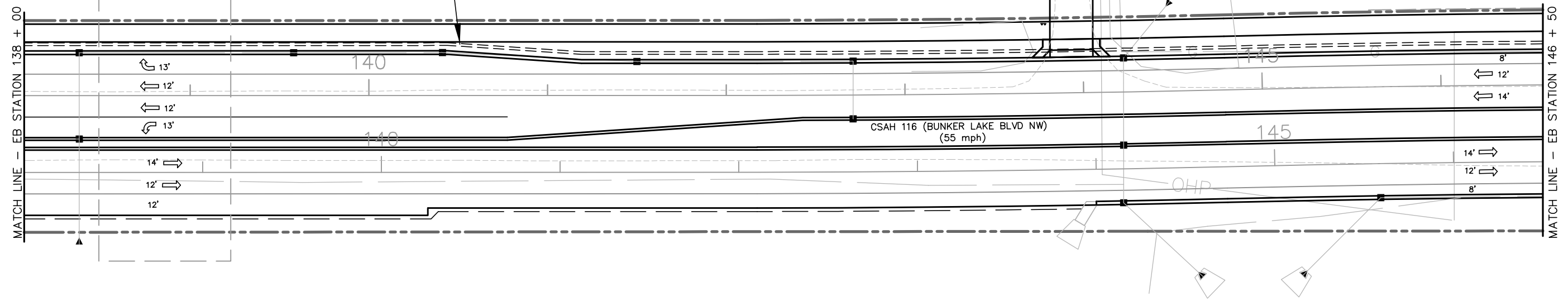

DRAWN BY: LC/JMG
 DESIGNER: JMG
 CHECKED BY: JMG
 DESIGN TEAM

NO.	BY	DATE	REVISIONS

I HEREBY CERTIFY THAT THIS PLAN WAS PREPARED BY ME OR UNDER MY DIRECT SUPERVISION AND THAT I AM A DULY LICENSED PROFESSIONAL ENGINEER UNDER THE LAWS OF THE STATE OF MINNESOTA.
 Date: February 19, 2016 Name: John M. Gray, PE Lic. No. 22457

SEH
 PHONE: (651) 490-2000
 3535 VADNAIS CENTER DR.
 ST. PAUL, MN 55110

ANOKA COUNTY
 CITY OF ANDOVER

**TRAFFIC CONTROL INTERCONNECT
 INTERSECTION LAYOUT**
 CSAH 116 (BUTTERNUT ST TO JEFFERSON ST)

FILE NO. ANOKC 132658
 SIGNAL SHEET 21 OF 32
362
482

S.P. 002-716-015

NOTE SCALE CHANGE FROM OTHER PLAN SHEETS.

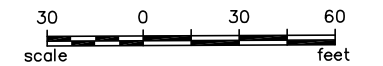

INTERCONNECT NOTES:

- 1) IT SHALL BE THE CONTRACTOR'S RESPONSIBILITY TO UTILIZE THE "ONE CALL EXCAVATION NOTICE SYSTEM" (TELEPHONE NUMBER 651-454-0002) AS REQUIRED BY MINNESOTA STATUTE 2160.
- 2) DISTANCE OFF SHOULDER OR CURB FOR INTERCONNECT CONDUIT SHALL BE 1-2 FEET.
- 3) (**) DENOTES ITEMS TO BE FURNISHED AND INSTALLED BY THE CONTRACTOR UNDER ITEM NO. 2565 (TRAFFIC CONTROL INTERCONNECT "A"). SEE STATEMENT OF ESTIMATED QUANTITIES AND SPECIAL PROVISIONS.
- 4) NEW HANDHOLES TO BE FURNISHED AND INSTALLED BY CONTRACTOR SHALL BE PVC HANDHOLES WITH METAL FRAMES AND COVERS. SEE SPECIAL PROVISIONS.
- 5) (F & I) DENOTES ITEMS TO BE FURNISHED AND INSTALLED BY CONTRACTOR AS PART OF THIS PROJECT.
- 6) ITEMS DENOTED BY "C" SHALL BE INCLUDED AS PART OF THE PAY ITEM FOR ITEM NO. 2565 (TRAFFIC CONTROL SIGNAL SYSTEM "C").

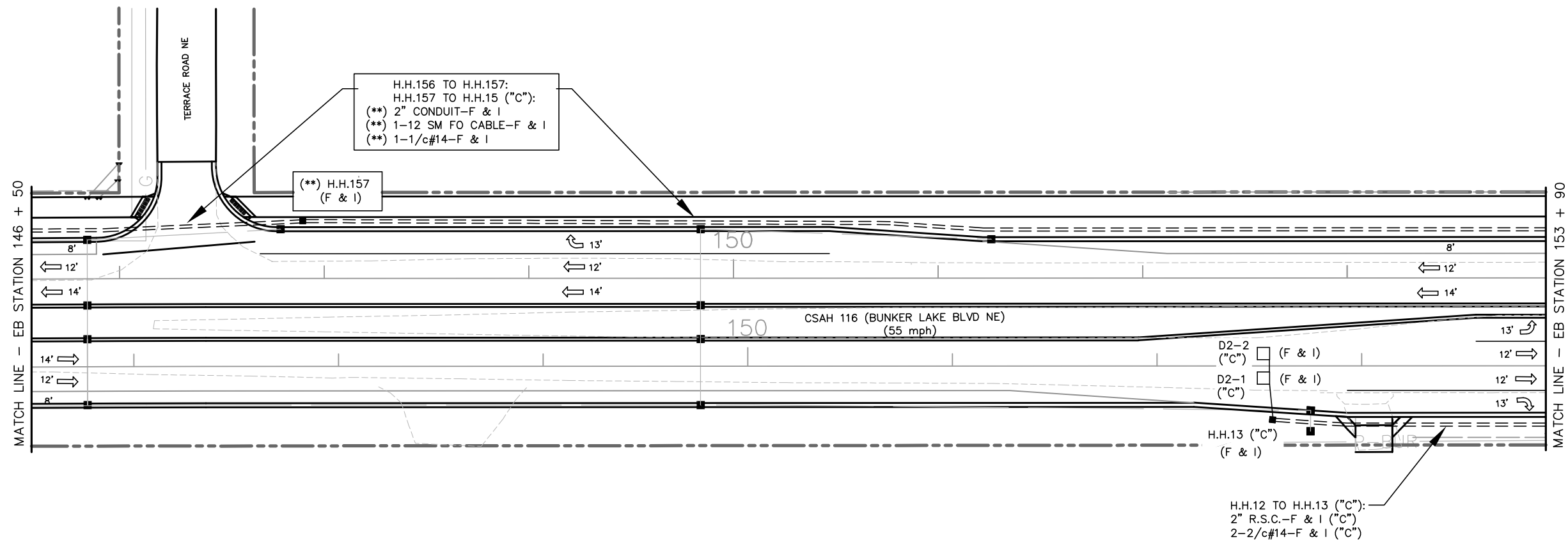

DRAWN BY: LC/JMG									
DESIGNER: JMG									
CHECKED BY: JMG									
DESIGN TEAM	NO.	BY	DATE	REVISIONS					

I HEREBY CERTIFY THAT THIS PLAN WAS PREPARED BY ME OR UNDER MY DIRECT SUPERVISION AND THAT I AM A DULY LICENSED PROFESSIONAL ENGINEER UNDER THE LAWS OF THE STATE OF MINNESOTA.

Name: John M. Gray, PE
 Lic. No. 22457
 Date: February 19, 2016

PHONE: (651) 490-2000
 3535 VADNAIS CENTER DR.
 ST. PAUL, MN 55110

ANOKA COUNTY
 CITY OF ANDOVER

TRAFFIC SIGNAL SYSTEM 'C'/INTERCONNECT
INTERSECTION LAYOUT
 CSAH 116 (BUTTERNUT ST TO JEFFERSON ST)

FILE NO. ANOKC 132658
 SIGNAL SHEET 22 OF 32
363
482

S.P. 002-716-015

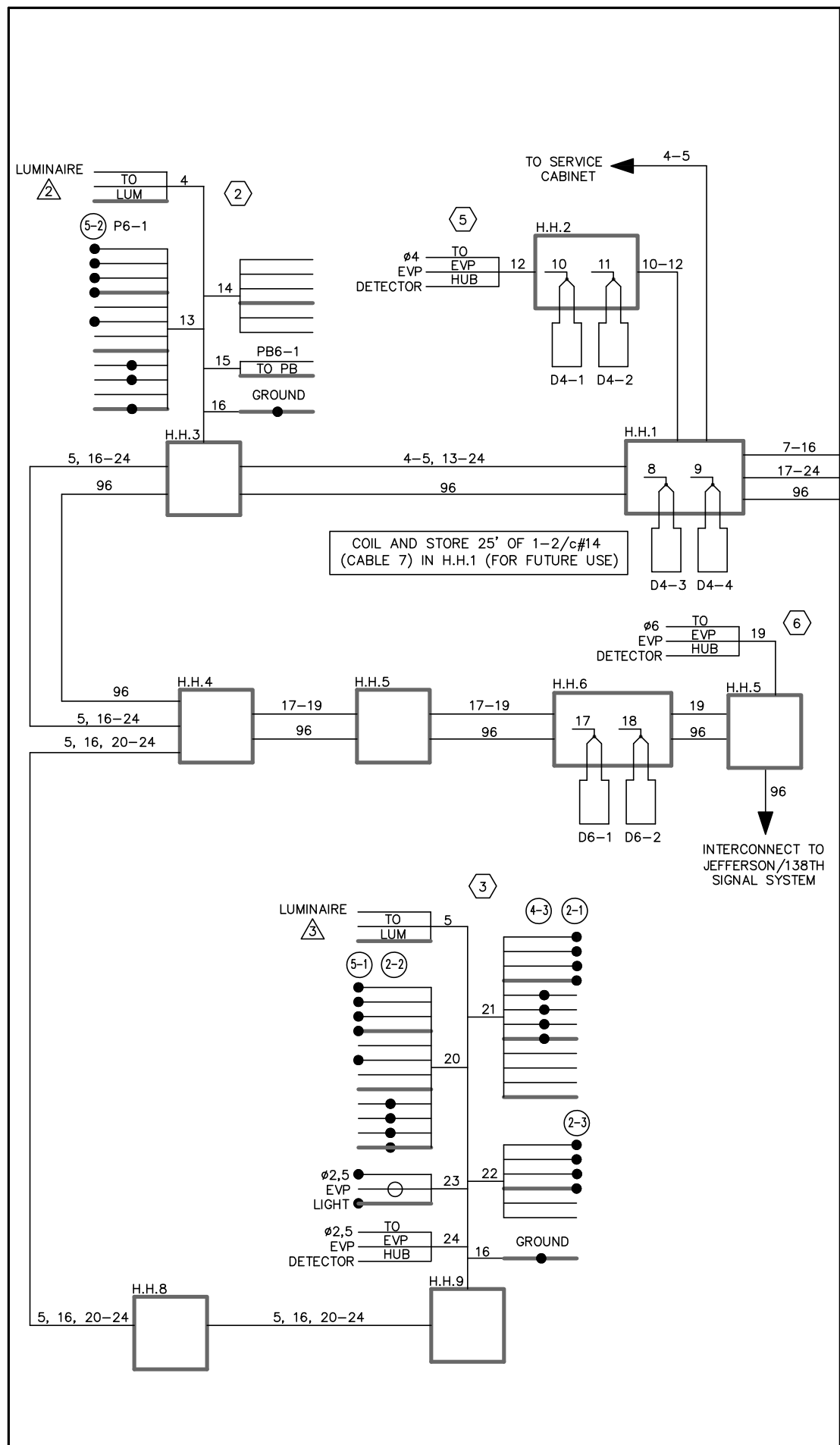

CONTROLLER AND CABINET

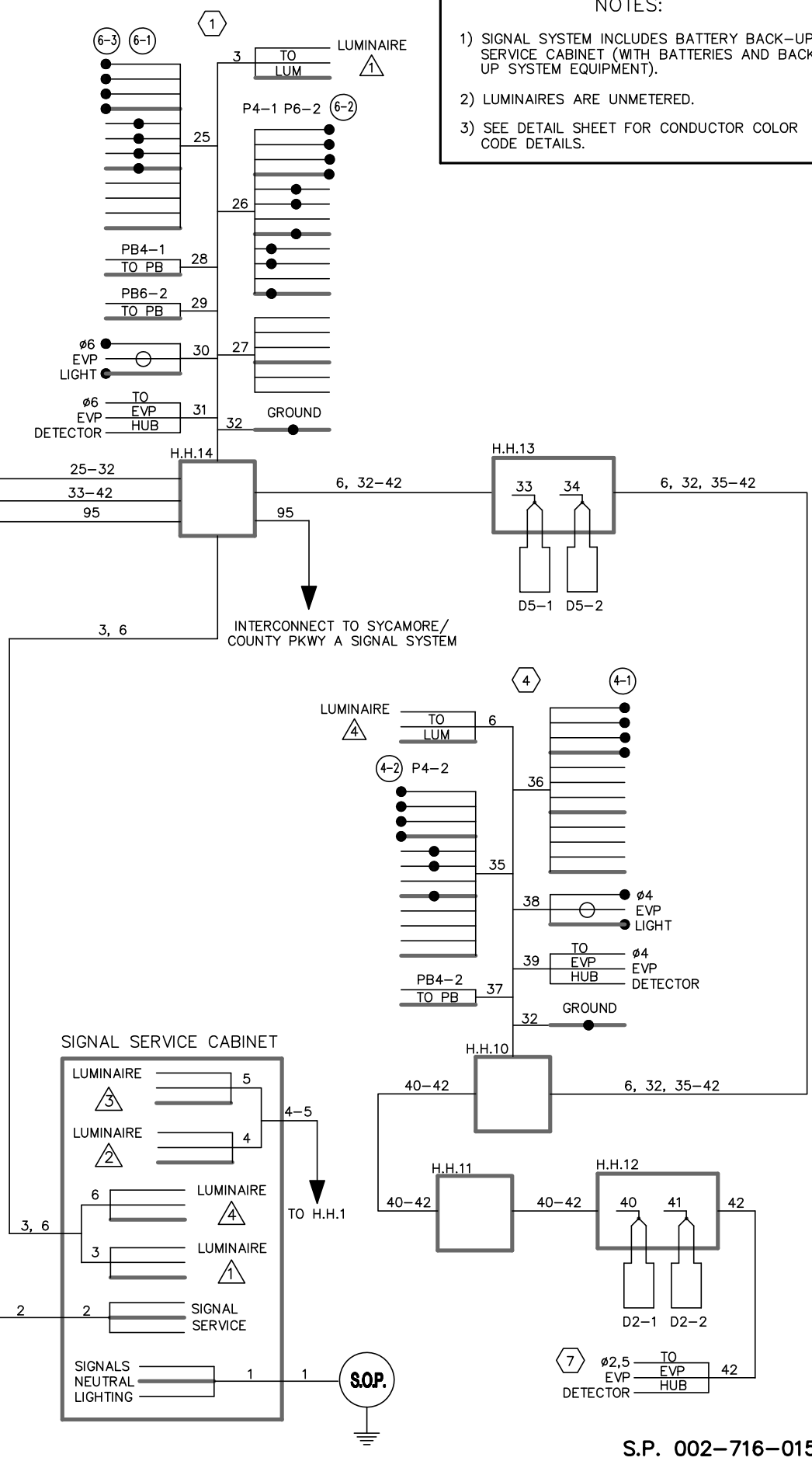
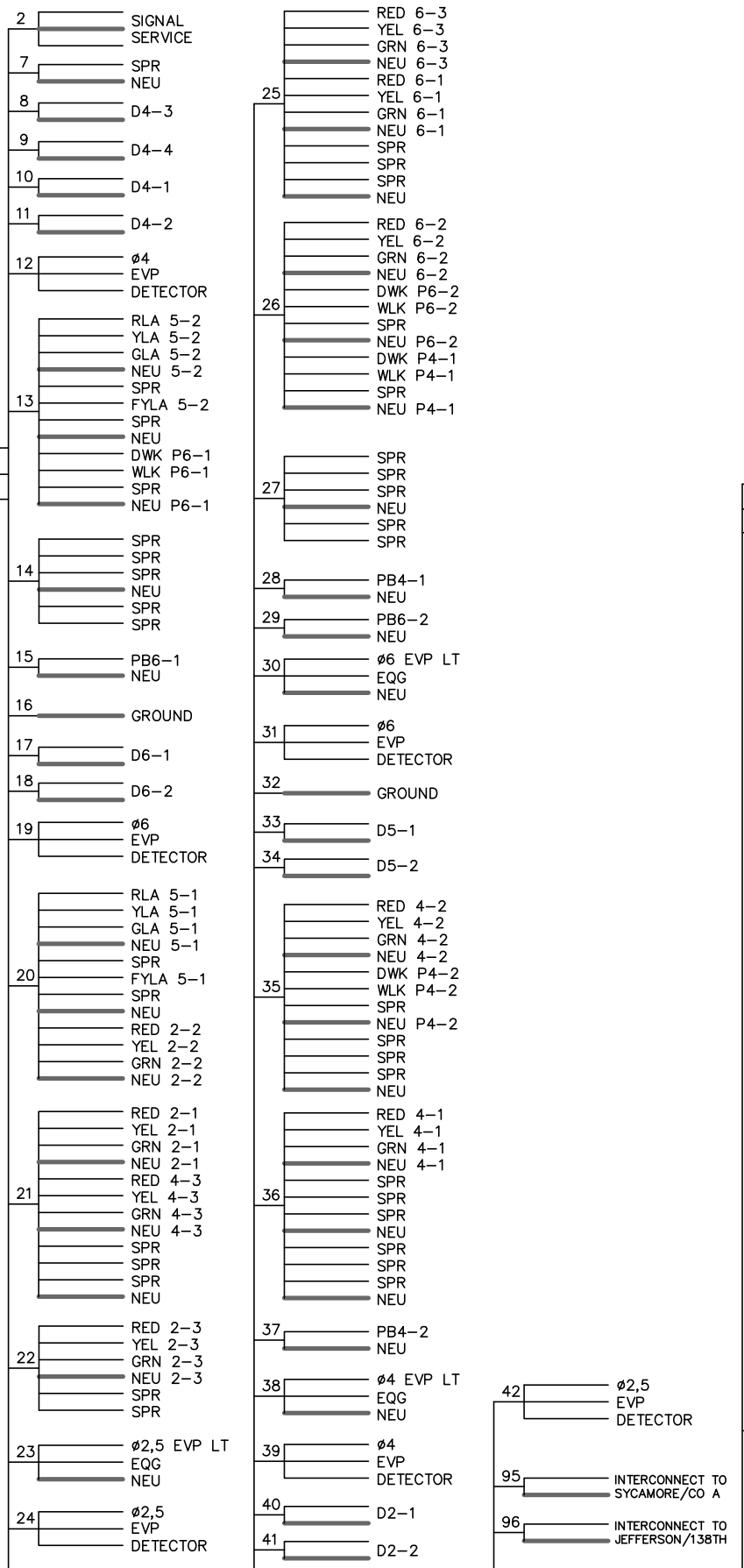

- NOTES:
- 1) SIGNAL SYSTEM INCLUDES BATTERY BACK-UP SERVICE CABINET (WITH BATTERIES AND BACK UP SYSTEM EQUIPMENT).
 - 2) LUMINAIRES ARE UNMETERED.
 - 3) SEE DETAIL SHEET FOR CONDUCTOR COLOR CODE DETAILS.

DRAWN BY: JMG	DESIGNER: JMG	CHECKED BY: JMG
DESIGN TEAM	NO. BY DATE	REVISIONS

HEREBY CERTIFY THAT THIS PLAN WAS PREPARED BY ME OR UNDER MY DIRECT SUPERVISION AND THAT I AM A DULY LICENSED PROFESSIONAL ENGINEER UNDER THE LAWS OF THE STATE OF MINNESOTA.

Date: February 19, 2016 Name: John M. Gray, PE Lic. No. 22457

SEH PHONE: (651) 490-2000 3535 VADNAIS CENTER DR. ST. PAUL, MN 55110

ANOKA COUNTY CITY OF ANDOVER

TRAFFIC CONTROL SIGNAL SYSTEM 'B' FIELD WIRING DIAGRAM CSAH 116 AT PRAIRIE ROAD NW

FILE NO. ANOKC 132658 358 SIGNAL SHEET 17 OF 32 482

S.P. 002-716-015