



PVC LOOP DETECTORS				
NUMBER	SIZE (FT)	LOCATION	FUNCTION	STATUS
D1-1	2-8 x 6	10' & 40'	1	1
D1-2	2-8 x 6	-5' & 25'	1	2
D2-1, D2-2	6 x 6	400'	1	INPLACE
D3-1	2-8 x 6	5' & 35'	1	INPLACE
D3-2	2-8 x 6	-5' & 20'	1	INPLACE
D4-1	6 x 6	120'	3, 8	INPLACE
D4-2	2-8 x 6	-5' & 5'	7	INPLACE
D4-3	2-6 x 6	5' & 20'	7	INPLACE
D5-1	2-6 x 6	10' & 40'	1	1
D5-2	2-6 x 6	-5' & 25'	1	2
D6-1, D6-2	6 x 6	400'	1	INPLACE
D7-1	2-8 x 6	5' & 35'	1	INPLACE
D7-2	2-8 x 6	-5' & 20'	1	INPLACE
D8-1	6 x 6	120'	3, 8	INPLACE
D8-2	2-8 x 6	-5' & 5'	7	INPLACE
D8-3	2-6 x 6	5' & 20'	7	INPLACE
SD-1, SD-2	6 x 6	-165'	11	INPLACE
SD-3, SD-4	6 x 6	-165'	11	INPLACE

- FUNCTIONS:
 1) CALL & EXTEND
 3) EXTEND ONLY
 7) DELAYED CALL, IMMEDIATE EXTEND
 8) DENSITY ONLY
 11) SYSTEM (VOLUME)

NOTE: LOCATION = DISTANCE FROM STOP BAR TO FRONT OF LOOP DETECTOR.

LOOP DETECTOR STATUS:
 1 = DETACH EXISTING FRONT (10') LOOP DETECTOR FROM EXISTING LEAD-IN CABLE AND SPLICE TO EXISTING BACK (40') LOOP DETECTOR AND BACK LEAD-IN CABLE (F & I NEW SPLICE KIT). PROTECT EXISTING 10'/40' LOOP DETECTORS IN ROADWAY.
 2 = FURNISH & INSTALL NEW PVC LOOP DETECTORS AT -5' AND 25' FROM STOP BAR. SPLICE THESE NEW LOOP DETECTORS TO EXISTING FRONT LEAD-IN CABLE (F & I NEW SPLICE KIT).

NOTE: WHEN INSTALLING NEW LOOP DETECTORS D1-2 AND D5-2, ENSURE THAT ALL EXISTING LOOP DETECTOR ROADWAY CONDUITS (TO D1-1 AND D5-1) ARE EXACTLY LOCATED AND PROTECTED DURING NEW LOOP INSTALLATION. ANY DAMAGE TO THESE EXISTING LOOP DETECTORS (ALL CONDUITS, WIRING, SPLICE KITS) DUE TO CONTRACTOR LOOP DETECTOR INSTALLATION WORK WILL REQUIRE THE CONTRACTOR TO FULLY REPLACE THE DAMAGED PVC LOOP DETECTORS ALL AT NO EXPENSE TO THE COUNTY.

CONTROLLER PHASING, PEDESTRIAN INDICATIONS AND PUSH BUTTONS

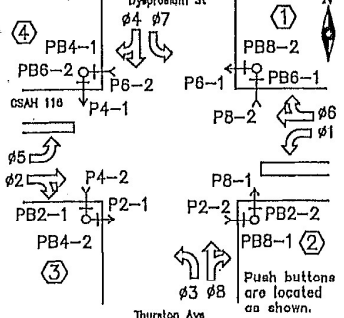

SIGNAL SYSTEM OPERATIONS:
 - SIGNAL SYSTEM FLASH MODE IS ALL RED.
 - NORMAL OPERATION IS 8 PHASE, WITH PHASES 1 & 5 BEING REVISED FROM PROTECTED LEFT TURNS TO FLASHING YELLOW ARROW OPERATIONS, AND PHASES 3 & 7 BEING REVISED FROM PROTECTED/PERMISSIVE LEFT TURNS TO FLASHING YELLOW ARROW OPERATIONS (FLASH BY TIME OF DAY PROGRAMS).
 - VEHICLE SIGNAL PHASES 2 & 6 OPERATE ON RECALL.

INPLACE (MAINTAIN INPLACE)
 CABINET FOUNDATION
 SIGNAL SERVICE CABINET
 EXTENDED INTO H.H.19:
 2" R.S.C.
 METERED SIGNAL SERVICE
 3-1/c#8
 METERED STREET LIGHT SERVICE
 4-3/c#12 (LUM)
 BETWEEN H.H.1 AND H.H.19:
 2" R.S.C.
 2-3/c#12 (LUM)
 BETWEEN H.H.18 AND H.H.19:
 2" R.S.C.
 2-3/c#12 (LUM)
 EXTENDED INTO H.H.20:
 2" R.S.C.
 3-1/c#2

SEE NEXT SHEET FOR GENERAL NOTES AND DETAILED POLE NOTES.

STATUS:
 1 = SALVAGE IN-PLACE OVERHEAD 3 SECTION SIGNAL AND F & I NEW OVERHEAD 4-SECTION SIGNAL.
 2 = SALVAGE IN-PLACE OVERHEAD 5 SECTION SIGNAL AND F & I NEW OVERHEAD 4-SECTION SIGNAL.
 3 = SALVAGE IN-PLACE POLE MOUNTED 3 SECTION SIGNAL AND F & I NEW POLE MOUNTED 4-SECTION SIGNAL (ON NEW TYPE 10B BRACKETING).
 4 = SALVAGE IN-PLACE POLE MOUNTED 5 SECTION SIGNAL AND F & I NEW POLE MOUNTED 4-SECTION SIGNAL (ON NEW TYPE 10B BRACKETING).

O = INPLACE LED (REUSE INPLACE).
 ← = F & I NEW LED INDICATION.
 FYA = FLASHING YELLOW ARROW

LED SIGNAL HEADS				
SIGNAL HEAD #	ALL 12" INDICATIONS			STATUS
	R	Y	FYA	
1-1, 5-1	←	←	←	1
1-2, 5-2	←	←	←	3
2-1, 2-2, 2-3	O	O	O	INPLACE
3-1, 7-1	←	←	←	2
3-2, 7-2	←	←	←	4
4-1, 4-2	O	O	O	INPLACE
6-1, 6-2, 6-3	O	O	O	INPLACE
8-1, 8-2	O	O	O	INPLACE

COUNTY PROJ. 16-25-00

DRAWN BY: JMG
 DESIGNER: JMG
 CHECKED BY: JMG

NO.	BY	DATE	REVISIONS

I HEREBY CERTIFY THAT THIS PLAN WAS PREPARED BY ME OR UNDER MY DIRECT SUPERVISION AND THAT I AM A DULY LICENSED PROFESSIONAL ENGINEER UNDER THE LAWS OF THE STATE OF MINNESOTA.
 Date: September 23, 2016 Name: John M. Gray, PE Lic. No. 22487

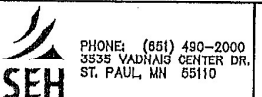

ANOKA COUNTY
 CITIES OF ANOKA AND RAMSEY, MN

REVISE SIGNAL SYSTEM 'F'
 INTERSECTION LAYOUT
 CSAH 116 (BUNKER LAKE BLVD NW)
 AT THURSTON AVENUE/DYSPROSIUM STREET

FILE NO. ANOK 138131
 DATE 09/23/2016
 40
 60

NOTES:

- 1) ALL ITEMS OF THIS SIGNAL SYSTEM ARE INPLACE AND SHALL BE REUSED AND MAINTAINED INPLACE, UNLESS OTHERWISE NOTED ON PLANS.
- 2) ALL HANDHOLES ARE PVC HANDHOLES WITH METAL FRAMES AND COVERS AND ARE INPLACE (REUSE AND MAINTAIN INPLACE).
- 3) CONTRACTOR SHALL REMOVE ALL INPLACE "HAND/WALKING PERSON" LENSES FROM EXISTING ONE-SECTION McCAIN PEDESTRIAN SIGNAL HOUSINGS, AND SHALL FURNISH AND INSTALL NEW COUNTDOWN TIMER LED "HAND/WALKING PERSON" LENSES IN THEIR PLACE (REUSE HOUSINGS AND VISORS AS DENOTED IN THE PLANS). SEE SPECIAL PROVISIONS.
- 4) ALL LOOP DETECTORS ARE INPLACE AND SHALL BE REUSED AND MAINTAINED INPLACE AND OPERATIONAL, EXCEPT AS FOLLOWS: CONTRACTOR SHALL FURNISH AND INSTALL NEW LOOP DETECTORS FOR D1-2 AND D5-2 IN PVC PER DETAILS INCLUDED ELSEWHERE IN THESE PLANS. LOOP DETECTOR WIRES FOR NEW LOOP DETECTORS SHALL BE CROSS-LINKED POLY-ETHYLENE (XLP) IN 3/4" NMC. SEE SPECIAL PROVISIONS.
- 5) ANY DAMAGE TO INPLACE TRAFFIC SIGNAL FACILITIES (CONDUIT, CABLES, HANDHOLES, SIGNAL POLES, ETC.), DUE TO TRAFFIC SIGNAL REVISION WORK, SHALL BE REPAIRED BY CONTRACTOR TO SATISFACTION OF THE ENGINEER, AT NO EXPENSE TO THE COUNTY.
- 6) CONTRACTOR SHALL MAINTAIN OPERATION OF THE SIGNAL SYSTEM AT ALL TIMES, EXCEPT AS OTHERWISE APPROVED BY ENGINEER.
- 7) ALL NEW VEHICULAR SIGNAL HEADS SHALL HAVE BACKGROUND SHIELDS FURNISHED & INSTALLED BY CONTRACTOR. ALL INPLACE VEHICULAR SIGNAL HEADS BEING REUSED AS PART OF REVISE SIGNAL SYSTEM "F" HAVE BACKGROUND SHIELDS (REUSE AND MAINTAIN INPLACE).
- 8) F & I = NEW, FURNISH AND INSTALL.
S & I = INPLACE, SALVAGE AND INSTALL.
- 9) ALL NEW VEHICULAR SIGNAL HOUSINGS, BACKGROUND SHIELDS AND VISORS SHALL BE FABRICATED USING BLACK POLYCARBONATE MATERIALS. SEE SPECIAL PROVISIONS.
- 10) SEE SPECIAL PROVISIONS REGARDING NEW TYPE C SIGN PANELS TO BE FURNISHED AND INSTALLED BY CONTRACTOR (INCLUDED AS PART OF PAY ITEM FOR "REVISE SIGNAL SYSTEM F").
- 11) SEE SPECIAL PROVISIONS FOR COUNTY FURNISHED MATERIALS TO BE INSTALLED AND MADE OPERATIONAL BY CONTRACTOR.
- 12) CONTRACTOR SHALL BE RESPONSIBLE FOR INSTALLING AND MAKING OPERATIONAL A NEW COUNTY FURNISHED CONTROLLER CABINET COMPLETE WITH NEW CONTROL EQUIPMENT ON THE INPLACE CABINET FOUNDATION & FOR SALVAGING THE EXISTING CONTROLLER AND CABINET TO THE COUNTY. SEE SPECIAL PROVISIONS (INCIDENTAL).

① INPLACE (MAINTAIN INPLACE) PA100 POLE FOUNDATION
 TYPE PA100-A-45-D40-9 (DAVIT AT 350 DEG)
 LUMINAIRE-250 W HPS
 1-ONE WAY SIGNAL-OVERHEAD AT 11' (8-2)
 1-TYPE 10B-POLE MOUNTED 180 DEG (R-1, P8-2)
 2-PEDESTRIAN PUSH BUTTONS
 TYPE D SIGN PANEL-OVERHEAD AT 18'
 ONE WAY EVP DETECTOR AND LIGHT AT 6' (#8,3)
 EXTENDED INTO H.H.1:
 3" R.S.C.
 2-12/c#12
 3-3/c#12
 1-3/c#20
 1-3/c#12 (LUM)

INPLACE (SALVAGE) 1-ONE WAY SIGNAL AND MOUNT-OVERHEAD AT 0' (OLD 8-3)
 1-ONE WAY SIGNAL-POLE MOUNTED 90 DEG (OLD 5-2)
 INPLACE (REMOVE) TYPE 10B BRACKETING-POLE MOUNTED 90 DEG
 2-"HAND/WALKING PERSON" LENSES
 2-R10-4b PEDESTRIAN INSTRUCTION STICKER SIGNS
 R10-12 SIGN PANEL-OVERHEAD
 INPLACE 1-SET PEDESTRIAN SIGNALS (HOUSING, VISOR) AT 90 DEG (P8-1) (S & I)
 F & I 1-ONE WAY SIGNAL AND ANGLE MOUNT-OVERHEAD AT 0' (NEW 3-1)
 TYPE 10B BRACKETING-POLE MOUNTED 90 DEG (FOR 5-2, P8-1)
 1-ONE WAY SIGNAL-POLE MOUNTED 90 DEG (NEW 5-2)
 2-SETS LED CD "HAND/WALKING PERSON" LENS (FOR P8-1, P8-2)
 2-R10-3a PEDESTRIAN INSTRUCTION STICKER SIGNS
 R10-X12 SIGN-ADJACENT TO 3-1

② INPLACE (MAINTAIN INPLACE) PA100 POLE FOUNDATION
 TYPE PA100-A-50-D40-9 (DAVIT AT 350 DEG)
 LUMINAIRE-250 W HPS
 2-ONE WAY SIGNALS-OVERHEAD (10' AND 20' FROM END OF MAST ARM) (2-3, 2-2)
 1-TYPE 10B-POLE MOUNTED 180 DEG (2-1, P2-2)
 2-PEDESTRIAN PUSH BUTTONS & SIGNS
 2-R6-1 SIGN PANELS-POLE MOUNTED 0/180 DEG
 TYPE D SIGN PANEL-OVERHEAD AT 26'
 ONE WAY EVP DETECTOR AND LIGHT AT 6' (#2,5)
 EXTENDED INTO H.H.5:
 3" R.S.C.
 2-12/c#12
 4-3/c#12
 1-3/c#20
 1-3/c#12 (LUM)



INPLACE (SALVAGE) 1-ONE WAY SIGNAL AND MOUNT-OVERHEAD AT 0' (OLD 5-1)
 1-ONE WAY SIGNAL-POLE MOUNTED 90 DEG (OLD 4-4)
 INPLACE (REMOVE) TYPE 10B BRACKETING-POLE MOUNTED 90 DEG
 2-"HAND/WALKING PERSON" LENSES
 2-R10-4b PEDESTRIAN INSTRUCTION STICKER SIGNS
 INPLACE 1-SET PEDESTRIAN SIGNALS (HOUSING, VISOR) AT 90 DEG (P8-1) (S & I)
 F & I 1-ONE WAY SIGNAL AND ANGLE MOUNT-OVERHEAD AT 0' (NEW 5-1)
 TYPE 10B BRACKETING-POLE MOUNTED 90 DEG (FOR 7-2, P8-1)
 1-ONE WAY SIGNAL-POLE MOUNTED 90 DEG (NEW 7-2)
 2-SETS LED CD "HAND/WALKING PERSON" LENS (FOR P2-2, P8-1)
 2-R10-3a PEDESTRIAN INSTRUCTION STICKER SIGNS
 R10-X12 SIGN-ADJACENT TO 5-1

③ INPLACE (MAINTAIN INPLACE) PA100 POLE FOUNDATION
 TYPE PA100-A-55-D40-9 (DAVIT AT 350 DEG)
 LUMINAIRE-250 W HPS
 1-ONE WAY SIGNAL-OVERHEAD AT 11' (4-2)
 1-TYPE 10B-POLE MOUNTED 180 DEG (4-1, P4-2)
 2-PEDESTRIAN PUSH BUTTONS & SIGNS
 TYPE D SIGN PANEL-OVERHEAD AT 18'
 ONE WAY EVP DETECTOR AND LIGHT AT 6' (#4,7)
 EXTENDED INTO H.H.10:
 3" R.S.C.
 2-12/c#12
 3-3/c#12
 1-3/c#20
 1-3/c#12 (LUM)

INPLACE (SALVAGE) 1-ONE WAY SIGNAL AND MOUNT-OVERHEAD AT 0' (OLD 4-3)
 1-ONE WAY SIGNAL-POLE MOUNTED 90 DEG (OLD 1-2)
 INPLACE (REMOVE) TYPE 10B BRACKETING-POLE MOUNTED 90 DEG
 2-"HAND/WALKING PERSON" LENSES
 2-R10-4b PEDESTRIAN INSTRUCTION STICKER SIGNS
 R10-12 SIGN PANEL-OVERHEAD
 INPLACE 1-SET PEDESTRIAN SIGNALS (HOUSING, VISOR) AT 90 DEG (P2-1) (S & I)
 F & I 1-ONE WAY SIGNAL AND ANGLE MOUNT-OVERHEAD AT 0' (NEW 7-1)
 TYPE 10B BRACKETING-POLE MOUNTED 90 DEG (FOR 1-2, P2-1)
 1-ONE WAY SIGNAL-POLE MOUNTED 90 DEG (NEW 1-2)
 2-SETS LED CD "HAND/WALKING PERSON" LENS (FOR P2-1, P4-2)
 2-R10-3a PEDESTRIAN INSTRUCTION STICKER SIGNS
 R10-X12 SIGN-ADJACENT TO 7-1

④ INPLACE (MAINTAIN INPLACE) PA100 POLE FOUNDATION
 TYPE PA100-A-60-D40-9 (DAVIT AT 350 DEG)
 LUMINAIRE-250 W HPS
 2-ONE WAY SIGNALS-OVERHEAD (12' AND 24' FROM END OF MAST ARM) (6-3, 6-2)
 1-TYPE 10B-POLE MOUNTED 180 DEG (6-1, P6-2)
 2-PEDESTRIAN PUSH BUTTONS & SIGNS
 2-R6-1 SIGN PANELS-POLE MOUNTED 0/180 DEG
 TYPE D SIGN PANEL-OVERHEAD AT 34'
 ONE WAY EVP DETECTOR AND LIGHT AT 6' (#6,1)
 EXTENDED INTO H.H.16:
 3" R.S.C.
 2-12/c#12
 4-3/c#12
 1-3/c#20
 1-3/c#12 (LUM)

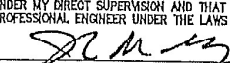
INPLACE (SALVAGE) 1-ONE WAY SIGNAL AND MOUNT-OVERHEAD AT 0' (OLD 1-1)
 1-ONE WAY SIGNAL-POLE MOUNTED 90 DEG (OLD 8-4)
 INPLACE (REMOVE) TYPE 10B BRACKETING-POLE MOUNTED 90 DEG
 2-"HAND/WALKING PERSON" LENSES
 2-R10-4b PEDESTRIAN INSTRUCTION STICKER SIGNS
 INPLACE 1-SET PEDESTRIAN SIGNALS (HOUSING, VISOR) AT 90 DEG (P4-1) (S & I)
 F & I 1-ONE WAY SIGNAL AND ANGLE MOUNT-OVERHEAD AT 0' (NEW 1-1)
 TYPE 10B BRACKETING-POLE MOUNTED 90 DEG (FOR 3-2, P4-1)
 1-ONE WAY SIGNAL-POLE MOUNTED 90 DEG (NEW 3-2)
 2-SETS LED CD "HAND/WALKING PERSON" LENS (FOR P4-1, P6-2)
 2-R10-3a PEDESTRIAN INSTRUCTION STICKER SIGNS
 R10-X12 SIGN-ADJACENT TO 1-1

DRAWN BY: JMG						I HEREBY CERTIFY THAT THIS PLAN WAS PREPARED BY ME OR UNDER MY DIRECT SUPERVISION AND THAT I AM A DULY LICENSED PROFESSIONAL ENGINEER UNDER THE LAWS OF THE STATE OF MINNESOTA.  Name: John M. Gray, PE Lic. No. 22457 Date: September 23, 2010	 PHONES (651) 490-2000 3035 VADNAIS CENTER DR. ST. PAUL, MN 55110	ANOKA COUNTY CITIES OF ANOKA AND RAMSEY, MN	REVISE SIGNAL SYSTEM 'F' GENERAL NOTES AND POLE NOTES CSAH 116 (BUNKER LAKE BLVD NW) AT THURSTON AVENUE/DYSPROSIUM STREET	FILE NO. ANOKC 136131	41
DESIGNER: JMG					DATE 09/23/2010					60	
CHECKED BY: JMG											
DESIGN TEAM						REVISIONS					

COUNTY PROJ. 16-25-00

MATCHLINE, E.B. STA. 106+40, SEE BELOW

MATCHLINE "A" E.B. STA. 112+20, SEE PAGE 1 OF 4

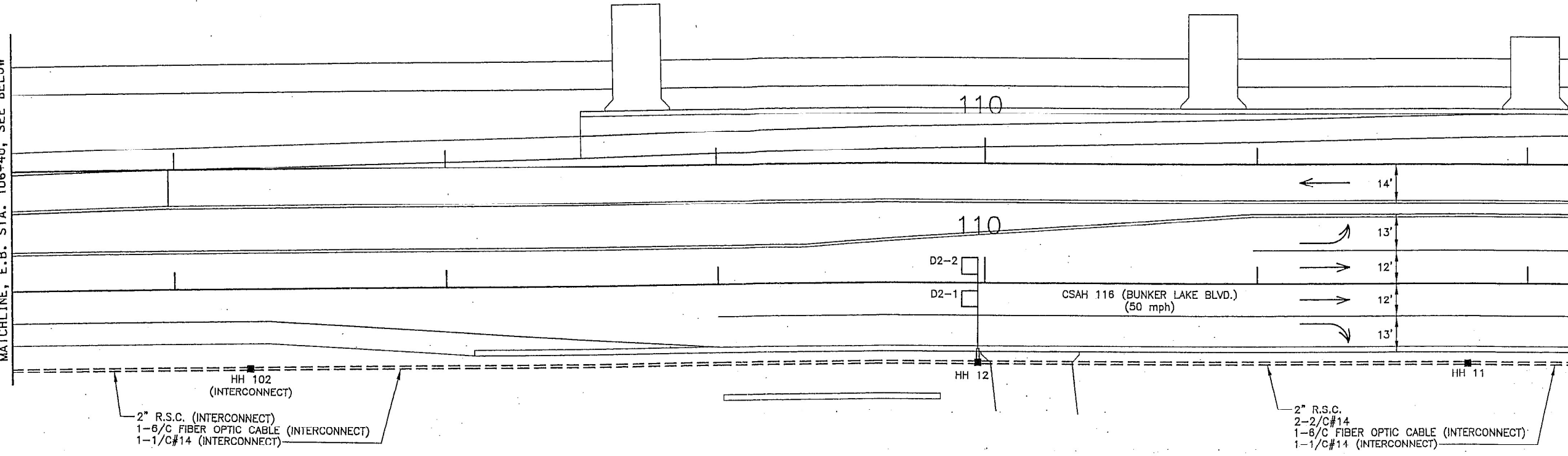

NOTES:

- 1) IT SHALL BE THE CONTRACTOR'S RESPONSIBILITY TO UTILIZE THE "ONE CALL EXCAVATION NOTICE SYSTEM" (TELEPHONE NUMBER 651-454-0002), AS REQUIRED BY MINNESOTA STATUTE 216D.
- 2) DISTANCE OFF OF SHOULDER OR CURB FOR INTERCONNECT CONDUIT SHALL BE 1 TO 2 FEET.
- 3) (INTERCONNECT) DENOTES ITEMS TO BE MEASURED AND PAID FOR UNDER ITEM NO.2565.601 (TRAFFIC CONTROL INTERCONNECTION). SEE ESTIMATED QUANTITIES AND SPECIAL PROVISIONS.

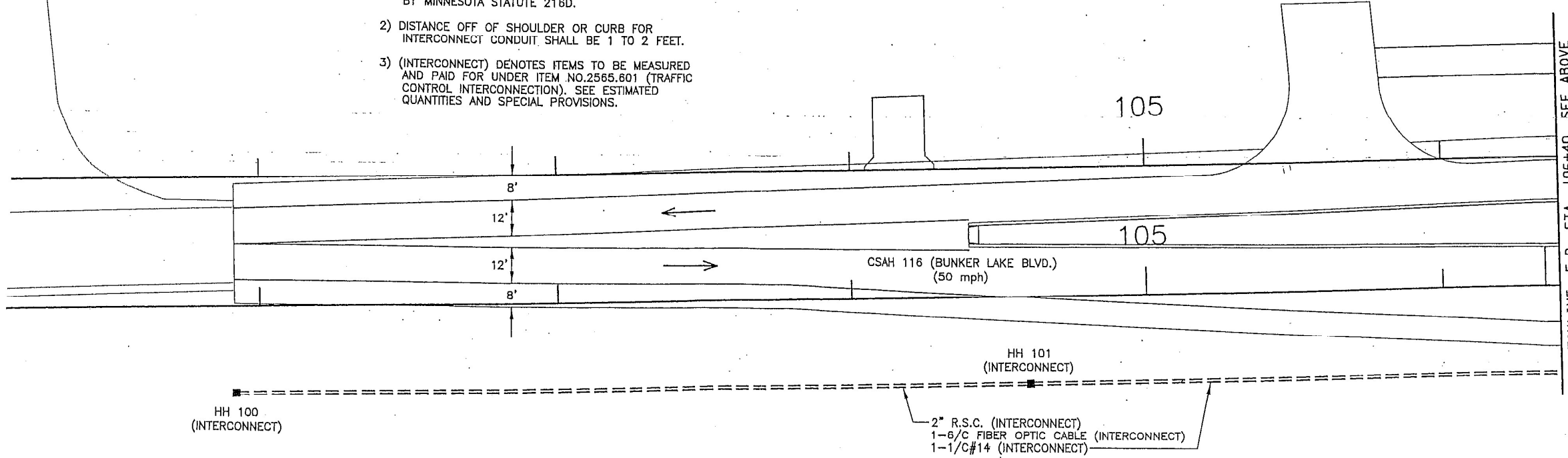

MATCHLINE, E.B. STA. 106+40, SEE ABOVE



NO	DATE	BY	CKD	APPR	REVISION

NAME: G:\SHEET\17366_RL_02.DWG

I HEREBY CERTIFY THAT THIS PLAN WAS PREPARED BY ME OR UNDER MY DIRECT SUPERVISION AND THAT I AM A DULY LICENSED PROFESSIONAL ENGINEER UNDER THE LAWS OF THE STATE OF MINNESOTA.

PRINT NAME: ALAN J. PALMER P.E.

SIGNATURE: *[Signature]*

DATE: 18 JUNE 2005 LICENSE NO. 42482

DRAWN BY: RLH/DJS DATE: 02/18/05

DESIGN BY: AJP/EDD DATE: 02/18/05

CHECKED BY: AJP DATE: 02/18/05



**ANOKA COUNTY
HIGHWAY DEPT.**

PROJECT NO. ANOKA COUNTY S.P. 02-716-07
CITY OF ANOKA S.P. 103-122-12
CITY OF RAMSEY S.P. 199-020-04

**SIGNAL SYSTEM/INTERCONNECT
INTERSECTION LAYOUT**
PAGE 2 OF 4
Sheet 70 of 120 Sheets

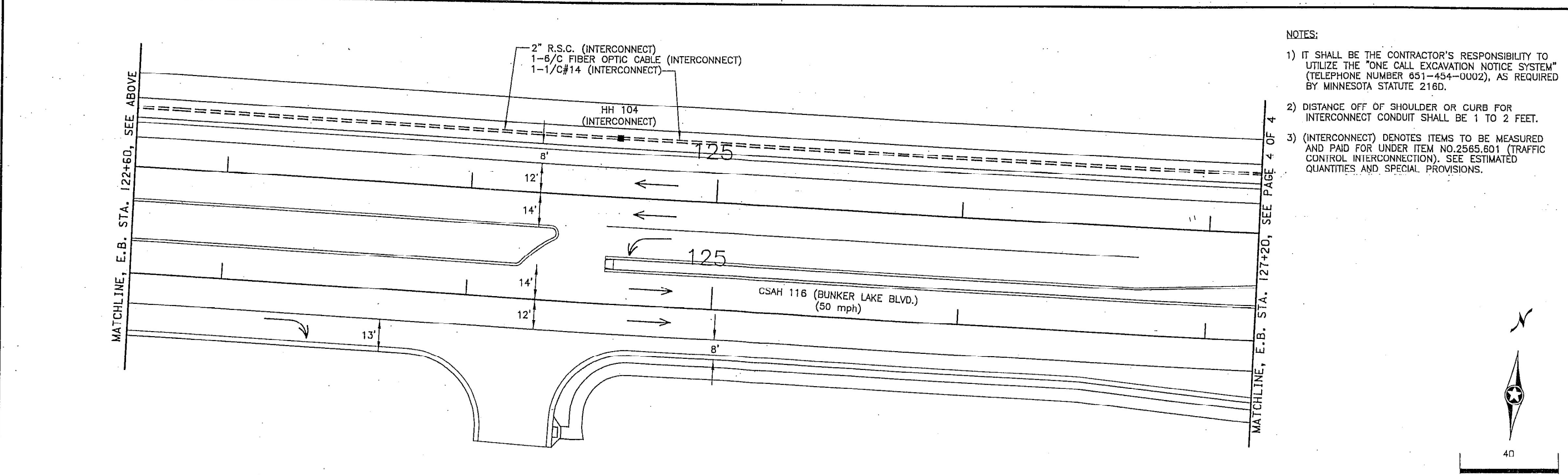
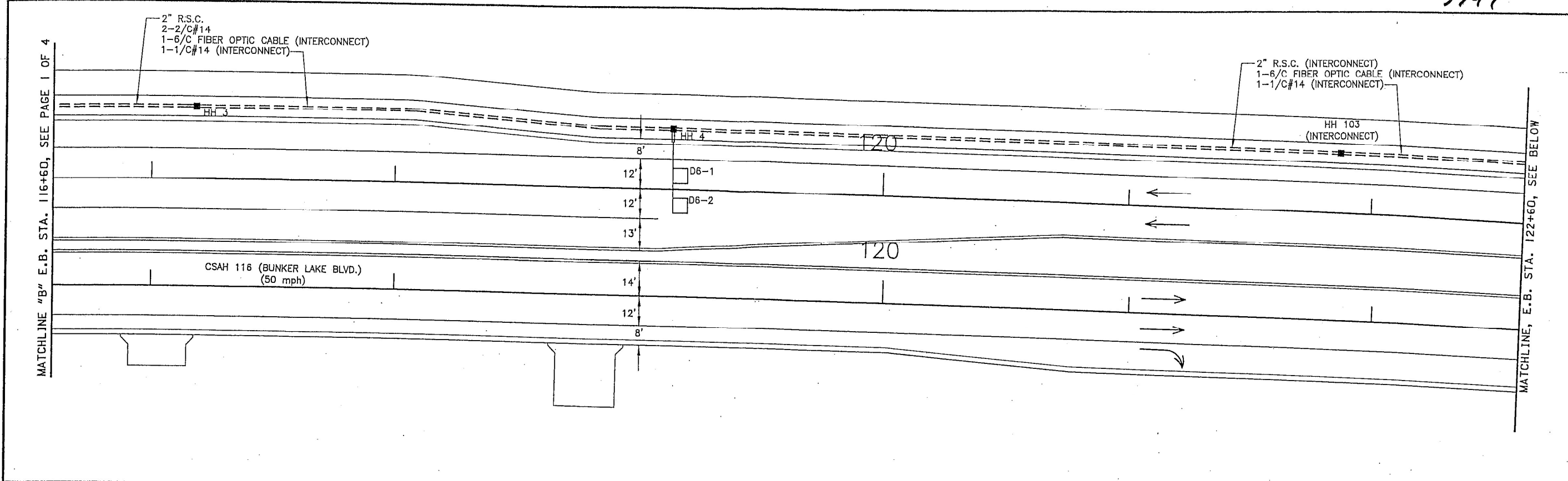

- NOTES:
- 1) IT SHALL BE THE CONTRACTOR'S RESPONSIBILITY TO UTILIZE THE "ONE CALL EXCAVATION NOTICE SYSTEM" (TELEPHONE NUMBER 651-454-0002), AS REQUIRED BY MINNESOTA STATUTE 216D.
 - 2) DISTANCE OFF OF SHOULDER OR CURB FOR INTERCONNECT CONDUIT SHALL BE 1 TO 2 FEET.
 - 3) (INTERCONNECT) DENOTES ITEMS TO BE MEASURED AND PAID FOR UNDER ITEM NO. 2565.601 (TRAFFIC CONTROL INTERCONNECTION). SEE ESTIMATED QUANTITIES AND SPECIAL PROVISIONS.



NO	DATE	BY	CKD	APPN	REVISION

I HEREBY CERTIFY THAT THIS PLAN WAS PREPARED BY ME OR UNDER MY DIRECT SUPERVISION AND THAT I AM A DULY LICENSED PROFESSIONAL ENGINEER UNDER THE LAWS OF THE STATE OF MINNESOTA.

PRINT NAME: ALAN V. PALMER, P.E.
 SIGNATURE: *[Signature]*
 DATE: 18 JUNE 2005 LICENSE NO. 42462

DRAWN BY: RLH/DJS DATE: 02/18/05
 DESIGN BY: AJP/EDD DATE: 02/18/05
 CHECKED BY: AJP DATE: 02/18/05

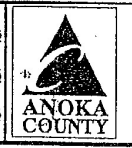

ANOKA COUNTY
 HIGHWAY DEPT.

PROJECT NO.
 ANOKA COUNTY S.P. 02-716-07
 CITY OF ANOKA S.P. 103-122-12
 CITY OF RAMSEY S.P. 199-020-04

SIGNAL SYSTEM/INTERCONNECT
 INTERSECTION LAYOUT
 PAGE 3 OF 4
 Sheet 71 of 120 Sheets

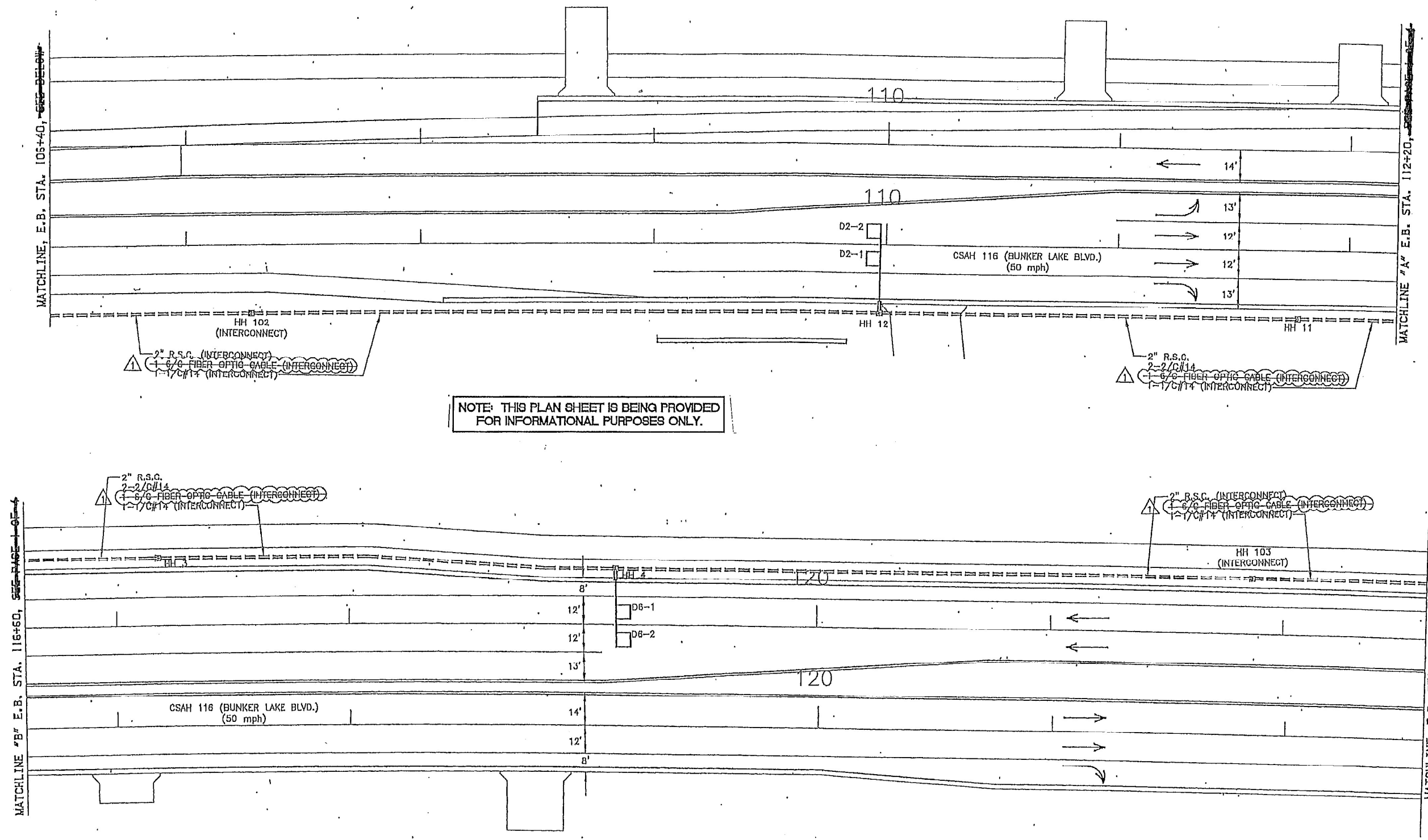

NOTE: THIS PLAN SHEET IS BEING PROVIDED FOR INFORMATIONAL PURPOSES ONLY.

201674A-BASE.DWG	DRAWN BY: JMG				
	DESIGNER: JMG				
	CHECKED BY: JMG				
	DESIGN TEAM	NO.	BY	DATE	REVISIONS

SEH
 PHONE: (851) 490-2000
 3535 VADNAIS CENTER DR.
 ST. PAUL, MN 55110

ANOKA COUNTY
 CITIES OF ANOKA
 AND RAMSEY, MN

INPLACE SIGNAL SYSTEM 'F'
'FOR INFORMATION ONLY'
 CSAH 116 (BUNKER LAKE BLVD NW)
 AT THURSTON AVENUE/DY88PROBUM STREET

COUNTY PROJ. 16-25-00
 FILE NO. ANOKA 138131
 DATE 09/23/2018

44
 60

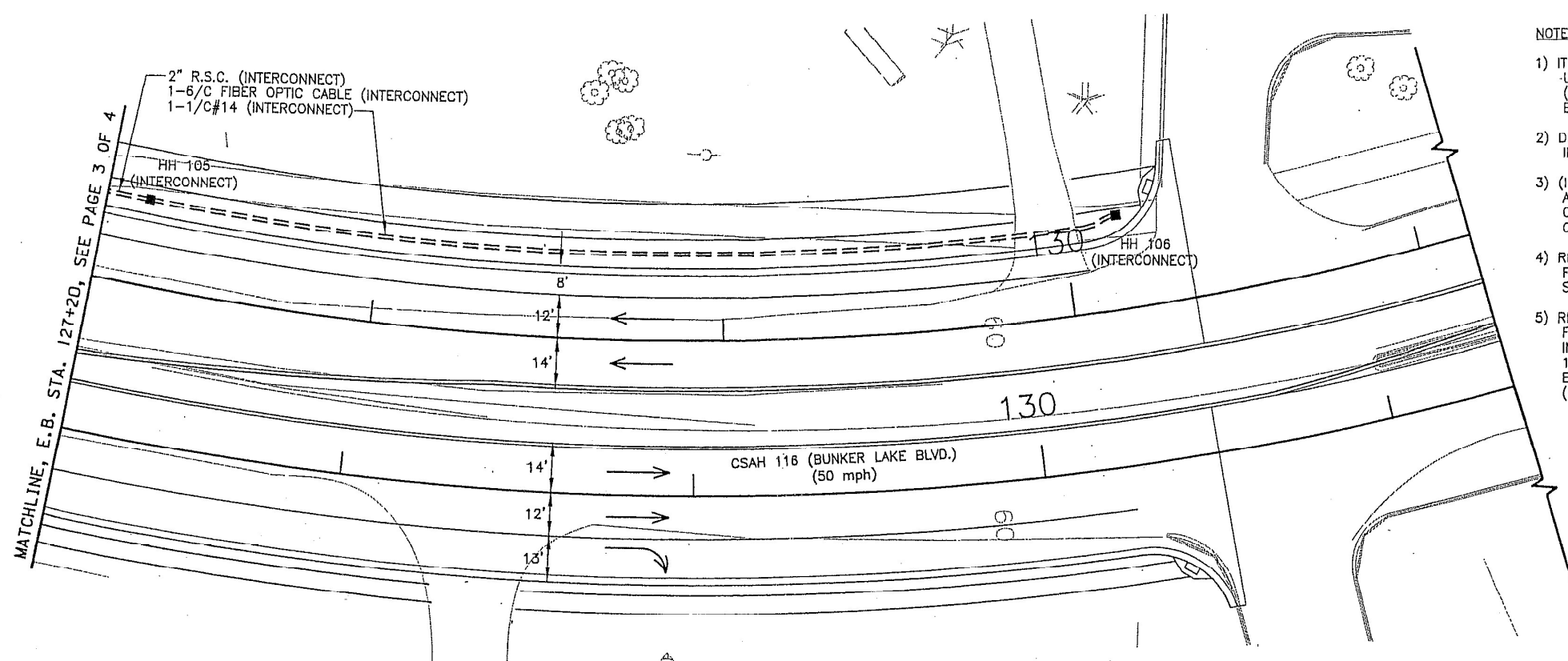

- NOTES:
- 1) IT SHALL BE THE CONTRACTOR'S RESPONSIBILITY TO UTILIZE THE "ONE CALL EXCAVATION NOTICE SYSTEM" (TELEPHONE NUMBER 651-454-0002), AS REQUIRED BY MINNESOTA STATUTE 216D.
 - 2) DISTANCE OFF OF SHOULDER OR CURB FOR INTERCONNECT CONDUIT SHALL BE 1 TO 2 FEET.
 - 3) (INTERCONNECT) DENOTES ITEMS TO BE MEASURED AND PAID FOR UNDER ITEM NO.2565.601 (TRAFFIC CONTROL INTERCONNECTION). SEE ESTIMATED QUANTITIES AND SPECIAL PROVISIONS.
 - 4) RELOCATING HANDHOLES WILL BE MEASURED AND PAID FOR UNDER ITEM NO. 2550.602 (RELOCATE HANDHOLE). SEE SPECIAL PROVISIONS.
 - 5) REMOVING EXISTING CONDUIT, REMOVING 1-2/C#14 FROM CONTROLLER TO INPLACE HH 4, FURNISHING AND INSTALLING NEW CONDUIT, FURNISHING AND INSTALLING 1-2/C#14 FROM CONTROLLER TO INPLACE HH 4, WILL BE MEASURED AND PAID UNDER ITEM NO. 2545.509 (CONDUIT SYSTEM (SIGNALS)). SEE SPECIAL PROVISIONS.

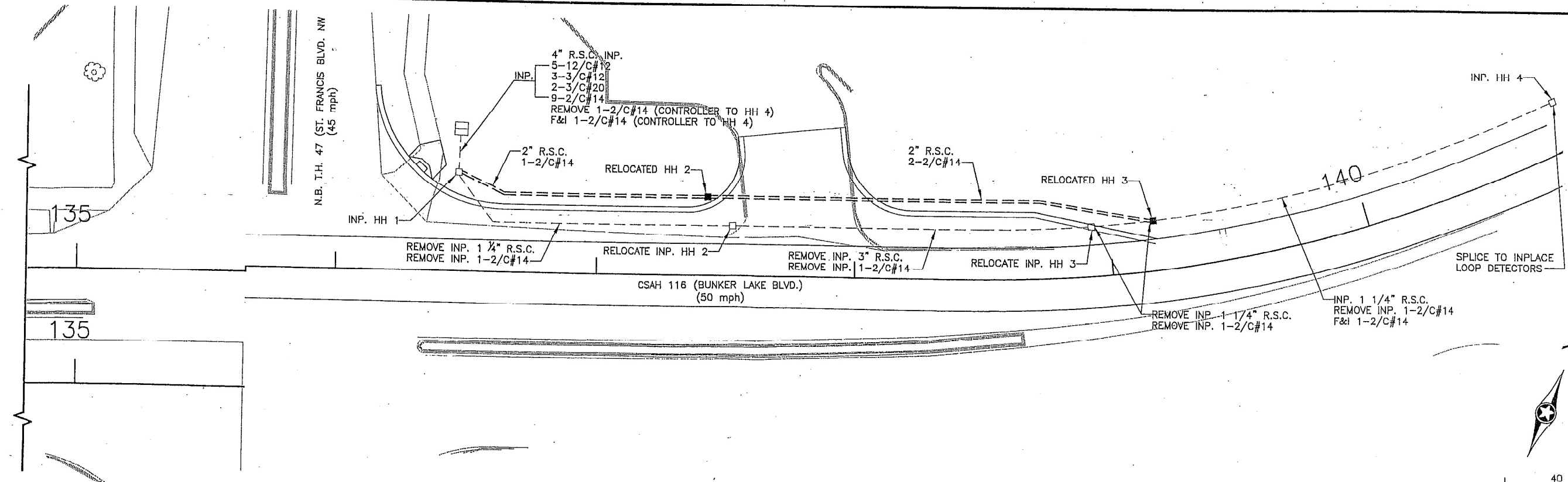

NO	DATE	BY	CKD	APPR	REVISION

NAME: C:\SHEET\17366_RL_04.DWG

I HEREBY CERTIFY THAT THIS PLAN WAS PREPARED BY ME OR UNDER MY DIRECT SUPERVISION AND THAT I AM A DULY LICENSED PROFESSIONAL ENGINEER UNDER THE LAWS OF THE STATE OF MINNESOTA.

PRINT NAME: ALAN J. PALMER, P.E.
 SIGNATURE: *[Signature]*
 DATE: 18 JUNE 2005 LICENSE NO. 42462

DRAWN BY: BLH/DJS DATE: 02/18/05
 DESIGN BY: AJP/EDD DATE: 02/18/05
 CHECKED BY: AJP DATE: 02/18/05

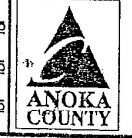

ANOKA COUNTY
 HIGHWAY DEPT.

PROJECT NO.
 ANOKA COUNTY S.P. 02-716-07
 CITY OF ANOKA S.P. 103-122-12
 CITY OF RAMSEY S.P. 199-020-04

SIGNAL SYSTEM/INTERCONNECT
 INTERSECTION LAYOUT
 PAGE 4 OF 4
 Sheet 72 of 120 Sheets

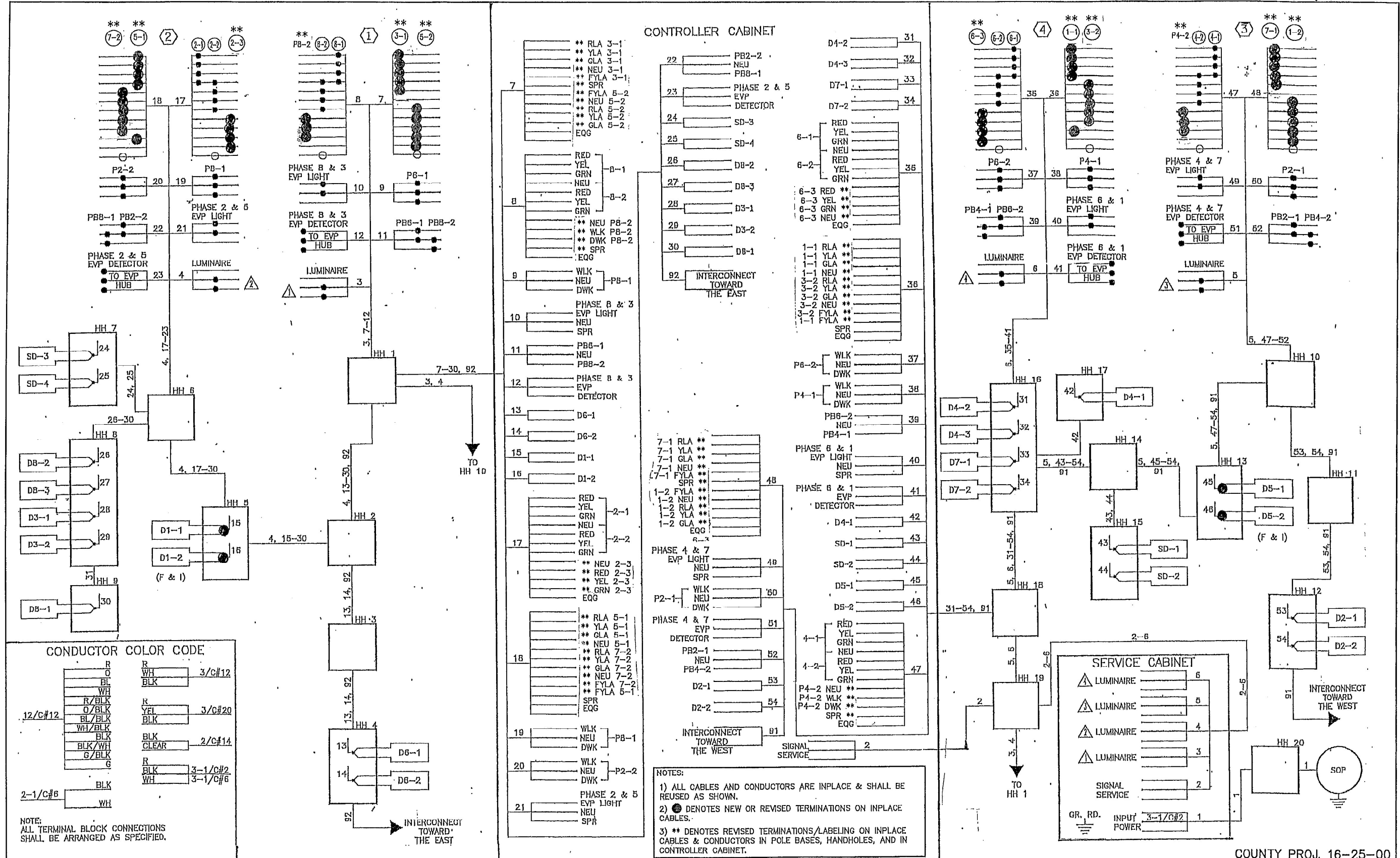

CONDUCTOR COLOR CODE

R	3/C#12
BL	3/C#20
WH	3/C#14
R/BLK	2/C#14
O/BLK	3-1/C#2
BLK/BLK	3-1/C#6
WH/BLK	
BLK	
BLK/WH	
G/BLK	
G	
2-1/C#6	
BLK	
WH	

NOTE: ALL TERMINAL BLOCK CONNECTIONS SHALL BE ARRANGED AS SPECIFIED.

CONTROLLER CABINET

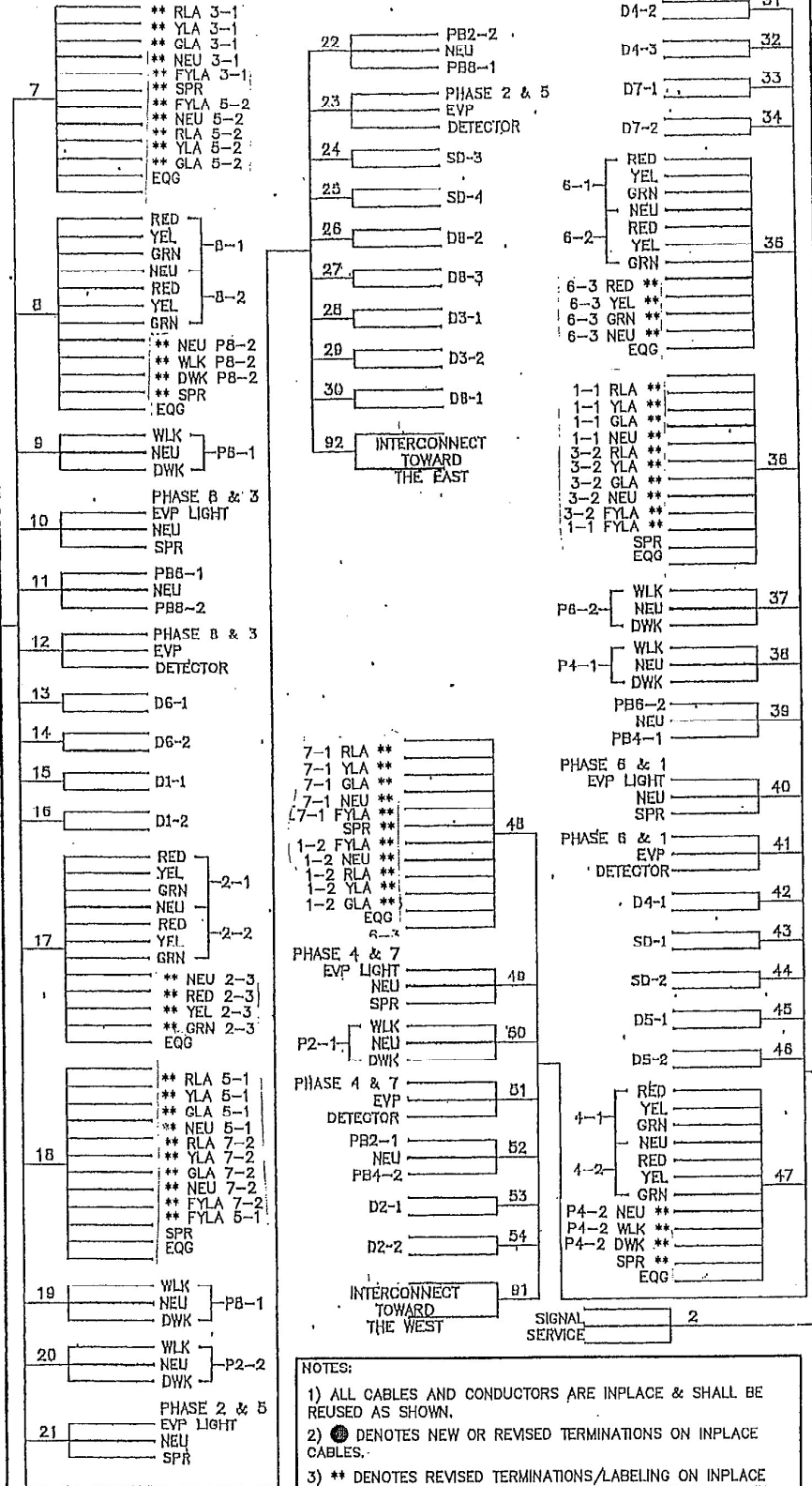

NOTES:

- 1) ALL CABLES AND CONDUCTORS ARE INPLACE & SHALL BE REUSED AS SHOWN.
- 2) ● DENOTES NEW OR REVISED TERMINATIONS ON INPLACE CABLES.
- 3) ** DENOTES REVISED TERMINATIONS/LABELING ON INPLACE CABLES & CONDUCTORS IN POLE BASES, HANDHOLES, AND IN CONTROLLER CABINET.

SERVICE CABINET

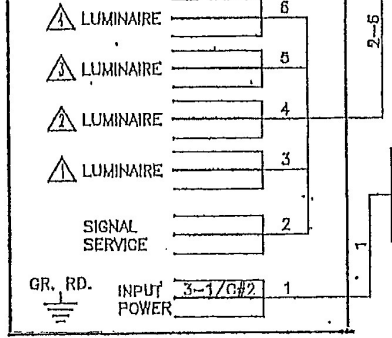

DRAWN BY: JMG
 DESIGNER: JMG
 CHECKED BY: JMG

NO.	BY	DATE

REVISIONS

NO.	BY	DATE

I HEREBY CERTIFY THAT THIS PLAN WAS PREPARED BY ME OR UNDER MY DIRECT SUPERVISION AND THAT I AM A DULY LICENSED PROFESSIONAL ENGINEER UNDER THE LAWS OF THE STATE OF MINNESOTA.

Date: September 23, 2016 Name: John M. Gray, PE Lico. No. 22487

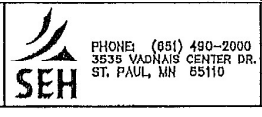

ANOKA COUNTY
 CITIES OF ANOKA AND RAMSEY, MN

REVISE SIGNAL SYSTEM 'F'
 FIELD WIRING DIAGRAM
 CSAH 116 (BUNKER LAKE BLVD NW)
 AT THURSTON AVENUE/DYBROGNUM STREET

COUNTY PROJ. 16-25-00

FILE NO. ANOKC 136131	42
DATE 09/23/2016	60