

WEST FLASHER SYSTEM

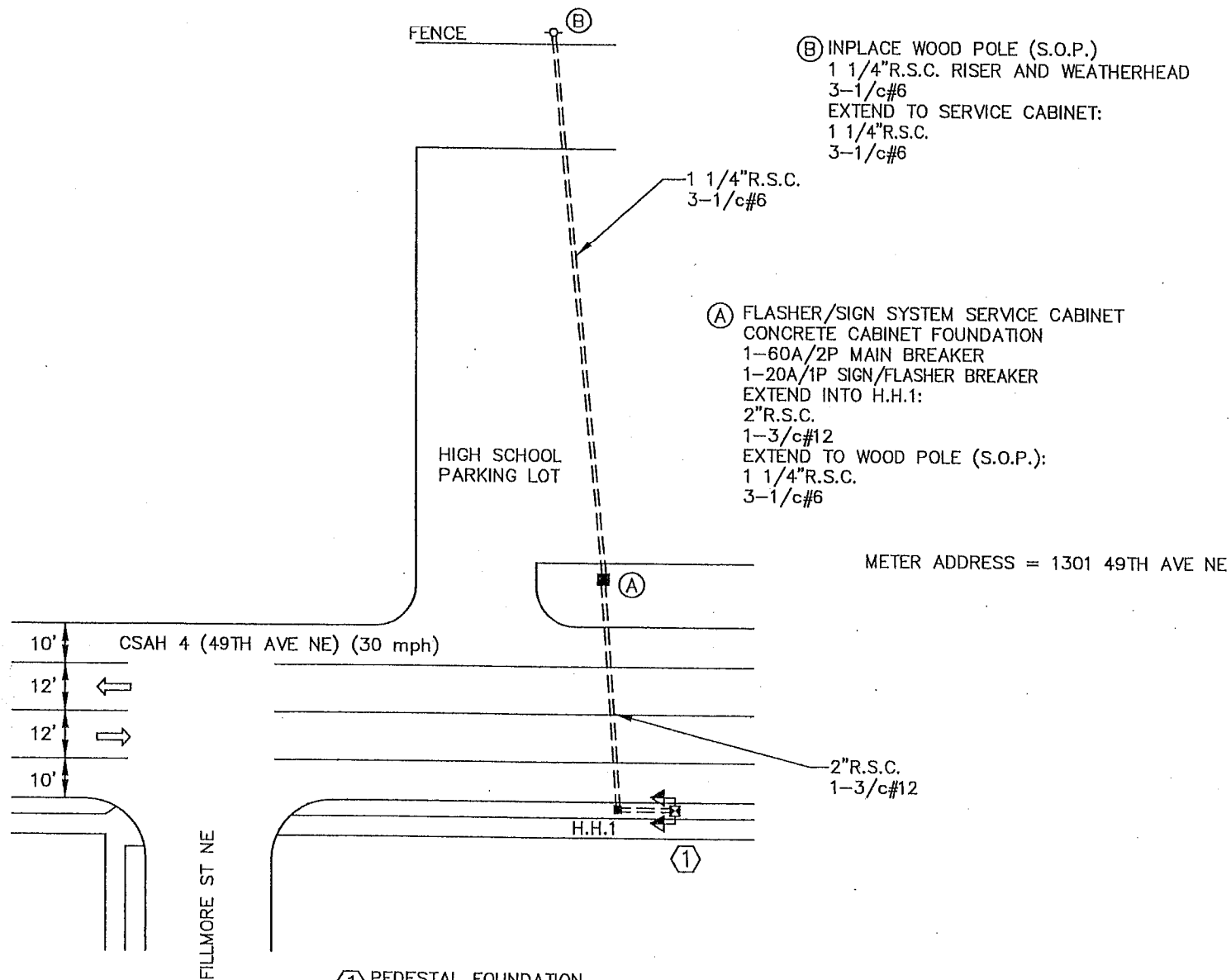

Ⓑ INPLACE WOOD POLE (S.O.P.)
 1 1/4" R.S.C. RISER AND WEATHERHEAD
 3-1/c#6
 EXTEND TO SERVICE CABINET:
 1 1/4" R.S.C.
 3-1/c#6

Ⓐ FLASHER/SIGN SYSTEM SERVICE CABINET
 CONCRETE CABINET FOUNDATION
 1-60A/2P MAIN BREAKER
 1-20A/1P SIGN/FLASHER BREAKER
 EXTEND INTO H.H.1:
 2" R.S.C.
 1-3/c#12
 EXTEND TO WOOD POLE (S.O.P.):
 1 1/4" R.S.C.
 3-1/c#6

Ⓐ PEDESTAL FOUNDATION
 12' PEDESTAL POLE (INCLUDES BASE)
 WIND COLLAR FOR PEDESTAL POLE
 2-12" LED YELLOW FLASHERS WITH
 VISORS, BRACKETING, AND SLIPFITTER COLLAR
 (FACING EASTBOUND TRAFFIC)
 3M RADAR SPEED SIGN (YOUR SPEED XX)-
 (36"x48")-POLE MOUNTED
 S5-1 (SCHOOL-SPEED LIMIT 25-WHEN FLASHING)
 SIGN PANEL (24"x48")-POLE MOUNTED
 1/2" EL FROM BOTTOM OF 3M SIGN PANEL TO
 PEDESTAL POLE
 2-1/c#10 (EXTEND TO POLE BASE)
 EXTEND INTO H.H.1:
 2" R.S.C.
 1-3/c#12



7933 + 7934
 EAST FLASHER SYSTEM

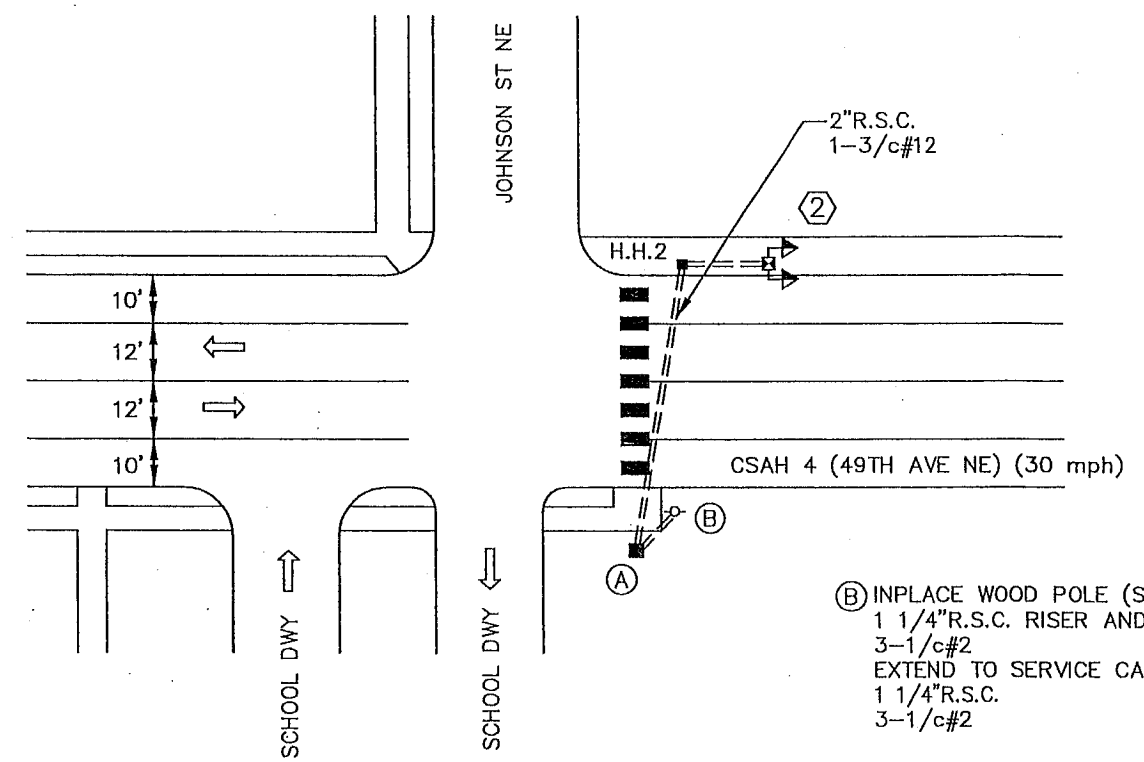

Ⓐ PEDESTAL FOUNDATION
 12' PEDESTAL POLE (INCLUDES BASE)
 WIND COLLAR FOR PEDESTAL POLE
 2-12" LED YELLOW FLASHERS WITH
 VISORS, BRACKETING, AND SLIPFITTER COLLAR
 (FACING WESTBOUND TRAFFIC)
 3M RADAR SPEED SIGN (YOUR SPEED XX)-
 (36"x48")-POLE MOUNTED
 S5-1 (SCHOOL-SPEED LIMIT 25-WHEN FLASHING)
 SIGN PANEL (24"x48")-POLE MOUNTED
 1/2" EL FROM BOTTOM OF 3M SIGN PANEL TO
 PEDESTAL POLE
 2-1/c#10 (EXTEND TO POLE BASE)
 EXTEND INTO H.H.2:
 2" R.S.C.
 1-3/c#12

Ⓑ INPLACE WOOD POLE (S.O.P.)
 1 1/4" R.S.C. RISER AND WEATHERHEAD
 3-1/c#2
 EXTEND TO SERVICE CABINET:
 1 1/4" R.S.C.
 3-1/c#2

Ⓐ FLASHER/SIGN SYSTEM SERVICE CABINET
 CONCRETE CABINET FOUNDATION
 1-60A/2P MAIN BREAKER
 1-20A/1P SIGN/FLASHER BREAKER
 EXTEND INTO H.H.2:
 2" R.S.C.
 1-3/c#12
 EXTEND TO WOOD POLE (S.O.P.):
 1 1/4" R.S.C.
 3-1/c#2

NOTES:

- HANDHOLES SHALL BE PVC HANDHOLES WITH METAL FRAMES AND COVERS PER MNDOT STANDARD PLATE NO. 8114A (CONCRETE COLLAR AT WEST FLASHER).
- SEE DETAILS FOR FURTHER INFORMATION REGARDING MOUNTING OF ALL FLASHER POLE MATERIALS AND ELECTRICAL EQUIPMENT.
- FLASHER SYSTEM SHALL BE TIME OF DAY ACTUATED.

FINAL PLAN
 CONFORMING TO
 CONST. RECORDS
 DATE JMG, 01-12-09

S:\AEV\ANOKA\CD\MINN\STONALS\SCHOOL_FLASHERS\DOORPLANS-REC.DWG

DESIGNER:	JMG	1	JMG	01/09	RECORD DRAWING
CHECKED BY:	JMG				
APPROVED BY:	JMG				
DESIGN TEAM	NO.	BY	DATE	REVISIONS	

© SHORT ELLIOTT HENDRICKSON 2004. ANY USE OR REUSE OF THIS PLAN/DRAWING AND THE CORRESPONDING COMPUTER AIDED DESIGN/DRAFTING FILES WITHOUT THE EXPRESS WRITTEN CONSENT OF SEH IS PROHIBITED. SEH SHALL NOT BE RESPONSIBLE FOR ANY UNAUTHORIZED USE OR REUSE OF THE MATERIALS, OR DAMAGES RESULTING THEREFROM.

I HEREBY CERTIFY THAT THIS PLAN WAS PREPARED BY ME OR UNDER MY DIRECT SUPERVISION AND THAT I AM A DULY LICENSED PROFESSIONAL ENGINEER UNDER THE LAWS OF THE STATE OF MINNESOTA.

SIGNATURE: *JMG* L.I.C. NO. 22457
 PRINTED NAME: JOHN M. GRAY DATE 10/27/2008

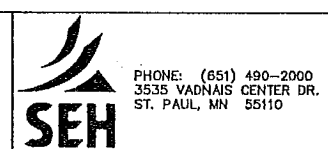

ANOKA COUNTY, MINNESOTA
 2008 SCHOOL FLASHERS
 CITY OF COLUMBIA HEIGHTS

SCHOOL SPEED ZONE
 FLASHER/SIGN SYSTEMS
 INTERSECTION LAYOUT
 CSAH 4 (49TH AVENUE NE) AT
 HIGHLAND ELEMENTARY-HIGH SCHOOL

FILE NO.	AANOKC0001.00	1
DATE	10/27/2008	5