

ORIGINAL

# AUDITOR'S PLAT No. 2.

## ANOKA COUNTY.

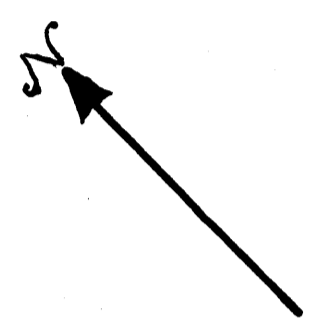

Scale: 1 inch = 100 feet.

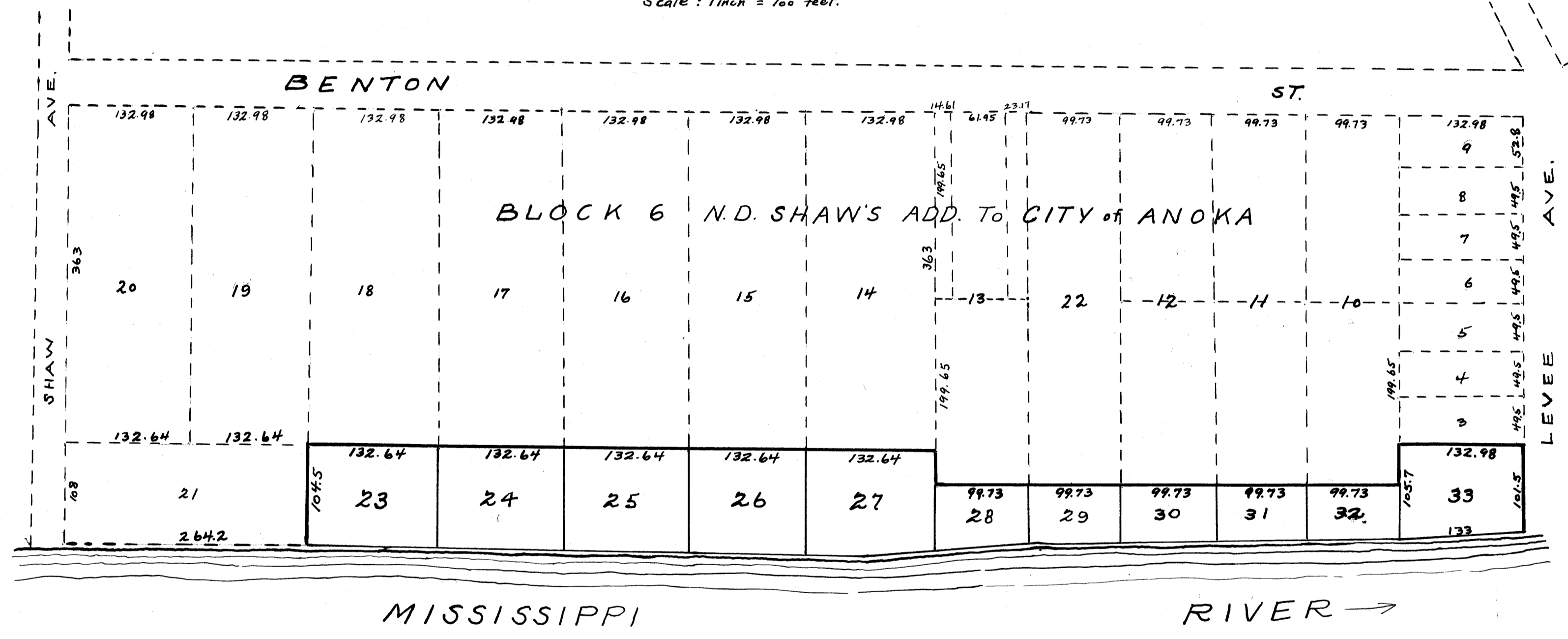

I, E. A. Carlson, Auditor of Anoka County, Minnesota do hereby certify that Wayne L. Ridge, County Surveyor of said County at my request surveyed and platted the property designated by this plat as "Auditor's Plat No. 2" in pursuance of Section 991 of Revised Laws of 1905 and as amended by Chapter 32, Laws of 1911

*E. A. Carlson*  
County Auditor

Above certificate subscribed and sworn to before me this 3rd day of August, 1933.

*Thos. A. Nelson*  
Clerk of District Court  
Anoka County, Minn.

I hereby certify that I have surveyed and platted the property described in this plat as "Auditor's Plat No. 2"; that this plat is a correct representation of said survey; that all distances are correctly shown in feet and decimals of a foot; that the outside boundary lines are correctly designated on the plat, and that there are no public highways other than as shown.

*Wayne L. Ridge*  
County Surveyor

Above certificate subscribed and sworn to before me this 3rd day of August, 1933.

*Thos. A. Nelson*  
Clerk of District Court  
Anoka County, Minn.

MISSISSIPPI RIVER →

### DESCRIPTION OF PLAT.

A strip of land on the River Bank, southerly of the platted portion of Block 6 of N.D. Shaw's Addition to the City of Anoka and containing about 2.25 acres, and to be known as Lots 23 to 32 inclusive of "Auditor's Plat No. 2"; also Lots 1 and 2 of Block 6 of N.D. Shaw's Addition to the City of Anoka and to be known as Lot 33 of "Auditor's Plat No. 2".

Doc. No. 776  
 OFFICE OF REGISTER OF DEEDS,  
 STATE OF MINNESOTA, COUNTY OF ANOKA

*Conrad Cypher*  
Register of Deeds

Doc. No. 776  
 OFFICE OF REGISTRAR OF TITLES,  
 STATE OF MINNESOTA,  
 COUNTY OF ANOKA

I hereby certify that the within instrument was filed in this office on the 3rd day of August, A. D. 1933 at 2 o'clock P. M.

*Conrad Cypher*, Registrar of Titles

DEPUTY REGISTRAR OF TITLES

