

# CENTRAL AVENUE

## ADDITION

TO  
MINNEAPOLIS

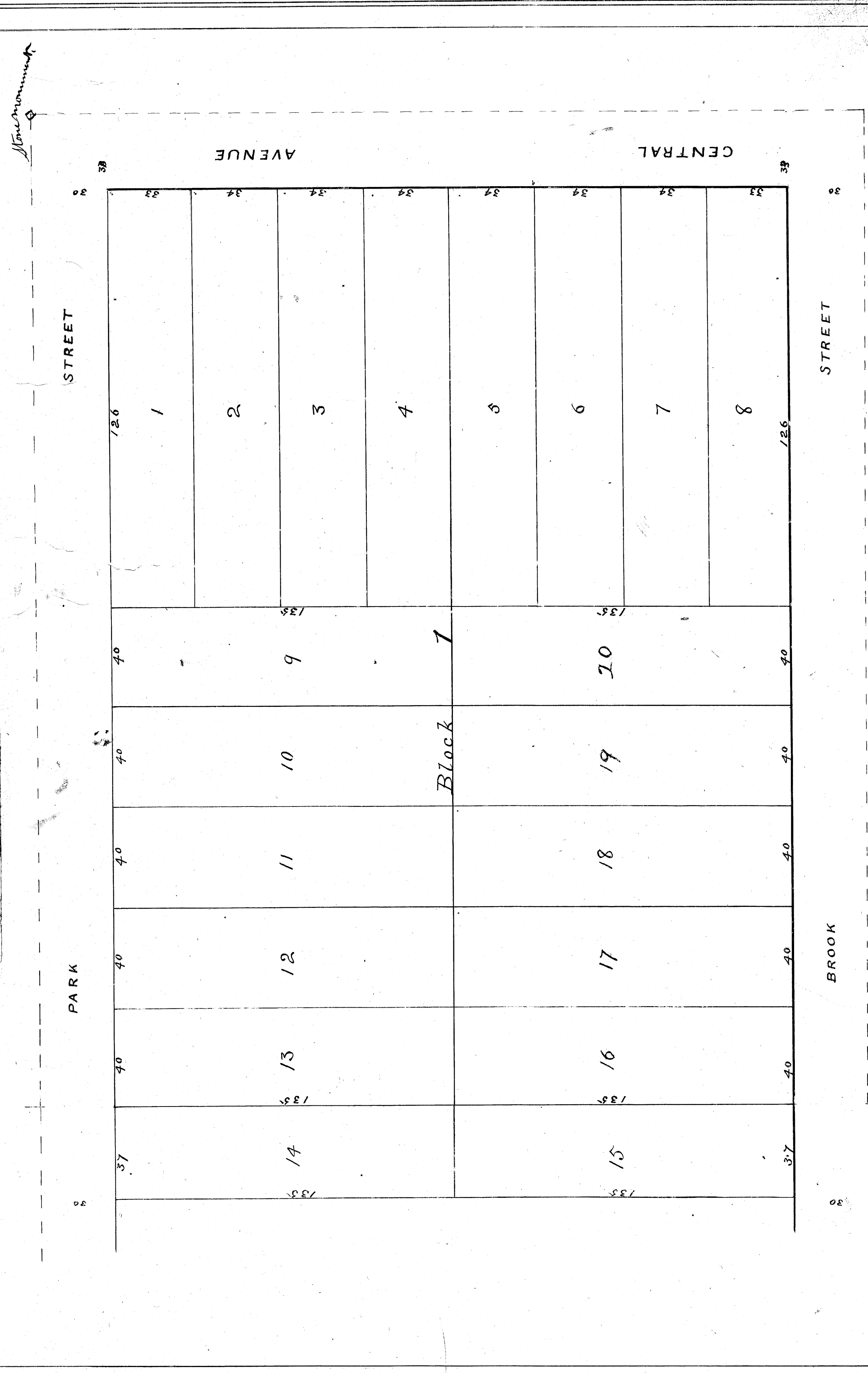

County Shirens office  
Ancker Minn May 1893  
I hereby certify that this is correct in every particular  
as set forth in the subsequent descriptions of L. P. Atterson.

I hereby certify that I have made a survey of  
and that the above is a true and correct plat of  
the same described as follows: Beginning at the North  
East corner of the South West quarter (1/4) of section twelve (12)  
Township thirty (30) Range twenty four (24) and running  
North thirty (30) degrees East thirty (30) feet to the place of beginning  
that the two streets and avenues in said sub-  
division are as indicated by the figures upon the  
above drawing and that there is a stone placed  
on the North East corner of said sub-division, upon  
which to make future surveys.

J. R. Lewis  
Level Eng

State of Minnesota  
County of Hennepin  
Before me a Notary Public in and for said  
County on the 9th day of March A. D. 1893. Personally came  
J. R. Lewis. Is one well known as the person described  
in, and who executed the above certificate and  
acknowledges the signing of the same as his free  
act and deed.

Notary Public in and for  
Hennepin County

# before me the Register of Deeds within and for said County  
of Hennepin to one well known to be the same person described in and  
who executed the foregoing certificate and acknowledged that he  
is the same as who said free act and deed.

Margaret Allinger, John Allinger  
and Ernest E. Blanchard - Owners and Proprietors  
of Real Estate described as follows: Beginning at the North  
East corner of Section 12 Township thirty (30) Range twenty four (24) and  
(1/4) of Section 12 Township thirty (30) Range twenty four (24) and  
running West twenty four (24) rods thence South twenty (20) rods thence  
East twenty four (24) rods thence North twenty rods to place of beginning  
and I hereby certify that they have caused this  
same to be surveyed and platted as indicated by  
the above drawing and have called the same  
Central Avenue Addition and that I hereby  
dedicate to the Public use forever all lands  
indicated on the above drawing as streets and  
Avenues

Margaret Allinger  
John Allinger  
Ernest E. Blanchard

State of Minnesota  
County of Hennepin  
Before me a Notary Public, in and for  
said County on the 9th day of March A. D. 1893. Personally  
came Margaret Allinger, John Allinger, Ernest E. Blanchard  
Is one well known as the persons described in  
and who executed the above dedication and  
acknowledges the signing of the same to be  
their free act and deed.

Notary Public in and for  
Hennepin County

12999  
OFFICE OF REGISTER OF DEEDS  
COUNTY OF ANOKA, MINN.  
I hereby certify that the within instrument  
was filed in this office for record on the  
day of \_\_\_\_\_ A. D. 18\_\_\_\_ at  
\_\_\_\_\_ o'clock \_\_\_\_\_ and was duly recorded in  
Book \_\_\_\_\_ Page \_\_\_\_\_

1893  
May 13th 1893  
J. M. Johnson  
Notary Public in and for  
Hennepin County