

CIC NUMBER 7 HILLWIND TOWNHOMES, A COMMON INTEREST COMMUNITY

This CIC Plat is part of the Declaration recorded as Document No. 1156207 on this 8 day of March, 1995.

County Recorder

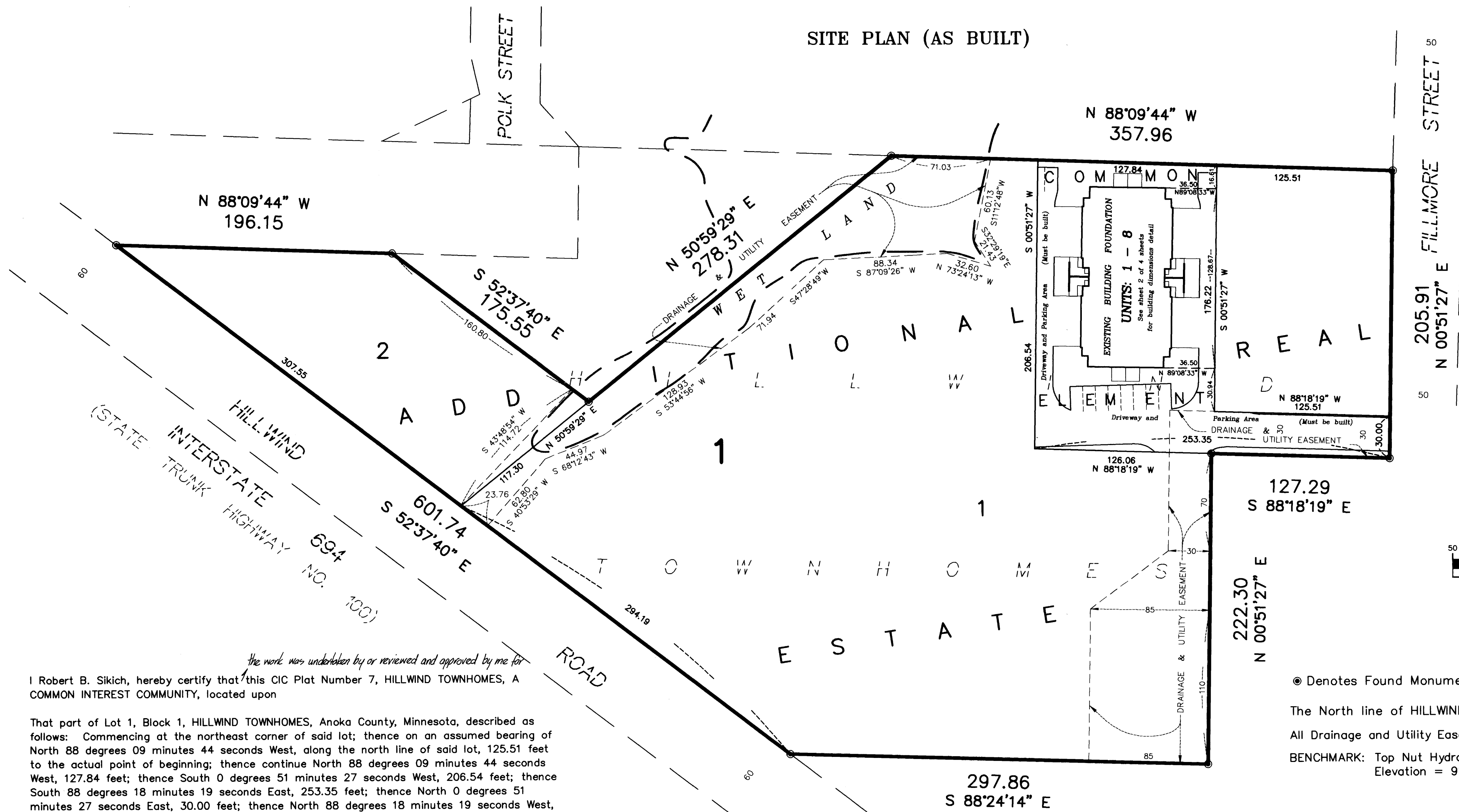

1156207
 OFFICE OF COUNTY RECORDER
 STATE OF MINNESOTA, COUNTY OF ANOKA
 I hereby certify that the within instrument was filed in this office for record on the March 8 A.D., 1995 at 2 o'clock P.M., and was duly recorded in book 1 of CIC Plats 7 page 7
Edward M. Treska
 County Recorder
 By A.J.H.
 Deputy

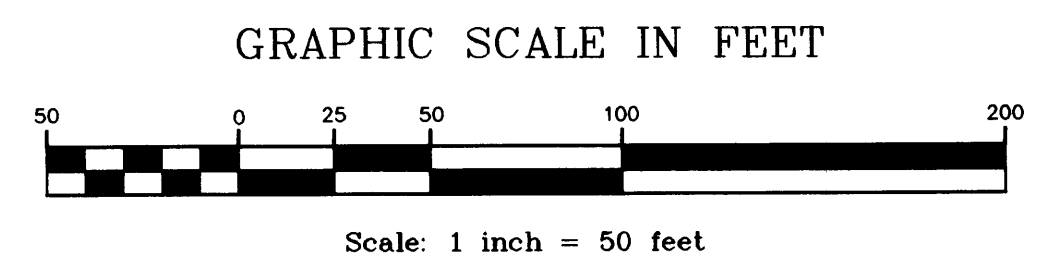

I Robert B. Sikich, hereby certify that this CIC Plat Number 7, HILLWIND TOWNHOMES, A COMMON INTEREST COMMUNITY, located upon

That part of Lot 1, Block 1, HILLWIND TOWNHOMES, Anoka County, Minnesota, described as follows: Commencing at the northeast corner of said lot; thence on an assumed bearing of North 88 degrees 09 minutes 44 seconds West, along the north line of said lot, 125.51 feet to the actual point of beginning; thence continue North 88 degrees 09 minutes 44 seconds West, 127.84 feet; thence South 0 degrees 51 minutes 27 seconds West, 206.54 feet; thence South 88 degrees 18 minutes 19 seconds East, 253.35 feet; thence North 0 degrees 51 minutes 27 seconds East, 30.00 feet; thence North 88 degrees 18 minutes 19 seconds West, 125.51 feet; thence North 0 degrees 51 minutes 27 seconds East, 176.22 feet to the point of beginning.

and the Additional Real Estate described as follows:
 Lot 1, except described as follows: Commencing at the northeast corner of said lot; thence on an assumed bearing of North 88 degrees 09 minutes 44 seconds West, along the north line of said lot, 125.51 feet to the actual point of beginning; thence continue North 88 degrees 09 minutes 44 seconds West, 127.84 feet; thence South 0 degrees 51 minutes 19 seconds East, 253.35 feet; thence North 0 degrees 51 minutes 27 seconds East, 30.00 feet; thence North 88 degrees 18 minutes 19 seconds West, 125.51 feet; thence North 0 degrees 51 minutes 27 seconds East, 176.22 feet to the point of beginning.

Lot 2, Block 1, all in HILLWIND TOWNHOMES, Anoka County, Minnesota according to the recorded plats thereof,
 fully and accurately depicts all information required by Minnesota Statutes, Section 515 B. 2-110, as amended.

Dated this 17th day of February, 1995
Robert B. Sikich
 Robert B. Sikich, Land Surveyor
 Minnesota License No. 14891

STATE OF MINNESOTA
 COUNTY OF ANOKA ss.
 The foregoing instrument was acknowledged before me this 17th day of February 1995 by Robert B. Sikich, a License Professional Land Surveyor.

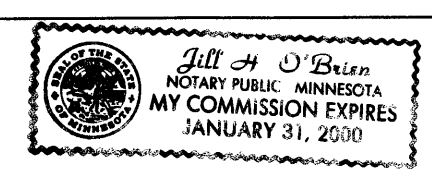

John J. O'Brien
 Notary Public, Anoka County, Minnesota
 My Commission Expires 1-31-2000

I, William J. Wilkos, pursuant to Minnesota Statutes, Section 515 B. 2-101 (c), hereby certify that all units and all structural components and mechanical systems serving more than one unit of all buildings containing or comprising any units hereby created, are substantially completed consistent with this CIC Plat Number 7, HILLWIND TOWNHOMES, A COMMON INTEREST COMMUNITY.

Dated this 10 day of February, 1995.

William J. Wilkos
 Registered Professional Architect
 Minnesota Registration No. 16382

STATE OF MINNESOTA
 COUNTY OF ANOKA ss.
 The foregoing instrument was acknowledged before me this 10 day of February 1995 by William Wilkos a Registered Professional Architect.

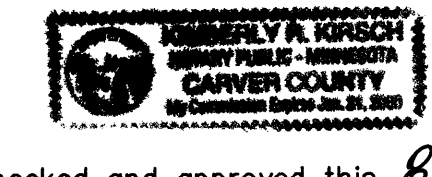

Kimberly A. Kusch
 Notary Public, Anoka County, Minnesota
 My Commission Expires 1-31-2000

Checked and approved this 8th day of March, 1995.
Edward M. Treska
 Anoka County Surveyor

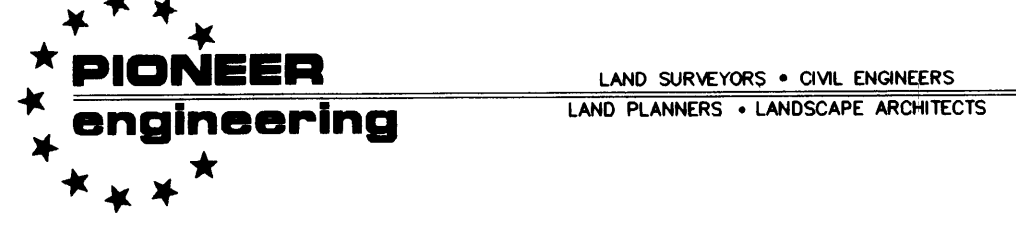
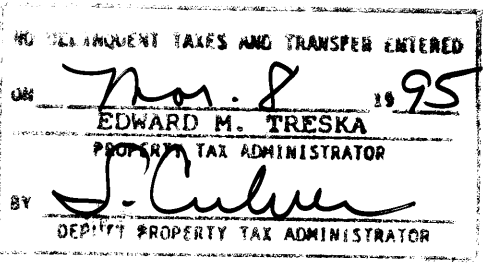

CIC NUMBER 7

HILLWIND TOWNHOMES, A COMMON INTEREST COMMUNITY

C O M M O N

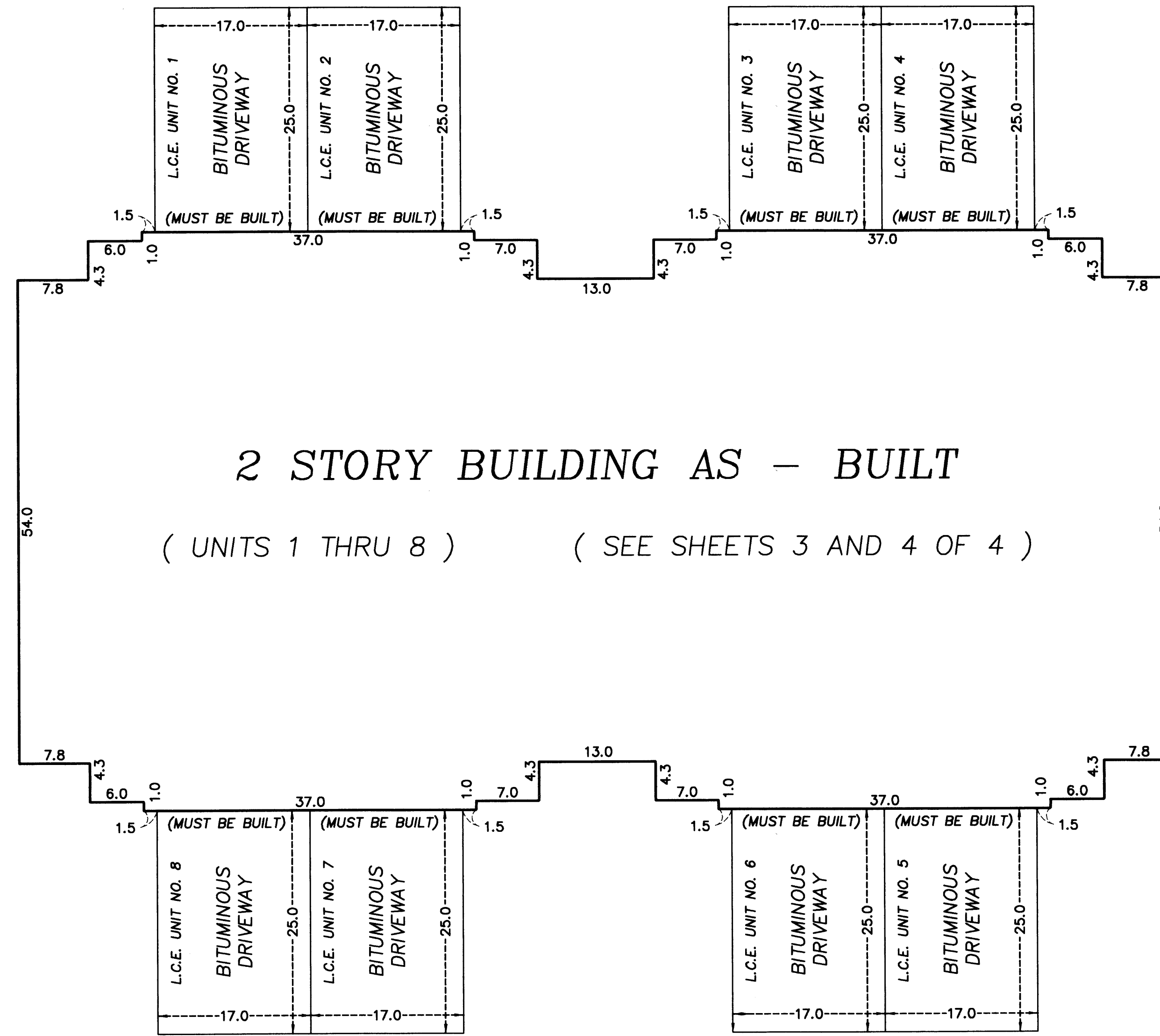

2 STORY BUILDING AS - BUILT
(UNITS 1 THRU 8) (SEE SHEETS 3 AND 4 OF 4)

L.C.E. Denotes Limited Common Element

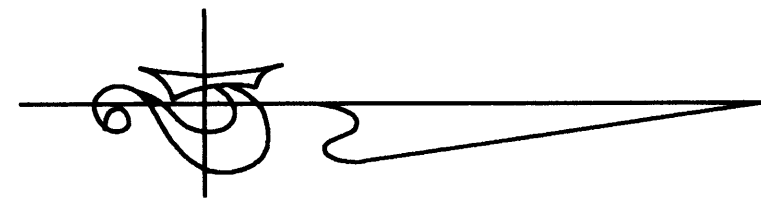

E L E M E N T

GRAPHIC SCALE IN FEET



Scale: 1 inch = 10 feet

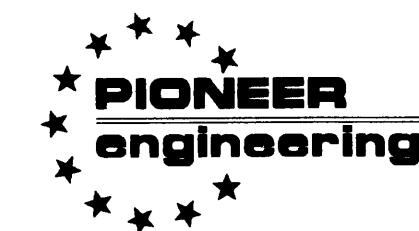

LAND SURVEYORS • CIVIL ENGINEERS
LAND PLANNERS • LANDSCAPE ARCHITECTS

CIC NUMBER 7 HILLWIND TOWNHOMES, A COMMON INTEREST COMMUNITY

FLOOR PLANS

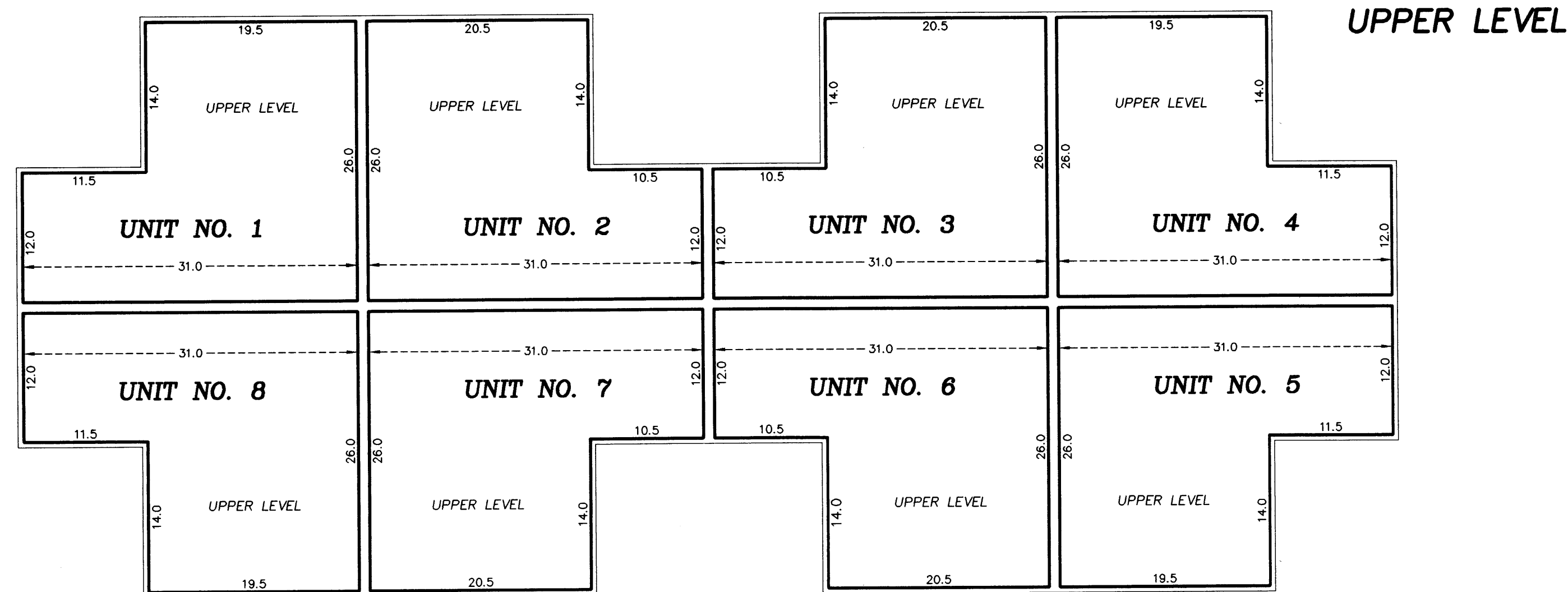

UNIT NO. 1
 UPPER LEVEL = 645 sq. ft.
 LOWER LEVEL = 589 sq. ft.
 GARAGE = 333 sq. ft.
 TOTAL = 1567 sq. ft.

UNIT NO. 5
 UPPER LEVEL = 645 sq. ft.
 LOWER LEVEL = 589 sq. ft.
 GARAGE = 333 sq. ft.
 TOTAL = 1567 sq. ft.

UNIT NO. 2
 UPPER LEVEL = 659 sq. ft.
 LOWER LEVEL = 589 sq. ft.
 GARAGE = 333 sq. ft.
 TOTAL = 1581 sq. ft.

UNIT NO. 6
 UPPER LEVEL = 659 sq. ft.
 LOWER LEVEL = 589 sq. ft.
 GARAGE = 333 sq. ft.
 TOTAL = 1581 sq. ft.

UNIT NO. 3
 UPPER LEVEL = 659 sq. ft.
 LOWER LEVEL = 589 sq. ft.
 GARAGE = 333 sq. ft.
 TOTAL = 1581 sq. ft.

UNIT NO. 7
 UPPER LEVEL = 659 sq. ft.
 LOWER LEVEL = 589 sq. ft.
 GARAGE = 333 sq. ft.
 TOTAL = 1581 sq. ft.

UNIT NO. 4
 UPPER LEVEL = 645 sq. ft.
 LOWER LEVEL = 589 sq. ft.
 GARAGE = 333 sq. ft.
 TOTAL = 1567 sq. ft.

UNIT NO. 8
 UPPER LEVEL = 645 sq. ft.
 LOWER LEVEL = 589 sq. ft.
 GARAGE = 333 sq. ft.
 TOTAL = 1567 sq. ft.

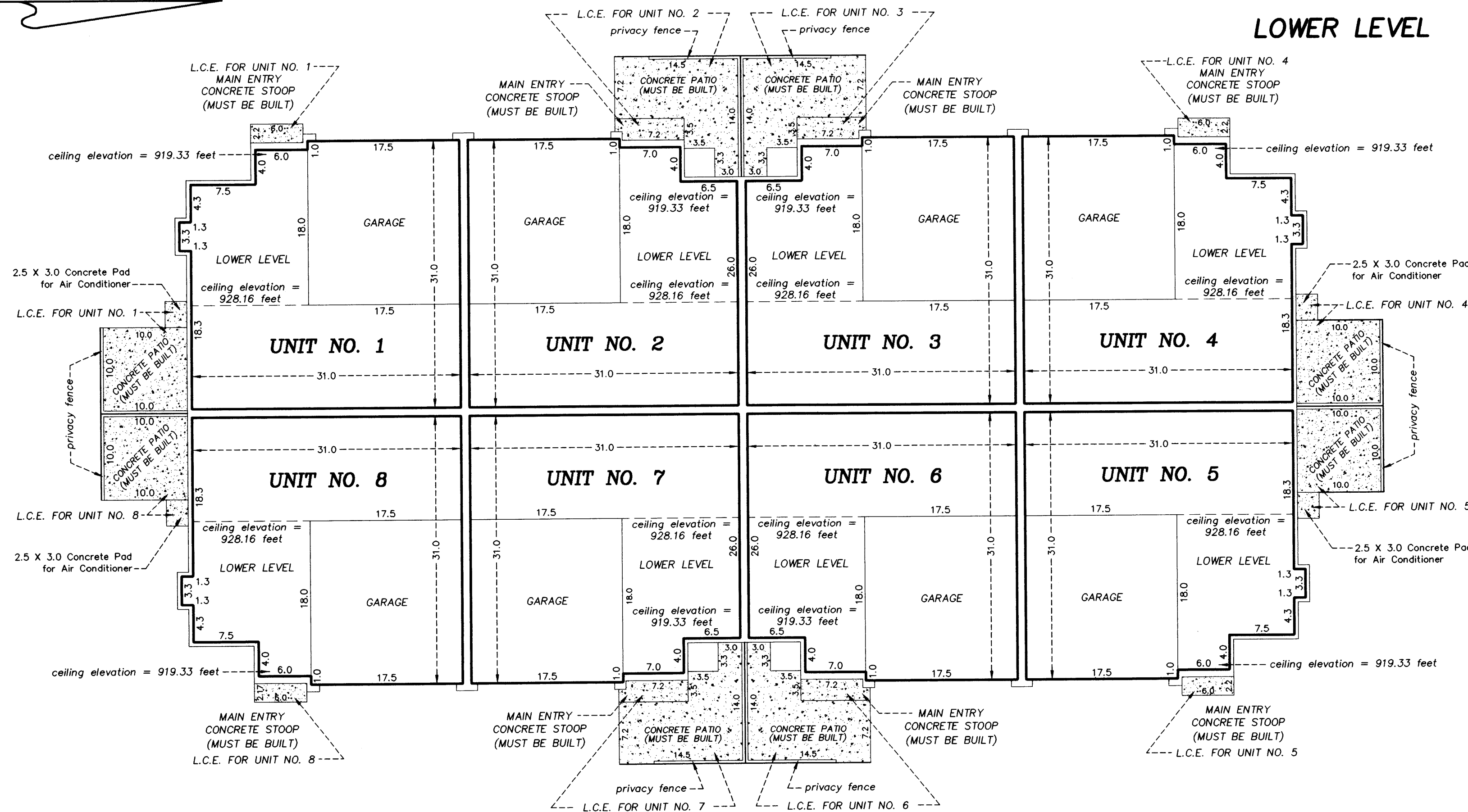
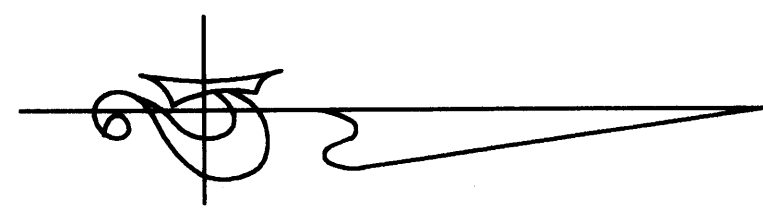

Interior Dimensions shown are measured to the unfinished surface of the walls, floors and ceilings

L.C.E. Denotes Limited Common Element

Elevations are referred to Benchmark as noted on site plan and are shown in feet and hundredths of a foot

All upper level unit floor elevations = 920.16 feet
 All upper level unit ceiling elevations = 928.16 feet

All lower level unit floor elevations = 911.33 feet
 All lower level unit ceiling elevations vary from 919.33 feet to 928.16 feet

Garage floor elevation = 910.00 feet

All privacy fences are Common Element and must be built.

GRAPHIC SCALE IN FEET



Scale: 1 inch = 10 feet

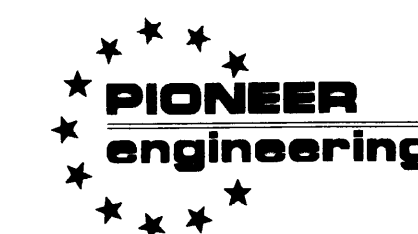

LAND SURVEYORS • CIVIL ENGINEERS
 LAND PLANNERS • LANDSCAPE ARCHITECTS

CIC NUMBER 7

HILLWIND TOWNHOMES, A COMMON INTEREST COMMUNITY

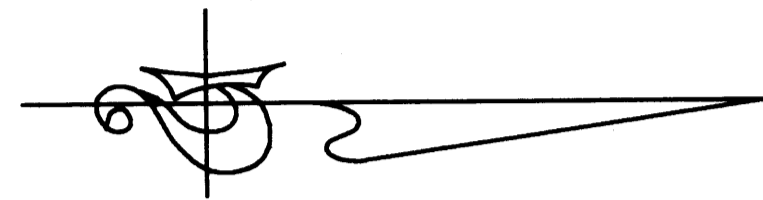

UNIT NO. 1
BASEMENT LEVEL = 559 sq. ft.

UNIT NO. 5
BASEMENT LEVEL = 559 sq. ft.

UNIT NO. 2
BASEMENT LEVEL = 576 sq. ft.

UNIT NO. 6
BASEMENT LEVEL = 576 sq. ft.

UNIT NO. 3
BASEMENT LEVEL = 576 sq. ft.

UNIT NO. 7
BASEMENT LEVEL = 576 sq. ft.

UNIT NO. 4
BASEMENT LEVEL = 559 sq. ft.

UNIT NO. 8
BASEMENT LEVEL = 559 sq. ft.

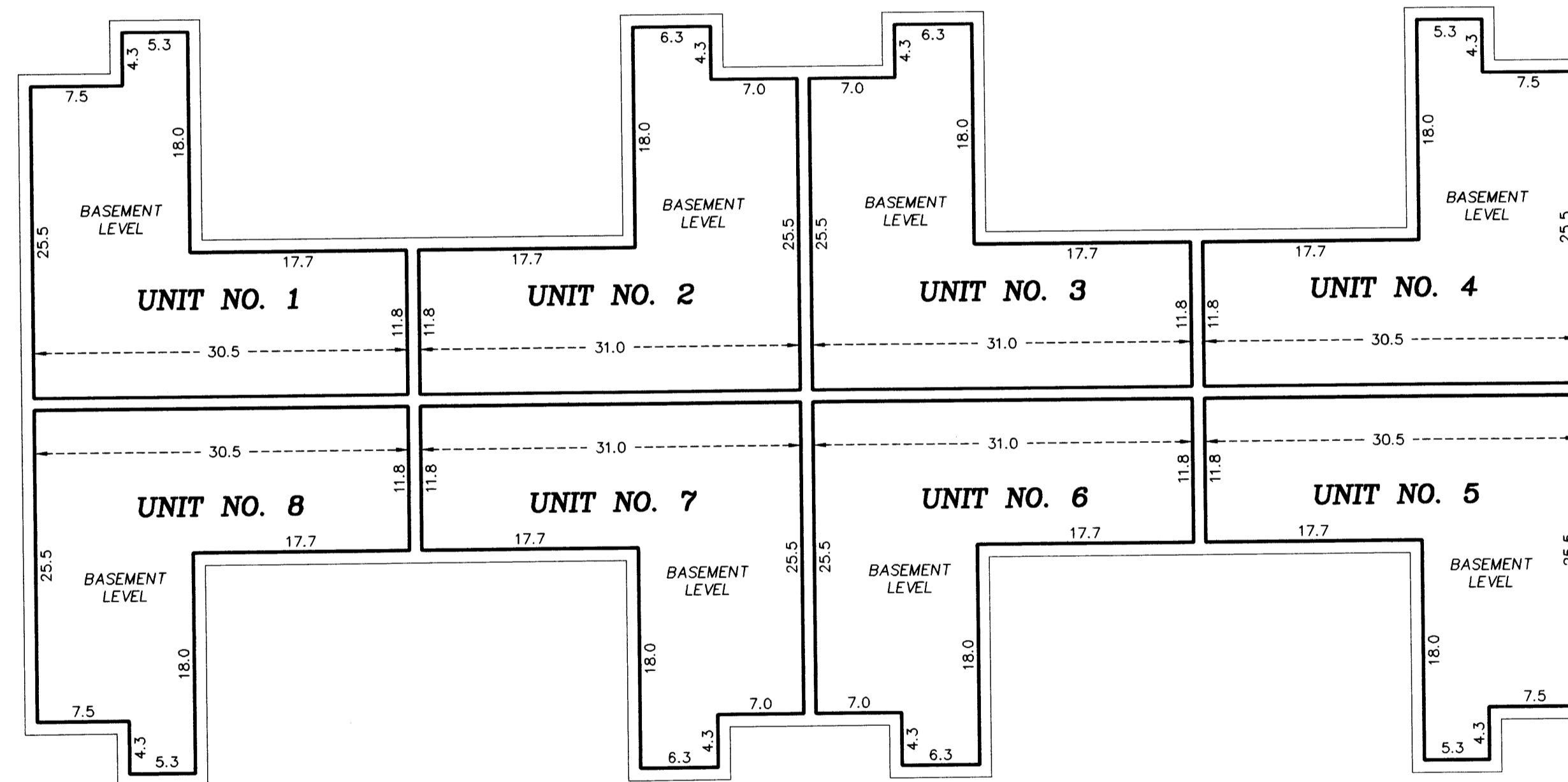

BASEMENT LEVEL

Interior Dimensions shown are measured to the unfinished surface of the walls, floors and ceilings

L.C.E. Denotes Limited Common Element

Elevations are referred to Benchmark as noted on site plan and are shown in feet and hundredths of a foot

*All basement level unit floor elevations = 902.63 feet
All basement level unit ceiling elevations = 910.50 feet*

All privacy fences are Common Element and must be built.

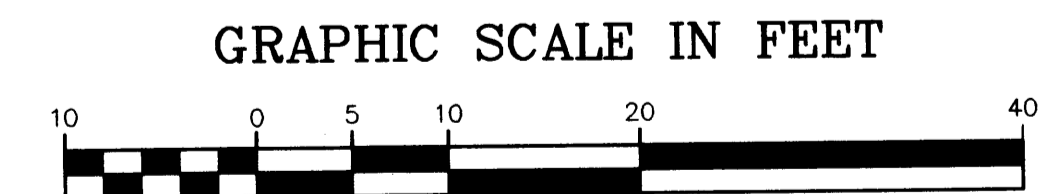

Scale: 1 inch = 10 feet

