

CIC NUMBER 19 PARK HEIGHTS TOWNHOMES

FIRST SUPPLEMENTAL CONDOMINIUM PLAT

SITE PLAN (AS BUILT)

This First Supplemental CIC plat is part of the First Amendment to the Declaration recorded as Document No. 1260175 on this 14th day of Jan, 1997

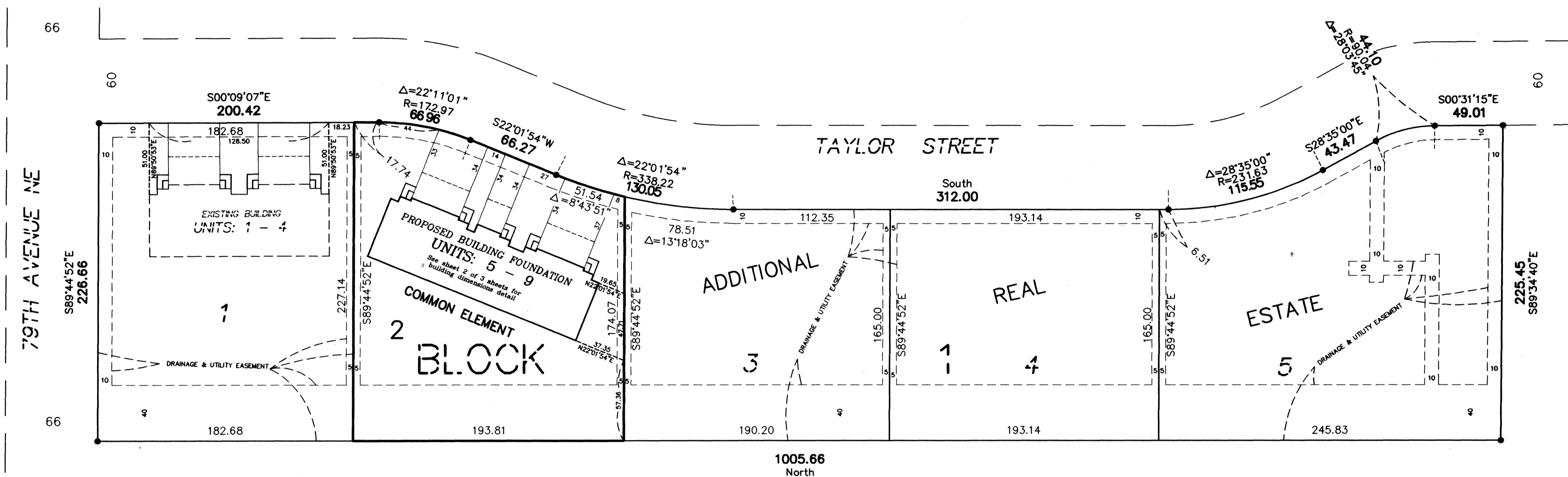

I, Robert B. Sikich, hereby certify that the work was undertaken by or reviewed and approved by me for this First Supplemental CIC Plat of CIC Number 19, PARK HEIGHTS TOWNHOMES being located upon

Lot 2, Block 1, PARK HEIGHTS TOWNHOMES, Anoka County, Minnesota

and the additional real estate is located upon the following described property designated as:

Lots 3, 4 and 5 Block 1, PARK HEIGHTS TOWNHOMES, Anoka County, Minnesota

fully and accurately depicts all information required by Minnesota Statutes, Section 515 B. 2-110.

Dated this 9th day of January, 19 97

Robert B. Sikich
Robert B. Sikich, Land Surveyor
Minnesota License No. 14891

STATE OF MINNESOTA
COUNTY OF ANOKA

The foregoing certificate was acknowledged before me this 8th day of January, 19 97, by Robert B. Sikich, a Licensed Professional Land Surveyor.

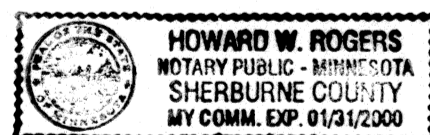

Howard W. Rogers
Notary Public, Sherburne County, Minnesota
My Commission Expires Jan 31, 2000

I, Michael J. Wilkies, pursuant to Minnesota Statutes, Section 515B.2-101(c), do hereby certify that all the units and all structural components and mechanical systems of all buildings containing or comprising any units hereby created, are substantially completed.

Dated this 10 day of January, 19 97

Michael J. Wilkies
Licensed Professional Architect
Minnesota License No. 16380

STATE OF MINNESOTA
COUNTY OF ANOKA

The foregoing certificate was acknowledged before me this 10 day of January, 19 97, by Michael J. Wilkies, a Licensed Professional Architect.



Robert B. Kessel
Notary Public, Anoka County, Minnesota
My Commission Expires Jun 01, 2000

Checked and approved this 14th day of JAN, 19 97.

Merlyn D. Anderson by Larry D. [Signature]
Anoka County Surveyor deputy

Doc # 1260175

OFFICE OF COUNTY RECORDS
STATE OF MINNESOTA, COUNTY OF ANOKA
I hereby certify that the within instrument was filed in this office for record on the 14th day of Jan, A.D. 1997 at 12:00 o'clock P.M. and was recorded in book 309 CIC page 5

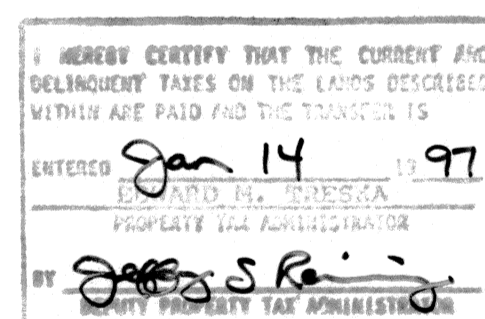

Edward M. Treaska
PROPERTY TAX ADMINISTRATOR
by BLP

BENCHMARK:

Top nut of hydrant at the intersection of Taylor Street and 79th Avenue Northeast
Elevation = 908.78 feet (NGVD 1929)

● Denotes Found Iron Monument

The north line of Lot 1, Block 1, PARK HEIGHTS TOWNHOMES has an assumed bearing of S 89°44'52" E.

All Drainage and Utility Easements shown were dedicated in the plat of PARK HEIGHTS TOWNHOMES.

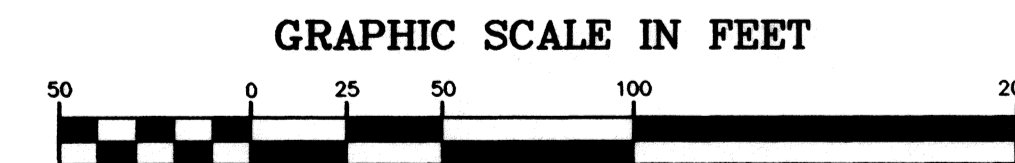
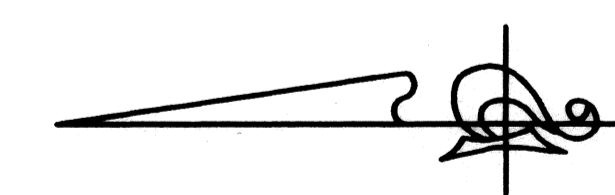

Scale: 1 inch = 50 feet

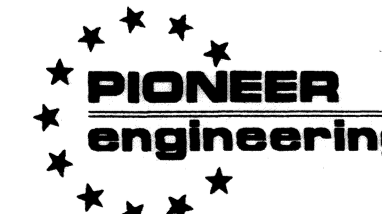

LAND SURVEYORS • CIVIL ENGINEERS
LAND PLANNERS • LANDSCAPE ARCHITECTS

CIC NUMBER 19 PARK HEIGHTS TOWNHOMES FIRST SUPPLEMENTAL CONDOMINIUM PLAT

DETAIL

C O M M O N

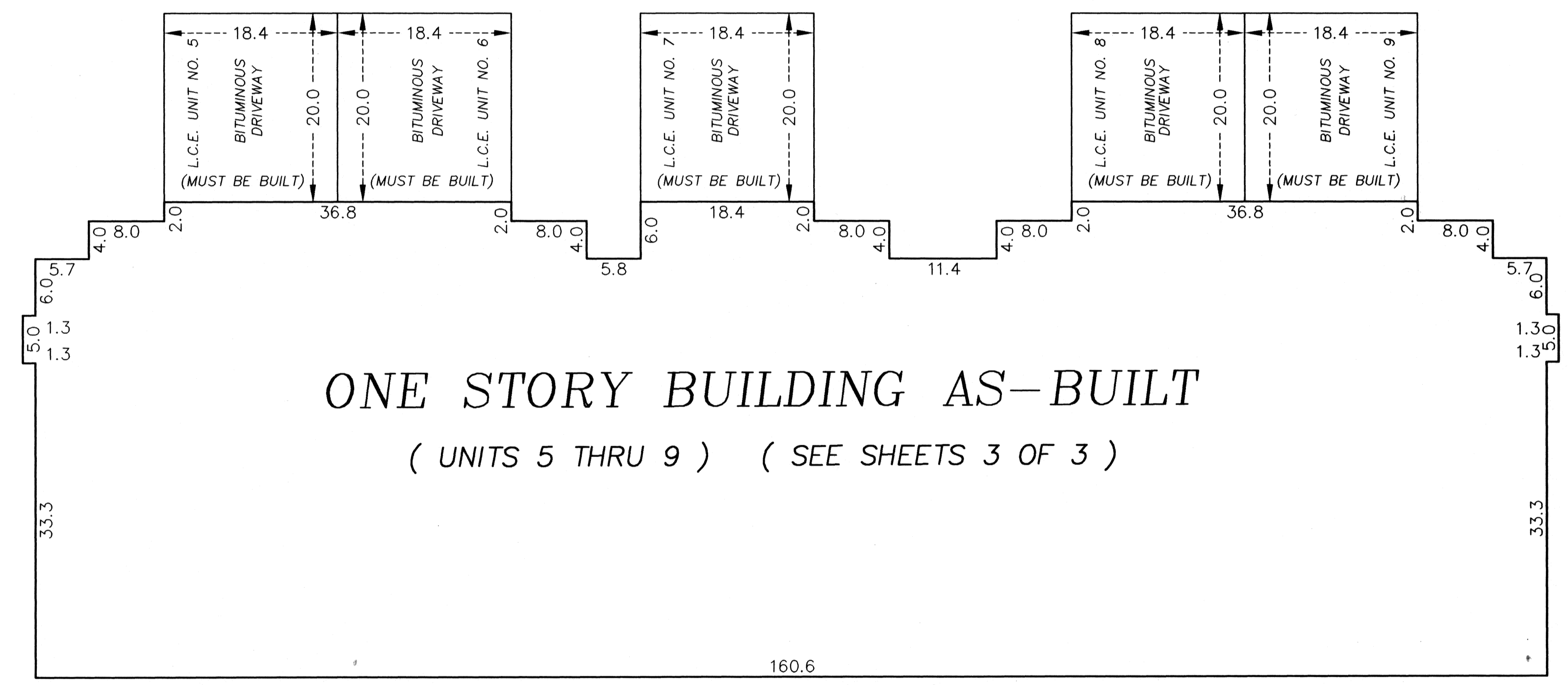

ONE STORY BUILDING AS-BUILT
(UNITS 5 THRU 9) (SEE SHEETS 3 OF 3)

E L E M E N T

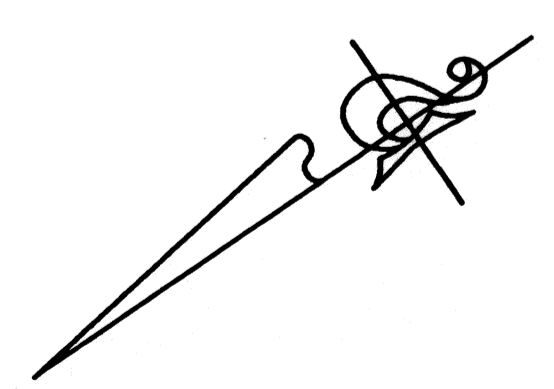

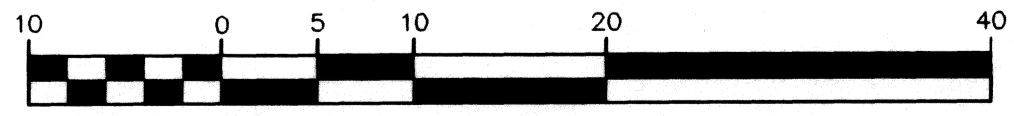
L.C.E. Denotes Limited Common Element
 GRAPHIC SCALE IN FEET

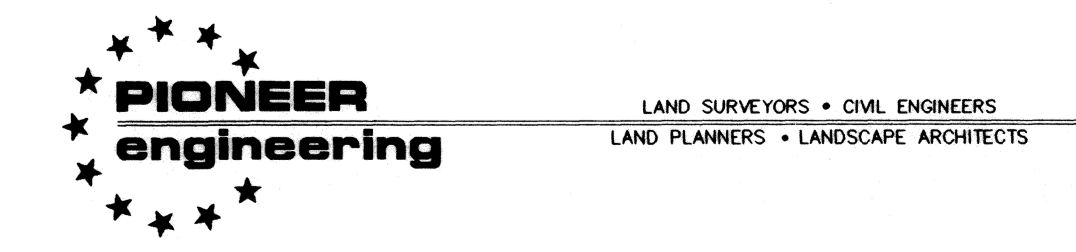
 Scale: 1 inch = 10 feet



CIC NUMBER 19 PARK HEIGHTS TOWNHOMES

FIRST SUPPLEMENTAL CONDOMINIUM PLAT

FLOOR PLANS

MAIN LEVEL

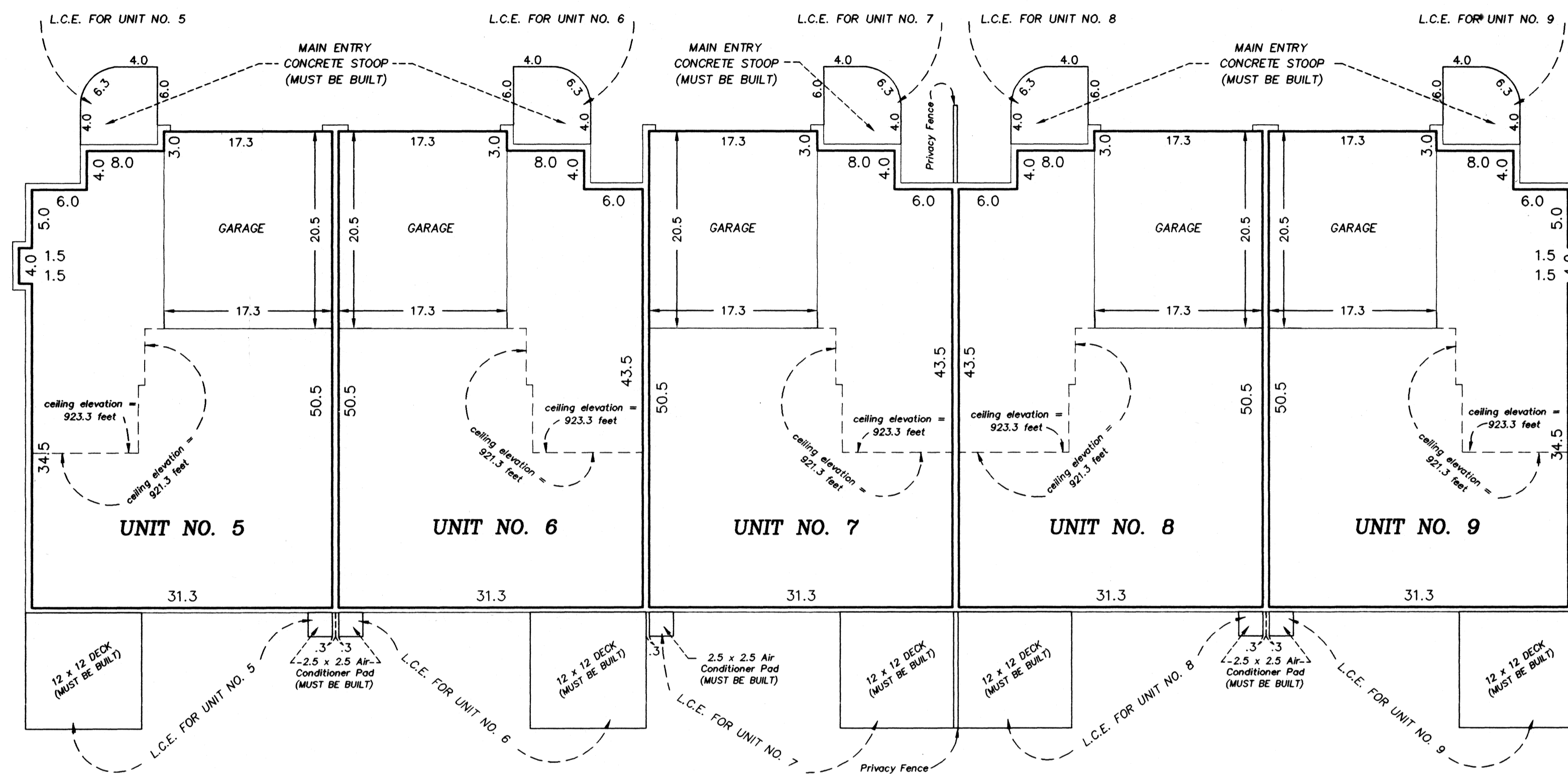

Interior Dimensions shown are measured to the unfinished surface of the walls, floors and ceilings

L.C.E. Denotes Limited Common Element

Elevations are referred to Benchmark as noted on site plan and are shown in feet and tenths of a foot

All units garage floor elevations = 912.5 feet
All units main level floor elevations = 913.3 feet
All units main level ceiling elevations vary from 921.3 feet to 923.3 feet
All units basement level floor elevations = 903.4 feet
All units basement level ceiling elevations = 912.1 feet

All privacy fences are Common Elements and must be built.

BASEMENT LEVEL

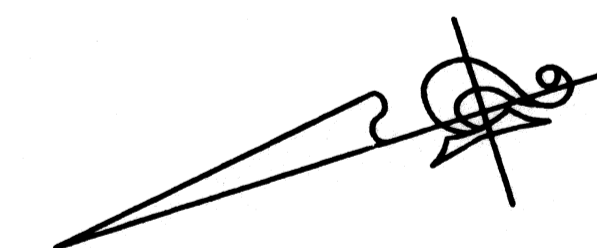
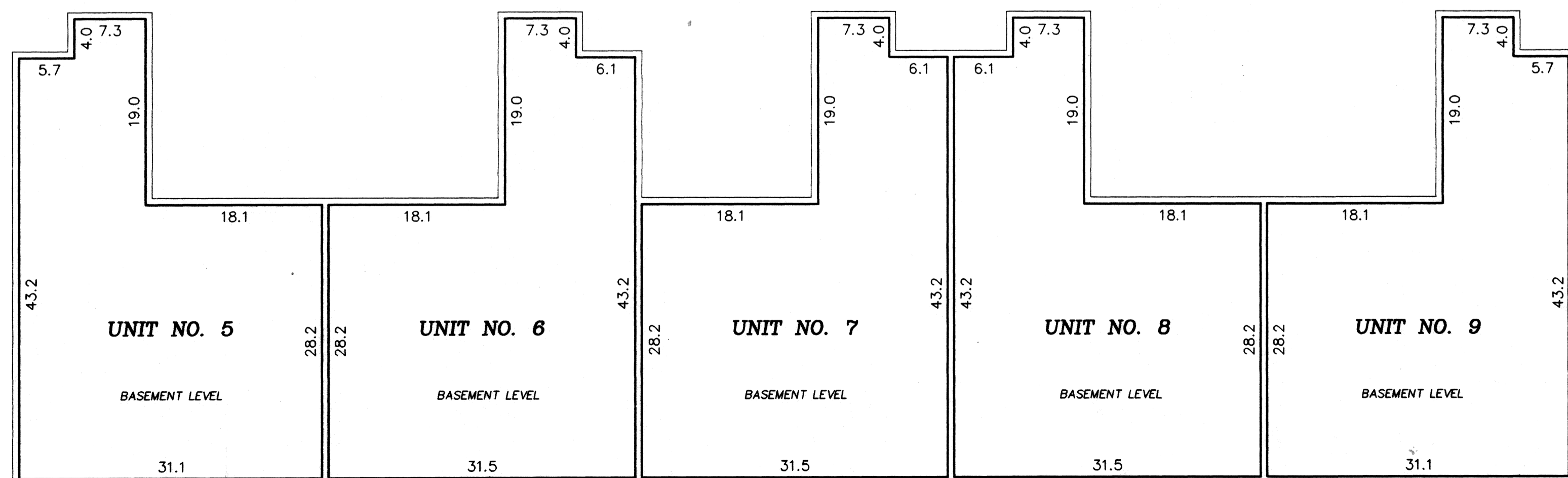

GRAPHIC SCALE IN FEET

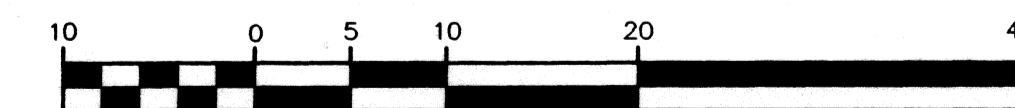

Scale: 1 inch = 10 feet

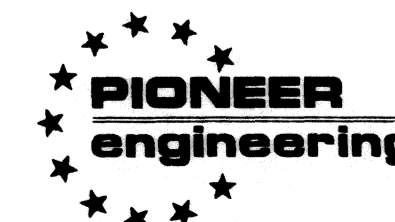

LAND SURVEYORS • CIVIL ENGINEERS
LAND PLANNERS • LANDSCAPE ARCHITECTS