

CIC NUMBER 239

A CONDOMINIUM HANSON STATION CIC PLAT

BK9 CIC
P9 50

This CIC Plat is part of the Declaration filed as Document No. 1991528.003 on this 8th day of March, 2007, at 11:59 o'clock A.M.

SEC. 15, T.31, R. 24
COON RAPIDS
ANOKA COUNTY

I, Travis W. Van Neste, do hereby certify that the work was undertaken by or reviewed and approved by me for this CIC PLAT of CIC NUMBER 239, HANSON STATION, a condominium being located upon the following described property:

Lot 1, Block 1, HANSON STATION LOFTS, according to the recorded plat thereof, Anoka County, Minnesota, except that part of said Lot 1, Block 1, described as follows:
Commencing at the northwest corner of said Lot 1, Block 1; thence on an assumed bearing of South 01 degree 14 minutes 50 seconds West, along the west line of said Lot 1, a distance of 36.97 feet; thence South 88 degrees 18 minutes 58 seconds East a distance of 51.89 feet to the point of beginning of the land to be described; thence continuing South 88 degrees 18 minutes 58 seconds East a distance of 92.33 feet; thence South 01 degree 41 minutes 02 seconds West a distance of 158.00 feet; thence North 88 degrees 18 minutes 58 seconds West a distance of 92.33 feet; thence North 01 degree 41 minutes 02 seconds East a distance of 158.00 feet to the point of beginning.

and the Additional Real Estate described as follows:

That part of Lot 1, Block 1, HANSON STATION LOFTS, according to the recorded plat thereof, Anoka County, Minnesota, described as follows:
Commencing at the northwest corner of said Lot 1, Block 1; thence on an assumed bearing of South 01 degree 14 minutes 50 seconds West, along the west line of said Lot 1, a distance of 36.97 feet; thence South 88 degrees 18 minutes 58 seconds East a distance of 51.89 feet to the point of beginning of the land to be described; thence continuing South 88 degrees 18 minutes 58 seconds East a distance of 92.33 feet; thence South 01 degree 41 minutes 02 seconds West a distance of 158.00 feet; thence North 88 degrees 18 minutes 58 seconds West a distance of 92.33 feet; thence North 01 degree 41 minutes 02 seconds East a distance of 158.00 feet to the point of beginning.

fully and accurately depicts all information required by Minnesota Statutes, Section 515B.2-110, Dated this 6TH day of MARCH, 2007.

Travis W. Van Neste
Travis W. Van Neste, Land Surveyor
MINNESOTA LICENSE No. 44109

STATE OF MINNESOTA
COUNTY OF DAKOTA
The foregoing instrument was acknowledged before me this 6th day of March, 2007, by Travis W. Van Neste, a Land Surveyor, MINNESOTA LICENSE No. 44109

Jessika Carolyn Bell
Notary Public, Dakota County, Minnesota
My Commission expires Jan. 31, 2011

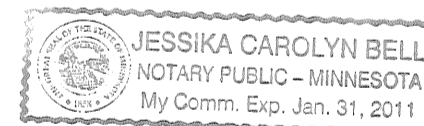

I, David A. Roedel pursuant to Minnesota Statutes, Section 515B.2-101(c), do hereby certify that the structural components of the structures containing the units and the mechanical systems serving more than one unit are substantially completed. Dated this 6 day of March, 2007.

David A. Roedel, Licensed Engineer
Minnesota License No. 22434

STATE OF MINNESOTA
COUNTY OF Dakota

The foregoing instrument was acknowledged before me this 6th day of March, 2007, by David A. Roedel, a Licensed Engineer
Minnesota License No. 22434

Jessika Carolyn Bell
Notary Public, Dakota County, Minnesota
My Commission expires Jan. 31, 2011

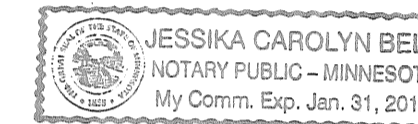

COUNTY SURVEYOR
ANOKA COUNTY, MINNESOTA

Pursuant to Minnesota Statutes, Chapter 389.09, Subd. 2, this CIC plat has been reviewed and is approved this 8TH day of MARCH, 2007.

By: Larry D. Hill
Anoka County Surveyor

1991528.003

OFFICE OF COUNTY RECORDER
STATE OF MINNESOTA, COUNTY OF ANOKA
I hereby certify that the within instrument was filed in this office for record on the 8th day of March, A.D., 2007 at 11:59 o'clock A.M., and was duly recorded in book 9CIC page 50
Margaret J. Devine
County Recorder
By: BMC
Deputy

I HEREBY CERTIFY THAT THE CURRENT AND DELINQUENT TAXES ON THE LANDS DESCRIBED WITHIN ARE PAID AND THE TRANSFER IS ENTERED March 8, 2007
MARGARET J. DEVINE
PROPERTY TAX ADMINISTRATOR
BY: S. Culver
DEPUTY PROPERTY TAX ADMINISTRATOR

\$56

SCHOELL MADSON
PLANNING * ENGINEERING * SURVEYING

SITE PLAN
(AS - BUILT)

CIC NUMBER 239

A CONDOMINIUM HANSON STATION CIC PLAT

SEC. 15, T.31, R. 24
COON RAPIDS
ANOKA COUNTY

bk901c
P50

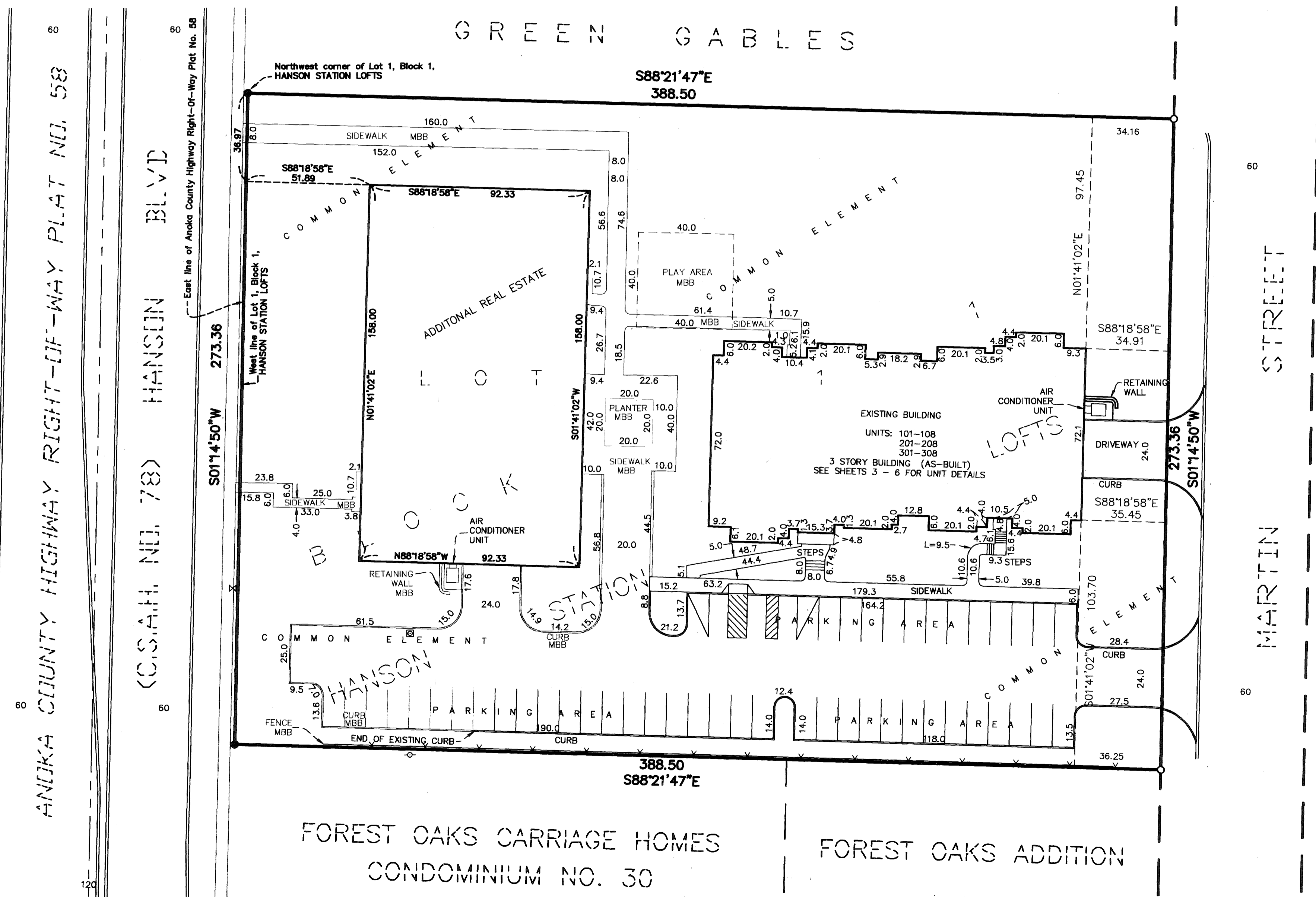
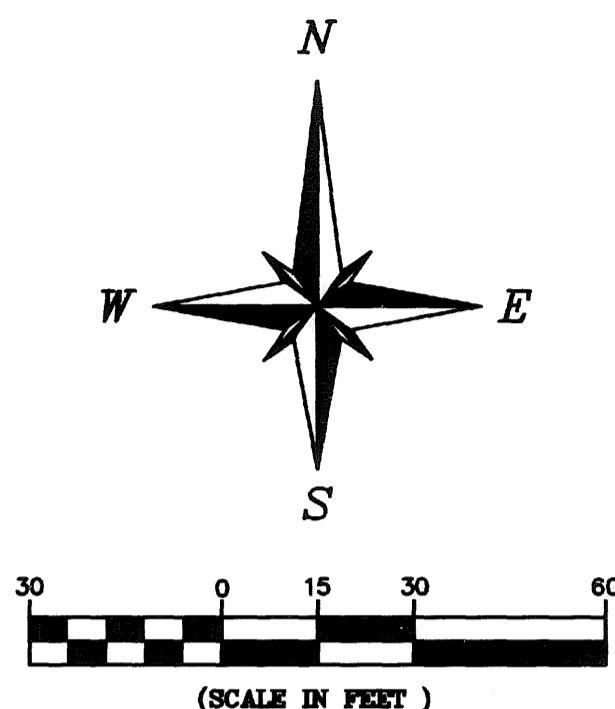

- - Denotes 1/2-inch found iron pipe
- - Denotes 1/2-inch X 14 inch set iron pipe marked by License 44109
- MBB - Denotes must be built

Bearings shown are based on the West line of Lot 1, Block 1, HANSON STATION LOFTS having an assumed bearing of S 01°14'50" W.

BENCHMARK:
Top Ring of Sanitary manhole 20 feet North of the Northeast property corner on Martin Street. Elevation = 865.95 (NGVD-1929)

SCHOELL MADSON
PLANNING * ENGINEERING * SURVEYING

UNIT DETAILS
(AS - BUILT)

CIC NUMBER 239

A CONDOMINIUM HANSON STATION CIC PLAT

*bkack
pg 50*

SEC. 15, T.31, R. 24
COON RAPIDS
ANOKA COUNTY

GARAGE LEVEL

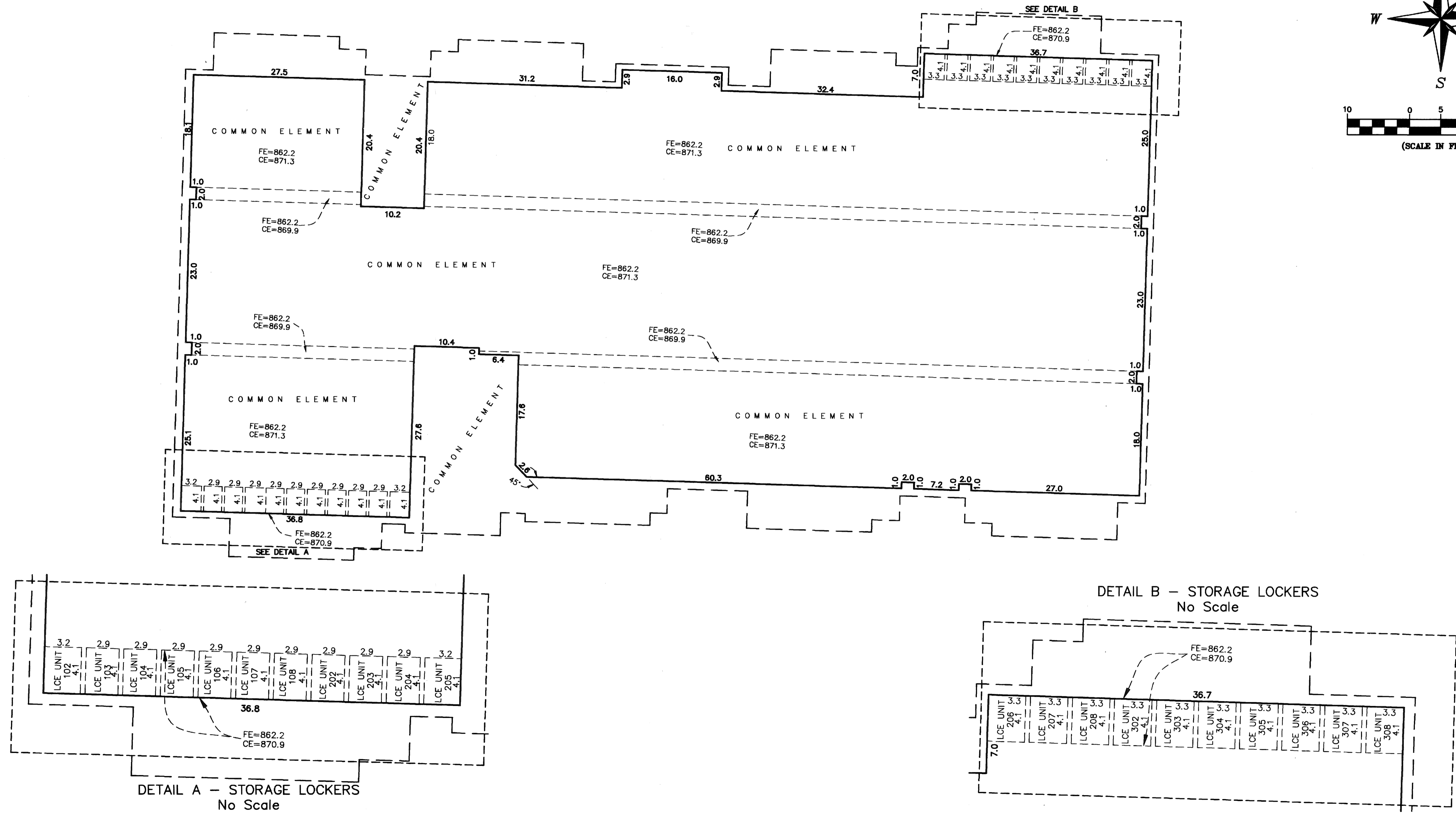
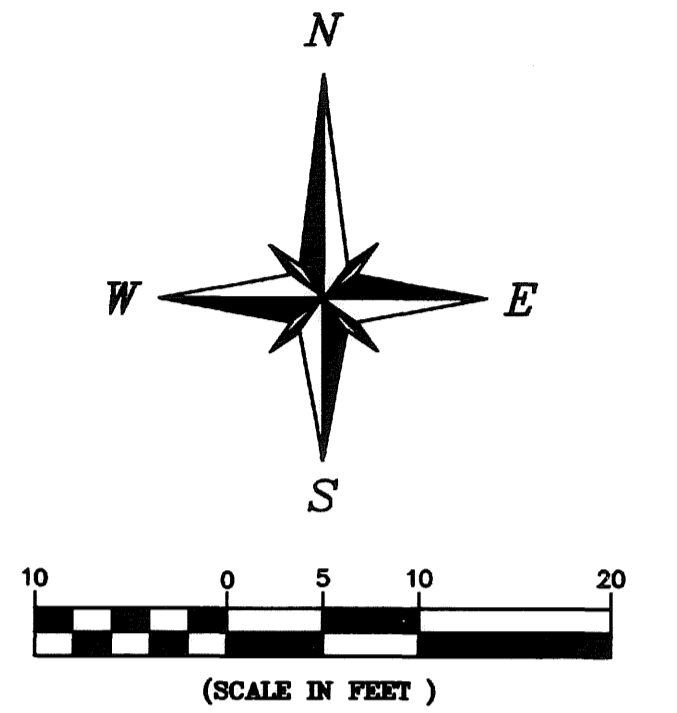

ELEVATIONS SHOWN ARE REFERENCED TO A BENCHMARK AS DENOTED ON SHEET 2 OF 6 SHEETS.

FE - DENOTES FLOOR ELEVATIONS
CE - DENOTES CEILING ELEVATIONS
LCE - DENOTES LIMITED COMMON ELEMENT

UNIT BOUNDARY DIMENSIONS ARE SHOWN IN FEET AND TENTHS OF A FOOT AND ARE MEASURED TO THE INTERIOR, UNFINISHED SURFACES OF THE PERIMETER WALLS, FLOORS, AND CEILINGS.

SCHOELL MADSON
PLANNING * ENGINEERING * SURVEYING

UNIT DETAILS
(AS - BUILT)

CIC NUMBER 239

A CONDOMINIUM HANSON STATION CIC PLAT

bka c/c
pg 50

SEC. 15, T.31, R. 24
COON RAPIDS
ANOKA COUNTY

FIRST LEVEL

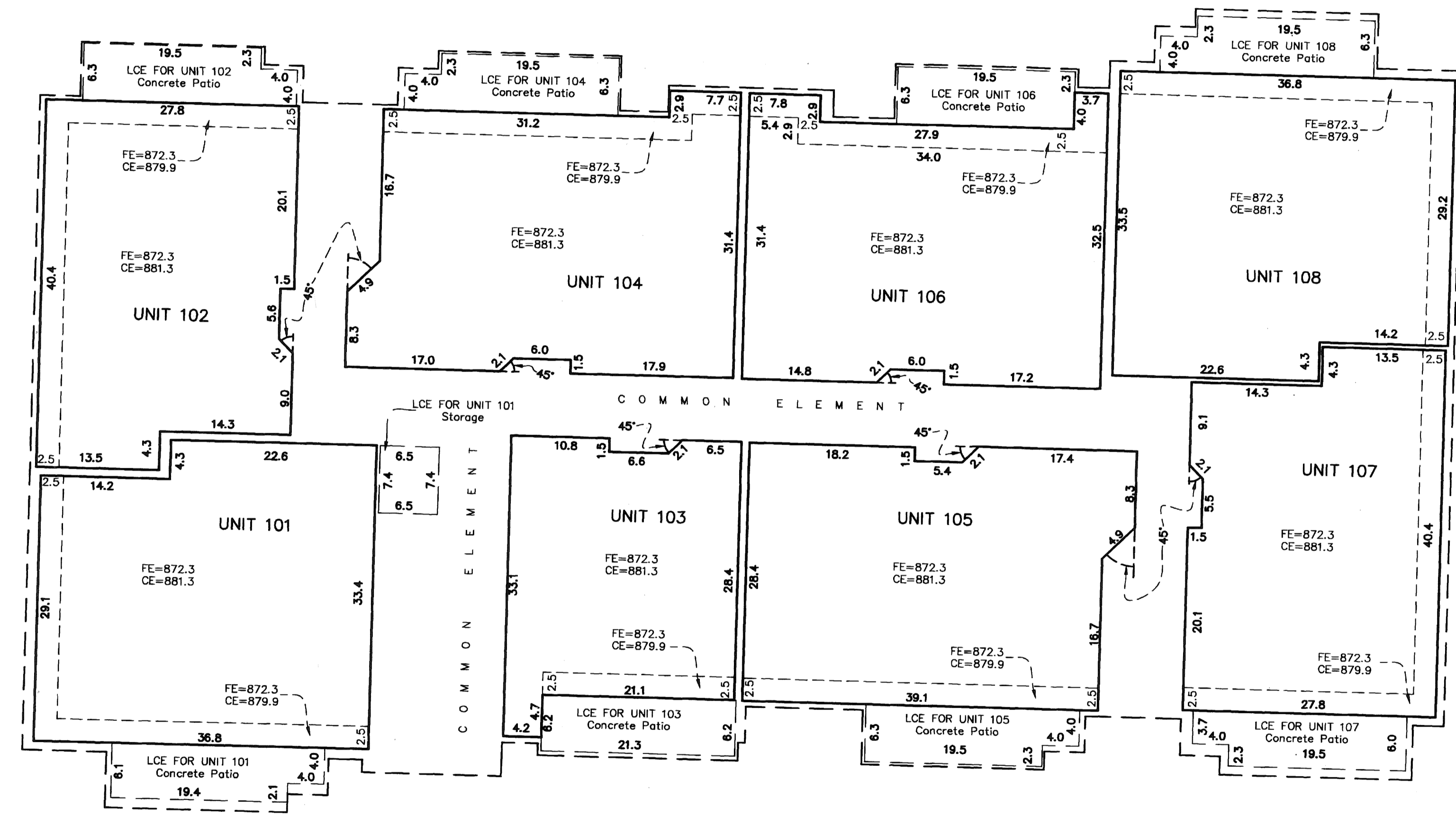
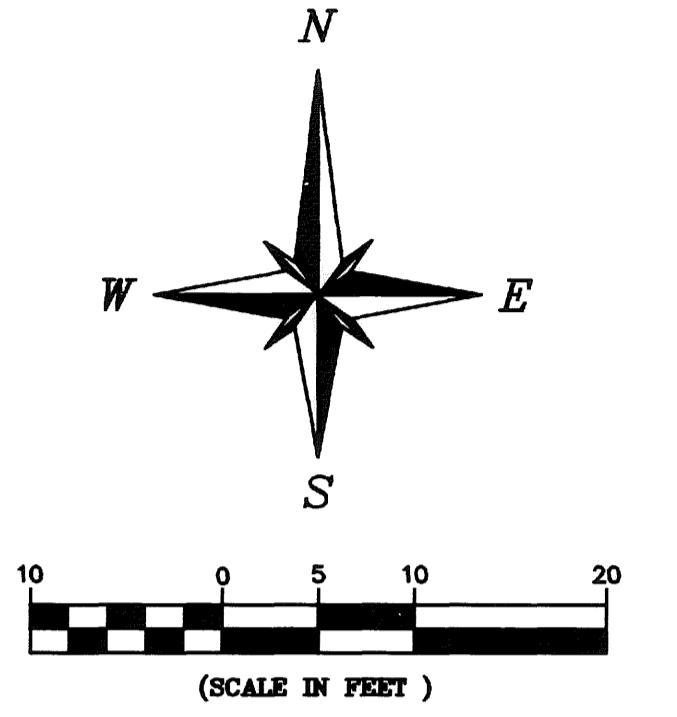

ELEVATIONS SHOWN ARE REFERENCED TO A BENCHMARK AS DENOTED ON SHEET 2 OF 6 SHEETS.

UNIT BOUNDARY DIMENSIONS ARE SHOWN IN FEET AND TENTHS OF A FOOT AND ARE MEASURED TO THE INTERIOR, UNFINISHED SURFACES OF THE PERIMETER WALLS, FLOORS, AND CEILINGS.

FE - DENOTES FLOOR ELEVATIONS
CE - DENOTES CEILING ELEVATIONS
LCE - DENOTES LIMITED COMMON ELEMENT

SCHOELL MADSON
PLANNING * ENGINEERING * SURVEYING

bk 9CIC
pg 50

UNIT DETAILS
(AS - BUILT)

CIC NUMBER 239

A CONDOMINIUM HANSON STATION CIC PLAT

SEC. 15, T.31, R. 24
COON RAPIDS
ANOKA COUNTY

SECOND LEVEL

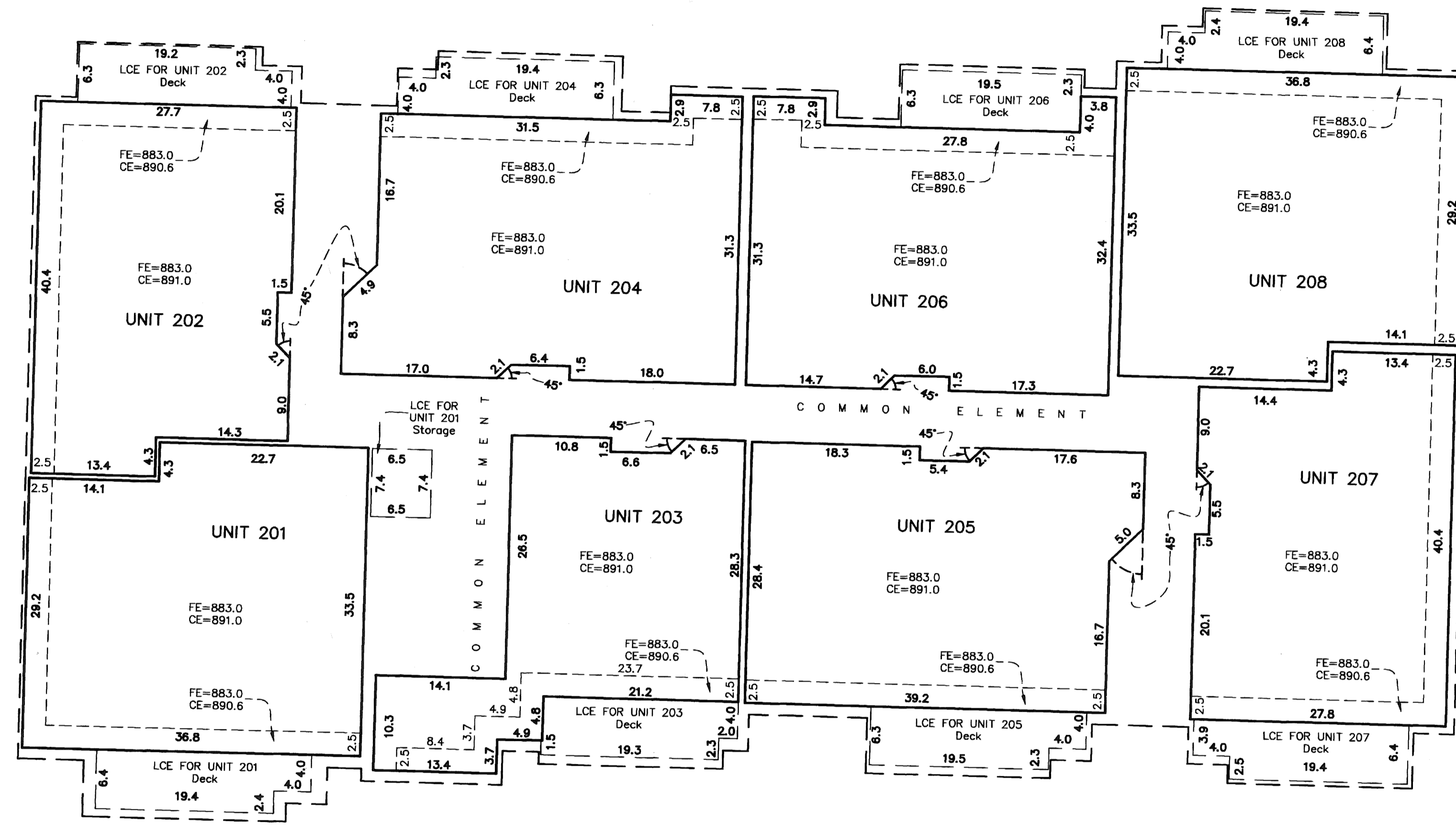
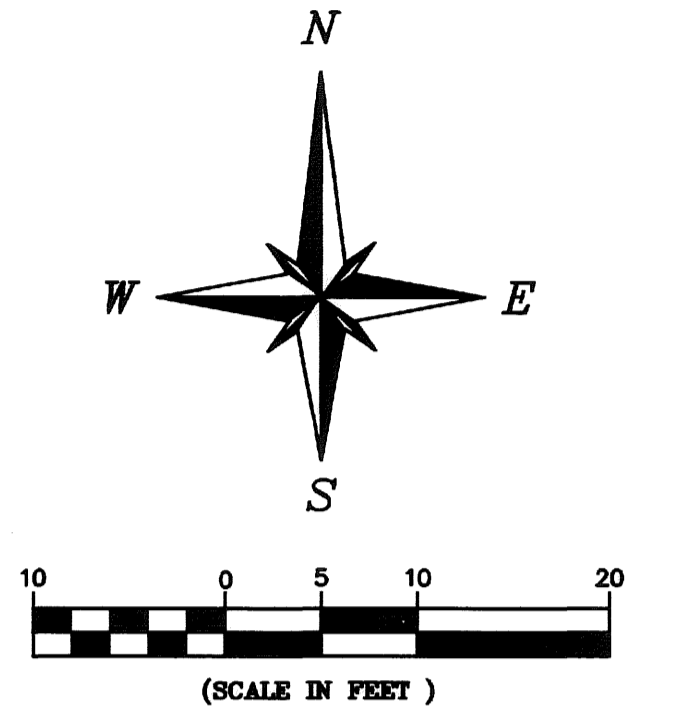

ELEVATIONS SHOWN ARE REFERENCED TO A BENCHMARK AS DENOTED ON SHEET 2 OF 6 SHEETS.

UNIT BOUNDARY DIMENSIONS ARE SHOWN IN FEET AND TENTHS OF A FOOT AND ARE MEASURED TO THE INTERIOR, UNFINISHED SURFACES OF THE PERIMETER WALLS, FLOORS, AND CEILINGS.

FE - DENOTES FLOOR ELEVATIONS
CE - DENOTES CEILING ELEVATIONS
LCE - DENOTES LIMITED COMMON ELEMENT

SCHOELL MADSON
PLANNING * ENGINEERING * SURVEYING

bk 9 CIC
pg 50

UNIT DETAILS
(AS - BUILT)

CIC NUMBER 239

A CONDOMINIUM HANSON STATION CIC PLAT

SEC. 15, T.31, R. 24
COON RAPIDS
ANOKA COUNTY

THIRD LEVEL

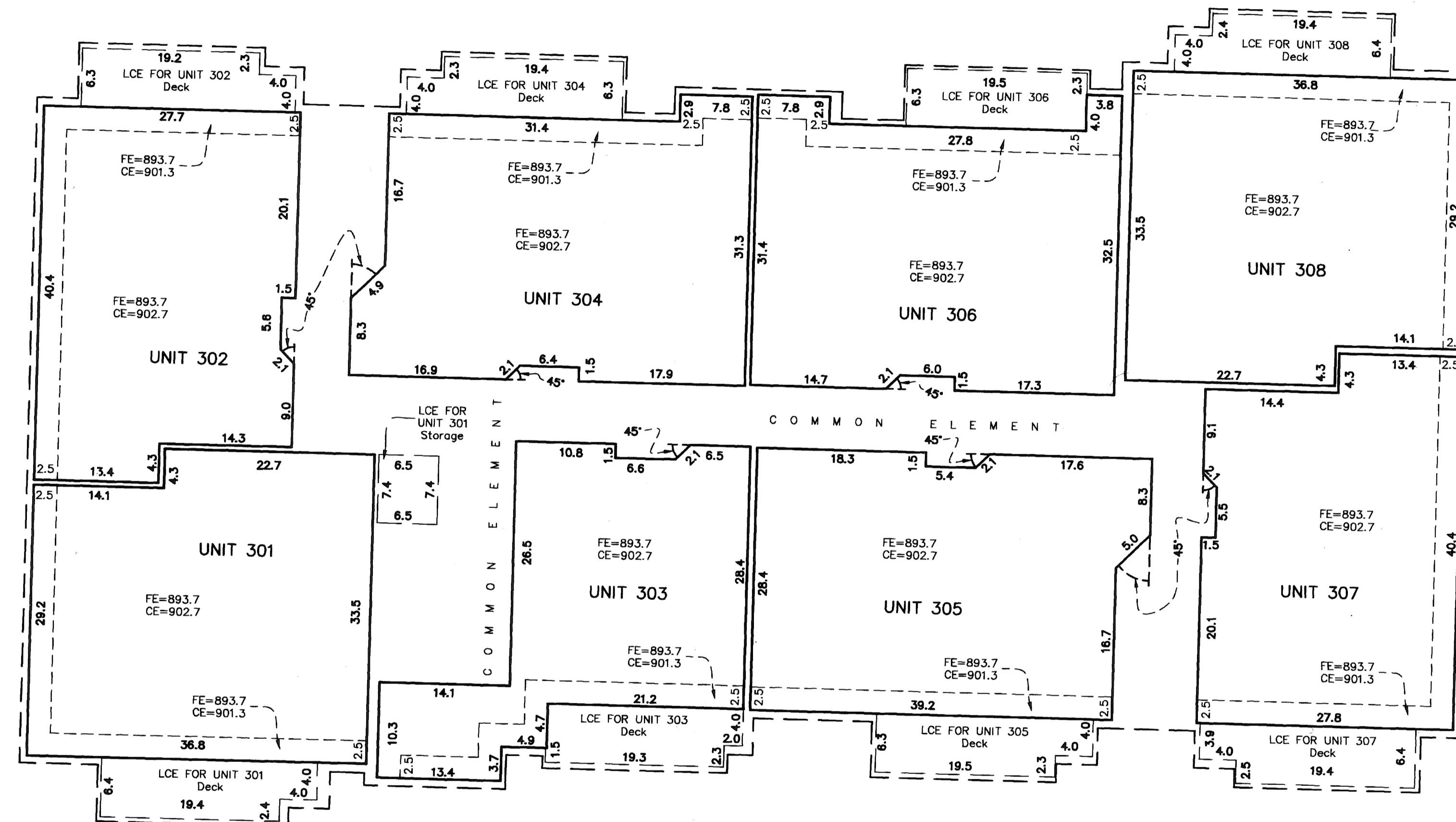
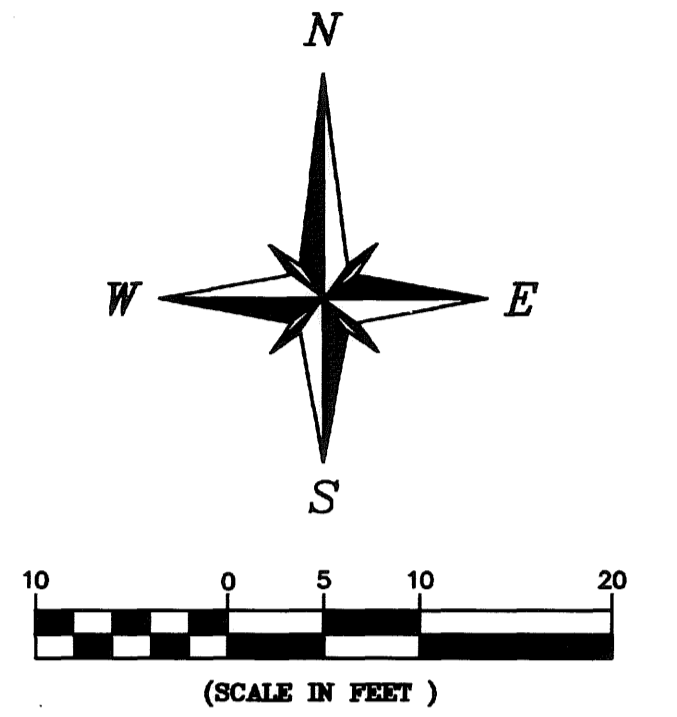

ELEVATIONS SHOWN ARE REFERENCED TO A BENCHMARK AS DENOTED ON SHEET 2 OF 6 SHEETS.

UNIT BOUNDARY DIMENSIONS ARE SHOWN IN FEET AND TENTHS OF A FOOT AND ARE MEASURED TO THE INTERIOR, UNFINISHED SURFACES OF THE PERIMETER WALLS, FLOORS, AND CEILINGS.

FE - DENOTES FLOOR ELEVATIONS
CE - DENOTES CEILING ELEVATIONS
LCE - DENOTES LIMITED COMMON ELEMENT

SCHOELL MADSON
PLANNING * ENGINEERING * SURVEYING